

LUMIX GH5 II

FIRMWARE Ver.1.1

LIVE STREAMING SETTINGS GUIDE

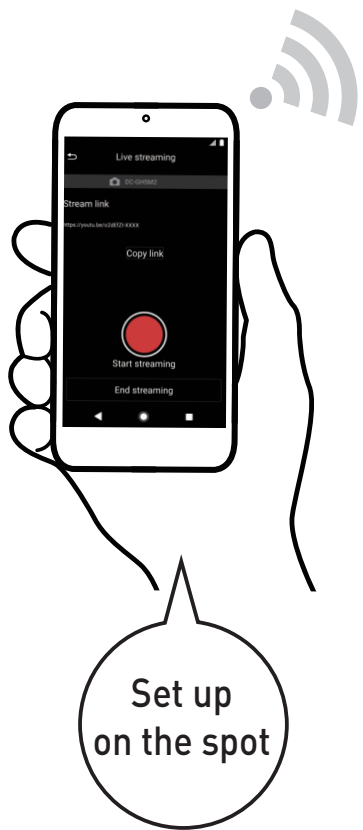



Live Streaming Settings Using a Smartphone

Advance Preparation | Pairing Your Camera and Smartphone 1

Use the Wireless IP Streaming 2



- RTMP/RTMPS 3 ~ 4
- YouTube LIVE YouTube 5 ~ 6
- Facebook LIVE LIVE 7 ~ 8

Use USB Tethering with a Smartphone 9

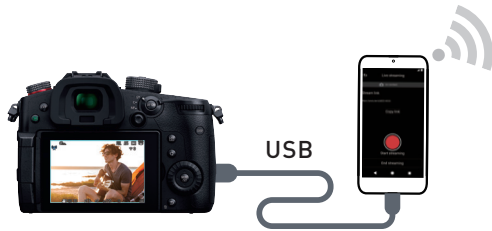

- RTMP/RTMPS 10 ~ 11
- YouTube LIVE YouTube 12 ~ 13
- Facebook LIVE LIVE 14 ~ 15

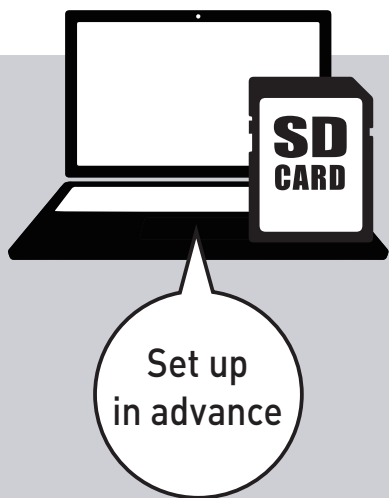

Live Streaming Settings Using a PC and SD Card

Advance Preparation | Set up Streaming on PC and Load into the Camera 16 ~ 17

Use the Wireless IP Streaming 18 ~ 19

Use USB Tethering with a Smartphone 20 ~ 21

THREE WAYS to Live Stream Using the “LUMIX Sync” Smartphone App



LUMIX Sync

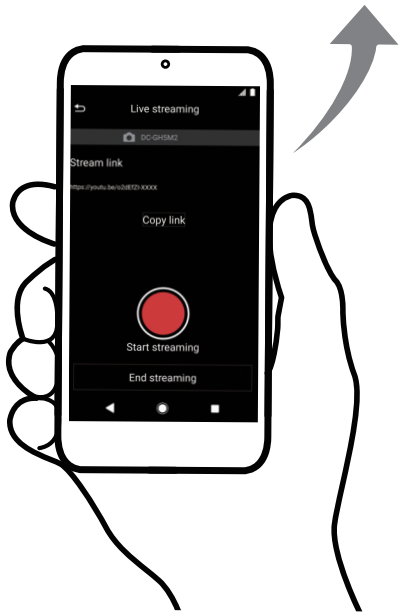

Streaming with RTMP/RTMPS

Setting method for live streaming using stream URL and stream key. In addition to YouTube and Facebook, it is possible to configure settings with various social streaming platforms that are compatible with RTMP/RTMPS.

**When you wish to schedule a post or if you have less than 1,000 subscribers on YouTube, connect with RTMP/RTMPS.*

Check

Wi-Fi

3 ~ 4

USB

10 ~ 11

Streaming with YouTube LIVE



This is a setting method to easily conduct live streaming by logging into your YouTube account so that you can omit inputs such as stream key.

Caution Due to YouTube's Terms of Service, this setting is only possible if you have over 1,000 subscribers.

Check

Wi-Fi

5 ~ 6

USB

12 ~ 13

Streaming with Facebook LIVE



This is a setting method to easily conduct live streaming by logging into your Facebook account so that you can omit inputs such as stream key.

Check

Wi-Fi

7 ~ 8

USB

14 ~ 15

- Live streaming to the platforms that comply with RTMP/RTMPS is basically possible (Compatibility with all the platforms is not guaranteed.) There may be the cases where the live streaming is not possible when the service of the platform changes. For more information, please refer to the terms and conditions of the platform.
- Since the transmission speed of live streaming varies depending on the Internet environment, smartphone performance, etc., we recommend that you conduct a transmission test in advance.
- YouTube™ and the “YouTube logo” are registered trademarks of Google Inc. •Facebook™ is a registered trademark of Facebook, Inc.

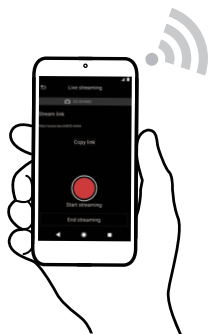

1 Advance Preparation Pairing Your Camera and Smartphone

Preparation when using a smartphone

■ GH5II



❗ Check the remaining battery level of your camera!

■ Smartphone



Install the "LUMIX Sync" smartphone app

*Turn Bluetooth ON.

❗ Check the remaining battery level and connection status of your smartphone!

- Supported OS (as of April 2022) Android™: 7.0 or later (The Bluetooth® function requires your device to use Android 5.0 or later and Bluetooth 4.0 or later. Excluding some models that are not compatible with Bluetooth Low Energy.), iOS: 12 or later.
- Android is a trademark or registered trademark of Google Inc.
- App Store is a service mark of Apple Inc.

Check FAQs

Frequently asked questions from customers are introduced at the LUMIX Customer Support page.

https://panasonic.jp/support/global/cs/dsc/faq/dc_gh5m2/index.html



Connect your camera and smartphone

Pair the "LUMIX Sync" smartphone app with your camera in advance with Bluetooth.

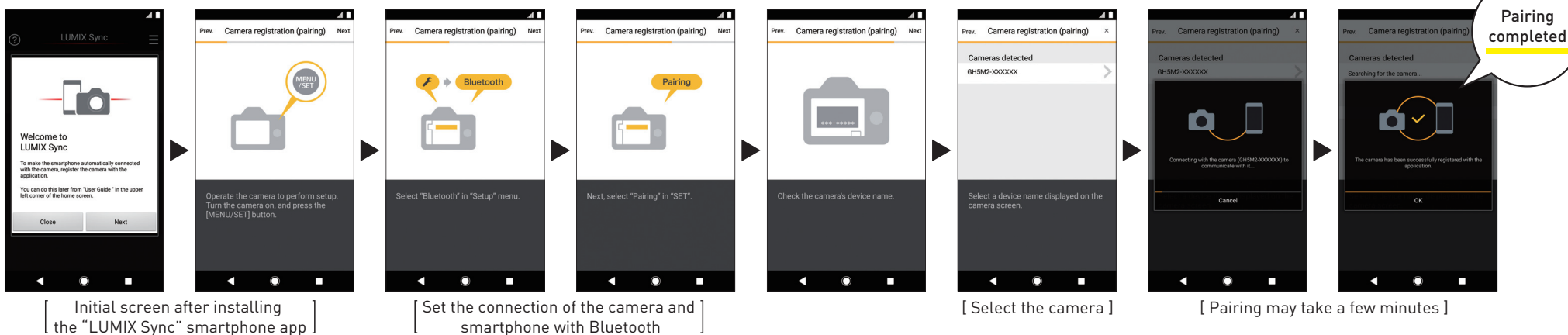

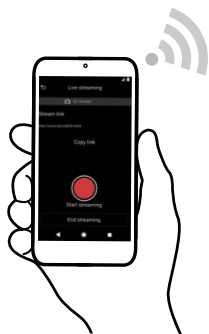

2 Use the Wireless IP Streaming



**HIGH IMAGE QUALITY
INDOORS & OUTDOORS**



Smartphone

Streaming
(RTMP/RTMPS)

Social streaming platform

- Wireless, high quality streaming both indoors and outdoors.
- Enables streaming more actively.

Live streaming mode (Wi-Fi)

| | | | | |
|-----|-------------------------------|-------|--------|--------------|
| FHD | 60p (59.94Hz) / 50p (50.00Hz) | H.264 | 16Mbps | RTMP |
| | 30p (59.94Hz) / 25p (50.00Hz) | | 8Mbps | RTMP / RTMPS |
| HD | 60p (59.94Hz) / 50p (50.00Hz) | | 6Mbps | RTMP / RTMPS |
| | 30p (59.94Hz) / 25p (50.00Hz) | | 3Mbps | RTMP / RTMPS |
| | | | 6Mbps | RTMP / RTMPS |
| | | | 4Mbps | RTMP / RTMPS |

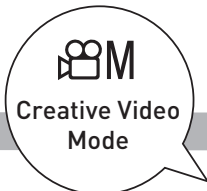

Confirm before setting up streaming



Please update the firmware to
**GH5II
Ver.1.1**

- RTMP/RTMPS 3 ~ 4
- YouTube LIVE 5 ~ 6
- Facebook LIVE 7 ~ 8

•YouTube™ and the "YouTube logo" are registered trademarks of Google Inc. •Facebook™ is a registered trademark of Facebook, Inc.

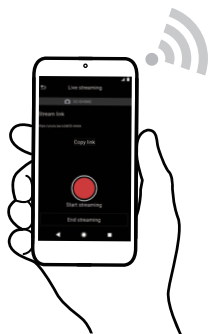

3

Wireless IP Streaming

Streaming with RTMP/RTMPS



This is a setting method for live streaming using platforms compatible with RTMP/RTMPS such as YouTube.

*YouTube™ and the “YouTube logo” are registered trademarks of Google Inc. *Here we will be explaining using a streaming setting using YouTube Studio as an example. *When you wish to schedule a post or if you have less than 1,000 subscribers on YouTube, connect with RTMP/RTMPS. *Please be sure to confirm the terms of use of the platform before using the streaming service.

STEP 1

Launch LUMIX Sync and start settings

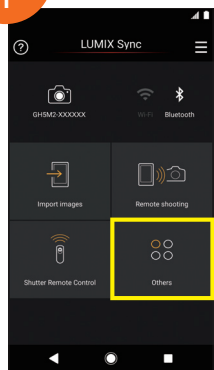

[Select “Others”]

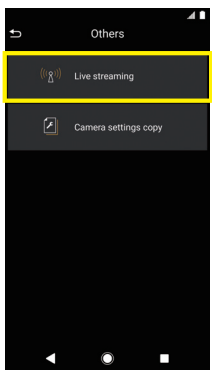

[Select “Live streaming”]

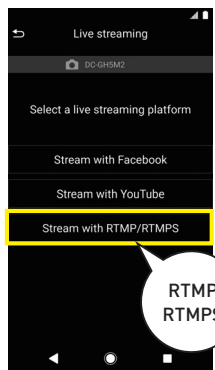

RTMP
RTMPS

[Select “Stream with RTMP/RTMPS”]

Connection method

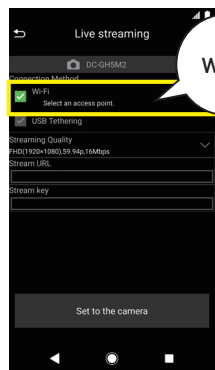

Wi-Fi

[Select “Wi-Fi”]

ADVANCE PREPARATION



Configure settings from the social streaming platform

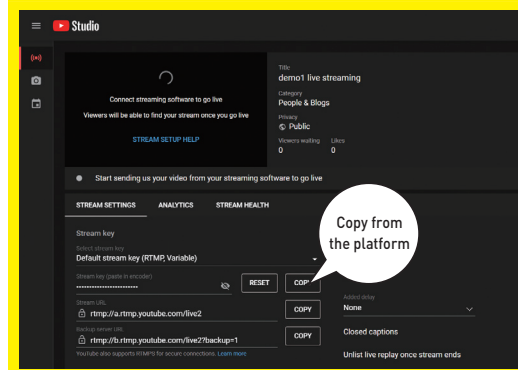

Copy from the platform

- 1 Set the privacy settings and date and time.
- 2 Set other details.
- 3 Copy the stream URL.
- 4 Copy the stream key.
- 5 Copy to your email, etc. and share with an app.

STEP 2

Wi-Fi settings

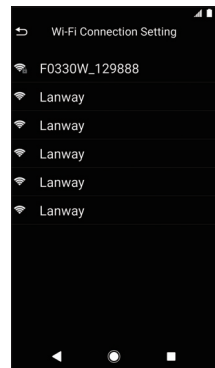

[Select a wireless access point]

Image quality settings

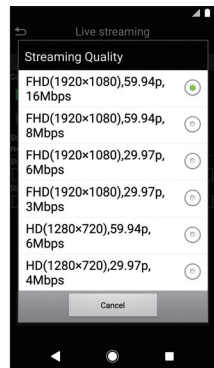
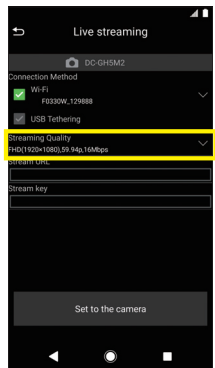

[Set the streaming quality]

Stream URL settings

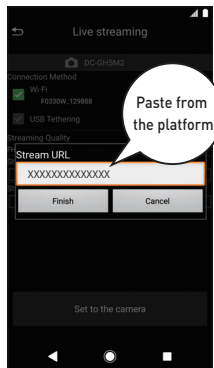

Paste from the platform

[Obtain a stream URL from the social streaming platform and configure settings]

Stream key settings

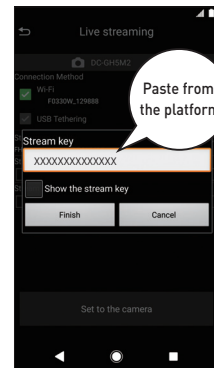

Paste from the platform

[Obtain a stream key from the social streaming platform and configure settings]

STEP 3
NEXT PAGE

! If a list of smartphones that you wish to connect is not displayed, turn the tethering function “OFF/ON” again.

! Confirm the upstream speed of the network that you are using before streaming and select the streaming quality.

*When streaming using a smartphone network, a tethering service contract for your carrier is required.

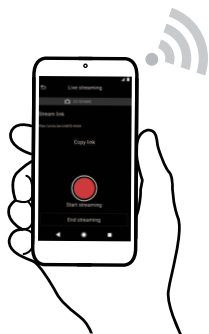

4

Wireless IP Streaming

Streaming with RTMP/RTMPS



This is a setting method for live streaming using platforms compatible with RTMP/RTMPS such as YouTube.

*YouTube™ and the “YouTube logo” are registered trademarks of Google Inc. *Here we will be explaining using a streaming setting using YouTube Studio as an example. *When you wish to schedule a post or if you have less than 1,000 subscribers on YouTube, connect with RTMP/RTMPS. *Please be sure to confirm the terms of use of the platform before using the streaming service.

STEP 3

Set from LUMIX Sync to a camera

Enable “Tethering” on your smartphone

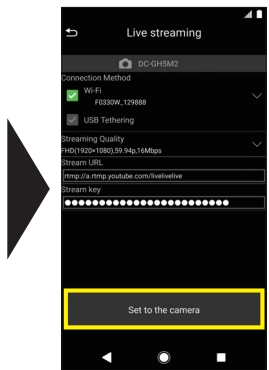

[Set to the camera]



Streaming function ON

[Turn the camera’s streaming function ON]

CHECK Creative Video Mode

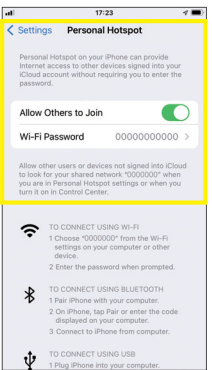

The time display is green on iOS.

STEP 4

*Make sure the smartphone is tethering and then start streaming.

STEP 4

Spread the URL and start streaming

Stopping and ending streaming

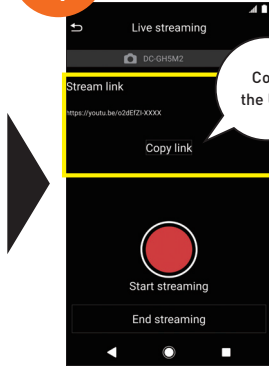

[Copy the stream URL]

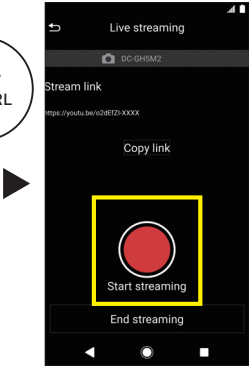

[Start live streaming]

Announce the URL with social media, email, etc.



LIVE STREAMING

[Blue frame indicator during live streaming]

*The blue frame indicator can be switched ON/OFF.

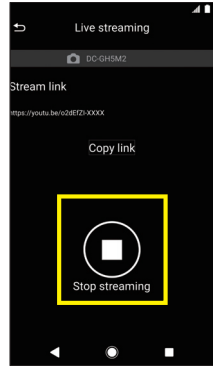

[Stop live streaming]

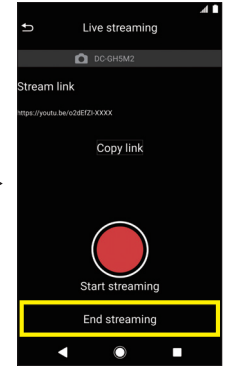

[End live streaming]

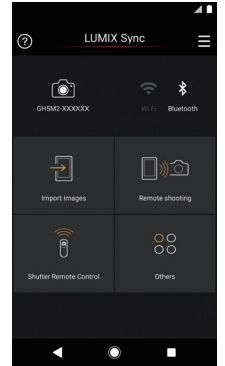

[Return to the top screen]

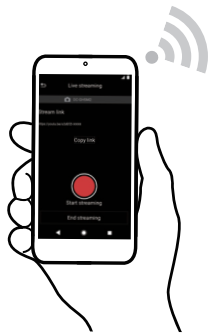

5 Wireless IP Streaming Streaming with YouTube LIVE



How to set live streaming using your account and YouTube Studio if you are a YouTube user with **over 1,000** subscribers.

*YouTube™ and the “YouTube logo” are registered trademarks of Google Inc. *Here we will be explaining using a streaming setting using YouTube Studio as an example. *When you wish to schedule a post or if you have less than 1,000 subscribers on YouTube, connect with RTMP/RTMPS. *Please be sure to confirm the terms of use of the platform before using the streaming service.

STEP 1

Launch LUMIX Sync and start settings

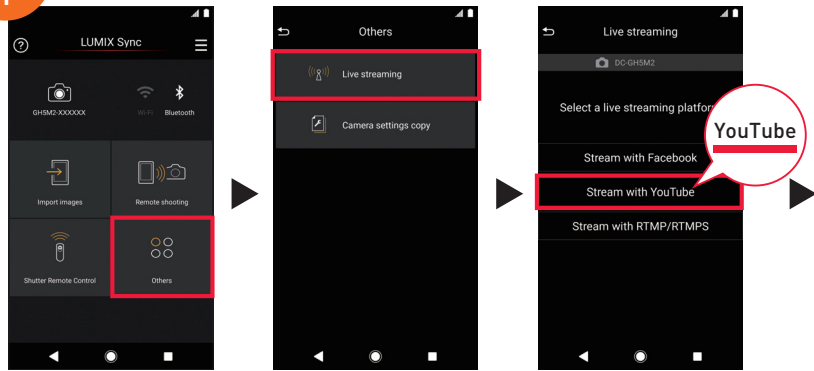

[Select “Others”]

[Select “Live streaming”]

[Select “Stream with YouTube”]

YouTube account settings

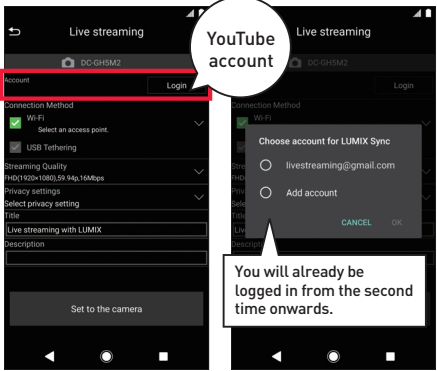

[Login to your YouTube account]

STEP 2

STEP 2

Connection method



[Select “Wi-Fi”]

Wi-Fi settings

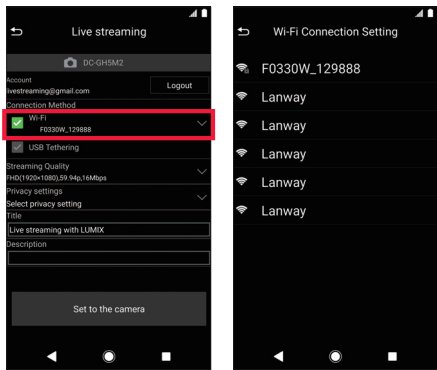

[Select a wireless access point]

Image quality, title and description

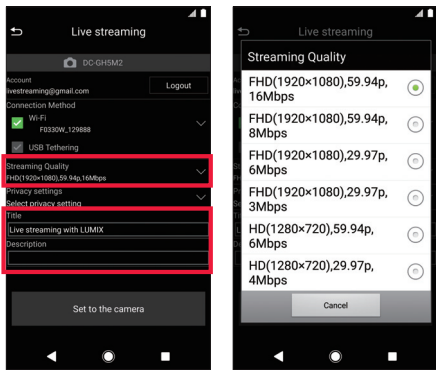

[Set the streaming quality, title and description]

Privacy settings

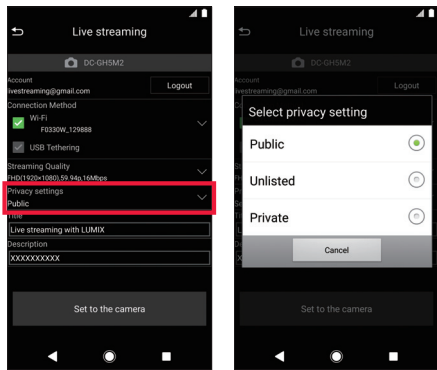

[Set the range to release the stream]

STEP 3
NEXT PAGE

! If a list of smartphones that you wish to connect is not displayed, turn the tethering function “OFF/ON” again.

! Confirm the upstream speed of the network that you are using before streaming and select the streaming quality.

*When streaming using a smartphone network, a tethering service contract for your carrier is required.

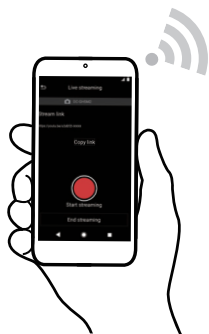

6

Wireless IP Streaming

Streaming with YouTube LIVE



How to set live streaming using your account and YouTube Studio if you are a YouTube user with **over 1,000** subscribers.

*YouTube™ and the “YouTube logo” are registered trademarks of Google Inc. *Here we will be explaining using a streaming setting using YouTube Studio as an example. *When you wish to schedule a post or if you have less than 1,000 subscribers on YouTube, connect with RTMP/RTMPS. *Please be sure to confirm the terms of use of the platform before using the streaming service.

STEP 3

Set from LUMIX Sync to a camera

Enable “Tethering” on your smartphone

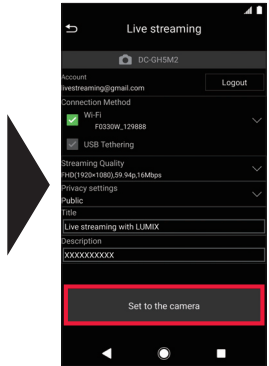

[Set to the camera]



Streaming function ON

[Turn the camera’s streaming function ON]

CHECK Creative Video Mode

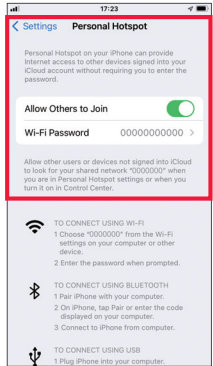

The time display is green on iOS.

STEP 4

*Make sure the smartphone is tethering and then start streaming.

STEP 4

Spread the URL and start streaming

Stopping and ending streaming

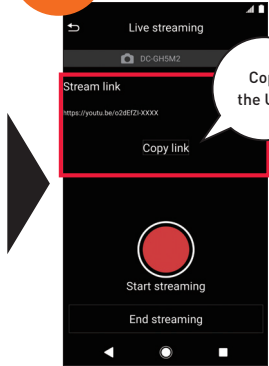

Copy the URL

[Copy the stream URL]

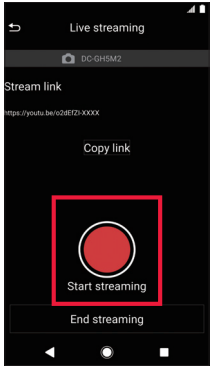

[Start live streaming]

Announce the URL with social media, email, etc.



LIVE STREAMING

[Blue frame indicator during live streaming]

*The blue frame indicator can be switched ON/OFF.

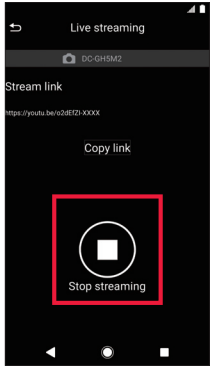

[Stop live streaming]

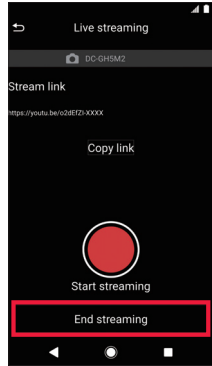

[End live streaming]

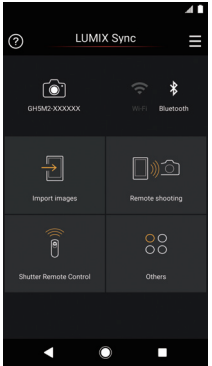

[Return to the top screen]

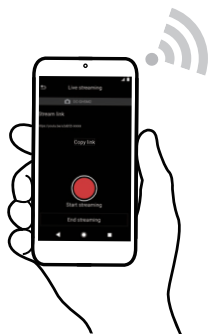

7

Wireless IP Streaming

Streaming with Facebook LIVE



Setting method for live streaming using your Facebook account and Facebook LIVE.

•Facebook™ is a registered trademark of Facebook, Inc.
*Please be sure to confirm the terms of use of the platform before using the streaming service.

STEP 1

Launch LUMIX Sync and start settings

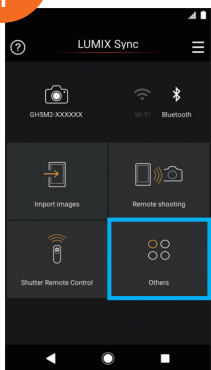

[Select "Others"]

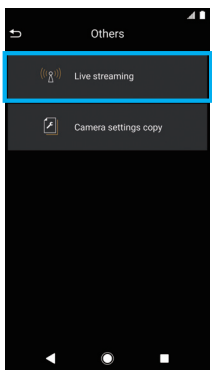

[Select "Live streaming"]

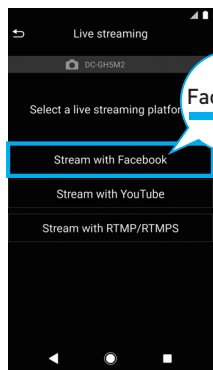

[Select "Stream with Facebook"]

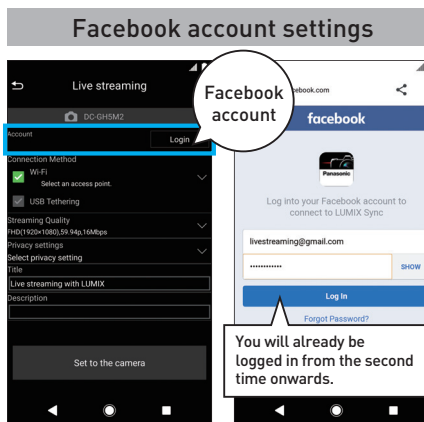

[Login to your Facebook account]

STEP 2

STEP 2

Connection method



[Select "Wi-Fi"]

Wi-Fi settings

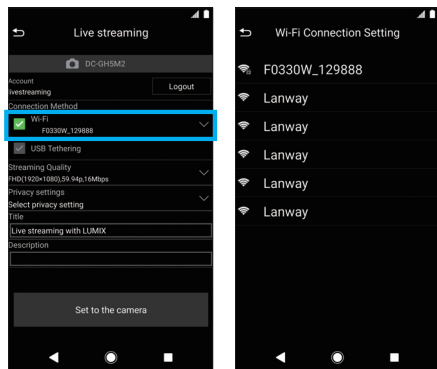

[Select a wireless access point]

Image quality, title and description

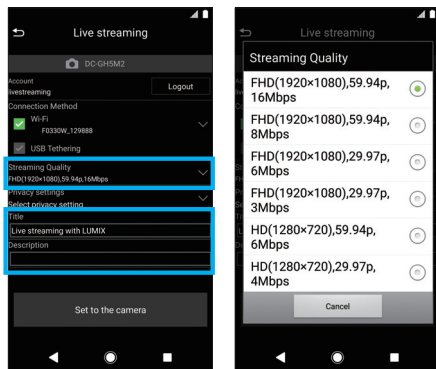

[Set the streaming quality, title and description]

Privacy settings

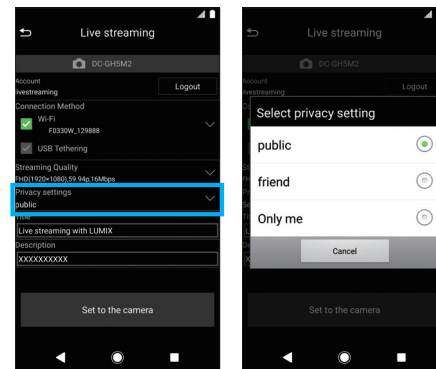

[Set the range to release the stream]

STEP 3
NEXT PAGE

! If a list of smartphones that you wish to connect is not displayed, turn the tethering function "OFF/ON" again.

! Confirm the upstream speed of the network that you are using before streaming and select the streaming quality.

*When streaming using a smartphone network, a tethering service contract for your carrier is required.

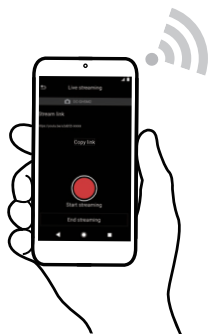

8

Wireless IP Streaming

Streaming with Facebook LIVE



Setting method for live streaming using your Facebook account and Facebook LIVE.

•Facebook™ is a registered trademark of Facebook, Inc.
*Please be sure to confirm the terms of use of the platform before using the streaming service.

STEP 3

Set from LUMIX Sync to a camera

Enable "Tethering" on your smartphone

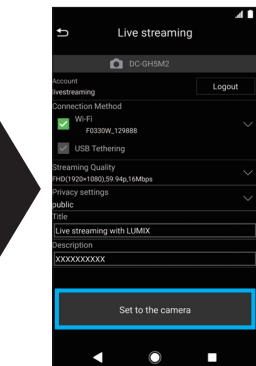

[Set to the camera]



[Turn the camera's streaming function ON]

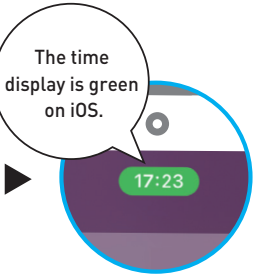
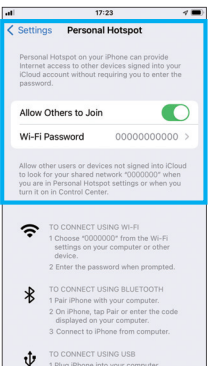

The time display is green on iOS.

STEP 4

*Make sure the smartphone is tethering and then start streaming.

STEP 4

Spread the URL and start streaming

Stopping and ending streaming

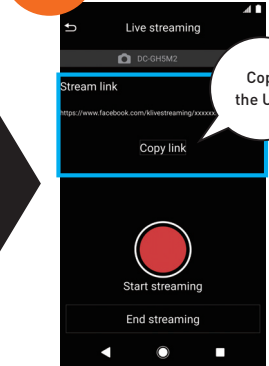

[Copy the stream URL]

Announce the URL with social media, email, etc.

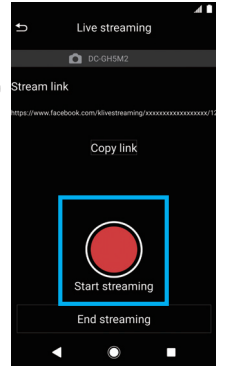

[Start live streaming]



[Blue frame indicator during live streaming]

*The blue frame indicator can be switched ON/OFF.

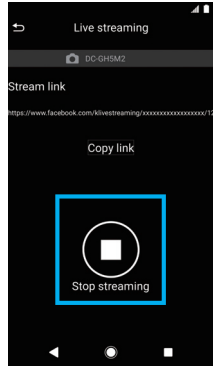

[Stop live streaming]

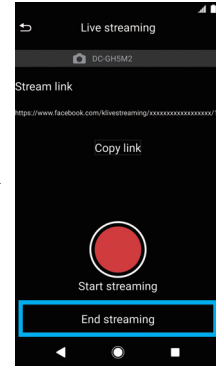

[End live streaming]

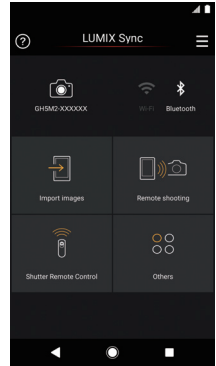

[Return to the top screen]

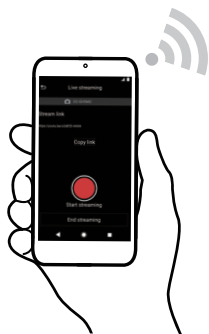

9 Use USB Tethering with a Smartphone



REDUCES RADIO INTERFERENCE

HIGH IMAGE QUALITY INDOORS & OUTDOORS

Caution When streaming using the USB tethering function, a tethering service contract for your carrier is required.

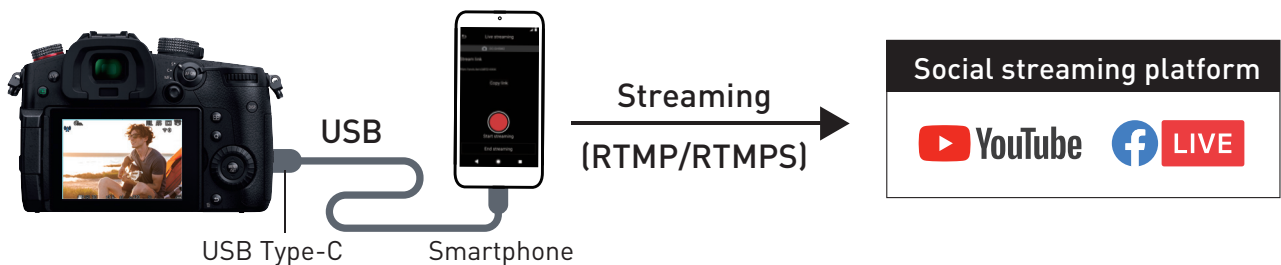

- Ensures communication stability even when used in environments with high radio interference.
- Compatible with 4K 30p/25p streaming.

Live streaming mode (USB tethering)

| | | | | |
|-----|-------------------------------|-------|--------------|--------------|
| 4K | 30p (59.94Hz) / 25p (50.00Hz) | H.264 | 12.5Mbps | RTMP / RTMPS |
| FHD | 60p (59.94Hz) / 50p (50.00Hz) | | 16Mbps | RTMP / RTMPS |
| | 30p (59.94Hz) / 25p (50.00Hz) | | 8Mbps | RTMP / RTMPS |
| HD | 60p (59.94Hz) / 50p (50.00Hz) | | 6Mbps | RTMP / RTMPS |
| | 30p (59.94Hz) / 25p (50.00Hz) | | 3Mbps | RTMP / RTMPS |
| | | | 6Mbps | RTMP / RTMPS |
| | | 4Mbps | RTMP / RTMPS | |

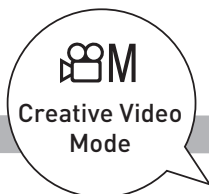

Confirm before setting up streaming



Please update the firmware to
GH5II Ver.1.1

- RTMP/RTMPS 10~11
- YouTube LIVE 12~13
- Facebook LIVE 14~15

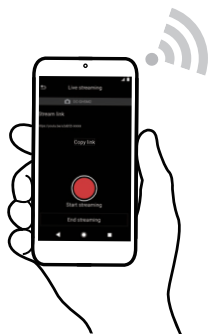

10

USB Tethering with a Smartphone

Streaming with RTMP/RTMPS



This is a setting method for live streaming using platforms compatible with RTMP/RTMPS such as YouTube.

•“YouTube” and the “YouTube logo” are registered trademarks of Google Inc. *Here we will be explaining using a streaming setting using YouTube Studio as an example. *When you wish to schedule a post or if you have less than 1,000 subscribers on YouTube, connect with RTMP/RTMPS. *Please be sure to confirm the terms of use of the platform before using the streaming service.

STEP 1

Launch LUMIX Sync and start settings

ADVANCE PREPARATION



Configure settings from the social streaming platform

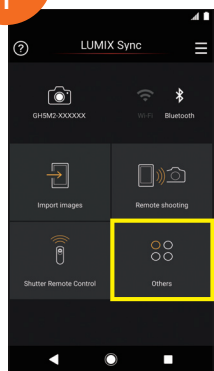

[Select "Others"]

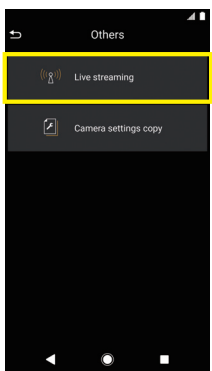

[Select "Live streaming"]

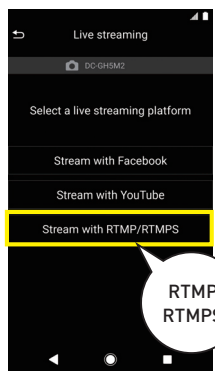

[Select "Stream with RTMP/RTMPS"]

STEP 2

RTMP RTMPS

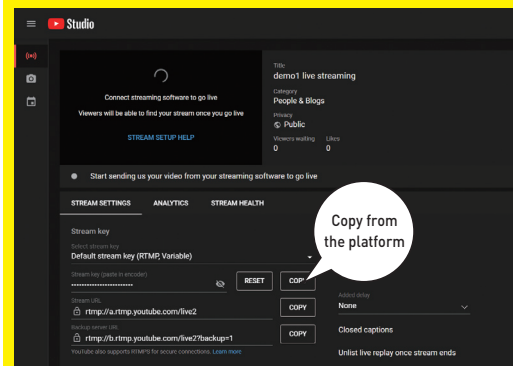

Copy from the platform

- ① Set the privacy settings and date and time.
- ② Set other details.
- ③ Copy the stream URL.
- ④ Copy the stream key.
- ⑤ Copy to your email, etc. and share with an app.

STEP 2

Connection method

Image quality settings

Stream URL settings

Stream key settings

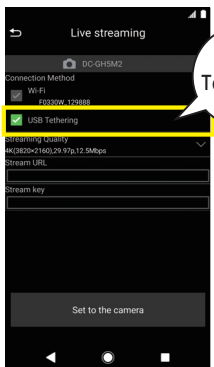

[Select "USB Tethering"]

USB Tethering

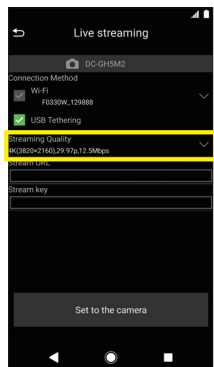

[Set the streaming quality]

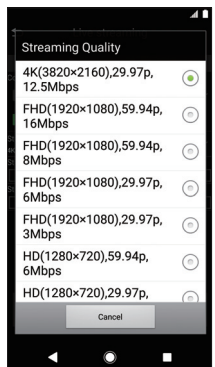

! Confirm the upstream speed of the network that you are using before streaming and select the streaming quality.

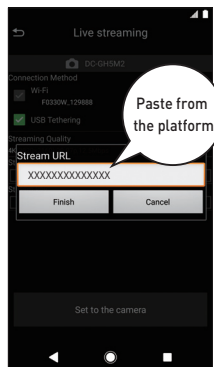

[Obtain a stream URL from the social streaming platform and configure settings]

Paste from the platform

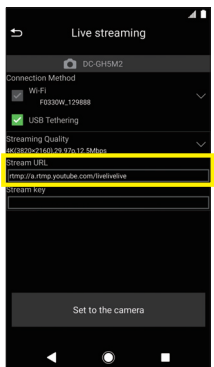

[Obtain a stream key from the social streaming platform and configure settings]

Paste from the platform

STEP 3 NEXT PAGE

Caution When streaming using the USB tethering function, a tethering service contract for your carrier is required.

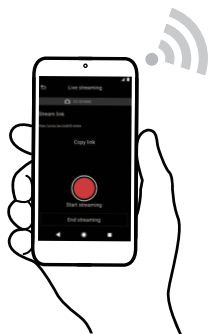

11 USB Tethering with a Smartphone

Streaming with RTMP/RTMPS



This is a setting method for live streaming using platforms compatible with RTMP/RTMPS such as YouTube.

*YouTube™ and the YouTube logo are registered trademarks of Google Inc. *Here we will be explaining using a streaming setting using YouTube Studio as an example. *When you wish to schedule a post or if you have less than 1,000 subscribers on YouTube, connect with RTMP/RTMPS. *Please be sure to confirm the terms of use of the platform before using the streaming service.

STEP 3

Set from LUMIX Sync to a camera

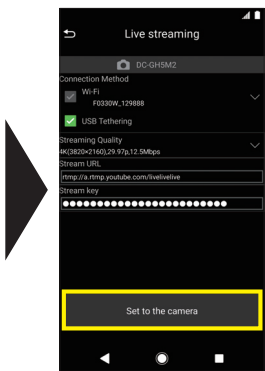

[Set to the camera]



[Turn the camera's streaming function ON]

CHECK
Creative Video Mode

STEP 4

Connect the USB cable and enable the tethering function of the smartphone before streaming

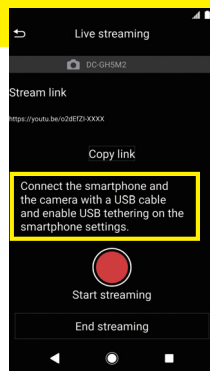

*Connect the USB after the streaming function is turned on.

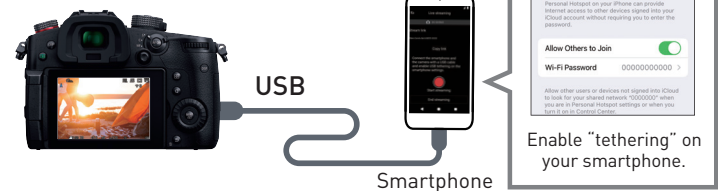

Caution When streaming using the USB tethering function, a tethering service contract for your carrier is required.

STEP 5

STEP 5

Spread the URL and start streaming

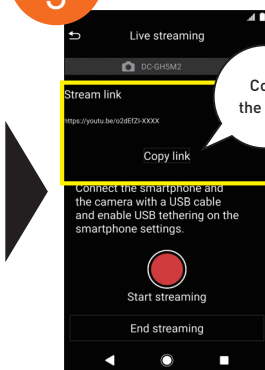

[Copy the stream URL]

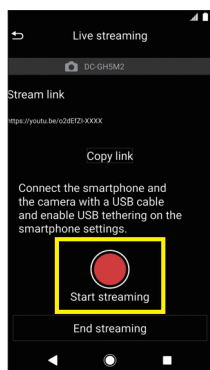

[Start live streaming]

Announce the URL with social media, email, etc.



[Blue frame indicator during live streaming]

*The blue frame indicator can be switched ON/OFF.

Stopping and ending streaming

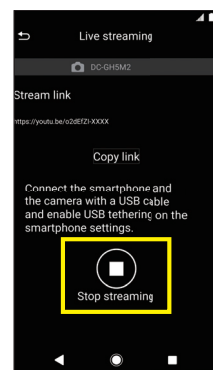

[Stop live streaming]

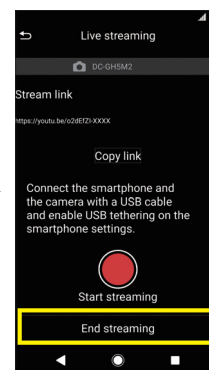

[End live streaming]

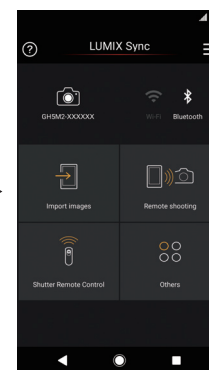

[Return to the top screen]

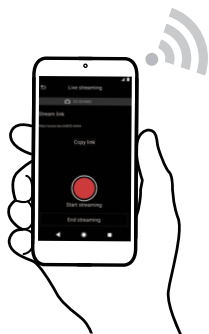

12

USB Tethering with a Smartphone

Streaming with YouTube LIVE



How to set live streaming using your account and YouTube Studio if you are a YouTube user with **over 1,000** subscribers.

•YouTube™ and the YouTube logo are registered trademarks of Google Inc. *Here we will be explaining using a streaming setting using YouTube Studio as an example. *When you wish to schedule a post or if you have less than 1,000 subscribers on YouTube, connect with RTMP/RTMPS. *Please be sure to confirm the terms of use of the platform before using the streaming service.

STEP 1

Launch LUMIX Sync and start settings

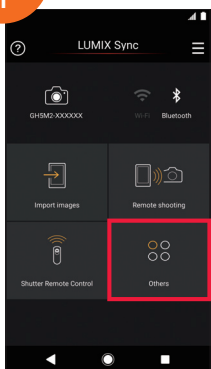

[Select "Others"]

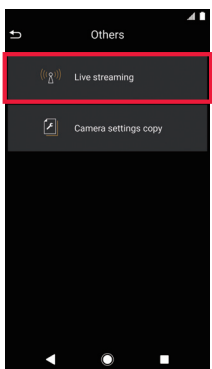

[Select "Live streaming"]

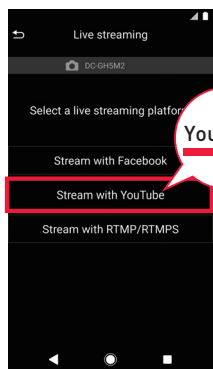

[Select "Stream with YouTube"]

STEP 2

STEP 2

YouTube account settings

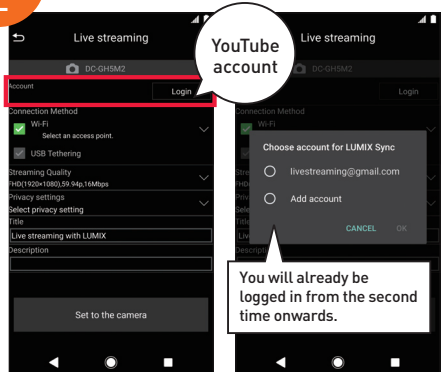

[Login to your YouTube account]

Connection method

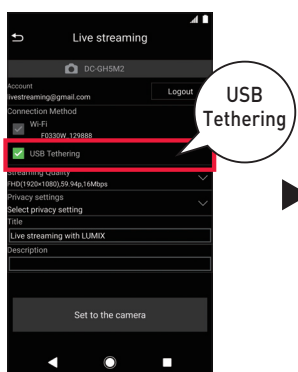

[Select "USB Tethering"]

Image quality, title and description

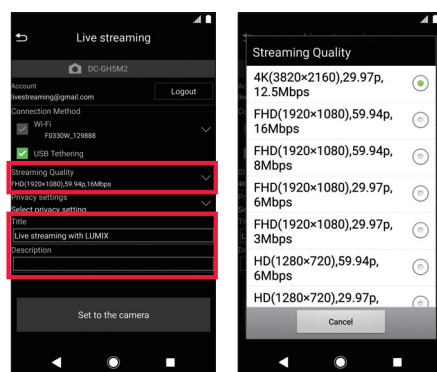

[Set the streaming quality, title and description]

Privacy settings

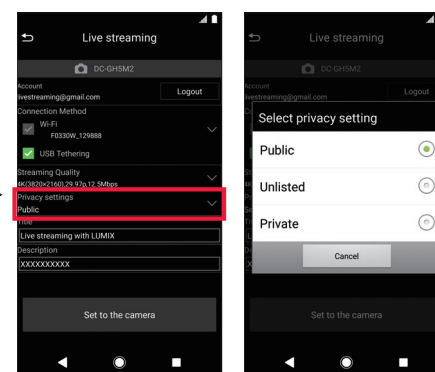

[Set the range to release the stream]

STEP 3 NEXT PAGE

Caution When streaming using the USB tethering function, a tethering service contract for your carrier is required.

! Confirm the upstream speed of the network that you are using before streaming and select the streaming quality.

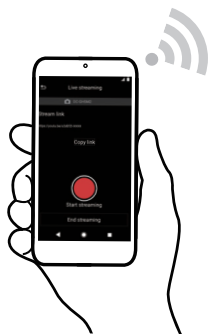

13

USB Tethering with a Smartphone

Streaming with YouTube LIVE



How to set live streaming using your account and YouTube Studio if you are a YouTube link user with **over 1,000** subscribers.

•YouTube™ and the “YouTube logo” are registered trademarks of Google Inc. *Here we will be explaining using a streaming setting using YouTube Studio as an example. *When you wish to schedule a post or if you have less than 1,000 subscribers on YouTube, connect with RTMP/RTMPS. *Please be sure to confirm the terms of use of the platform before using the streaming service.

STEP 3

Set from LUMIX Sync to a camera

CHECK



Creative Video Mode

Streaming function ON

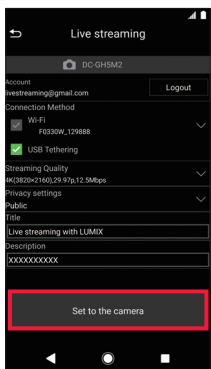

[Set to the camera]



[Turn the camera's streaming function ON]

STEP 4

Connect the USB cable and enable the tethering function of the smartphone before streaming

*Connect the USB after the streaming function is turned on.



USB

Smartphone

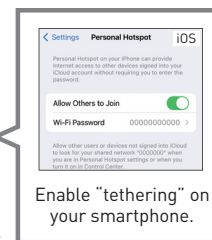

Enable "tethering" on your smartphone.

Caution When streaming using the USB tethering function, a tethering service contract for your carrier is required.

STEP 5

STEP 5

Spread the URL and start streaming

Copy the URL

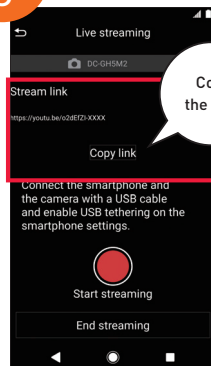

[Copy the stream URL]

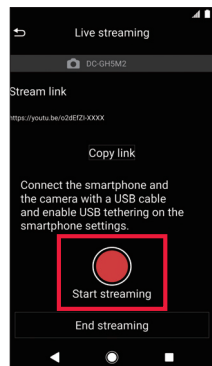

[Start live streaming]

Announce the URL with social media, email, etc.

LIVE STREAMING



[Blue frame indicator during live streaming]

*The blue frame indicator can be switched ON/OFF.

Stopping and ending streaming

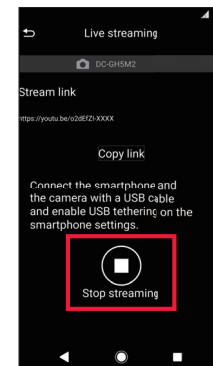

[Stop live streaming]

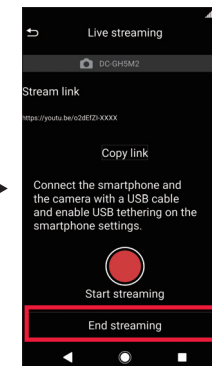

[End live streaming]

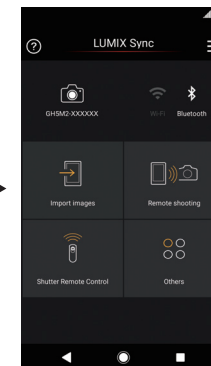

[Return to the top screen]

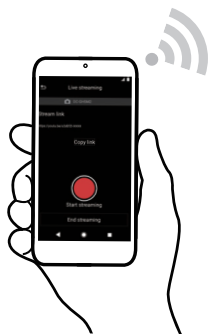

14

USB Tethering with a Smartphone

Streaming with Facebook LIVE



Setting method for live streaming using your Facebook account and Facebook LIVE.

•Facebook™ is a registered trademark of Facebook, Inc.
*Please be sure to confirm the terms of use of the platform before using the streaming service.

STEP 1

Launch LUMIX Sync and start settings

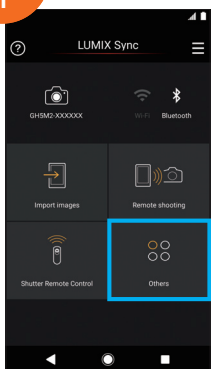

[Select "Others"]

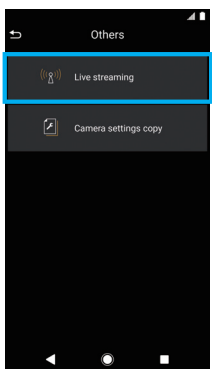

Select "Live streaming"

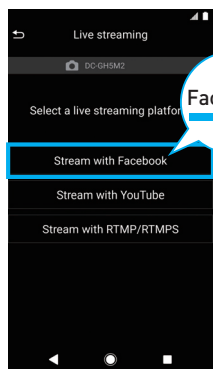

[Select "Stream with Facebook"]

STEP 2

STEP 2

Facebook account settings

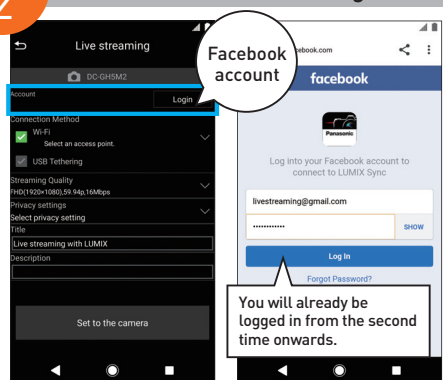

[Login to your Facebook account]

Connection method

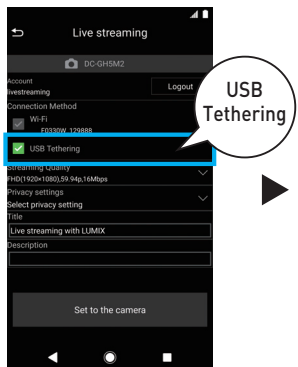

[Select "USB Tethering"]

Image quality, title and description

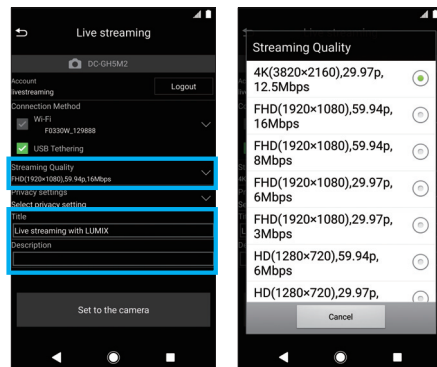

[Set the streaming quality, title and description]

Privacy settings

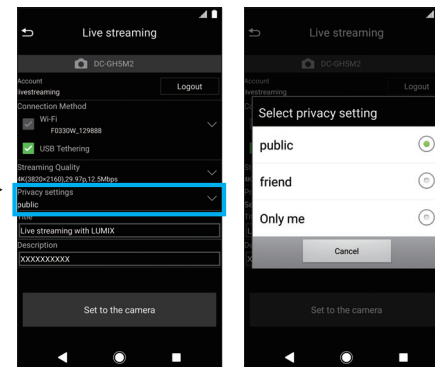

[Set the range to release the stream]

STEP 3 NEXT PAGE

Caution When streaming using the USB tethering function, a tethering service contract for your carrier is required.

! Confirm the upstream speed of the network that you are using before streaming and select the streaming quality.

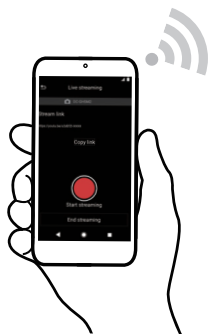

15

USB Tethering with a Smartphone

Streaming with Facebook LIVE



Setting method for live streaming using your Facebook account and Facebook LIVE.

•Facebook™ is a registered trademark of Facebook, Inc.
*Please be sure to confirm the terms of use of the platform before using the streaming service.

STEP 3

Set from LUMIX Sync to a camera

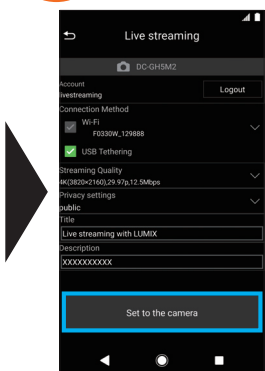

[Set to the camera]



[Turn the camera's streaming function ON]

CHECK



Creative Video Mode

STEP 4

Connect the USB cable and enable the tethering function of the smartphone before streaming

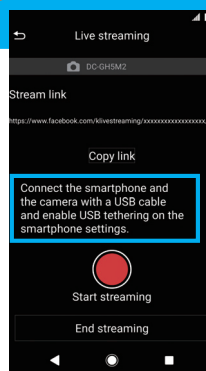

*Connect the USB after the streaming function is turned on.

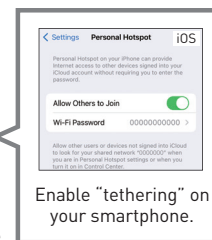

Enable "tethering" on your smartphone.

Caution When streaming using the USB tethering function, a tethering service contract for your carrier is required.

STEP 5

STEP 5

Spread the URL and start streaming

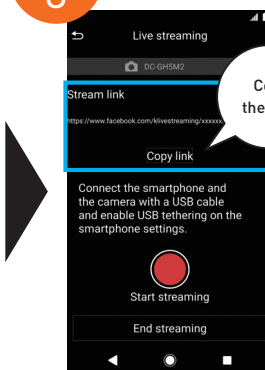

[Copy the stream URL]

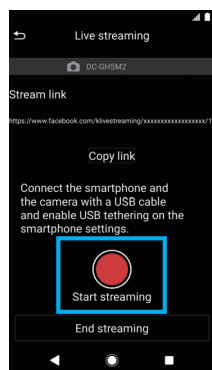

[Start live streaming]

Announce the URL with social media, email, etc.

LIVE STREAMING



[Blue frame indicator during live streaming]

*The blue frame indicator can be switched ON/OFF.

Stopping and ending streaming

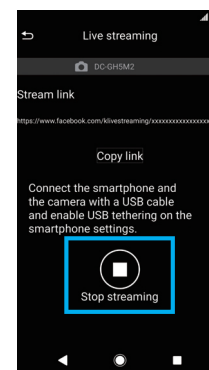

[Stop live streaming]

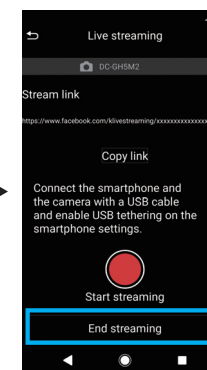

[End live streaming]

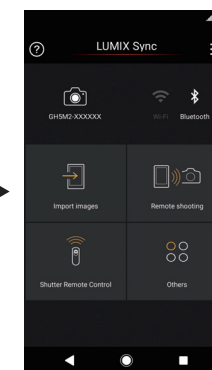

[Return to the top screen]



16

Advance Preparation Set Up Streaming on PC and Load into the Camera



Set the streaming destination with your PC and save onto an SD memory card. Insert the card into your camera and start live streaming by loading the streaming settings onto your camera.

STEP 1

Install the LUMIX Network Setting Software onto your PC



Download the software and install it onto your PC

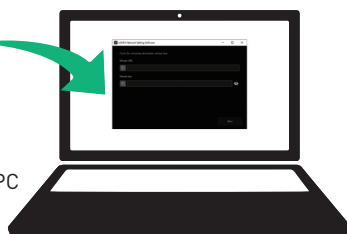

[Prepare your PC]

PC software
[LUMIX Network Setting Software]

Download site
https://av.jpn.support.panasonic.com/support/global/cs/soft/download/lumix_nss.html

Supported OS (as of April 2022)
Windows: Windows 10
Mac: macOS 10.13, 10.14, 10.15.3-10.15.7, 11.0-11.2

Insert an SD card into your PC

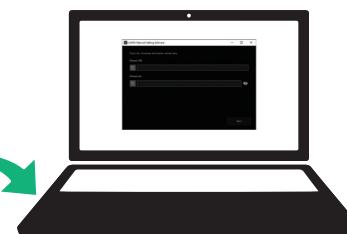

STEP 2

*Please use an SD memory card with free space.
*If your PC does not have an SD memory card slot, use an SD card reader.

STEP 2

Obtain the streaming content settings from the platform

Obtain the URL from the platform

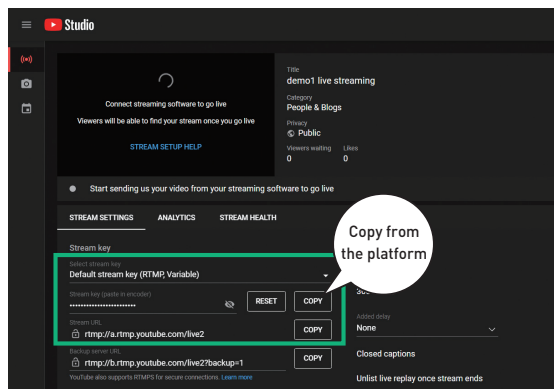

Login to your account.

Configure settings from the social streaming platform

Set the privacy settings and date and time. Set other details.

★ Copy the stream URL
★ Copy the stream key

Input to the LUMIX Network Setting Software

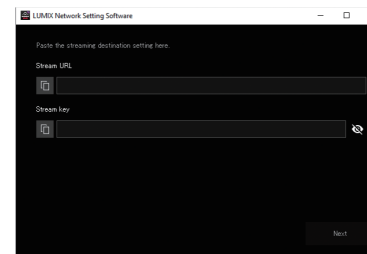

[Launch the LUMIX Network Setting Software]

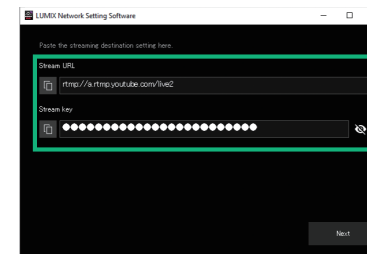

[Paste the stream URL and stream key that you copied]

STEP 3
NEXT PAGE

*Here we will be explaining using the YouTube LIVE (YouTube Studio) settings as an example.



17

Advance Preparation Set Up Streaming on PC and Load into the Camera



Set the streaming destination with your PC and save onto an SD memory card. Insert the card into your camera and start live streaming by loading the streaming settings onto your camera.

STEP 3



Export from the LUMIX Network Setting Software to the SD card

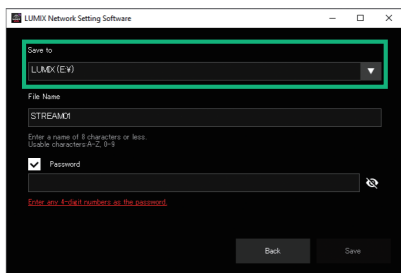

[Settings file]

STREAM01.STM

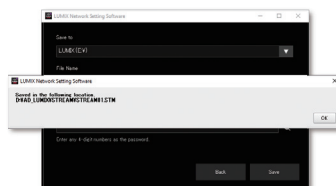

[Save to the SD memory card]

[Export the streaming destination onto the SD memory card]

- Characters that can be set in "File Name": Alphabet (uppercase), numbers, up to 8 characters.
- To prevent usage from a third party, you can secure the streaming destination with a password.
 - Put a check mark in "Password".
 - When you set a password, password input will be required when loading the streaming destination.
 - You can enter any 4-digit numbers as the password.



Insert the SD card into your camera and start settings



Creative Video Mode



STEP 4

Please update the firmware to **GH5II Ver.1.1**

STEP 4



Load the streaming destination inside the SD card to your camera

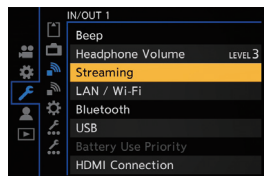

Select

[Streaming]
in the camera menu

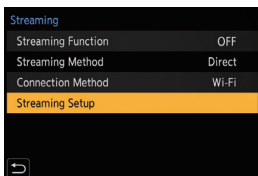

[Select "Streaming Setup"]

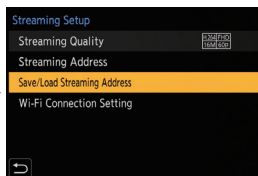

[Select "Save/Load Streaming Address"]

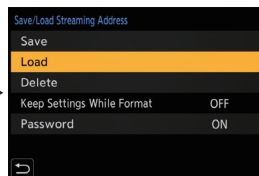

[Select "Load"]

*When a password is set, enter the password to load.



[Select card slot]

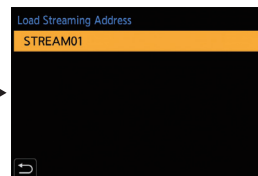

[Load the streaming destination]

STREAM01.STM

Wireless IP Streaming

18 STEP 5

USB Tethering

20 STEP 5



18

Wireless IP Streaming

Streaming Using a PC, Software and Camera



Set the streaming destination with your PC and save onto an SD memory card. Insert the card into your camera and start live streaming by loading the streaming settings onto your camera.

STEP 5



Streaming Method → Direct

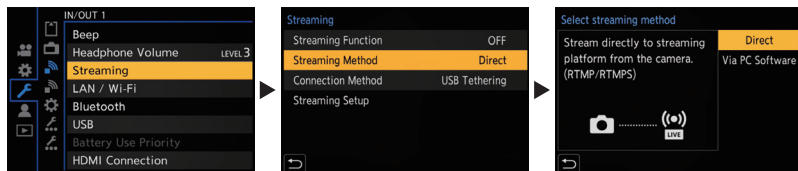

Select [→ → Streaming → Streaming Method → Direct] in the camera menu



Connection Method → Wi-Fi

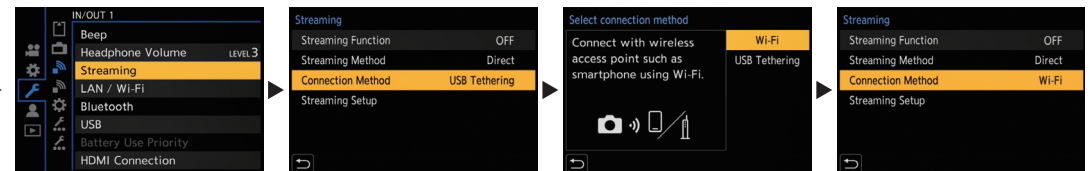

Select [→ → Streaming → Connection Method → Wi-Fi] in the camera menu

STEP 6

STEP 6



Set the image quality

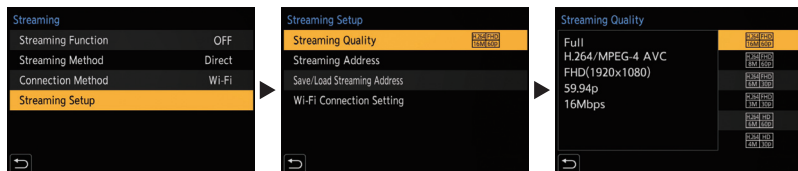

Select [→ → Streaming → Streaming Setup → Streaming Quality] in the camera menu

! Confirm the upstream speed of the network that you are using before streaming and select the streaming quality.

STEP 7

STEP 7



Set the wireless access point

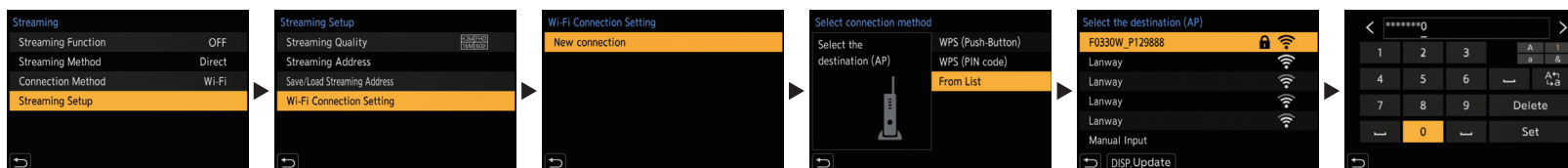

Select [→ → Streaming → Streaming Setup → Wi-Fi Connection Setting → New Connection] in the camera menu

[Select an access point (Wi-Fi), enter the password (encryption key) and connect wirelessly]

STEP 8
NEXT PAGE



19

Wireless IP Streaming

Streaming Using a PC, Software and Camera



Set the streaming destination with your PC and save onto an SD memory card. Insert the card into your camera and start live streaming by loading the streaming settings onto your camera.

STEP 8

Set the streaming function ON

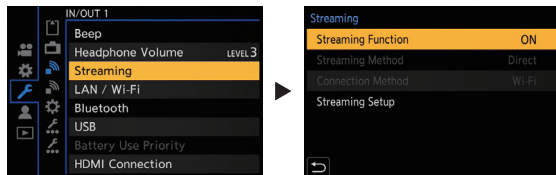

Select [→ → Streaming → Streaming Function → ON]



[Turn the camera's streaming function ON]

Enable "Tethering" on your smartphone

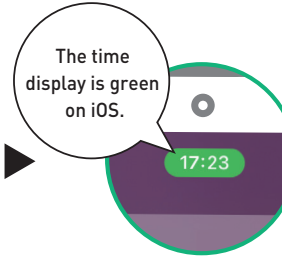
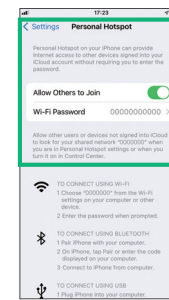

The time display is green on iOS.

*Make sure the smartphone is tethering and then start streaming.

STEP 9

STEP 9

Start streaming



[Press the shutter button or video rec button and start live streaming]



[Blue frame indicator during live streaming]

*The blue frame indicator can be switched ON/OFF.

Stopping and ending streaming



[Press the shutter button or video rec button and stop live streaming]

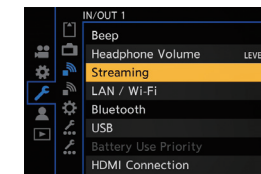

[→ → Streaming → Streaming Function →]
Select OFF to end live streaming



Try using the schedule stream!

*Here we will be explaining using the YouTube LIVE (YouTube Studio) settings on your PC as an example.

When enabled, you can automatically start streaming by starting it with your camera or LUMIX Sync. When disabled, the streaming will not start automatically with your camera or LUMIX Sync, and you must press the stream start button on the PC.

*With Facebook, press the streaming button on your PC and start.

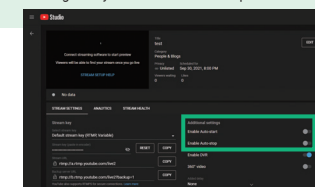

Auto-start settings

*Please be sure to confirm the terms of use of the platform before using the streaming service.



20

USB Tethering with a Smartphone

Streaming Using a PC, Software and Camera



Set the streaming destination with your PC and save onto an SD memory card. Insert the card into your camera and start live streaming by loading the streaming settings onto your camera.

**Please set up the camera without connecting the USB cable.*

STEP 5



Streaming Method → Direct

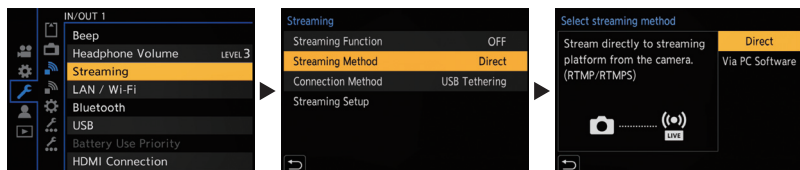

Select [→ → Streaming → Streaming Method → Direct] in the camera menu



Connection Method → USB Tethering



Select [→ → Streaming → Connection Method → USB Tethering] in the camera menu

STEP 6

STEP 6



Set the image quality

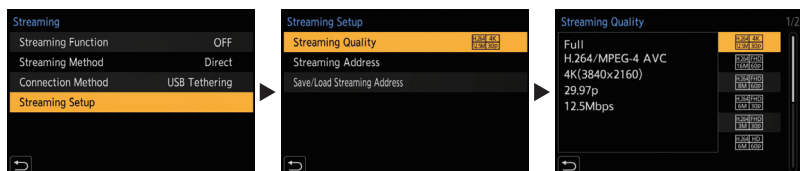

Select [→ → Streaming → Streaming Setup → Streaming Quality] in the camera menu

! Confirm the upstream speed of the network that you are using before streaming and select the streaming quality.

STEP 7

STEP 7



Streaming Function → ON

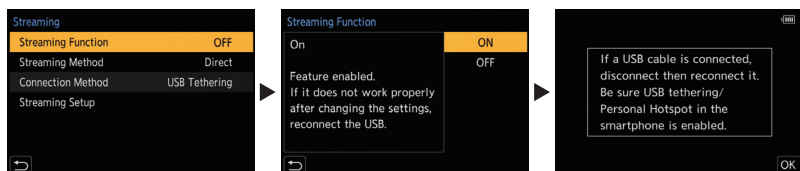

Select [→ → Streaming → Streaming Function → ON] in the camera menu



STEP 8
NEXT PAGE



21

USB Tethering with a Smartphone

Streaming Using a PC, Software and Camera



Set the streaming destination with your PC and save onto an SD memory card. Insert the card into your camera and start live streaming by loading the streaming settings onto your camera.

**Please set up the camera without connecting the USB cable.*

STEP 8

Connect the USB cable and enable the tethering function of the smartphone before streaming

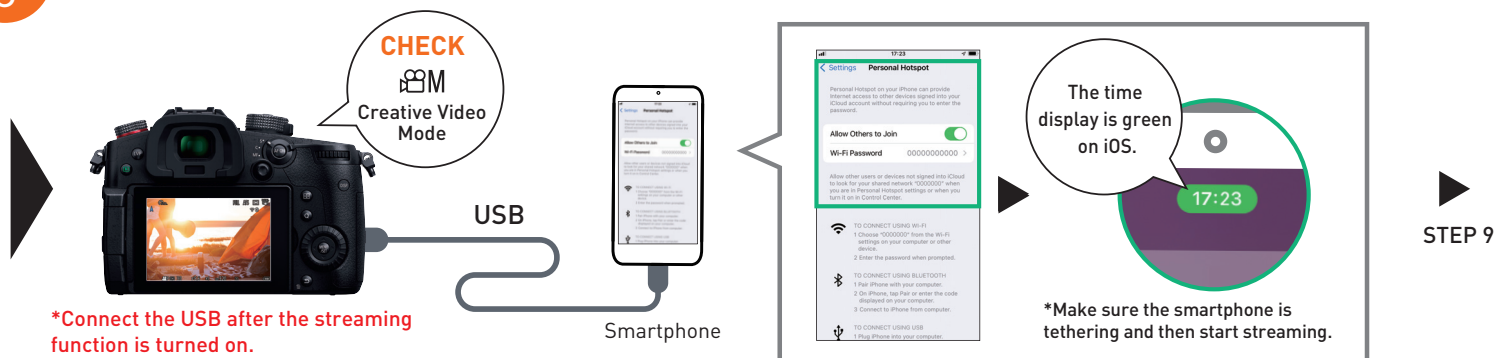

**Connect the USB after the streaming function is turned on.*

Caution When streaming using the USB tethering function, a tethering service contract for your carrier is required.

STEP 9

Start streaming

LIVE STREAMING



[Blue frame indicator during live streaming]

**The blue frame indicator can be switched ON/OFF.*

Stopping and ending streaming

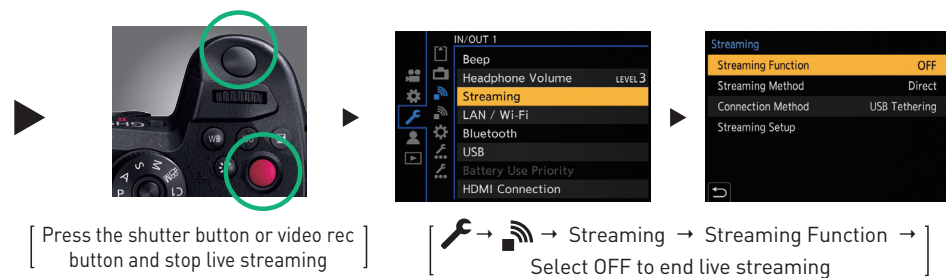

**Please be sure to confirm the terms of use of the platform before using the streaming service.*