

# ***Panasonic Broadcast***

## ***AG-HPX500 Menu Information***

# Chapter 7 Menu Operations

## Viewfinder and LCD Menus

### Using the menus

Use the setup menus to change the settings to suit the scenes you are shooting or what you are recording.

- If the thumbnail menu is displayed, press the THUMBNAIL button to release the display.
- The menu items indicated in the blue characters cannot be used.

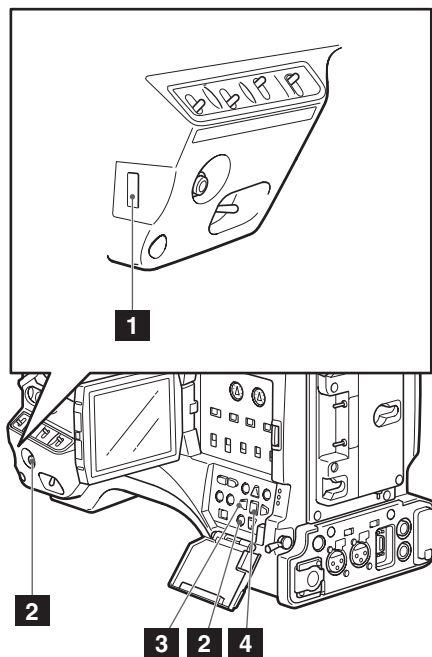

- 1 JOG dial button
- 2 MENU button
- 3 CURSOR buttons
- 4 SET button

### 1 When the unit is in other than playback or recording mode, press the MENU button.

- The function screen appears in the viewfinder and on the LCD screen.

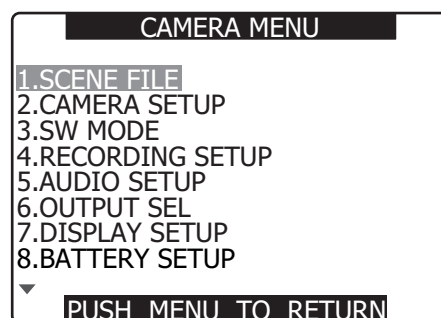

### 2 Use the JOG dial button (or the Up and Down cursor buttons) to highlight the function you want to change.

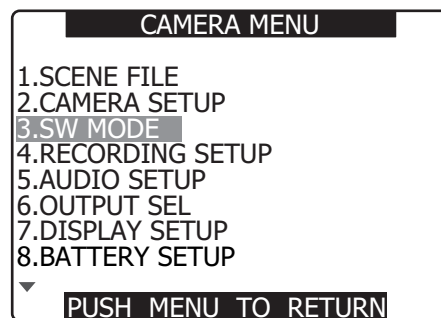

### 3 Press the JOG dial button (or the SET button) to display the items.

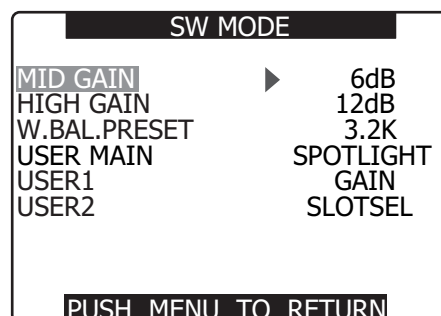

- 4** Use the JOG dial button (or the Up and Down cursor buttons) to highlight the item you want to change.

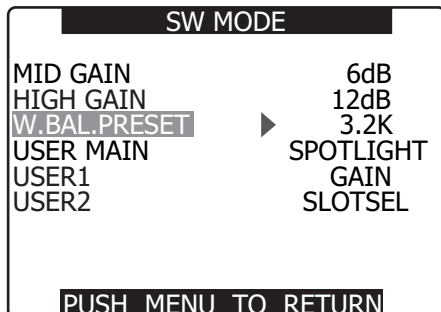

- 5** Use the JOG dial button (or the SET button) to change the setting value.

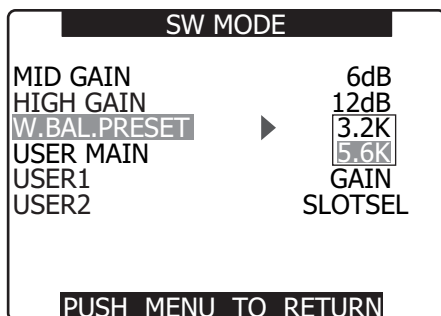

- 6** To change other settings, repeat steps 4 and 5.

- When you finish, press the MENU button to return to the function screen.

- 7** To change other functions, repeat steps 2 to 5.

- To exit the function screen and return to the normal screen, press the MENU button again.

## Initializing the menu settings

The menu settings contain both the user file settings and the scene file settings. You can initialize them separately.

### To initialize the user file (i.e. all the settings other than the scene file settings)

Select INITIAL in USER FILE of the OTHER FUNCTIONS screen. The current menu settings of user file will return to the factory settings.

### To initialize the scene file

From the 6 scene files, select the one you want to initialize with the scene dial. Then in the SCENE FILE screen, LOAD/SAVE/INIT, select INITIAL.

The settings for only the selected scene file are returned to the factory settings.

- This does not effect the other scene files.

# Setup menu structure

## Camera (CAM) mode menu

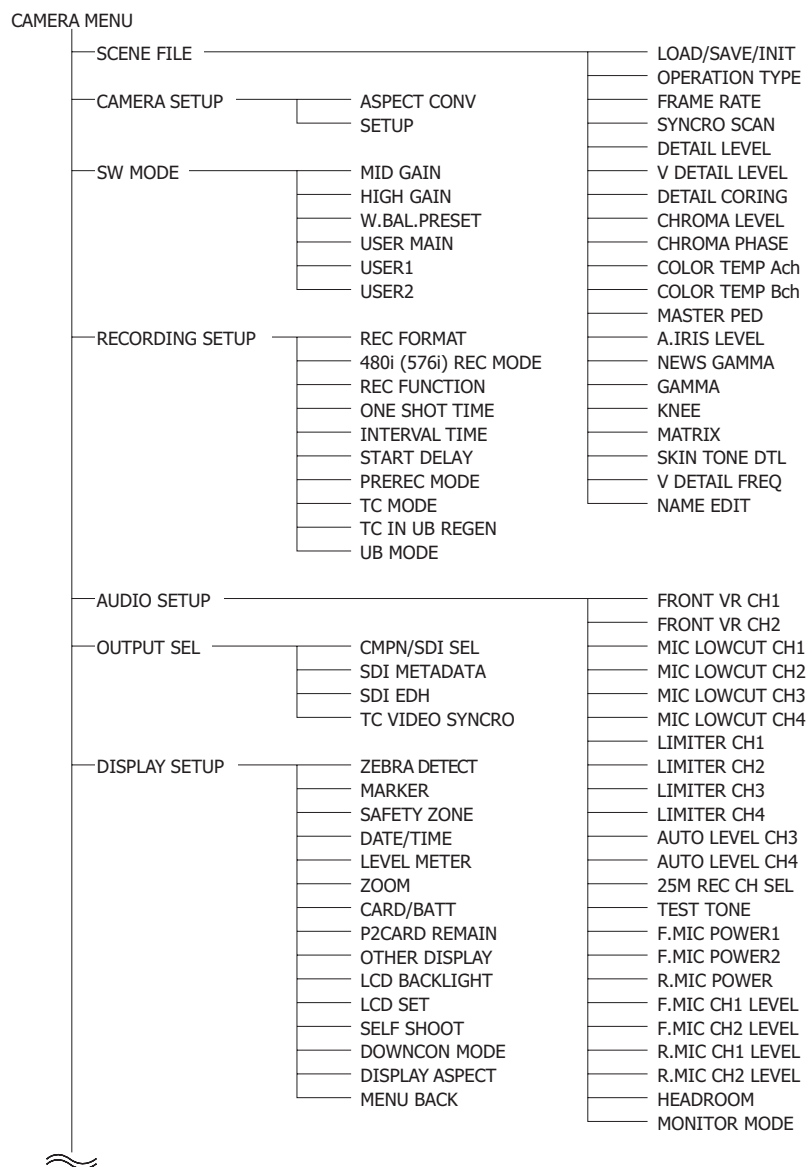

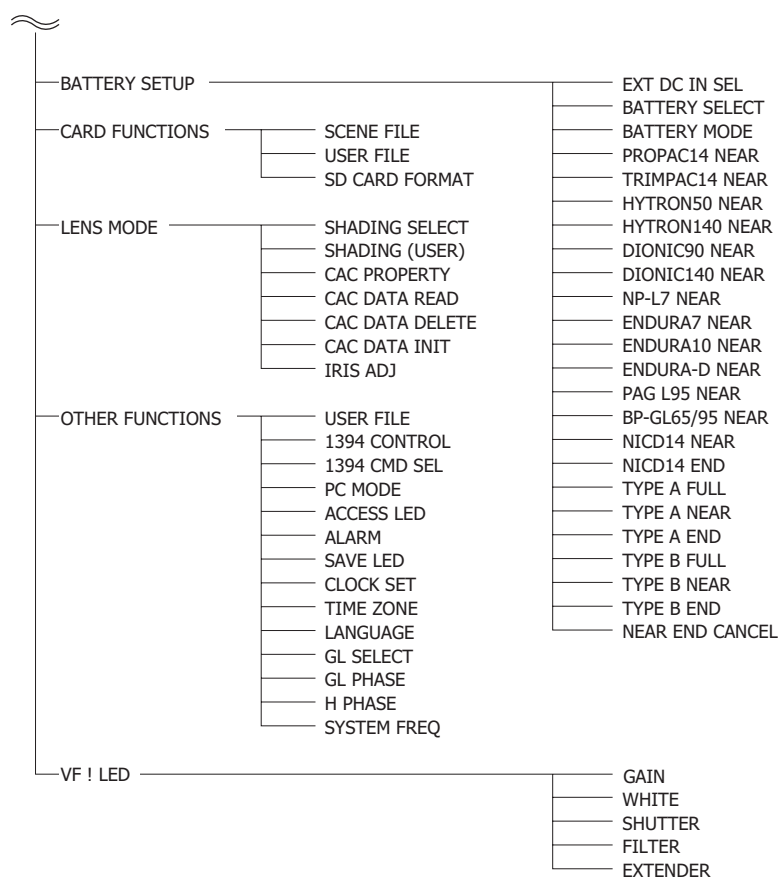

## MCR mode menu

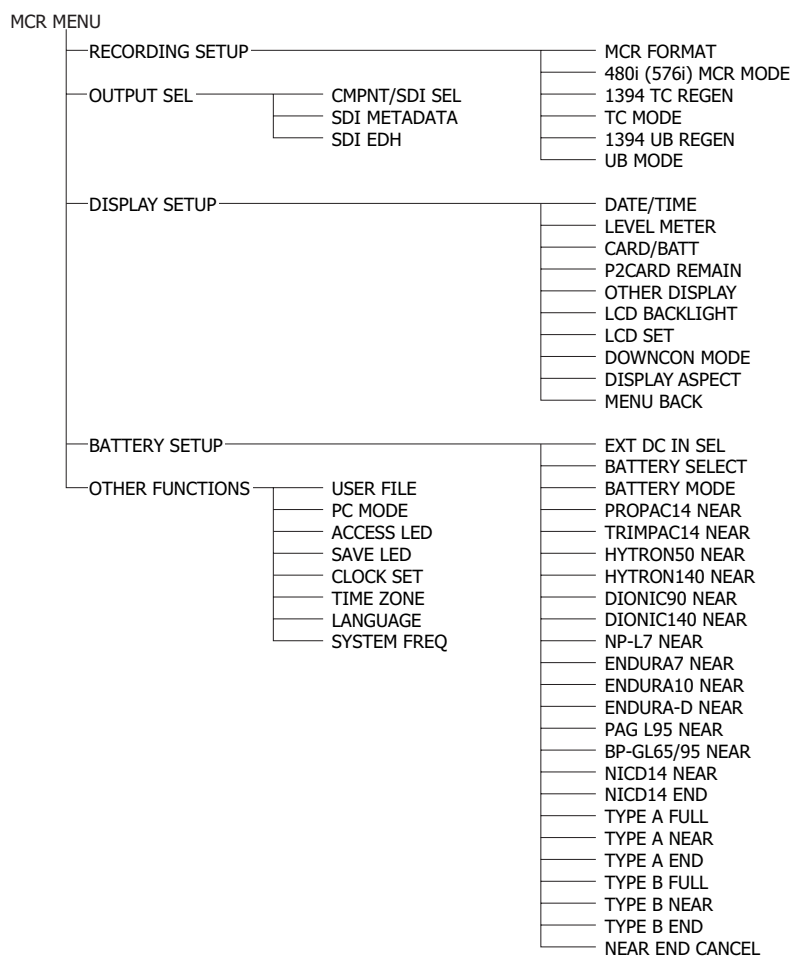

# Setup menu list

## SCENE FILE screen

Item	Description of settings (Items in bold are factory settings.)
LOAD/SAVE/INIT	Saves, loads and initializes scene files (SD memory card) ----(No operation), LOAD (Load), SAVE (Save), INITIAL (Initialize)
OPERATION TYPE	Switches the shutter and frame rate operation to the video type or film type. ● <b>VIDEO CAM: SYNCRO SCAN is set in 1/n increments./The frame rate is dependent on the REC FORMAT./Slow shutter speeds are enabled./Time code is displayed at 30 frames except at 24PN.</b> ● <b>FILM CAM: SYNCRO SCAN is displayed as an angle./ FRAME RATE can be used to vary the frame rate./Slow shutter speeds are disabled./ The time code indication is fixed at 24 hour display.</b>
FRAME RATE	Selects the shooting interval and exposure time when 720P and FILM CAM is selected. The default values for the REC FORMAT 720/60, 720/30 and 720/24 are fixed at 60P, 30P and 24P, respectively. ●59.94Hz SYSTEM <b>DEFAULT</b> , 12, 18, 20, 22, 24, 26, 30, 32, 36, 48, 60 ●50Hz SYSTEM <b>DEFAULT</b> , 12, 18, 20, 23, 25, 27, 30, 32, 37, 48, 50
SYNCRO SCAN	Adjusts the synchro scan shutter speed used for shooting images on a TV screen, etc. Turn and hold the JOG dial button (operation button) upwards or downwards to increase the speed at which the set values change. ●When VIDEO CAM is selected as the OPERATION TYPE option setting: • 60P/60i: <b>1/60.0</b> ... 1/249.8 • 30P/30PN: 1/30.1 ... <b>1/48.0</b> ... 1/249.8 • 24P/24PA/24PN: 1/24.0 ... <b>1/48.0</b> ... 1/249.8 ●When FILM CAM is selected as the OPERATION TYPE option setting: • The shutter speed is displayed as an angle such as "180.0d." • 10.0 deg ... <b>180.0 deg</b> ... 350.0 deg (the angle can be changed in increments of 0.5 degrees)
DETAIL LEVEL	Adjusts the level of the image outline correction (in the horizontal and vertical directions). ●Adjustable range: - 7 ... <b>0</b> ... + 7
V DETAIL LEVEL	Adjusts the level of outline correction in the vertical direction. ●Adjustable range: - 7 ... <b>0</b> ... + 7
DETAIL CORING	Adjusts the level of noise reduction of the detail signal. ●Adjustable range: - 2 ... <b>0</b> ... + 7 Set to - for a clearer image. Noise increases slightly. Set to + to reduce noise.
CHROMA LEVEL	Adjusts the chroma level. ●Adjustable range: - 7 ... <b>0</b> ... + 7
CHROMA PHASE	Makes fine adjustments to the chroma phase. ●Adjustable range: - 7 ... <b>0</b> ... + 7
COLOR TEMP Ach	Makes fine adjustments to the color temperature (after white balance adjustment of Ach). ●Adjustable range: - 7 ... <b>0</b> ... + 7
COLOR TEMP Bch	Makes fine adjustments to the color temperature (after white balance adjustment of Bch). ●Adjustable range: - 7 ... <b>0</b> ... + 7
MASTER PED	Adjusts the black master pedestal that serves as the video reference. ●Adjustable range: - 127 ... <b>0</b> ... + 127
A. IRIS LEVEL	Sets the desired AUTO IRIS level. ●Adjustable range: - 10 ... <b>0</b> ... + 10
NEWS GAMMA	Selects the news gamma curve. (Only valid for 1080i/60i, 50i, 720/50P, 50P, 480/60i and 576/50i) ● <b>ON, OFF</b> Setting this function to ON also turns on ADSC (adaptable shading correction).

Item	Description of settings (Items in bold are factory settings.)
GAMMA	<p>Selects the gamma curves other than the news gamma curve.</p> <ul style="list-style-type: none"> <li>●HD NORM: This gamma setting is suitable for HD shooting.</li> <li>●LOW: Makes a mellow image using the gamma curve which has a gentle incline in lowbrightness curve. The contrast sharpens.</li> <li>●SD NORM: This is the normal video setting.</li> <li>●HIGH: Expands the tone of dark parts and makes a brighter image using the gamma curve which has a sharp incline in lowbrightness curve. The contrast softens.</li> <li>●B.PRESS: Makes the contrast sharper than LOW.</li> <li>●CINELIKE_D: Makes a cinema-like image.</li> <li>●CINELIKE_V: Makes a cinema-like image with emphasized contrast.</li> </ul> <p>When you select CINE-LIKE gamma, we recommend to set the lens aperture lower than normal image level (approximately 1/2) to enjoy the full benefit of the function. (Disabled when gamma is ON.)</p>
KNEE	<p>To avoid overexposure, select the compression level (knee point) of the high intensity video signals received through CCD.</p> <ul style="list-style-type: none"> <li>●LOW: Low setting (Compression starts at approx. 80 %.)</li> <li>●MID: Medium setting (Compression starts at approx. 90 %.)</li> <li>●HIGH: High Setting (Compression starts at approx. 100 %.)</li> </ul> <p>This setting cannot be changed when GAMMA is enabled and CINELIKE_D, V are selected.</p>
MATRIX	<p>Selects the MATRIX table suitable for the desired color expression during shooting.</p> <ul style="list-style-type: none"> <li>●<b>NORM1: Suitable for shooting in the open air or under a halogen lamp.</b></li> <li>●NORM2: Suitable for brighter colors than the NORM1 mode.</li> <li>●FLUO: Suitable for shooting under fluorescent light indoors.</li> <li>●CINE-LIKE: Suitable for cinema-like image.</li> </ul>
SKIN TONE DTL	<p>Sets the skin tone details. Select ON to reduce the skin tone details and soften the skin tone.</p> <p>●ON, <b>OFF</b></p>
V DETAIL FREQ	<p>Sets the vertical detail for shooting in 480 24P, 24PA, 30P 576/25P mode.</p> <ul style="list-style-type: none"> <li>●<b>THIN: Makes the detail thin.</b></li> <li>●MID: Makes the detail slightly thicker.</li> <li>●THICK: Makes the detail thicker.</li> </ul> <p>When images were shot in the progressive mode in which the vertical detail is set as "THIN" or "MID" and are played on a monitoring television (60i interlace), you will see flickers caused on horizontal lines and almost horizontal oblique lines. When playing back images in the progressive mode or when editing images or performing other postprocessing, images with a higher resolution will be obtained with the THIN or MID setting than with the THICK setting.</p>
NAME EDIT	Edits the name of the selected scene file you have selected with the scene file dial.

## CAMERA SETUP screen

Item	Description of settings (Items in bold are factory settings.)
ASPECT CONV	<p>Selects the aspect ratio of the image you record in 480i format. This item cannot be selected when the 1080i or 720P recording format is used.</p> <p>●<b>SIDE-CROP (Side crop), LETTER BOX, SQUEEZE</b></p>
SETUP	<p>Selects the setup level for the 480i video signal.</p> <ul style="list-style-type: none"> <li>●0 %: Setup is switched to 0 % for both camera output and recording.</li> <li>●<b>7.5 %A: Setup is switched to 7.5 % for camera output and 0 % for recording.</b></li> </ul>

## SW MODE screen

Item	Description of settings (Items in bold are factory settings.)
MID GAIN	Sets the gain value assigned to the M position of the GAIN switch. ●0 dB, 3 dB, <b>6 dB</b> , 9 dB, 12 dB
HIGH GAIN	Sets the gain value assigned to the H position of the GAIN switch. ●0 dB, 3 dB, 6 dB, 9 dB, <b>12 dB</b>
W.BAL.PRESET	Sets the color temperature assigned to the PRST position of the WHITE BAL switch. ●3.2 K / 5.6 K
USER MAIN	<p>Selects the function assigned to the USER MAIN button.</p> <ul style="list-style-type: none"> <li>●REC CHECK: Performs Rec Check.</li> <li>●SPOTLIGHT: Auto iris control for the spotlight ON/OFF</li> <li>●BACKLIGHT: Auto iris control for the backlight compensation</li> <li>●BLACKFADE: Blackfade</li> <li>●WHITEFADE: Whitefade</li> <li>●GAIN: 18 dB: <ul style="list-style-type: none"> <li>• Press the button to set the gain value to 18 dB. This setting takes effect with the 60i and 60P recording formats only. It is not valid when the recording frame rate is less than 22 fps or when the slow shutter mode (1/15) is established.</li> <li>• When the gain value is set to 18 dB or set from 18 dB to another value, the image can be disordered for a moment.</li> <li>• If the unit is being used in the MANUAL mode or AUTO mode, set the AGC item on the AUTO SW screen of the setting menu to OFF to use this function.</li> </ul> </li> <li>●TEXT MEMO: Text memo recording</li> <li>●SLOT SEL: Selects one of the P2 card slots.</li> <li>●<b>SHOT MARK: Shot mark recording</b></li> <li>●LEV METER: Displays the level for channels other than those set in the menu.</li> <li>●MARKER: Displays markers.</li> <li>●LCD REV: Displays an upside down and reversed image on the LCD.</li> </ul>
USER1	Selects the function assigned to the USER1 button. The settings are the same as USER MAIN above.
USER2	Selects the function assigned to the USER2 button. The settings are the same as USER MAIN above.



## RECORDING SETUP screen

Item	Description of settings (Items in bold are factory settings.)
REC FORMAT	Selects the recording format for P2 card. ●59.94Hz System: 1080i/60i, 1080i/30P, 1080i/24P, 1080i/24PA, 720P/60P, 720P/30P, 720P/24P, 720P/30PN, 720P/24PN, 480i/60i, 480i/30P, 480i/24P, 480i/24PA ●50 Hz System: <b>1080i/50i</b> , 1080i/25P, 720P/50P, 720P/25P, 720P/25PN, 576i/50i, 576i/25P
480i (576i) REC MODE	Selects the 480i (576i) recording mode. ● <b>DVCPRO50</b> /DVCPRO DV
REC FUNCTION	Selects the special recording mode. ● <b>NORMAL</b> , INTERVAL, ONE SHOT, LOOP
ONE SHOT TIME	Selects the one-shot recording time. ● <b>1F</b> , 2F, 4F, 8F, 16F, 1s
INTERVAL TIME	Sets the interval time (INT) for interval recording (INTERVAL REC). ● <b>2F</b> , 4F, 8F, 16F, 1s, 2s, 5s, 10s, 30s, 1m, 5m, 10m
START DELAY	Sets the START delay time for INTERVAL REC and ONE SHOT REC.
PREREC MODE	Sets PRE RECORDING to ON or OFF. (Fixed to 3 seconds for HD and 7 seconds for SD) ● <b>ON</b> , <b>OFF</b>
TC MODE	Selects the time code correction mode when recording the time code output by the internal time code generator. ● <b>DF</b> : Uses the drop frame mode. ● <b>NDF</b> : Uses the non-drop frame mode. The non-drop frame mode is used when a frame rate of 24P, 24PA, or 24PN is selected in a recording format regardless of TC MODE setting.
TC IN UB REGEN	Selects the user bits to be recorded when recording signals from a device connected to the TC IN connector. ● <b>ON</b> : Records the user bits of the signal input to the TC IN connector. ● <b>OFF</b> : Records the user bits selected in the menu option UB MODE. • Setting this option to ON prioritizes the input signal over the settings made in the menu option UB MODE. • No user bits are recorded when the input signal does not contain any user bits. • Settings of the menu option UB MODE are used when no signal is input to the TC IN connector.
UB MODE	Set the content for user information. ● <b>USER</b> : Records the information of user. ● <b>TIME</b> : Records the time at recording. ● <b>DATE</b> : Records the date at recording. ● <b>TCG</b> : Records the values of the time code generator. ● <b>FRM. RATE</b> : Records the frame rate information for frame conversion.  * * 0 * * * * *                   a   b   c   d a: Checking information for user information b: Frame sequence No. • 0 to 4 are displayed in 24P/24P (ADV) mode. • F is displayed in 60i/30P mode. c: Frame rates • Frame rate (60/30/24) • I/P ID • Conversion data • Frame rate coefficient d: Recording management data • Frame update information • REC START/STOP information

## AUDIO SETUP screen

Item	Description of settings (Items in bold are factory settings.)
FRONT VR CH1	Selects the function of the F. AUDIO LEVEL control of CH1 input. ●FRONT: The F. AUDIO LEVEL control controls FRONT1 input. ●REAR: The F. AUDIO LEVEL control controls REAR1 input. ●ALL: The F. AUDIO LEVEL control controls both FRONT1 and REAR1 inputs. ●OFF: <b>The F. AUDIO LEVEL control does not control the input signal.</b> This control is disabled when the AUDIO SELECT CH1 switch is set to AUTO.
FRONT VR CH2	Selects the function of the F. AUDIO LEVEL control of CH2 input. ●FRONT: The F. AUDIO LEVEL control controls FRONT2 input. ●REAR: The F. AUDIO LEVEL control controls REAR2 input. ●ALL: The F. AUDIO LEVEL control controls both FRONT2 and REAR2 inputs. ●OFF: <b>The F. AUDIO LEVEL control does not control the input signal.</b> This control is disabled when the AUDIO SELECT CH2 switch is set to AUTO.
MIC LOWCUT CH1	Turns on and off the CH1 microphone lowcut filter. ●ON, <b>OFF</b>
MIC LOWCUT CH2	Turns on and off the CH2 microphone lowcut filter. ●ON, <b>OFF</b>
MIC LOWCUT CH3	Turns on and off the CH3 microphone lowcut filter. ●ON, <b>OFF</b>
MIC LOWCUT CH4	Turns on and off the CH4 microphone lowcut filter. ●ON, <b>OFF</b>
LIMITER CH1	Turns on and off the CH1 limiter. ●ON, <b>OFF</b>
LIMITER CH2	Turns on and off the CH2 limiter. ●ON, <b>OFF</b>
LIMITER CH3	Turns on and off the CH3 limiter. ●ON, <b>OFF</b>
LIMITER CH4	Turns on and off the CH4 limiter. ●ON, <b>OFF</b>
AUTO LEVEL CH3	Selects the method for selecting CH3 level. ●ON: Automatically controls CH3 level. ●OFF: <b>Enables dial control of CH3 level via dial.</b>
AUTO LEVEL CH4	Selects the method for selecting CH4 level. ●ON: Automatically controls CH4 level. ●OFF: <b>Enables dial control of CH4 level via dial.</b>
25M REC CH SEL	Selects the audio channels to be recorded in the DVCPRO and DV formats. ●2CH: <b>Only recorded on CH1 and CH2.</b> ●4CH: Recorded on channels 1 to 4.
TEST TONE	Selects the test signal. ●OFF: Disables test tone output. ●NORMAL: <b>Outputs test tones to channels 1, 2, 3 and 4 when the OUTPUT/AUTO KNEE selector switch is set to BARS and the AUDIO IN switch CH1 is set to FRONT.</b> ●ALWAYS: Outputs test tones to channels 1, 2, 3 and 4 when the OUTPUT/AUTO KNEE selector switch is set to BARS. ●CHSEL: Outputs test tones to channels where the AUDIO IN switch CH1 or CH2 is set to FRONT with the OUTPUT/AUTO KNEE selector switch set to BARS.
F.MIC POWER1	Turns on and off the phantom power supply for the front microphone connected to CH1. ●ON, <b>OFF</b>
F.MIC POWER2	Turns on and off the phantom power supply for the front microphone connected to CH2. ●ON, <b>OFF</b>
R.MIC POWER	Turns on and off the phantom power supply for the rear microphone. ●ON, <b>OFF</b>
F.MIC CH1 LEVEL	Selects the input level for the front microphone connected to CH1. ●-40 dB, <b>-50 dB</b> , -60 dB
F.MIC CH2 LEVEL	Selects the input level for the front microphone connected to CH2. ●-40 dB, <b>-50 dB</b> , -60 dB
R.MIC CH1 LEVEL	Selects the input level for the rear microphone connected to CH1. ●-50 dB, <b>-60 dB</b>
R.MIC CH2 LEVEL	Selects the input level for the rear microphone connected to CH2. ●-50 dB, <b>-60 dB</b>
HEADROOM	Sets the headroom (standard level). ●59.94Hz System: 18 dB, <b>20 dB</b> ●50 Hz System: 18 dB, <b>20 dB</b>
MONITOR MODE	Switches speaker and headphone audio delay. ●LIVE: No audio delay ●RECORDING: <b>Recorded (delayed) audio</b>

## OUTUT SEL screen

Item	Description of settings (Items in bold are factory settings.)
CMPNT/SDI SEL	Selects D or SDI connector. ●59.94Hz system: <b>720P</b> , 1080i, 480i ●50 Hz system: <b>720P</b> , 1080i, 576i
SDI METADATA	Turns on and off metadata superimposition onto the HS-SDI signal. ● <b>ON</b> , OFF
SDI EDH	Turns on and off EDH superimposition onto the SD-SDI signal. ● <b>ON</b> , OFF
TC VIDEO SYNCRO	Selects whether to delay time code output. ● <b>TC IN: Outputs the input from the TC IN connector without delay.</b> ● <b>VIDEO:</b> Outputs the time code with delay according to the output video.

## DISPLAY SETUP screen

Item	Description of settings (Items in bold are factory settings.)
ZEBRA DETECT	Selects the brightness level of the leftleaning zebra patterns on the screen. ●50 %, 55 %, 60 %, 65 %, 70 %, 75 %, <b>80 %</b> , 85 %, 90 %, 95 %, 100 %, 105 %
MARKER	Select ON to display the marker. ● <b>ON</b> , OFF To display the marker.
SAFETY ZONE	Sets SAFETY ZONE. ●OFF, <b>90 %</b> , 4:3
DATE/TIME	Sets whether to display the date and time on the screen and whether to output from the VIDEO IN/OUT jack. ● <b>OFF: The date and time are not displayed.</b> ● <b>TIME:</b> The time is displayed. ● <b>DATE:</b> The date is displayed. ● <b>TIME&amp;DATE:</b> The time and date are displayed.
LEVEL METER	Select ON to display the audio level meter. ● <b>ON</b> , OFF
ZOOM	Turns zoom value display on and off. ● <b>ON</b> , OFF Displays zoom values between Z00 to Z99.
CARD/BATT	Turns on and off card and battery remaining level. ● <b>ON</b> , OFF
P2CARD REMAIN	Switches the indication of remaining P2 memory card capacity. ● <b>TOTAL: Indicates total remaining capacity of all cards.</b> ● <b>ONE CARD:</b> Indicates the remaining capacity of the card that is being recorded.
OTHER DISPLAY	Select how much information to display on the screen. ●OFF, <b>PARTIAL</b> , ALL
LCD BACKLIGHT	Adjusts the backlight of the LCD monitor. Select HIGH for brighter backlight. ●HIGH, <b>NORMAL</b>
LCD SET	Adjusts the display level of the images on the LCD monitor. ● <b>LCD COLOR LEVEL, LCD BRIGHTNESS, LCD CONTRAST</b> Select to set respective value using the right and left cursor keys.
SELF SHOOT	Selects the LCD mirror mode for self-portrait shooting. Select MIRROR to reverse left and right at self-portrait shooting. ● <b>NORMAL, MIRROR</b>
DOWNCON MODE	Switches down-conversion output mode. ● <b>SIDE-CROP:</b> Side-crop mode ● <b>LETTER-BOX: Letter-box mode</b> ● <b>SQUEEZE:</b> Squeeze mode
DISPLAY ASPECT	Selects the aspect ratio of the LCD monitor and the viewfinder. ● <b>AUTO: Changes automatically to the appropriate ratio according to the recording or play mode information.</b> ●4:3: Fixed at 4:3. Black bands appear at the top and bottom of the screen when images are displayed at a 16:9 aspect ratio. No parts of the images are missing.
MENU BACK	Selects whether to lower the transparency of the background to make menu text easier to read. ● <b>ON: Lowers background transparency. This function is not available for synchro scan and LCD SET pages.</b> ●OFF: Sets a background transparency of 100%.

## BATTERY SETUP screen

Item	Description of settings (Items in bold are factory settings.)
EXT DC IN SEL	Selects external DC power supply type. ● <b>AC ADAPTER: AC adapter</b> ●BATTERY: battery
BATTERY SELECT	Selects battery type. ●PROPAC14, TRIMPAC14, HYTRON50, HYTRON140, <b>DIONIC90</b> , DIONIC140, NP-L7, ENDURA7, ENDURA10, ENDURA-D, PAG L95, BP-GL65/95, NICD14, TYPE A, TYPE B
BATTERY MODE	Near end setting ● <b>AUTO: Automatically sets one of the following battery types.</b> PROPAC14, TRIMPAC14, HYTRON50, HYTRON140, DIONIC90, DIONIC140, NP-L7, ENDURA7, ENDURA10, ENDURA-D, PAG L95, BP-GL65/95 ●MANUAL: Manually enter near end voltage for battery types other than those listed above.
PROPAC14 NEAR	Sets near end voltage for PROPAC14 • Adjustable in 0.1 V units.
TRIMPAC14NEAR	Sets near end voltage for TRIMPAC14 • Adjustable in 0.1 V units.
HYTRON50 NEAR	Sets near end voltage for HYTRON50 • Adjustable in 0.1 V units.
HYTRON140 NEAR	Sets near end voltage for HYTRON140 • Adjustable in 0.1 V units.
DIONIC90 NEAR	Sets near end voltage for DIONIC90 • Adjustable in 0.1 V units.
DIONIC160 NEAR	Sets near end voltage for DIONIC160 • Adjustable in 0.1 V units.
NP-L7 NEAR	Sets near end voltage for NP-L7 • Adjustable in 0.1 V units.
ENDURA7 NEAR	Sets near end voltage for ENDURA7 • Adjustable in 0.1 V units.
ENDURA10 NEAR	Sets near end voltage for ENDURA10 • Adjustable in 0.1 V units.
ENDURA-D NEAR	Sets near end voltage for ENDURA-D • Adjustable in 0.1 V units.
PAGL95 NEAR	Sets near end voltage for PAG L95 • Adjustable in 0.1 V units.
BP-L65/95 NEAR	Sets near end voltage for BP-GL65/95 • Adjustable in 0.1 V units.
NICD14 NEAR	Sets near end voltage for NICD14 • Adjustable in 0.1 V units.
NICD14 END	Sets end voltage for NICD14 • Adjustable in 0.1 V units.
TYPEA FULL	Sets full voltage for TYPE A • Adjustable in 0.1 V units.
TYPEA NEAR	Sets near end voltage for TYPE A • Adjustable in 0.1 V units.
TYPEA END	Sets end voltage for TYPE A • Adjustable in 0.1 V units.
TYPEB FULL	Sets full voltage for TYPE B • Adjustable in 0.1 V units.
TYPEB NEAR	Sets near end voltage for TYPE B • Adjustable in 0.1 V units.
TYPEB END	Sets end voltage for TYPE B • Adjustable in 0.1 V units.
NEAR END CANCEL	Selects whether to cancel battery near end warning or not.

## CARD FUNCTIONS screen

Item	Description of settings
SCENE FILE	Reads/writes a scene file from/onto the SD memory card. ●READ: Loads the selected scene file (F1 to F6) values from an SD memory card. ●WRITE: Saves the current scene file (F1 to F6) settings to the SD memory card.
USER FILE	Reads/writes user files (files other than scene files) from/onto the SD memory card. ●READ: Loads the user file settings from an SD memory card. ●WRITE: Saves the current user file settings to the SD memory card.
SD CARD FORMAT	Formats the SD memory cards or not. ●----: Does not format. ●YES: Format.

## LENS SETUP screen

Item	Description of settings (Items in bold are factory settings.)
SHADING SELECT	Selects one of the following shading compensation parameters. ● <b>DEFAULT: Standard lens setting</b> ●USER1: User setting 1 ●USER2: User setting 2 ●USER3: User setting 3 ●OFF: Sets shading compensation to OFF.
SHADING (USER)	Selects whether to set shading parameters to SHADING SELECT USER1, 2, and 3 or not. ●----: Off ●YES: On This item is disabled when SHADING SELECT is set to DEFAULT or OFF.
CAC PROPERTY	Selects whether to indicate the currently selected chromatic aberration correction data or not. ●----: Off ●YES: On
CAC DATA READ	Selects whether to load chromatic aberration correction data from the SD card or not. ●----: Off ●YES: On
CAC DATA DELETE	Selects whether to display a list of chromatic aberration data loaded in the camera and to delete the selected item. ●----: Off ●YES: On
CAC DATA INIT	Returns the chromatic aberration data to its factory default setting. ●----: Off ●YES: On
IRIS ADJ	Forcibly sets the iris. ● <b>OFF: Sets the iris automatically.</b> / F 2.8 / F 16

## OTHER FUNCTIONS screen

Item	Description of settings (Items in bold are factory settings.)
USER FILE	<p>Saves users files on, loads users files from the storage area of the camera (EEPROM), and initializes the storage area.</p> <ul style="list-style-type: none"> <li>●----: Off (no operation)</li> <li>●LOAD: Loads the settings in a user file previously stored on the storage area.</li> <li>●SAVE: Saves the user file updated settings on the storage area.</li> <li>●INITIAL: Returns the user settings in the user file to their factory defaults.</li> </ul> <p>• After a LOAD or INITIAL operation, turn the POWER switch off and then back on again to make the new settings available.</p> <p>• An INITIAL operation does not change the setting of the menu option TIME ZONE.</p>
1394CONTROL	<p>Sets the control method for backup recording using a backup unit connected to the 1394 terminal.</p> <ul style="list-style-type: none"> <li>●OFF: <b>The backup unit is not controlled.</b></li> <li>●EXT: The backup unit can be controlled by the START/STOP button. The images shot by the camera recorder are recorded by the backup unit. Note that the camera recorder does not record them.</li> <li>●BOTH: The images shot by the camera recorder are recorded by both the camera recorder and backup unit.</li> <li>●CHAIN: When the camera recorder's media approaches its end during shooting, the backup unit in the recording standby mode automatically starts recording images.</li> </ul>
1394CMD SEL	<p>Sets how the START/STOP button works for the backup unit.</p> <ul style="list-style-type: none"> <li>●REC_P: <b>This switches between recording and pause.</b></li> <li>●STOP: This switches between recording and stop.</li> </ul> <p>If the backup unit does not have a rec pause function, select STOP.</p>
PC MODE	<p>Selects the terminal for data transfer. (You cannot select USB and 1394 at the same time.)</p> <ul style="list-style-type: none"> <li>●USB DEVICE: Mode for sending files using the USB connector.</li> <li>●1394 DEVICE: <b>Mode for sending files using the 1394 connector.</b></li> <li>●1394 HOST: Mode for copying files from the P2 card onto an external hard disk drive using the 1394 connector.</li> </ul>
ACCESS LED	<p>Enables or disables the access LED. The L-SIDE is the left side as seen from the lens (the P2 card slot side).</p> <ul style="list-style-type: none"> <li>●OFF L-SIDE: OFF R-SIDE: OFF</li> <li>●SLOT SIDE L-SIDE: ON R-SIDE: OFF</li> <li>●LCD SIDE L-SIDE: OFF R-SIDE: ON</li> <li>●BOTH L-SIDE: ON R-SIDE: OFF</li> </ul>
ALARM	<p>Turns the alarm function on and off.</p> <ul style="list-style-type: none"> <li>●ON, OFF</li> </ul>
SAVE LED	<p>Sets the SAVE lamp operation.</p> <ul style="list-style-type: none"> <li>●SAVE: <b>Lights when the SAVE/STBY switch is set to SAVE. Off during recording.</b></li> <li>●P2CARD: Blinks when a warning message appears to indicate that there is little space left on a P2 card.</li> </ul>
CLOCK SET	Sets the camera-recorder's calendar.
TIME ZONE	<p>Adds to or deducts from GMT the time value of -12:00 to +13:00 in 30-minute steps. (As an exception, you can set +12:45.) (Page XX)</p> <ul style="list-style-type: none"> <li>●+9:00</li> </ul>
LANGUAGE	<p>Sets the Menu language.</p> <ul style="list-style-type: none"> <li>●ENGLISH</li> <li>●JAPANESE</li> <li>●CHINESE</li> </ul>
GL SELECT	<p>Determines which signal to lock on to.</p> <ul style="list-style-type: none"> <li>●SDI, COMPOSITE, COMPONENT</li> </ul>
GL PHASE	<p>Determines whether to perform a 90H shift (ON) or not (OFF).</p> <ul style="list-style-type: none"> <li>●ON, OFF</li> </ul>
H PHASE	<p>Adjusts the phase.</p> <ul style="list-style-type: none"> <li>●-511 ~ 0 ~ +511</li> </ul>
SYSTEM FREQ	<p>Switches between NTSC and PAL.</p> <ul style="list-style-type: none"> <li>●59.94 Hz, 50 Hz</li> </ul>

## VF! LED screen

Item	Description of settings (Items in bold are factory settings.)
GAIN	Sets the conditions (gain value) for lighting the “!” symbol LED in the viewfinder. ●w/o0 dB: <b>other than 0 dB</b> ●OFF: Off
WHITE	Sets the conditions (white balance value) for lighting the “!” symbol LED in the viewfinder. ●PRE: Preset ●OFF: <b>Off</b>
SHUTTER	Sets the conditions (shutter status) for lighting the “!” symbol LED in the viewfinder. ●ON, OFF
FILTER	Sets the conditions (filter status) for lighting the “!” symbol LED in the viewfinder. ●NG: Abnormal ●No1: No1 ●w/o No1: other than No 1 ●OFF: <b>Off</b>
EXTENDER	Sets the conditions (extender status) for lighting the “!” symbol LED in the viewfinder. ●ON, OFF