

Operating Instructions LED TV

VIERA

32-inch model



40-inch model



49-inch model



English

Thank you for purchasing this Panasonic product.
Please read these instructions carefully before operating
this product and retain them for future reference.

The images shown in this manual are for illustrative
purposes only.
Some illustrations are presented as conceptual images
and may be different from the actual products.
Illustrations shown may be different between models
and countries.

**The illustrations for 49-inch model is used in this
manual unless otherwise mentioned.**

Transport only in upright position

EEA



TQB4GC1473



Manufactured under license from Dolby Laboratories. Dolby and the double-D symbol are trademarks of Dolby Laboratories.

HDMI, the HDMI Logo, and High-Definition Multimedia Interface are trademarks or registered trademarks of HDMI Licensing LLC in the United States and other countries.

This product is licensed under the AVC patent portfolio license for the personal and non-commercial use of a consumer to (i) encode video in compliance with the AVC Standard ("AVC Video") and/or (ii) decode AVC Video that was encoded by a consumer engaged in a personal and non-commercial activity and/or was obtained from a video provider licensed to provide AVC Video. No license is granted or shall be implied for any other use.

Additional information may be obtained from MPEG LA, LLC.

See <http://www.mpegla.com>.

Panasonic does not guarantee operation and performance of peripheral devices made by other manufacturers; and we disclaim any liability or damage arising from operation and/or performance from usage of such other maker's peripheral devices.



This mark shows that the construction of the product is double-insulated.



This mark indicates the product operates under AC voltage.

Even if no special notation has been made of company or product trademarks, these trademarks have been fully respected.

Contents

Safety Precautions	3
Setting Up the TV	4
Connecting the TV	7
Initial Setup	8
Operating the TV	9
Using TV Guide / Freeview Guide	10
Watching External Inputs	11
Using Media Player	11
Using the Menu Functions	13
Additional Information	18
Troubleshooting	20
Maintenance	21
Specifications	21
Warranty (Australia)	23
Warranty (New Zealand)	24

Safety Precautions

To help avoid risk of electrical shock, fire, damage or injury, please follow the warnings and cautions below:

■ Mains plug and lead

Warning

If you detect anything unusual, immediately remove the mains plug.

- Mains plug types vary between countries.



- This TV is designed to operate on AC $\sim 220 - 240$ V, 50/60 Hz
- Insert the mains plug fully into the mains socket.
- To turn Off the apparatus completely, you must pull the mains plug out of the mains socket. Consequently, the mains plug should be easily accessible at all times.
- Disconnect the mains plug when cleaning the TV.
- Do not touch the mains plug with wet hands.



- Do not damage the mains lead.
 - Do not place a heavy object on the lead.



- Do not place the lead near a high temperature object.



- Do not pull on the lead. Hold onto the mains plug body when disconnecting the plug.



- Do not move the TV with the lead plugged into a mains socket.
- Do not twist the lead, bend it excessively or stretch it.
- Do not use a damaged mains plug or mains socket.
- Ensure the TV does not crush the mains lead.
- Do not use any mains lead other than that provided with this TV.

■ Take care

Warning

- Do not remove covers and never modify the TV yourself as live parts are accessible and risk of electric shock when they are removed.
- Do not expose the TV to rain or excessive moisture. This TV must not be exposed to dripping or splashing water and objects filled with liquid, such as vases, must not be placed on top of or above the TV.
- Do not insert foreign objects into the TV through the air vents.
- Do not use an unapproved pedestal / mounting equipment. Be sure to ask your local Panasonic dealer to perform the setup or installation of approved wall-hanging brackets.
- Do not apply strong force or impact to the display panel.
- Ensure that children do not climb on the TV.



- Do not place the TV on sloped or unstable surfaces, and ensure that the TV does not hang over the edge of the base.



Warning

Never place a TV in an unstable location. A TV may fall, causing serious personal injury or death. Many injuries, particularly to children, can be avoided by taking simple precautions such as:

- Using cabinets or stands recommended by the manufacturer of the TV.
- Only using furniture that can safely support the TV.
- Ensuring the TV is not overhanging the edge of the supporting furniture.
- Not placing the TV on tall furniture (for example, cupboards or bookcases) without anchoring both the furniture and the TV to a suitable support.
- Not placing the TV on cloth or other materials placed between the TV and supporting furniture.
- Educating children about the dangers of climbing on furniture to reach the TV or its controls.

If your existing TV is being retained and relocated, the same considerations as above should be applied.

- This TV is designed for table-top use.
- Do not expose the TV to direct sunlight and other sources of heat.



To prevent the spread of fire, keep candles or other open flames away from this product at all times



■ Suffocation / Choking Hazard

Warning

- The packaging of this product may cause suffocation, and some of the parts are small and may present a choking hazard to young children. Keep these parts out of reach of young children.

■ Pedestal

Warning

- Do not disassemble or modify the pedestal.

Cautions

- Do not use any pedestal other than the one provided with this TV.
- Do not use the pedestal if it becomes warped or physically damaged. If this occurs, contact your nearest Panasonic dealer immediately.
- During setup, make sure that all screws are securely tightened.
- Ensure that the TV does not suffer any impact during installation of the pedestal.
- Ensure that children do not climb onto the pedestal.
- Install or remove the TV from the pedestal with at least two people.
- Install or remove the TV by the specified procedure.

Ventilation

Caution

Allow sufficient space (at least 10 cm) around the TV in order to help prevent excessive heat, which could lead to early failure of some electronic components.

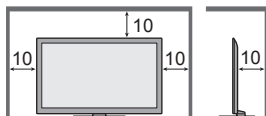

- Ventilation should not be impeded by covering the ventilation openings with items such as newspapers, tablecloths and curtains.
- Whether you are using a pedestal or not, always ensure the vents at the bottom of the TV are not blocked and there is sufficient space to enable adequate ventilation.



Moving the TV

Caution

- Before moving the TV, disconnect all cables.
- At least two people are required to move the TV.

When not in use for a long time

Caution

- This TV will still consume some power even in the Off mode, as long as the mains plug is still connected to a live mains socket.
- Remove the mains plug from the wall socket when the TV is not in use for a prolonged period of time.

Battery for the Remote Control

Caution

- Incorrect installation may cause battery leakage, corrosion and explosion.
- Replace only with the same or equivalent type.
- Do not mix old and new batteries.
- Do not mix different battery types (such as alkaline and manganese batteries).
- Do not use rechargeable batteries (Ni-Cd, etc.).
- Do not burn or break up batteries.
- Do not expose batteries to excessive heat such as sunshine, fire or the like.
- Make sure you dispose of batteries correctly.
- Remove the battery from the unit when not using for a prolonged period of time to prevent battery leakage, corrosion and explosion.

Setting Up the TV

Supplied accessories

Accessories may not be placed all together. Take care not to throw them away unintentionally.

Operating Instructions with Warranty statement

Remote Control

- N2QAYB000976
- ➔ (p. 9)



Batteries (R6) × 2

➔ (p. 6)



Mains Lead

➔ (p. 7)

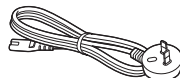

Pedestal

32-inch model

➔ (p. 5)

- Assembly screws

A  (M4 × 18 mm) × 4

B  (M4 × 15 mm) × 4

- Bracket

- Base

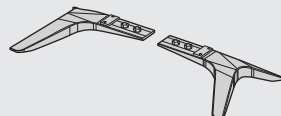
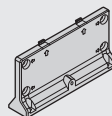

40-inch model

➔ (p. 5)

- Assembly screws

A  (M5 × 15 mm) × 4

B  (M4 × 12 mm) × 4

- Bracket

- Base

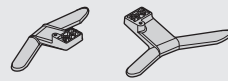

49-inch model

➔ (p. 5 - 6)

- Assembly screws
 (M4 × 12 mm) × 4
- Pedestal

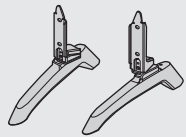

40-inch model

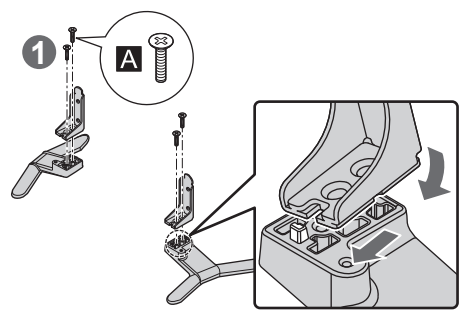

40/49-inch model

Fall-prevention parts

- Screw
- Wood screw
- Band

➔ (p. 6)

Attaching the pedestal

32-inch model

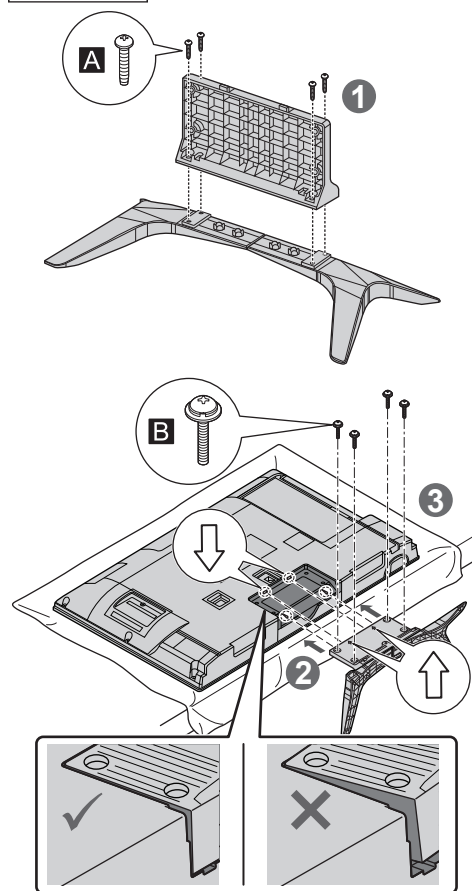

49-inch model

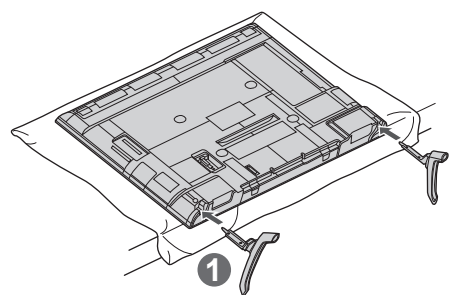

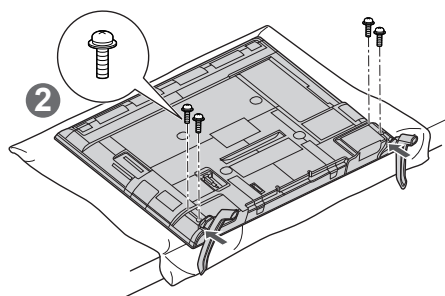

Preventing the TV from falling over

It is recommended to secure the pedestal to a furniture as shown to prevent the TV from falling over.

- This information is designed to reduce the risk of injuries caused by the TV falling over. However, no measure can guarantee protection in all cases.

40-inch model

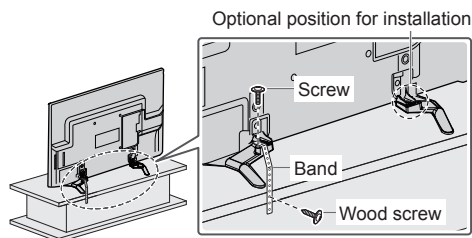

49-inch model

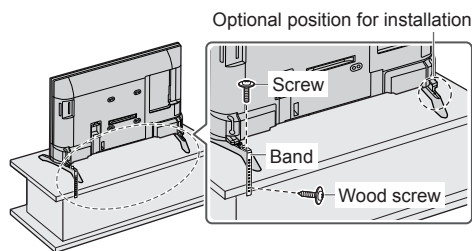

Removing the pedestal from the TV

Be sure to remove the pedestal in the following way when using the wall-hanging bracket or repacking the TV.

- 1 Lay the TV on a foam mat or thick soft cloth on a table (32-inch and 40-inch models only).
- 2 Remove the assembly screws **B** from the TV.
- 3 Pull out the pedestal from the TV.
- 4 Remove the assembly screws **A** from the bracket.

Inserting remote's batteries

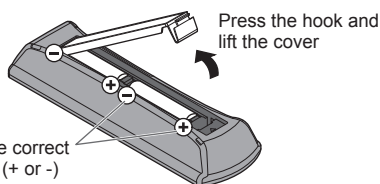

Note the correct polarity (+ or -)

Wall mounting the TV (optional)

Choosing to wall mount the TV shall be done at the owner's risk and expense. Always use a qualified installer to perform a TV wall bracket installation. Incorrect installation may cause TV to fall, resulting in personal injury and product damage that is not covered by warranty.

Rear of the TV

(View from the side)

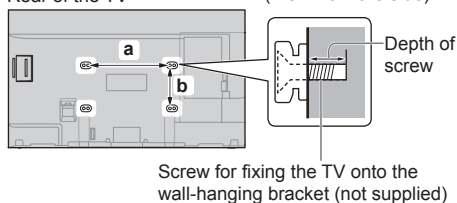

■ Holes for wall-hanging bracket installation

Model	a	b
32/40-inch	200 mm	200 mm
49-inch	400 mm	200 mm

■ Screw specification

Model	Type	Depth of screw	
		Minimum	Maximum
32-inch	M4	9 mm	14 mm
40-inch	M6	11 mm	15 mm
49-inch	M6	10 mm	19 mm

Warning

- When optional accessories such as wall brackets etc. are used, always read and follow the manufacturer installation and usage instructions.
- Do not mount the unit directly below ceiling lights (such as spotlights or halogen lights) which typically give off high heat. Doing so may warp or damage plastic cabinet parts.
- When installing wall brackets you must ensure the wall bracket is not electrically grounded to metal wall studs. Always ensure that there are no electrical cables, pipes etc. in the wall before you begin the wall bracket installation.
- To prevent fall and injury, remove the TV from its fixed wall position when it is no longer in use.

Connecting the TV

- Please ensure the TV is disconnected from the mains socket / power point before attaching or disconnecting any RF / AV leads.
- External equipment and cables are for illustrative purposes only and not supplied with this TV.
- Check the type of terminals and cable plugs are correct when connecting.
- When using an HDMI cable, use the fully wired one.
- Keep the TV away from electronic equipment (video equipment, etc.) or equipment with an infrared sensor. Otherwise, distortion of image / sound may occur or operation of other equipment may be interfered.
- Also read the manual of the equipment being connected.

Terminals

Rear of the TV

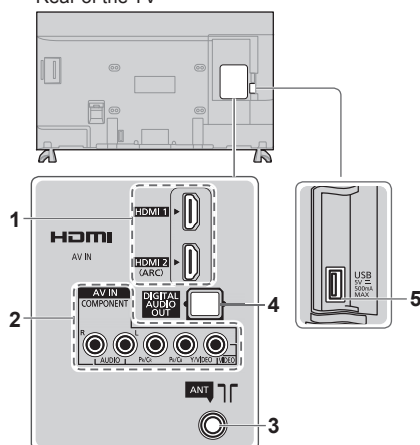

- 1 HDMI 1 - 2
- 2 AV IN
- 3 Aerial terminal
- 4 DIGITAL AUDIO OUT
- 5 USB port

Connections

Aerial and mains lead

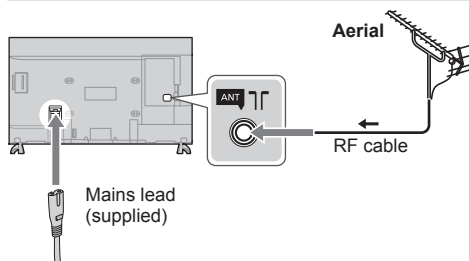

Insert the mains plug firmly into place.

32-inch model

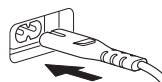

49-inch model

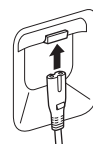

40-inch model

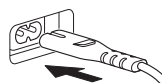

- When disconnecting the mains lead, be absolutely sure to disconnect the mains plug at the socket outlet first.

- To minimise DTV impulse noise pickup, please ensure there is separation between mains lead and RF cable.
- Do not place the RF cable under the TV.
- An aerial, correct cable (75 Ω coaxial) and correct terminating plug are required to obtain optimum quality picture and sound.
- If a communal aerial system is used, you may require the correct connection cable and plug between the wall aerial socket and the TV.
- Your local Television Service Centre or dealer may be able to assist you in obtaining the correct aerial system for your particular area and the accessories required.
- Any matters regarding aerial installation, upgrading of existing systems or accessories required, and the costs incurred, are the responsibility of you, the customer.
- If the aerial is placed in the wrong location, interference might happen.

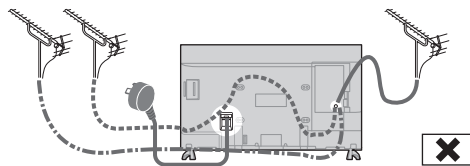
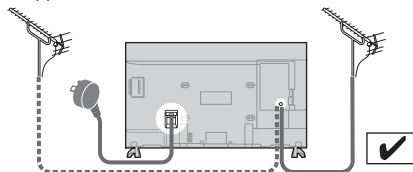

DTV Recorder / PVR / VCR

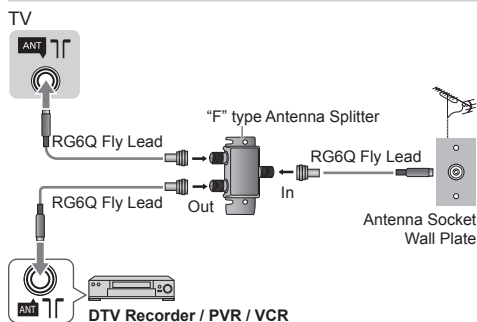

- To maintain optimum antenna signal quality, use an "F" type TV signal splitter (as illustrated) when connecting two or more devices to the same antenna socket.

Set top box

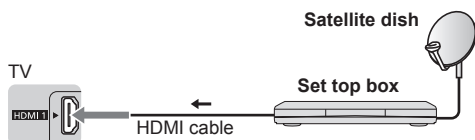

AV / Game equipment

■ Using HDMI terminal

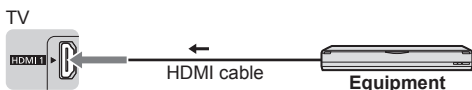

- You can also make similar connection via HDMI 2.

■ Using COMPONENT terminals

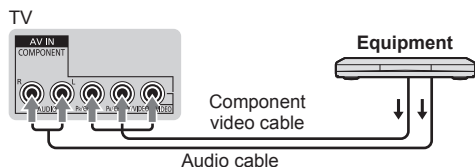

■ Using COMPOSITE terminals

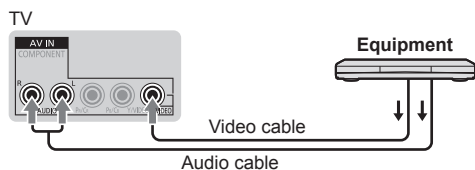

Speaker system

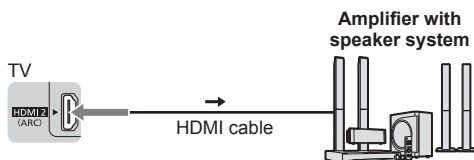

- Use HDMI 2 for connecting an amplifier that has ARC (Audio Return Channel) function. For an amplifier without ARC function, use DIGITAL AUDIO OUT.
- To enjoy the sound from the external equipment in multi-channel sound (e.g. Dolby Digital 5.1ch), connect the equipment to the amplifier. For the connections, read the manuals of the equipment and amplifier.

Initial Setup

When you first turn on the TV, a series of steps will pop-up to guide you to setup your TV.

- These steps are not necessary if the setup has been completed by your local dealer.

1 Plug the mains plug into the socket outlet and turn on the TV.

It may take a few seconds before the screen is displayed.

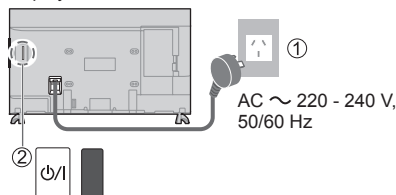

Australia | Proceed to steps 2, 3 and 4.

New Zealand | Scanning starts automatically when you turn on the TV (step 3). After scanning is completed, proceed to step 4.

2 Select your area. **Australia**

Select State/Territory
New South Wales/Australian Capital Territory
Victoria
Queensland
South Australia
Western Australia
Northern Territory
Tasmania



3 Scanning starts.

[Australia] [Automatic Channel Search]

[New Zealand] [Auto Tuning]

Example:

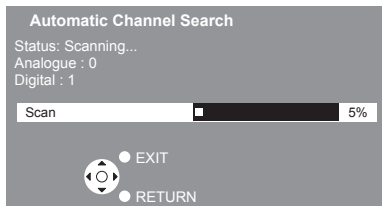

- This function searches and stores TV channels.
- The stored channels and sorted channel order vary depending on the area, broadcasting system and conditions of signal reception.

4 Select [Home].

Please select your viewing environment.

Home

Shop



Change
Confirm

- [Shop] is for shop display.
- To change the viewing environment later on, you need to initialise all settings by accessing [Shipping Condition] (p. 16).

Setup is now complete and your TV is ready for viewing.

Note

- If tuning has failed, check the connection of the RF cable, then follow the on-screen instructions.

Operating the TV

Using the TV controls

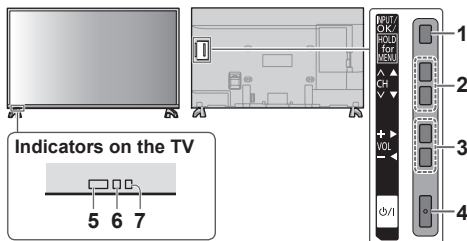

1 Changes the input mode

Displays [Main Menu] when press and hold for 3 seconds

- Press again and hold for 3 seconds to return to the previous screen from submenus / exit from main menu page.

2 Channel Up / Down

Cursor Up / Down

- Makes selections in the menu system.

3 Volume Up / Down

Cursor Left / Right

- Makes selections and / or adjustments when in the menu system.

4 Mains power On / Off switch

- Use to switch the mains power.

5 Remote control signal receiver

6 C.A.T.S. (Contrast Automatic Tracking System) sensor

- Senses brightness to adjust picture quality when [Eco Mode] in the [Picture] menu is set to [On].
➔ (p. 13)

7 Power LED

- Red: Standby
- Green: On
- The LED blinks when the TV receives a command from the remote control.

Using the remote control

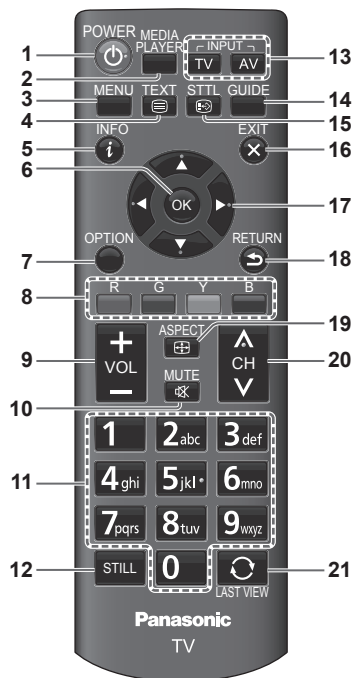

1 Switches the TV On / Standby

2 MEDIA PLAYER ➔ (p. 11)

3 Displays [Main Menu] ➔ (p. 13)

4 Switches to Teletext mode

5 Displays Information banner

6 OK

- Confirms selections.
- Press after selecting channel positions to quickly change channel.
- Displays the [Channel List].

7 Displays [Option Menu]

- Shortcut to subtitle language / sound settings.
- Follow the operation guide to select / change the settings.

8 Coloured buttons

- Performs multiple operations which correspond to the operation guide displayed on the menu screen.

9 Volume Up / Down**10 Sound Mute On / Off****11 Numeric buttons**

- Changes channel / teletext pages.
- Sets characters.
- When in Standby mode, switches TV On.

12 Freezes / unfreezes picture**13 Input mode selection**

- TV - switches to TV input mode (Digital TV or Analogue TV).
- AV - displays [Input Selection] screen (p. 11) or press repeatedly to select the input mode.

14 TV Guide **Australia** ➔ (p. 10)Freeview Guide **New Zealand** ➔ (p. 11)**15 Displays subtitles / audio description**

Displays favourite page in teletext mode

16 Exits to the TV viewing screen**17 Cursor buttons**

- Makes selections or adjustments.

18 Returns to the previous menu / page**19 ASPECT**

- Displays the [Aspect Selection] screen. Follow the operation guide to select the mode. **[16:9] / [14:9] / [Just] / [4:3] / [4:3 Full] / [Zoom1] / [Zoom2] / [Zoom3]** ➔ (p. 18)
- You can also press the button repeatedly to select the mode.

20 Channel Up / Down**21 Returns to the last viewed channel****About operation guide**

When operating the TV with the remote control, follow the operation guide available at the bottom of the screen to perform the operation you want.

Example: [Aspect Selection]

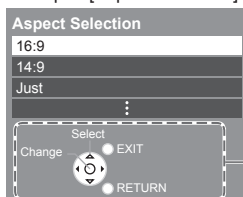

Operation guide

Referring to the operation guide:

- To select the mode



- To return to the previous menu



- To change to the selected mode



- To exit from the menu



Using TV Guide / Freeview Guide

The TV Guide / Freeview Guide - Electronic Programme Guide (EPG), shows a list of broadcasts for several days (depending on the broadcasters).

- When this TV is turned on for the first time, or switched off for more than a week, it may take some time before the TV Guide / Freeview Guide is completely shown.
- This function varies depending on the area you select (p. 8).
- Digital and Analogue channels are displayed on the same TV Guide screen. There will be no programme listings for Analogue channels.
- TV mode only.

Australia**Display the TV Guide.**

GUIDE



Example:

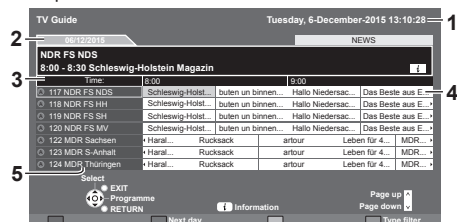

- 1 Current date and time
- 2 TV Guide date
- 3 TV Guide time
- 4 Programme
- 5 Channel position and name

Follow the operation guide to operate the TV Guide.**Note**

- It may be slow to response when pressing the **UP/ DOWN** cursor button for TV program guide. This is due to program data downloading.

[Type filter]

Lets you view a channel list of the selected type filter.

B
 (Press again to return to TV Guide.)

(Type list)

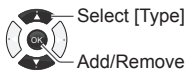
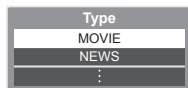

New Zealand

Display the Freeview Guide.

GUIDE (Each press will toggle the screen between the Freeview Guide Listing and What's on Now / Next.)

Example: Freeview Guide Listing

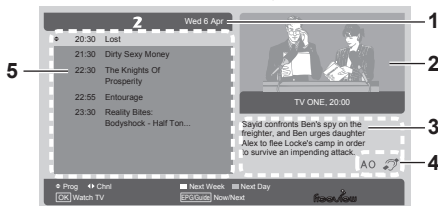

- 1 Current day and date
- 2 Current programme
- 3 Programme description
- 4 Parental rating and captioning information
- 5 Current channel's programme listing

Follow the operation guide to operate the Freeview Guide.

Note

- The Freeview Guide screen and operations are subject to change without notice.

Watching External Inputs

- 1 Connect the external equipment.
 ➔ (p. 8)
- 2 Display the [Input Selection] menu, then select the input of the connected equipment.

Example:

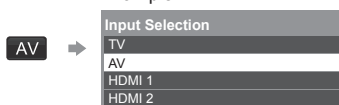

Note

- You can label or skip each input mode.
 ➔ **[Input Labels] (p. 15)**
 Skipped inputs will not be displayed when the **AV** button is pressed.
- If the external equipment has an aspect adjustment function, set it to "16:9".

Using Media Player

Media Player allows you to enjoy photo, music or video recorded on a USB Flash Memory.

- During the operation, audio signal is output from DIGITAL AUDIO OUT or HDMI 2 (ARC function) terminals. To use HDMI 2 with ARC function, connect an amplifier that has ARC function and set to use theatre speakers (p. 8).
- The picture may not appear correctly on this TV depending on the digital cameras used.
- Display may take some time when there are many files and folders in the USB Flash Memory.
- Partly degraded files might be displayed at a reduced resolution.
- The folder and file names may be different depending on the digital camera used.

Inserting / Removing the USB Flash Memory

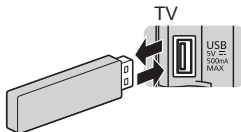

- Insert or remove straight and completely.

Starting Media Player

- 1 Insert the USB Flash Memory.
- 2 Start Media Player.



- 3 Select the mode.



[Photo]: Displays the thumbnail of all photos in the USB Flash Memory.

[Music]: Displays the thumbnail of music folders in the USB Flash Memory.

[Movie]: Displays the thumbnail of video titles in the USB Flash Memory.

[Contents Select]

Switching between modes

When you are in the thumbnail view of any mode, you can change to the other mode by accessing the [Contents Select] screen.

B



[Drive Select]

For USB with partition, you can change to the other partition directly in the same mode.

Y



Follow the operation guide to perform available operations in each mode.

- INFO
- Displays the information of the highlighted content.
 - Displays / hides the operation guide.

Photo mode



Operation guide

[?]: Error display

[View]

Enters Single view mode to view photo one at a time.

[Slideshow]

Lets you view all photos in the slideshow mode.

[View Select]

Lets you toggle between all photos view and folder view.

G



[All photos]: Displays all photos.

[Folder view]: Displays the thumbnails grouped by folder.

[Option Menu]

■ [Slideshow Settings]

- **[Transition Effect]:** Effect for photo switching during slideshow. [None] / [Dissolve] / [Wipe right] / [Wipe left] / [Wipe up] / [Wipe down] / [Box in] / [Box out] / [Random]
- **[Screen Mode]:** Screen mode for Single view and Slideshow. [Normal] / [Zoom]
 - In [Normal] screen mode, depending on the photo size, it may not be fully enlarged to fill the screen. E.g.: portrait style picture.

- **[Interval]:** Slideshow interval. [5] / [10] / [15] / [30] / [60] / [90] / [120] (seconds)
- **[Repeat]:** Slideshow repeat. [Off] / [On]
- **[Back Ground Music]:** Background music during photo viewing. [Off] / [Type1] / [Type2] / [Type3]

Note

- Picture quality may become lower depending on the slideshow settings.

Music mode

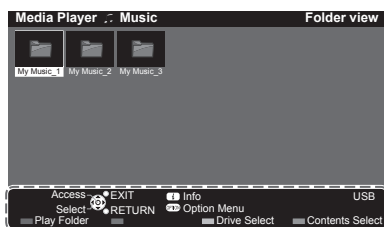

Operation guide

[Play Folder]

Playbacks all music in the selected folder.

R



■ To playback the selected file only

Select the folder.



Select the file.



[Option Menu]

■ [Music Setup Menu]

- **[Repeat]**
 - [One]: Playback repeat on the selected one file.
 - [Folder]: Playback repeat within the selected folder.
 - [Off]: Playback repeat off.

Movie mode

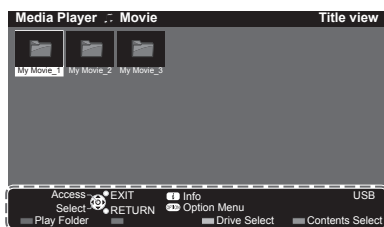

Operation guide

[Play Folder]

Playbacks all movies in the selected folder.

R



■ To playback the selected file only

Select the folder.



Select the file.



[Option Menu]

■ [Video Setup Menu]

- **[Multi Audio]:** Selects the sound tracks (if available) during video playback.
- **[Subtitle]:** Selects the subtitle (if available) during video playback.
- **[Aspect Change]:** Selects the aspect mode during video playback. [16:9] / [14:9] / [Just] / [4:3] / [4:3 Full] / [Zoom1] / [Zoom2] / [Zoom3]
 - You can also change the aspect by pressing the **ASPECT** button repeatedly.
- **[Repeat]:** Playback repeat options. [Off] / [On]

Using the Menu Functions

1 Display the menu.

MENU

Example:

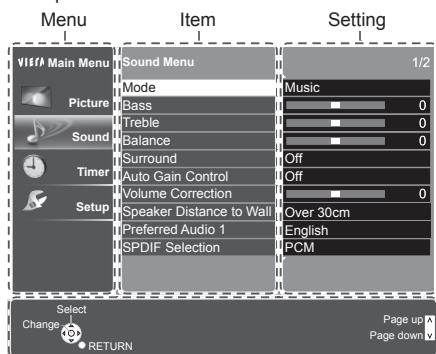

Operation guide

2 Select the menu.



3 Select the item.

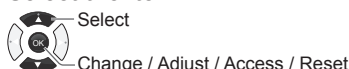

4 Change the setting.

Example:

- Change the setting option



- Adjust the intensity bar



- Access the submenu

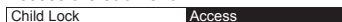

Note

- Only available items can be selected.

Picture

[Viewing Mode]

Sets the picture mode for each input. **[Dynamic]** / **[Normal]** / **[Cinema]** / **[True Cinema]**

[Dynamic]: Improves contrast and sharpness for viewing in a bright room.

[Normal]: For viewing in a normal lighting condition.

[Cinema]: Improves the performance of contrast, black and colour reproduction for watching movies in a darkened room.

[True Cinema]: Reproduces the original image quality precisely without any revision.

In each [Viewing Mode], the settings for [Backlight], [Contrast], [Brightness], [Colour], [Sharpness], [Tint], [Colour Balance], [Eco Mode], [P-NR] and [3D-COMB] can be adjusted and stored for each input.

[Backlight], [Contrast], [Brightness], [Colour], [Sharpness]

Increases or decreases the levels of these options according to your personal preference.

[Tint]

Adjusts the picture hue to suit your taste.

- For NTSC signal reception.

[Colour Balance]

Selects the colour temperature of the picture.

[Cool] / [Normal] / [Warm]

- Not available when [Viewing Mode] is set to [True Cinema].

[Channel Colour Set]

Adjusts the suitable colour density from 3 levels for each channel.

- Select the channel to adjust and set this function.

[Eco Mode]

Automatically adjusts picture settings depending on ambient lighting conditions. **[Off]** / **[On]**

[P-NR]

Picture noise reduction function which reduces unwanted picture noise and flicker noise in the contoured parts of a picture. **[Off]** / **[Min]** / **[Mid]** / **[Max]**

[3D-COMB]

Makes still or slow moving pictures more vivid.

[Off] / [On]

- Set to **[On]** to improve the colours if patterning is seen while watching still or slow moving pictures.
- For PAL / NTSC signal reception in TV mode or from composite input.

[Colour Matrix]

Adjusts suitable colour parameters for **[SD]** (standard definition) or **[HD]** (high definition).

[SD]: Input signal is a normal TV system.

[HD]: Input signal is a high definition system.

- Available only with 480p or 576p input on video signals in a natural colour from digital equipment connected to COMPONENT or HDMI terminal.

[Colour System]

Selects optional colour system based on video signals in AV mode. **[Auto]** / **[PAL]** / **[SECAM]** / **[M.NTSC]** / **[NTSC]**

[16:9 Overscan]

Selects the screen area displaying the image for 16:9 aspect. **[Off]** / **[On]**

[On]: Enlarges the image to hide the edge of the image.

[Off]: Displays the image in the original size.

- Set to **[On]** if noise is generated on the edge of the screen.
- This function can be memorised separately for SD (Standard definition) and HD (High definition) signals.

[16:9 H size] (40-inch model only)

Adjusts the horizontal display range to reduce noise on both side edges of an image for 16:9 aspect. **[Size 1 / Size 2]**

- When **[16:9 Overscan]** is set to **[On]**,
 - **[Size 1]**: displays the image at 95 % with horizontal stretched.
 - **[Size 2]**: displays the image 95 % with side mask.
- When **[16:9 Overscan]** is set to **[Off]**,
 - **[Size 1]**: displays the image at 100 % with horizontal stretched.
 - **[Size 2]**: displays the image 100 % with side mask.

[Reset to Defaults]

Resets the current picture settings to defaults.

Sound**[Mode]**

Sets your favourite sound mode. **[Music]** / **[Speech]** / **[User]**

- The selected mode affects all input signals.

[Music]*: Improves sound quality for watching music videos, etc.

[Speech]*: Improves sound quality for watching news, drama, etc.

*In **[Music]** and **[Speech]** modes, you can adjust the **[Bass]** and **[Treble]** settings, and those settings will be stored for each mode.

[User]: Adjusts the sound manually by using the equaliser.

- When you select **[User]** mode, **[Equaliser]** is active instead of **[Bass]** and **[Treble]**. Select **[Equaliser]** and adjust the frequency. ➡ (p. 14)

[Bass]

Adjusts level to enhance or minimise lower, deeper sound output.

[Treble]

Adjusts level to enhance or minimise sharper, higher sound output.

[Equaliser]

Adjusts the frequency level to suit your favourite sound quality.

- This function is available when **[Mode]** is set to **[User]**.
- Select the frequency and change the frequency level by using the cursor buttons.
- To enhance the bass sound, raise the level of the lower frequency. To enhance the treble sound, raise the level of the higher frequency.
- To reset the levels of each frequency to the default settings, select **[Reset to Defaults]** by using the cursor button, and then press the **OK** button.

[Balance]

Adjusts volume level of right and left speakers.

[Surround]

Surround sound settings. **[Off]** / **[On]**

[Auto Gain Control]

Automatically regulates large sound level differences between channels and inputs. **[Off]** / **[On]**

[Volume Correction]

Adjusts the volume of individual channel or input mode.

[Speaker Distance to Wall]

Compensates for the low frequency sound due to the distance between the speakers and the wall.

[Over 30cm] / [Up to 30cm]

- If the distance between the TV and wall is over 30 cm, **[Over 30cm]** is recommended.
- If the distance between the TV and wall is within 30 cm, **[Up to 30cm]** is recommended.

[Preferred Audio 1] (New Zealand)

Selects the preferred language for Digital TV multi audio (depending on the broadcaster).

[MPX]

Selects multiplex sound mode (if available).

[Stereo]: Use this normally.

[Mono]: When stereo signal cannot be received.

[M1] / [M2]: Available while mono signal is transmitted.

- For Analogue TV only.

[SPDIF Selection]

SPDIF: A standard audio file transfer format.

Selects the initial setting for digital audio output signal from DIGITAL AUDIO OUT and HDMI 2 (ARC function) terminals. **[Auto]** / **[PCM]**

[Auto]: Dolby Digital is output as Dolby Digital Bitstream. HE-AAC and MPEG are output as PCM.

[PCM]: Digital output signal is fixed to PCM.

- For Digital TV or video contents of Media Player.

[MPEG Optical Level]

Adjusts the audio level output from DIGITAL AUDIO OUT terminal as the initial setting.

[-12 / -10 / -8 / -6 / -4 / -2 / 0 dB]

- Normally, PCM sound is higher comparing with the other types of audio track.

[HDMI 1/2 Input(HDMI)]

Selects to fit the input signal (p. 19).

[Digital] / [Analogue]

[Digital]: When sound is carried via the HDMI cable connection.

[Analogue]: When sound is not carried via the HDMI-DVI adaptor cable connection.

- For HDMI input only

[SPDIF Delay]

Adjusts the time delay for the sound output from DIGITAL AUDIO OUT or HDMI 2 (ARC function) terminals if the sound does not synchronise with the image. **[0] / [10] / [20 to 200] (msec)**

[Downmix Mode]

Selects the output mode for listening to compressed music. **[Surround] / [Stereo] / [Dual1] / [Dual2]**

[Type]

Narration settings for impaired users (only available in some countries). **[Normal] / [Hearing Impaired] / [Visually Impaired]**

[Hearing Impaired]: Provides aids in understanding and enjoyment with Digital TV subtitles (depending on the broadcaster).

[Visually Impaired]*: Activates the narration sound track when available on the broadcast.

- For Digital TV only.

* [Visually Impaired] (below) is available after you have selected this option.

[Visually Impaired]**■ [Speaker]**

Narration sound track is output to the TV speakers.

[Off] / [On]

■ [Volume]

Adjusts the volume of the narration sound track.

■ [Pan and Fade]

Sets the audio pan and fade effect. **[Off] / [On]**

[Off]: Main Audio program.

[On]: Controls the level of the Main Audio Program and the pan of the Associated Audio Program.

[Reset to Defaults]

Resets the current sound settings to defaults.

Timer**[Off Timer]**

Sets the duration until the TV automatically goes to Standby mode.

[Off] / [15 / 30 / 45 / 60 / 75 / 90 minutes]

[Region Selection] Australia

Selects the region where you live to adjust the standard time. **[NSW/ACT] / [Victoria] / [Queensland] / [South Australia] / [Western Australia] / [Northern Territory] / [Tasmania]**

[Daylight Saving] Australia

Selects the time offset from the standard time for Summer. **[Auto] / [Off] / [1/2 hour] / [1 hour]**

[Auto Standby]

Enables the TV to turn into Standby mode automatically if no operation is performed after the selected period.

[Off] / [2 hours] / [4 hours]

- Automatic input switching with the connected equipment affects this function and time-count will be reset.

Setup**[Link Settings]****■ [CEC]**

When set to [On], the TV will automatically switch to the appropriate HDMI input whenever an HDMI connected equipment is initially turned on and play mode is selected. **[Off] / [On]**

■ [Power off Link]

When set to [On], all HDMI connected equipment will be turned off automatically by turning off the TV.

[Off] / [On]

- A Panasonic DVD Recorder will not turn off if it is still in the Rec mode.
- The TV remains on even if all the HDMI connected equipment are turned off.

[Child Lock] ➔ (p. 17)

[Tuning Menu] ➔ (p. 16 - 17)

[Display Settings]**■ [Preferred Subtitles 1]** New Zealand

Selects the preferred subtitle language for digital channels (depending on the broadcaster).

■ [Preferred Subtitle Type] New Zealand

Selects the preferred subtitle type for digital channels (depending on the broadcaster). **[Normal] / [Hearing Impaired]**

■ [Input Labels]

Accesses the input labels list to select the label of each input mode or set to skip unconnected one for easier identification and selection in [Input Selection] (p. 11) or banner.

- To skip the input mode, select [Skip].

■ [Banner Display Timeout]

Sets how long the Information banner stays on screen (p. 9). **[0 (No display)] / [1 second] / [2 - 10 (seconds)]**

■ [Radio Mode]

Sets the timer to turn off the screen automatically when a radio channel is selected.

[Off] / [5 / 10 / 15 / 20 seconds]

- The sound is active even when the screen is off. This function could reduce power consumption when listening to a radio channel.
- Press any button except Standby, Volume Up / Down and Sound Mute buttons to turn on the screen.
- Not available in Analogue TV mode.

[System Menu]

■ [Shipping Condition]

Resets all settings, including tuning data, to the original condition.

- Access this function and follow the on-screen instructions to complete the procedures.
- Initial Setup (p. 8) will automatically start after [Shipping Condition] completes.

■ [System Update] ➔ (p. 18)

■ [Software Licence]

Displays the software licence information.

■ [System Information]

Displays the software version.

[Power Save]

Reduces brightness of picture to economise on power consumption. [Off] / [On]

Using the [Tuning Menu]

Use the [Tuning Menu] to retune the TV automatically or manually, add new channels, check signal conditions, create your favourite channel lists, skip unwanted channels, etc.

Australia [Automatic Channel Search] New Zealand [Auto Tuning] (TV mode only)

Retunes the channels received in your area automatically.

- Automatically searches and adds available channels to the memory.
- After the scan is complete, all previously saved channels will be erased.

Example:



- When the operation is completed, the channel at the lowest position will be displayed.
- If tuning has not been done completely, perform [Analogue Manual Tuning].

[Scan]

Adds new channels automatically to the channel list.

Example: Antenna

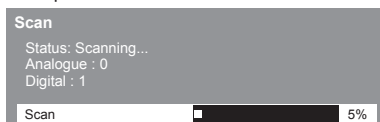

[Analogue Manual Tuning]

Sets analogue channel manually.

Example: Antenna

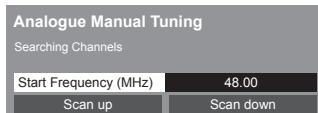

1 Enter the frequency to start scanning.

2 Select the scanning method.



- **[Scan up]:** Scans ascendingly from the entered frequency to higher frequencies.
- **[Scan down]:** Scans descendingly from the entered frequency to lower frequencies.

[DVB-T Signal Condition]

Shows the Digital TV signal condition.

Example:

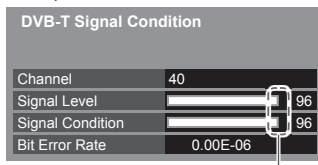

These bars show the maximum signal value of the selected channel.

[DVB-T Manual Tuning]

Searches for the Digital TV channels manually.

All channels found will be added to the Channel List.

Select a channel position, then start tuning.

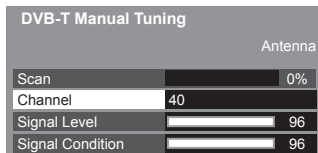

[Favourites Edit]

Creates favourite channel lists from various broadcasters.

Select a channel to add or remove from the list.

(): Encrypted channel)

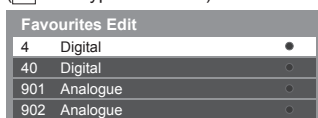

✓ : Add
● : Remove

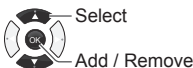

[Skip]

Skips or hides unwanted channels.

Select a channel, then reveal / hide.

Skip	
4	Digital
40	Digital
901	Analogue
902	Analogue

☒ : Hide (skip) ☐ : Reveal



[Sort]

Sorts channels.

1 Select a channel

Sort	
4	Digital
40	Digital
901	Analogue
902	Analogue

☒ : Selected ☐ : Unselected



2 Swap the channel position (if available).



[Channel List Edit]

Edits channel settings.

1 Select a channel.

Channel List Edit	
4	Digital
40	Digital
901	Analogue
902	Analogue



2 Edit the channel settings.

Channel List Edit	
Network Name	
Channel	901
Channel Name	
Frequency (MHz)	48.25
Colour System	Auto
Sound System	B/G

- You cannot change the [Network Name].
- [Frequency], [Colour System] and [Sound System] edit are available for Analogue channels only.

Select an item.



Enter the new settings.

1	2	3
4	5	6
7	8	9
0		

or

Change the settings.



- You can set the characters by using the numeric and cursor buttons as follows:

0	1	2	3	4	5	6	7	8	9
.	!	:	#		J	K	L		
A	B	C	D	E	M	N	O		
P	Q	R	S	T	U	V	W	X	Y
Z									

Backspace

[Clear block]

Clears the entire channel list.

Select [OK] to clear.

Are you sure?	
OK	Cancel

Setting [Child Lock]

You can lock specific channels / AV input terminals. When the locked channel / input is selected, a message appears. Enter the PIN number to watch.

Enter the PIN number (4 digits).

Child Lock-PIN Entry	
Please enter new PIN	
PIN	***

- Enter the PIN number twice at first setting.
- Write your PIN number here in case you forget it.

--	--	--	--

Child Lock

Change PIN	
Child Lock List	Access
Parental Rating	No Block

■ To lock channels or inputs

- 1 Select [Child Lock List].
- 2 Select a channel / input, then lock it.

Child Lock List - TV and AV			
Name	Input	Type	Lock
7 BBC 1 Wales	TV	TV	
14 BBC THREE	TV	TV	
101 E4C	TV	TV	
...			

Lock [OK] EXIT RETURN Page up: Page down

(🔒 : Locked input / channel)

■ To change the PIN number

- 1 Select [Change PIN].
- 2 Enter a new PIN number twice.

■ To set parental rating

To watch the Digital TV programme that has rating information over the selected age, enter the PIN number (depending on the broadcaster). The availability of this function depends on the area you select (p. 8).

- 1 Select [Parental Rating].
- 2 Select the block setting.

Note

- Setting [Shipping Condition] (p. 16) erases the PIN number and all settings.

Performing [System Update]

To update automatically

Set [Auto Download] and [Auto Install] to [Yes].

Setup

Manual OAD Download	
Auto Download	Yes
Auto Install	Yes

- Once you have set the option, the TV automatically performs a search and download any available update.
- The automatic update can also perform when the TV is in Standby.

If [System Update] is performed, the software will be updated (it may change TV functions).
If you do not want to do so, set [Auto Install] to [No].

To update immediately

1 Select [Manual OAD Download].

Setup

Manual OAD Download	Access
Auto Download	No
Auto Install	No

The TV searches for an update (several minutes) and displays a corresponding message, if any.

2 Download the update.

Note

- Download may take more than 10 minutes.
- During software download and update, DO NOT switch off the TV.
- The notification message might be a reminder. In this case, the schedule information (the date that the new version can be used) will appear. You can set the reservation for update.

Information banner

Example : Digital TV

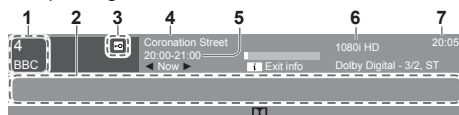

- Channel position and name
- Programme details
- Channel type ([Radio], [Data], etc.) / Encrypted channel ([E])
- Programme
- Programme Start / Finish time (Digital TV)
Channel number, etc. (Analogue TV)
- Input signal
- Current time

Icon / Message	Meaning
	Sound mute On
[Encrypted]	Scrambled programme
[Dolby Digital]	Dolby Digital audio track
[STTL]	Subtitle service available
[TTX]	Teletext service available
[ST], [Dual], [Mono]	Audio mode
1 - 90	Off Timer remaining time

■ To display extra information (Digital TV)

INFO



(Press again to hide the banner.)

Aspect

■ [16:9]

Directly displays the image at 16:9 without distortion (anamorphic).

- For Digital Broadcast channels, image will be displayed based on broadcasted channel aspect ratio.

■ [14:9]

Displays the image at the standard 14:9 without distortion.

■ [Just]

Displays a 4:3 image full-screen. Stretching is only noticeable at the left and right edges.

■ [4:3]

Displays the image at the standard 4:3 without distortion.

■ [4:3 Full]

Displays a 4:3 image enlarged horizontally to fit the screen.

- For HD (High definition) signals only

■ [Zoom1]

Displays a 16:9 letterbox or 4:3 image without distortion.

■ [Zoom2]

Displays a 16:9 letterbox (anamorphic) image full-screen without distortion.

Additional Information

Auto power standby function

The TV will automatically go into Standby mode in the following conditions:

- [Off Timer] is active in the [Timer] menu (p. 15).
- No operation is performed for the period selected in [Auto Standby] (p. 15).

■ [Zoom3]

Displays a 2.35:1 letterbox (anamorphic) image full-screen without distortion. At 16:9, displays the image at its maximum (with slight enlargement).

Input signal that can be displayed

Signal name	COMPONENT	HDMI
525 (480) / 60i, 60p	○	○
625 (576) / 50i, 50p	○	○
750 (720) / 60p, 50p	○	○
1,125 (1,080) / 60i, 50i	○	○
1,125 (1,080) / 60p, 50p, 24p		○

- Mark : Applicable input signal
- Signals other than above may not be displayed properly.
- The above signals are reformatted for optimal viewing on your display.

Supported file format in Media Player

■ Photo

- JPEG (.jpg, .jpeg)
- Supported resolution: 8 × 8 to 30,719 × 17,279
 - DCF and EXIF standards
 - Sub-sampling: 4:4:4, 4:2:2, 4:2:0
 - Progressive JPEG is not supported.

■ Music

MP3 (.mp3) / AAC (.m4a)*1 / WMA (.wma)*1, 2 / LPCM (.wav) / FLAC (.flac)

■ Video

AVI (.avi)*2, 3 / MKV (.mkv)*3 / ASF (.asf, .wmv)*1, 2 / MP4 (.f4v, .m4v, .mp4)*4 / FLV (.flv) / 3GPP (.3gp, .3g2) / TS (.mts, .m2ts, .tp, .ts, .tts) / PS (.mod, .mpg, .mpeg, .vob, .vro)

- *1 Copy-protected files cannot be played back.
*2 WMA Pro and WMA Lossless are not supported.
*3 Some subtitles or chapter functions may not be available.
*4 This TV supports this container recorded with Panasonic products. For details, read the manual of the products.

■ Subtitles

- MicroDVD, SubRip, TMLayer (.srt, .sub, .txt)
- The video file and subtitles text file are inside the same folder, and the file names are the same except for the file extensions.
 - If there are more than one subtitles text file inside the same folder, they are displayed in the following order of priority: ".srt", ".sub", ".txt".

Note

- Even if these conditions are fulfilled, some files may not play depending on how they are encoded.
- Do not use two-byte characters or other special codes for data.
- Connected devices may become unusable with this TV if the file or folder names are changed.

HDMI connection

This TV incorporates HDMI™ technology. HDMI (high-definition multimedia interface) is the world's first complete digital consumer AV interface complying with a non-compression standard. HDMI allows you to enjoy high-definition digital images and high-quality sound by connecting the TV and the equipment.

■ Applicable HDMI features

- Input audio signal:
2ch Linear PCM (sampling frequencies - 48 kHz, 44.1 kHz, 32 kHz)
- Input video signal:
➔ "Input signal that can be displayed" (p. 19)
Match the output setting of the digital equipment.
- Audio Return Channel* (HDMI 2 terminal only)

■ DVI connection

If the external equipment has only a DVI output, connect to the HDMI terminal via a DVI to HDMI adaptor cable. When the DVI to HDMI adaptor cable is used, connect the audio cable to the audio input terminal (use AV IN AUDIO terminals).

Note

- Audio settings can be made on [HDMI 1/2 Input(HDMI)] in the [Sound] menu.
- These HDMI connectors are "type A".
- These HDMI connectors are compatible with HDCP (High-Bandwidth Digital Content Protection) copyright protection.
- Equipment having no digital output terminal may be connected to the input terminal of component or video to receive analogue signals.

* Audio Return Channel (ARC) is a function to send digital sound signals via an HDMI cable.

USB Flash Memory

For playing back in Media Player
Format: FAT16, FAT32

Compliance:

Supports only USB1.1 or USB2.0 standard.
Maximum USB capacity supported is 16GB.
USB Hub or card adapter is not supported.

Note

- Data modified with a PC may not be displayed.
- Do not remove the device while the TV is accessing data. Otherwise this can damage the device or TV.
- Do not touch the pins on the device.
- Insert the device in the correct direction. Otherwise this can damage device or TV.
- Electrical interference, static electricity, or erroneous operation may damage the data or device. Panasonic is not liable for any deterioration or damage of data or device during operations with the TV.
- It is recommended to connect the USB Flash Memory directly to the TV's USB port.
- Some USB devices or USB HUB may not be used with this TV.
- You cannot connect any devices by using USB card reader.
- Additional information for USB devices may be on the following website. (English only)
<http://panasonic.net/viera/support>

Troubleshooting

Before requesting service or assistance, please follow these simple guides to resolve the problem.

If an error message appears, follow the message's instructions.

If the problem still persists, please contact your local Panasonic dealer for assistance.

Screen

Red, blue, green or black spots on the screen.

- This is the characteristic of liquid crystal panels. The liquid crystal panel is built with very high precision technology. Occasionally, a few non-active pixels may appear on the screen as points of red, green, blue or black. This does not affect the performance of your TV and it is not a quality problem.

Chaotic image, noisy.

- Set [P-NR] in the [Picture] menu to remove noise (p. 14).
- Check nearby electrical products (car, motorcycle, fluorescent lamp).

No image is displayed.

- Check the settings of [Contrast], [Brightness] or [Colour] in the [Picture] menu (p. 13).
- Check the TV is in AV mode. If the TV is in AV mode, check the selected input mode match the output of the external equipment (p. 11).

Blurry or distorted image.

(No sound or low volume.)

- Reset channels. ➔ (p. 16)

Unusual image is displayed.

- Turn the TV off with Mains power On / Off switch (p. 9), then turn it on again. If the problem persists, initialise all settings. ➔ [Shipping Condition] (p. 16)

Pictures from equipment connected via HDMI are unusual.

- Check the HDMI cable is connected properly.
- Turn the TV and equipment off, then turn them on again.
- Check an input signal from the equipment (p. 19).
- Use equipment compliant with EIA/CEA-861/861D.

Sound

No sound is produced.

- Check the sound mute setting (p. 10) and volume.

Low level or distorted sound.

- Sound signal reception may be deteriorated.

Sound output via HDMI connection is unusual.

- Set the sound setting of the connected equipment to "2ch L.PCM".
- Check the [HDMI 1/2 Input(HDMI)] setting in the [Sound] menu (p. 15).
- If digital sound connection has a problem, select analogue sound connection (p. 19).

General

The TV goes into Standby mode.

- This TV is equipped with auto power standby function (p. 18).

The remote control does not work or is intermittent.

- Replace the batteries (p. 6).
- Point the remote control directly at the remote control signal receiver of the TV (within about 7 m and 30 degree angle).
- Situate the TV away from sunshine or block sources of bright light from shining on the remote control signal receiver of the TV.

Parts of the TV become hot.

- Even if the temperature of parts of the front, top and rear panels has risen, these temperature rises do not cause any problems in terms of performance or quality.

The TV panel moves slightly when it is pushed with a finger.

Clattered sound might be heard.

- There is some flexibility around the panel to prevent damage. This is not a malfunction.

Overcurrent error message appears.

- The connected USB device might cause this error. Remove the device and turn the TV off with Mains power On / Off switch, then turn it on again.
- Check foreign objects are not inside the USB port.

Maintenance

First, remove the mains plug from the socket outlet.

Regular care

- Gently wipe the surface of the display panel, cabinet and pedestal by using a soft cloth.
- Wipe the mains plug with a dry cloth at regular intervals. Moisture and dust may lead to fire or electrical shock.

For stubborn dirt

First clean the dust on the surface. Dampen a soft cloth with clean water or diluted neutral detergent (1 part detergent to 100 parts water). Wring the cloth and wipe the surface. Finally, wipe away all the moisture.

Caution

- Do not use a hard cloth or rub the surface too hard as this could scratch the surface.
- Do not subject the TV's surfaces to water or detergent. Liquid inside the TV could lead to product failure.
- Do not subject the surfaces to insect repellent, solvent, thinner or other volatile substances. This may degrade surface quality or cause peeling of the paint.
- The surface of the display panel is specially treated and may be easily damaged. Take care not to tap or scratch the surface with your fingernail or other hard objects.
- Do not allow the cabinet and pedestal to make contact with a rubber or PVC substance for a long time. This may degrade surface quality.

Specifications

Model no.

32-inch model

- Australia TH-32D400A
- New Zealand TH-32D400Z

40-inch model

- Australia TH-40D400A
- New Zealand TH-40D400Z

49-inch model

- Australia TH-49D400A
- New Zealand TH-49D400Z

Power

Rating

- 32-inch model: AC 220 - 240 V, 50/60 Hz 0.56 A
- 40-inch model: AC 220 - 240 V, 50/60 Hz XX A
- 49-inch model: AC 220 - 240 V, 50/60 Hz 0.55 A

Normal (Home) mode

- 32-inch model: 52 W
- 40-inch model: XX W
- 49-inch model: 98 W

Standby power consumption

- 32-inch model: 0.30 W
- 40-inch model: XX W
- 49-inch model: 0.20 W

Display panel

Panel

- LCD panel (LED backlight)

Visible screen size (diagonal)

- 32-inch model: 80 cm
- 40-inch model: 108 cm
- 49-inch model: 123 cm

Display resolution

- 32-inch model: 1,366 (W) × 768 (H)
- 40/49-inch model: 1,920 (W) × 1,080 (H)

Dimensions (W × H × D)

32-inch model

- 733 mm × 476 mm × 179 mm (With Pedestal)
- 733 mm × 437 mm × 70 mm (TV only)

40-inch model

- XX mm × XX mm × XX mm (With Pedestal)
- XX mm × XX mm × XX mm (TV only)

49-inch model

- 1,106 mm × 704 mm × 259 mm (With Pedestal)
- 1,106 mm × 644 mm × 80 mm (TV only)

Mass

32-inch model

6.0 kg (With Pedestal)
5.5 kg (TV only)

40-inch model

XX kg (With Pedestal)
XX kg (TV only)

49-inch model

14.0 kg (With Pedestal)
13.0 kg (TV only)

Connection terminals

AV IN (COMPONENT / VIDEO)

VIDEO

RCA PIN Type × 1, 1.0 V[p-p] (75 Ω)

AUDIO L - R

RCA PIN Type × 2, 0.5 V[rms]

Y

1.0 V[p-p] (including synchronisation)

P_B/C_B, P_R/C_R

±0.35 V[p-p]

HDMI 1 / 2 input

TYPE A Connectors

USB

USB 2.0 TYPE A Connectors
DC ≐ 5 V, Max. 500 mA

DIGITAL AUDIO OUT

PCM / Dolby Digital / Fibre optic

Sound

Audio output

20 W (10 W + 10 W)

Receiving systems / Band name

Digital TV

Australia 7 MHz VHF / UHF (Australia) free-to-air
TV broadcast reception

New Zealand 8 MHz UHF (New Zealand) free-to-air
TV broadcast reception

PAL B / G

Reception of Off air broadcasts

PAL 60 Hz

Playback of NTSC tape from some PAL Video
recorders (VCR)

M. NTSC

Playback from M. NTSC Video recorders (VCR)

NTSC

Playback from NTSC Video recorders (VCR)

Aerial input

Australia Standard Belling & Lee connector

New Zealand VHF / UHF

Operating conditions

Temperature

0 °C - 35 °C

Humidity

20 % - 80 % RH (non-condensing)

Note

- Design and Specifications are subject to change without notice. Mass and Dimensions shown are approximate.

This product incorporates the following software:

(1) the software licensed under the GNU General Public License, Version 2.0 (GPL V2.0) and/or, (2) open sourced software other than the software licensed under the GPL.

The software categorized as (1) - (2) are distributed in the hope that it will be useful, but WITHOUT ANY WARRANTY, without even the implied warranty of MERCHANTABILITY or FITNESS FOR A PARTICULAR PURPOSE. Please refer to the detailed terms and conditions thereof shown in the "Software License" menu on this product.

At least three (3) years from delivery of this product, Panasonic Corporation will give to any third party who contacts us at the contact information provided below, for a charge no more than our cost of physically performing source code distribution, a complete machine-readable copy of the corresponding source code covered under GPL V2.0 or the other licenses with the obligation to do so, as well as the respective copyright notice thereof.

Contact Information: cdrequest@unipf.jp

The source code and the copyright notice are also available for free in our website below.

<http://www.unipf.jp/dl/DTV13ET/>

Panasonic Warranty

1. The product is warranted for 12 months from the date of purchase. Subject to the conditions of this warranty Panasonic or its Authorised Service Centre will perform necessary service on the product without charge for parts or labour, if in the opinion of Panasonic, the product is found to be faulty within the warranty period.
2. This warranty only applies to Panasonic products purchased in Australia and sold by Panasonic Australia or its Authorised Distributors or Dealers and only where the products are used and serviced within Australia or its territories. Warranty cover only applies to service carried out by a Panasonic Authorised Service Centre and only if valid proof of purchase is presented when warranty service is requested.
3. This warranty only applies if the product has been installed and used in accordance with the manufacturer's recommendations (as noted in the operating instructions) under normal use and reasonable care (in the opinion of Panasonic). The warranty covers normal domestic use only and does not cover damage, malfunction or failure resulting from use of incorrect voltages, incorrect installation, accident, misuse, neglect, build-up of dirt or dust, abuse, maladjustment of customer controls, mains supply problems, thunderstorm activity, infestation by insects or vermin, tampering or repair by unauthorised persons (including unauthorised alterations), introduction of sand, humidity or liquids, commercial use such as hotel, office, restaurant, or other business or rental use of the product, exposure to abnormally corrosive conditions or any foreign object or matter having entered the product.
4. This warranty does not cover the following items unless the fault or defect existed at the time of purchase:

(a) Cabinet Part(s) (b) Video or Audio Tapes (c) SD cards or USB devices (d) User replaceable Batteries etc	(e) DVD, Blu-ray, or Recordable Discs (f) Video / Audio Heads from wear and tear in normal use (g) Information stored on Hard Disk Drive, USB stick or SD card (h) DTV reception issues caused by TV Aerial / Cabling / Wall socket(s)
--	---
5. Some products may be supplied with Ethernet connection hardware. The warranty is limited on such products and will not cover
 - (a) Internet and or DLNA connection / setup related problems
 - (b) Access fees and or charges incurred for internet connection
 - (c) The use of incompatible software or software not specifically stipulated in the product operations manual; and
 - (d) Any indirect or consequential costs associated with the incorrect use or misuse of the hardware, its connection to the internet or any other device.
6. To claim warranty service, when required, you should:
 - Telephone Panasonic's Customer Care Centre on 132600 or visit our website referred to below and use the Service Centre Locator for the name/address of the nearest Authorised Service Centre.
 - Send or take the product to a Panasonic Authorised Service Centre together with your proof of purchase receipt as a proof of purchase date. Please note that freight and insurance to and / or from your nearest Authorised Service Centre must be arranged by you.
 - Note that home or pick-up/delivery service is available for the following products in the major metropolitan areas of Australia or the normal operating areas of the nearest Authorised Service Centres:
 - Plasma/LCD televisions / displays (screen size greater than 103 cm)
7. The warranties hereby conferred do not extend to, and exclude, any costs associated with the installation, de-installation or re-installation of a product, including costs related to the mounting, de-mounting or remounting of any screen, (and any other ancillary activities), delivery, handling, freighting, transportation or insurance of the product or any part thereof or replacement of and do not extend to, and exclude, any damage or loss occurring by reason of, during, associated with, or related to such installation, de-installation, re-installation or transit.

Panasonic Authorised Service Centres are located in major metropolitan areas and most regional centres of Australia, however, coverage will vary dependant on product. For advice on exact Authorised Service Centre locations for your product, please telephone our Customer Care Centre on 132600 or visit our website and use the Service Centre Locator.

In addition to your rights under this warranty, Panasonic products come with consumer guarantees that cannot be excluded under the Australian Consumer Law. If there is a major failure with the product, you can reject the product and elect to have a refund or to have the product replaced or if you wish you may elect to keep the goods and be compensated for the drop in value of the goods. You are also entitled to have the product repaired or replaced if the product fails to be of acceptable quality and the failure does not amount to a major failure.

If there is a major failure in regard to the product which cannot be remedied then you must notify us within a reasonable period by contacting the Panasonic Customer Care Centre. If the failure in the product is not a major failure then Panasonic may choose to repair or replace the product and will do so in a reasonable period of time from receiving notice from you.

THIS WARRANTY CARD AND THE PURCHASE DOCKET (OR SIMILAR PROOF OF PURCHASE) SHOULD BE RETAINED BY THE CUSTOMER AT ALL TIMES

If you require assistance regarding warranty conditions or any other enquiries, please visit the **Panasonic Australia** website www.panasonic.com.au or contact by phone on **132 600**
If phoning in, please ensure you have your operating instructions available.

Panasonic Australia Pty. Limited

ACN 001 592 187 ABN 83 001 592 187

1 Innovation Road, Macquarie Park NSW 2113

PRO-031-F11 Issue: 4.0

01-01-2011

WARRANTY - New Zealand only

WE WARRANT that the Panasonic Television that you have purchased is free from defects in material and workmanship under normal home use and service.

Accordingly, we undertake to repair, or at our option, replace without cost to the owner, either for material or labour, any part which within 12 months from the date of delivery is found to be defective, provided that the appliance has been used for domestic purposes only and in accordance with the instructions given in the Instruction Book and not been subjected to misuse, neglect or installed, dismantled, repaired or serviced by any other than an authorised Panasonic New Zealand Dealer or Panasonic New Zealand Authorised Service Centre.

NOTE

- Before reporting a fault, please ensure that you read the item "Troubleshooting" in the information section of your Panasonic Instruction Book.
- It is important to retain your proof of purchase as this will be required by the serviceman or retailer as proof of purchase date, should service be required.
- In the event of service being required, contact your Panasonic New Zealand retailer or Panasonic New Zealand Authorised Service Centre.

IMPORTANT

Any request for warranty service must be through an Authorised Panasonic New Zealand Service Centre who during the period of the warranty, undertakes to make any necessary adjustment and fit any replacement part supplied by the manufacturer, during normal working hours, or alternatively will arrange for such service to be provided by some other Panasonic New Zealand Authorised Service Centre.

NEW ZEALAND

Distributed in New Zealand by Panasonic New Zealand Limited

350 Te Irirangi Drive East Tamaki, Private Bag 14911, Panmure Auckland

Tel. 09 272 0100

Customer Care Center

Email: Customerservice@nz.panasonic.com

www.panasonic.co.nz

Information on Disposal in other Countries outside the European Union



This symbol is only valid in the European Union. If you wish to discard this product, please contact your local authorities or dealer and ask for the correct method of disposal.

Customer's Record

The model number and serial number of this product may be found on its rear panel. You should note this serial number in the space provided below and retain this book, plus your purchase receipt, as a permanent record of your purchase to aid in identification in the event of theft or loss, and for Warranty Service purposes.

Model Number _____

Serial Number _____

Panasonic Corporation

Web Site: <http://www.panasonic.com>

© Panasonic Corporation 2016

F0116-0

Printed in Malaysia