

Troubleshooting guide

Before requesting service, make the following checks. If you are in doubt about some of the check points, or if the remedies indicated in the chart do not solve the problem, consult your dealer for instructions.

No operation.
The hold function is on. Switch the function off.
Poor reception status. A lot of noise or distortion.
<ul style="list-style-type: none">• (For AM broadcasting) reorient the unit.• (For FM broadcasting) change the length or reception angle of the rod antenna.• You may have difficulty in listening to the radio inside a building or on a vehicle because of weakened radio waves. Use as near a window as possible.• If the unit is used near another radio or electronic equipment such as TV or video, interference may occur, generating noise. Try turning off the power of the nearby radio, TV, video, etc.• If the unit is suddenly transported from a cool place to a warm place, it may not operate normally. This is because condensation could have occurred in the operating part of the unit. With the power turned off, leave the unit as it is until it conforms to room temperature. After about 60 minutes, it is restored to normal.• Moving a mobile phone close to the unit can cause noise. Use the unit away from any mobile phone.• When the remaining battery level becomes low, decrease in the sound volume or sound distortion can occur. Crank the handle to charge or replace the dry-cell batteries.

No sound comes out of the unit.
The volume sets to the minimum. Adjust with the [VOL] button.
The unit was hand cranked and charged, but it cannot be operated.
The battery selector switch in the [DRY BATTERY] position. Switch to [RECHARGEABLE BATTERY].
Dry-cell batteries were put in the unit, but it does not operate on the dry-cell batteries.
The battery selector switch in the [RECHARGEABLE BATTERY] position. Switch to [DRY BATTERY].

Even after the rechargeable batteries are charged, the runtime is shorter than usual.
<ul style="list-style-type: none">• The runtime may become shorter if the rechargeable batteries are charged for the first time or after hours of nonuse. They are restored to normal after repeated use.• When battery runtime is extremely shorter than normal even if it is charged, it would be considered to be at the end of its life. The built-in rechargeable batteries are designed specifically for this unit. Please contact the sales store where you bought the unit or your local service representative to request for replacement of the rechargeable batteries.

The display panel light often flickers or goes out.
When the battery level becomes low, the display light tends to flicker or go out. Crank the handle to charge or replace the dry-cell batteries.

Care and use

To reduce risk of radio interference caused by headphone-, earphone- or microphone cables, only use adequate accessories with a cable length of less than 3 m.

- **Unit**
 - Avoid using or placing this unit near sources of heat.
 - To avoid product damage, do not expose this product to rain, water or other liquids.
 - The unit's speaker does not have magnetic shielding. Do not place the unit near televisions, personal computers, magnetized cards (bank cards, commuter passes) or other devices easily influenced by a magnet.
 - If the unit and a mobile phone are being used in close proximity to each other, keep the two away from each other.
 - Check the operating status of the unit about once every 6 months.

- **Batteries**
 - Do not peel off the covering on batteries and do not use the batteries if the covering has been peeled off.
 - Align the poles ⊕ and ⊖ correctly when inserting the battery.
 - Remove the battery if you do not intend to use the unit for a long time.
 - Do not heat or expose to flame.
 - Do not leave the battery(ies) in a car exposed to direct sunlight for a long period of time with doors and windows closed.
 - Battery mishandling can cause electrolyte leakage which can damage items the leaked fluid comes into contact with. If electrolyte leaks from the batteries, consult your dealer. Wash thoroughly with water if electrolyte comes in contact with any part of your body.
 - Keep the LR03 (AAA size) batteries out of reach of children to prevent swallowing. Accidental swallowing of batteries can result in stomach and intestinal damage.
 - When carrying batteries in a pocket or bag, ensure no metal objects such as necklaces are placed together with them. Contact with metal may cause short-circuiting which can cause a fire. For safety, carry the batteries in a battery carrying case.

- **Allergies**
 - Discontinue use if you experience discomfort with the earphones or any other parts that directly contact your skin.
 - Continued use may cause rashes or other allergic reactions.

Precautions for listening with the Headphones or Earphones

- Do not play your headphones or earphones at a high volume. Hearing experts advise against continuous extended play.
- If you experience a ringing in your ears, reduce volume or discontinue use.
- Do not use while operating a motorized vehicle. It may create a traffic hazard and is illegal in many areas.
- You should use extreme caution or temporarily discontinue use in potentially hazardous situations.
- Even if your headphones or earphones are the open-air type designed to let you hear outside sounds, don't turn up the volume so high that you can't hear what's around you.

Disposal of the unit

When disposing of the used product, remove the built-in rechargeable batteries, and extend your cooperation to a recycling program.

- Take the removed rechargeable batteries to your local store participating in such a recycling program as soon as possible.

Never disassemble the unit except when disposing of it.
<ul style="list-style-type: none">• Disassemble the unit after the rechargeable batteries are all used up.• If dry-cell batteries are used, keep them removed.



Danger

The rechargeable batteries are designed specifically for the unit Do not use for any other equipment

Do not charge the removed rechargeable battery.

- **Do not throw into a fire or heat**
- **Do not pierce with a nail, subject to impact, or disassemble / remodel**
- **Do not connect a metal piece or a thing like that between the positive ⊕ and negative ⊖ terminals**
- **Do not break or peel off the external seal**
- **Do not transport or store together with necklaces, hair pins, etc.**
- **Do not heat in a microwave or oven**
- **Do not charge, use, or leave the battery near a heat source or at high temperature**

Doing so may cause leakage, heating, ignition or explosion.



Warning

Keep removed screws out of the reach of infants and children

Adverse health effects can result from accidental swallowing.

- Should you suspect an infant or child has swallowed it, immediately seek medical attention.

Do not touch leaking batteries with bare hands

- If leaking solution gets into the eyes, it could result in loss of vision. Do not rub the eyes. Immediately rinse with clean water and then seek medical attention.
- Contact of the solution with your skin or cloth could cause injury or skin inflammation. Immediately rinse with clan water and then seek medical attention.

■How to remove rechargeable batteries

The illustration is intended to describe how to dispose of the unit but not how to repair it. Once disassembled, it is impossible to reassemble.

- Using a screwdriver, follow the procedure below to disassemble. (No screwdriver is supplied)
- Please contact the store where you bought the unit or your local service representative if you cannot remove the batteries.

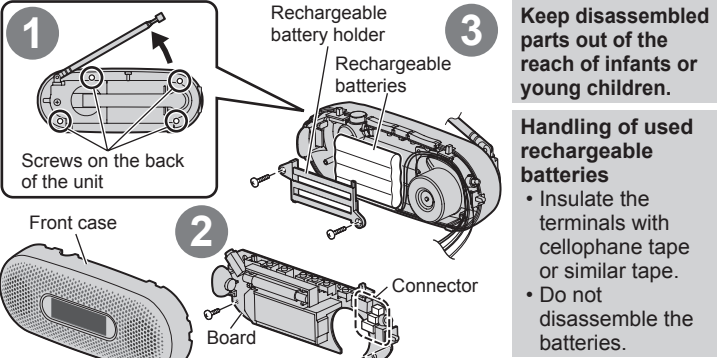

- 1 Remove 4 screws on the back side of the unit**
 - Remove the front case.
- 2 Remove 3 connectors from the board and unscrew 2 screws in the board**
 - Remove the board.
- 3 Remove 2 screws from the part holding the rechargeable batteries**
 - Remove the rechargeable batteries.

Maintenance

Clean this unit with a dry and soft cloth.

- If the unit becomes too dirty, wring a cloth moistened in water, wipe the dirt with it and clean with a dry cloth.
- Do not use solvents including benzene, thinner, alcohol, kitchen detergent, a chemical wiper, etc. This might cause the exterior case to be deformed or the coating to come off.

Specifications

Power	Rechargeable battery DC 4.8 V 300 mAh (Equipped with 4 nickel-metal hydride rechargeable battery pack)
	Dry-cell battery DC 4.5 V (3 LR03 (AAA size) batteries)
Received frequency	FM: 87.50 MHz to 108.00 MHz (0.05 MHz step) AM: 522 kHz to 1629 kHz (9 kHz step) AM: 520 kHz to 1630 kHz (10 kHz step)
Speaker	2.8 cm Round 16 Ω 2pcs (monaural)
Headphone terminal	Recommended impedance 8 Ω φ3.5 mm (monaural)
Mobile phone charging jack	DC OUT MAX 5 V 0.5 A (For turn of the handle at a rate of about 120 revolutions per minute)
Max. effective output power	250 mW (With rechargeable batteries in use) 230 mW (With dry-cell batteries in use)

	Power	
	Panasonic alkaline battery	Rechargeable battery* (built-in) (At an output power of approx. 1 mW)
FM	approx. 24 h.	approx. 14 min.
AM	approx. 24 h.	approx. 14 min.
LIGHT	approx. 100 h.	approx. 3 h.
SIREN	approx. 20 h.	approx. 20 min.

	*: For the handle turn at a rate of about 120 revolutions per minute for 1 minute.
Max. outer dimensions	144.5 (W) x 55.6 (H) x 59.0 (D) mm
Main body dimensions	140.4 (W) x 54.4 (H) x 52.0 (D) mm
Mass	Approx. 288 g (with batteries) Approx. 254 g (without batteries)
Operating temperature range	0 °C to 40 °C
Operating humidity range	20%RH to 80%RH (no condensation)

- Depending on the use conditions, the battery runtime may become shorter.
- Specifications are subject to change without notice.

8

Limited Warranty (ONLY FOR AUSTRALIA)

Panasonic Warranty

- The product is warranted for 12 months from the date of purchase. Subject to the conditions of this warranty Panasonic or its Authorised Service Centre will perform necessary service on the product without charge for parts or labour, if in the opinion of Panasonic, the product is found to be faulty within the warranty period.
- This warranty only applies to Panasonic products purchased in Australia and sold by Panasonic Australia or its Authorised Distributors or Dealers and only where the products are used and serviced within Australia or its territories. Warranty cover only applies to service carried out by a Panasonic Authorised Service Centre and only if valid proof of purchase is presented when warranty service is requested.
- This warranty only applies if the product has been installed and used in accordance with the manufacturer's recommendations (as noted in the operating instructions) under normal use and reasonable care (in the opinion of Panasonic). The warranty covers normal domestic use only and does not cover damage, malfunction or failure resulting from use of incorrect voltages, incorrect installation, accident, misuse, neglect, build-up of dirt or dust, abuse, misadjustment of customer controls, mains supply problems, thunderstorm alterations, introduction by insects or vermin, tampering or repair by unauthorised persons (including unauthorised businesses or rental use of the product), exposure to abnormally corrosive conditions or any foreign object or matter having entered the product.
- This warranty does not cover the following items unless the fault or defect existed at the time of purchase:
 - (a) Cabinet Part(s)
 - (e) DVD, Blu-ray or Recordable Discs
 - (f) Video / Audio Heads from wear and tear in normal use
 - (g) SD cards or USB devices
 - (h) DTV reception issues caused by TV Aerial / Cabling / Wall socket(s) etc
- Some products may be supplied with Ethernet connection hardware. The warranty is limited on such products and will not cover:
 - (a) Internet and or DLNA connection / setup related problems
 - (b) Access fees and or charges incurred for internet connection
 - (c) The use of incompatible software or software not specifically stipulated in the product operations manual; and
- Any indirect or consequential costs associated with the incorrect use or misuse of the hardware, its connection to the internet or any other device.

To claim warranty service, when required, you should:

- Telephone Panasonic's Customer Care Centre on 132600 or visit our website referred to below and use the Service Centre Locator for the name/address of the nearest Authorised Service Centre.
- Send or take the product to a Panasonic Authorised Service Centre together with your proof of purchase receipt as a proof of purchase date. Please note that freight and insurance to and / or from your nearest Authorised Service Centre must be arranged by you.
- Note that home or pick-up/delivery service is available for the following products in the major metropolitan areas of Australia or the normal operating areas of the nearest Authorised Service Centres:
 - Plasma/LCD televisions / displays (screen size greater than 103 cm)

The warranties hereby conferred do not extend to, and exclude, any costs associated with the installation, de-installation or re-installation of a product, including costs related to the mounting, de-mounting or re-mounting of any screen, (and any other ancillary activities), delivery, handling, freight, transportation or insurance of the product or any part thereof or replacement of and do not extend to, and exclude, any damage or loss occurring by reason of, during, associated with, or related to such installation, de-installation, re-installation or transit.

Panasonic Authorised Service Centres are located in major metropolitan areas and most regional centres of Australia, however, coverage will vary dependant on product. For advice on exact Authorised Service Centre locations for your product, please telephone our Customer Care Centre on 132600 or visit our website and use the Service Centre Locator.

In addition to your rights under this warranty, Panasonic products come with consumer guarantees that cannot be excluded under the Australian Consumer Law. If there is a major failure with the product, you can reject the product and elect to have a refund or to have the product replaced or if you wish you may elect to keep the goods and be compensated for the drop in value of the goods. You are also entitled to have the product repaired or replaced if the product fails to be of acceptable quality and the failure does not amount to a major failure.

If there is a major failure in regard to the product which cannot be remedied then you must notify us within a reasonable period by contacting the Panasonic Customer Care Centre. If the failure in the product is not a major failure then Panasonic may choose to repair or replace the product and will do so in a reasonable period of time from receiving notice from you.

THIS WARRANTY CARD AND THE PURCHASE DOCKET (OR SIMILAR PROOF OF PURCHASE) SHOULD BE RETAINED BY THE CUSTOMER AT ALL TIMES

If you require assistance regarding warranty conditions or any other enquiries, please visit the **Panasonic Australia** website www.panasonic.com.au or contact by phone on **132 600** *If phoning in, please ensure you have your operating instructions available.*

Panasonic Australia Pty. Limited

ACN 001 592 187 ABN 83 001 592 187
1 Innovation Road, Macquarie Park NSW 2113

PRO-031-F11 Issue: 4.0

01-01-2011

Panasonic®

Operating Instructions

FM-AM 2-Band Receiver



Model No. **RF-TJ10**

Dear customer

Thank you for purchasing this product. Please read these instructions carefully before using this product, and save this manual for future use.

-If you see this symbol-



Information on Disposal in other Countries outside the European Union

This symbol is only valid in the European Union. If you wish to discard this product, please contact your local authorities or dealer and ask for the correct method of disposal.

Panasonic Corporation
Web Site: <http://panasonic.net>

© Panasonic Corporation 2013

GN

VQT5F82
M1013KZ0

Part names

Front of the unit

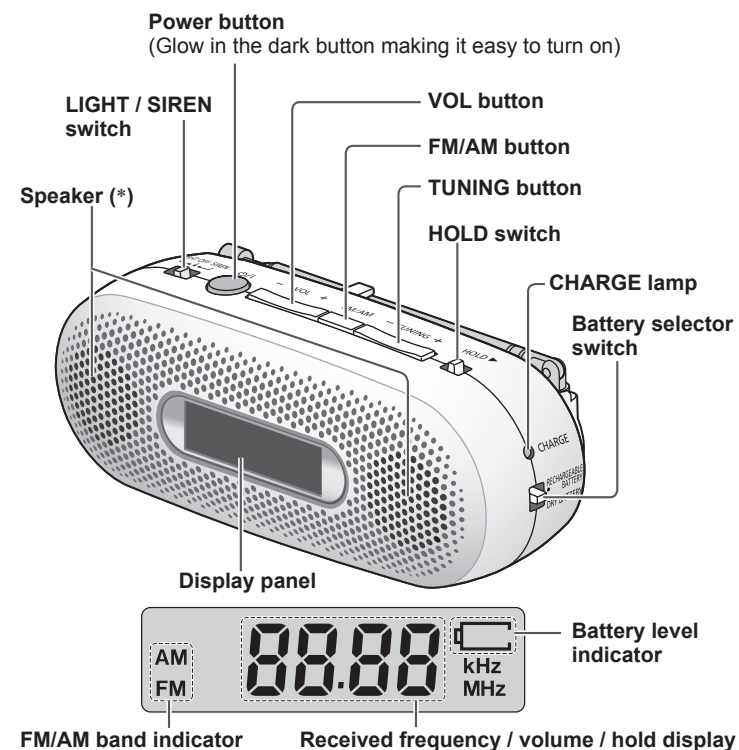

- If you attempt to operate the [VOL], [FM/AM] or [TUNING] button or the [HOLD] switch when the power is on or when the power has been turned on, the display panel light comes on. After a little while, it goes off.

Rear of the unit

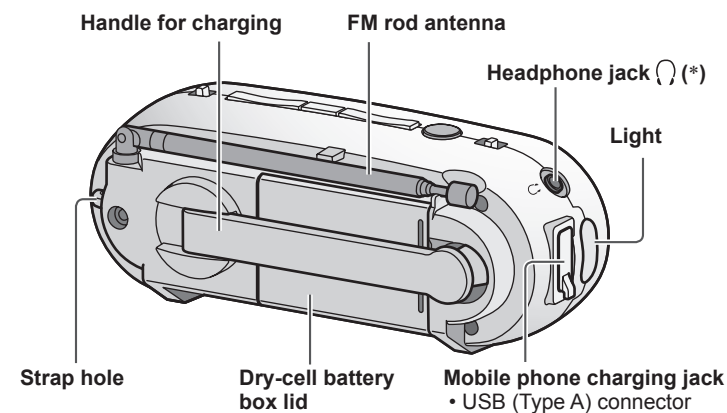

(*) The unit's output is monaural. The right / left speakers and headphones play the same sound.

Headphone (commercial) listening

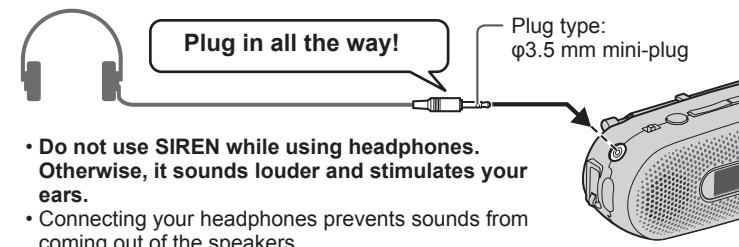

Battery preparations

Hand crank battery charging

The unit can operate on the power from the built-in rechargeable batteries that you have charged by cranking the handle for charging. The rechargeable batteries built into the unit are charged irrespective of whether the battery selector switch is in [RECHARGEABLE BATTERY] or [DRY BATTERY] position.

1 Pull out the handle

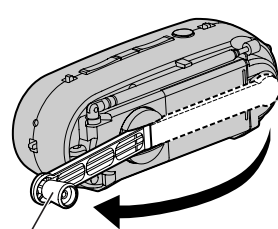

Handle

- Crank in either direction.
- First, turn slowly. Then, increase the speed of cranking and keep up a good enough speed to light the charge lamp.

2 Crank the handle to charge the batteries

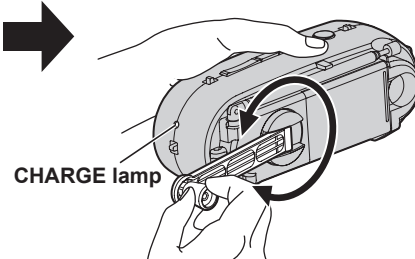

CHARGE lamp

Notice

- Retract the FM rod antenna in place before cranking the handle.
- The power generation amount depends on your speed of cranking the handle. Additionally, cranking too fast can cause your wrist to hurt or the unit to malfunction. So, crank at a rate of less than 120 revolutions per minute.
- Prolonged, continuous cranking operation may cause the unit to malfunction, so when you keep operating the handle for a prolonged time, have about 1 minute of pause for every 2 or 3 minutes of operation.
- If the rechargeable battery is not used for a long time, the rechargeable battery performance may degrade. Charge the batteries once every 6 months by cranking at a rate of about 120 revolutions per minute for 2 to 3 minutes, and make sure the unit is entirely operational.

Note

- With the battery selector switch in the [RECHARGEABLE BATTERY] position, when the unit runs out of the rechargeable batteries, the [CHARGE] lamp starts blinking.
- The rechargeable batteries can be charged during radio reception, but noise may interfere with radio broadcasting. So it is recommended to keep the unit turned off while charging them.

Use of dry-cell batteries (sold separately)

1 Pull out the handle and open the battery box lid

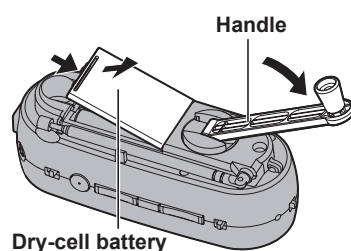

Dry-cell battery box lid

Note

- Due to their extremely short battery runtime, the use of manganese dry-cell batteries is discouraged.
- With the battery selector switch in the [DRY BATTERY] position, when the unit runs out of the dry-cell batteries, the [CHARGE] lamp starts blinking. When replacing the dry-cell batteries, replace all of the three with new ones.
- It is advisable to turn the unit off before replacing the dry-cell batteries.
- If the unit will not be used for a long time, remove the dry-cell batteries from it.

CAUTION

- Danger of explosion if battery is incorrectly replaced. Replace only with the type recommended by the manufacturer.
- When disposing of the batteries, please contact your local authorities or dealer and ask for the correct method of disposal.

Radio listening

1 Select the power source



- Set the battery selector switch to a power source to be used.

2 Power on the unit



- To power off the unit, press [P/I] again.

3 Choose either AM or FM



- Each time you press the button, the display is switched between "AM" ↔ "FM".

4 Tune in the desired station



- Each time you press the button, the frequency changes.
- When the TUNING button, [-] or [+], is held down for at least 1 second, automatic station selection is started, and it is stopped as the radio is tuned to the first station to be received.
- Depending on the particular reception status, you may not be able to use automatic station selection. When automatic station selection is not stopped, press either TUNING [-] or [+] to quit.

5 Adjust the volume



Hint for improving reception status

AM

Adjust the unit's orientation.

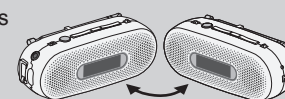

FM

Raise the rod antenna to adjust its length, orientation and reception angle.



AM frequency step

The step is factory-set to 9 kHz, but you can change it to receive broadcasts allocated to 10 kHz steps.

1. Press [FM/AM] to "AM" mode.
 2. Press and hold [FM/AM].
- When "520" is displayed, frequency step will be set to "10 kHz", or when "522", it will be set to "9 kHz".

Mobile phone charging

Personal equipment like a mobile phone can be charged by connecting via a charging cable to the unit. It is charged only when the handle is being cranked.

1 Connect a charging cable (not supplied) between your smart-phone or mobile phone and the unit

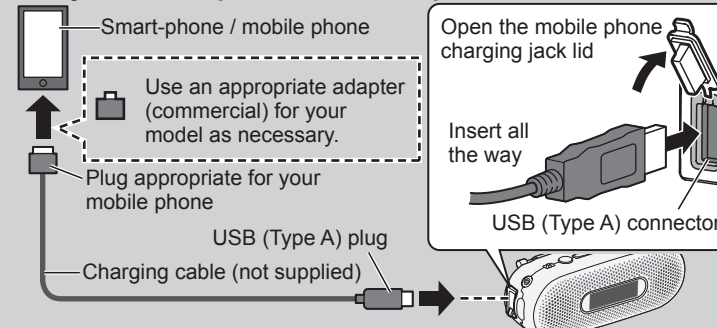

2 Crank the handle to charge the batteries

- The charge lamp is lit while charging is in progress. Crank at a speed that allows the lamp to stay lit. (The built-in rechargeable batteries are also charged)
- Crank in either direction.
- It can be charged even when the battery selector switch is either in [RECHARGEABLE BATTERY] or [DRY BATTERY] position.

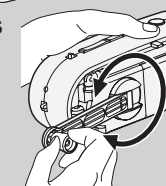

Useful functions

Set the LIGHT / SIREN switch to a function you want to use.

SIREN

An audible alarm is generated.

LIGHT

The light turns on.

- To stop an audible alarm or turn off the light, set the switch to "OFF".

Note

- SIREN or LIGHT can be used irrespective of whether the radio is powered on / off.
- The audible alarm starts out soft and then becomes louder.
- The volume of the audible alarm or the brightness of the light is unalterable.
- The audible alarm volume and the light brightness vary according to the type of the batteries used or the remaining battery level.
- Some surrounding conditions may keep you from hearing the audible alarm.

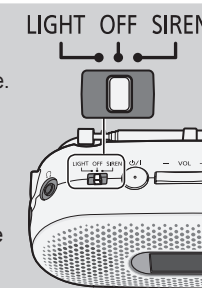

Operating error prevention (HOLD)

Sliding HOLD to the [▶] side disables the [P/I], [VOL], [FM/AM] and [TUNING] buttons.

The function prevents such an operation error as the one that could occur while the unit is put on charge. In addition, while the unit is carried in a bag with you, it blocks the unit from powering up even when the button is inadvertently pressed. (Display: HOLD)

- To deactivate HOLD, slide the switch left back in "OFF".

Note

- SIREN or LIGHT can be used even while HOLD is on.
- The unit or a mobile phone can be charged with a hand crank even during HOLD in use.

