



To maintain purification performance, the cartridge must be replaced periodically.

Replacement cartridge part numbers

- Sediment Cartridge: TK-CS50C1SD
 - Advanced ECO RO Cartridge: TK-CS80C1RM (for TK-AS80-DA)
 - Advanced ECO RO Cartridge for soft water: TK-CS80C1NF (for TK-AS80-DAN)
 - Post Carbon Cartridge: TK-CS80C1PC
- See page 12.

Thank you for purchasing this Panasonic product.

- Please read these instructions carefully before using this product, and save this manual for future use.
- **Be absolutely sure to read the "Safety Precautions" (see pages 2 to 5) before use to ensure that you use the product safely.** After reading the manual, keep it in a safe place along with the warranty in case you need to refer to it later.
- Be absolutely sure to check that the purchase date has been entered on the warranty card.

Panasonic Corporation
http://panasonic.net/
© Panasonic Corporation 2014

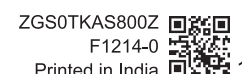

Contents

Features2
 Safety Precautions2
 Tips to ensure proper operation5
 Part names6
 Control Panel and Functions7
 Operation8
 Maintenance10
 Water Flow Diagram11
 Construction Sketch11
 Troubleshooting12
 Specifications14
 Contact Details14

Features

- ▶ **This product can generate 2 levels of Alkaline Ion Water by electrolyzing the purified water.**
- ▶ **Clean water is provided with the Advanced ECO RO Technology. 7 Stage water control process**
 1. Non woven filter
 2. Cloth filter
 3. Activated carbon block
 4. Advanced ECO RO cartridge
 5. Post carbon cartridge
 6. UV disinfection
 7. Alkalizer
- ▶ **Monitor safe water with sensing function**
 - LED Indicator for replacement of the cartridge.
 - Monitors the operation of the UV, and automatically shuts down when an error occurs.

Safety Precautions

To reduce the risk of injury, loss of life, electric shock, fire, and damage to property, always observe the following safety precautions.

Explanation of symbols

The following symbols are used to classify and describe the level of hazard, injury, and property damage caused when the denotation is disregarded and improper use is performed.

	WARNING	Denotes a potential hazard that could result in serious injury or death.
	CAUTION	Denotes a hazard that could result in minor injury.
	NOTICE	Denotes a hazard that could result in property damage.

Safety Precautions (continued)

The following symbols are used to classify and describe the type of instructions to be observed.

- This symbol is used to alert users to a specific operating procedure that must not be performed.
- This symbol is used to alert users to a specific operating procedure that must be followed in order to operate the unit safely.

WARNING

- Insert the power plug firmly.**
 - If the plug is not inserted properly, electric shocks or a fire caused by heat generation may result.
 - Do not use a damaged plug or loose power outlet.
- Remove the dust or other foreign matter on the power plug periodically.**
 - If dust or other foreign matter is allowed to build up on the plug, moisture or other factors may lead to defective insulation which, in turn, may cause a fire.
 - Disconnect the power plug, and wipe it with a dry cloth.
- Stop use immediately and unplug the power plug when there are aberrations or malfunctions.**
 - Failure to do this may cause smoke generation, fire ignition or electric shock.
 - <Examples of aberrations or malfunctions>
 - Product does not operate when switched on
 - Electrical current is conducted or not conducted if the power cord is moved
 - Burning smells or strange noises generated while product is being operated
 - Product gets misshapen or abnormally hot
 - Unplug the power cord, have the product inspected and repaired.

This appliance is not intended for use by persons (including children) with reduced physical, sensory or mental capabilities, or lack of experience and knowledge, unless they have been given supervision or instruction concerning use of the appliance by a person responsible for their safety. Children should be supervised to ensure that they do not play with the appliance. -It may cause burns, injury or electric shock.

- Do not disassemble by yourself or remodel the unit.**
 - Doing so can lead to a fire and/or electric shocks.

Do not damage the power cord or power plug in any way by, for instance:

- Using staples () to secure it
- Scratching it
- Re-working it
- Bending it unnaturally
- Twisting it
- Pulling it
- Positioning it too close to a heating appliance
- Placing heavy objects on it
- Bundling it
- Pinching it or sandwiching it
- Standing on it.
- Using a damaged cord or plug can lead to electric shocks, short circuit and/or a fire.
- **When disconnecting the power plug from the power outlet, take hold of the moulded part of the plug rather than the cord itself, and pull the plug free.**
 - If the supply cord is damaged, it must be replaced by the manufacturer, its service agent or similarly qualified persons in order to avoid a hazard.
- Do not use the power outlet or wiring device at levels beyond its ratings, and supply only 230 V ±15% AC voltage to the unit.**
 - If the ratings are exceeded because too many electrical cords have been connected to a single outlet, a fire caused by heat generation may result.

Warranty

Panasonic India Private Limited

CERTIFICATE OF WARRANTY **CUSTOMER COPY**

Dear Customer,

Thank you for buying this Panasonic product. This card entitles you to enjoy one year warranty on your product purchased in India only. For any assistance please contact our Help Line Number.

Product: _____

Model No.: _____ Sl. No. _____

Customer Name: _____

Address: _____

Tel. No.: _____ Mobile No. _____

Date of Purchase: _____ Date of Expiry: _____

Invoice No.: _____

Dealer Name and Address: _____

Help Line (24 Hours 7 Days): 1800 103 1333 / 1860 425 1860, 044-42889222.
 Email: helpline@in.panasonic.com
 Panasonic India Private Limited, 6th Floor "SPIC BUILDING" ANNEXE, No. 88, Mount Road, Guindy, Chennai – 600 032.

Safety Precautions (continued)

- Do not use aluminium containers that do not stand up to alkaline or copper containers that do not stand up to acids.**
 - Doing so may cause discolouration of the containers or damage them.
- Do not connect tubes and other devices to the faucet.**
 - Doing so may result in water leaks or otherwise affect performance.
- Do not cover the faucet, or bend, twist or flatten the tubes.**
 - Doing so may result in water leakage, or not producing water with the appropriate pH.
- Do not spray water on or wash the unit.**
 - Doing so may result in electric leakage or electric shock.
- Do not keep any heavy or dangerous objects on top of the machine.**
 - This may damage the unit.

NOTICE

- Please keep in mind that the manufacturer of the product will not be responsible for any product malfunctioning or accidents resulting from the improper operation of the product.
- Repair of the unit should be handled only by a service dealer. (See page 14.) In case of cartridge replacement, always call a service dealer. (See page 14.)
- This appliance cannot be used during a power failure.
- If this appliance is used during water failure, the water will stop flowing when the water in the tank is emptied.
- Clean the tank once in every 15 days for better hygiene.

Tips to ensure proper operation

DO'S:

- Replace the cartridge once the cartridge indicator starts blinking.
- Always keep the tank lid closed to avoid exposure of the purified water to airborne diseases.
- Install the machine away from direct sunlight.

DON'TS:

- Do not use any cartridge other than those specified.

Part names

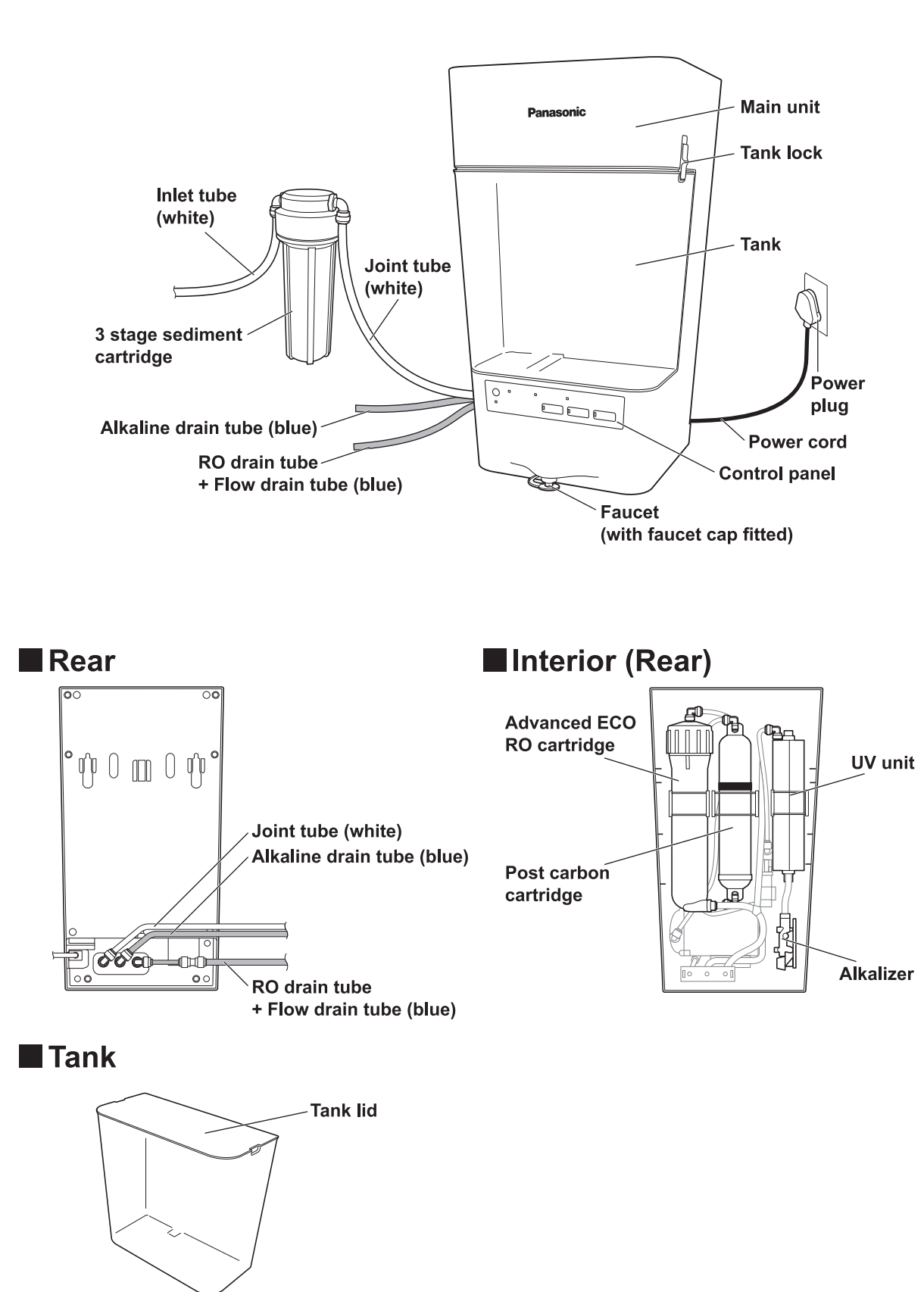

- Do not connect or disconnect the power plug with wet hands.**
 - Doing so can lead to electric shocks.
- If the unit falls into water by mistake, disconnect its power plug from the power outlet, and take the unit out of the water.**
 - Touching the unit while it is in water or wet may cause electric shocks.
- Do not allow water above 40 °C in temperature to pass through the unit.**
 - You may scald yourself if you do so.
- Do not use undrinkable water.**
 - Doing so can lead to adverse health effects.

CAUTION

- When the unit is not in use, fit the faucet cap. (See page 9.)**
 - Water left inside the unit may drip.
- When the unit is not in use, close the ball valve. (See page 11.)**
 - Damage to property may result in the unlikely event of a water leak.
- People with the following conditions should consult a doctor before drinking alkaline ion water.**
 - People who is receiving medical treatment from a doctor
 - People with health problems or weakened constitution (People who are not feeling well)
 - Persons with renal disease
 - Failure to do this may cause health problems.
- Stop drinking alkaline ion water and consult a doctor if you feel unwell after drinking the water.**
 - Failure to do this may cause health problems.
- First time users should consume small quantities (1 to 2 cupfuls) starting at the "Alkaline level 1" setting for about 2 weeks, and then start using the "Alkaline level 2" setting. Follow the above precautions to get used to alkaline ion water.**
 - Drinking strong alkaline ion water from the beginning, or drinking large amounts (more than 3 cups) may result in health problems.
- When storing alkaline ion water or purified water for future consumption, pour it into a clean sealed container, and consume it within 24 hours if it is kept at room temperature or within 2 days if it is kept in the refrigerator.**
 - The unit removes sterilizers and disinfectants (such as chlorine) so the water may go bad over time, possibly causing health problems.
- Perform the following when the product is not going to be used for a few days:**
 - Remove the water from the tank.
 - Close the inlet water connection and discharge the purified water through the faucet.
- Always unplug the power plug when removing the tank.**
 - Water supply will not stop.
- Do not place the unit on objects that are likely to be troubled by leaking water.**
 - Damage to property may result in the unlikely event of a water leak.
- Persons with renal disease (renal failure, potassium elimination impairment) should not drink alkaline ion water.**
 - Doing so may result to health problems.
- Do not drink the following kinds of water:**
 - Water which comes out of the drain tube
 - Water which comes out of the faucet while any of the Purified Water/Alkaline Level 1/Alkaline Level 2 lamps are flashing
 - Doing so may cause health problems.
- Do not take medicine with alkaline ion water.**
 - Doing so may cause health problems.
- Do not use alkaline ion water or purified water for fish tanks.**
 - The environment may change as a result, and the fish, etc may die.

Control Panel and Functions

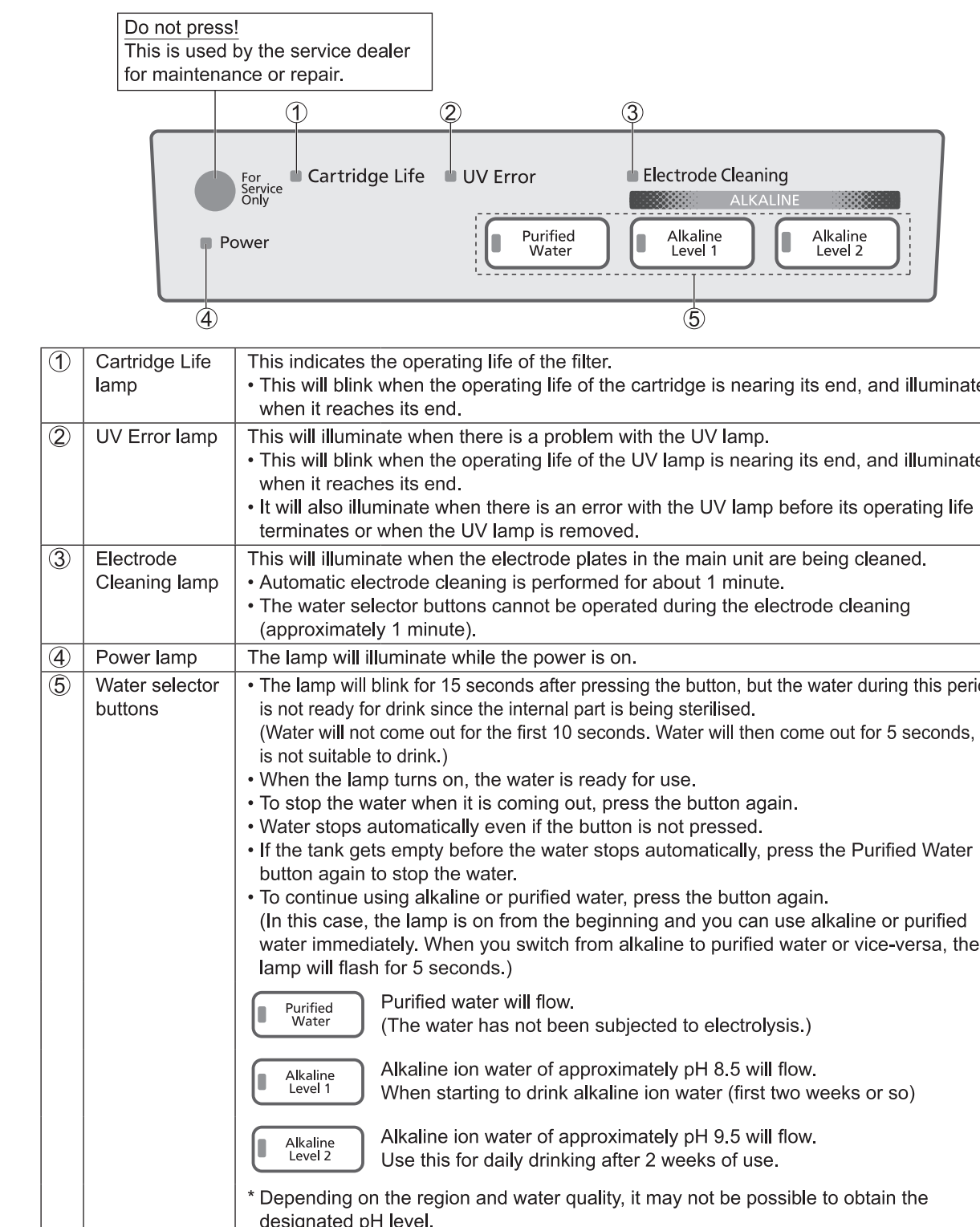

Operation

Check that there is water in the tank before use.
Water will not flow if the level is below the water valve.

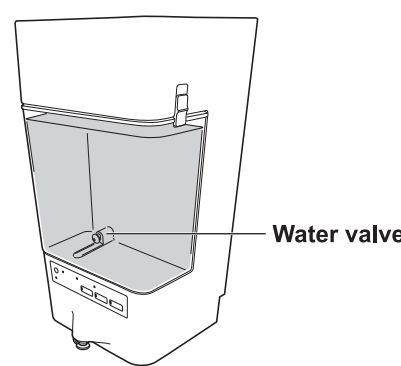

- Please handle the faucet cap with clean hands. Touching it with dirty hands may cause bacteria to adhere to the faucet.
- Fold the faucet cap away before use so that it avoids the water during discharge.

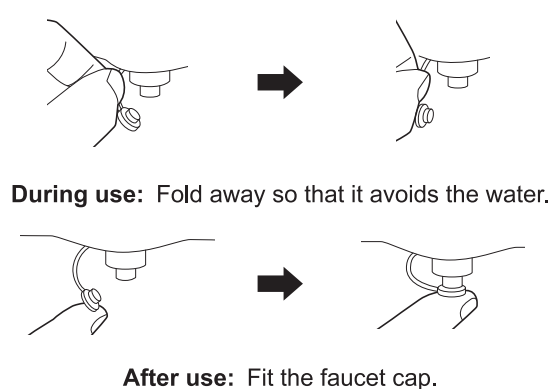

Producing Alkaline Ion Water

1. Remove the faucet cap.
2. Press **Alkaline Level 1** or **Alkaline Level 2**.
• The selected lamp flashes.
3. After approximately 15 seconds, the lamp will stop flashing (lamp stays on), and alkaline ion water will flow. (Do not drink water that comes out while the lamp is flashing.)
4. Stop the water by pressing **Alkaline Level 1** or **Alkaline Level 2**.
• The water will stop automatically even if the button is not pressed.
5. Fit the faucet cap.

Water quality	Application	pH level
Alkaline Level 2	Daily drinking	9 to 10
Alkaline Level 1	New users (first two weeks or so)	8 to 9
Purified Water	For taking medicine, diluting baby formula, drinking, etc.	—

* Above pH will differ depending on the dispensing pump quality of the tap water. When the cartridge is new, the pH level may be somewhat higher; this is normal and does not indicate any trouble.

Producing Purified Water

1. Remove the faucet cap.
2. Press **Purified Water**.
• The lamp flashes.
3. After approximately 15 seconds, the lamp will stop flashing (lamp stays on), and purified water will flow. (Do not drink water that comes out while the lamp is flashing.)
4. Stop the water by pressing **Purified Water**.
• The water will stop automatically even if the button is not pressed.
5. Fit the faucet cap.

NOTE: If water does not come out when the Purified Water button is pressed even when there is water in the tank, fill the tank with water, press Alkaline Level 1 or Alkaline Level 2 button, and run water through for approximately 15 seconds.

Maintenance (Perform Periodically)

Cleaning the Main Unit

- Soak a soft cloth in water, wring it out well, and use it to wipe the units and parts.

Cleaning the Tank

- When inside of the tank becomes dirty, clean it using the following procedure.
 - Be careful when removing the tank since any water left inside the unit can run out.
1. Press the Purified Water button and drain the water until the tank is empty. Press the button again and stop the water once the tank is empty.
• Water is drained from the faucet, so collect it using a pot or something similar and use it to wash the tank.
 2. Unplug the power plug.
 3. Unlock by sliding the tank lock (2 locations) upward. Slide the tank lock firmly upward.
 4. Holding both sides of the tank, remove the tank from the main unit by moving it forward.
 5. Remove the tank lid.
 6. Clean inside the tank using a clean cloth and let it dry completely.
• Use the water collected in the pot to clean the tank.
 7. Attach the tank lid to the tank.
• Securely fasten the tank lid (or dust, etc., may get into the tank).
 8. Align the tank guide on the main unit with the groove on the tank, and insert the tank all the way into the main unit.
• Securely insert the tank all the way.
 9. Plug in the power plug.
 10. Fill the tank with water.
 11. Press the Alkaline Level 1 or Alkaline Level 2 button and run water through for approximately 15 seconds. (Sometimes water may not come out when the Purified Water button is pressed.)

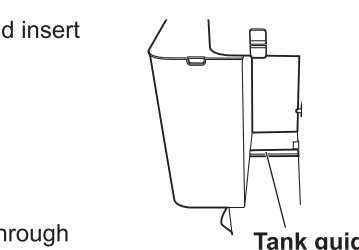
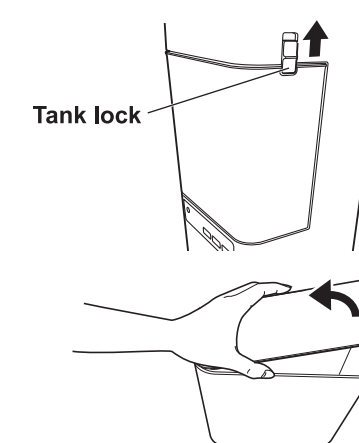

Requests

Do not open or close the water valve, or cause it to become distorted.

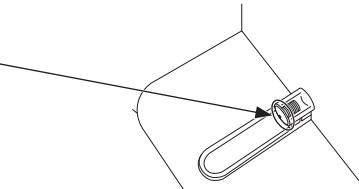

Water Flow Diagram

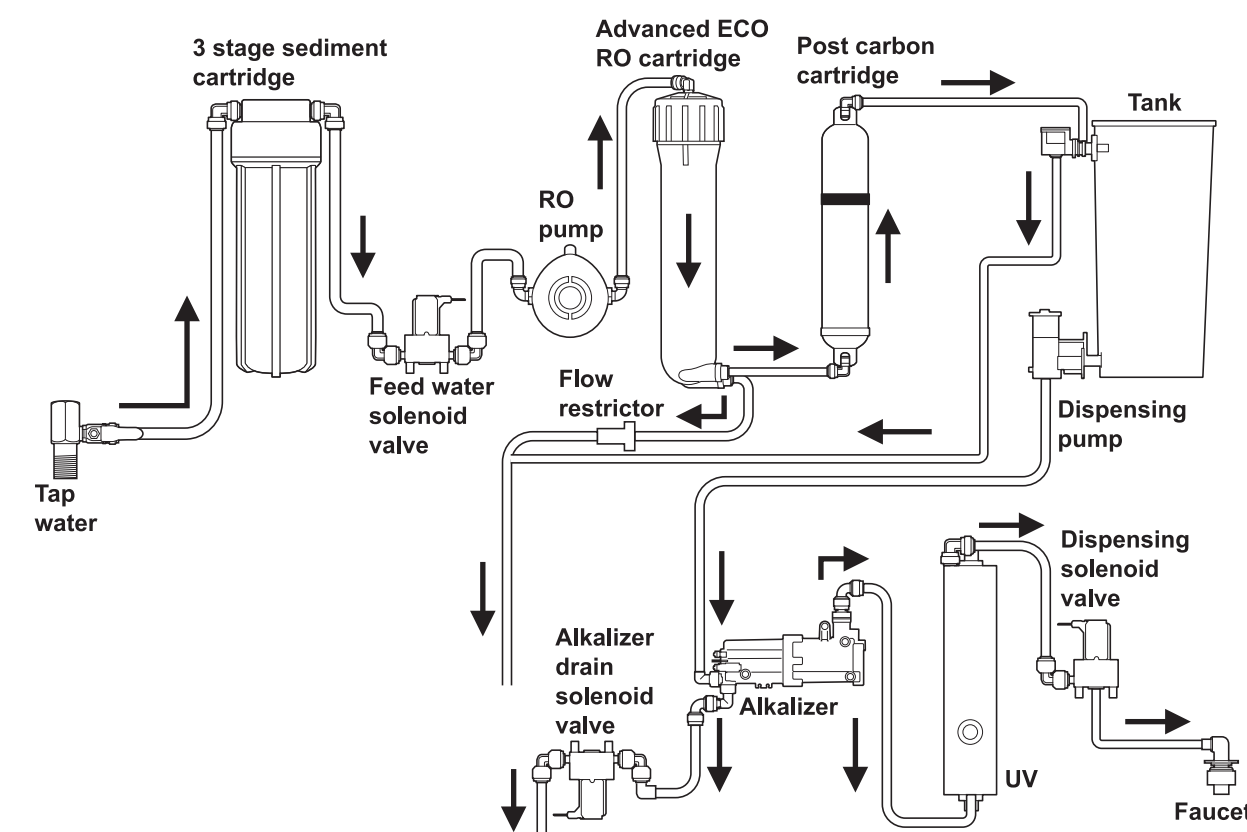

Construction Sketch

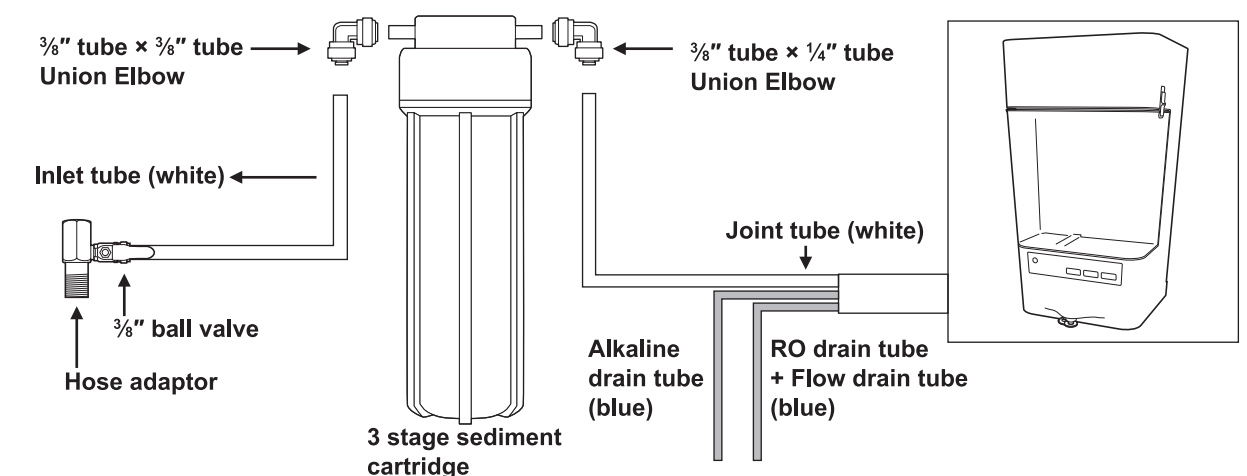

NOTE: The illustrations in this manual are for explanation purposes only and may differ from the actual unit. It is subjected to change without notice for future improvement.

Troubleshooting

If you think that something is wrong with the unit, check out the following points before requesting repairs. If you decide that trouble has occurred, do NOT attempt to disassemble and repair the unit by yourself, but contact your service dealer.

Symptom	Cause and remedial action	Page
None of the lamps on the main unit light up.	<ul style="list-style-type: none"> • Is there a power failure? → Wait until the power is restored. • Is the power cord plugged in? → Plug in the power plug. 	5 6
Tank does not become full.	<ul style="list-style-type: none"> • Is the power lamp illuminated? → Check above items. • Has the water supply been cut off? → Wait until the water supply is restored. • Is the tap water valve closed? → Open the tap water valve. • Has the flow at the faucet been reduced too much? → Open up the tap water valve. • Is the faucet cap still fitted? → Remove the faucet cap. • Is the inlet tube, drain tube or joint tube bent or flattened? → If it is, straighten it out. • Has the Cartridge Life Lamp lit? → If it has, replace the cartridge. (Call the service dealer and check the cartridge.) • Cartridge is choked. → Replace the cartridge. (Call the service dealer and check the cartridge.) • When the ambient temperature or water pressure is low, the water supply may stop automatically after specific time has elapsed even if the tank is not full. → Press the "Purified Water" button. 	12 5 11 11 9 6 7, 14 14 7
No water is discharged from the unit.	<ul style="list-style-type: none"> • Is the power lamp illuminated? → Check above items. • Is the faucet cap still fitted? → Remove the faucet cap. 	12 9
Water does not come out when the Purified Water button is pressed.	<ul style="list-style-type: none"> • A large amount of air has accumulated in the piping and the Dispensing pump is running in a dry state. → Fill the tank with water, press the Alkaline Level 1 or Alkaline Level 2 button, and run water through for approximately 15 seconds to discharge the air from the inner portion. (Air is discharged from the inner portion by running alkaline ion water through.) 	9, 10

Symptom	Cause and remedial action	Page
The water produced by the unit has an odour or unpleasant taste or is turbid.	<ul style="list-style-type: none"> • Is the tank dirty? → Clean the tank. (Clean the tank approximately once every 15 days.) • The purified water in the tank might have been kept for a long time. (Has the product not been used for a few days? Is the water in the tank getting old?) → Drain the water, clean the tank and fill fresh water again. • The ability of the cartridge to remove odours, unpleasant tastes and turbidity has deteriorated. → Replace the cartridge. (Call the service dealer and check the cartridge.) • After replacing the Advanced ECO RO cartridge, you may smell a sour smell. (In new Advanced ECO RO cartridges, a preservative fluid is used to maintain the quality of the cartridge.) → The preservative fluid poses no safety risk. However, if you are concerned about the smell, throw away the first tank of water before use. 	5, 10 5, 10 14 —
Water comes out from the drain tube (blue tube) on its own.	<ul style="list-style-type: none"> • Water is caused to flow out from the drain tube while the water is flowing from the faucet by pressing the "Purified Water", "Alkaline Level 1", or "Alkaline Level 2" buttons. → This is not a malfunction. • When the power plug is plugged in, water will come out from the drain tube until the tank is full of water. → This is not a malfunction. • Is the Electrode Cleaning lamp blinking? → This product has a feature to periodically perform automatic cleaning to keep the electrodes clean. This is not a malfunction. 	— — 7
The Cartridge Life lamp does not illuminate even when it is used for a long period of time.	<ul style="list-style-type: none"> • This product calculates the life of the filter from the time the water is purified with the cartridge. Therefore, the time for the lamp to illuminate will differ depending on conditions in the usage environment such as daily water usage, water quality, etc. → This is not a malfunction. 	—
The power lamp is blinking.	<ul style="list-style-type: none"> • Call the service dealer. (Replacement of the cartridge or repair of the equipment is required.) 	14

Specifications

Model No.	TK-AS80	
Rating	230 V ~ 50 Hz 1 A	
Power Consumption	Approx. 90 W (approx. 2 W during standby)	
RO pump Voltage	24 V =	
UV Lamp Wattage	11 W	
UV Lamp Life	11 000 h ^{*1}	
Maximum Water Flow ^{*2}	1.1 L/min	
Inlet Water Temperature	0 °C – 40 °C	
Inlet Water Pressure	50 kPa to 200 kPa	
Minimum Inlet Water TDS ^{*3}	More than 300 mg/L (TK-AS80-DA)	50 – 300 mg/L (TK-AS80-DAN)
Install cartridge (membrane) (Replacement cartridge)	TK-CS80C1RM	TK-CS80C1NF
Purification Capacity	Approx. 12 L/h (at 100 kPa water pressure) ^{*4}	
Rejection of Salts	80 % – 90 % (TK-AS80-DA) (NaCl-500 mg/L, 25 °C, at 100 kPa water pressure) ^{*4}	40 % – 60 % (TK-AS80-DAN) (NaCl-200 mg/L, 25 °C, at 100 kPa water pressure) ^{*4}
Recovery	25 % – 40 % (TK-AS80-DA) (NaCl-500 mg/L, 25 °C, at 100 kPa water pressure) ^{*4}	25 % – 50 % (TK-AS80-DAN) (NaCl-200 mg/L, 25 °C, at 100 kPa water pressure) ^{*4}
pH Level	Alkaline Level 1: 8 – 9 ^{*4} Alkaline Level 2: 9 – 10 ^{*4}	
Electrolyzer Life Cumulative	Approx. 425 h ^{*4}	
Cartridge Life	3 Stage Sediment Cartridge Advanced ECO RO Cartridge Post Carbon Cartridge	Approx. 4 000 L ^{*4} Approx. 8 000 L ^{*4} Approx. 8 000 L ^{*4}
Length of Power Cord	Approx. 2 m	
Dimensions	280 (W) × 230 (D) × 485 (H) mm	
Weight	Approx. 8.1 kg (approx. 14.5 kg when full of water)	
Storage Capacity	Approx. 6 L	

*1 As per lamp manufacturer's specification

*2 The water flow value that represents the capability of the UV unit.

*3 TDS: Total Dissolved Solids

*4 Will differ depending on conditions in the usage environment such as water quality, etc.

Contact Details

- Help Line: Panasonic Customer Care: 1860-425-1860, 1800-103-1333
- Email: helpline@in.panasonic.com
- Panasonic India Private Limited, 6th Floor "SPIC BUILDING" ANNEXE, No. 88, Mount Road, Guindy, Chennai – 600 032

Panasonic India Pvt. Ltd. Certificate of Warranty: Terms and Conditions

1. Panasonic India Pvt. Ltd. having registered office at 6th Floor "SPIC BUILDING" ANNEXE, No. 88, Mount Road, Guindy, Chennai – 600 032, warrants the Alkaline Ionizer for **One year** from the date of purchase. This warranty covers only the repairs and does not entitle you for replacement of this product.
2. The customer has to provide original warranty card at the time of using our services. The warranty card should have a legible dealer stamp and date of purchase. In case the dealer stamp is not there or if the same is not legible, customer has to show the purchase receipt, failing which the warranty will not be honored.
3. Warranty takes care of any manufacturing defect or breakdown of the product during warranty period. Panasonic India Pvt. Ltd., hereinafter referred to as "Company", at its sole discretion will repair or replace such parts and defective parts could become the property of the Company. Repair under warranty may also be carried out by any Authorized Service Centre of the Company.
4. Warranty does not cover free replacement of cabinets and styling materials, aesthetic material frames, plastic parts & accessories/ consumables such as Post Carbon cartridge, Sediment Filter, Advanced ECO RO cartridge, Water Pipe, External Motor Pump, etc.
5. In the event the Company carries out repairs or replacement of any part during the said warranty period, the warranty shall thereafter continue only for the remaining period of the warranty.
6. This warranty does not cover any form of damage resulting from dust, foreign object, fire, water, input voltage beyond specifications, not, mistanding, commercial use, lightning, flood or any act of natural and use contrary to the operations specified in the user's manual supplied with the equipment.
7. This warranty is valid only in the country of purchase (India only).
8. The warranty is not valid when the unit is operated with other than Municipal Corporation and Well Water conditions which are above 40°C.
9. Company will not accept any responsibility for damage arising out of unauthorized modification or alteration, precipitates or biological growth, improper maintenance, repair or use of this product or any accessories/attachments other than those specified by the Company.
10. Company will not cover any responsibility for damage or loss arising out of mishandling incurred during transit.
11. The warranty is not valid if serial number of equipment is mutilated, detached or altered.
12. This warranty does not cover the cost of transportation of the product from the place of installation to the service centre.
13. The Company shall not be liable or be deemed to be in default for any delay or failure in performance resulting directly or indirectly from causes beyond its reasonable control including delay in repairing due to non-availability of any component and/or accessory, labour problem, restrictions and regulations of the government, public movement, war and any unavoidable circumstances, specially vis-a-vis the import of supplies, sickness/illness due to consumption of drinking water from improperly maintained purifier, and raw material or if the company is otherwise prevented from performing its functions under this warranty.
14. Any defect in the electrical/plumbing installation or wiring/piping at site has to be rectified by the customer as per the recommendation of our engineers.
15. In the event of any difference or dispute arising with reference to the terms and conditions of the warranty or there interpretation, the same shall be referred to a sole arbitrator, who shall be appointed by the Company's Managing Director. The decision of the sole arbitrator shall be final and binding on the parties. Such arbitration proceedings shall be held at Chennai and provision of the Arbitration & Conciliation Act 1996 shall apply to the arbitration proceedings.

Panasonic	Panasonic	Panasonic	Panasonic
Customer * This coupon is valid for one year from date of purchase of the product. * Each coupon is valid for one service request only. * Cut and hand over coupon to the Authorized Service Representative after completion of one warranty service.	Customer * This coupon is valid for one year from date of purchase of the product. * Each coupon is valid for one service request only. * Cut and hand over coupon to the Authorized Service Representative after completion of one warranty service.	Customer * This coupon is valid for one year from date of purchase of the product. * Each coupon is valid for one service request only. * Cut and hand over coupon to the Authorized Service Representative after completion of one warranty service.	Customer * Installation/Demo Service is the privileged service offered by Panasonic. This coupon is valid for one month from date of purchase of the product. * This coupon is valid for one installation request only. * Cut and hand over coupon to the Authorized Service Representative after completion of the installation/Demo.
Service agent * Fill in all necessary details and obtain customer signature. * Attach the coupon to your service claim job-sheet.	Service agent * Fill in all necessary details and obtain customer signature. * Attach the coupon to your service claim job-sheet.	Service agent * Fill in all necessary details and obtain customer signature. * Attach the coupon to your service claim job-sheet.	Service agent * Fill in all necessary details and obtain customer signature. * Attach the coupon to your service claim job-sheet.