

# FBA08A (80□ x 25.5<sup>L</sup>)



eMINEBEA.COM

## 一般仕様 General Specifications

- ◇許容環境温度範囲：-10℃ to +70℃ (65%RH) (Operating)  
-40℃ to +75℃ (65%RH) (Storage)  
実用上さしつかえない状態で結露無きこと
- ◇ Allowable Ambient Temperature Range :  
-10℃ to +70℃ (65%RH) (Operating)  
-40℃ to +75℃ (65%RH) (Storage)  
No such condensation as hinders practical use

## 期待できる寿命 Expected Life

- ※故障率 10%  
50,000時間 (40℃, 65%RH)
- ※ Failure rate 10%  
50,000 hours (40℃, 65%RH)

## 外觀図 Outline

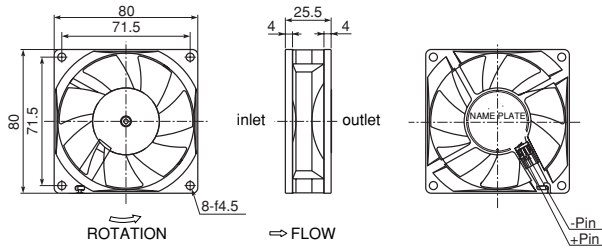

※ Housing with solid corner type are available.

## 特性曲線 Characteristic Curves

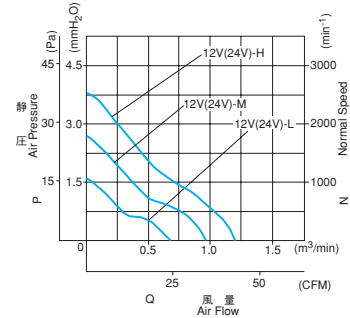

## 取付穴参考寸法 Panel Out-cuts

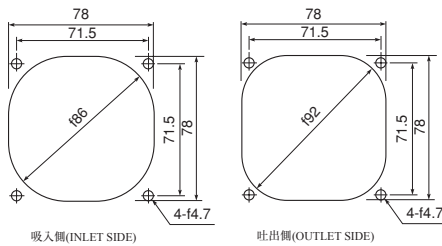

## 材質 Material

- ◇軸受 : ハイドロウェーブベアリング
- ◇Bearing : Hydro Wave Bearing

## 仕様 Specifications

型式 Model	定格電圧 Rated Voltage	使用電圧範囲 Operating Voltage	定格電流 Current	定格入力 Input Power	定格回転速度 Rated Speed	最大風量 Maximum Air Flow		最大静圧 Maximum Air Pressure		騒音 Noise
	(V)	(V)	(mA)*1	(W)*1	(min <sup>-1</sup> )*1	(m <sup>3</sup> /min)*1	(CFM)*1	(Pa)*1	(mmH <sub>2</sub> O)*1	(dB-A)*1
FBA08A12L	12	7 to 13.8	68	0.82	1900	0.68	24.0	15.4	1.57	21.0
FBA08A12M			124	1.49	2450	0.91	32.1	24.6	2.51	28.0
FBA08A12H			173	2.08	2950	1.12	39.6	37.1	3.78	32.0
FBA08A24L	24	14 to 27.6	54	1.30	1900	0.68	24.0	15.4	1.57	21.0
FBA08A24M			71	1.70	2450	0.91	32.1	24.6	2.51	28.0
FBA08A24H			105	2.52	2950	1.12	39.6	37.1	3.78	32.0

回転方向：ラベルから見て時計方向  
風吹き出し方向：ラベル側

Rotation: Clockwise as seen from the label side.  
Airflow Outlet: Label side

\*1: Average Values in Free Air