

## Operating Instructions

Attached Installation Instructions

## 使用说明书

另附安装说明书

Water Purifier

For Household Use

净水机

家庭用

Model No. **TK-CB430**

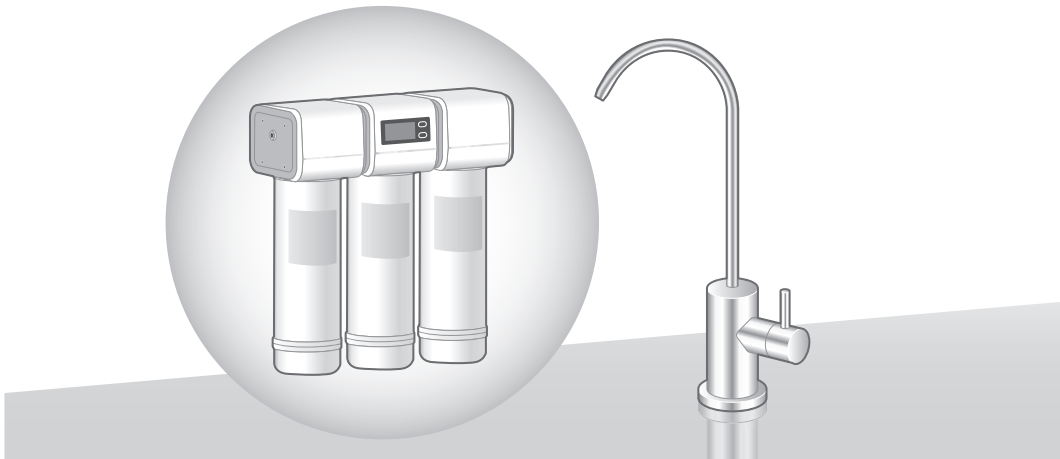

Thank you for purchasing this Panasonic product.

感谢您购买Panasonic的产品。

- Please read these instructions carefully before using this product, and save this manual for future use.
- Please carefully read the “Safety Precautions” (P. EN3 – EN5) of this manual before use.
- Be required to present the purchase receipt for your free warranty service, failing which the company or its authorized service dealer reserves the right to decline any warranty claim.
- Please keep in mind that the manufacturer of the product will not be responsible for any product malfunctioning or accidents resulting from the improper installation or operation of the product.
- 请在安装本产品之前仔细阅读本说明书，并妥善保管以备日后使用。
- 使用前请仔细阅读「安全注意事项」(P. SC3 ~ SC5)。
- 必须出示购买单据才可享有免费保养服务，若无法出示，本公司或其授权服务代理商保留拒绝任何保养及索赔的权利。
- 因错误安装或不正确使用，而造成产品故障或发生事故时，本公司概不负责。

# Contents

<b>Safety Precautions</b> .....	EN3
Operating Precautions.....	EN6
Names and functions of the parts.....	EN7
Steps to Take Before Operation .....	EN8
<b>Installation 1</b> Check the setup and accessories of the Water Purifier .....	EN8
<b>Installation 2</b> Check after installation.....	EN9
<b>Installation 3</b> Inspecting the Quick-connect valve .....	EN9
Use of the Water Purifier .....	EN10
Adjustment of water pressure.....	EN10
Maintenance .....	EN11
Replacing the Batteries .....	EN12
Replacing the Cartridge.....	EN14
About Flushing.....	EN20
When the water supply is cut off.....	EN21
When not using the product for a long period of time.....	EN21
Q&A .....	EN22
Troubleshooting.....	EN23
Optional Accessories .....	EN25
Specifications .....	EN26

# Safety Precautions

Please make sure to follow these instructions

In order to prevent accidents to people or damage to property, always follow the instructions below.

■ **The following is an explanation of danger and damage caused due to incorrect usage according to severity.**



## WARNING

Indicates serious injury or death.



## CAUTION

Indicates risk of injury or property damage.

■ **The symbols are classified and explained as follows.** (The following are examples of symbols.)



This symbol indicates prohibition.



This symbol indicates requirements that must be followed.



## WARNING

### Water supply



- **Use only water (such as tap water) which has been approved for consumption.**  
(Failure to do so may cause health problems.)

- The Water Purifier cannot remove harmful substances other than those listed on P. EN26 or cannot sterilize water.



## CAUTION

### About batteries



- **Do not dispose of batteries in fires, or short circuit or disassemble them.**  
(Doing so may cause burns or injury.)



- **Always adhere to the precautions shown on the battery.**
- **Do not use rechargeable battery instead of dry battery.**
- **Check the ⊕ and ⊖ of the battery, and insert them correctly.**
- **Remove used up batteries as soon as possible.**
- **Use batteries that are within the specification's recommended expiry date.**  
(Failure to do so may cause injury or accidents due to battery heat generation, explosion or fluid leakage.)

### Disassembly prohibited



- **Do not disassemble, repair or remodel the unit.**  
(Doing so may cause of water leakage or malfunction.)  
→ Please contact a dealer or subordinate service station of Panasonic for inspection or maintenance.

# Safety Precautions

Please make sure to follow these instructions



## CAUTION

### About accessories



- **Do not impose strong force or impact force to the Quick-connect valve.**

(Doing so may cause water leakage due to the loosening of the piping connection part.)

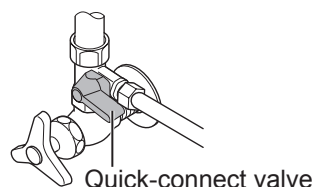

- **Do not block the main spout or bend, twist, flatten, pull or clamp the PE tubes.**

(Doing so may cause water to leak, prevent the output of water or cause other malfunctioning.)

- **Do not connect other devices (such as hoses) to the end of the spout of the Special faucet for the Water Purifier.**

(Doing so may cause water leakage or other malfunctions due to abnormal water pressure of the main unit.)

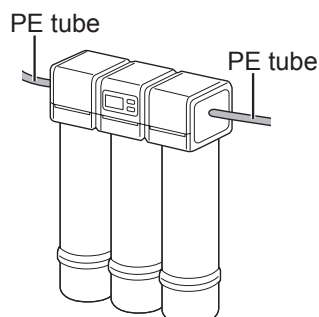

- **The main unit should be used with the Special faucet for Water Purifier and installation accessories.**

(Failure to do so may lead to water leakage.)

- Do not use the main unit and the Special faucet for Water Purifier without the installation accessories.
- Do not reuse old tubes.

- **Contact a dealer or subordinate service station of Panasonic for the installation and removal of the Water Purifier.**

(Incomplete installation and removal may lead to water leakage.)

### Note for the user



- **This appliance is not intended for use by persons (including children) with reduced physical, sensory or mental capabilities, or lack of experience and knowledge, unless they have been given supervision or instruction concerning use of the appliance by a person responsible for their safety.**

(Risk of accident or injury.)

- **Children should be supervised to ensure that they do not play with the appliance.**

(Risk of accident or injury.)

# CAUTION

## Storing purified water



- **Use purified water immediately after it is produced. When storing it for future consumption, pour into a clean sealed container, and consume it within 1 day if it is kept at room temperature or within 2 days if it is kept in the refrigerator.**  
(For chlorine (disinfectant) contained within tap water is removed, which result in general bacteria to increase more and cause health problems.)

## Non-consumable purified water



- **Do not use purified water for the care of fish or other pets.**  
(The environment may change as a result, and the fish, etc. may die.)

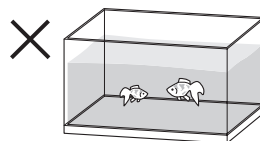

- **In order to avoid health problems, when starting to operate the Water Purifier, do not use the accumulated water inside the main unit for drinking use. Fully flush the water through and out, following the instructions below.**  
(Otherwise it may cause health problems.)

When starting use every day

Use after about 3 liters water flows out (about 2 minutes).

When the Water Purifier has not been used for 3 or more days after replacing the cartridge

Use after letting water drain for more than 10 minutes

## Accidental ingestion



- **Do not leave the supplied accessories within reach of infants or toddlers.**  
(Doing so may result in accessories being swallowed by mistake.)
  - Consult a doctor immediately if you suspect that an accessory has been swallowed.
- **Do not allow infants and children to play with packaging material.**  
(Doing so may cause suffocation.)

# Operating Precautions

## Water supply

- **Do not drink water in case of the following conditions.**
  - Water which is very turbid, or containing a great deal of red rust  
(Doing so may cause health problems.)
  - Well water  
(Doing so may cause health problems.)
  - Water that does not pass as drinking water  
(Doing so may cause health problems.)

## Usage

- **Do not hit the main unit or outlet pipe with heavy items like chopping boards, or subject them to strong impact.**  
(Doing so may cause malfunction.)
- **Do not put cook pot or other objects with high temperature close to the Special faucet for Water Purifier.**  
(Doing so may lead to deformation or malfunction.)
- **Do not place the main unit or piping part in freezing condition.**  
(Doing so may lead to damage, water leakage, or malfunction.)
  - The specification of this Water Purifier is not applicable for cold region.
- **Do not let the movable part or door of a lifting cabinet touch the outlet pipe.**
- **Do not spray insecticide to the main unit, PE tube or other parts of the Water Purifier.**  
(Doing so may cause malfunction.)  
In case of accidental spray, please wipe with wet cloth immediately.
- **Stop using immediately and remove the batteries.**  
(Doing so may cause malfunction.)  
<Examples of abnormality and malfunction>
  - Abnormal sound during operation
  - Abnormal heat or deformation of the Water Purifier→ Contact a dealer or subordinate service station of Panasonic for inspection or maintenance.
- **Do not splash water on the main unit or wash the body.**  
(Doing so may cause malfunction.)

## Usage

- **The Water Purifier usage temperature needs to be between 5 and 38°C, and exceeding 38°C may damage sealing materials and cause water leakage.**
- **Temperatures lower than 5°C may result in freezing and ruptured piping, and cause water leakage.**
  - When the main unit or piping part of the unit is frozen, please close the water stop valve, and contact a dealer or subordinate service station of Panasonic for handling.
- **The cartridge must be installed in the correct order to ensure full functionality. Make sure the installation order is correct.**  
Cartridge installation order  
(1. PP cartridge→2. UF cartridge→3. CB cartridge)
- **Do not install the product upside down.**  
(Doing so may cause malfunction.)
- **When carrying the product, hold under both edges of the main unit.**  
(The upper cover can come off easily, and may fall off, causing damage.)

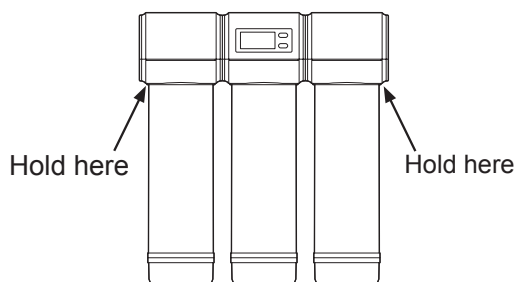

# Names and functions of the parts

## Overall figure

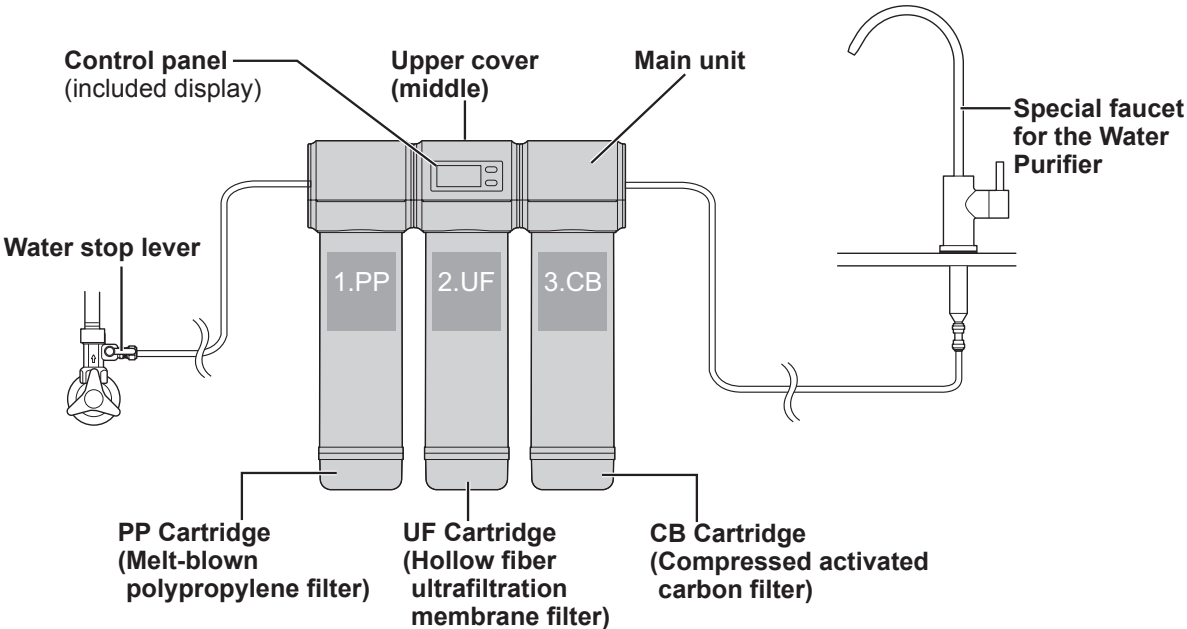

## Control panel

### Battery display “”

- Flashes when the batteries require replacing. (P. EN12)

### Notice to replace “ 预警”

- Flashes that one remaining level of the cartridges has dropped to 1. Please replace the cartridge.

### Water flow “ 制水”

- Flashes for 25 seconds when purified water is flowing.

### Flushing “ 冲洗”

- Flashes for approx. 10 minutes if either of the following occurs. (P. EN20)
  - No water has flowed for 3 days
  - After replacing the cartridges

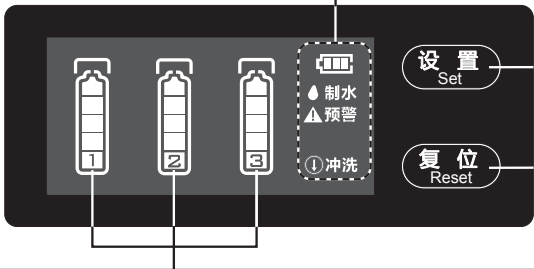

### Setup Button

- Select the replaced cartridge. (P. EN19)

### Reset Button

- Press after replacing the cartridges (P. EN19)

### 1: PP cartridge life display

### 2: UF cartridge life display

### 3: CB cartridge life display

- The cartridge life is shown in 5 levels. (P. EN15)

# Steps to Take Before Operation

## Installation 1

### Check the setup and accessories of the Water Purifier

P. EN8

## Installation 2

### Check after installation

The air in the main unit is not completely exhausted, please drain the purified water for 10 minutes or longer.

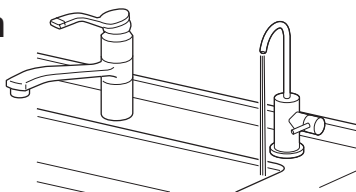

P. EN9

## Installation 3

### Inspecting the Quick-connect valve

P. EN9

## Installation 1

### Check the setup and accessories of the Water Purifier

- In case of any deficiency, please notify your dealer or subordinate service station of Panasonic.
- The main unit shall be installed under the sink and connected with the Special faucet for Water Purifier. (Please check the position where the Quick-connect valve and main unit are set.)

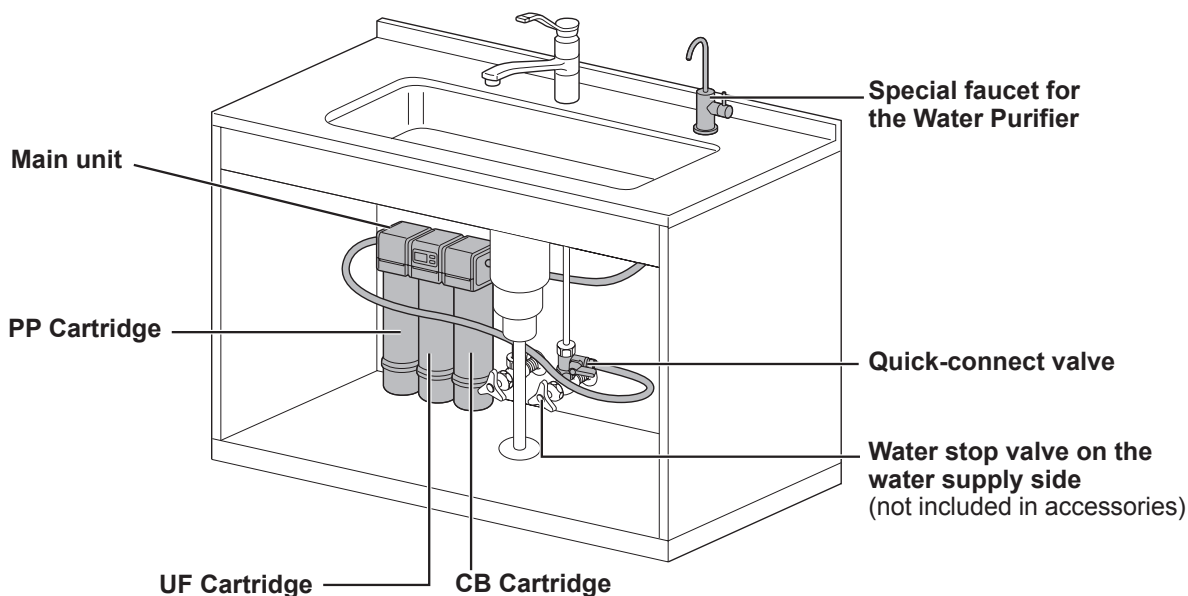

#### Supplied Accessories

##### ☐ Installation instructions

- Please check whether all the items in the final inspection confirmation table (P. EN27 in installation instructions) have been ticked (finished).



## Installation 2 Check after installation

To exhaust the air in the main unit, the purified water shall be drained for 10 minutes or longer.

To use the Water Purifier (P. EN10)

❶ Lower the lever (water is discharged)

❷ Raise the lever (water stops flowing)

- If the air in the main unit is not completely exhausted, the water flow will not be smooth.
- If there are still bubbles remaining in the purified water or it has an unpleasant smell or taste even after flushing for 10 minutes, please flush for an additional 10 minutes.

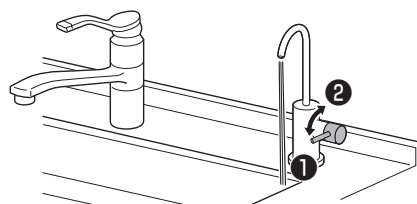

## Installation 3 Inspecting the Quick-connect valve

❶ Close the Quick-connect valve  
(Raise the water stop lever)

- If the water stops flowing from the outlet pipe, the Quick-connect valve is operating correctly.

❷ Please open the Quick-connect valve to use.  
(Lower the water stop lever)

- For how to adjust Quick-connect valve, see "Adjustment of water pressure" (P. EN10).
- If other than above, the Quick-connect valve may have malfunctions, so please contact a dealer or subordinate service station of panasonic.

Water stop lever

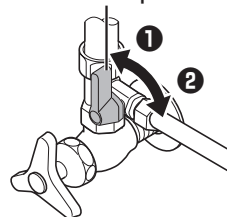

# Use of the Water Purifier

## 1 How to turn on water

- **Lower the lever.**

- If the water is splashing, please raise the water stop valve a little bit.  
(For the water pressure is relatively high.)  
(P. EN10)

- The “ 制水” indicator turns off after flashing for approx. 25 seconds.

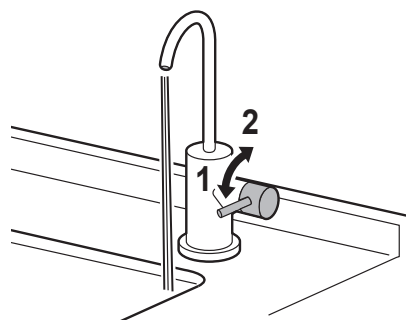

## 2 How to turn off water

- **Raise the lever.**

### Note

- Regularly check for water leakages in the Water Purifier piping.
- If water is discharged when the batteries are flat, the water will be purified however water volume or usage time used as the reference for replacing the cartridge will not be counted, and the cartridge life will not be displayed correctly.

Please check the remaining level of the battery regularly. (See Replacing the Batteries on P. EN12)

# Adjustment of water pressure

- **When the water pressure is relatively high**

Adjust by raising the water stop lever gradually.

- **When the water pressure is relatively low**

Adjust by lowering the water stop lever gradually.

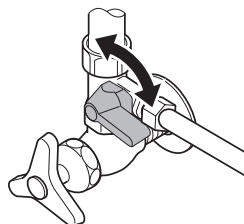

# Maintenance

## Daily maintenance

### The main unit and the Special faucet for Water Purifier

Dip a soft cloth in water and wring it out to wipe the Water Purifier.

- Remove dirt on the Main spout using a cotton swab, etc.  
(If the water for cleaning use is splashed and attached to the main spout, it may result in dirt or daily microbes.)

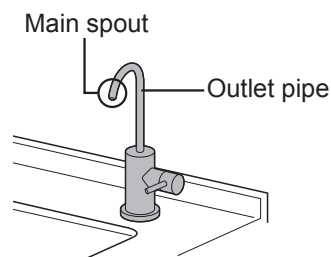
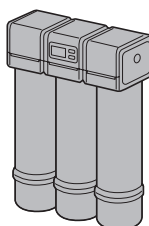

### Important

- Do not use detergent, cleaning powder, diluting agent, volatile oil, ethyl alcohol or kerosene, etc. In case of accidental use, please wipe with wet cloth right away to remove the detergent, etc. on the surface.  
(Detergent mixed into the water run through may lead to resin crack, electroplating damage, electroplating or coating spalling, discoloration or deformation.)
- Detergent may lead to unsmooth outflow in the outlet pipe and result in malfunction.
- Do not use metal brush or other apparatus. (Doing so may lead to damage.)
- Avoid bringing the main unit into contact with water by spraying it with water or washing. (Doing so may cause malfunction.)
- Tighten the Locking nut if the Special faucet is loose or spinning. (Installation Instructions P. EN15)  
(Doing so may cause of water leakage.)

# Replacing the Batteries

- “” is flashing, please replace with the new batteries.
- Prepare 3 AAA alkaline batteries.  
Use of batteries not specified will significantly shorten the usage time.

- 1 Remove the upper cover (middle).**
  - 1 Push the fitting portions deep inside the holes using a flared screwdriver. (2 locations)**
  - 2 Open the upper cover (middle) slowly.**

- The wiring are behind upper cover (middle) and there is a risk of disconnection.

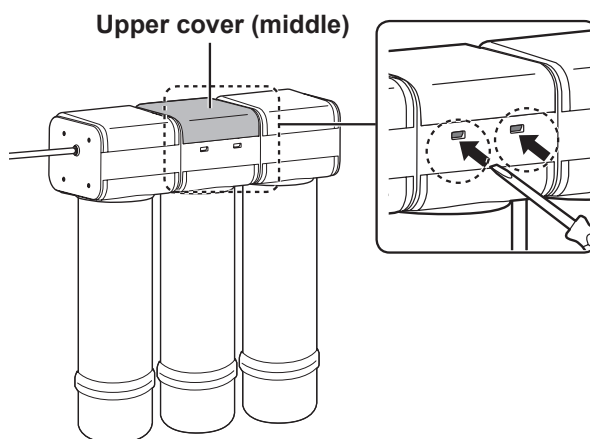

- 2 Remove the battery cover and replace the batteries.**

- 1 Slide in the direction of the arrow.**

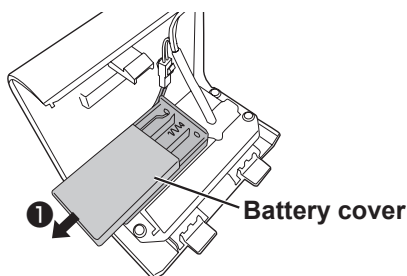

- 2 Check ⊕ and ⊖, and insert the batteries all the way. (Beep will sound)**

- Check that there is no foreign object on the battery ⊕ and ⊖ (terminals).
- The display will light up for approximately 25 seconds and then turn off. Pressing the button after the display turns off will make it light up again.

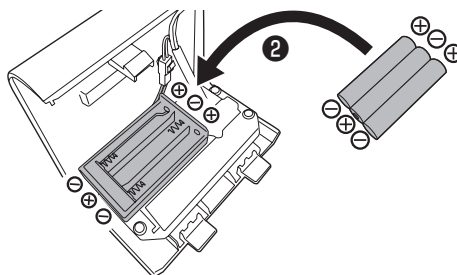

- 3 Slide in the direction of the arrow until it clicks.**

- Take care not to pull the wiring.

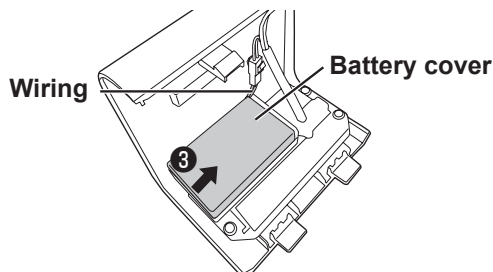

- 3** Install the upper cover (middle).  
① Insert the claw structure in two holes from inside.  
② Press the front upper part of the upper cover (middle).

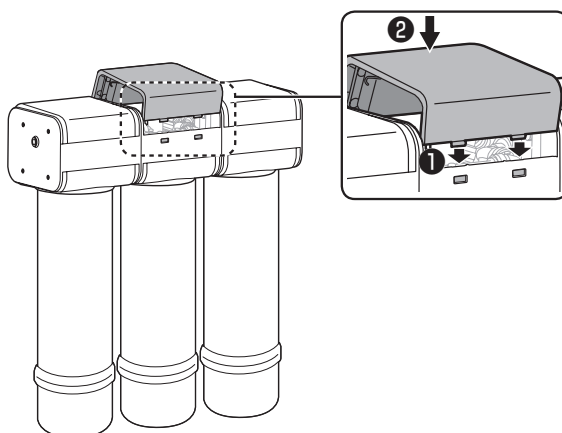

#### Reference of battery usage time

- Three AAA Panasonic alkaline batteries would last for approximately 1 year.  
(Battery usage time may differ depending on the usage environment)

#### Note

- When inserting batteries, wipe the main unit so that no water droplets get inside.
- Always use 3 AAA alkaline batteries.
- Panasonic batteries are recommended.

# Replacing the Cartridge

When the cartridge life is to be expired or the purified water ability is reduced, please replace the cartridge with a new one.



Replacement PP cartridge  
Model: TK-F4PP0-EX  
(P. EN25)



Replacement UF cartridge  
Model: TK-F4UF0-EX  
(P. EN25)



Replacement CB cartridge  
Model: TK-F4CB0-EX  
(P. EN25)

## Cartridge replacement standard

There are 3 conditions to be used as a guide for replacement. Replace the cartridges if even one of the conditions is present.

“ 预警” is displayed  
(water volume or usage time  
has reached the cartridge life)

Sudden drop in water flow

When there is unpleasant  
smell or taste.

Please replace the cartridge  
that is flashing.

Please replace the  
UF cartridge.

Please replace the  
CB cartridge.



- If there is no improvement even after replacing the cartridge, please contact a dealer or subordinate service station of Panasonic for inspection or maintenance.

## About the Cartridge Life Display

The cartridge level indicates the water volume or usage time.

<E.g. PP Cartridge>



- Level 5 ..... 75 %  $\leq$  cartridge life  $\leq$  100 %
- Level 4 ..... 50 %  $\leq$  cartridge life < 75 %
- Level 3 ..... 25 %  $\leq$  cartridge life < 50 %
- Level 2 ..... 5 %  $\leq$  cartridge life < 25 %
- Level 1 ..... “” flashes at 0 % < cartridge life < 5 %.
- Level 0 ..... “” flashes at cartridge life 0 %.

## When the Cartridge Life level 2 is displayed

The replacement time is approaching.  
Please prepare a new cartridge.

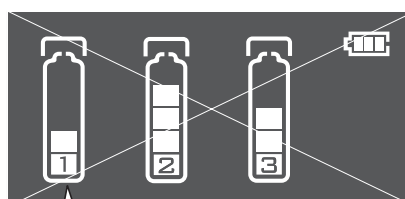

## When the indicator of “Notice to replace” is flashing

**Please replace.**

- If there is unpleasant smell or taste, replace the cartridge even if the the indicator of “ 预警” is not flashing.  
(The purified water ability is reduced.)
- When the level of cartridge life is displayed as 1 or less (cartridge life is less than 5 %) while discharging purified water, the buzzer will sound once every 6 seconds to remind users to replace the cartridge.

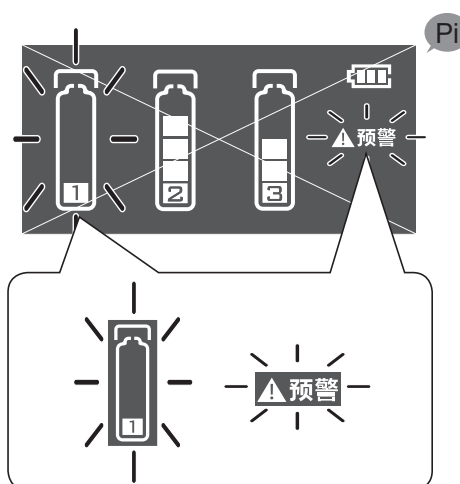

Flash

# Replacing the Cartridge (continued)

## Replacing method

- Do not discharge water with the cartridge removed.  
(Or water will spill.)
- Dispose of the used cartridge in accordance with the applicable ordinances in the area concerned.  
(The material of the cartridge cover is PP. Refer to “Specifications” for the type of the filter materials (P. EN26).)
- Always perform steps 1 and 2, as they help to reduce water leakage when replacing the cartridges.

### 1 Drain the water from the product.

- ① Raise the Water stop lever.

Water stop lever

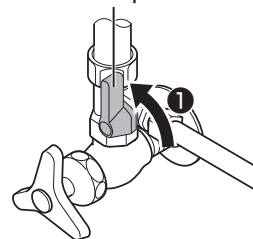

- ② Lower the Special faucet for Water Purifier lever.

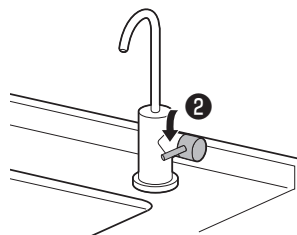

### 2 Lay out a towel or similar object, and then lower the Water Purifier.

- Move any objects nearby, as there is the risk of water leakage when replacing the cartridges.

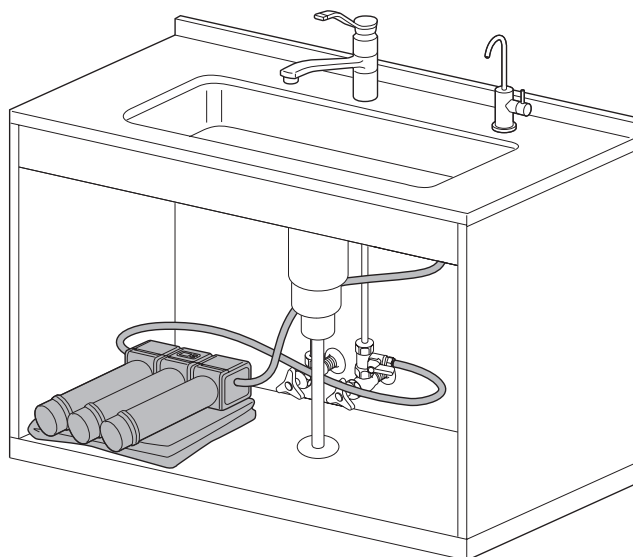



### 3 Remove the cartridge. Rotate the cartridge 90° to the left.

- Take care since water will drip from the cartridge.
- Check that the “●” on the main unit and the “●” on the Cartridge are aligned, then remove the cartridge.

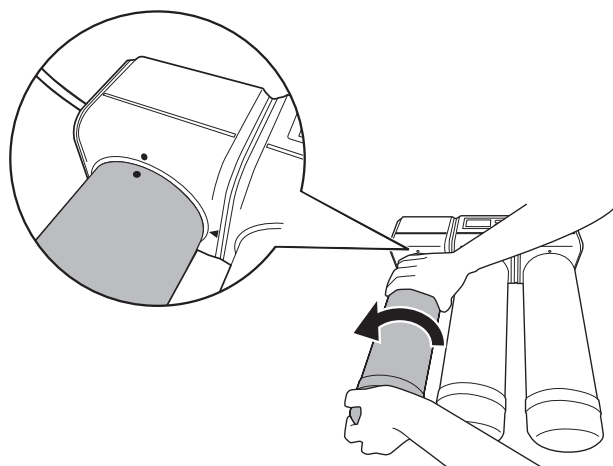

### 4 Remove the cap at the top of the new cartridge.

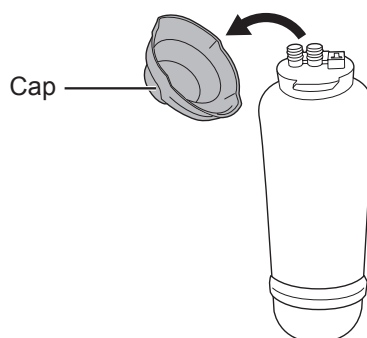

### 5 Check the installation position of the cartridges.

- Check that the label name and colour on the cartridges match the label name and colour on the main unit side.

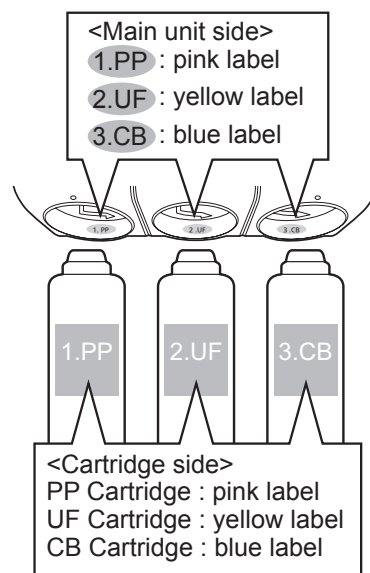

# Replacing the Cartridge (continued)

## Replacing method

**6**

**Install the cartridge to the main unit.**

- ① Align the “●” of the main unit with the “●” of the cartridge, and insert the cartridge into the main unit.
- ② Rotate the cartridge 90° to the right, and align the “▲” of the main unit with the “●” of the cartridge.

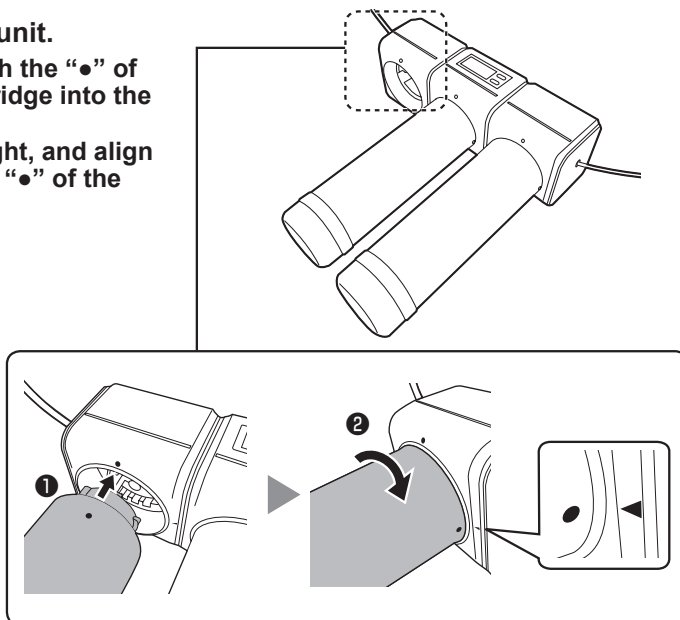

**7**

**Check that the cartridges have been installed in the correct position.**

- Installation order of cartridge is successively as follows:  
From the front left side of the main unit,  
1 PP cartridge - 2 UF cartridge - 3 CB cartridge

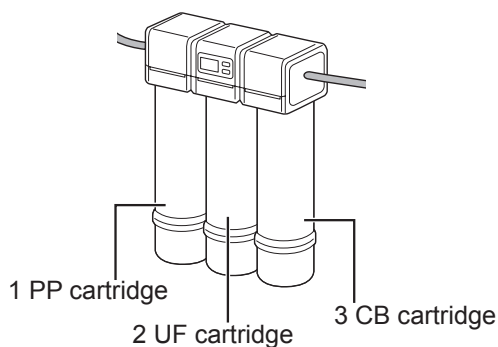

**8**

**Raise up the Water Purifier.**

## 9 Reset the cartridge life of the replaced cartridges.

① Press **设置** (Set) (for about 3 seconds). Pi

- Cartridge 1 is now selected (Cartridge 1 is flashing).

② Press **设置** (Set) to select the replaced cartridge. Pi

③ Press **复位** (Reset) (for about 3 seconds). Pi

- The selected cartridge flashes for 10 seconds, and then lights up.



Cartridge 1 flashes

## 10 Discharge purified water until the water is clear. (Flush for 10 minutes or more)

- “**↓冲洗**” flashes for about 10 minutes.

(For battery saving, display turns off after about 25 seconds.)

10 minutes after, push **设置** (Set) to check that “**↓冲洗**” display is off.

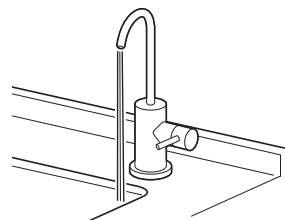

### Note

- New cartridges contains air inside.  
By flushing the air is exhausted.
- If discharging is not enough.
  - Water drip from the main spout after the lever is raised.
  - Bubbles remain in the purified water.
  - Unpleasant smell or taste remains.
- If after flushing for 10 minutes the problems above are not improved, please flush for an additional 10 minutes.
- While water is running through the unit, check that water is not leaking from the area where the cartridge was installed.
- Purified water may contain some black powder (activated carbon).  
The amount will decrease as more water flows, so continue checking the water condition for a while.

### Important

- If the outflow has not been recovered after replacing the cartridge, please contact a dealer or subordinate service station of Panasonic.

# About Flushing

The indicator of “ 冲洗” is displayed when flushing is required.

Lower the Water Purifier lever and flush water through it for 10 minutes or longer

## Timing when the indicator of “flushing” is Displayed





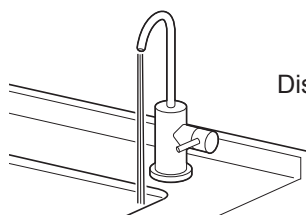

Unit has not been used for 3 days

After the cartridges have been replaced



Discharging purified water...

### Flushing (10 minutes or longer)

- “ 冲洗” flashes for about 10 minutes.  
(For battery saving, display turns off after about 25 seconds.)  
10 minutes after, push  to check that “ 冲洗” display is off.
  - To remove the air or unpleasant smell or taste from the inside of the cartridge, flush the water for 10 minutes or longer.  
If there is no improvement, flush for an additional 10 minutes.
  - Do not drink the water used for flushing.
- 
- The Display turns off after 25 seconds. Press  to turn it on.  
Check that “ 冲洗” is turned off.  
When “ 冲洗” flashing display → Flushing. Do not stop the water.  
“ 冲洗” off → Flushing complete. Stop the water.

# When the water supply is cut off

## ■ When the water supply is cut off

- It is not available.
- After the water supply is recovered, please open the faucets except for the Special faucet for Water Purifier, so the tap water (raw water) flow can discharge the air or dregs in pipes. The Water Purifier can be subsequently used as usual. (The cartridge life may be greatly shortened if air or dregs enter the main unit.)

# When not using the product for a long period of time

## When not using the product for 3 days or longer

- Flush with water (for 10 minutes) (P. EN20)

## When not using the product for 1 week or longer

### ● Remove the cartridges and store them in the refrigerator.

- ① Close the Quick-connect valve by raising the water stop lever completely. (P. EN16)
- ② Remove the cartridges. (P. EN16 – EN19)
- ③ Place them in a sealed plastic bag and store them in the refrigerator.
- ④ Remove the batteries (when not using for approx. 1 month or longer).

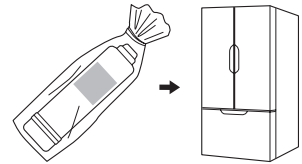

### Note

Note that storing for long periods of time will cause the water inside the cartridges to deteriorate, even if stored in a refrigerator.

Replacing the cartridges is recommended.

### ● Resume using the product

- ① Install the cartridges. (P. EN16 – EN19)
- ② Insert the batteries (when not using for approx. 1 month or longer). (P. EN12 – EN13)
- ③ Flush with water (for 10 minutes). (P. EN20)



# Q&A

	Question	Answer
Cartridge	I want to replace the cartridge. What type should I use?	PP cartridge is type TK-F4PP0-EX. UF cartridge is type TK-F4UF0-EX. CB cartridge is type TK-F4CB0-EX. (P. EN14)
	Why is the indicator of “  预警” is flashing before using 1 year?	The indicator is flashing based on both water volume and usage time, whichever comes first.
Tap water/Well water	Can ground water or well water be used?	<b>Ground water or well water cannot be used.</b> Please use tap water, as the safety of ground water or well water cannot be adequately verified.
Purified water	How long does purified water last?	<b>Purified water should be used within</b> • 1 day at room temperature • 2 days in refrigerator (fill in a clean, sealed container) (For chlorine (disinfectant) contained within tap water is removed, which result in general bacteria to increase more and cause health problems.)
Other	What is the white powder that's deposited on the inside of the kettle and thermos flasks?	<b>It is the calcium from the water.</b> There is no problem if you drink the water, but if it bothers you, clean the containers concerned. If the white powder is not removed by cleaning, obtain some citric acid from a pharmacy, mix 50 g with 1 liter of water, leave to soak in the containers for 2 or 3 days, and then rinse the deposit off.
	Can the batteries be removed when the product is not being used?	<b>Do not remove the batteries, even when the product is not being used.</b> <b>Otherwise the cartridge life display becomes incorrect.</b> (Water volume or usage time will not be counted if purified water is used with the batteries removed.) <b>Note: If not using the product for 1 month or longer, remove the batteries.</b>

# Troubleshooting

In case of suspected malfunction, please check the following conditions before sending the Water Purifier for inspection.

In addition, if there is any abnormal condition, do not dismantle the Water Purifier by yourself. Please contact a dealer or subordinate service station of Panasonic for handling.

	Phenomenon	Cause and solution	Pages for reference
Display	Nothing is displayed.	<ul style="list-style-type: none"> <li>● The display turns off automatically when not in use to prevent the batteries going flat.</li> <li>● Are the batteries flat?</li> <li>● Machine malfunction → Contact a dealer or subordinate service station of Panasonic.</li> </ul>	EN12 EN12 —
	The indicator of  预警 does not turn off even after replacing the cartridge.	<ul style="list-style-type: none"> <li>● Did you reset the cartridges after replacing them?</li> </ul>	EN19
Water leakage	Cartridge mounting section.	<ul style="list-style-type: none"> <li>● Have the cartridges been firmly installed? → Install them firmly.</li> </ul>	EN16 – EN19
Spout	Water is still dripping even after closing the faucet.	<ul style="list-style-type: none"> <li>● It is not a malfunction. (Water remaining in the water outlet)</li> </ul>	—
	The water flow is reduced, or the water cannot flow out.	<ul style="list-style-type: none"> <li>● Is the Quick-connect valve (water stop lever) too tight? → Please open the water stop lever.</li> <li>● Is the indicator of  预警 flashing? → Please replace the cartridge.</li> <li>● Has the cartridge been installed? → Install them firmly.</li> <li>● Is the water stopped? → Until water supply are recovered, please wait with patience.</li> <li>● Is the water pressure too low? → Check for malfunctions such as insufficient flow rate, or kinked or squashed tubes. If the water flow is not restored even after checking, the cartridges may be blocked. Please replace them. If the water pressure does not recover even after replacing the cartridges, please contact a dealer or subordinate service station of Panasonic.</li> </ul>	EN10 EN16 – EN19 EN16 – EN19 — —
	There is less water flowing out after replacing the cartridges.	<ul style="list-style-type: none"> <li>● Did you flush the water for 10 minutes or longer after replacing the cartridges? (This is required to exhaust air inside the cartridges.)</li> </ul>	EN19
	The water which flows out is warm.	<ul style="list-style-type: none"> <li>● The heat of the room temperature or the main unit will make the temperature of the water rising, therefore, the water flow is warm. → This phenomenon is not a malfunction, please let the water flow out.</li> </ul>	—

# Troubleshooting (continued)

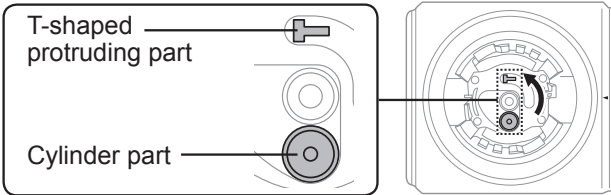
Phenomenon		Cause and solution	Pages for reference
Odor, taste, cloudiness, or discoloring	The unpleasant smell, taste or impurities cannot be removed.	<ul style="list-style-type: none"> <li>● The product has not been used for 3 days or longer. → Flush with water for 10 minutes or longer. When not using the product for a long period of time, the water inside the cartridges will deteriorate, so replacing the cartridges is recommended. (P. EN16 – EN19)</li> <li>● The filter capacity of the cartridge has reduced. → Please replace the cartridge.</li> </ul>	EN21  EN16 – EN19
	The purified water looks like it is sparkling.	<ul style="list-style-type: none"> <li>● This is caused by substances dissolved in the water (mainly minerals) being separated out.</li> </ul>	—
	The water looks cloudy white, or contains bubbles.	<ul style="list-style-type: none"> <li>● These are air bubbles created during filtration. → After replacing the cartridges, flush with water for 10 minutes or longer before use.</li> </ul>	EN19
	Water smells of plastic.	<ul style="list-style-type: none"> <li>● When using the product for the first time, there may be a slight smell. → This decreases gradually as the product is used.</li> </ul>	—
	Water contains black specks.	<ul style="list-style-type: none"> <li>● Activated carbon may be released when first using the product. → This decreases gradually as the product is used.</li> </ul>	—
Others	There is condensed water in piping, let water drips from the pipe.	<ul style="list-style-type: none"> <li>● In humid places, many drips of water may condense. → Please contact a dealer or subordinate service station of Panasonic to handle by covering the piping with heat isolation material.</li> </ul>	—
	Cannot install the cartridges.	<ul style="list-style-type: none"> <li>● When the cartridge is removed, the joint part might be positioned incorrectly. → Check the position of T-shaped protruding. If not the same as the illustration, please move the protruding. Hold the protruding and the cylinder part by fingers.</li> </ul> <p style="text-align: right;">&lt;Bottom of main unit&gt;</p> 	—



# Optional Accessories

Please purchase from a dealer or subordinate service station of Panasonic.

## Consumables

Replacement PP cartridge  
Model: TK-F4PP0-EX



Replacement UF cartridge  
Model: TK-F4UF0-EX



Replacement CB cartridge  
Model: TK-F4CB0-EX



## Mark position of the manufacturing number

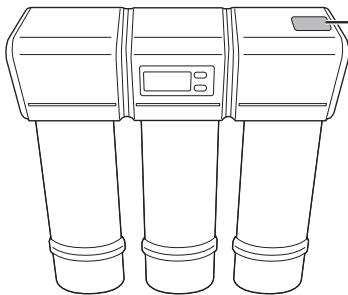

The manufacturing number  
is marked on this label

# Specifications

Materials	Main unit	ABS resin, PP resin
	Faucet	Stainless steel, POM resin
	Connecting tube	Polyethylene
Filter material		Melt-blown polypropylene, hollow fiber membrane, compressed activated carbon
Filtration flow volume		1.5 liters/minute
The lowest applicable dynamic water pressure		100 kPa
Pressure of water used by Water Purifier (dynamic pressure)		100 kPa to 400 kPa
Usable water service pressure (static pressure)		100 kPa to 400 kPa
Temperature of water used by Water Purifier		5 – 38 °C
Purification capacity	Free residual chlorine	4 000 L (Note 1)
	Turbidity	4 000 L (Note 2)
	Total trihalomethane	4 000 L (Note 3)
	Chloroform	4 000 L (Note 3)
	Bromodichloromethane	4 000 L (Note 3)
	Dibromochloromethane	4 000 L (Note 3)
	Bromoform	4 000 L (Note 3)
	Tetrachloroethylene	4 000 L (Note 3)
	Trichloroethylene	4 000 L (Note 3)
	cis-1,2-dichloroethylene and trans-1,2-dichloroethylene	4 000 L (Note 3)
	Benzene	4 000 L (Note 3)
Substances other than above that can be removed	bacteria	Can be removed. (Note 4)
Components which cannot be filtered out		Iron dissolved in water, heavy metals (silver, copper, etc.), salt (seawater)
Filter Usage Limit [Guide to Replacement]		PP cartridge: 12 months or 4 000 L (Note 5) UF cartridge: 12 months or 4 000 L CB cartridge: 12 months or 4 000 L
Main unit	Dimensions (width × depth × height)	395 mm (W) × 125 mm (D) × 360 mm (H)
	Weight	Approx. 4.2 kg (approx. 7.7 kg when full of water)
Faucet	Format	Attached faucet base: vertical type, single hole
	Mounting hole	Diameter: 13 mm to 14 mm
	Main spout	Rotary type
	Dimensions (turning radius × height)	115 mm × 261 mm (H)

Note 1: This value is for a removal rate of 80 % based on JIS S 3201:2019 tests.

Note 2: This value is for a filtration flow volume of 50 % based on JIS S 3201:2019 tests.

Note 3: This value is for a removal rate of 80 % based on Annex A, JIS S 3201:2019 tests.

Note 4: Tested in accordance with Annex B, JIS S 3201:2019 at the Japan Food Research Laboratories.

Note that the removal of bacteria are not stipulated as part of purification capacity.

Note 5: This time applies when 10 liters of water are used a day.

The actual cartridge life depends on local tap water quality and daily usage.





# 目录

安全注意事项 .....	SC3
使用注意事项 .....	SC6
各部件的名称和功能 .....	SC7
使用前要进行的步骤 .....	SC8
<b>安装 1</b> 确认净水机的设置和配件 .....	SC8
<b>安装 2</b> 安装后确认 .....	SC9
<b>安装 3</b> 检查快接三通 .....	SC9
净水机的使用 .....	SC10
调整水压 .....	SC10
保养 .....	SC11
更换电池 .....	SC12
更换滤芯 .....	SC14
关于冲洗 .....	SC20
供水中断时 .....	SC21
长时间不使用产品时 .....	SC21
问题及解答 .....	SC22
故障排除 .....	SC23
可选配件 .....	SC25
规格 .....	SC26

# 安全注意事项

请确保遵循以下说明

为了防止人身事故或财产损失，请始终遵循以下说明。  
■ 以下根据严重程度说明由错误使用引起的危险和损坏。

	<b>警告</b>	表示严重伤害或死亡。
	<b>注意</b>	表示可能导致伤害或财产损失。

■ 符号的分类及解释如下。（以下是符号示例。）

	此符号表示禁止		此符号表示必须遵循的要求
---	---------	---	--------------

## 警告

### 供水



- 请使用符合相应标准的水源（如自来水）。  
（否则可能会导致健康问题。）
- 净水机无法去除 P. SC26 所列物质以外的有害物质，也无法对水进行消毒。

## 注意

### 关于电池



- 请勿将电池丢入火中，使其短路，拆卸。  
（否则可能导致灼伤等伤害。）



- 请始终遵循电池上注明的注意事项。
- 请勿以充电电池代替干电池使用。
- 确认电池的⊕和⊖，然后将其正确插入。
- 尽快取出用完的电池。
- 请使用规范建议的有效期限内的电池。  
（否则可能因电池发热、破裂或漏液而导致人身伤害或事故。）

### 禁止拆解



- 请勿拆卸、修理或改造产品。  
（否则可能导致漏水或故障。）  
→ 请联系 Panasonic 的经销商或下属服务站进行检查或保养。

## ⚠ 注意

### 关于配件



- 请勿对快接三通施加过大的力。  
(否则可能造成管道连接部分的松动而导致漏水。)

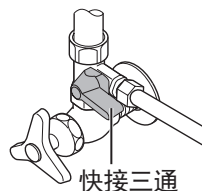

- 请勿阻塞主出水口或弯曲、扭曲、压平、拉扯或夹紧PE管。  
(否则可能导致漏水、阻止出水或引起其他故障。)
- 请勿将其他产品(例如软管)连接至净水机专用龙头的主出水口  
(否则可能由于主机的异常水压而导致漏水或其他故障。)

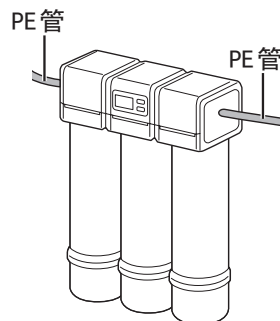

- 主机应与净水机专用龙头以及安装配件一起使用。  
(否则可能导致漏水。)
  - 没有安装配件时, 请勿使用主机和净水机专用龙头。
  - 请勿重复使用旧管。
- 联系 Panasonic 的经销商或下属服务站进行安装或拆卸本产品。  
(安装或拆卸不妥当可能会漏水。)

### 使用者须知



- 本产品不适用于肢体、感官或精神能力较弱或缺乏经验和知识的人员(包括儿童)使用, 除非由负责其安全的人员监督或指导对他们使用本产品。  
(存在发生事故或受伤的风险。)
- 应该监督儿童, 以确保其不玩耍本产品。  
(存在发生事故或受伤的风险。)

## ⚠ 注意

### 存储净水



- 产出净水后应立即使用。存储以备将来使用时, 请将净水倒入干净的密封容器中, 如果将其保存在室温下, 则应在1天内用完; 如果将其保存在冰箱中, 则应在2天内用完。  
(自来水中所含的氯(消毒剂)被去除后会导致一般细菌的增加并引起健康问题。)

### 非消耗净水



- 请勿使用净水养鱼或其他宠物。  
(可能造成环境改变, 鱼等可能死亡。)

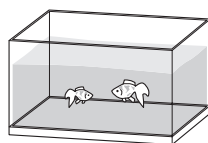

- 为了避免健康问题, 在开始使用净水机时, 请勿饮用主机内部积存的水。请按照以下说明进行彻底冲洗。  
(避免危害身体健康。)

每天开始使用时

放出约3升水后使用  
(约2分钟)。

更换滤芯后, 或3天  
及以上未使用净水  
机时

放水时间超过10分钟  
后使用

### 意外吞食



- 请勿将随附的配件放在婴儿或幼儿可以拿到的地方。  
(否则可能导致误吞配件。)
  - 如果疑似吞咽了配件, 请立即咨询医生。
- 请勿让婴幼儿玩弄包装材料。  
(否则可能导致窒息。)

# 使用注意事项

## 供水

- 出现以下情况时请勿饮水。
  - 水浑浊或含有大量红锈  
(避免危害身体健康。)
  - 井水  
(避免危害身体健康。)
  - 未达到饮用水标准的水  
(避免危害身体健康。)

## 使用

- 请勿用砧板等重物撞击主机或出水管, 或使其受到强烈冲击。  
(否则可能导致故障。)
- 请勿将炊具锅或其他高温物体放在净水机专用龙头附近。  
(否则可能导致变形或故障。)
- 请勿将主机或管道部件置于冻结环境中。  
(否则可能导致损坏、漏水或故障。)
  - 本净水机的规格不适用于寒冷地区。
- 不要让升降柜的活动部件或门碰触出水管。
- 请勿将杀虫剂喷洒到净水机的主机、PE管或其他部件上。  
(否则可能导致故障。)  
如果意外喷洒, 请立即用湿布擦拭。
- 请立即停止使用并取出电池。  
(否则可能导致故障。)  
<异常和故障的示例>
  - 运行时声音异常
  - 净水机异常发热或变形  
→联系Panasonic的经销商或下属服务站进行检查或保养。
- 请勿用水淋湿主机或水清洗主机。  
(否则可能导致故障。)

## 使用

- 净水机的原水使用温度需要在5到38℃之间, 超过38℃可能损坏密封材料并导致漏水。
- 温度低于5℃可能导致管道冰冻和破裂, 并导致漏水。
  - 当主机或主机的管道部件冻结时, 请关闭止水阀, 并与Panasonic的经销商或下属服务站联系以进行处理。
- 必须按正确顺序安装滤芯, 以确保功能完整。确保安装顺序正确。  
滤芯安装顺序  
(1. PP滤芯→2. UF滤芯→3. CB滤芯)
- 请勿倒置安装本产品。  
(否则可能导致故障。)
- 搬运产品时, 请握住主机的两边。  
(上盖可能轻易脱落, 并可能跌落而导致损坏。)

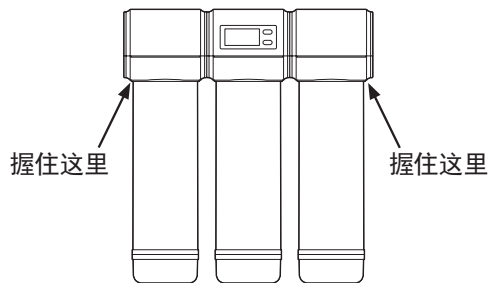



# 各部件的名称和功能

## 外形图

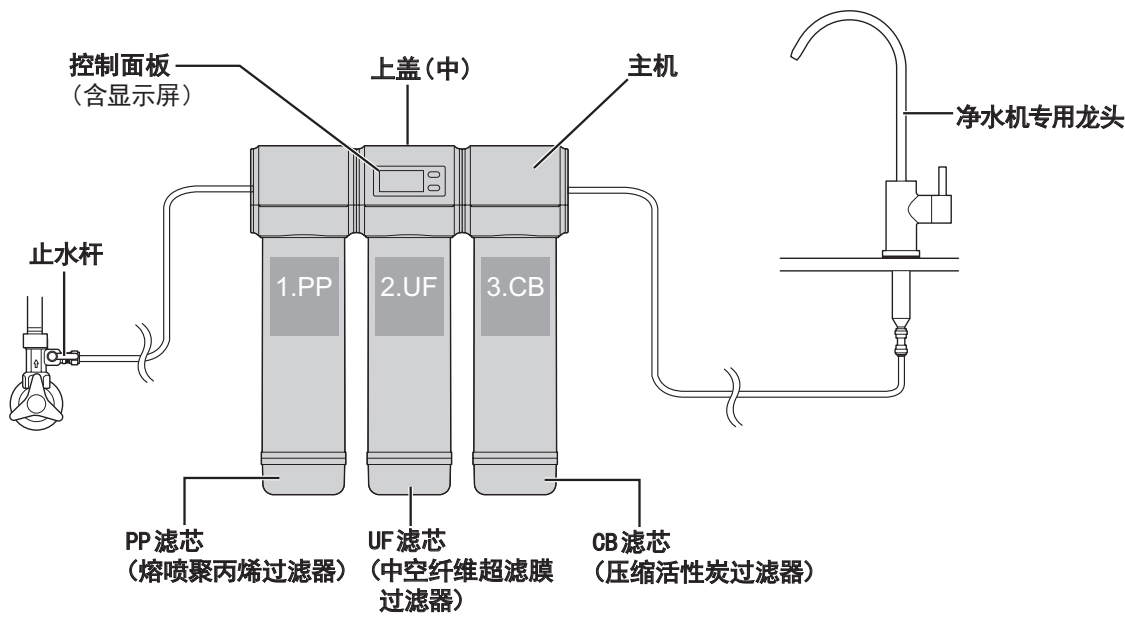

## 控制面板

<b>电池显示 “”</b> <ul style="list-style-type: none"><li>● 需要更换电池时闪烁。(P. SC12)</li></ul>	<b>更换通知 “ 预警”</b> <ul style="list-style-type: none"><li>● 剩余的滤芯寿命少于等于1个刻度时闪烁。请更换滤芯。</li></ul>
<b>水流 “ 制水”</b> <ul style="list-style-type: none"><li>● 净水流动时闪烁 25 秒。</li></ul>	<b>冲洗 “ 冲洗”</b> <ul style="list-style-type: none"><li>● 如果出现以下任一情况，则闪烁约 10 分。(P. SC20)<ul style="list-style-type: none"><li>• 3天内无使用</li><li>• 更换滤芯后</li></ul></li></ul>

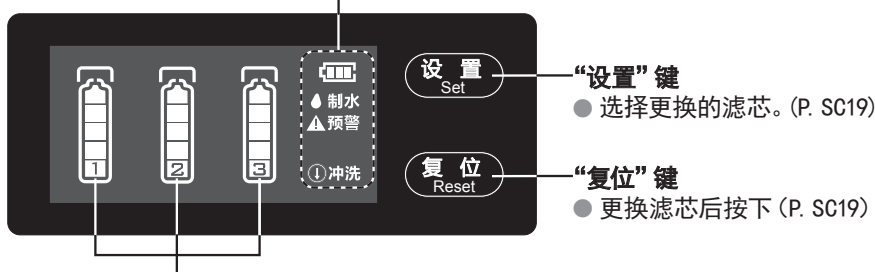

<b>1: PP 滤芯寿命显示</b>	<b>2: UF 滤芯寿命显示</b>	<b>3: CB 滤芯寿命显示</b>
● 滤芯寿命以 5 个刻度显示。(P. SC15)		

# 使用前要进行的步骤

安装 1

确认净水机的设置和配件

P. SC8

安装 2

安装后确认

主机中的空气未完全排出, 请排放  
净水 10 分钟或更长时间

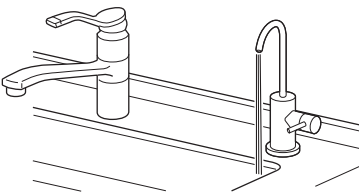

P. SC9

安装 3

检查快接三通

P. SC9

安装 1

确认净水机的设置和配件

- 如有任何缺陷, 请通知Panasonic的经销商或下属服务站。
- 主机应安装在水槽下方, 并与净水机专用龙头连接。  
(请确认快接三通和主机的放置位置。)

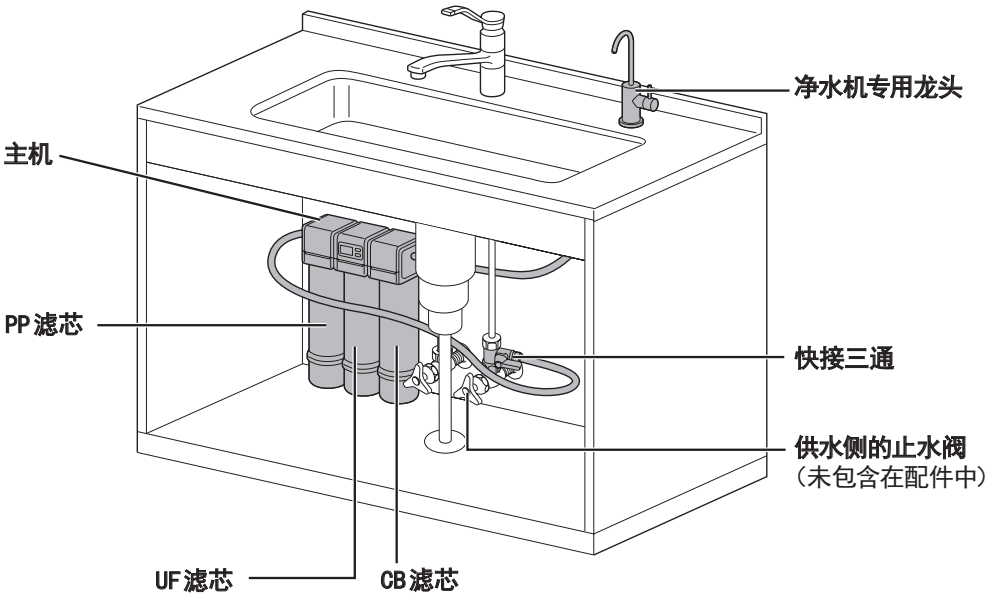

## 随附配件

### □ 安装说明书

- 请确认最终检查确认表 (安装说明书中P. SC27) 中的所有项目是否都已打勾 (已完成)。

为排出主机中的空气, 净水应排放 10 分钟或更长时间。

使用净水机 (P. SC10)

① 放下控制杆 (放水)

② 抬起控制杆 (水流停止)

- 如果主机中的空气未完全排出, 水流将不通畅。
- 如果在冲洗 10 分钟后, 净水中仍然残留气泡或难为的气味, 味道, 请再冲洗 10 分钟。

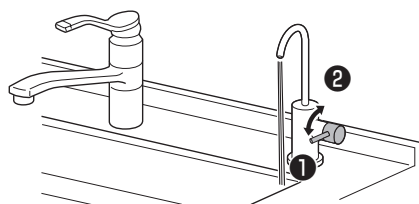

① 关闭快接三通  
(抬起止水杆)

- 如果水不再从出水管流出, 则说明快接三通工作正常。

② 打开快接三通以使用。  
(放下止水杆)

- 有关如何调节快接三通的信息, 请参见“水压调整”(P. SC10)。
- 如果不是上述情况, 则快接三通可能有故障, 请联系 Panasonic 的经销商或下属服务站。

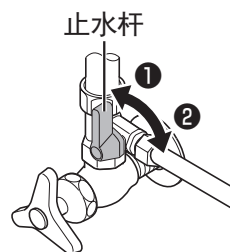

# 净水机的使用

## 1 如何打开水

### ●放下控制杆

- 如果水溅出，请稍微抬起止水杆。  
(对于水压较高的情况。)(P. SC10)
- 闪烁约 25 秒钟后，“制水”指示灯熄灭。

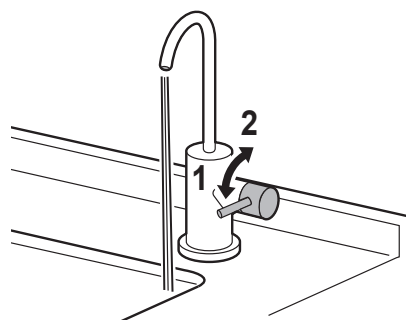

## 2 如何关闭水

### ●抬起控制杆

### 注意

- 定期确认净水机管道是否漏水。
- 如果在电池没电的情况下放水，水仍会被净化，但作为更换滤芯的参考水量或使用时间将不会被计算在内，并且无法正确显示滤芯寿命。  
请定期确认电池的剩余电量。(请参见 P. SC12 中的更换电池)

# 调整水压

### ●水压比较高时

逐渐抬起止水杆进行调节。

### ●水压比较低时

逐渐放下止水杆进行调节。

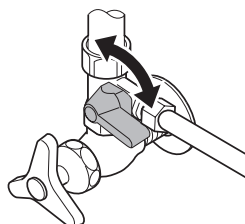

## 日常保养

### 主机和净水器专用龙头

将软布浸入水中, 拧干后擦拭净饮水机。

- 请用棉棒等物品擦掉主出水口的污垢  
(如果将清洁用的污水溅出并附着在主出水口上,  
则可能导致产生灰尘或滋生细菌。)

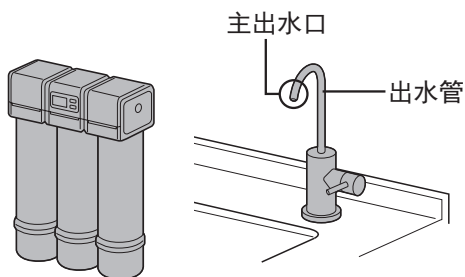

### 重要

- 请勿使用洗涤剂、清洁粉、稀释剂、挥发油、乙醇或煤油等。如果意外使用, 请立即用湿布擦拭以除去表面上的洗涤剂等。  
(混入水中的洗涤剂可能导致树脂开裂、电镀损坏、电镀或涂层剥落、变色或变形。)
- 洗涤剂可能会使出水管中的水流不畅而导致故障。
- 请勿使用金属刷或其他器具。(否则可能导致损坏。)
- 避免通过喷水或洗涤使主机与水接触。(否则可能导致故障。)
- 专用龙头有晃动或可以转动时, 请拧紧锁紧螺母。(安装说明书P. SC15)  
(否则可能导致漏水。)

# 更换电池

- “” (闪烁) 时, 请更换新电池。
- 准备3节7号碱性电池。  
使用非指定的电池将缩短使用寿命。

## 1 卸下主机上盖 (中)。

- ① 用一字螺丝刀推动位于孔底的爪部。(2处)
- ② 请慢慢打开上盖 (中)。

● 上盖 (中) 内侧有电线, 有断线风险。

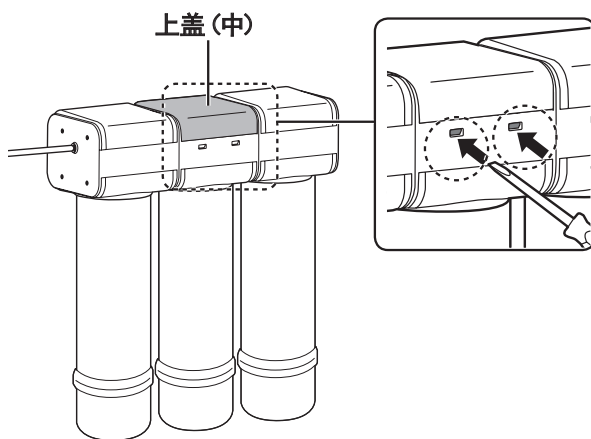

## 2 取下电池盖并更换电池。

- ① 沿箭头方向滑动。

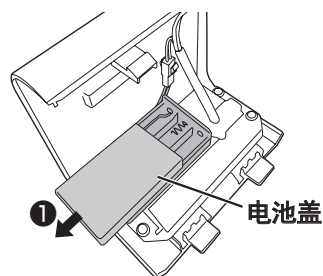

- ② 确认⊕与⊖, 将电池牢固插入到底。  
(将发出“哔”声。)

- 确认电池的正负极 (端子) 上是否有异物。
- 显示屏将点亮约25秒钟, 然后关闭。  
显示屏关闭后按下按钮将再次点亮。

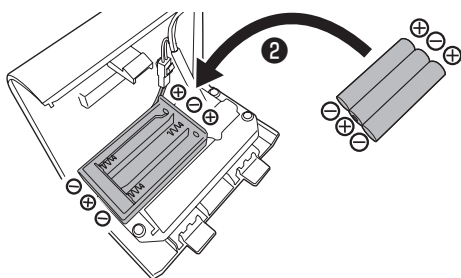

- ③ 沿箭头方向滑动直至发出喀哒声。

- 注意请勿拉扯接线。

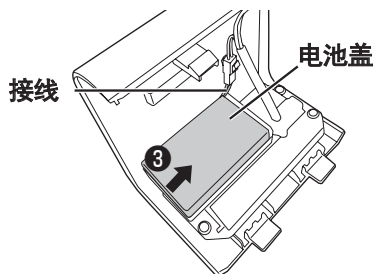

- ### 3 安装上盖(中)。
- ①从内部将爪结构插入两个孔中。
  - ②按压上盖(中)的正面上方。

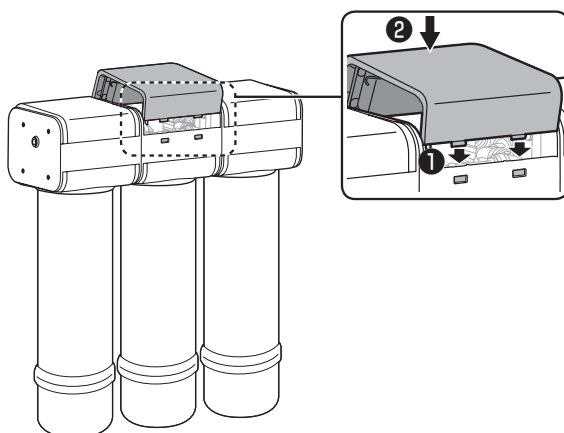

#### 电池使用时间参考

- 3节7号 Panasonic 碱性电池可以使用大约1年。  
(电池使用时间根据使用环境而不同)

#### 注意

- 插入电池时, 请擦拭主机, 以免水滴进入内部。
- 请始终使用3节7号碱性电池。
- 推荐使用 Panasonic 电池。

# 更换滤芯

当滤芯寿命到期或净水能力降低时, 请更换新的滤芯。



更换PP滤芯  
型号: TK-F4PP0-EX  
(P. SC25)

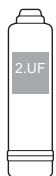

更换UF滤芯  
型号: TK-F4UF0-EX  
(P. SC25)



更换CB滤芯  
型号: TK-F4CB0-EX  
(P. SC25)

## 滤芯更换标准

更换滤芯可以从3个特征去确认。只要符合其中1个特征就请更换滤芯。



● 更换滤芯后仍未改善时, 请联系 Panasonic 的经销商或下属服务站进行检查或保养。



## 关于滤芯寿命显示

滤芯寿命按使用水量或使用时间显示。

〈例如：PP 滤芯〉

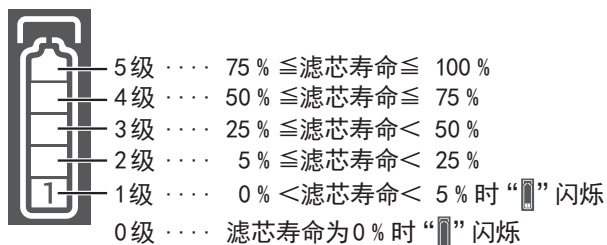

## 当滤芯寿命显示为2级时

临近更换时间。  
请准备新滤芯。

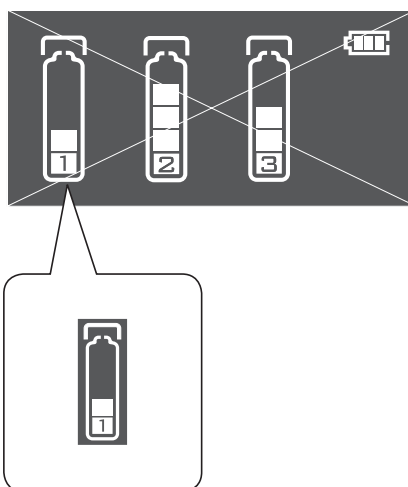

## 当“更换通知”指示灯闪烁时

请更换。

- 如果有难闻的气味或味道，即使“ 预警”指示灯未闪烁，也请更换滤芯。（净水能力降低。）
- 如果在排放净水时滤芯寿命显示为1级或更低（滤芯寿命少于 5 %），则蜂鸣器将每 6 秒响一次，以提醒用户更换滤芯。

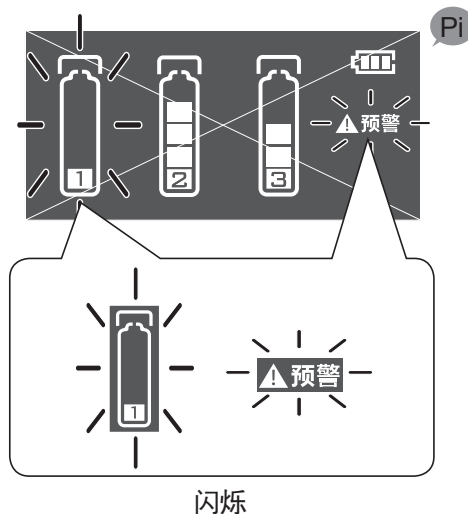

# 更换滤芯 (续)

## 更换方法

- 请勿在取出滤芯的情况下排放水。  
(否则水会溢出。)
- 根据相关地区的适用法规处理用过的滤芯。  
(滤芯盖的材料是PP。有关过滤材料的类型, 请参见“规格”(P. SC26)。)
- 更换滤芯时请始终执行步骤1和2, 有助于减少漏水。

### 1 排出产品内部的水。

- ① 请拉起止水杆。

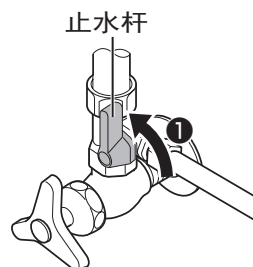

- ② 放下净水器控制杆的专用龙头。

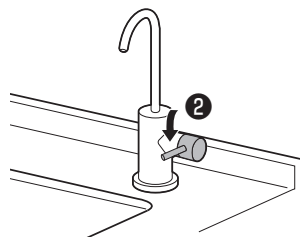

### 2 铺好毛巾或类似物品, 然后放下净水器。

- 移走附近的物品, 因为更换滤芯时有漏水的风险。

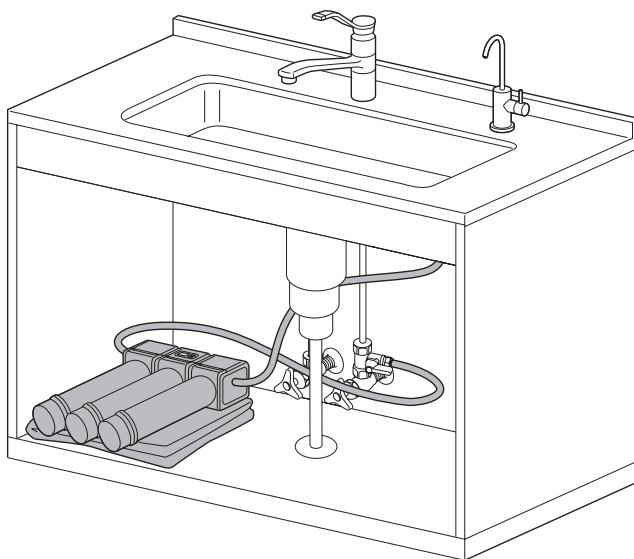

### 3 拆除滤芯。 将滤芯向左旋转 90°。

- 注意, 因为滤芯会滴水。
- 请确认主机的“●”与滤芯的“●”已对准后, 再拆卸滤芯。

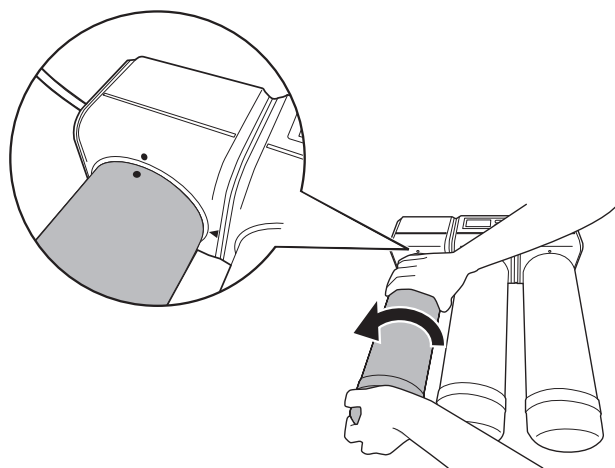

### 4 取下新滤芯顶部的盖子

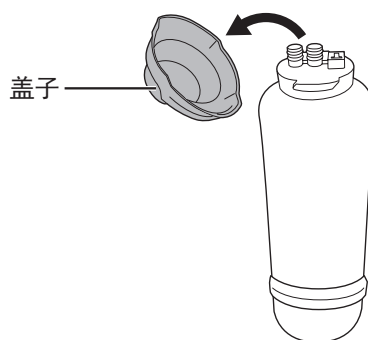

### 5 确认滤芯的安装位置

- 确认滤芯上的标签名称和颜色是否与主机侧的标签名称和颜色匹配。

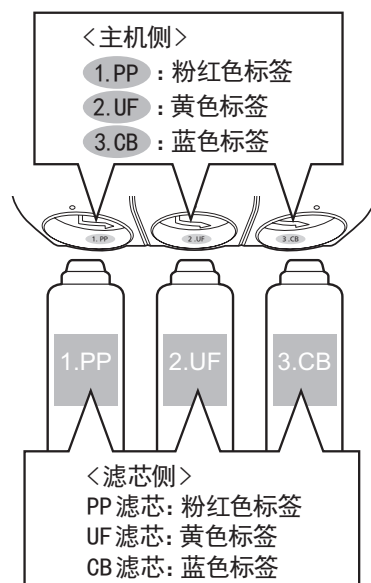

# 更换滤芯 (续)

## 更换方法

- 6
- 将滤芯安装至主机上
- ❶

将主机的“●”与滤芯的“●”对准, 然后将滤芯插入主机
- ❷

向右旋转滤芯90°, 然后将主机的“▲”与滤芯的“●”对齐

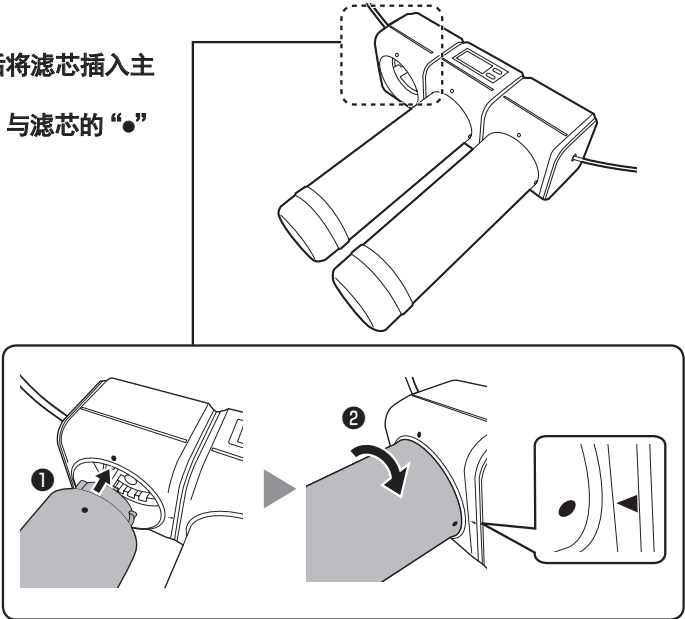

- 7
- 确认滤芯是否安装在正确的位置。
- 按照如下安装顺序依次:  
从主机的左前侧开始,  
1 PP滤芯-2 UF滤芯-3 CB滤芯

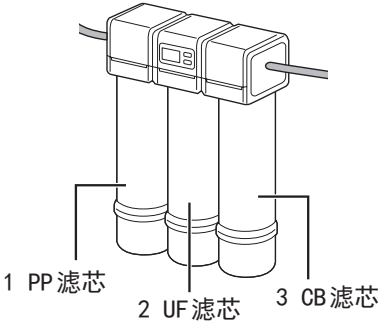

- 8
- 竖起净水机

## 9 将更换的滤芯的滤芯寿命复位。

- ① 按 **设置** (Set) (大约3秒)。Pi  
● 此时滤芯1处于被选中的状态。(滤芯1闪烁)
- ② 按 **设置** (Set), 选择更换后的滤芯。Pi
- ③ 按 **复位** (Reset) (大约3秒)。Pi  
● 选择的滤芯闪烁10秒钟后点亮。



## 10 排放净水, 指导水清澈为止。 (冲洗10分钟或更长时间)

- “**↓冲洗**” 闪烁约10分钟。  
(为节省电池电量, 显示屏会在约25秒后关闭。)
- 10分钟后, 按 **设置** (Set) 确认 “**↓冲洗**” 显示关闭。

### 注意

- 新滤芯内部有空气。  
冲洗后, 排出空气。
- 排水不充分时。
  - 抬起控制杆后, 主龙头上滴水。
  - 净水中残留气泡。
  - 残留难闻的气味或味道。
- 如果冲洗10分钟后仍未解决上述问题, 请再冲洗10分钟。
- 当水流过本机时, 确认滤芯部位是否有漏水。
- 净水中可能含有一些黑色粉末(活性炭)。  
连续出水后会慢慢改善, 请观察一会儿。

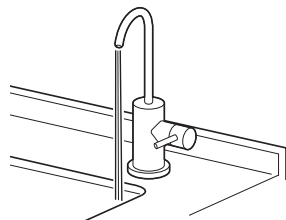

### 重要

- 如果更换滤芯后仍有水溢出, 请联系Panasonic的经销商或下属服务站。

# 关于冲洗

需要冲洗时，会显示“**↓冲洗**”指示灯。  
放下净水器控制杆，并冲洗10分钟或更长时间

“冲洗”指示灯显示的定时

3天未使用净水器时

更换滤芯后

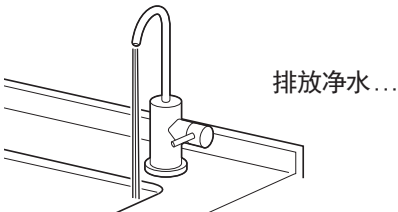

冲洗（10分钟或更长）

- “**↓冲洗**” 闪烁约10分钟。  
（为节省电池电量，显示屏会在约25秒后关闭。）  
10分钟后，按 **设置** Set 确认“**↓冲洗**”显示关闭。
- 为了排出滤芯内部的空气及清除难闻的气味或味道，请冲洗10分钟以上。  
冲洗后仍未恢复时，请再冲洗10分钟。
- 请勿饮用用于冲洗的水。

- 显示屏显示25秒钟后关闭。按 **设置** Set 则点亮。  
请确认“**↓冲洗**”是否已关灯。
- “**↓冲洗**” 闪烁显示 → 清洗中。请勿停止供水。
- “**↓冲洗**” 闪烁停止 → 清洗结束。请停止供水。

# 供水中断时

## ■ 供水中断时

- 不可用。
- 供水恢复后, 请打开除了净水机专用龙头以外的龙头, 以便自来水(原水的水)流可以排出管道中的空气或沉淀物。随后照常使用净水机。(如果空气或沉淀物进入主机, 则可能大大缩短滤芯寿命。)

# 长时间不使用产品时

## 3 天或更长时间不使用产品时

- 用水冲洗 (10 分钟) (P. SC20)

## 1 周以上不使用产品时

### ● 请去除滤芯存放在冰箱中冷藏

- ① 完全抬起止水杆, 关闭快接三通。(P. SC16)
- ② 取出滤芯。(P. SC16 ~ SC19)
- ③ 密封于塑料袋中存放在冰箱中。
- ④ 拆下电池 (大约 1 个月或更长时间不使用时)。

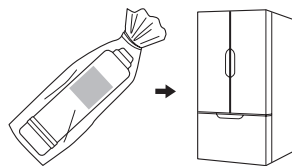

### 注意

即使在冰箱内, 长期存放也可能导致滤芯内的水变质。  
建议更换滤芯。

### ● 恢复使用产品

- ① 安装滤芯。(P. SC16 ~ SC19)
- ② 插入电池 (大约 1 个月或更长时间不使用时)。(P. SC12 ~ SC13)
- ③ 用水冲洗 (10 分钟)。(P. SC20)

# 问题及解答

问题		回答
滤芯	我想更换滤芯。我应该使用哪个型号？	PP 滤芯型号为 TK-F4PP0-EX。 UF 滤芯型号为 TK-F4UF0-EX。 CB 滤芯型号为 TK-F4CB0-EX。 ) (P. SC14)
	为什么“  预警”指示灯在使用未满1年时就闪烁？	指示灯根据用水量或者使用时间（以先到者为准）闪烁。
自来水 / 井水	可以使用地下水或井水吗？	地下水或井水不能使用。 地下水或井水的安全性尚未充分检验，因此请使用自来水。
净水	净水能存放多久？	净水使用时间 • 室温下1天内 • 冰箱中2天内（装入干净的密封容器中） （自来水中所含的氯（消毒剂）被去除后会导致一般细菌的增加并引起健康问题。）
其他	水壶和保温瓶内部沉积的白色粉末是什么？	它是水中的钙。 容器中的水可以饮用，但是如果这个问题困扰您，请清洁相关的容器。如果无法通过清洁去除白色粉末，请从药房购买一些柠檬酸，将 50 g 柠檬酸与 1 L 水混合，在容器中浸泡 2 或 3 天，然后冲洗掉沉淀物。
	不使用产品时可以取出电池吗？	即使不使用产品，也不要取出电池。 这是由于显示更换滤芯的正确指示。 （如果在取出电池的情况下使用净水，则不计算水量或使用时间） 注意：1 个月以上不使用时，请取出电池。



# 故障排除

如果怀疑有故障，请在将净饮水机送去检查之前确认以下情况。  
此外，如果有任何异常情况，请勿自行拆解净饮水机。请联系Panasonic的经销商或下属服务站进行处理。

现象		原因和解决方法	供参考的页面
显示	什么也没有显示。	<ul style="list-style-type: none"><li>● 不使用时，显示屏会自动关闭，以防止电池耗尽。</li><li>● 电池没电了吗？</li><li>● 机器故障 →联系Panasonic的经销商或下属服务站。</li></ul>	SC12 SC12 —
	即使更换了滤芯， ⚠ 预警 指示灯也不熄灭。	<ul style="list-style-type: none"><li>● 更换滤芯后是否进行过复位操作？</li></ul>	SC19
漏水	滤芯安装部分。	<ul style="list-style-type: none"><li>● 滤芯安装是否牢固？ →牢固安装。</li></ul>	SC16～SC19
出水口	即使关闭龙头，仍然有滴水。	<ul style="list-style-type: none"><li>● 非故障。（出水口中残留的水）</li></ul>	—
	水流减小，或水无法流出。	<ul style="list-style-type: none"><li>● 快接三通（止水杆）是否太紧？ →请打开止水杆</li></ul>	SC10
		<ul style="list-style-type: none"><li>● “⚠ 预警”指示灯是否闪烁？ →请更换滤芯。</li></ul>	SC16～SC19
		<ul style="list-style-type: none"><li>● 是否已安装滤芯？ →牢固安装。</li></ul>	SC16～SC19
		<ul style="list-style-type: none"><li>● 供水有无停止？ →直到恢复供水，请耐心等待。</li><li>● 水压是否过低？ →确认故障，例如流量不足、管材扭曲或挤压。 如果在确认后仍无法恢复流量，则滤芯可能被堵塞。请更换滤芯。 更换滤芯后水压仍未恢复时，请联系Panasonic的经销商或下属服务站。</li></ul>	— —
	更换滤芯后流出的水更少。	<ul style="list-style-type: none"><li>● 更换滤芯后，是否冲洗了10分钟或更长时间？ （这样可以排出滤芯内的空气）</li></ul>	SC19
	流出的水是温热的。	<ul style="list-style-type: none"><li>● 室温或主机的热量会使水温升高，因此水流变得温热。 →此现象非故障，请让水流出。</li></ul>	—

# 故障排除 (续)

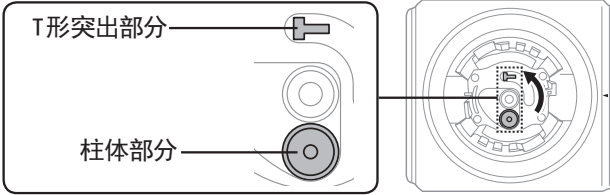
现象		原因和解决方法	供参考的页面
气味、味道、浑浊或变色	无法去除难闻的气味、味道或杂质。	<ul style="list-style-type: none"><li>● 3 天以上未使用产品。 → 用水冲洗 10 分钟或更长时间。 长时间不使用时, 滤芯内的水有可能变质, 因此建议更换滤芯。(P. SC16 ~ SC19)</li><li>● 滤芯的过滤能力下降了。 → 请更换滤芯。</li></ul>	SC21  SC16 ~ SC19
	净水看起来在冒泡。	<ul style="list-style-type: none"><li>● 这是由于溶解在水中的物质 (主要是矿物质) 被分离引起的。</li></ul>	—
	水看起来是浑浊的白色, 或含有气泡。	<ul style="list-style-type: none"><li>● 这些是过滤过程中产生的气泡。 → 更换滤芯后, 请在使用前用水冲洗 10 分钟或更长时间。</li></ul>	SC19
	水中有塑料气味。	<ul style="list-style-type: none"><li>● 首次使用时, 可能有少许气味。 → 随着产品的使用, 这种情况逐渐减少。</li></ul>	—
	水含有黑色斑点。	<ul style="list-style-type: none"><li>● 首次使用产品时, 可能会释放活性炭。 → 随着产品的使用, 这种情况逐渐减少。</li></ul>	—
其他	管道中有冷凝水, 使水从管道上滴落。	<ul style="list-style-type: none"><li>● 在潮湿的地方, 可能会凝结出许多水滴。 → 请联系 Panasonic 的经销商或下属服务站用隔热材料覆盖管道进行处理。</li></ul>	—
	无法安装滤芯。	<ul style="list-style-type: none"><li>● 卸下滤芯后, 接头部件可能定位不正确。 → 确认 T 形突出部分的位置。 如果与图例不同, 请移动突出部分。 用手指握住突出部分和柱体部分。</li></ul> <div><p>＜主机底部＞</p></div>	—

# 可选配件

请从 Panasonic 的经销商或下属服务站处购买。

## 消耗品

更换 PP 滤芯  
型号: TK-F4PP0-EX



更换 UF 滤芯  
型号: TK-F4UF0-EX



更换 CB 滤芯  
型号: TK-F4CB0-EX



## 制造编号的标注位置

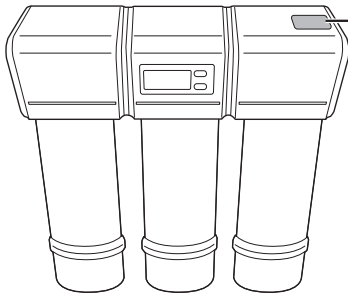

制造编号标在此标签上

# 规格

材料	主机	ABS 树脂、PP 树脂
	龙头	不锈钢、POM 树脂
	连接管	聚乙烯
过滤材料		熔喷聚丙烯、中空纤维膜、压缩活性炭
过滤流量		1.5 升/分钟
最低适用动态水压		100 kPa
净水机使用的水压（动压）		100 kPa 至 400 kPa
可用供水压力（静压）		100 kPa 至 400 kPa
净水机使用的水温		5～38 ℃
净化能力	游离残留氯	4 000 L（注意 1）
	混浊度	4 000 L（注意 2）
	三卤甲烷总量	4 000 L（注意 3）
	氯仿	4 000 L（注意 3）
	溴二氯甲烷	4 000 L（注意 3）
	二溴氯甲烷	4 000 L（注意 3）
	三溴甲烷	4 000 L（注意 3）
	四氯乙烯	4 000 L（注意 3）
	三氯乙烯	4 000 L（注意 3）
	顺-1,2-二氯乙烯和 反-1,2-二氯乙烯	4 000 L（注意 3）
	苯	4 000 L（注意 3）
除上述物质外的可去除的物质	细菌	可以去除。（注意 4）
无法过滤掉的成分		溶于水的铁离子、重金属（银、铜等）、盐（海水）
过滤器使用量限制 〔更换指南〕		PP 滤芯: 12 个月或 4 000 L（注意 5） UF 滤芯: 12 个月或 4 000 L CB 滤芯: 12 个月或 4 000 L
主机	尺寸（宽度×深度×高度）	395 mm(宽)× 125 mm(深)× 360 mm(高)
	重量	约 4.2 kg（装满水约 7.7 kg）
龙头	样式	附龙头底座: 立式、单孔
	安装孔	直径: 13 mm 至 14 mm
	主出水口	旋转式
	尺寸（转弯半径×高度）	115 mm × 261 mm（高）

注意 1: 该值是基于 JIS S 3201:2019 测试的去除率为 80 % 时的过滤流量。  
注意 2: 该值是基于 JIS S 3201:2019 测试的过滤流速为 50 % 时的过滤流量。  
注意 3: 该值是基于 JIS S 3201:2019 附录 A 测试的去除率为 80 % 时的过滤流量。  
注意 4: 根据 JIS S 3201:2019 附录 B 在日本食品研究实验室进行的测试。  
请注意，没有规定去除细菌是净化能力的一部分。  
注意 5: 这一时间适用于每天使用 10 升水的情况。  
实际的滤芯寿命取决于当地的自来水水质和日常使用情况。







