

2.3 24-hour nanoe™ X Protection with Panasonic Comfort Cloud

nanoe™ X Concentration Simulation.

Let's see how nanoe™ X fills the room. This program covers limited patterns of the simulation results. The program will be updated with real time simulation patterns.

When nanoe™ X Fan Mode is ON

When nanoe™ X Cooling Mode is ON

When Air Conditioner is OFF

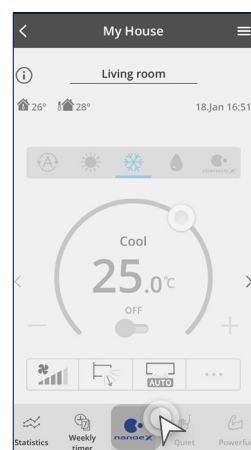
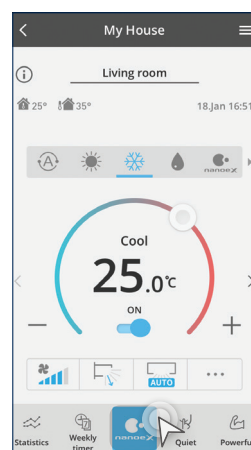
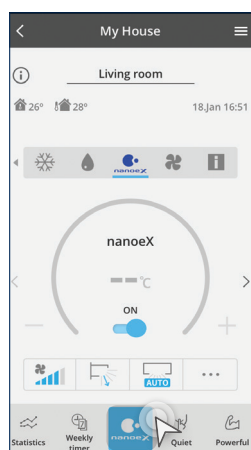

STEP 1*

Tap the "One-touch nanoe™ button".

* These 3 images are typical examples.

nanoe™ X Simulation Compatible Models only

These two screens are shown only once when the One-touch nanoe™ button is tapped for the first time.

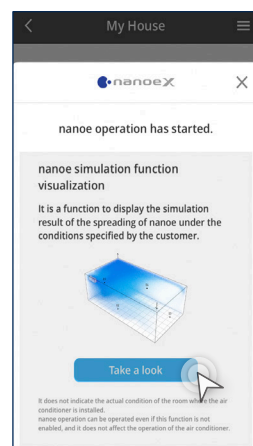

STEP 2

Explanation of nanoe™ X simulation function visualization. Tap "Take a look".

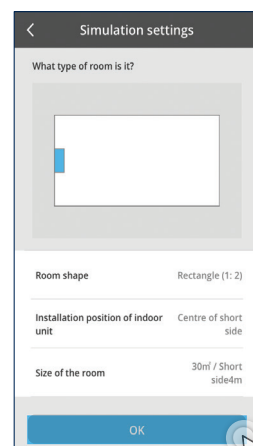

STEP 3

Select room shape, size and indoor unit mounting position setting screen. Tap "OK".

Visualization Screen

Two patterns based on previous operation.

Pattern 1 (Simulation of the future): When nanoe™ X OFF → ON.

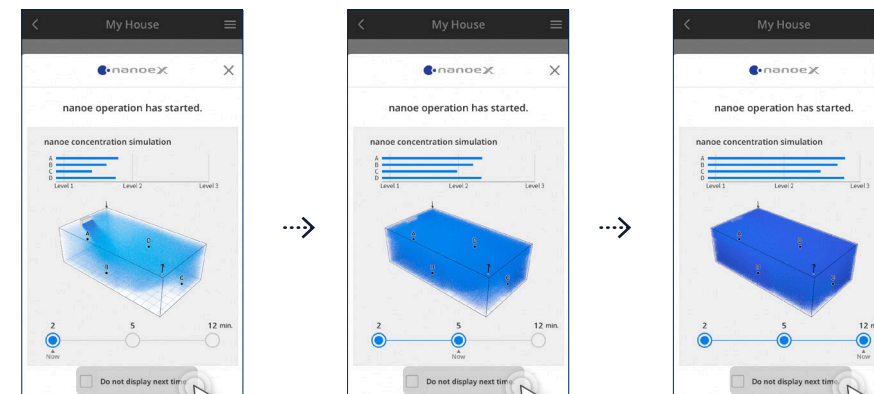

Tap "Do not display next time" to not show the nanoe™ X concentration simulation the next time.

Pattern 2 (Simulation of the current): When Air Conditioner ON, nanoe™ X ON.

* This displayed screen changes depending on the time elapsed since the nanoe™ X has been turned ON.

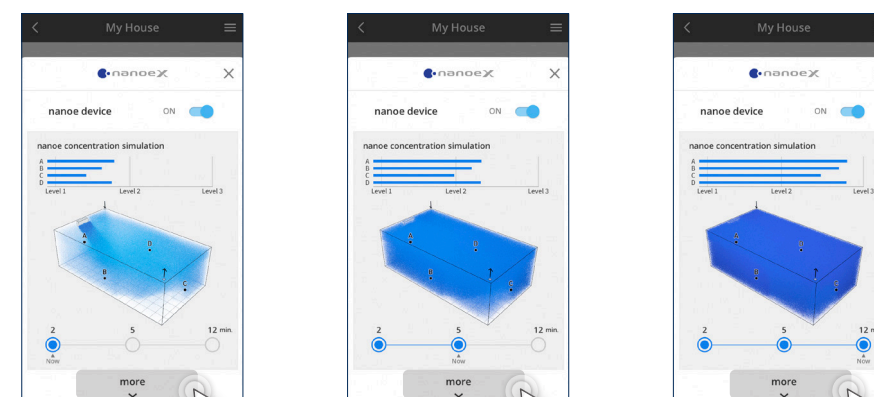

Tap "more" to learn about nanoe™ X. Proceed to Information.

Information

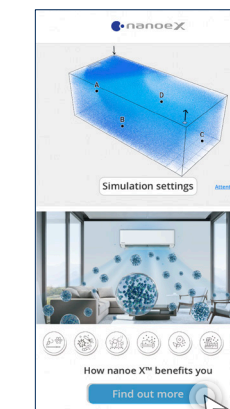

Tap "Find out more" to jump to nanoe™ X webpage.

Non-nanoe™ X Simulation Compatible Models or pressed "Do not show next time".

Pattern 1

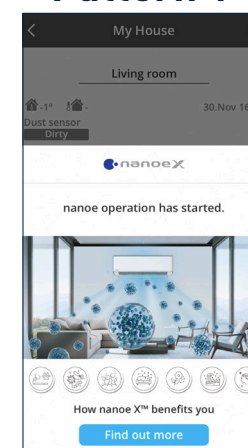

When nanoe™ X OFF → ON.

Pattern 2

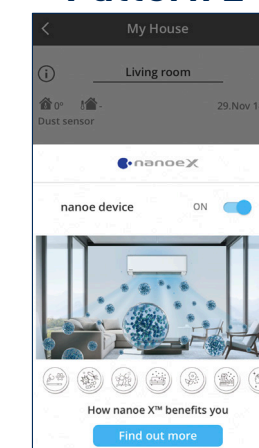

When Air Conditioner ON, nanoe™ X ON.