

Home Network System

Usage Examples

Design and specifications may

Panasonic

Design and specifications may differ depending on country.



■ What is the Panasonic Home Network System?

The Panasonic Home Network System is a wireless system that lets you create a powerful network of cameras, sensors, and smart plugs in your home, and control them all with an easy-to-use app. The system can also connect to your landline, allowing you to use your smartphone or tablet as a home phone.



■ What is it for?

Home Monitoring

- » Check on your sleeping baby from another room, and even play lullabies or talk to them.
- » Easily check on your pets and home when away. The home monitor will even inform you when there are troubles (such as water leakage).



Home Control

- » Turn off the lights and other electrical appliances using your smartphone
- » Make it appear as though someone is at home when away using remote on and off for greater home protection
- » Set a timer to turn appliances on or off

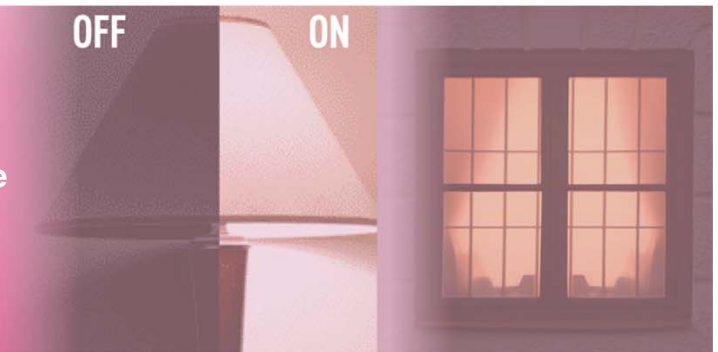

Home Safety

- » Peace of mind by knowing who is visiting
- » The sensor detects any suspicious persons who enter when you are away from home and also performs the following functions:
 - Sends a notification
 - Issues a warning
 - Records footage



■ Where to use?

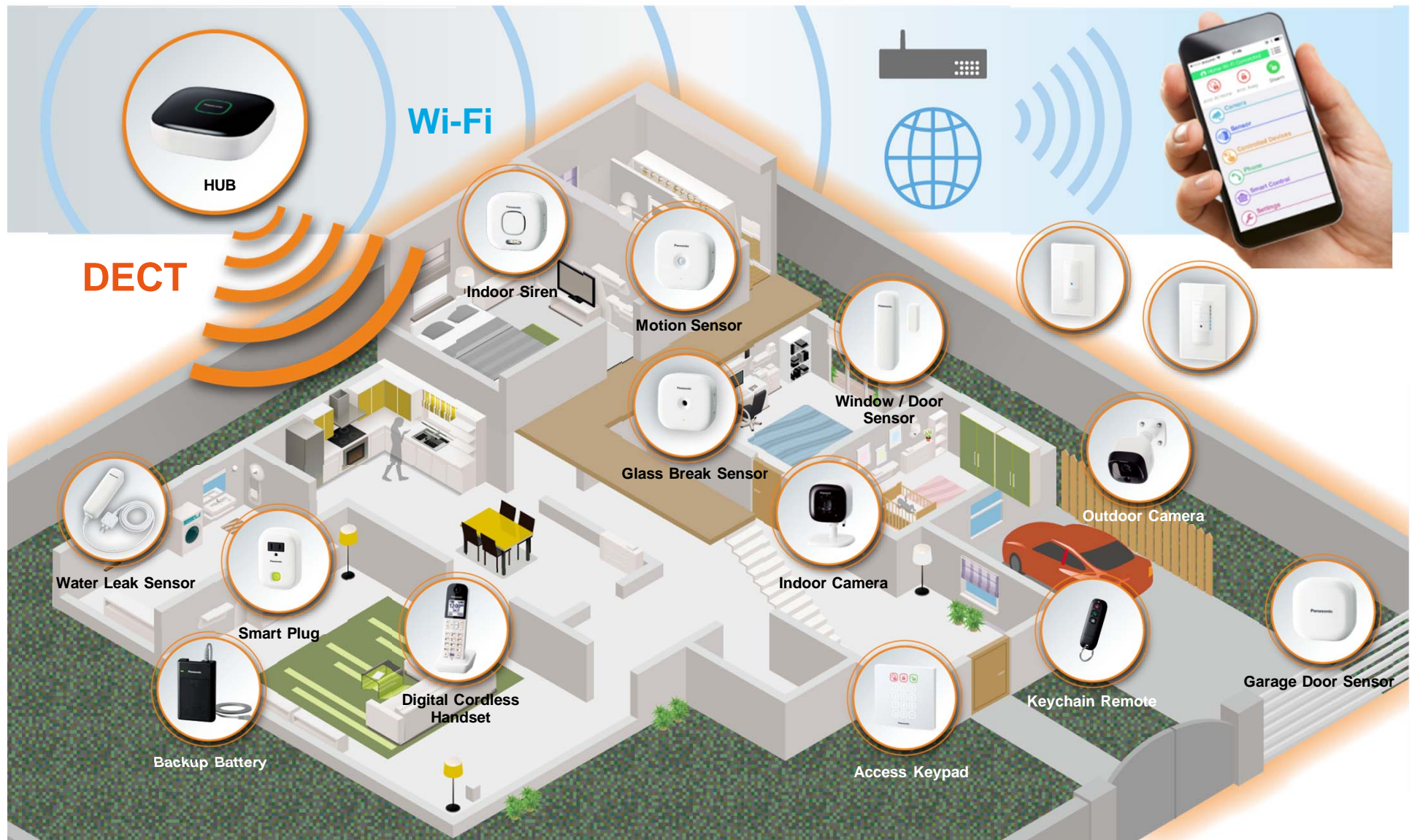

Panasonic

■ Why Panasonic?

It's because....

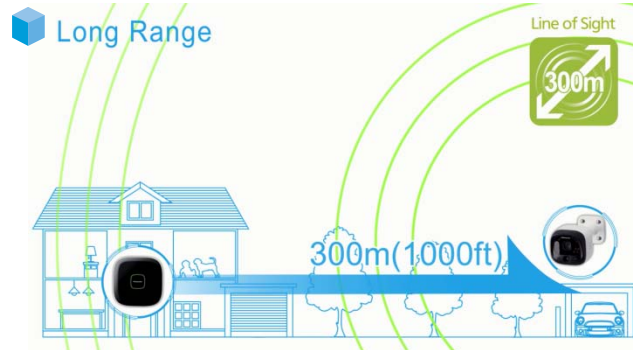

DECT wireless technology for a longer range than Wi-Fi® and 2.4GHz FHSS technology. Easy wireless installation even in remote locations.

Wi-Fi is a trademark or registered trademark of Wi-Fi Alliance.

■ Easy Expansion

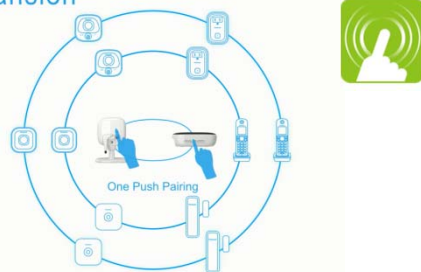

When additional optional accessories are purchased, they can be easily registered with a single button.

■ No Monthly Fees



Usable simply by purchasing hardware, unlike security services that require a monthly safety fee.

How to use?

Required devices



Panasonic

STEP 1

Open the package and confirm the accessories

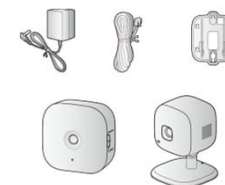

STEP 2

Set up main unit (Hub)

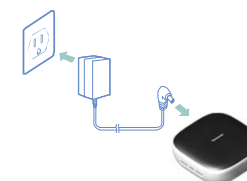

STEP 3

Install the Home Network app.

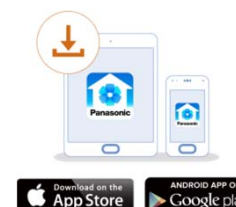

STEP 4

Make sure your mobile device is connected to your Wi-Fi® network.



STEP 5

Set up accessories



What are accessories for?

HUB (KX-HNB600)

- Joins all system devices together
- Connects to your home landline for making and receiving calls
- Supports microSD / microSDHC card connection for recording camera video and audio

Motion Sensor (KX-HNS102) Max.50 *1

- Uses a heat sensor to detect motion in the surrounding area
- Can be used to trigger other actions (camera recording, turning on a light, etc.)

Window/Door Sensor (KX-HNS101) Max.50 *1

- Detects when the corresponding window or door is opened
- Can be used to trigger other actions (camera recording, turning on a light, etc.)

Digital Cordless Handset (KX-HNH100) Max.6 handsets

- Makes and receives calls using your home landline
- Can be used to change the system's arm mode with one touch operation
- Displays the system status
- Receives talking notification when the sensors are triggered

Indoor Camera (KX-HNC200) Max.4 *2

- Full-color camera with night vision and built-in microphone for live monitoring and recording
- Built-in visual sensor (motion detection), audio sensor, and temperature sensor can be used to trigger other actions (camera recording, turning on a light, etc.)
- Built-in microphone and speaker for two-way communication

Outdoor Camera (KX-HNC600) Max.4 *2

- Full-color camera with night vision and built-in microphone for live monitoring and recording
- Built-in visual sensor and infrared sensor (motion detection) can be used to trigger other actions (camera recording, turning on a light, etc.)
- Built-in microphone and speaker for two-way communication
- Splash-proof design for permanent, outdoor installation (IP55)



AC powered



Battery Operated



Battery Operated



Rechargeable
Batteries



AC powered



AC powered

What are accessories for?

Smart Plug (KX-HNA101) Max.50 *1

- Can be turned on and off when using the app or when triggered by a sensor
- Built-in overcurrent detection for added peace of mind
- Power consumption is logged for your reference

Water Leak Sensor (KX-HNS103) Max.50 *1

- Uses a small probe that can detect water
- Can be used to trigger other actions (camera recording, turning on a light, etc.)

Glass Break Sensor (KX-HNS104) Max.50 *1

- Uses a microphone that can detect the unique sound frequencies that are produced when glass breaks
- Can be used to trigger other actions (camera recording, turning on a light, etc.)

Indoor Siren (KX-HNS105) Max.50 *1

- Uses a loud speaker and strobe light to alert you when the alert system is triggered
- You can enable and disable the loud speaker and strobe light for each siren

Access Keypad (KX-HNK101) Max.50 *1

- Allows you to quickly confirm and change the system's arm mode
- Can be wall mounted inside your home near the entrances and exits for easy access

Keychain Remote (KX-HNK102) Max.50 *1

- Allows you to quickly change the system's arm mode as when you come home or are going out
- Can be used to trigger a pre-programmed operation, such as turning on a smart plug or sounding an alert
- Can be attached to a set of keys for added convenience

Backup Battery (KX-HNP100) Max.50 *1

- Supplies power to your Hub or other devices in the event of a power outage
- Can be used to trigger the Hub to call a pre-programmed phone number in the event of a power outage



AC powered



Battery Operated



Battery Operated



AC powered



AC powered



Battery Operated



Rechargeable Batteries

■ What are accessories for?

Garage Door Sensor (KX-HNS107) Max.50 *1

- Detects when the garage door has been opened and closed with an accelerometer to detect its orientation
- Allows the system to notify you when the garage door is opened, and when it has been left open
- Can be used to trigger other actions (camera recording, turn on a light, etc.)



Battery Operated

* Some functions may require an optional device and a commercially-available microSD / microSDHC card.

*1 A total of 50 accessories can be registered to the hub, including Smart Plugs, Sensors (Motion, Window/ Door, Water Leak, Glass Break, Garage Door), Access Keypads, Keychain Remotes, Backup Batteries, Smart Motion Lights and Indoor Sirens.

*2 A total of 4 cameras can be registered to the hub, including outdoor cameras and indoor cameras.

Home Monitoring

Remotely check if your kids have safely returned home using an indoor camera and sensors

Product Combination



HUB
[KX-HNB600]



Indoor Camera
[KX-HNC200]



Motion Sensor
[KX-HNS102]



Window/Door Sensor
[KX-HNS101]

Features

- Monitor remotely
- Sensor notification
- 2 way communication

You can be notified that your kids have safely got home on your smartphone or tablet using a door sensor, motion sensor, or the indoor camera's built-in motion sensor. The indoor camera's built-in mic and speaker let you talk to your kids via your smartphone or tablet.



Panasonic

Home Monitoring

Communicate with kids while you are on a business trip

Product Combination



HUB
[KX-HNB600]



Indoor Camera
[KX-HNC200]

Features

- Monitor remotely
- 2 way communication

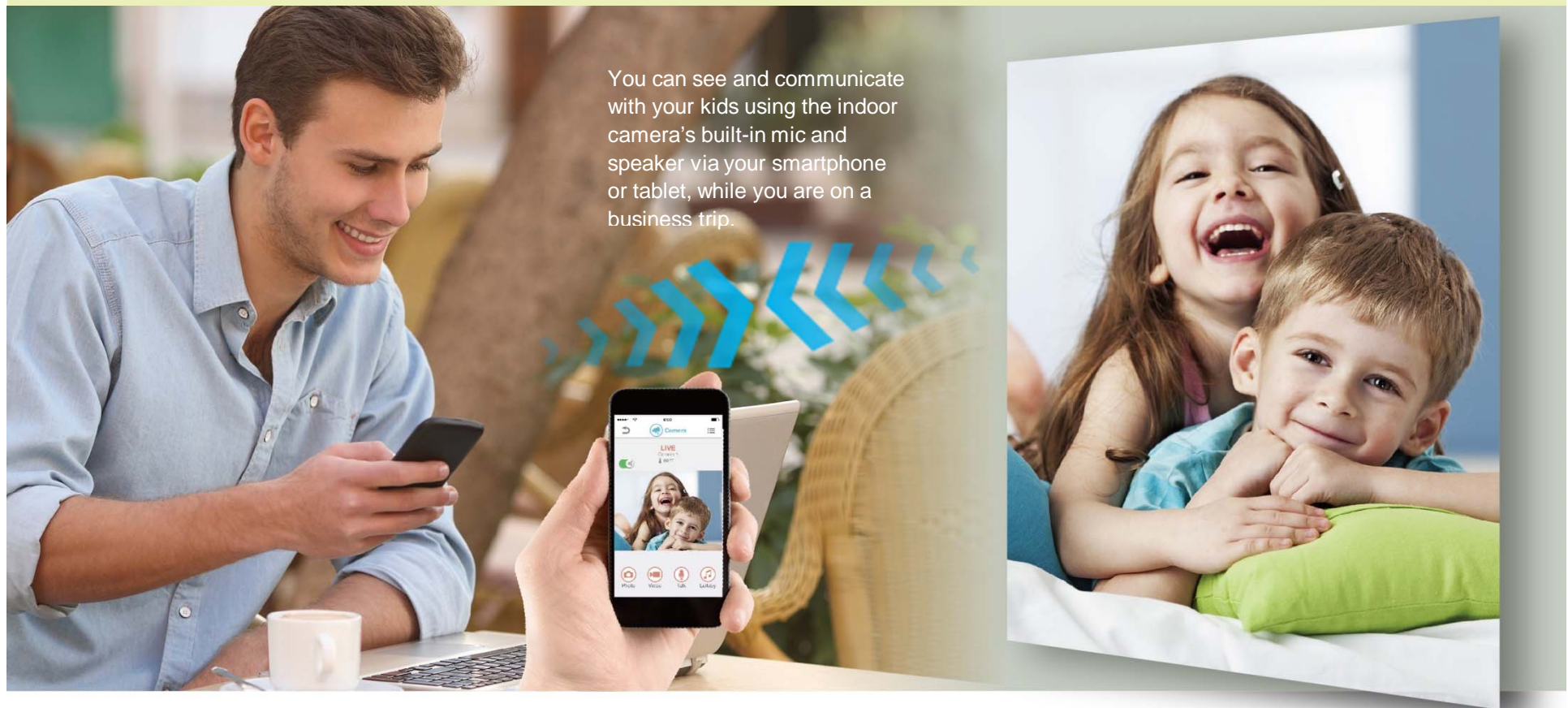

Home Monitoring

Monitor your pets remotely anytime and anywhere, while you're away from your home

Product Combination



HUB
[KX-HNB600]



Indoor Camera
[KX-HNC200]



Smart Plug
[KX-HNA101]

Features

- Monitor remotely
- Sensor notification
- Remote and scheduled control

You can monitor your pets at any time, from anywhere.
An indoor camera equipped with a temperature sensor can notify your smartphone when it detects a change of temperature. You can control lighting with a smart plug, remotely, or according to a preset schedule.



◀ Be notified of abnormal temperatures

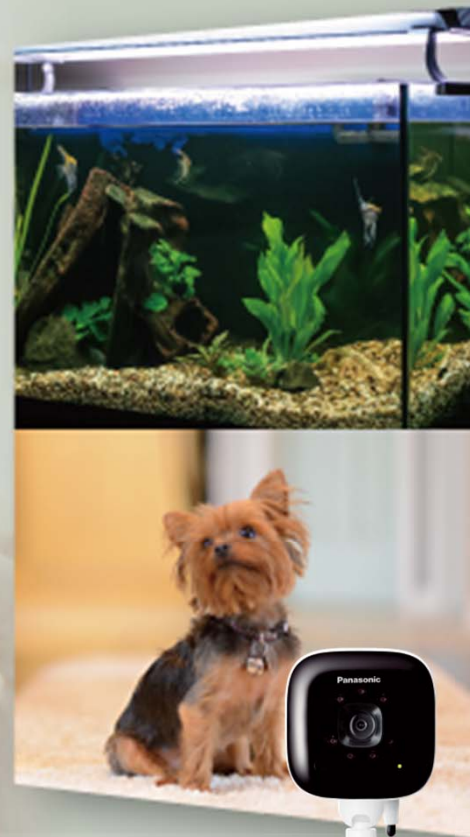
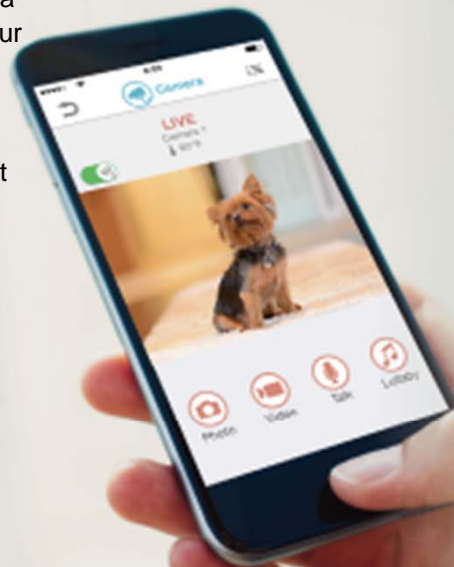

Lights can be turned on / off by remote and scheduled control



Home Control

Control room lighting right from your bed

Product Combination



HUB
[KX-HNB600]



Smart Plug
[KX-HNA101]

Features

■ Remote control

Conveniently turn devices in a room on and off anytime and anywhere, via your smartphone or tablet. You can also check and turn off a light in the living room on the first floor while lying in your bed upstairs. This provides an easy way to save on your electricity bills.

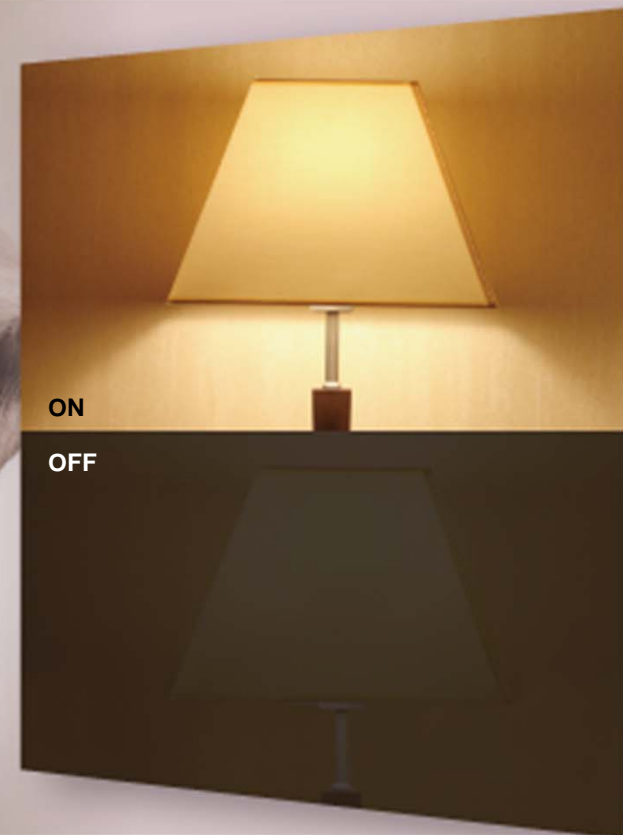

Home Safety

Control lighting so that it appears as though someone is in the house, to prevent burglars from entering

Product Combination



HUB
[KX-HNB600]



Smart Plug
[KX-HNA101]

Features

- Remote control
- Automatic control with preset schedule

You turn devices in a room on and off at anytime and anywhere, via your smartphone or tablet. You can also turn the power on and off according to a preset schedule. By automatically turning the lights on and off while you're away on a trip, you can make it appear as though someone is in the house to prevent burglars from entering.

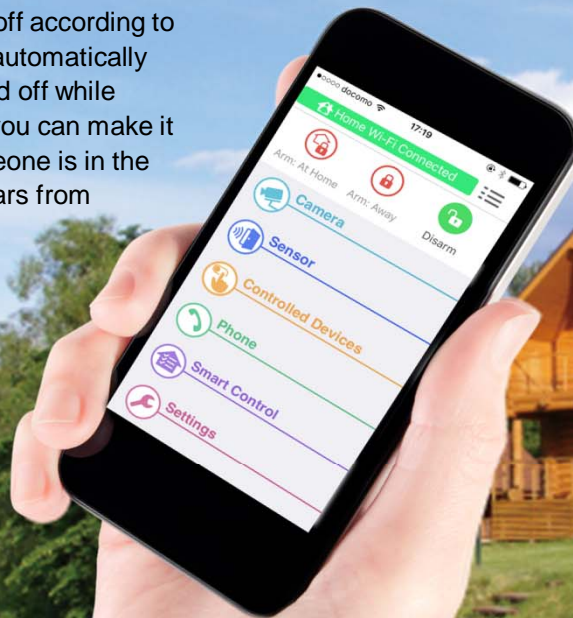

Turn off / on with preset schedule



Turn off / on by remote control



Home Control

Control the room lighting by connecting a motion sensor and window/door sensor

Product Combination



HUB
[KX-HNB600]



Smart Plug
[KX-HNA101]



Motion Sensor
[KX-HNS102]



Window/Door Sensor
[KX-HNS101]

Features

■ Motion sensor connection

Connecting a smart plug and motion sensor or window/door sensor allows the lights to be automatically turned on by detecting movement when you come home in the evening, or when you wake up at night to use the bathroom or go into another room.

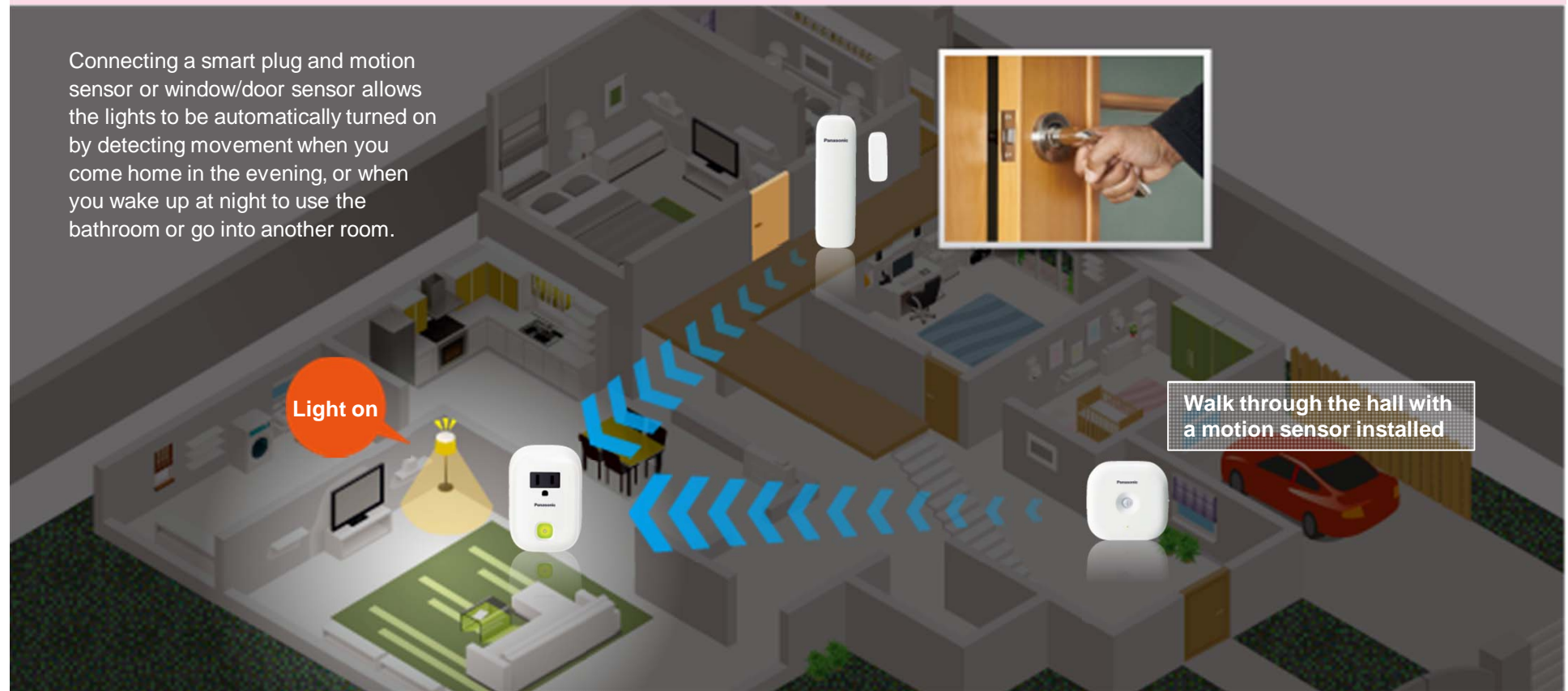

Home Control

Automatically turn lights on with a home Wi-Fi connection

Product Combination



HUB
[KX-HNB600]



Smart Plug
[KX-HNA101]

Features

- Automatically turn lights on

When you come home or approach the home in the evening and your smartphone is connected to home Wi-Fi, that can be a trigger to automatically turn on the lights connected to a smart plug in the room.



* Wi-Fi is a trademark or registered trademark of Wi-Fi Alliance.

Home Safety

Check who is visiting your home remotely
and at home

Product Combination



HUB
[KX-HNB600]



Outdoor Camera
[KX-HNC600]

Features

- Monitor remotely
- Monitor at home

An outdoor camera is equipped with video motion detectors that, when activated, send an alert to your smartphone or tablet. You can also check who is visiting at your home and start talking.



Panasonic

Home Safety

Confirm safety to keep your family safe and your home protected

Product Combination



HUB
[KX-HNB600]



Outdoor Camera
[KX-HNC600]

Features

- Check the situation outside from inside your home
- Check the status of pets

Keep an eye on the exterior of your home from anywhere with the Panasonic Home Monitoring System. Set up outdoor cameras to cover entrances, the garage, patio, garden and other exterior locations. View and record an area or space in real time, day or night and in low-light conditions, from inside your home. You can also monitor your pet.

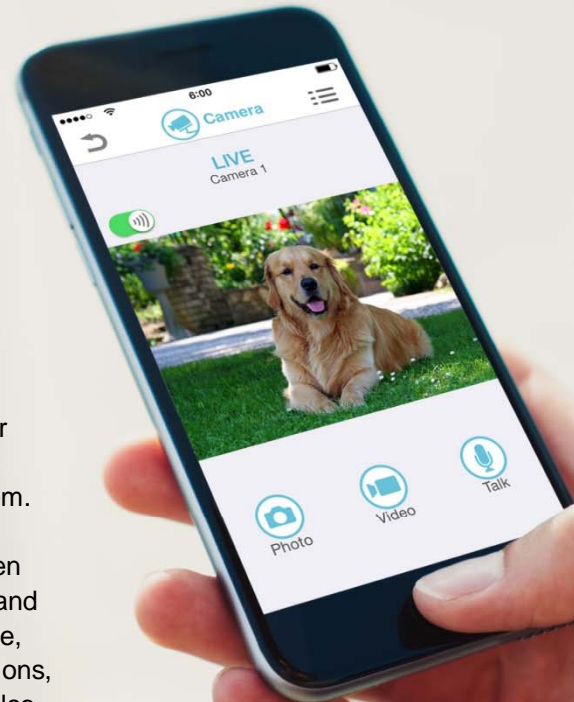

Home Safety

Be alerted of a home intruder even while you're at work

Product Combination



HUB
[KX-HNB600]



Indoor Camera
[KX-HNC200]



Outdoor Camera
[KX-HNC600]



Motion Sensor
[KX-HNS102]



Indoor Siren
[KX-HNS105]



Window/Door Sensor
[KX-HNS101]

Features

- Sensor notification
- Monitor remotely
- Automatic camera recording

Even when there's nobody at home, you can be alerted that a window or door that's equipped with a sensor has been opened. If an intruder enters the house, he or she can be recorded by an indoor or outdoor camera for evidence. The siren can work as a warning making a loud sound and flashing an LED light when triggered by sensors.

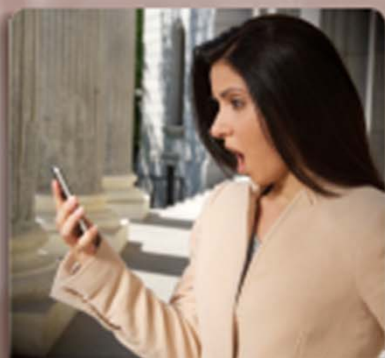

Receive notifications on your smartphone or tablet and monitor remotely



Automatic camera recording



Hub beeping



Makes a loud sound and flashes an LED light when triggered by sensors.

Home Monitoring

Keep an eye on a baby in another room even while you're cooking

Product Combination



HUB
[KX-HNB600]



Indoor Camera
[KX-HNC200]

Features

- Baby monitor
- Play 5 lullabies
- 2 way communication

You can watch a baby sleeping in another room on your smartphone or tablet through the indoor camera. It detects motion, sound, and temperature to notify you of unusual conditions. The indoor camera's built-in mic and speaker let you talk to the baby and play 5 types of lullabies.

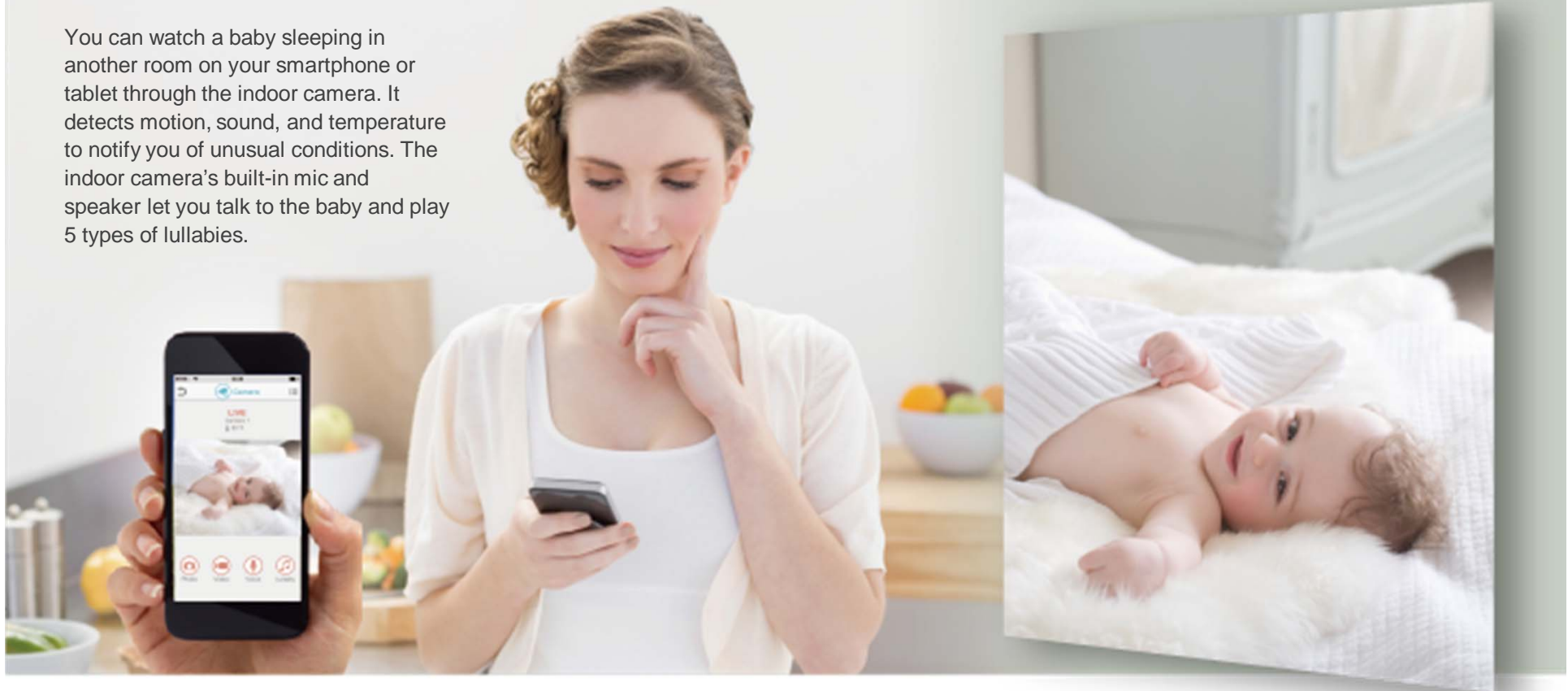

Home Monitoring

Detect water leaks and send 3 way notification

Product Combination



HUB
[KX-HNB600]



Water Leak Sensor
[KX-HNS103]



Digital Cordless Handset
[KX-HNH100]

Features

- Water leak detection
- 3 way notification



Receive notifications on your smartphone or tablet and monitor remotely

When the water leak sensor detects a water leak, the smartphone app is automatically notified and the hub beeps. Notifications can be checked when you are inside or outside the home. If you have a cordless handset, it can also announce the location and name of the sensor.



Alerting a handset

Basement, water leak detected.



Hub beeping

Home Control

Useful tools to make the operation easier and quicker

Product Combination



HUB
[KX-HNB600]



Access Keypad
[KX-HNK101]



Keychain Remote
[KX-HNK102]

Features

- Easy and quick arming
disarming
- Trigger of pre-programmed
operation

One touch arming

Easy disarming

DECT Area

One touch disarming

Using an Access Keypad or a Keychain Remote makes it easy and quick to change ARM and DISARM when you come home or go out without activating an app on your smartphone.

A customizable smart button on a Keychain Remote can be used to trigger a pre-programmed operation such as turning on / off a smart plug or triggering an alarm system.

Home Control

Supplies power to your hub or other devices in the event of a power outage, giving you peace of mind

Product Combination



Backup Battery
[KX-HNP100]



HUB
[KX-HNB600]



Indoor Camera
[KX-HNC200]



Outdoor Camera
[KX-HNC600]



Indoor Siren
[KX-HNS105]

Features

- Backup power supply
- Notification of power outage

A backup battery supplies power to your hub unit, camera, or siren in the event of a power outage or when someone cuts the power. The hub unit can be triggered to call a pre-programmed phone number through a landline or to send a notification to your mobile device, in the event of a power outage.

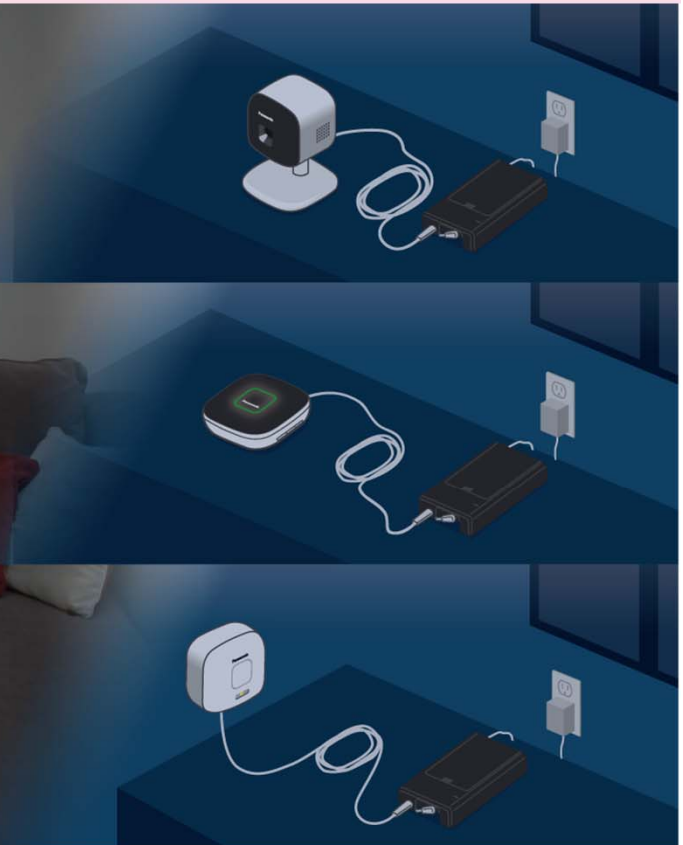

Home Safety

Detect the sound of glass breaking in the house

Product Combination



Glass Break Sensor
[KX-HNS104]



HUB
[KX-HNB600]



Indoor Camera
[KX-HNC200]



Outdoor Camera
[KX-HNC600]



Indoor Siren
[KX-HNS105]

Features

- Sensor notification
- Monitor remotely
- Automatic camera recording

When the glass break sensor detects the sound of glass breaking, the smartphone app is automatically notified, the hub beeps, and the indoor siren makes a loud sound. Notifications can be checked when you are inside* or outside the home. It can also be used together with an indoor camera or outdoor camera to start recording when the sensor is triggered.



Receive notifications on your smartphone or tablet and monitor remotely



Makes a loud sound and flashes an LED light when triggered by sensors.



Hub beeping



Automatic camera recording

* Requires a setting to be changed by the user.

Panasonic

Home Monitoring

Check whether the garage is open or closed when away from home

Product Combination



HUB
[KX-HNB600]



Garage Door Sensor
[KX-HNS107]



Outdoor Camera
[KX-HNC600]



Smart Plug
[KX-HNA101]

Features

- Sensor notification
- Automatic camera recording
- Monitor remotely
- Trigger other devices

A notification will be sent to your smartphone or tablet when you forget to close the garage. You can check remotely whether the garage is open or closed when away from home. Even at home, you will not need to go out to the garage for checking. It can be programmed to trigger other devices, such as recording video or turning on a light when the sensor is detected.

