



5MP Fixed Bullet Network Camera

Panasonic cameras are designed to provide high security, ensuring the safety of customers in their homes, shops, and offices. Equipped with advanced intelligence features, these cameras detect line crossings, abandoned or missing objects, and more, enhancing user security and peace of mind. Moreover, the cameras guarantee customer privacy through an advanced encryption algorithm and the Region of Interest (ROI) feature built into the camera.

Key Features

- H.265+/H.265/H.264+/H.264/MJPEG coding
- Max. resolution: 2880×1624
- ICR auto switch, true day/night vision
- 30 ~ 50m IR night view distance
- 3D DNR, true WDR, HLC, BLC, Defog, Smart IR and ROI coding
- Support image distortion correction
- Built-in micro SD card slot, up to 256GB
- DC12V/PoE power supply
- Weather protection up to IP67
- Support three streams
- Support P2P function
- Support Smart Motion Detection
- Advanced Intelligence
- Redundant system backup

Appearance

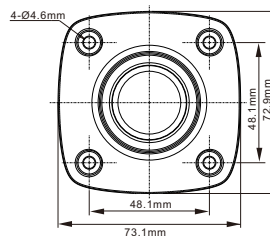
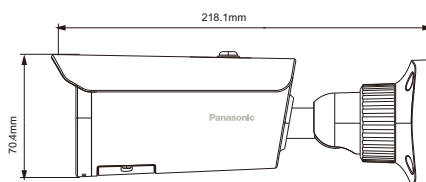

Optional Accessories

Mount Bracket



PM-YH0103-W
Junction box



PM-YH0104-W
Junction box



PM-YH0301-W
Junction box



PM-YH0301-W+
PM-YZJ0501-W
Pole Mount Bracket



PM-YH0301-W+
PM-YZJ0601-W
Corner Mount Bracket



PM-YH0301-W+
PM-YZJ0810-W
Ceiling Mount Bracket

Specifications

Camera				
Image Sensor	1/2.5"CMOS			
Image Size	2880×1624			
Electronic Shutter	1/4s~1/100000 s			
Iris Type	Fixed Iris			
Min. Illumination	0.005 lux @F1.6, AGC ON; 0 lux with IR			
Lens	3.6 mm@F1.6, H.FoV: 79°; V.FoV:39°; D.FoV:96°			
Focus	Fixed			
Lens Mount	M12			
Day&Night	ICR			
Wide Dynamic Range	120dB			
Back Light Compensation (BLC)	Yes			
High Light Compensation (HLC	Yes			
Defog	Yes			
Digital Noise Reduction (DNR)	Yes			
S/N ratio	≥50dB			
Angle Adjustment	Pan: 0°~360°; Tilt:0°~90°;Rotation: 0°~360°			
Image				
Video Compression	Main stream: H.265+/H.265/H.264+/H.264 Sub/thirdstream:H.265+/H.265/H.264+/H.264/MJPEG			
H.265 Compression Standard	Main Profile@Leve4.1 High Tier			
Resolution	5MP(2880×1624), 4MP(2688×1520),1080P(1920×1080), 720P(1280×720), D1, VGA(640×480), CIF, 480×240			
Main Stream	5MP/4MP/1080P(60Hz : 1~30fps; 50Hz: 1~25fps)			
Sub Stream	1080P/720P/D1/VGA/CIF/480×240(60Hz : 1~30fps; 50Hz: 1~25fps)			
Third Stream	D1/CIF/480×240 (60Hz : 1~ 30fps; 50Hz: 1~25fps)			
Bit Rate	64 Kbps ~10 Mbps			
Bit Rate Type	VBR/CBR			
Image Settings	ROI, Saturation, Brightness, Hue, Contrast, Wide Dynamic, Sharpness, Image Mirror, Image Flip, NR, etc. adjustable through client software or web browser			
Audio Compression	G711A/U			
Region of Interest (ROI)	Each ROI to be configured separately			
Interfaces				
Network	RJ 45 10M/100M self-adaptive Ethernet port			
Audio	1CH audio input; 1CH audio output; 1 CH built-in MIC			
Storage	Built-in micro SD card slot, up to 256GB			
Reset	Yes			
I/O	1CH alarm input; 1CH alarm output			
DORI Distance				
Lens	Detect	Observe	Recognize	Identify
3.6mm	102m(334ft)	41m(133ft)	20m(67ft)	10m(33ft)
Intelligent analytics				
Smart Event	Line crossing, region intrusion/entrance/exiting (human/vehicle classification) loitering detection, illegal parking detection, abandoned/missing object detection			
Statistics	Target counting by line/area, heat map			
Exception Detection	Scene change, video blur and abnormal color detection, audio exception			
Face Detection	Face detection and face capture			
Video Metadata	Simultaneously captures human body, motor vehicle and non-motor vehicle and extracts 13 human features, 4 motor vehicle features and 1 non-motor vehicle feature			
Functions				
Remote Monitoring	Web browser/NVR/NVMS2.X/Mobile APP			
Web Browser	Chrome 89.0+/Edge 89.0+/Firefox 87.0+/Safari 14.0+			
Online Connection	Support simultaneous monitoring for up to 10 users; Support multi-stream real time transmission			
Network Protocol	UDP, IPv4, IPv6, DHCP, NTP, RTSP, RTP, RTMP, RTCP, PPPoE, DDNS, SMTP, FTP, SNMP, HTTP, HTTP POST, 802.1x, UPnP, HTTPS, P2P, QoS			
Interface Protocol	ONVIF			
Storage	Network remote storage; micro SD card storage			
Smart Alarm	Motion detection, SMD, SD card full, SD card error, IP address conflict, cable disconnection, video exception (scene change, video blur and abnormal color detection)			
General Function	Watermark, IP address filtering, video mask, heartbeat, image distortion correction, corridor pattern, ANR, cloud upgrade			
Security	Video encryption, firmware encryption, HTTPS encryption, configuration encryption, illegal login lock, IP address filtering, 802.1x authentication, basic and digest authentication for HTTP/RTSP			
PoE	Yes, IEEE802.3af			
IR Distance	30 ~ 50 m			
Weather Protection	IP67 Protection from dust and water			
Others				
Power Supply	DC12V/PoE			
Power Consumption	<10.5W			
Operating Environment	-30°C~60°C (-22°F~140°F);Humidity: less than 95 % (non-condensing)			
Storage Environment	- 30°C~65°C (-22°F~149°F), Humidity: less than 95 % (non-condensing)			
Dimensions (mm)	218.1×70.4×80.3			
Weight (net)	Approx. 0.73KG			
Installation	Ceiling mounting; Wall mounting			
Certificate	EMC: CE/EN 55032:2015+A11:2020 EN 55035:2017+A11:2020 Safety: IEC 62368-1:2020+A11:2020 RoHS: 2011/65/EU			
Environmental Protection	Complies with Directive EU RoHS, WEEE(2012/19/EU) , directive 94/62/EC and REACH(EC1907/2006)			