

# Panasonic®

## Operating Instructions Washer and Dryer

Model no: NA-S085M2\*

Thank you very much for purchasing Panasonic Washing Machine

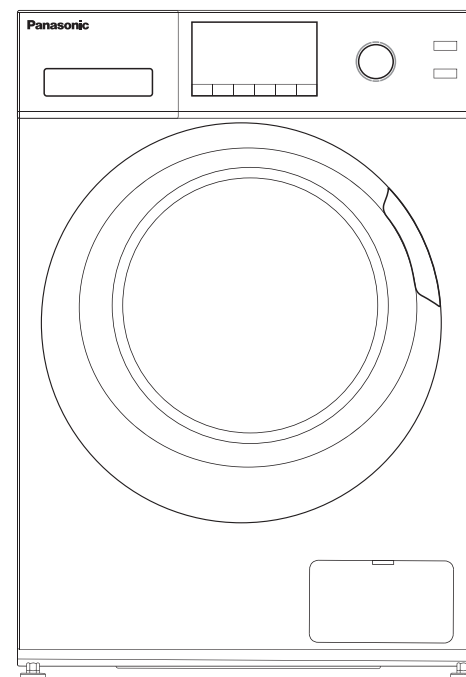

\*Picture is only for illustration

\*LSA-Silver  
\*WSA-White

Before operating this unit, please completely read these instructions especially the **Safety Precautions and Important Instructions**.



## Contents

---

<b>Safety Precautions</b> .....	3
<b>Overview of Washer dryer Machine</b> .....	8
<b>Install Washer dryer Machine</b> .....	9
<b>Operate Washer dryer Machine</b> .....	12
Checklist and Preparation before Washing Clothes .....	12
View of Control Panel.....	17
Select the procedure .....	18
Table of Washing and drying Procedures .....	22
<b>Maintenance</b> .....	23
Cleaning and Maintenance of Washer dryer Machine Cabinet .....	24
Troubleshooting.....	26
Remove the problems .....	27
<b>Appendix</b> .....	28
Care Label.....	28
Product Specifications .....	29

## Safety Precautions

---

### ■ Safety Precautions

- If the supply cord is damaged, it must be replaced by the manufacturer, its service agent or similarly qualified persons in order to avoid a hazard.
- The new hose-sets supplied with the appliance are to be used and that old hose-sets should not be reused.
- This washer dryer machine is for indoor use only.
- The ventilation openings must not be obstructed by a carpet.
- This appliance can be used by children aged from 8 years and above and persons with reduced physical, sensory or mental capabilities or lack of experience and knowledge if they have been given supervision or instruction concerning use of the appliance in a safe way and understand the hazards involved. Children shall not play with the appliance. Cleaning and user maintenance shall not be made by children without supervision.
- This appliance is not intended for use by persons (including children) with reduced physical, sensory or mental capabilities, or lack of experience and knowledge, unless they have been given supervision or instruction concerning use of the appliance by a person responsible for their safety. Children should be supervised to ensure that they do not play with the appliance.
- Pull out its plug from the power socket before cleaning or maintenance.
- Make sure that all pockets are emptied.

## Safety Precautions

---

- Do not use any socket with rated current less than that of washer dryer machine. Never pull out power plug with wet hand.
- To ensure your safety, power cord plug must be inserted into an earthed three-pole socket. Check carefully and make sure that your socket is properly and reliably earthed.
- Children of less than 3 years should be kept away unless continuously supervised.
- Kids should be supervised to ensure that they do not play with the machine.
- Packing materials may be dangerous to the kids. Please keep all packing materials (plastic bags, foams etc) far away from the kids.
- Washer dryer machine shall not be installed in bath room or very wet rooms as well as in the rooms with explosive or caustic gases.
- Make sure that the water and electrical devices must be connected by a qualified technician in accordance with the manufacturer's instructions and local safety regulations.
- Before operating this machine, all packages and transport bolts must be removed. Otherwise, the washer dryer machine may be seriously damaged while washing the clothes.
- Before washing the clothes at first time, the washer dryer machine shall be operated in one round of the whole procedures without the clothes inside.
- The washer dryer machine with single inlet valve only can be connected to the cold water supply. The washer drier machine with double inlet valves can be connected to the hot water and cold water supply.
- Your washer dryer machine is only for home use and is only designed for the textiles suitable for machine washing.
- Flammable and explosive or toxic solvents are forbidden.

## Safety Precautions

---

- Gasoline and alcohol etc. shall not be used as detergents. Please only select the detergents suitable for machine washing, especially for drum.
- It is forbidden to wash carpets.
  - Be careful of burning when washer dryer machine drains hot washing water.
  - Never refill the water by hand during washing.
  - After the program is completed, please wait for two minutes to open the door.
  - Please remember to disconnect water and power supply immediately after the clothes are washed.
  - Do not climb up and sit on top cover of the machine.
  - Do not lean against machine door.
  - Please do not close the door with excessive forces. If it is found difficult to close the door, please check if the excessive clothes are put in or distributed well.
  - Cautions during Handling Machine
    1. Transport bolts shall be reinstalled to the machine by a specialized person.
    2. The accumulated water shall be drained out of the machine.
    3. Handle the machine carefully. Never hold each protruded part on the machine while lifting. Machine door can not be used as the handle during the conveyance.
    4. That the hands shall not be inserted into running water -extracting tub.
  - The washer dryer is not to be used if industrial chemicals have been used for cleaning.
  - Oil-affected items can ignite spontaneously, especially when exposed to heat sources such as in a tumble dryer. The items become warm, causing an oxidation reaction in the oil. Oxidation creates heat. If the heat cannot escape,

## Safety Precautions

---

the items can become hot enough to catch fire. Piling, stacking or storing oil-affected items can prevent heat from escaping and so create a fire hazard.

- If it is unavoidable that fabrics that contain vegetable or cooking oil or have been contaminated by hair care products. be placed in a tumble dryer they should first be washed in hot water with extra detergent - this will reduce, but not eliminate, the hazard.
- Adequate ventilation has to be provided to avoid the back flow of gases into the room from appliances burning other fuels, including open fires.
- Do not dry unwashed items in the washer drier.
- Items that have been soiled with substances such as cooking oil, acetone, alcohol, petrol, kerosene, spot removers, turpentine, waxes and wax removers should be washed in hot with an extra amount of detergent before being dried in the washer dryer.
- Items such as foam rubber (latex foam), shower caps, water proof textiles, rubber backed articles and clothes or pillows fitted with foam rubber pads should not be dried in the washer dryer.
- Fabric softeners, or similar products, should be used as specified by the fabric softener instructions.
- The final part of a washer dryer cycle occurs without heat (cool down cycle) to ensure that the items are left at a temperature that ensures that the items will not be damaged.
- Remove all objects from pockets such as lighters and matches before use the appliance.
- **WARNING:** Never stop a washer dryer before the end of the drying cycle unless all items are quickly removed and spread out so that the heat is dissipated.

## Safety Precautions

---

- The openings must not be obstructed by a carpet.
- The exhaust air must not be discharged into a flue which is for exhausting fumes from appliances burning gas or other fuels.
- The appliance must not be installed behind a lockable door, a sliding door or a door with a hinge on the opposite side to that of the washer dryer.
- The washer drier shall not be installed at a humid place.
- The household washer dryer isn't intended to be built-in.
- The washer and dryer lid when opened during water extraction then it takes 15s or more for complete stop of water extracting chamber tub.

## Overview of Washer Dryer Machine

### ■ Component

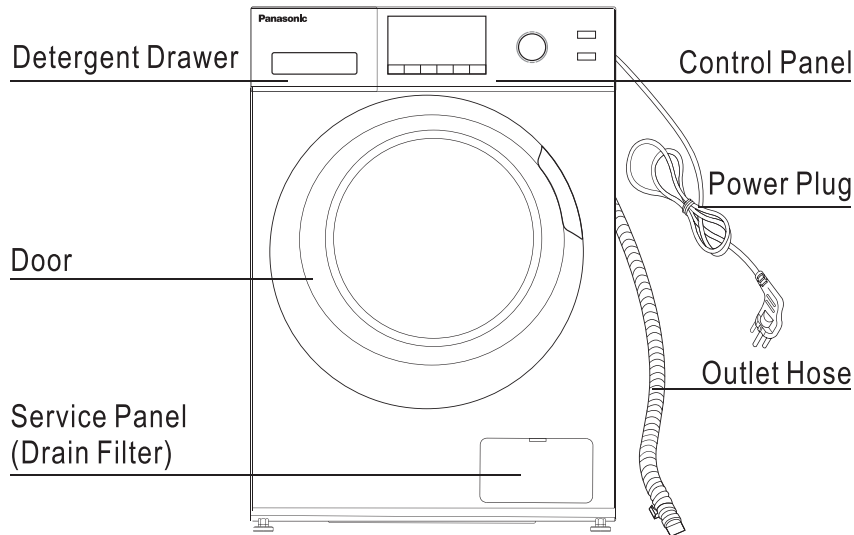

Disclaimer:- Pictures for illustration only

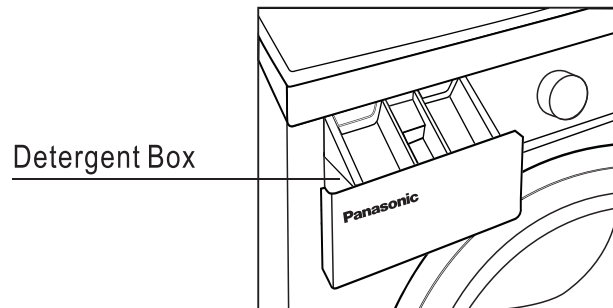

### ■ Accessories

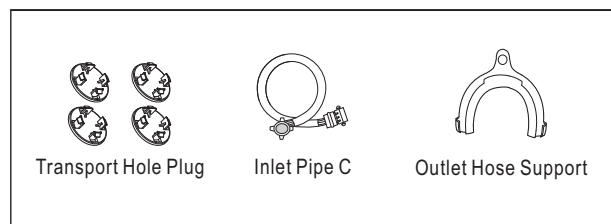

## Install Washer Dryer Machine

### ■ Unpacking the washer dryer machine

Unpack your washer dryer machine and check if there is any damage during the transportation. Also make sure that all the items in the attached bag are received.

If there is any damage to the washer dryer machine during the transportation, or any item is missing, please contact the local dealer immediately.

### ■ Dispose the packing materials

The packing materials of this machine may be dangerous to kids. Please dispose them properly and avoid easy touch by kids. Please dispose the related packing materials according to the relevant local regulations. Please do not throw the packing materials away together with the other daily living rubbishes.

### ■ Remove transport bolts

Before using this washer dryer machine, transport bolts must be removed from the backside of this machine. Please take the following steps to remove the bolts:

1. Loosen all bolts with spanner and then remove them.
2. Stop the holes with transport hole plugs.
3. Keep the transport bolts properly for future use.

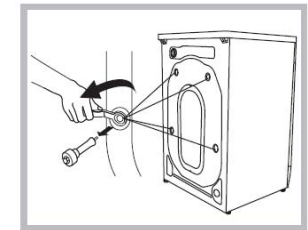

### ■ Select the location

Before installing the washer dryer machine, the location characterized as follows shall be selected:

- Rigid, dry, and level surface (if not level, please make it level with reference to the following figure "Adjust Leg")
- Avoid direct sunlight
- Sufficient ventilation
- Room temperature is above 0°C
- Keep far away from the heat resources such as coal or gas.

Make sure that the washer dryer machine will not stand on power cord.

Do not install the washing machine on the carpet floor.

### ■ Adjust Leg

1. When positioning the washer dryer machine, please first check if the legs are closely attached to the cabinet. If not, please turn them to their original positions with hand or spanner and tighten the nuts with spanner.

2. After positioning the washer dryer machine, press four corners on top cover of washer dryer machine in sequence. If the washing machine is not stable when being pressed, this leg shall be adjusted.

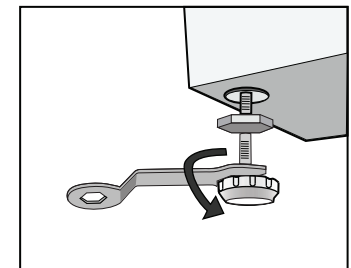

## Install Washer Dryer Machine

3. Ensure the positioning status of washer dryer machine. Loosen the lock nut with spanner and turn the leg with hand until it closely contacts with the floor. Press the leg with one hand and fasten the nut closely to the cabinet with the other hand.
4. After being locked properly, press four corners again to make sure that they have been adjusted properly. If it is still unstable, it has to repeat Steps 2 and 3.
5. Put a solid cylinder (e.g. pop cans) oppositely on the top cover of the washer dryer machine from in the left, right, front and back directions. If the cylinder keeps stable, the washer dryer machine is positioned level. If it rolls, the washer dryer machine is positioned unlevel. The rolling direction is the direction of lower ground surface. Then, the two legs in this direction shall be raised at the same time until the washer dryer machine is level. Steps 1~3 are repeated to make the bottom legs closely against the ground and the nuts shall be locked tightly.

### ■ Install inlet pipe

1. Connect the elbow to tap and fasten it clockwise.
2. Connect the other end of inlet pipe to the inlet valve at the backside of washing machine and fasten the pipe tightly clockwise.

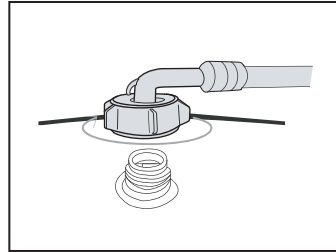

Notes: after connection, if there is any leakage with hose, then repeat the steps to connect inlet pipe. The most common type of tap shall be used to supply water. If tap is square or too big, then standard tap shall be changed.

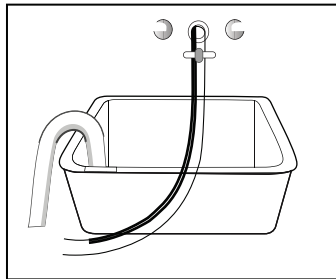

### ■ Place outlet hose

- There are two ways to place the end of outlet hose:
1. Put it beside the water trough.

## Install Washer Dryer Machine

2. Connect it to the branch drain pipe of the trough.

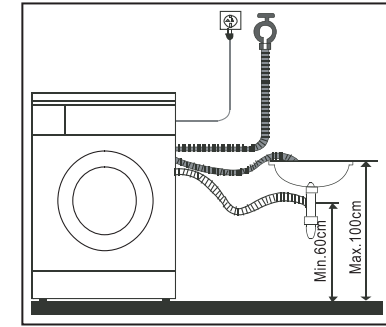
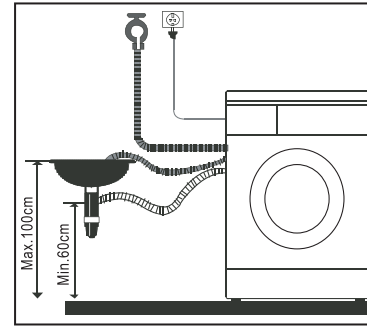

- It can drain the water up and down, outlet hose shall not be installed at a height beyond 100cm and its end shall not be immersed in water.

Position outlet hose properly so that the floor will not be damaged by water leakage.

Notes:

If the machine has outlet hose support, please install it like the following pictures.

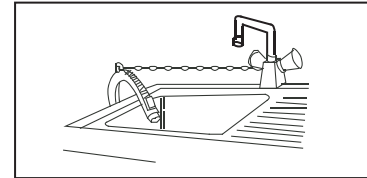

- When installing outlet hose, fix it properly with a rope.
- Position outlet hose properly so that the floor will not be damaged by water leakage.

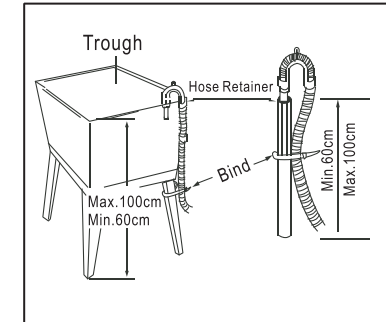

- If outlet hose is too long, do not force it into washer dryer machine as it will cause abnormal noises.

### ■ Electrical Connection

- As the maximum current through the unit is 10A when you are using its heating function, please make sure the power supply system (current, power voltage and wire) at your home can meet the normal loading requirements of the electrical appliances.
- Please connect the power to a socket which is correctly installed and properly earthed.
- Make sure the power voltage at your place is same to that in the machine's rating label.
- Power plug must match the socket and cabinet must be properly and effectively earthed.
- Do not use multi-purpose plug or socket as extension cord.
- Do not connect and pull out plug with wet hand.
- When connecting and pulling out the plug, hold the plug tightly and then pull it out. Do not pull power cord forcibly.
- If power cord is damaged or has any sign of being broken, special power cord must be selected or purchased from its manufacturer or service center for replacement.

## Install Washer Dryer Machine

### WARNING

1. **This machine must be earthed properly.** If there is any short circuit, earthing can reduce the danger of electrical shock.  
This machine is equipped with power cord, which includes plug, earthing wire at earthing terminal.
2. Washer dryer machine shall be operated in a circuit separate from other electrical appliances. Otherwise, power protector may be tripped or fuse may be burned out.

## Operate Washer Dryer Machine

### ■ Checklist and Preparation before Washing Clothes

Please read this operation method carefully to avoid the troubles of washing machine and damages of clothes.

#### Check if the first-washed clothes will be decolorized.

After a white towel touched with liquid detergent is used to wash the invisible corners of the clothes, check if the white towel is stained with clothes' original color.

As for the scarves and those clothes that easily get decolorized among imported clothes, please wash them separately before washing.

As for the stains on sleeves, collars and pockets, use the liquid detergent and wash it with brush gently. Finally put them into the washer dryer machine to achieve more ideal washing effects.

As for temperature-sensitive clothes, they shall be washed as required in the labels. Otherwise, it may cause color change or distortion.

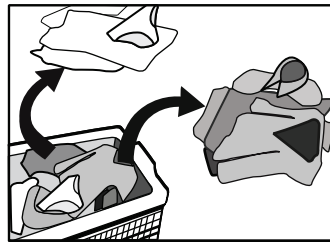

#### Keep in Mind:

Never put the clothes to be washed in washer dryer machine for a long period of time. Otherwise it may get moldy and cause spots. Therefore, please wash the clothes in time. The clothes also may get color changed or distorted if they are not washed according to the stated washing temperature.

#### Clothes that can not be washed by washer dryer machine

The clothes that may get distorted if being immersed in water:

Ties, waistcoats, western-style clothes, outer garments etc. may have obvious shrinkage if being immersed in water; the decolorized clothes such as blended spinning clothes of artificial fiber etc.

## Operate Washer Dryer Machine

Wrinkle-style clothes, embossed clothes, resin clothes etc. may get distorted when being immersed in water. Among cotton and wool materials, the clothes that get easily distorted are wrinkle-style silk, fur products and fur decorations;

Clothes with decoration, long dress and traditional clothes etc are the products to get decolorized easily.

Please do not wash the clothes without material labels and washing requirements.

Never wash the clothes stained with the chemicals such as gasoline, petroleum, benzene, paint thinner and alcohol.

#### Please pay attention with regard to detergents

"Low bubble" detergent or washing powder or washing powder special for drum washing machine shall be selected according to fiber types (cotton, synthetic fiber, soft products and wool products), colors, washing temperatures, dirty degrees and types. Otherwise, excessive bubbles may be generated and overflowed out of the drawer so that accidents may take place.

Bleacher belongs to alkali type and can damage clothes, so it is suggested to use as little as possible.

Powder detergents can easily leave the residues in the clothes so as to generate the bad smell, so they shall be sufficiently rinsed.

Detergent can not easily get dissolved completely if there is too much detergent or water temperature is rather low. It can remain in clothes, pipes and washing machines to pollute the clothes.

Washing shall follow the weight of clothes, dirty degrees, local water hardness as well as the recommendations from the detergent manufacturers. Please consult the water company if you are not clear of water hardness.

#### Notes:

Keep detergents and additives in safe and dry places out of touch by kids.

### ■ Checklist and Preparation before Washing Clothes

#### Please take out the items out of the pockets.

Please check the pockets of the clothes to be washed, empty the rigid items such as decorations and coins, otherwise washing machine may be damaged or have abnormal troubles.

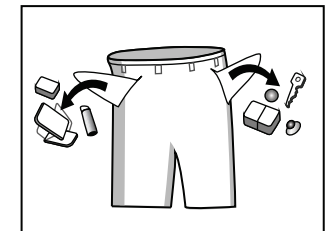

#### For the clothes to be washed, they are classified according to the following characteristics:

The symbol types of care labels: the clothes to be washed are classified into cotton, blended fiber, synthetic fiber, silk, wool and artificial fiber.



## Operate Washer Dryer Machine

Color: white and colorful colors shall be identified. All new colorful articles shall be washed in a separate way.

Size: the articles of different sizes are washed together to increase the washing effects.

Sensitivity: soft articles shall be washed separately. As for new pure wool textiles, curtains and silks, the soft washing procedure shall be selected. Check the labels in all washing articles.

The clothes shall be sorted before being put into washer dryer. As for the curtains with hooks, the hooks shall be removed before being washed.

The decorations on the clothes may damage the washer dryer machine. As for the clothes with buttons or embroideries, they shall be turned over before being washed.

### Clean up fasteners:

Zips shall be zipped close and buttons or hooks shall be fixed. The loose band or ribbon shall be bound together.

 It is suggested to put bras into the pillow slip with zip or buttons sealed to prevent the steel wire from popping out of bras into the drum and damaging the machine.

Especially delicate textiles such as laced curtains, straight jackets, small articles (tight socks, handkerchiefs, ties etc.) shall be put into string bag for washing.

When washing a single big and heavy dress such as Turkish towels, jeans, wadded jackets etc., it may easily cause great eccentricity and give alarm due to great unbalance. Therefore it is suggested to add one or two more clothes to be washed together so that draining can be done smoothly.

### Clean away dusts, stains and pet hairs from the clothes.

The clothes may be damaged and disturb washing effects during the friction between dusts, stains and clothes.

### To protect baby skin

Baby articles (baby clothes and towels) including napkins shall be washed separately. If they are washed together with the adults' clothes, they may be infected. Rinsing times shall be increased to ensure the thorough rinsing and cleaning without the detergent residues.

**It is suggested that the parts that are easily stained such as white sockets, collars and sleeves etc. shall be hand washed before being put into washing machine to achieve more ideal washing effects.**

Please use powder or liquid detergents. The residues of the soap could remain in the gaps of the clothes if soap is used.

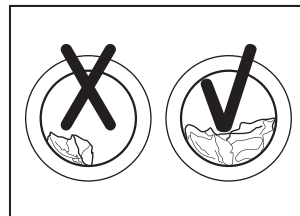
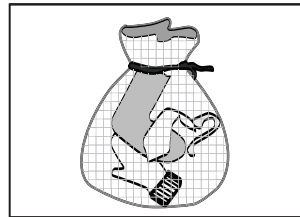

## Operate Washer Dryer Machine

### Pre-wash cotton cloth

New-developed washer dryer together with new-developed detergent can make washing perfect, which can save energy, time, water and detergent. But if cotton cloth is very dirty, albumen-based detergent can be used for pre-washing.

Confirm the washing capacity:

Do not put excessive washings; otherwise it may affect the washing effects. Please confirm the maximum affordable washing quantity according to the following table.

Fiber Type	Maximum Loading Capacity
	8.0kg
Cotton	8.0kg
Synthetic	4.0kg
Wool	2.0kg

**Note: The rated capacity is the maximum capacity, make sure that the dry clothes which are loaded to the appliance do not exceed the rated capacity each time.**

### The clothes which easily get fuzzed shall be turned over for washing

The clothes which easily get fuzzed shall be washed separately; otherwise the other articles can be stained with dust and thrum etc. Preferably, black clothes and cotton clothes shall be washed separately because they can easily get stained with the thrums of other colors when being washed together.

Please check before washing.

### Washing machine shall not wash water-proof materials (ski suits, outside napkin pads, curtains).

As for the fiber products that water can not get soaked easily into such as water-proof cushions, and clothes, it is better not to wash. Otherwise there will be water bursting out or abnormal vibration to cause danger while rinsing and draining so that the clothes also may be damaged. (Such as outside napkin pads, raincoats, umbrella, ski suits, car covers, sleeping sacks etc.)

### Cautions during Draining

Draining of normal clothes:

Moistures of washings are drained through drain hole. Draining of water-proof clothes and fiber products:

In the normal washing and draining status, moistures of water-proof clothes and fiber products can not be drained while washing water is gathered in one direction so that the eccentricity of washing machine is too great and vibration or moving is caused.

### Drying hints

Clothes could be dried after spinning.

Please don't press the button speed when spinning to ensure the clothes spin properly.

As for synthetic textiles, the proper spin speed should be selected before dry them.

To ensure quality dry the textiles, please classify them according to their kinds and the drying temperature.

Synthetic should better be taken out before drying out by out to protect them and please set the proper drying time according to their load.



## Operate Washer Dryer Machine

If you want to iron the clothes after drying, please put them for a while to make the humidity diffuse in the clothes.

### Garments not suitable for drying

Particularly delicate items such as synthetic curtains, woolen and silk, garments with metal inserts, nylon stockings, bulky garments such as anoraks, bedcovers, quilts, sleeping bags and duvets must not be machine dried.

Garments padded with foam-rubber or materials similar to foam-rubber must not be machine dried; they represent a fire hazard.

Also, fabrics containing residues of setting lotions or hair sprays, nail solvents or similar solutions must not be machine dried in order to avoid the formation of harmful vapours.

## Operate Washer Dryer Machine

### ■ View of Control Panel

**On/Off**

Press once to turn the washing machine on, press again to turn the washing machine off.

**Dry** ❄️

Press the Dry button continuously to choose the dry level: Extra Dry/Normal Dry/Gentle Dry/Air Dry.

❄️ Extra Dry: Need to wear clothes immediately, we can choose this function.

❄️ Normal Dry: The normal dry procedure.

❄️ Gentle Dry: Only to dry slightly and then is just ok.

❄️ All Dry: Clothes is rotated to remove peculiar smell without water in high temperature.

**Start/Pause**

Press the button to start or pause the wash cycle

**Speed**

600-800-1000-1200-1400

**Function setting**

Press the button repeatedly to set the water temp. washing time, rinse number, spin speed and so on.

**Programme**

For the convenience of users to washing clothes with the different programme.

**Programme**

For the convenience of users to washing clothes with the different programme.

**Function setting**

Press the button repeatedly to set the water temp. washing time, rinse number, spin speed and so on.

**Speed**

600-800-1000-1200-1400

**On/Off**

Press once to turn the washing machine on, press again to turn the washing machine off.

**Dry** ❄️

Press the Dry button continuously to choose the dry level: Extra Dry/Normal Dry/Gentle Dry/Air Dry.

❄️ Extra Dry: Need to wear clothes immediately, we can choose this function.

❄️ Normal Dry: The normal dry procedure.

❄️ Gentle Dry: Only to dry slightly and then is just ok.

❄️ All Dry: Clothes is rotated to remove peculiar smell without water in high temperature.

**Start/Pause**

Press the button to start or pause the wash cycle

**Speed**

600-800-1000-1200-1400

**Function setting**

Press the button repeatedly to set the water temp. washing time, rinse number, spin speed and so on.

**Programme**

For the convenience of users to washing clothes with the different programme.

**Programme**

For the convenience of users to washing clothes with the different programme.

**Function setting**

Press the button repeatedly to set the water temp. washing time, rinse number, spin speed and so on.

**Speed**

600-800-1000-1200-1400

**Programme**

For the convenience of users to washing clothes with the different programme.

**Function setting**

Press the button repeatedly to set the water temp. washing time, rinse number, spin speed and so on.

**Speed**

600-800-1000-1200-1400

**Programme**

For the convenience of users to washing clothes with the different programme.

**Function setting**

Press the button repeatedly to set the water temp. washing time, rinse number, spin speed and so on.

**Speed**

600-800-1000-1200-1400

**Notes:**

- The Control panel line chart is for reference only, Please refer to real product as standard.
- The Control panel could be changed without written notice.
- When the lights of Speed are off means the speed is 0.

## Operate Washer Dryer Machine

### ■ Washing Clothes at first time

Before washing clothes at first time, the washing machine shall be operated in one round of the whole procedures without clothes in as follows:

- 1.Connect power source and water.
- 2.Put a little detergent into the box and close it.
- 3.Press the button "On/Off".
- 4.Press the button "Start/Pause".

The drawer is separated as follows:

I: Pre-detergent.

II: Main detergent, pre-dip, bleaching or decontaminating product.

☼: Washing additive, such as fabric softener or tackifier.

### ■ Put detergent into washer dryer machine.

- 1.Pull out the drawer.
- 2.Fill pre-detergent into Case I (when necessary).
- 3.Fill detergent into Case II.

option1: detergent (powder) . option2:detergent(liquid)

- 4.Fill softener into Case ☼(when necessary).

Notes:

- As for the agglomerated or ropy detergent or additive, before they are poured into the detergent box, it is suggested to use some water for dilution to prevent the inlet of detergent box from being blocked and overflowing while filling water.
- Please choose suitable type of detergent for the various washing temperature to get the best washing effect with less water and energy consumption.

### ■ Start up washer dryer machine

Connect the power. Check if water pipes are connected properly. Open the tap completely. Put in the clothes to be washed and fill in the detergent and tackifier. Then press the button "On/Off", Select the proper procedures and functions and press the button "Start/Pause".

### ■ Select the procedure

The proper washing procedures shall be selected according to the types, quantities, and dirtiness of the clothes to be washed in combination with the following washing temperature table.

90 °C	Seriously besmirched, pure white cotton or flax (for example: coffee table cloths, canteen table cloths, towels, bed sheets)
60 °C	Moderately besmirched, colorful flax, cotton and synthetic articles with certain decolorizing degree (for example: shirts, night pajamas; Slightly besmirched, pure white flax (for example: underwear)
40 °C, 30 °C, 20 °C Cold water	Normally besmirched articles (for example:synthetic and wool)

## Operate Washer Dryer Machine

First, turn the rotary switch to select the corresponding procedures according to the types of textiles.

Second, select the proper temperature according to the dirtiness. Generally, the higher the temperature is, the more the power is consumed.

Last, select the proper revolution speed. The normal textiles are recommended with 1000~1200rpm and the delicate textiles with 600~800rpm. The higher the revolution speed is, the dryer the textiles are spun, but higher the noises will also be increased.

The surfaces of delicate textiles will have wrinkles and the working life of washing machine will be shortened.

**PLEASE NOTE:** to protect the clothes, the lower revolution speed shall be selected for delicate textiles. The main washing procedures depend on the types of the clothes to be washed. The main washing troubles can be selected as follows:

#### - 1Hour W/D

For small synthetic clothes or shirts, load limitation is 1 kg (about 4 shirts). When you have an urgent appointment but no more clean shirt left in your cupboard, this program will help you. Time duration is only 1 hour including wash and dry. Remark: Big towels or jeans is not suitable for this program, they will enlarge the time duration and affect the moisture content.

#### - Cotton

You can select this procedure to wash the daily washable clothes. The washing period is quite long with quite strong washing intension. It is recommended to wash the daily cotton articles, for example: bed sheets, quilt covers, pillowcases, gowns, underwear etc.

#### - Synthetic

You can select this procedure to wash the quite delicate clothes. The procedure is shorter compared with that for cottons and the washing intension is quite gentle. It is recommended to wash synthetic articles, for example: shirts, coats, blending. As for curtains and laced textiles, the procedure "Synthetic" shall be selected. While washing the knitting textiles, detergent quantity shall be reduced due to its loose string construction and easily forming bubbles.

#### - Baby Care

You can select this procedure to wash your baby's clothes, it can make the baby's wear cleaner and make the rinse performance better to protect the baby's skin.

#### - Mix

You can select this procedure wash the tough clothes, that need much more time and strength. It is used for the daily clothes fo cotton, such as sheets, chained, pillowcases bathrobe and underwear.

#### - Dry Only

Select Dry programme to dry clothes, the drying temperature is different .Select the drying time according to the load .

#### - Cotton ECO

To increase the washing effects, main additional washing time is increased.

It is recommended to wash the clothes for babies or worn by the persons with allergic skin.

#### - Sports Wear

You can select this procedure to wash the activewear.

## Operate Washer Dryer Machine

### - Rapid 15'

This procedure is suitable for washing few and not very dirty clothes quickly.

### - Delicate

You can select this procedure to wash your delicate clothes. Its washing intensity is gentler and revolution speed is less compared with the procedure "Synthetic". It is recommended for the articles to be washed softly.

### - Wool

You can select this procedure to wash the wool textiles labeled with "Machine Wash". Please select the proper washing temperature according to the label on the articles to be washed. Furthermore, the proper detergent shall be selected for wool textiles.

### - Colors

You can choose the program washing brightly colored clothing, it can protect the bright colors better.

### - Jeans

This program is specially designed for washing jeans.

### - Spin Only

Separate spin only procedure. Soap water or rinse water shall be drained out before spinning.

### - Rinse&Spin

Separate Rinse&Spin Procedure.

### - My Cycle

Press Spin button for 3 sec. to let My cycle memorize the procedure. The default My cycle is cotton.

### The main function can be selected as follows:

#### - Preset

Preset function can be set with this button, the delaying time is 0-24 H.

Set the Preset function:

1. Select a programme;
2. Press the Preset button to choose the time;
3. Press Start/Pause to commence the preset operation.

Cancel the Preset function: Press the Preset button until the display will be 0H. It should be pressed before starting the program. If the program already started, should press the On/Off button.

Notes: If there is any break in the power supply while the machine is operating, a special memory stores the selected programme and the left time will continue when the power is restarted. If not, please press the On/Off.

#### - Speed Wash

The function can decrease the washing time.

#### - Extra Rinse

The laundry will undergo extra rinse once after you select it.

#### - Extra Wash

So dirty clothes can choose this function. It can select the prewash function to increase the washing effect, you need to put detergent into the Case (I) when using pre-wash function.

## Operate Washer Dryer Machine

### - Prewash

The Prewash function can get an extra wash before main wash.

### - Anti -crease

Anti -crease function can be used to reduce the wrinkles of clothes.

### - Reload

This operation can be executed during the washing procedure. When the drum of the washer dryer machine is still rolling and there is large amount of water with high temperature in the drum, the state is unsafe and the door cannot be opened forcefully. Press "Start/Pause" for 3 sec. to reload and add the clothes in the mid way of the function.

Please follow the steps as below:

1. Wait until the drum stops rotation.
2. The door lock is unlocked.
3. Close the door when the clothes needs are loaded and repress the Start/Pause button.

Notes: Don't use the Reload function when the water surface over the edge of the inner tub and the temperature is higher.

### - Child Lock

To avoid the misuse of operation by kids during washing procedure, you can select this function.

In this function the other buttons will not work except On/Off button.

The machine can only be powered off with On/Off button.

Press "Function and Select" together 3 seconds during the running procedure, the buzzer will beep, Start/Pause button as well as the rotary switch are locked. Press the two buttons for 3 seconds together and buzzer will beep to release to locking. But if the power supply is cut off and power comes back the child lock function will be active unless it is deactivated as above.

### - Suppression of the buzzer function

This is an additional buzzer function on your appliance. After deactivating the buzzer function, the buzzer will be closed.

After starting the machine, press the "Dry & Temp." button for 3 seconds and you will hear a beep, then the buzzer will be deactivated. To restart the buzzer function, press the "Dry & Temp." button again for 3 seconds. The setting will be kept until the next reset.

Warning: After deactivating the buzzer function, the sounds will not be activated any more.

### - Bubble Removal Function

Bubble Check Function: Redundant bubbles will occur when there is excessive detergent, which will affect wash and rinse effects. The procedure will check automatically and one bubble removal procedure will be added automatically to remove bubbles when excessive bubbles are checked.

# Operate Washer Dryer Machine

## ■ Table of Washing and drying Procedures

Procedure Description	Load(kg)	Detergent Box			Delay	Speed Wash	Extra Rinse	Prewash	Extra Wash	Anti-Crease	Default Temp. (°C)	Default Time HH:MM	Default Speed (RPM)
		Case I	Case II	Softener Case									
Cotton ECO	8.0	×	●	○	○	×	×	×	×	×	60	3:18	1400
Sports wear	4.0	○	●	○	○	○	○	○	○	○	40	0:45	1200
Rapid 15'	2.0	×	●	○	○	×	×	×	×	×	Cold	0:15	800
Delicate	2.5	×	●	○	○	×	×	×	×	×	30	0:50	600
Wool	2.0	×	●	○	○	×	×	×	×	×	40	1:07	600
Colors	4.0	×	●	○	○	○	×	×	×	○	Cold	1:10	1000
Jeans	8.0	○	●	○	○	○	○	×	×	○	60	1:45	800
Spin Only	8.0	×	×	×	○	×	×	×	×	○	-	0:12	1000
Rinse&Spin	8.0	×	×	○	○	○	×	×	×	○	-	0:20	1000
Dry Only	4.0	×	×	×	○	×	×	×	×	×	-	3:29	1400
Mix	8.0	○	●	○	○	○	○	○	○	○	40	1:13	800
Baby Care	8.0	○	●	○	○	○	○	○	○	○	30	1:20	800
Synthetic	4.0	○	●	○	○	○	○	○	○	○	40	1:40	800
Cotton	8.0	○	●	○	○	○	○	○	○	○	40	2:40	800
1 Hour W/D	1.0	×	●	○	○	×	×	×	×	×	Cold	0:59	1400

**The energy class (KSA): B Energy test program: Cotton ECO 40/60 °C, Speed: the highest speed; Other as the default.**  
 Half load for 8.0Kg machine:4.0Kg.

"Cotton Eco 60 °C " is the standard washing program and "Dry only " is the standard drying programs to which the information in the label and the fiche relates, and they are suitable to clean normally soiled cotton laundry and that they are the most efficient programmes in terms of combined energy and water consumptions for washing that type of cotton laundry, that the actual water temperature may differ from the declared cycle temperature.

Notes: The parameters in this table are only for user's reference. The actual parameters maybe different with the parameters in above mentioned table.

● Means must ○ Means optional × Means not necessary

# Maintenance

Before your maintenance starts, please do pull out the power plug or disconnect power and close the tap.



- Solvents are forbidden to avoid that the washer dryer machine is damaged, and toxic gases are generated or exploded.
- Never use water to sprinkle and wash the machine.
- It is forbidden that the detergents containing PCMX are used to clean the machine.

## ■ Cleaning and Maintenance of Washer Dryer Machine Cabinet

Proper maintenance on the washer dryer machine can extend its working life. The surface can be cleaned with diluted non-abrasive neutral detergents when necessary. If there is any water overflow, use the wet cloth to wipe it off immediately. No sharp items are allowed to strike the cabinet.

Notes: formic acid and its diluted solvents or equivalent are forbidden.

## ■ Clean Internal Drum

The rusts left inside the drum by the metal articles shall be removed immediately with chlorine-free detergents.

Never use steel wool.

## ■ Dispose a Frozen Washer dryer Machine

When the temperature drops below zero and your washer dryer machine gets frozen, you may:

1. Disconnect the power supply for the machine.
2. Wash the tap with warm water to loosen inlet pipe.
3. Take down inlet pipe and immerse it in warm water.
4. Pour warm water into washing drum and wait for 10 minutes.
5. Reconnect inlet pipe to the tap and check whether inlet and outlet are working normally.

Notes: when the washing machine is reused, make sure the ambient temperature is above 0°C

## ■ Anti-freeze

If your machine is located in the room where it can get frozen easily, please drain the remaining water inside drain pipe and inlet pipe thoroughly.

### Remove the remaining water in inlet pipe:

1. Close the tap.
2. Screw off the inlet pipe from tap and put its end into the container.
3. Start up any procedure except single Wash or Drain procedure. Water will be drained out of inlet pipe if any for about 40 seconds.
4. Reconnect the inlet pipe to tap.

### Remove the remaining water in drain pump



To avoid burning, it shall be done after the hot water inside the machine cools down.

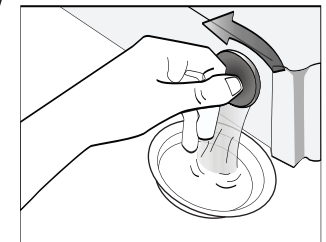

## Maintenance

### ■ Clean detergent box and grooves

Clean detergent drawer and grooves

1. Press down the arrow location on softener cover inside the drawer.
2. Lift the clip up and take out softener cover and wash all grooves with water.
3. Restore the softener cover and push the drawer into position.

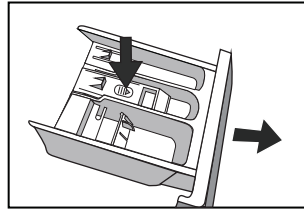

### ■ Clean inlet filter

Inlet filter shall must be cleaned if there is not any or insufficient water in when the tap is opened.

#### Clean the tap filter:

1. Close the tap.
2. Select any procedure except "Wash" or Rinse&Spin" procedure.
3. Press the button "START/PAUSE" and keep the procedure running for about 40 seconds.
4. Remove the inlet pipe from the tap.
5. Use water to wash the filter.
6. Reconnect the inlet pipe.

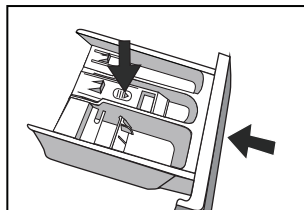
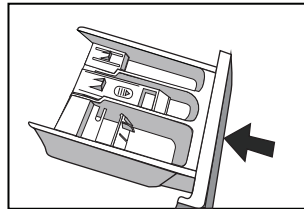

#### Washing the filter in washer dryer machine:

1. Screw off the inlet pipe from the backside of the machine.
2. Pull out the filter with long nose pliers and reinstall it back after being washed.
3. Reconnect the inlet pipe.
4. Open the tap and make sure there is no water leakage.
5. Close the tap.

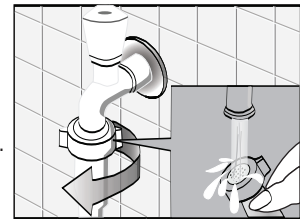

Notes: Generally, the tap filter is washed first and then the filter in washing machine will be washed. If only the filter in washing machine is washed, then the steps 1~3 in cleaning the tap filter shall be repeated.

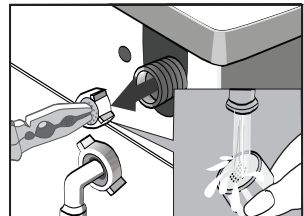
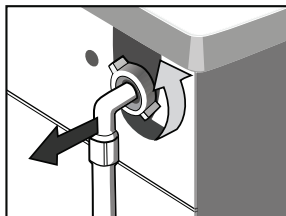

## Maintenance

### ⚠ WARNING

Pull out the power plug to avoid electrical shock before washing.

After using the washing machine, pull out the power cord and close the door tightly to avoid pinching the kids.

### ■ Remove foreign matters

#### Drain Pump Filter:

Drain pump filter can filter the yarns and small foreign matters from the washings. Clean the filter periodically to ensure the normal operation of washing machine.

### ⚠ WARNING

According to the soil level within the cycles and the frequency of the cycles, you have to inspect and clean the filter regularly.

The pump should be inspected if the machine does not empty and/or spin;

The machine makes an unusual noise during draining due to objects such as safety pins, coins etc. blocking the pump.

The Service\_panel proceed as follows:

1. After the power is disconnected, use hand to open the filter cover.

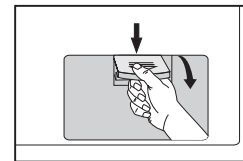

2. Turn the filter down as shown with the figure and take out sundries matters.

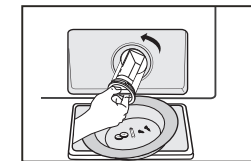

3. Reinstall each part back after sundries matters are removed.

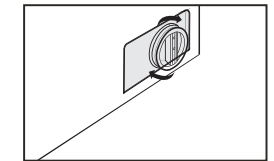

#### Warning!

When the appliance is in use and depending on the programme selected there can be hot water in the pump. Never remove the pump cover during a wash cycle, always wait until the appliance has finished the cycle, and is empty. When replacing the cover, ensure it is securely retight end so.



## Troubleshooting

Troubles	Reason	Solution
Washing machine cannot start up		Check if the door is closed tightly. Check if power plug is inserted well. Check if water supply tap is opened. Check if button "Start/Pause" is pressed. Check if button "On/Off" is pressed.
Door cannot be opened	Machine's safety protection design is working.	Disconnect the power.
Heating fault	NTC is damaged and heating pipe is aging.	Can normally wash the clothes. Only cannot wash with heating. Shall contact the service center promptly.
Water leakage	The connection between inlet pipe or outlet hose and tap or washing machine is not tight. Drain pipe in the room is blocked.	Check and fasten water pipes. Clean up outlet hose and ask a specialized person to repair it when necessary.
Water is overflowed from the bottom of the machine	The inlet pipe is not connected firmly. Outlet hose has water leakage.	Fix the inlet pipe. Replace the drain hose.
Indicator or display does not light.	Power is disconnected. PC board has problems. Harness has connection problem.	Check if the power is shut down and power plug is connected correctly. If not, please call up authorized service centre.
Detergent residues in the box	Washing powder is dampened and agglomerated.	Clean and wipe the box. Use liquid detergents or the detergents special for drum.
Washing effects are not good	The clothes are too dirty. Insufficient detergent quantity.	Select a proper procedure. Add the proper detergent quantity according to the instructions in detergent package.
Abnormal noise Great vibration		Check if the fixing (bolts) has been removed. If cabinet is installed on the solid and level floor. Check if there are any barrettes or metal articles inside. Check if the legs in the washing machine are adjusted level.

## Remove the problems























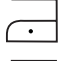







Display LED	Description	Reason	Solution
E30	Door lock problem	Door is not closed properly.	Restart after the door is closed.
		Please call up authorized service centre if there are still troubles.	
E10	Water injecting problem while washing	Tap is not opened or water flows too slowly. Inlet valve filter is blocked. Inlet pipe is twisted. If water is not supplied	Open the tap or wait till the water supply becomes normal. Check inlet valve filter. Straighten the water pipe Check the other taps in the room.
		Please call up authorized service centre if there are still troubles.	
E21	Drain problem while washing	Outlet hose is blocked or twisted Drain pump is blocked	Wash and straighten outlet hose. Wash drain pump filter
		Please call up service line if there are still troubles.	
Please call up the authorized service centre if there is any other problem.			



## Appendix

### Care Label

The label and sign on the fabric can help you to choose the best way to launder your clothes.

<p>Normal wash</p>  <p>Gentle wash</p> 	<p>40</p> <p>Warm wash (max 40°C)</p> 	<p>Hand wash</p>  <p>Do not wash</p> 	<p>Bleach</p>  <p>Do not bleach</p> 	<p>Chlorine bleach may be used</p>  <p>Chlorine bleach not be used</p> 	<p>Tumble dry. Medium (max 150°C)</p>  <p>Tumble dry. Low heat (max 110°C)</p> 
<p>Iron</p>  <p>Do not iron</p> 	<p>Cool iron(max 110°C)</p>  <p>Warm iron,medium (max 150°C)</p> 	<p>Dry clean</p>  <p>Do not dry clean</p> 	<p>Dry clean normal cycle with any solvent</p>  <p>Dry clean normal cycle petroleum solvent only</p> 	<p>Tumble dry normal</p>  <p>Dry flat</p> 	<p>Drip dry</p>  <p>Hang to dry /Line dry</p> 
<p>Iron with cloth</p>  <p>Steam Iron</p> 	<p>Dry after wash</p>  <p>Line Dry in shade</p> 	<p>Warmly dry clean</p>  <p>Do not tumble dry</p> 	<p>Line Dry</p> 	<p>No Wring</p> 	<p>No machine wash</p> 

### Electrical Warning

To avoid fire, electrical shock and other accidents, please remember the following reminding:

- Only the voltage indicated in power label can be used. If you are not clear of the voltage at home, please contact the local power bureau.
- When you are using the heating function, the maximum current through the washing machine will reach 10A. Therefore, please make sure the power supply units (current, voltage and cable) can meet the normal load requirements for the machine.
- Protect the power cord properly. Power cord shall be fixed well so that it will not trip the people or other things and be damaged. Special attention shall be paid to the socket. It shall be plugged into the sockets easily and attention shall be paid to the plug location.
- Do not make the wall-mounted socket overloaded or cable extended. Overloading of the wiring may cause fire or electrical shock. Do not pull out power plug with wet hand.
- To ensure your safety, power plug shall be inserted into an earthed three-pole socket. Carefully check and ensure that your socket is properly and reliably earthed.

## Product Specifications

Parameter	
Model	NA-S085M2*
Normal Load	8.0kg
Drying Load	4.0kg
Net Dimension(W*D*H)	595*565*850 mm
Net Weight	78kg
Rated input Power	2100W
Drying Power	1300W
Pump rated input Power	35W
Motor rated input Power	680W
Rated voltage, frequency	220-230V~, 60Hz
Water Pressure	0.05MPa~1MPa
Water Volume	57L
Standard program water volume consumption	93L
Annual Water Consumption	9240 L
Annual Energy Consumption	172 kWh

Model	NA-S085M2*
Capacity	8kg
Spin Speed	1400 rpm
Annual water consumption:	9240L /annual
Annual energy consumption:	172 kWh /annual
Power consumption of off-mode:	0.5W
Power consumption of left-on mode:	1.0W
Energy consumption of the standard 60°C at full load:	0.94 kWh /cycle
Energy consumption of the standard 60°C at partial load:	0.66 kWh /cycle
Energy consumption of the standard 40°C at partial load:	0.60 kWh /cycle
Water consumption of the standard 60°C at full load:	48L /cycle
Water consumption of the standard 60°C at partial load:	36L /cycle
Water consumption of the standard 40°C at partial load:	36L /cycle
Programme duration of the standard 60°C at full load:	199 min
Programme duration of the standard 60°C at partial load:	148 min
Programme duration of the standard 40°C at partial load:	149 min
Remaining moisture content of the standard 60°C at full load:	50 %
Remaining moisture content of the standard 60°C at partial load:	55 %
Remaining moisture content of the standard 40°C at partial load:	55%