



Operating Instructions for advanced features

Refer to "Operating Instructions for advanced features" (PDF format) for details about how to use the camera and notes on use. You can view the document by downloading it from the website below:

<https://panasonic.jp/support/dsc/oi/G97/index.html>

CE
EU

© Panasonic Entertainment & Communication Co., Ltd. 2025
E DVQX2623ZA
F1224MZ0

■ **To view the “Operating Instructions for advanced features”**
You will need Adobe Reader to browse or print the “Operating Instructions for advanced features” (PDF format).
You can download and install a version of Adobe Reader that you can use with your OS from the following website. (As of January 2025)
<http://www.adobe.com/products/acrobat/readstep2.html>

Information for Your Safety

WARNING:

To reduce the risk of fire, electric shock or product damage,

- Do not expose this unit to rain, moisture, dripping or splashing.
- Use the recommended accessories.
- Do not remove covers.
- Do not repair this unit by yourself. Refer servicing to qualified service personnel.

Product	Location
Digital camera	Bottom

Declaration of Conformity (DoC) for UK:
 Hereby, "Panasonic Entertainment & Communication Co., Ltd." declares that this product is in compliance with the essential requirements and other relevant provisions of the Radio Equipment Regulations 2017.
 Customers can download a copy of the original DoC for our RE products from our DoC server: <https://www.ptc.panasonic.eu/compliance-documents>
 Importer for UK: Panasonic UK, a branch of Panasonic Marketing Europe GmbH
 Maxis 2, Western Road, Bracknell, Berkshire, RG12 1RT

Type of wireless	Frequency band (central frequency)	Maximum power (dBm e.i.r.p.)
WLAN	2412-2462 MHz	13 dBm
Bluetooth	2402-2480 MHz	10 dBm

CAUTION

- Danger of explosion if battery is incorrectly replaced. Replace only with the type recommended by the manufacturer.
- When disposing of the batteries, please contact your local authorities or dealer and ask for the correct method of disposal.

- Warning**
Risk of fire, explosion and burns. Do not disassemble, heat above 60 °C or incinerate.

- Excessive sound pressure from earphones and headphones can cause hearing loss.

MENU: Indicates that the menu can be set by pressing [MENU/SET] button.

Direct Sales at Panasonic UK

- Order accessory and consumable items for your product with ease and confidence by phoning our Customer Communications Centre Monday – Friday 9:00 am – 5:00 pm (Excluding public holidays).
- Or go on line through our Internet Accessory ordering application at www.pas-europe.com.
- Most major credit and debit cards accepted.
- All enquiries transactions and distribution facilities are provided directly by Panasonic UK.
- It couldn't be simpler!
- Also available through our Internet is direct shopping for a wide range of finished products. Take a browse on our website for further details.

Diagram illustrating the back of the camera with numbered callouts (32) through (50) identifying various controls and features:

- (32) Touch screen/monitor
- (33) [LVF] button/[Fn3] button
- (34) Viewfinder
- (35) Eye sensor
- (36) Eye cup
- (37) [] (Playback) button
- (38) Speaker
- (39) [AF/AE LOCK] button
- (40) Focus mode lever
- (41) Control dial
- (42) Cursor buttons/
▲: Fn button (Fn9)
▼: Fn button (Fn11)/
Send to smartphone button
◀: [] (AF Mode) button
▶: Fn button (Fn10)
- (43) [MENU/SET] button
- (44) Card door
- (45) [Q.MENU] button/[Fn2] button/
[] (Delete) button/
[] (Cancel) button
- (46) [DISP.] button
- (47) Battery door
- (48) Release lever
- (49) Cover for the battery grip connector
- (50) Tripod mount

- Using the camera body and the optional AC Adaptor (DMW-AC11).

- The battery that can be used with the camera is DMW-BLC12E. (As of January 2025)
- **Always use genuine Panasonic batteries (DMW-BLC12E).**
- **If you use other batteries, we cannot guarantee the quality of this product.**
- **It is recommended to use the Panasonic AC Adaptor (DMW-AC11: optional) for charging.**
- You can also charge with a Battery Charger (DMW-BTC12: optional).
- You can charge with the camera body using a commercially available AC adaptor and a USB connection cable.
 - *Recommended specifications for the commercially available AC adaptor
 - Supports 5 V/3 A (15 W) DC output
 - USB Type-C terminal
 - *Use a USB connection cable with 15 W output or better for charging.
- You can also use an AC adaptor with 5 V/500 mA or better for charging. However, charging time may be longer than with the recommended AC adaptor.
- Operation is not guaranteed with all commercially available devices.
- Using charging methods other than those specified may result in fluid leakage, overheating, combustion, rupturing, etc., and these may cause injury.
- This battery may present a risk of fire or chemical burn if misreated.
- Place the removed battery in a plastic bag, and store or keep away from metallic objects (clips, etc.).
- When disposing of the batteries, please contact your local authorities or dealer and ask for the correct method of disposal.

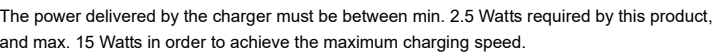

Inserting Cards (Optional)

You can use SD memory cards with this camera.

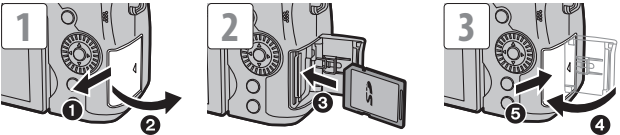

- Push it securely all the way until you hear a click while being careful about the direction in which you insert it.
- To remove:
 - Insert until a clicking sound is heard and then pull it straight out.
 - Turn the camera off and wait for the “LUMIX” display on the monitor to clear before removing the card.
- Format the cards with the camera before use.
[MENU] ➡ **[]** [Setup] ➡ [Format]

Attaching a Lens

This unit can use the dedicated lenses compatible with the Micro Four Thirds™ System lens mount specification (Micro Four Thirds mount).

- Refer to catalogs/websites for information regarding supported lenses.
<https://panasonic.jp/support/global/cs/dsc/connect/index.html> (English only)

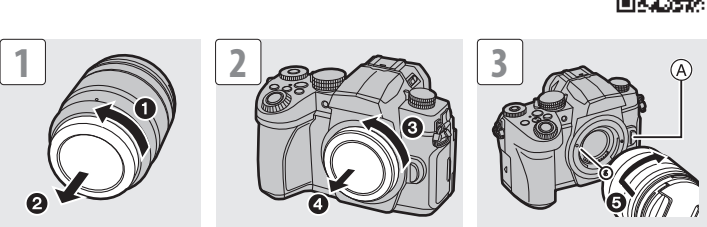

- Do not press the lens release button (A) when you attach a lens.
- When removing the lens, rotate while pressing the lens release button.

Setting the Clock (When Turning On for the First Time)

When you turn the camera on for the first time, a screen to set the clock and home area appears. Follow the message to make the settings.

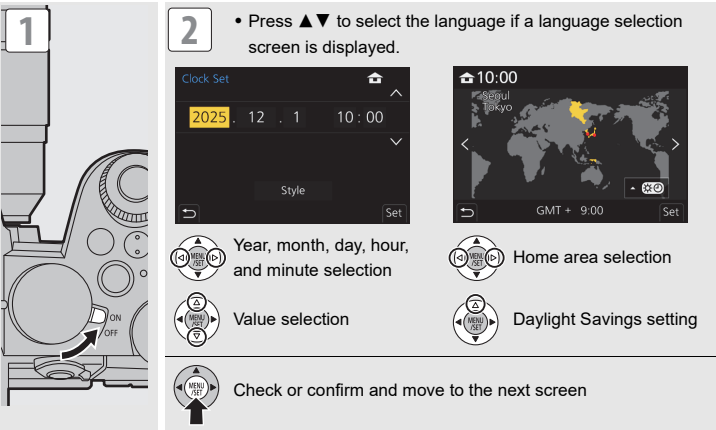

Taking Pictures

- 1 Rotate the mode dial to select the recording mode ([iA]/[P]/[A]/[S]/[M]).
- 2 Press the shutter button halfway (press it gently) to focus.
- 3 Press the shutter button fully (press it further) to take pictures.

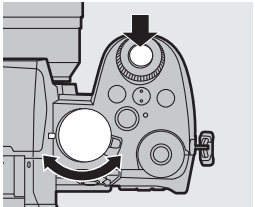

Recording Motion Pictures

- 1 Rotate the mode dial to select the recording mode.
- 2 Press the motion picture button to start recording.
- 3 Press the motion picture button again to end recording.

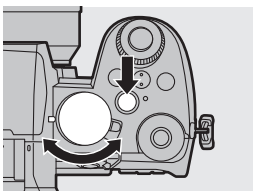

Playing Back Images

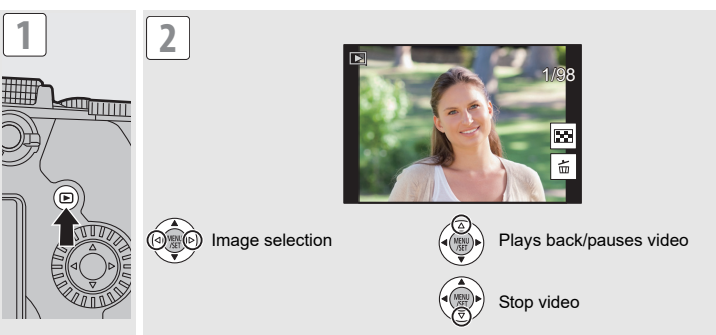

Cautions for Use

- ❖ **Firmware of Your Camera/Lens**
Firmware updates may be provided in order to improve camera capabilities or to add functionality.
 - For the latest information on the firmware or to download/update the firmware, visit the following support site:
<https://panasonic.jp/support/global/cs/dsc/download/index.html> (English only)

- ❖ **Splash Resistant**
Splash Resistant is a term used to describe an extra level of protection this camera offers against exposure to a minimal amount of moisture, water or dust. **Splash Resistant does not guarantee that damage will not occur if this camera is subjected to direct contact with water.**
In order to minimize the possibility of damage please be sure the following precautions are taken:
 - Splash Resistant works in conjunction with the lenses that were specifically designed to support this feature.
 - Securely close the doors, socket caps, contact points cover, flash, etc.
 - When the lens or cap is removed or a door is open, do not allow sand, dust, and moisture to enter inside.
 - If liquid gets on the camera, wipe it off with a dry soft cloth.

- ❖ **Be Sure to Perform Trial Recording in Advance**
Be sure to perform trial recording in advance to check that recording can be performed normally.
Please note that compensation cannot be provided in the event that recording could not be performed due to a problem with the camera or a card.

- ❖ **Be Careful with Regard to Copyrights**
Under copyright law, you may not use the images and audio you have recorded without the permission of the copyright holder.

- ❖ **Caution with Strong Light Beams Such as Laser Light**
Do not allow strong light beams, such as laser light, to be directly exposed to this camera (lens). These can destroy the image sensor and cause the camera to malfunction.

- ❖ **The camera**
Keep this unit as far away as possible from electromagnetic equipment (such as microwave ovens, TVs, video games etc.).
 - If you use this unit on top of or near a TV, the pictures and/or sound on this unit may be disrupted by electromagnetic wave radiation.
 - Do not use this unit near cell phones because doing so may result in noise adversely affecting the pictures and/or sound.
 - Recorded data may be damaged, or pictures may be distorted, by strong magnetic fields created by speakers or large motors.
 - Electromagnetic wave radiation may adversely affect this unit, disturbing the pictures and/or sound.
 - If this unit is adversely affected by electromagnetic equipment and stops functioning properly, turn this unit off and remove the battery or disconnect AC adaptor. Then reinsert the battery or reconnect AC adaptor and turn this unit on.

- Do not use this unit near radio transmitters or high-voltage lines.
 - If you record near radio transmitters or high-voltage lines, the recorded pictures and/or sound may be adversely affected.
- ❖ **Wi-Fi® Function**
Use of the Wi-Fi function of the camera is presumed to be in countries where it is sold.
There is the risk that the camera violates the radio wave regulations if used in countries other than those where it is sold, and Panasonic takes no responsibility for any violations.

- When [Sleep Mode] or [Sleep Mode(Wi-Fi)] in [Power Save Mode] is set to [OFF], the power consumption of this camera may rise.
- For more information about the energy efficiency of the product, please visit our website, www.panasonic.com, and enter the model number in the search box.
- Please be advised that Panasonic is not liable for any damage directly or indirectly caused by use (including use in combination with the products of other companies) or malfunction of this product.
- Please be advised that Panasonic is not liable for any damage to data caused by this product.
- The external design and specifications of this product, as described in this document, may differ from the actual product.
- Illustrations used in this document may differ from the actual product and the actual images displayed on the product.
- Images used in this document are sample pictures used to explain the functions and effects.

Main Specifications

The specifications are subject to change for performance enhancement.
Digital camera body (DC-G97):
Information for your safety

Power source:	7.2 V ===
Power consumption:	3.2 W (when recording with the monitor), 2.6 W (when playing back with the monitor) [When using the interchangeable lens (H-FS12060)] 3.3 W (when recording with the monitor), 2.6 W (when playing back with the monitor) [When using the interchangeable lens (H-FSA14140)]

Type	
Type	Digital Single Lens Mirrorless camera
Lens mount	Micro Four Thirds mount
Recording media	SD memory card / SDHC memory card / SDXC memory card
Image sensor	
Image sensor	4/3" CMOS sensor, total pixel number approx. 21,800,000 pixels, Primary color filter
Effective number of pixels of the camera	Approx. 20,300,000 pixels
Viewfinder	
Type	Aspect ratio 4:3, 0.39 inches, approx. 2,360,000 dots, OLED Live Viewfinder
Monitor	
Type	Aspect ratio 3:2, 3.0 inches, approx. 1,840,000 dots monitor, capacitive touch screen
Interface	
USB / CHARGE	USB Type-C®, USB 2.0 (High Speed)
HDMI	micro HDMI Type D
[REMOTE]	Ø2.5 mm jack
[MIC]	Ø3.5 mm stereo mini jack
Headphones	Ø3.5 mm stereo mini jack

External dimensions / Mass (Weight)	
External dimensions	Approx. 130.4 mm (W)×93.5 mm (H)×77.4 mm (D) (5.14" (W)×3.69" (H)×3.05" (D)) (excluding the projecting parts)
Mass (Weight)	Approx. 530 g/1.17 lb (camera body, with battery and card) Approx. 478 g/1.06 lb (only camera body)
Operating environment	
Recommended operating temperature	0 °C to 40 °C (32 °F to 104 °F)
Permissible relative humidity	10 %RH to 80 %RH
Wi-Fi	
Compliance standard	IEEE 802.11b/g/n (standard wireless LAN protocol)
Frequency range used (central frequency)	2412 MHz to 2462 MHz (1 to 11ch)
Encryption method	Wi-Fi compliant WPA™ / WPA2™
Access method	Infrastructure mode
Bluetooth®	
Compliance standard	Bluetooth v5.0, Bluetooth Low Energy (BLE)
Frequency range used (central frequency)	2402 MHz to 2480 MHz

Battery pack (lithium-ion) (Panasonic DMW-BLC12E):
Information for your safety

Voltage/capacity:	7.2 V / 1200 mAh
===	DC

Trademarks and Licenses

- Micro Four Thirds™ and Micro Four Thirds Logo marks are trademarks or registered trademarks of OM Digital Solutions Corporation, in Japan, the United States, the European Union and other countries.
- SDXC Logo is a trademark of SD-3C, LLC.
- The terms HDMI, HDMI High-Definition Multimedia Interface, HDMI Trade dress and the HDMI Logos are trademarks or registered trademarks of HDMI Licensing Administrator, Inc.
- USB Type-C® and USB-C® are registered trademarks of USB Implementers Forum.
- Adobe is a trademark or registered trademark of Adobe Systems Incorporated in the United States and/or other countries.
- The Bluetooth® word mark and logos are registered trademarks owned by Bluetooth SIG, Inc. and any use of such marks by Panasonic Holdings Corporation is under license. Other trademarks and trade names are those of their respective owners.
- "Wi-Fi®" is a registered trademark of Wi-Fi Alliance®.
- "WPA™" and "WPA2™" are trademarks of Wi-Fi Alliance®.
- QR Code is a registered trademark of DENSO WAVE INCORPORATED.
- Other names, company names, product names mentioned in this document are trademarks or registered trademarks of the companies concerned.

At least three (3) years from delivery of this product, Panasonic will give to any third party who contacts us at the contact information provided below, for a charge no more than our cost of physically performing source code distribution, a complete machine-readable copy of the corresponding source code covered under GPL V2.0 or LGPL V2.1, as well as the respective copyright notice thereof.
Contact Information: oss-cd-request@gg.jp.panasonic.com
The source code and the copyright notice are also available for free in our website below.
<https://docs.connect.panasonic.com/oss/>

This product is licensed under the AVC Patent Portfolio License for the personal use of a consumer or other uses in which it does not receive remuneration to (i) encode video in compliance with the AVC Standard ("AVC Video") and/or (ii) decode AVC Video that was encoded by a consumer engaged in a personal activity and/or was obtained from a video provider licensed to provide AVC Video. No license is granted or shall be implied for any other use. Additional information may be obtained from MPEG LA, L.L.C.
See <http://www.mpegla.com>

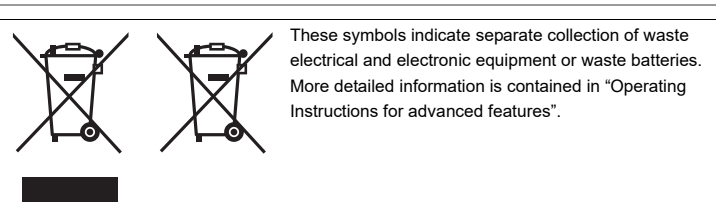

2023 No. CONSUMER PROTECTION
The Product Security and Telecommunications Infrastructure (Security Requirements for Relevant Connectable Products) Regulations 2023
Statement of compliance

We hereby deliver our Statement of Compliance for product (type, batch);
Digital Camera
Refer to the website below for compliant models and their support periods.
https://panasonic.jp/support/global/cs/info/im_sec_info.html
Name / address of each manufacturer of the product and authorised representative;

Manufacturer name:	Panasonic Entertainment & Communication Co., Ltd.
Address:	1-10-12 Yagumo-higashi-machi, Moriguchi City, Osaka 570-0021, Japan
Representative:	TOSHIYUKI TSUMURA

- Declaration of compliance that, in the opinion of the manufacturer, we have complied with the deemed compliance conditions in Schedule 2;**
1. **No universal default passwords: Complies with ETSI EN 303 645 provisions 5.1-1, 5.1-2**
 2. **Product Security vulnerability report: Complies with ETSI EN 303 645 provisions 5.2-1**
Panasonic Product Security Incident Response Team link:
<https://holdings.panasonic/global/corporate/product-security.html>
 3. **Security update periods: Complies with 5.3-13 of ETSI EN 303 645**
Panasonic product security update link:
https://panasonic.jp/support/global/cs/info/im_sec_info.html

Statement of Compliance signatory;
Company name: Panasonic Entertainment & Communication Co., Ltd.

Signature by:	Toshiyuki Tsumura
Name:	TOSHIYUKI TSUMURA
Title:	Director, Imaging Solution Business Division
Place:	1-10-12 Yagumo-higashi-machi, Moriguchi City, Osaka, Japan
Date:	29/5/2024