

Panasonic®

Operating Instructions
(Household use) Rechargeable Shaver

Model No. ES-RM3FX

Contents

Safety precautions.....	2
Important information	7
Parts identification	9
Charging.....	10
How to use	12
Operation and display of the switch lock.....	14
Cleaning	15
Replacing the system outer foil and the inner blades.....	17
Troubleshooting	19
Battery life	21
Removing and disposing of the built-in rechargeable battery	22
Specifications	23

Thank you for purchasing this Panasonic product.

Before operating this unit, please read these instructions completely and save them for future use.



The USB power adaptor is sold separately.

Safety precautions

To reduce the risk of electric shock, injury, fire, loss of life, and damage to property, always observe the following safety precautions.

Explanation of symbols

The following symbols are used to classify and describe the level of hazard, injury, and property damage caused when the notation is disregarded and improper use is performed.

 DANGER	Indicates potential hazard that will result in serious injury or death.
 WARNING	Indicates potential hazard that could result in serious injury or death.
 CAUTION	Indicates potential hazard that could result in minor injury or property damage.

The illustrations in the manual may differ from the actual item.

WARNING

► This product

- **This product has a built-in rechargeable battery.**
Do not throw into flame or heat. Do not charge, use, or leave in high temperature environments.
 - Doing so may cause overheating, ignition, or explosion.
- **Do not modify or repair.**
 - Doing so may cause fire, electric shock, or injury. Contact an authorized service center for repair (battery change etc.).
- **Never disassemble except when disposing of the product.**
 - Doing so may cause fire, electric shock, or injury.

WARNING

- **Unplug the USB cable from the main body when cleaning.**
 - Failure to do so may cause electric shock or injury.
- ▶ **In case of an abnormality or malfunction**
- **Immediately stop using this product and disconnect USB power adaptor if there is an abnormality or malfunction.**
 - Failure to do so may cause fire, electric shock, or injury.
- **<Abnormality or malfunction cases>**
- **The main body, USB power adaptor or USB cable is deformed or abnormally hot.**
- **The main body, USB power adaptor or USB cable smells of burning.**
- **There is abnormal sound during use or charging of the main body.**
 - Immediately request inspection or repair at an authorized service center.
- ▶ **Power supply**
- **Do not use this product beyond the rated values of the power supply.**
 - Doing so may cause fire.
- **Fully insert the power plug of the USB power adaptor.**
 - Failure to do so may cause fire or electric shock.
- ▶ **About the USB power adaptor and USB cable**
- **Do not connect or disconnect the USB power adaptor or USB cable to or from the power supply with a wet hand.**
 - Doing so may cause electric shock or injury.

WARNING

- **Do not charge this product when the USB power adaptor or USB cable is damaged or when the fitting into the household outlet is loose.**
- **Do not immerse the USB power adaptor or USB cable in water or wash it with water.**
- **Do not damage, modify, forcefully bend, pull, twist, or place anything heavy on the USB power adaptor or USB cable.**
 - Doing so may cause electric shock or fire due to a short circuit.
- **Do not charge this product using any USB cable other than the supplied USB cable. Also, do not use any other product with the supplied USB cable.**
 - Failure to do so may cause burns, electric shock or fire.
 - The USB cable provides the overheat protection function. If charging is abnormal or the USB plug (Type-C) heats up, disconnect the power supply, check the socket [A⑨], and remove any water or foreign objects from the socket.
- **Always plug the USB cable to a USB power supply approved for general use with a rated voltage of 5.0 V and a rated output current of 1.0 A which meets requirements of the Safety Extra Low Voltage (SELV) system.**
 - Doing so may cause burn or fire due to a short circuit. It is necessary to separately purchase a power adaptor if required to power this product. The Panasonic power adaptor ES-RU1-02 is recommended.
- **Clean regularly to prevent dust from accumulating.**
 - Failure to do so may cause fire due to insulation failure caused by humidity.
 - Disconnect the USB power adaptor and wipe with a dry cloth.

WARNING

► Preventing accidents

- **This product is not intended for use by persons (including children) with reduced physical, sensory or mental capabilities, or lack of experience and knowledge, unless they have been given supervision or instruction concerning use of the product by a person responsible for their safety. Children should be supervised to ensure that they do not play with the product.**
 - Failure to do so may cause an accident or injury.
- **Do not place within reach of children or infants. Do not let them use it.**
 - Doing so may cause an accident or injury due to accidental ingestion of the inner blade, cleaning brush, etc.

CAUTION

► To protect the skin

- **Check the system outer foil for any damage or deformation before use.**
 - Failure to do so may cause injury to skin.
- **Do not forcefully press the system outer foil on the skin or lips. When there are small bumps on the face or the skin is injured, avoid direct contact with the system outer foil.**
- **Do not touch the blade section (metallic section) of the inner blade directly with your hands.**
 - Doing so may cause injury to skin or hand.
- **Do not forcefully press the system outer foil. Do not touch the system outer foil with fingers or nails when in use.**
- **Do not use this product for any purpose other than shaving. (For example, hair shaving)**
 - Failure to do so may cause injury to skin or reduce the life of the system outer foil.

CAUTION

► Note the following precautions

- **Do not allow needles or any other foreign objects to adhere to the power plug of the USB power adaptor or the plugs of the USB cable.**
 - Doing so may cause electric shock or fire due to a short circuit.
- **Do not charge when the socket is wet.**
 - Failure to do so may cause fire or electric shock.
- **Do not share with your family or others.**
 - Doing so may result in infection or inflammation.
- **Disconnect the USB power adaptor from the household outlet when not charging.**
 - Failure to do so may cause electric shock or fire due to electrical leakage resulting from insulation deterioration.

Handling of the removed battery when disposing

DANGER

- **The rechargeable battery is exclusively for use with this product. Do not use the battery with other products.**
- **Do not charge the battery after it has been removed from this product.**
- **Do not throw into fire or apply heat.**
- **Do not hit, disassemble, modify, or puncture with a nail.**
- **Do not let the positive and negative terminals of the battery get in contact with each other through metallic objects.**
- **Do not carry or store the battery together with metallic jewellery such as necklaces and hairpins.**
- **Do not use or leave the battery where it will be exposed to high temperature environments, such as under direct sunlight or near other sources of heat.**
- **Never peel off the tube.**
 - Doing so may cause overheating, ignition, or explosion.

WARNING

- **After removing the rechargeable battery, do not keep it within reach of children and infants.**
 - The battery will harm the body if accidentally swallowed. If this happens, consult a physician immediately.
- **If the battery fluid leaks out and comes in contact with the eyes, do not rub the eyes, and thoroughly rinse with clean water, such as tap water.**
 - Failure to do so may cause eye injury. Consult a physician immediately.

CAUTION

- **If the battery fluid leaks out and comes in contact with the skin or clothes, rinse off with clean water, such as tap water.**
 - Failure to do so may cause inflammation.

Important information

- This WET/DRY shaver can be used for wet shaving using shaving lather or for dry shaving. You can use this watertight shaver in the shower and clean with water. The following symbol means suitable for use in a bath or shower.



This symbol on the product means that not generated higher voltage than the safety extra low voltage (SELV).
In which protection against electric shock relies on power supply.



► **To avoid product malfunction, deformation and aging, observe the following precautions:**

- Do not drop this product or subject it to shock.
- Do not hit the system outer foil on any hard objects.
- After use, store this product in a dry place.
- Do not store this product in a place with direct sunlight inside the carriage.
- Do not heat or dry this product with a hair dryer.
- When carrying or storing this product, always attach the protective cap.

► **Notes**

- Charge this product correctly according to these Operating Instructions. (See page 10 “Charging”.)
- This product contains a battery that is only replaceable by skilled persons. Please contact an authorized service center for repair details.

Parts identification

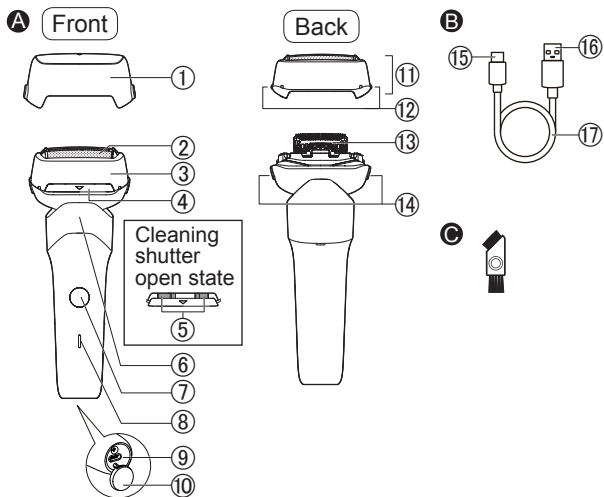

A Main body

- ① Protective cap
- ② System outer foil
- ③ Foil frame
- ④ Cleaning shutter
- ⑤ Water inlet
- ⑥ Finger rest
- ⑦ Power switch
- ⑧ Indicator light
- ⑨ Socket (Type-C)
- ⑩ Socket cover
- ⑪ Outer foil section

- ⑫ System outer foil release buttons
- ⑬ Inner blades
- ⑭ Foil frame release button

B USB cable

- ⑮ USB plug (Type-C)
- ⑯ USB plug (Type-A)
- ⑰ Cord

Accessory

C Cleaning brush

Charging

- Before charging, make sure that this product is powered off.
- Attach the protective cap to avoid damaging the system outer foil.
- Do not charge when the socket is wet. Wipe the socket when it is wet before charging.

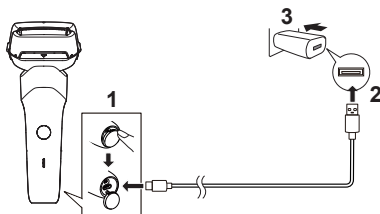

- 1. Open the socket cover, insert the USB cable into the main body and the USB power adaptor.**
- 2. Connect the USB power adaptor to a household outlet.**
 - Check that the indicator light (red) is on.
- 3. After charging, remove the USB cable and attach the socket cover.**
 - Charging is completed after approx. 1 hour. The charging time may be shortened, depending on the remaining battery level.

• Be sure to close the socket cover when using or washing.

► Display of the indicator light during charging

Charging in progress	Indicator light stays red
Charging complete	Indicator light turns off
Charging abnormal	Indicator light keeps blinking red quickly, twice a second.

► How to confirm that charging is completed

- If the USB plug (Type-C) is removed and then inserted back right after charging is completed, the indicator light will light up red and then turn off after about 5 seconds.

► When the battery level is low

- When in use, the indicator light (red) blinks once a second.

After the indicator light starts blinking, you can continue to use the shaver 2 or 3 times. (The number of uses may vary with the duration of use and the ambient temperature.)



- After the power is turned off, the indicator light (red) will blink and then turn off after about 5 seconds.

► Notes

- You cannot operate this product while charging.
- This product can be charged with adaptors other than the specified one. However, for safety, it is recommended to use the Panasonic-specified adaptor with a splash-resistant design. Please note the adaptor is not fully waterproof, so avoid exposing it to water.
- This product uses a Li-ion battery. Therefore, the service life of the battery will not be affected even if it is charged after each use.
- When this product is used for the first time or when it has not been used for more than 6 months, the charging time may differ and the indicator light may not light on immediately. However, it will light on as the charging proceeds.
- If this product has not been used for a long time, the battery performance may be degraded. Therefore, if this product has not been used for more than half a year, please fully charge the battery once every half a year.
- If an incompatible USB power adaptor is used for charging, or problems such as poor contact with the USB cable occur, charging time may be longer and the product may be damaged.

- The appliance can be used for approximately 2 weeks after it is fully charged.

(Based on one 3-minute dry-shave usages per day in an ambient temperature range of 20 °C – 30 °C.)

The usable days depend on the usage conditions: beard thickness, pressure applied to the skin, and use of wet shaving.

- If there is noise from the radio or other sources while this product is used or charged, move this product to a different location or charge it with another household outlet.
- Keep the socket cover closed when the product is not charged, especially while you are using the product or washing it with water.

How to use

Shaving

1. Press the power switch to start the shaver, and start shaving.

- The indicator light (white) is always on.
- If the indicator light (white) turns off after blinking for 5 seconds, the shaver cannot be started because the power switch is locked. Please press and hold the power switch for longer than 2 seconds to unlock it. (See page 14.)
- While using the shaver, grip the shaver with your fingers placed on the finger rest position.



2. Turn off the shaver when you have finished shaving.

► How to improve the shaving effect

- Apply the whole system outer foil perpendicularly against the skin and shave by slowly sliding the shaver over the face against the grain of the beard.

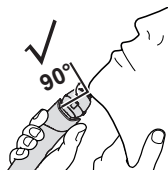

- To prevent damaging the system outer foil, do not shave with only a part of the system outer foil.



- The beard under the chin and around the throat can be shaved better by stretching the skin so the beard will stand.



► Notes

- Before shaving, check that the cleaning shutter is closed.
- It is recommended to clean the shaver after each use.

Operation and display of the switch lock

Locking the power switch

Press and hold the power switch for longer than 2 seconds.

- The lock mode can only be activated when the power is off.
Release the power switch after about 2 seconds from when the indicator light (white) lights up.



The power switch is locked

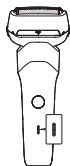

► **Checking if the power switch is locked.**

Press and then release the power switch in the locked state. The indicator light (white) will blink and turn off after 5 seconds.



Unlocking the power switch

Press and hold the power switch for longer than 2 seconds in the locked state.

- Release the power switch once the indicator light (white) turns off after blinking for about 2 seconds.



The power switch is unlocked

- (The shaver starts operating.)

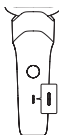

► **Notes**

- The power switch cannot be unlocked while the shaver is being charged.

Cleaning

- It is recommended to clean the shaver after each use.
- Check that the socket cover is closed.

- 1. Apply a small amount of hand soap and water on the system outer foil.**
 - Ensure the cleaning shutter is closed.

- 2. Turn the shaver on.**

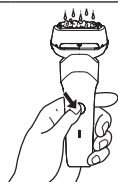

To remove light dirt

- 3. Slide the cleaning shutter down until it clicks into place.**



- 4. Rinse the shaver head by running water through the water inlets located within the cleaning shutter, as illustrated in the image below.**



- 5. After rinsing the shaver, turn it off and shake it several times to remove excess water.**
- 6. Dry the shaver with a clean, dry cloth, then slide the cleaning shutter upward to close.**

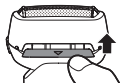

For heavy dirt

- 3. Run the shaver for 10 to 20 seconds, then turn it off.**



- 4. Remove the outer foil section and turn the shaver on.**

- 5. Clean the shaver and the outer foil section with running water.**

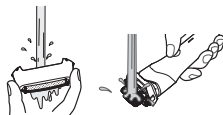

- 6. After rinsing the shaver, turn it off and shake it several times to remove excess water. Finish by drying the shaver with a clean, dry cloth.**

7. Store the shaver after drying it.

- ❶ Remove the outer foil section, thoroughly dry the outer foil section, main body and the socket.
 - Leave them to dry in a shaded area, out of direct sunlight.
- ❷ After the shaver has dried completely, install the outer foil section onto the main body.

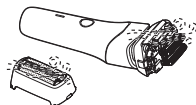

► Notes

- Be careful not to hit the shaver on the sink or any other objects while draining the water. Failure to do so may cause malfunction.
- Do not use cleaning agents other than hand soap. Doing so may cause malfunction.
- Do not clean the shaver with thinner, gasoline, alcohol, or other chemicals. Doing so may cause cracking or discoloration. The enclosure can be cleaned with a soft cloth moistened with tap water or soap solution.
- Do not use salt solution or hot water to wash the shaver. Do not soak the shaver in water for a long time. The shaver can be washed with running water.

Cleaning with the cleaning brush

- Clean the system outer foil and the main body using the long brush.

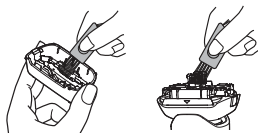

- **Clean the inner blades using the short brush by moving it in the direction shown in the right figure (A).**

- Do not move the short brush in the (B) direction. Doing so may damage the inner blades and thus affect their sharpness.

- Do not use the short brush to clean the system outer foil.

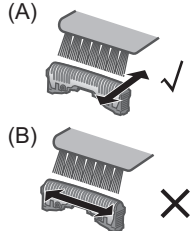

Replacing the system outer foil and the inner blades

- It is recommended to replace the system outer foil once a year and the inner blades once every two years.

► Replacement parts

Replacement parts are available at your dealer or Service Center.

Replacement parts for ES-RM3FX	System outer foil	WES9087
	Inner blades	WES9068

► Outer foil section

How to remove

Press the foil frame release button, and lift to remove the outer foil section.

How to install

Turn the side with water inlets to the front, and securely attach the outer foil section onto the shaver until it is in place.

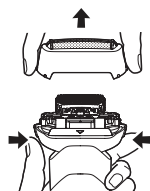

► System outer foil

How to remove

Press the system outer foil release buttons, and pull down the system outer foil.

How to install

Align with the system outer foil mark (▲), and securely attach them together until a “click” sound is heard.

- The system outer foil cannot be installed backwards.
- To install it back to the shaver, make sure that the system outer foil is inserted into the foil frame.

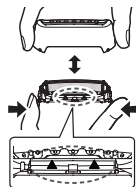

► Inner blades

How to remove

Remove one inner blade at a time.

- Do not touch the edges (metallic section) of the inner blades or else your hands will be injured.

How to install

Insert one inner blade at a time until they are fixed in position.

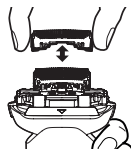

► Note

- Do not press the system outer foil release buttons with excessive force.

Doing so may bend the system outer foil, preventing complete attachment to the foil frame.

Troubleshooting

Problem	Action
The power switch cannot be turned on.	<p>▶ Unlock the power switch. (See page 14.)</p>
The shaver cannot be charged.	<p>▶ The recommended ambient temperature range for charging is 10 - 35 °C. It may take longer to charge or the battery may fail to charge properly in extremely high or low temperatures. Charge the shaver within the recommended ambient temperature range.</p>
	<p>▶ Check that the USB cable is securely connected to the power supply. If the above step do not resolve the issue, disconnect the USB cable and reconnect it.</p>
	<p>▶ If the USB plug (Type-C) heats up, disconnect the power supply, check the socket [A⑨], and remove any water or foreign objects from the socket.</p>

Problem	Action
The operating time is short after the shaver is charged.	<p>▶ Although the shaver can be used for about 2 weeks on a full charge (based on dry shaving for 3 minutes a day), the number of usable days may be reduced depending on how or where the shaver is used (e.g., when used for wet shaving).</p> <p>▶ The battery has reached the end of its life. (approx. 3 years)</p> <p>▶ This can be improved by cleaning the shaver after each use.</p>
The shaver does not operate even after charging.	<p>▶ The recommended ambient temperature for using the shaver is no lower than 5 °C.</p> <p>▶ The battery has reached the end of its life. (approx. 3 years)</p> <p>▶ When the power supply is connected, this shaver does not operate.</p>
A loud sound is heard.	<p>▶ Check that the blades are properly attached.</p> <p>▶ Clean the system outer foil with the cleaning brush.</p>
An odor is noticed from the blades.	<p>▶ This can be improved by cleaning the shaver after each use.</p>

Problem	Action
Shavings disperse.	<ul style="list-style-type: none"> ▶ This issue can be minimized by cleaning the shaver after each use. ▶ Use a brush to clean the inner blades if shavings accumulate on them.
The system outer foil is overheated.	<ul style="list-style-type: none"> ▶ Replace the system outer foil if it is damaged or deformed. (See page 18.)
The shaving performance deteriorates.	<ul style="list-style-type: none"> ▶ This can be improved by cleaning the shaver after each use. ▶ Replace the system outer foil or inner blades once they reach their service life.

If problems still cannot be solved, contact the store where you purchased this product or a service center authorized by Panasonic for repair.

Battery life

Approximately 3 years. If the operating time is significantly shorter even after a full charge, the battery has reached the end of its life. (The battery life may change due to usage and storage conditions.)

Removing and disposing of the built-in rechargeable battery

This product has a built-in rechargeable battery. Be sure to remove the battery before disposing of this product.

- The battery is to be disposed of safely.
- This figure must only be used when disposing of this product and must not be used to repair it.
- If you dismantle this product yourself, it will no longer be waterproof, which may cause it to malfunction.
- We recommend seeking the advice of a dealer or a Panasonic authorized service center before deciding to dispose of this product, so as to extend the service life of this product as much as possible.
- If you decide to dispose of this product but do not want to disassemble this product by yourself to remove the battery, we recommend taking this product to a Panasonic authorized service center who can remove and recycle the battery.

► How to remove the built-in rechargeable battery

- Power off this product before removing the battery. Turn on the power and keep the power on until the battery is completely discharged.
- Follow Steps ① to ③ as illustrated to disassemble this product and remove the battery with a screwdriver.
- During disassembly, take care not to short circuit the positive and negative terminals of the removed battery and insulate the terminals by applying tape to them.

- If you cannot remove the battery, please contact an authorized service center.

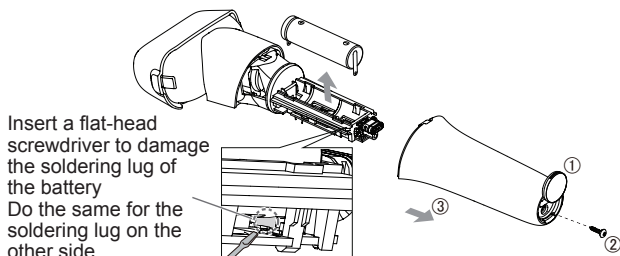

For environmental protection and recycling of materials

This product contains a Li-ion battery.

Please make sure that the battery is disposed of at an officially assigned location, if there is one in your country.

Specifications

Output rating of applicable adaptor (sold separately)	5.0 V \equiv 1.0 A In compliance with the Safety Extra Low Voltage (SELV) system
Charging time	Approx. 1 hour

This product is intended for household use only.

Panasonic Corporation
<https://www.panasonic.com>
© Panasonic Corporation 2025

Printed in China

Ⓔ EN

ES970RM3FX1541 S0325-0