

Panasonic®

Operating Instructions
(Household) Oral Irrigator

Model No. EW1211A

English..... 3



Panasonic®

Operating Instructions
(Household) Oral Irrigator
Model No. EW1211A

Contents

Safety precautions	4	Cleaning	12
Intended use	7	Troubleshooting	13
Parts identification	8	Battery life	14
Charging	8	Removing the built-in rechargeable battery	14
How to use	9	Specifications	15
After use	11	Changing the nozzle (Sold separately) ...	15

Thank you for purchasing this Panasonic product.

Before operating this unit, please read these instructions completely and save them for future use.

Safety precautions

To reduce the risk of injury, loss of life, electric shock, fire, and damage to property, always observe the following safety precautions.

Explanation of symbols

The following symbols are used to classify and describe the level of hazard, injury, and property damage caused when the denotation is disregarded and improper use is performed.



DANGER

Denotes a potential hazard that will result in serious injury or death.



WARNING

Denotes a potential hazard that could result in serious injury or death.



CAUTION

Denotes a hazard that could result in minor injury.

The following symbols are used to classify and describe the type of instructions to be observed.



This symbol is used to alert users to a specific operating procedure that must not be performed.



This symbol is used to alert users to a specific operating procedure that must be followed in order to operate the unit safely.



WARNING

► Preventing accidents

-  **Do not store within the reach of children or infants. Do not let them use it.**
 - Doing so may cause an accident or injury due to accidental ingestion of removable parts.

► Power supply

-  **Do not connect or disconnect the power plug to a household outlet with a wet hand.**
 - Doing so may cause electric shock or injury.

Do not immerse the charger in water or wash it with water.

Do not place the charger over or near water filled sink or bathtub.

Do not use when the cord or the power plug is damaged or when the fitting into the household outlet is loose.



Do not damage, modify, forcefully bend, pull, twist, or bundle the cord.
Also, do not place anything heavy on or pinch the cord.

- Doing so may cause electric shock or fire due to a short circuit.



Do not use anything other than the supplied charger. Also, do not charge any other product with the supplied charger.

- Doing so may cause burn or fire due to a short circuit.



WARNING



Do not use in a way exceeding the rating of the household outlet or the wiring.

- Exceeding the rating by connecting too many power plugs to one household outlet may cause fire due to overheating.



Always ensure the appliance is operated on an electric power source matched to the rated voltage indicated on the charger.

Fully insert the power plug.

- Failure to do so may cause fire or electric shock.

► In case of an abnormality or malfunction

Immediately stop using and remove the power plug if there is an abnormality or malfunction.

- Failure to do so may cause fire, electric shock, or injury.

<Abnormality or malfunction cases>



• **The main unit or charger is deformed or abnormally hot.**

• **The main unit or charger smells of burning.**

• **There is abnormal sound during use or charging of the main unit or charger.**

- Immediately request inspection or repair at an authorized service center.

► This product



This product has a built-in rechargeable battery. Do not throw into flame or heat.

- Doing so may cause fluid leak, overheating, or explosion.



Do not modify or repair.

- Doing so may cause fire, electric shock, or injury.

Contact an authorized service center for repair (battery change, etc.).



Never disassemble except when disposing of the product.

- Doing so may cause fire, electric shock, or injury.

► Cleaning



Always unplug the power plug from a household outlet when cleaning the charger.

- Failure to do so may cause electric shock or injury.

Regularly clean the power plug to prevent dust from accumulating (once every half a year).



- Failure to do so may cause fire due to insulation failure caused by humidity.

Disconnect the power plug and wipe with a dry cloth.

This appliance is not intended for use by persons (including children) with reduced physical, sensory or mental capabilities, or lack of experience and knowledge, unless they have been given supervision or instruction concerning use of the appliance by a person responsible for their safety. Children should be supervised to ensure that they do not play with the appliance.

- Failure to do so may cause an accident or injury.



The supply cord cannot be replaced. If the cord is damaged, the charger should be scrapped.

- Failure to do so may cause an accident or injury.



CAUTION

► Preventing damage to teeth and gums

People who are unable to operate should not use this appliance.



People with weak oral senses should not use this appliance.

- Doing so may cause injury or damage to teeth and gums.

People who may have periodontal disease, have teeth being treated, or concerned about symptoms within their mouth should consult a dentist before use.



- Failure to do so may cause injury or damage to teeth and gums.

► This product

Never use for a purpose other than oral cleaning.



- Doing so may cause an accident or injury when the stream of water is pointed toward the eyes, nose, ears, or throat.

Do not fill the tank with water warmer than 40 °C.



- Doing so may cause burns.

Do not share nozzle with your family or other people.



- Doing so may cause infection or inflammation.

Do not place a metallic object such as a coin or a clip on top of the charger.



- Doing so may cause burns due to excessive heat.

► Note the following precautions

Do not allow pins or trash to adhere to the power plug.



- Doing so may cause electric shock or fire due to a short circuit.



Do not drop or subject to shock.

- Doing so may cause injury.



Do not wrap the cord around the charger when storing.

- Doing so may cause the wire in the cord to break with the load, and may cause fire due to a short circuit.



Disconnect the power plug from the household outlet when not using for extended period of time.

- Failure to do so may cause electric shock or fire due to electrical leakage resulting from insulation deterioration.



Disconnect the power plug by holding onto it instead of the cord.

- Failure to do so may cause electric shock or fire due to a short circuit.

Keep the appliance sanitized and use fresh tap water or warm water when cleaning the mouth.

Make sure to throw out the water inside the tank, and run the appliance for 2 to 3 seconds to drain the water after usage.



- Failure to do so may cause damage to your health if used without keeping it sanitized due to propagation of mold and bacteria.

► Disposal of the rechargeable battery

DANGER

The rechargeable battery is exclusively for use with this appliance. Do not use the battery with other products.

Do not charge the battery after it has been removed from the product.

- Do not throw into fire or apply heat.
-  • Do not solder, disassemble or modify the battery.
- Do not let the positive and negative terminals of the battery get in contact with each other through metallic objects.
- Do not carry or store the battery together with metallic jewelry such as necklaces and hairpins.
- Never peel off the tube.
- Doing so may cause fluid leak, overheating, or explosion.

WARNING

After removing the rechargeable battery, do not keep it within the reach of children and infants.

-  - The battery will harm the body if accidentally swallowed. If this happens, consult a physician immediately.

If the battery fluid leaks out, take the following procedures. Do not touch the battery with your bare hands.

- The battery fluid may cause blindness if it comes in contact with your eyes.
 Do not rub your eyes. Wash immediately with clean water and consult a physician.
- The battery fluid may cause inflammation or injury if it comes in contact with the skin or clothes.
Wash it off thoroughly with clean water and consult a physician.

Intended use

- Do not put salt, mouthwash or other chemicals into the water tank. Doing so may cause malfunction.
- Do not dry the main unit with a dryer or a fan heater. Doing so may cause malfunction or deformation of the parts.
- Do not wipe with thinners, benzine, alcohol etc. Doing so may cause malfunction, cracking or discoloration of the parts.
- Store the appliance in a place with low humidity after use.
- Leaving the appliance in a bathroom may cause malfunction.

Parts identification

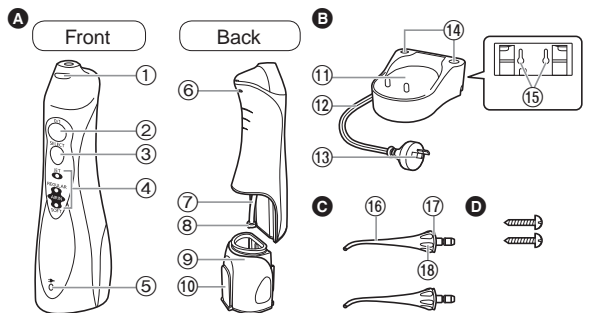

A Main unit

- ① Nozzle release button
- ② Power switch [0/1]
- ③ Mode switch
- ④ Mode indicator
- ⑤ Charging indicator
- ⑥ Ventilation hole
- ⑦ Suction hose
- ⑧ Filter
- ⑨ Water tank
- ⑩ Water tank cap

B Charger (RE8-53)

- ⑪ Charging section

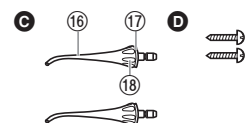
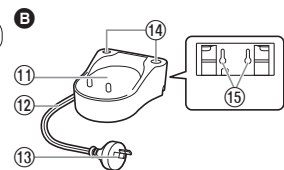

- ⑫ Cord
- ⑬ Power plug
- ⑭ Nozzle stands
- ⑮ Screw holes for wall mounting

The charger can be mounted on a wall using two wood screws.

C Nozzle (x2)

- ⑯ Nozzle
- ⑰ Identification ring
- ⑱ Nozzle handle

Accessories

D 2 screws

Note

There may be moisture inside the main unit (water tank and suction hose). This is moisture left from the distilled water used for product testing and is hygienically safe.

Charging

► On the bathroom countertop or a shelf

1. Place the cord in the right, left or center cord guide, depending on where the charger will be placed.
2. Place the charger on a secure, level surface.
3. Plug in the power plug.

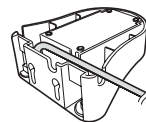

1 Insert main unit so it stands upright in the charging section.

The charging indicator will light up.

- Be sure to place the main unit upright. If the main unit is tilted or not in direct contact with the charger, the main unit may not charge properly.
- Charging is completed in about 15 hours.
- The lamp does not go off even when charging ends.
- The main unit will provide an operation time of approximately 15 minutes of use when the battery is fully charged. (The operating duration will become shorter as the batteries get older.)



2 Disconnect the power plug after charging is completed.

- The battery performance will not be affected even if it is charged for more than 15 hours.

Notes

- When using the appliance for the first time or if it has not been used for more than half a year, the charging indicator may not light up for several minutes after charging starts or the operating time may become shorter. In such cases, charge the battery for 23 hours or more.
- Recommended ambient temperature for charging is 5 – 35 °C. Battery performance may decrease under extremely low or high temperatures, and the battery may not be charged properly.

How to use

- 1 Attach the nozzle firmly onto the main unit.**



- 2 Open the water tank cap, hold the main unit so it is level, and fill the tank with water.**

- Always use new tap water or lukewarm water.
- If the water feels cold, use lukewarm water with a temperature of 40 °C or less.



- 3 Close the water tank cap, making sure it locks in place.**



- 4 Press the mode switch and select the desired water jet mode.**

- The mode indicator will glow the previously selected mode. If the appliance is not used for more than 30 days, or after the appliance has been fully charged from its fully discharged state, the mode is initialized to AIR IN (SOFT). (When the battery is drained, the mode will be reset but this is not a fault.)
- If you want to use a different mode, press the mode switch until it changes to the desired setting. Pressing the mode switch will change the mode from AIR IN (SOFT) to AIR IN (REGULAR) to JET.

Mode	Description
 JET REGULAR AIR IN SOFT	JET mode <ul style="list-style-type: none">• This mode is for removing food particles trapped between the teeth.
 JET REGULAR AIR IN SOFT	AIR IN (REGULAR) mode <ul style="list-style-type: none">• This mode is for periodontal pocket cleaning and gum care.
 JET REGULAR AIR IN SOFT	AIR IN (SOFT) mode <ul style="list-style-type: none">• This mode is for gently massaging the gums.

Notes

- When you use the appliance for the first time, press the power switch to turn the appliance on and test each of the water jet modes with the tank filled with water.
- We recommend using the appliance in an ambient temperature range of 5 – 35 °C. If used outside this range, the appliance may stop operating.
- Do not hold the tip of the nozzle firmly against the teeth or gums.
- Do not operate the main unit when empty other than when pouring out any remaining water after use. Operating the main unit without water may result in a malfunction.

5 Place the nozzle in your mouth and close your mouth gently before pressing the power switch.

- To use, place your face over a washbasin, and with the main unit upright and the nozzle at the top, raise your elbow.
- Pressing the mode switch during use will change the mode.
- A fully filled water tank provides approximately 35 seconds of use.
- If the nozzle is inclined too much, water will come out of the ventilation hole instead of the nozzle. (The ventilation hole in the rear of the main unit allows for easier water suction of the hose.)



Turn the nozzle handle to adjust the direction of the water flow.

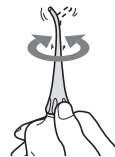

6 After use, press the power switch to turn off the main unit.

- Stop operation with the nozzle still in the mouth to prevent water from splashing.

► Cleaning the space between the teeth

In the JET mode

- Direct the water flow onto the \triangle zone between the teeth.
- Direct from the front and rear sides of the teeth.



► Periodontal pocket cleaning

In the AIR IN (REGULAR) mode

- Aim the water flow at the space between the teeth and gum.
- Slowly shift the water flow along the gum.
- Clean the front and back of the teeth and behind the molars as well.
- Clean the areas of concern in the gum in the AIR IN (SOFT) mode.
- * Do not clean the periodontal pocket in JET mode, since the strength of water flow is too strong.



► Gum care

In the AIR IN (REGULAR) mode

- Stimulate the gum.
- Gently stimulate the areas of concern in the gum in the AIR IN (SOFT) mode.



After use

1. Open the water tank cap and pour out the water.
 - Always pour out the remaining water and empty out the water tank. If water is left behind, this may result in the growth of bacteria.
2. Turn on the power switch and drain out the water.
 - Operate for 2-3 seconds until no more water appears and then turn off the power switch.
3. Stand the main unit in the charger.
4. While pressing the nozzle release button, remove the nozzle from the main unit and place it on the nozzle stand.

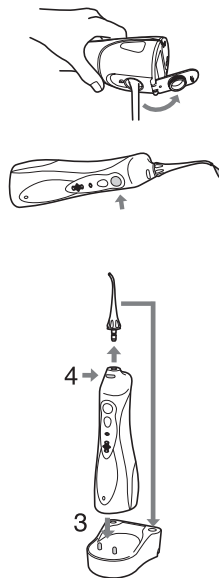

Cleaning

1. Pull out the water tank downwards.



2. Clean with water.



- Remove the identification ring and clean with water.
- Do not wash with hot water exceeding 50 °C.
- If using a detergent, use one suitable for dishwashing. Rinse well with water to ensure no detergent remains after cleaning.
- Never use thinners, benzine, or alcohol since it may cause malfunction or cracking/discoloration of the parts.

Scrub the filter at the tip of the suction hose lightly with a soft brush.

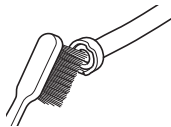

3. Wipe away the water with a towel etc. and dry.

4. Align and slide the water tank along the groove and install it securely.



Use a cloth to wipe away the stains on the charger.

- Never use thinners, benzine, or alcohol since it may cause malfunction or cracking/discoloration of the parts.
- Do not clean the charger with water.
- About once every six months wipe the prongs of the power plug with a dry cloth.



Troubleshooting

Problem	Possible cause	Action
The appliance does not operate.	▶ You have just purchased the product or it has not been used for more than 6 months.	▶ Charge the unit for at least 23 hours. (See page 9.)
	▶ The charging time is short.	
The appliance can be used only for several minutes, even if it is charged.	▶ The main unit is not standing upright on the charger. (See page 8.)	▶ Stand the main unit upright so that its base contacts the charging section of the charger.
	▶ Battery life is over (approx. 3 years).	▶ The battery has reached the end of its life. (See page 14.)
Water pressure is low.	▶ The nozzle is clogged.	▶ Replace the nozzle.
	▶ Mouth of the nozzle is squashed.	
	▶ Filter is clogged.	▶ Clean filter. (See page 12.)
Water does not come out.	▶ The main unit is tilted too much while in use.	▶ Use with the main unit in a vertical state. (See page 10.)

If the problems still cannot be solved, contact the store where you purchased the unit or a service center authorized by Panasonic for repair.

Battery life

The battery life is about 3 years when charged about once a week (when used by one person).

If the operating time is significantly shorter even after a full charge, the battery has reached the end of its life. (The operating life of the battery may differ depending on usage or storage conditions)
Have the battery replaced by an authorized service center.

Removing the built-in rechargeable battery

Remove the built-in rechargeable battery before disposing the appliance.

Please make sure that the battery is disposed of at an officially designated location if there is one.

This figure must only be used when disposing the appliance, and must not be used to repair it. If you dismantle the appliance yourself, it will no longer be waterproof, which may cause it to malfunction.

- Remove the appliance from the charger when removing the battery.
- Press the power switch to turn on the power and then keep the power on until the battery is completely discharged.
- Perform steps ① to ⑥ and lift the battery, and then remove it.
- Please take care not to short-circuit the battery.

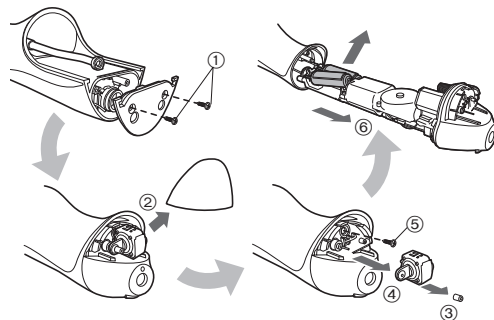

For environmental protection and recycling of materials

This appliance contains a Nickel-Metal Hydride battery.

Please make sure that the battery is disposed of at an officially assigned location, if there is one in your country.

Specifications

Power source	See the name plate on the product (Automatic voltage conversion)
Charging time	Approx. 15 hours
Power consumption	Approx. 1 W
Pump frequency	1400 pulses/minute*
Water pressure	JET : 590 kPa (6.0 kgf/cm ²) AIR IN (REGULAR): 390 kPa (4.0 kgf/cm ²) AIR IN (SOFT): 200 kPa (2.0 kgf/cm ²)
Operating time	Approx. 15 minutes (at 20 °C when fully charged)
Tank volume	Approx. 130 mL (approx. 35 seconds*)
Dimensions	Main unit: 197 (H) x 59 (W) x 75 (D) mm Charger: 40 (H) x 93 (W) x 98 (D) mm
Mass	Main unit: Approx. 305 g (Including nozzle) Charger: Approx. 210 g

* When using AIR IN (REGULAR) mode
This product is intended for household use only.

Changing the nozzle (Sold separately)

- If the tip of nozzle gets deformed, please replace with a new nozzle.
- The nozzle is a consumable. The nozzle should be replaced with a new one every 6 months or so due to hygiene reasons, even if its shape is unchanged.



New nozzle (tip)



Deformed nozzle (tip)

Part number	Replacement Nozzle for EW1211A	
EW0950	Nozzle	

Panasonic Corporation
<http://www.panasonic.com>
© Panasonic Corporation 2015