

Operating Instructions DAB-FM Radio Model No. RC-D8

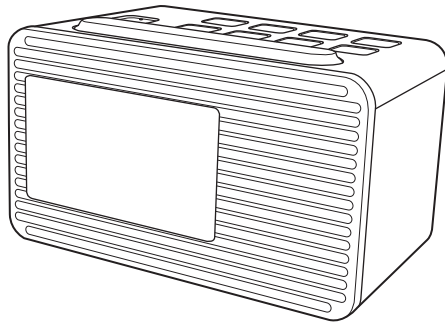

Thank you for purchasing this product. Please read these instructions carefully before using this product, and save this manual for future use.

Model number suffix "EB" denotes UK model.



Manufactured by:
Panasonic Corporation
Kadoma, Osaka, Japan
Authorized Representative in Europe:
Panasonic Marketing Europe GmbH
Panasonic Testing Centre
Winsbergring 15, 22525 Hamburg, Germany

Panasonic Corporation
Web Site: <http://www.panasonic.com>
© Panasonic Corporation 2020
77-20RC00801000
TQBJ2231-1
F0620TM1080

Disposal of Old Equipment
Only for European Union and countries with recycling systems

This symbol on the products, packaging, and/or accompanying documents means that used electrical and electronic products must not be mixed with general household waste. For proper treatment, recovery and recycling of old products, please take them to applicable collection points in accordance with your national legislation. By disposing of them correctly, you will help to save valuable resources and prevent any potential negative effects on human health and the environment. For more information about collection and recycling, please contact your local municipality. Penalties may be applicable for incorrect disposal of this waste, in accordance with national legislation.

Product Identification Marking is located on the bottom of the unit.

The symbols on this product represent the following:

- ~ AC
- DC
- Class II equipment (The construction of the product is double-insulated.)
- ⏻ On
- ⏻ Standby
- 🏠 For indoor use only

For the United Kingdom and Ireland customers

Sales and Support Information
Customer Communications Centre

- For customers within the UK: 0344 844 3899
- For customers within Ireland: 01 289 8333
- Monday–Friday 9:00 am - 5:00 pm (Excluding public holidays).
- For further support on your product, please visit our website: www.panasonic.co.uk

Direct Sales at Panasonic UK

- Order accessory and consumable items for your product with ease and confidence by phoning our Customer Communications Centre Monday–Friday 9:00 am - 5:00 pm (Excluding public holidays).
- Or go on line through our Internet Accessory ordering application at www.pas-europe.com.
- Most major credit and debit cards accepted.
- All enquiries transactions and distribution facilities are provided directly by Panasonic UK.
- It couldn't be simpler!
- Also available through our Internet is direct shopping for a wide range of finished products. Take a browse on our website for further details.

For Australia

Panasonic Warranty

1. Subject to the conditions of this warranty Panasonic or its Authorised Service Centre will perform necessary service on the product, without charge for parts or labour, if in the opinion of Panasonic the product is found to have a manufacturing defect within one (1) year or (12 months) (the "warranty period") from the date of purchase appearing on your purchase receipt.

2. This warranty only applies to Panasonic products purchased in Australia and sold by Panasonic Australia, its Authorised Distributors, or Dealers, and only where the products are used and serviced within Australia or its territories. Warranty cover only applies to the services that are carried out by a Panasonic Authorised Service Centre and only if valid proof of purchase is presented when the warranty service is requested.

3. This warranty only applies if the product has been installed and/or used in accordance with the manufacturer's recommendations (as noted in the operating instructions) under normal use and reasonable care (in the opinion of Panasonic). The warranty does not cover damage, malfunction or failure resulting from use of incorrect voltages, incorrect installation, accident, misuse, neglect, build-up of dirt or dust, abuse, maladjustment of customer controls, mains supply problems, thunderstorm activity, infestation by insects or vermin, tampering or repair by unauthorised persons (including unauthorised alterations), exposure to abnormally corrosive conditions, or any foreign object or matter having entered the product.

4. This warranty does not cover the following items unless the fault or defect existed at the time of purchase:

- Consumable parts
- Cosmetic parts
- Worn or damaged parts
- Information stored on Hard Disk Drives, Optical Discs, USB Devices, SD Cards, Tapes
- DTV reception issues caused by TV Aerial / Cabling / Wall socket(s)

5. Some products may be supplied with Ethernet connection hardware. The warranty is limited on such products and will not cover:

- Internet and or DLNA connection / setup related problems
- Access fees and or charges incurred for internet connection
- Incompatible software or software not specifically stipulated in the product operations manual; and
- Any indirect or consequential costs associated with the incorrect use or misuse of the hardware, its connection to the internet or any other device.

6. To claim warranty service, when required, you should:

- Contact Panasonic's Customer Care Centre on 132 600 for Service Centre information.
- Confirm the opening and acceptance times with the Authorised Service centre that you choose.
- Then send or take the product to a Panasonic Authorised Service Centre together with your proof of purchase receipt.
- Any freight and insurance costs associated with the transport of the product to and/or from your nearest Authorised Service Centre must be arranged and paid for by you.

7. The warranties hereby conferred do not extend to, and exclude, any costs associated with the installation, de-installation or re-installation of a product, including costs related to the mounting, de-mounting or remounting of any screen, (and any other ancillary activities), delivery, handling, freight, transportation or insurance of the product or any part thereof or replacement of and do not extend to, and exclude, any damage or loss occurring by reason of, during, associated with, or related to such installation, de-installation, re-installation or transit.

Panasonic Authorised Service Centres are located in major metropolitan areas and most regional centres of Australia, however, coverage will vary dependant on product. For advice on exact Authorised Service Centre locations for your product, please telephone our Customer Care Centre on 132600 or visit our website and use the Service Centre Locator.

In addition to your rights under this warranty, Panasonic products come with consumer guarantees that cannot be excluded under the Australian Consumer Law. If there is a major failure with the product, you can reject the product and elect to have a refund or to have the product replaced or if you wish you may elect to keep the goods and be compensated for the drop in value of the goods. You are also entitled to have the product repaired or replaced if the product fails to be of acceptable quality and the failure does not amount to a major failure.

If there is a major failure in regard to the product which cannot be remedied then you must notify us within a reasonable period by contacting the Panasonic Customer Care Centre. If the failure in the product is not a major failure then Panasonic may choose to repair or replace the product and will do so in a reasonable period of time from receiving notice from you.

THIS WARRANTY CARD AND THE PURCHASE DOCKET (OR SIMILAR PROOF OF PURCHASE) SHOULD BE RETAINED BY THE CUSTOMER AT ALL TIMES

If you require assistance regarding warranty conditions or any other enquiries, please visit the Panasonic Australia website www.panasonic.com.au or contact by phone on 132 600. If phoning in, please ensure you have your operating instructions available.

Panasonic Australia Pty. Limited
ACN 001 592 187 ABN 83 001 592 187
1 Innovation Road, Macquarie Park NSW 2113
www.panasonic.com.au

PRO-031-F11 Issue: 5.0 23-01-2018

Control reference guide

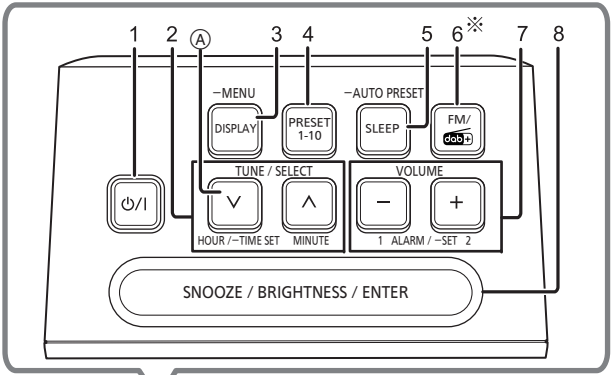

- Standby/on switch (⏻/I)
- Selects the frequency for radio source
Selects menu item/setting (During standby mode) Adjusts hour and minute setting
Ⓐ (During standby mode) Press and hold to enter alarm setting mode.
- Changes the displayed information
• Press and hold to enter menu mode.
- Stores or selects preset radio station
- Sets sleep timer
• Press and hold to perform auto presetting for FM stations.
- Selects "DAB" or "FM" as the audio source
※ This button is indicated as [FM/dab+] in these operating instructions.
- Adjusts the volume (0 (minimum) to 16 (maximum)) (During standby mode)
Turn alarm on/off
• Press and hold to enter alarm setting mode.
- Snoozes the alarm
Changes brightness of display
Confirms menu items/setting
- Display
- Speaker
The speaker does not have magnetic shielding. Do not place this unit near PCs or other magnetic devices.
- Battery compartment
- USB port for charging a device

Memory backup batteries (not supplied)

The memory backup batteries retain the clock settings during power supply interruption. (These batteries do not power the unit.) Use alkaline or manganese batteries. Install the batteries so that the poles (+ and -) align with those in the unit.

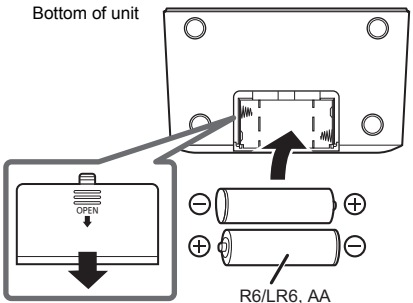

- “” will light up on the display if there is no battery inserted or when the battery level is below its minimum.
- When the batteries are weak, “” flashes on the display. Replace the batteries with new ones.
- Do not disconnect the unit from the power source when replacing the batteries.

Power source

Connect the AC adaptor firmly to the household mains socket.

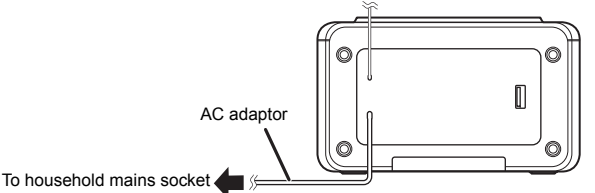

- The unit is in the standby condition when the AC adaptor is connected. The primary circuit is always "live" as long as the AC adaptor is connected to an electrical outlet.
- "0:00" flashes on the display if the time is not set.

Charging a device

Charging starts when a device (rated value: 5 V/1 A) is connected to the USB port of this unit.

- Confirm from the screen of the connected device, etc. to make sure charging has started.

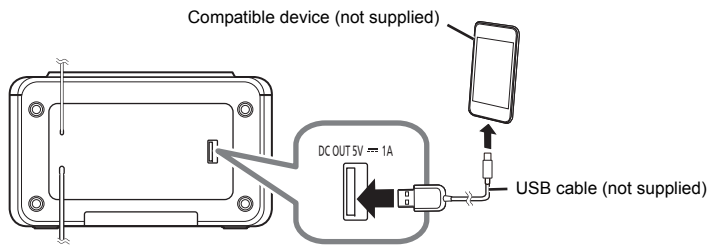

- You can charge the device regardless the unit is turned on or in standby mode.
- A cable compatible with your device is required. Use the cable that comes with your device.
- Even if you connect a cable compatible with the USB port of this unit, your device may not be charged. In that case, use the charger that comes with the device.
- Depending on your device, using other chargers may not work. Check the operating instructions of your device before use.
- Do not connect a device with a rated value higher than 5 V/1 A to this unit.
- To check if charging is complete, look at the screen of the connected device, etc.
- Once fully charged, remove the USB cable from the USB port.
- Depending on the type and placement of the device that is connected to the USB port, you may notice a degradation in radio signal reception.

Preparing the antenna

This unit can receive DAB/DAB+ and FM stations with the antenna. Rotate the antenna at Ⓐ to improve reception.

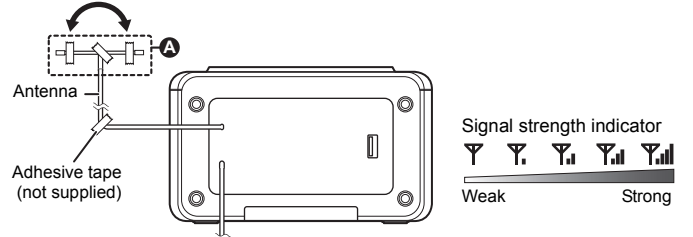

Unit on/standby

Press [⏻/I] to turn on the unit.

- The first time you turn on the unit, it will enter DAB mode and automatically scan for stations. It sets the time and date (if data is available) and starts playing the first station it finds.
- Press [⏻/I] again to switch the unit to standby mode.

- The unit is not turned off completely even in the standby condition. In the interest of energy conservation, if you will not be using the unit for an extended period of time, we recommend disconnecting the mains plug from the mains socket or removing the batteries. The unit consumes a small amount of power even in the standby condition. (→ "Specifications")
- In standby mode, the time and date are displayed.

Listening to DAB/DAB+

Preparation

- Turn the unit on.
- Press [FM/dab+] repeatedly to select "DAB".

Memorising stations

The first time you enter DAB mode, or if the station list is empty, the unit will start the full scan and memorise the stations. You can perform the full scan procedure when there is a new station or a station becomes available.

Press and hold [– MENU] for at least 2 seconds to select "Full scan" and then press [SNOOZE / BRIGHTNESS / ENTER] to start full scan.

- To cancel, press and hold [– MENU] for at least 2 seconds.

Remove unavailable listed stations

This unit indicates those stations that are closed or no longer available with a question mark in front of the station name. You can remove these stations from the station list.

- Press and hold [– MENU] for at least 2 seconds.
- Press [TUNE / SELECT √, ∨] to select "Prune" and then press [SNOOZE / BRIGHTNESS / ENTER].
- Press [TUNE / SELECT √] to select "Y" (Yes) and then press [SNOOZE / BRIGHTNESS / ENTER].
 - To cancel, press [TUNE / SELECT ∨] to select "N" (No).

Safety precautions

WARNING

- Unit**
- To reduce the risk of fire, electric shock or product damage,
 - Do not expose this unit to rain, moisture, dripping or splashing.
 - Do not place objects filled with liquids, such as vases, on this unit.
 - Use the recommended accessories.
 - Do not remove covers.
 - Do not repair this unit by yourself. Refer servicing to qualified service personnel.
 - Insert the mains plug fully into the socket outlet.
 - Do not pull, bend, or place heavy items on the lead.
 - Do not handle the plug with wet hands.
 - Hold onto the mains plug body when disconnecting the plug.
 - Do not use a damaged mains plug or socket outlet.
 - The mains plug is the disconnecting device. Install this unit so that the mains plug can be unplugged from the socket outlet immediately.

AC adaptor

- To reduce the risk of fire, electric shock or product damage,

CAUTION

- Unit**
- This unit may receive radio interference caused by mobile telephones during use. If such interference occurs, please increase separation between this unit and the mobile telephone.
- Avoid the use in the following conditions**
- High or low extreme temperatures during use, storage or transportation.
 - Replacement of a battery with an incorrect type.
 - Disposal of a battery into fire or a hot oven, or mechanically crushing or cutting of a battery, that can result in an explosion.
 - Extremely high temperature and/or extremely low air pressure that can result in an explosion or the leakage of flammable liquid or gas.
- Battery**
- Do not use rechargeable type batteries.
 - Danger of explosion if battery is incorrectly replaced. Replace only with the type recommended by the manufacturer.
 - Mishandling of batteries can cause electrolyte leakage and may cause a fire.
 - Remove the batteries if you do not intend to use the unit for a long period of time or if the unit is to be powered exclusively by AC power. Store in a cool, dark place.
 - Do not heat or expose to flame.
 - Do not leave the battery(ies) in a car exposed to direct sunlight for a long period of time with doors and windows closed.
 - Do not take apart or short circuit.
 - Do not recharge alkaline or manganese batteries.
 - Do not use batteries if the covering has been peeled off.
 - Do not mix old and new batteries.
 - Do not use different types of batteries at the same time.
 - When disposing of the batteries, please contact your local authorities or dealer and ask for the correct method of disposal.

Safety information for customers in Finland

SUOMI
VAROITUS

Laitte

- Tulipalo-, sähköisku- tai tuotteen vahingoittumisvaaran välttämiseksi,
 - Älä anna tämän laitteen altistua sateelle, kosteudelle, pisaroille tai roiskeille.
 - Älä laita laitteen päälle mitään nesteitä sisältäviä esineitä kuten maljakot.
- Käytä suositeltuja lisävarusteita.
 - Älä poista suojuksia.
 - Älä korjaa tätä laitetta itse. Anna huoltopalvelut tehtäväksi päteväälle henkilöstölle.

Verkkokaapeli

- Pistoketta käytetään virrankatkaisulaitteena. Asenna yksikkö siten, että pistoke voidaan irrottaa nopeasti pistorasistiasta.

Listening to the memorised stations	
1	Press [TUNE / SELECT ↕ , ↗] to select a station from the station list.
2	Press [SNOOZE / BRIGHTNESS / ENTER] to tune to the selected station.



- "**◻**"** indicates a secondary service station. Secondary service stations are always listed next to their primary station in the station list.

Presetting DAB/DAB+ stations	
You can preset up to 10 DAB/DAB+ channels.	
1	While listening to a radio broadcast: <p>Press and hold [PRESET 1-10] for at least 2 seconds.</p>
2	Press [TUNE / SELECT ↕ , ↗] to select the desired preset channel number and then press [SNOOZE / BRIGHTNESS / ENTER].



- The station occupying a channel is erased if another station is preset in that channel.

Listening to preset DAB/DAB+ stations
Press [PRESET 1-10] repeatedly to select desired channel number.
Manually tuning 1 frequency block
You can manually tune to 1 frequency block. This can be useful when you are adjusting the antenna to achieve the best possible reception and scanning a particular frequency block to update the station list.

- Press and hold [– MENU] for at least 2 seconds.
- Press [TUNE / SELECT ↕, ↗] to select “Manual tune” and then press [SNOOZE / BRIGHTNESS / ENTER].
- Press [TUNE / SELECT ↕, ↗] to select the frequency block that is receivable in your region and then press [SNOOZE / BRIGHTNESS / ENTER].

The display shows the received signal strength of the selected frequency block. Adjust the antenna to achieve the best reception.

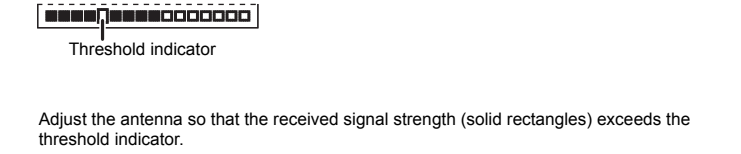

Viewing available information

You can view various information about the DAB/DAB+ broadcast such as dynamic label information (if available), signal strength, program type, ensemble name, frequency, bit rate, DAB variant and date.

Press [DISPLAY] repeatedly to view the available information.

Listening to FM radio

You can preset up to 10 FM channels.

Preparation

- Turn the unit on.
- Press [FM/dab+] repeatedly to select “FM”.

Presetting stations automatically
Press and hold [– AUTO PRESET] for at least 2 seconds.
(Once this step is performed, all previously preset stations will be erased.)
<ul style="list-style-type: none">Auto preset begins with the lowest frequency. The tuner starts to preset all the stations it can receive into the channels in ascending order. To cancel, press [TUNE / SELECT ↕, ↗]. (Erased stations will not be recovered.)

Listening to preset stations
Press [PRESET 1-10] repeatedly to select desired channel number.
■ Tuning to a station
Press and hold [TUNE / SELECT ↕ , ↗] until the frequency starts changing quickly.
<ul style="list-style-type: none">The unit stops tuning when it finds a station.



- Press [TUNE / SELECT ↕, ↗] repeatedly to search for the required station manually.

■ Presetting stations manually	
1	While listening to a radio broadcast: <p>Press and hold [PRESET 1-10] for at least 2 seconds.</p>
2	Press [TUNE / SELECT ↕ , ↗] to select the desired preset channel number and then press [SNOOZE / BRIGHTNESS / ENTER].



- The station occupying a channel is erased if another station is preset in that channel.

Viewing available information
(Except for Australia and New Zealand)
This unit can show the text data transmitted by the Radio Data System available in some areas, such as radio text, programme service, programme type and date.
(For Australia and New Zealand)
This unit can show the date.

Press [DISPLAY] repeatedly to view the available information.



- Radio Data System may not be available if reception is poor.

Time and alarm settings

Time
This is a 24-hour clock.
The time and date are updated automatically with the DAB/DAB+ broadcast (if available).
You can also set the time and date manually as follows.
(Only when the unit is in standby mode)

- Press and hold [HOUR / –TIME SET] for at least 2 seconds.
- Set the time. (Hours and minutes)
 - Press [HOUR / –TIME SET] repeatedly to adjust the hour.
 - Press [MINUTE] repeatedly to adjust the minute.
- Press [SNOOZE / BRIGHTNESS / ENTER].
- Set the date. (Day, month and year)
 - Press [TUNE / SELECT ↕, ↗] to adjust the setting and then press [SNOOZE / BRIGHTNESS / ENTER].



- Reset the clock regularly to maintain accuracy.

Alarm

You can set two alarms with different desired settings.

Preparation

- Ensure the time is set.

(Only when the unit is in standby mode)	
1	Press and hold [ALARM/–SET, 1] or [ALARM/–SET, 2] for at least 2 seconds. <ul style="list-style-type: none">If the time is not set, this unit will enter time setting mode. Make settings for the time.
2	While “Alarm 1 Setup” or “Alarm 2 Setup” is displayed, press [SNOOZE / BRIGHTNESS / ENTER].
3	Set the alarm time. <ul style="list-style-type: none">Press [HOUR / –TIME SET] repeatedly to adjust the hour. Press [MINUTE] repeatedly to adjust the minute.
4	Press [SNOOZE / BRIGHTNESS / ENTER] to confirm the alarm time.
5	Press [TUNE / SELECT ↕ , ↗] to select desired item or setting and then press [SNOOZE / BRIGHTNESS / ENTER]. <ul style="list-style-type: none">Set the audio source. <p>Source: Buzzer, DAB, FM</p> If FM or DAB is set, select the last station you tuned in to (“Last listened”) or a preset station as the audio source. Set the volume (8 (minimum) to 16 (maximum)) <p>The alarm starts at a low volume and increases gradually to the preset level.</p> (Volume adjustment made using [VOLUME –, +] will not affect the alarm volume.) Turn on the alarm <p>Alarm: Off, On</p> Select “On” to turn on the alarm.

- Turning the alarm on/off**

The alarm will sound at the set time every day for a duration of 59 minutes. You can turn the alarm on/off as desired.

(Only when the unit is in standby mode)

Press [ALARM/–SET, 1] or [ALARM/–SET, 2] to turn the corresponding alarm on/off.

- The corresponding alarm indicator (“Ⓞ₁” or “Ⓞ₂”) will be displayed when its alarm is turned on.

To stop the sounding alarm

Press [Ⓞ₁] or press the corresponding alarm button ([ALARM/–SET, 1] or [ALARM/–SET, 2]).

“Alarm off” is displayed.

To snooze the sounding alarm

Press [SNOOZE / BRIGHTNESS / ENTER] to put the alarm into snooze mode.

- The unit will switch into standby mode and the corresponding alarm indicator (“Ⓞ₁” or “Ⓞ₂”) blinks slowly.
- Snooze interval is 5 minutes.
- Press [Ⓞ₁] to turn on the unit will also stop the snooze mode.
- The alarm works in both unit on and standby modes.

Sleep timer

The sleep timer can turn the unit off after a set time.

Press [SLEEP] repeatedly to select the setting (in minutes).

– Sleep off, 30 minutes, 60 minutes, 90 minutes, 120 minutes

- “SLEEP” is displayed when the sleep timer is set.
- To cancel, select “Sleep off”.
- Pressing [SLEEP] while the sleep timer is set allows you to check the remaining time.

Display brightness

Press [SNOOZE / BRIGHTNESS / ENTER] repeatedly to select desired display brightness (bright, less bright, dim).

- You can change the display brightness during unit on or standby mode.
- You cannot change the brightness during menu setting mode, or when the alarm sounds or snoozes.

System settings

- Press and hold [– MENU] for at least 2 seconds.
- Press [TUNE / SELECT ↕, ↗] to select “System” and then press [SNOOZE / BRIGHTNESS / ENTER].
- Press [TUNE / SELECT ↕, ↗] to select desired item or setting and then press [SNOOZE / BRIGHTNESS / ENTER].
 - To cancel the setting in the middle, press [– MENU].
 - If there is an asterisk on the right-hand side of the menu item, the display is showing the current setting of the item.

Backlight
You can set the backlight of display to turn off automatically after 10 seconds of inactivity. <ul style="list-style-type: none">On: The backlight is always on. – 10 sec: The backlight turns off after 10 seconds of inactivity.
Language

(Except for Australia and New Zealand)

You can change the language for the display.

– English, Français, Deutsch, Italiano

Factory Reset
Select “Y” (Yes) to reset the unit to factory default setting. <ul style="list-style-type: none">N (No), Y (Yes)
Software ver

Select “Y” (Yes) to view the software version installed for this unit.

– N (No), Y (Yes)

Troubleshooting

Before requesting service, make the following checks. If you are uncertain about some of the check points, or if the solutions indicated in the following guide does not resolve the issue, then consult your dealer for instructions.

To return all settings to the factory defaults
Set “Factory Reset” in System menu to “Y” (Yes).
<div><div><div></div><div></div></div></div>
<ul style="list-style-type: none">The settings are returned to the factory defaults. It is necessary to set the settings again.

General
Sound is distorted or no sound.
<ul style="list-style-type: none">Adjust the volume. If the AC adaptor or fluorescent lights are near the cords, then keep other appliances and cords away from the cables.

The unit does not work.

- One of the unit’s safety devices may have been activated.
 - ① Press [⏻/⏻] to switch the unit to standby.
 - If the unit does not turn off, disconnect the AC adaptor from the AC mains socket. After about 30 seconds, reconnect the AC adaptor to the AC mains socket. Then wait for about 10 seconds.
 - ② Press [⏻/⏻] to switch it on. If the unit still cannot be operated, consult the dealer.

Radio
DAB/DAB+ reception is poor.
<ul style="list-style-type: none">Keep the antenna away from computers, televisions, other cables and cords. Move the unit to another location and do a full scan again.

Static or noisy reception is heard while listening to a radio broadcast.

- Check and adjust the antenna.
- Try to keep a certain amount of distance between the antenna and AC adaptor.
- Turn the TV or other audio players off or separate it from this unit.
- Keep this unit away from mobile phones if there is interference.

Messages
The following messages may appear on the unit’s display.
“Alarm Not saved”
<ul style="list-style-type: none">The changes made to the alarm settings are incomplete. The changes will be lost.

“No DAB Station”
<ul style="list-style-type: none">No DAB/DAB+ station available. Check the antenna. Move the unit to another location and do a full scan again.

“Preset ◻ Empty” (“◻” stands for a number.)
<ul style="list-style-type: none">There are no preset stations to select. Preset some channels.

“Service Invalid”
<ul style="list-style-type: none">No DAB/DAB+ reception.
“Time Not saved”
<ul style="list-style-type: none">The changes made to the time settings are incomplete. The changes will be lost.

“USB over current remove USB”
<ul style="list-style-type: none">The USB device is using too much power. Disconnect the USB device. Then, disconnect the AC adaptor from the AC mains socket, and then reconnect the AC adaptor to the AC mains socket. Check the connection, it may be caused by a faulty cable.

Maintenance

Disconnect the AC adaptor from the outlet before maintenance.

- Clean this unit with a soft, dry cloth**
 - When dirt is heavy, wring a wet cloth tightly to wipe the dirt, and then wipe it with a dry cloth.
 - Never use alcohol, paint thinner or benzine to clean this unit.
 - Before using chemically treated cloth, carefully read the cloth’s instructions.

- To dispose or transfer this unit**

The unit may keep the user settings information in the unit. If you discard this unit either by disposal or transfer, then follow the procedure to return all the settings to the factory defaults to delete the user settings. (→ Troubleshooting, “To return all settings to the factory defaults”)

Specifications

■ GENERAL	
Power supply	
AC adaptor	
Input	AC 100 V to 240 V, 50/60 Hz, 0.5 A
Output	(For Australia and New Zealand) DC 5.0 V, 2.0 A <p>(For others) DC 5.0 V, 2.0 A, 10.0 W</p>
Main unit	
Power supply input	
DC IN	DC 5 V, 2 A
Power consumption	9 W
Power consumption in standby mode	Approx. 0.8 W
Memory backup batteries	3 V (2×R6/LR6)

Dimensions (W×H×D)	150 mm×89 mm×90 mm (including protrusions)
Mass	
Without batteries	Approx. 0.53 kg
With batteries	Approx. 0.58 kg
Operating temperature range	0 °C to +40 °C
Operating humidity range	20% to 80% RH (no condensation)

■ AMPLIFIER SECTION	
Output power	
RMS output power	
Front Ch	1 W Mono (8 Ω), 1 kHz, 10% THD
■ TUNER SECTION	
Preset Memory	FM 10 stations
Frequency Modulation (FM)	
Frequency range	87.50 MHz to 108.00 MHz (50 kHz step)
■ DAB SECTION	
DAB memories	10 channels
Frequency Band (Wavelength)	
Band III	5A to 13F (174.928 MHz to 239.200 MHz)
Sensitivity *BER 4x10⁻⁴	
Min Requirement	–98 dBm
■ SPEAKER SECTION	
Speaker unit	
Full Range	5 cm cone type×1
■ TERMINAL SECTION	
USB Port	
USB Port power (for charging only)	DC OUT 5 V 1 A



- Specifications are subject to change without notice.
- Mass and dimensions are approximate.
- Total harmonic distortion is measured by a digital spectrum analyzer.

 Safety information for customers in the EU
Declaration of Conformity (DoC)
Hereby, “ <i>Panasonic Corporation</i> ” declares that this product is in compliance with the essential requirements and other relevant provisions of Directive 2014/53/EU. Customers can download a copy of the original DoC to our RE products from our DoC server: http://www.ptc.panasonic.eu <p>Contact to Authorized Representative: Panasonic Marketing Europe GmbH, Panasonic Testing Centre, Winsbergring 15, 22525 Hamburg, Germany</p>