

Smart Air-Conditioner Operating Instructions

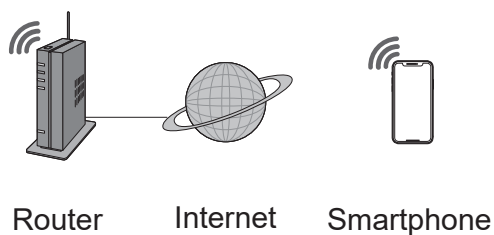

Indoor Unit

Items you need to prepare
(purchase and subscribe separately)



Download from app store



Panasonic "MirAle" app
(free)



Operating Instructions Smart Air Conditioner

Thank you for purchasing Panasonic Smart Air Conditioner.
Installation instructions attached.

Before operating the unit, please read these operating instructions thoroughly and keep them for future reference.

The illustrations in this manual are for explanation purposes only and may differ from actual unit.

They are subject to change without notice for future improvement

More information and Troubleshooting tips –for Latest Information on Connectivity and IoT Features;
we recommend to follow the steps and instructions mentioned on:-
<http://www.panasonic.com/in/miraie/support>

Panasonic Smart Air-Conditioner User Manual

Panasonic Smart Air Conditioner can be operated and controlled by using your smart phone even when you are away from your home.

What do you need?

- Panasonic Smart Air Conditioner.
- Wi-Fi router with internet connectivity of at least 2 Mbps.
- Ensure to have a strong Wi-Fi signal where your Air Conditioner is installed.
- Panasonic Smart Air Conditioner Wi-Fi operates in the 2.4 GHz band.
- Smart Phone with an active mobile number (+91- 1234 567 890) for registration purpose.

How to get the (Android / iOS based) Panasonic Smart-Home Application?

1. Download the “MirAle” application from App Store or Google Play Store.
2. “MirAle” application supports from iOS version 12 and Android version 6 onwards.

How to register as a user?

1. Launch Application and press Sign Up button.

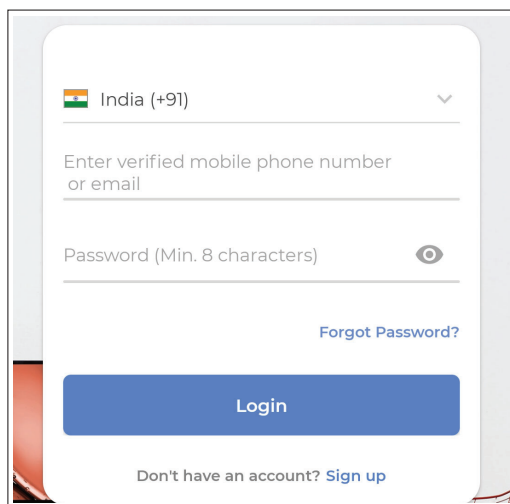

2. Enter a valid mobile number and click on Generate OTP Button.

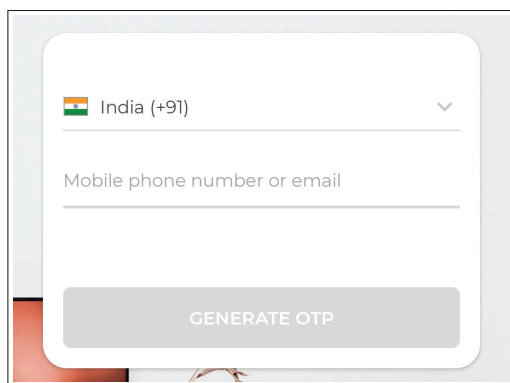

3. An OTP shall be received via text message on entered phone number.

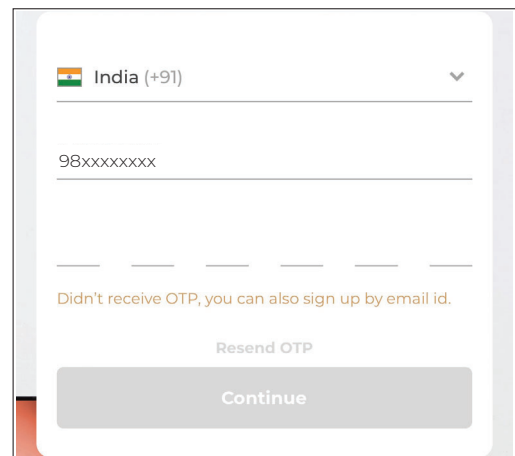

4. Enter your name, e-mail address and create a Password of 8 character or more. Then, click on 'SIGN UP' button.

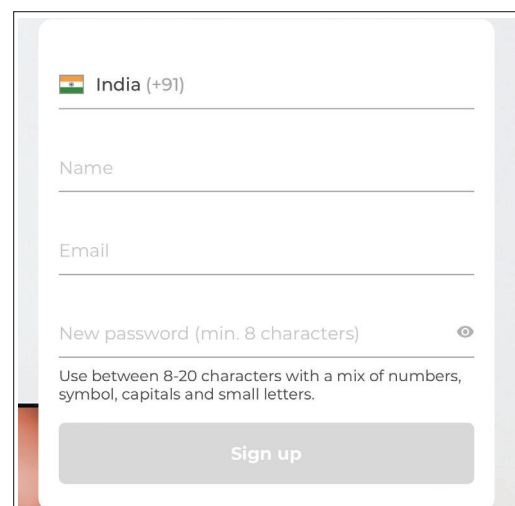

Congratulations! You have now registered as a user in the MirAle application. Let us setup your Air Conditioner to this application

Matter is an Open Standard for Smart Home Technology that lets your Device works with any Matter - Certified Ecosystem using a Single Protocol.

- All Matter Certified Devices comes packed with a Matter Logo
- All Matter Certified Devices will provide a QR Code and a Manual Pairing Code (11 or 21-digit codes)

Where can I find QR Code and Manual Pairing Code?

QR Code Sticker can be found on the AC Unit. 11- or 21-digit Manual Pairing Code can be found on QR code.

How to add your Panasonic Matter Certified Air Conditioner to the MirAle Application.

1. Click on “ + ” in the app dashboard and add a device.

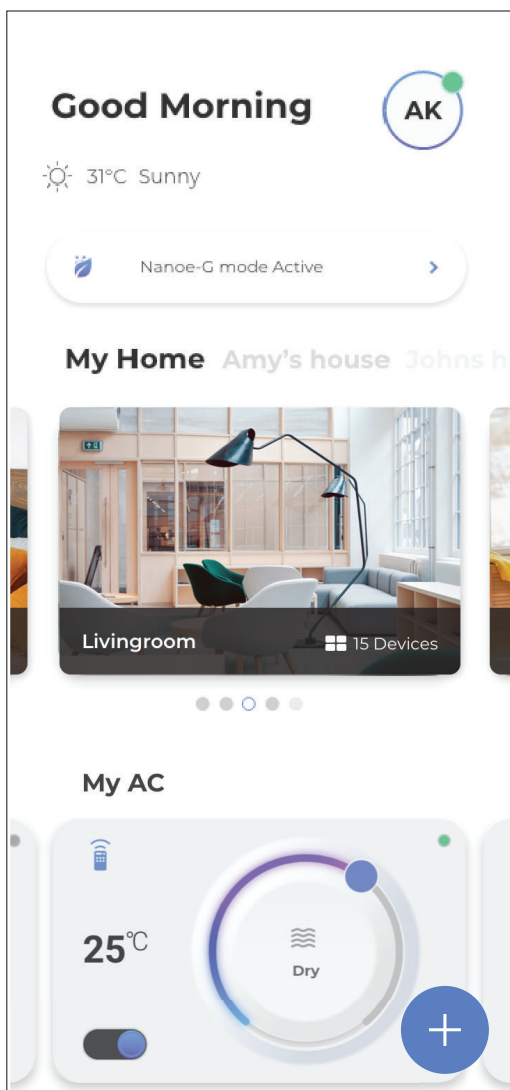

2. Device can be added by any of the following methods :

a). Scan QR Code

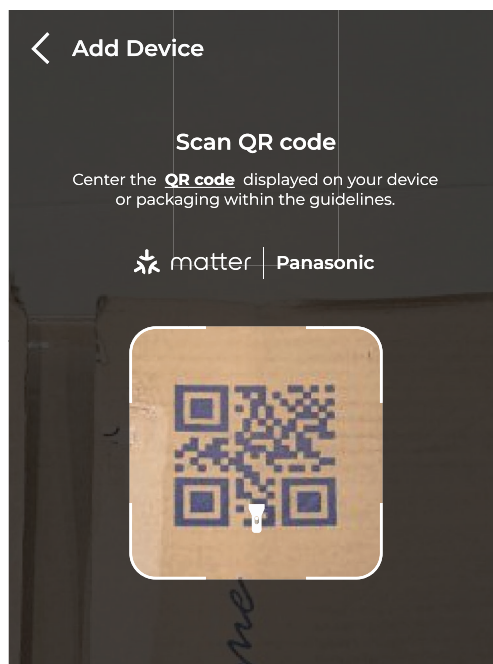

b). Add by setup code:

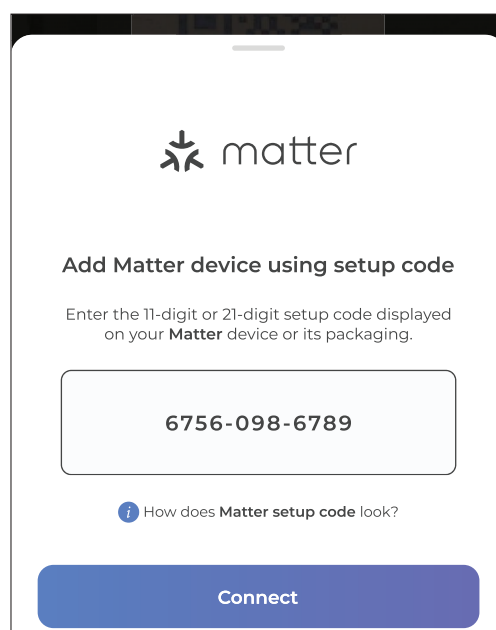

3. Press "SMART" button on remote until the Wi-Fi (📶) Indicator on AC starts blinking. "SE" will be displayed, showing that the AC is in setup mode. Click on continue button.

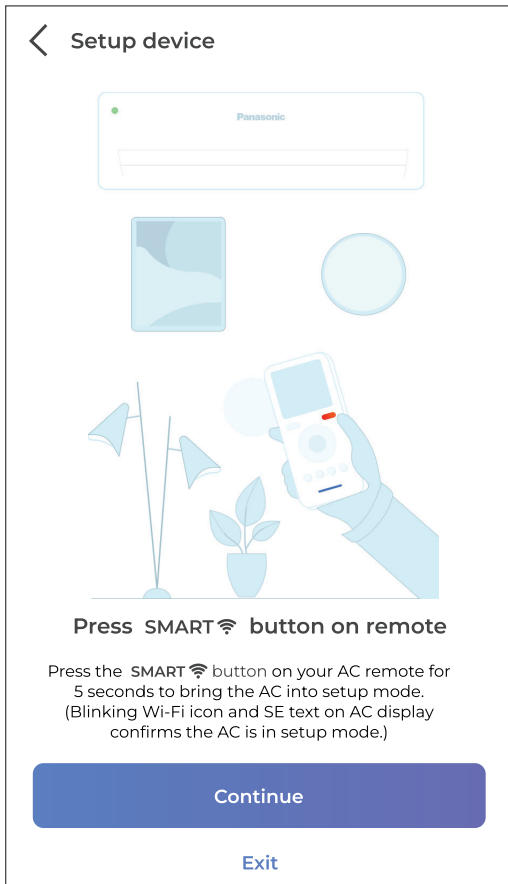

4. Choose Home WiFi Network and enter the Password.

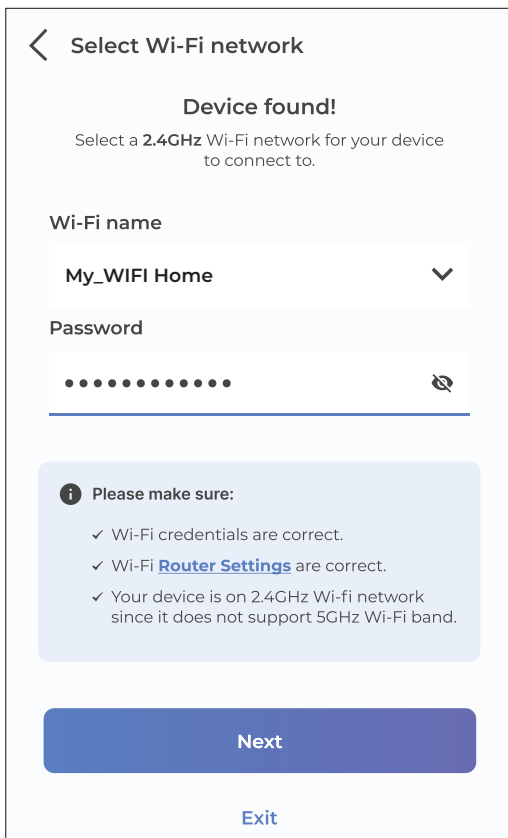

5. Mobile App will setup the Air conditioner and connect to server.

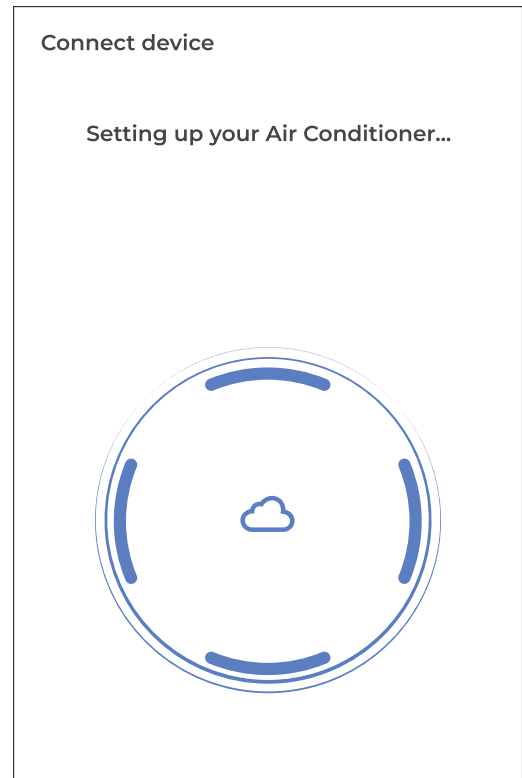

6. Upon successful completion, press "Go to Dashboard" to view and control the Air Conditioner.

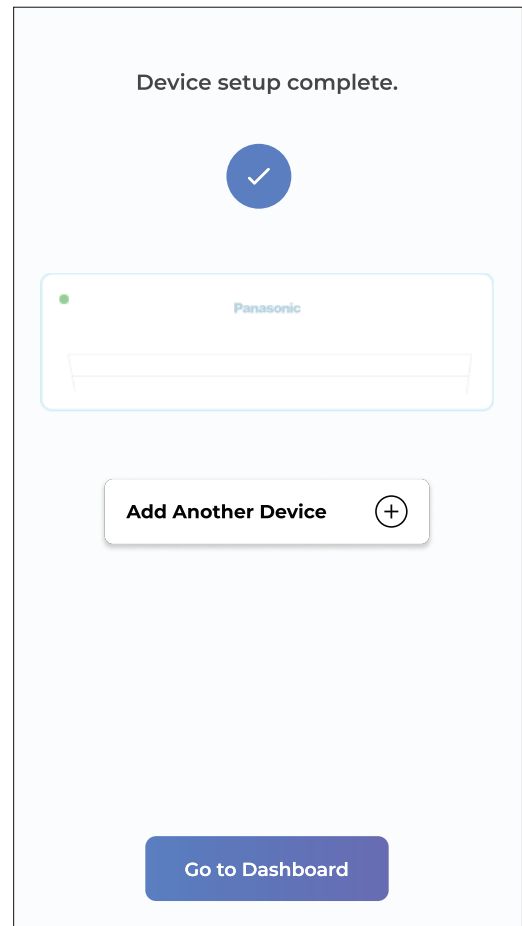

How to add your Panasonic Matter Certified Air Conditioner to the other Matter Certified Ecosystem Application.

- 1). Before onboarding, please check if the Ecosystem Application supports Matter Room Air Conditioner device type.
- 2). Power OFF and Power ON your Room Air Conditioner and Press “SMART” button on remote until the WiFi Indicator on AC starts blinking. “SE” will be displayed, showing that the AC is in Set-up mode.
- 3). Follow Instructions given on Ecosystem Application for AC device onboarding. (only 2.4GHz frequency allowed)

How to add your Panasonic Non-Matter Air Conditioner to the MirAle Application.

1. Click on “ + ” in the app dashboard and add a device.

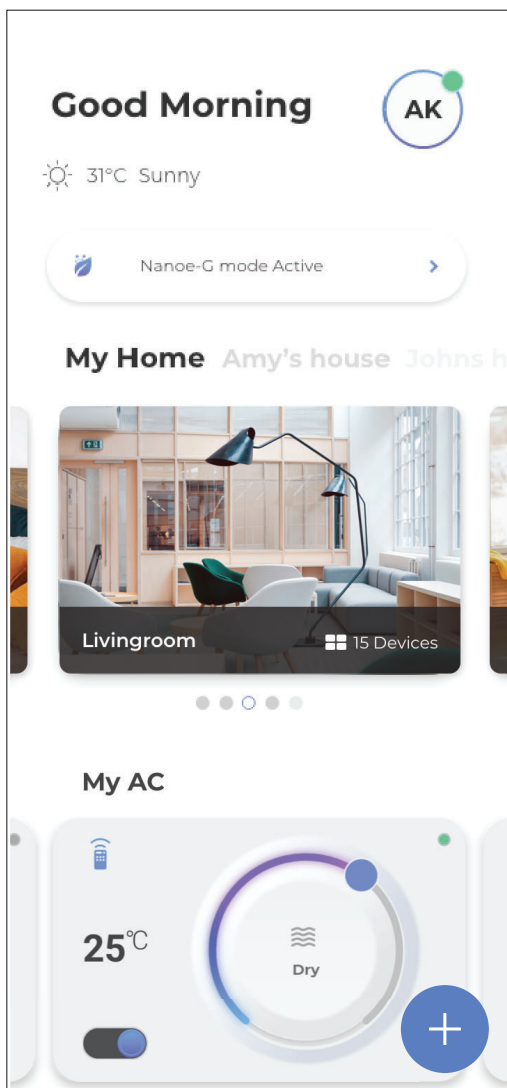

2. Device can be added by device type and Select Air Conditioner

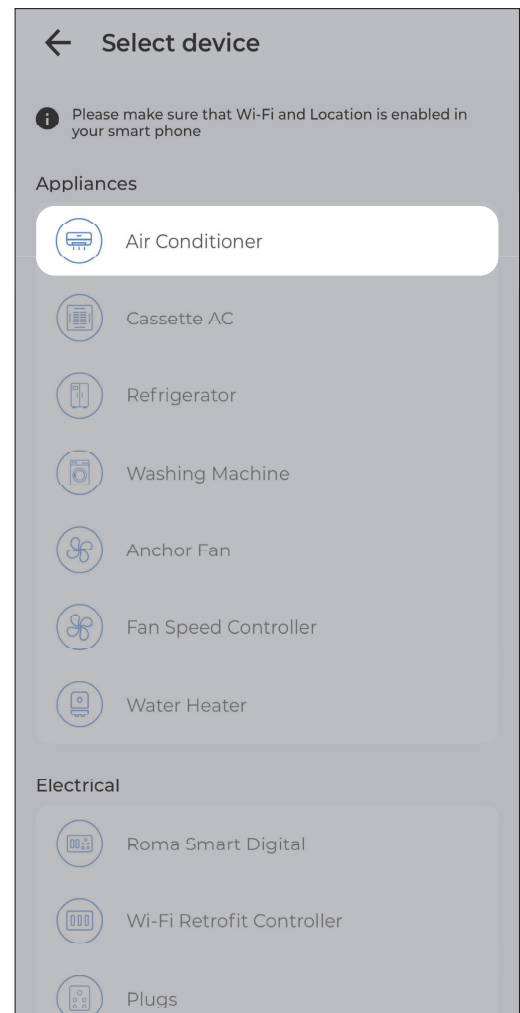

3. Press “SMART” button on remote until the Wi-Fi (📶) Indicator on AC starts blinking. “SE” will be displayed, showing that the AC is in setup mode. Click on continue button.

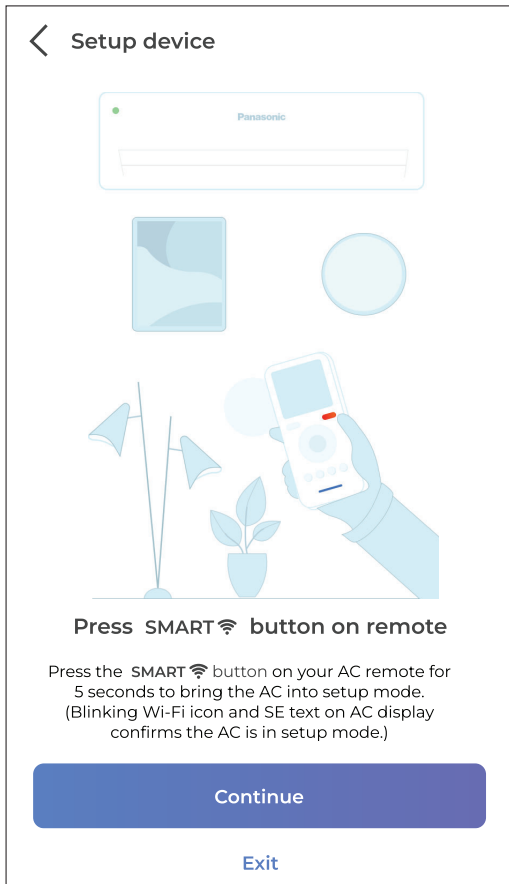

4. **Android:** Choose the AC that needs to be setup.
iOS: Connect to the access point that has prefix “PANASONIC” from the Wi-Fi settings page.

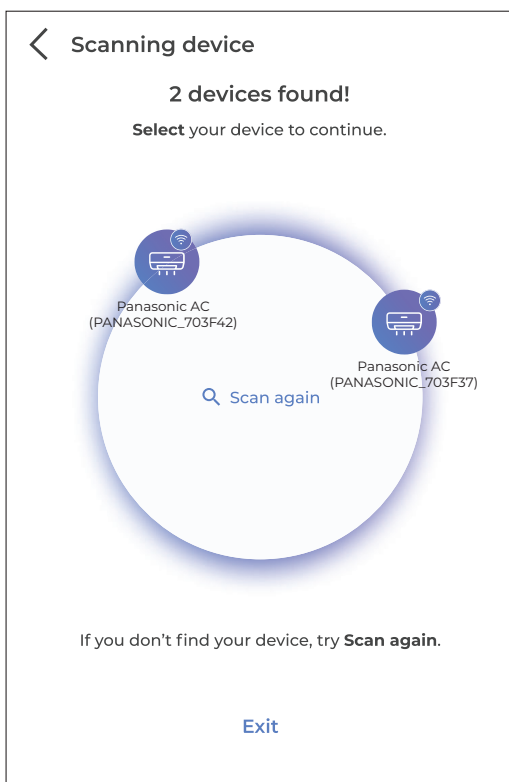

5. Choose Home WiFi Network and enter the Password.

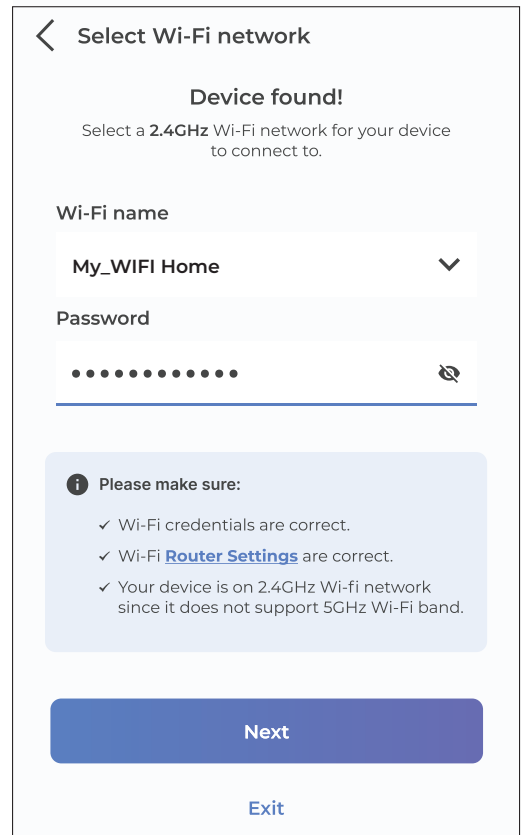

6. Mobile App will setup the Air conditioner and connect to server.

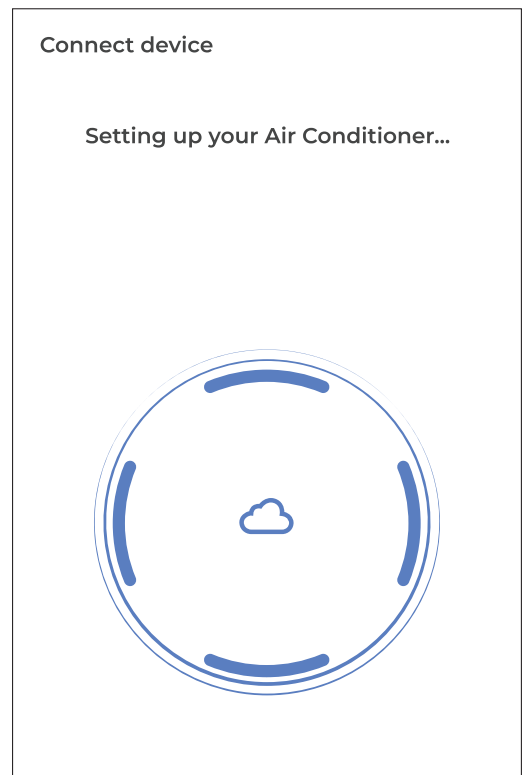

7. Upon successful completion, press “Go to Dashboard” to view and control the Air Conditioner.

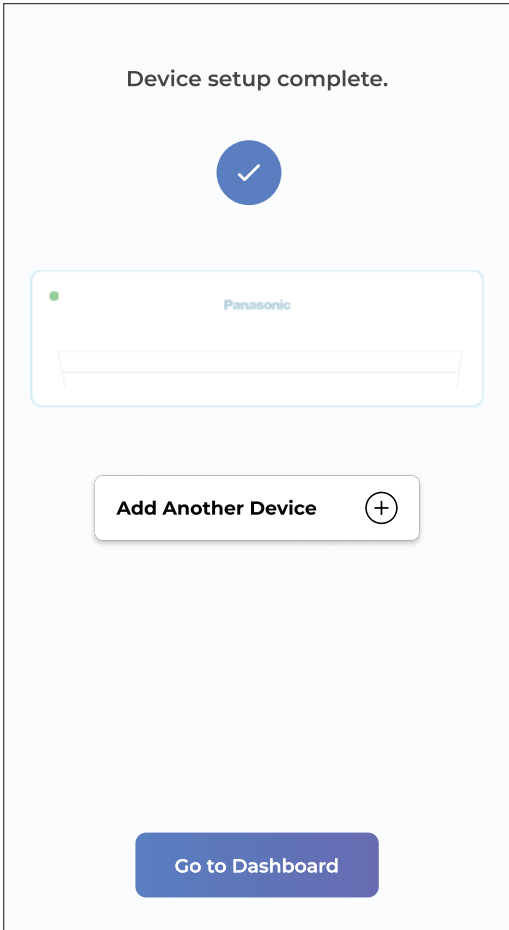

Disclaimer :

All features of Remote may not work with WiFi, they are specific to respective models and subject to change without notice.

For No Connectivity

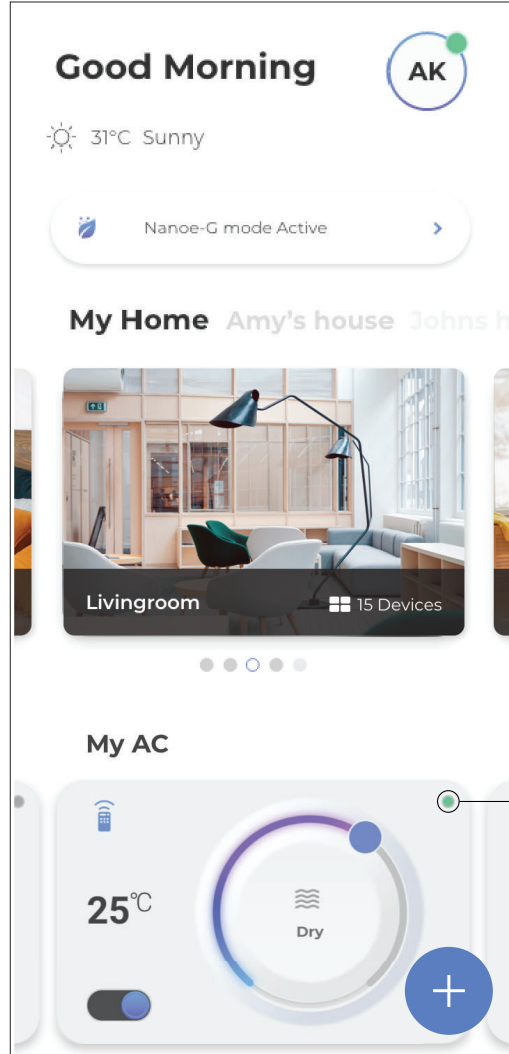

Green means – Connectivity Good
Grey means – Connectivity Poor / No Connectivity

Air-Conditioner with Google Assistant

Steps to enable Google Assistant to control Panasonic Smart Air Conditioner:

1. From the Google Home app, link Panasonic MirAle account.
2. Provide the Panasonic MirAle app user-name and password in the Panasonic Identity Server page.
3. Your Panasonic Smart Air conditioner will now appear under devices in Google Home Application
4. Google Assistant can now be used to control your Air Conditioner through voice commands.



Air-Conditioner with Amazon Alexa

Steps to enable Amazon Alexa to control Panasonic Smart Air Conditioner:

1. Open the Amazon Alexa App and search for Panasonic MirAle skill.

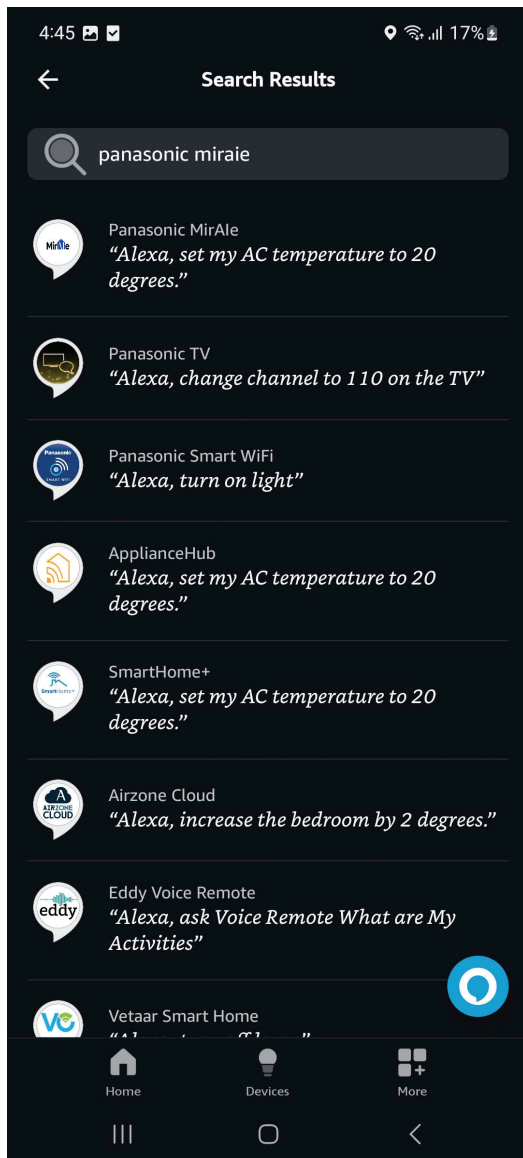

2. Enable Panasonic MirAle skill.
Provide the Panasonic MirAle app user-name and password in the Panasonic Identity Server page.

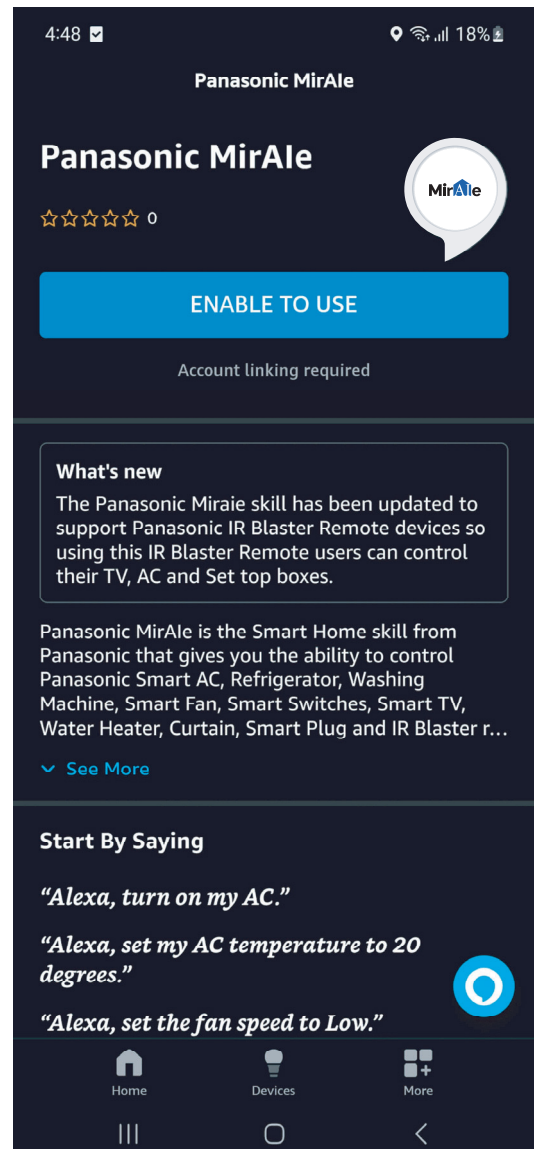

Your Panasonic Smart Air conditioner will now appear under devices in Amazon Alexa App. Amazon Alexa can now be used to control your Air Conditioner through voice commands.

Troubleshooting

Common Onboarding Errors :-

S.No.	Error Codes	Details
1.	102 /125	Must Upgrade the device Firmware before you can Setup the Device
2.	105	Incorrect Home WiFi Credeantial. Please re-enter Correct Credential and retry.
3.	115	Home WiFi is Not accessible by AC. make Sure Router in Powered ON and Close to the appliance.
4.	117 / 104 / 120	Please try after sometime.
5.	103 / 193	Please try after sometime. If Possible, try with different SMART PHONE model.
6.	116 / 4xxx	Contact Customer Care

S.No.	Problems	Solutions
1.	I could not see my Air Conditioner when I try to add to MirAle application.	Ensure that you have pressed the "SMART" button until the Wi-Fi indicator on the AC is blinking.
2.	I could not connect my Air Conditioner with Wi-Fi network.	Retry the procedure. If the problem persists, contact customer support.
3.	I would like to know the status of Wi-Fi connectivity of my Air Conditioner.	Press "Cancel" button for 10 seconds. AC will display the status. Use the "Diagnose" option in "MirAle" application (Go to AC Details page and then select "Manage Device" in the title bar) for next steps.
4.	I am not able to change settings of my Air Conditioner from my mobile application.	Press "Cancel" button for 10 seconds. AC will display the status. Use the "Diagnose" option in "MirAle" application for next steps.

Error code list:-

Detail	Problem	Error Code	Fix
No Error	No problem, server connection OK	EC0	---
Wi-Fi Module not Connected	IDU PCB cannot detect Wi-Fi Module	H85	Connect Wi-Fi module / replace Wi-Fi module
Information: Wi-Fi module in setup mode	Wi-Fi module in onboarding state currently	SE	
Wi-Fi router not setup	Wi-Fi router SSID and password not setup	EC1	Enter onboarding mode and provide SSID and password
Wi-Fi router not Connected	1) Wrong password	EC2	Provide correct SSID/password by entering onboarding state
	2) Wi-Fi router signal weak / router abnormal	EC3	Fix Wi-Fi router and/or signal problem
Cannot connect to the Server	Connected Wi-Fi network but cannot connect to the server / unknown server problem	EC4	Check internet settings of Wi-Fi router / contact ISP / contact PANASONIC customer care
Information: Wi-Fi radio truned off by user	Wi-Fi radio turned off by user	EC5	Wi-Fi radio can be turned on by user

Factory Reset :-

For Factory Reset, please refer Air Conditioner Product Manual.

Panasonic Corporation
Website: <http://www.panasonic.com>

© Panasonic Corporation 2023

Printed in India

ACXF55-39580
FT1123-0