

Panasonic

Operating Instructions

(Household use) Body trimmer
Model No. ES-WR51

Contents

- Safety precautions**..... 2
- Important information** 4
- Parts identification** 4
- Installing the battery** 5
- Instructions** 5
- Replacing** 7
- Cleaning** 8
- Troubleshooting** 8
- Specifications** 9

Thank you for purchasing this Panasonic product.
Before operating this unit, please read these instructions completely and save them for future use.

WARNING

- This appliance can be used by children aged from 8 years and above and persons with reduced physical, sensory or mental capabilities or lack of experience and knowledge if they have been given supervision or instruction concerning use of the appliance in a safe way and understand the hazards involved. Children shall not play with the appliance. Cleaning and user maintenance shall not be made by children without supervision.
- Keep the appliance dry.

Safety precautions

Make sure to follow these instructions.

- To prevent accidents, injuries or damage to property, please follow the instructions below.

	WARNING	Indicates potential hazard that could result in serious injury or death.
	CAUTION	Indicates potential hazard that could result in minor injury or property damage.

Some parts of the safety precaution illustrations differ from the actual product.

WARNING

- ▶ **This product**
 - **Do not place within reach of children or infants. Do not let them use it.**
Doing so may cause injury or accidental ingestion of the accessories or removable of small parts.
 - **Immediately stop using if there is an abnormality or malfunction.**
Failure to do so may cause fire or injury.

CAUTION

- ▶ **To protect your skin**
 - **The following persons should not use this appliance:**
Persons with sensitive or delicate skin, persons with allergies.
 - **Do not use in the following body areas:**
 - Face, vulva, anus
 - Pre-existing injuries, rashes, moles, bruises, warts, pimples or any other protrusions, along with the surrounding areas of each
 - Skin which is flaccid, limp, sagging, crepey, etc.
- Doing so may result in skin inflammation, abrasions, bleeding or even more serious injury.

- **If the battery cover is tight, do not remove it with excessive force.**
The protective cap may detach first and the blade may cause injury to your hands.
- **Do not apply strong pressure to the skin or move repeatedly over the same area.**
- **Do not use with a jabbing motion.**
Doing so may result in skin inflammation, abrasions, bleeding or even more serious injury.
- **Check the blade for cracks or deformations before use.**
Failure to do so may cause injury to the skin.
- **To remove the protective cap, hold it in the centre and pull.**
Failure to do so may cause injury to your hands by the blade.
- **Use the appliance only for its intended use.**
Failure to do so may cause injury.
- **If skin problems appear after use, stop using the appliance and contact a dermatologist.**
Failure to do so may cause symptoms to worsen.
- **When storing or carrying, always attach the protective cap.**
Failure to do so may cause injury to the skin or reduce the life of the blade.

- ▶ **This product**
 - **Do not forcefully press the blade. Also, do not touch the blade with fingers or nails when in use.**
Doing so may cause injury to the skin or reduce the life of the blade.
 - **Do not share with your family or others.**
Doing so may cause infection or inflammation.
 - **Do not modify, disassemble or repair.**
Doing so may cause an accident or injury.
→ Contact an authorized service centre for repair.
- ▶ **The battery**
 - **Do not throw the battery into fire or disassemble.**
 - **The supply terminals are not to be short-circuited.**
Doing so may cause a burn or injury.
 - **Always follow the cautions printed on the battery.**
 - **Check the polarity of the battery (⊕ and ⊖) and install it correctly.**
 - **Remove the battery immediately and dispose of it safely when it is discharged.**
 - **Remove the battery when not using the appliance for an extended period of time.**
 - **Use the battery by the recommended use-by date.**
 - **Non-rechargeable batteries are not to be recharged.**
Failure to do so may cause overheating or explosion of the battery, injury or contamination of surroundings due to leakage.



The symbol on the left means "Do not wash the product with water".

Important information

- Dry shave only.
- Do not immerse the main body in water or pour water over it. Doing so may damage it.
- Do not operate the appliance with sunscreen or perfume, etc. sticking to your hands. If sunscreen or perfume, etc. adheres to the main body, please remove it. Otherwise such substances may cause deterioration of the plastic or malfunction due to cracks.
- Do not drop or hit against other objects.

Parts identification

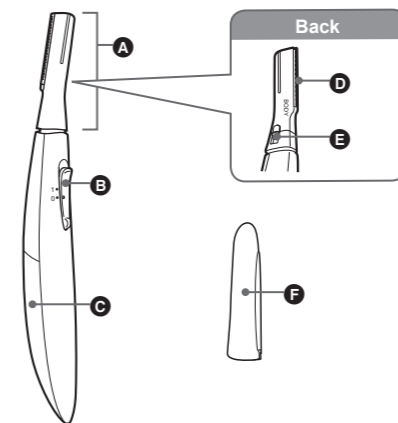

- Ⓐ Head
- Ⓑ Power switch [0/1]
- Ⓒ Battery cover
- Ⓓ Blade
- Ⓔ Blade release button
- Ⓕ Protective cap

A battery is not supplied.
Please purchase it separately.

Installing the battery

- Always attach the protective cap when installing or replacing the battery.
 - Make sure the power switch is in the "0" position.
1. Pull the battery cover to remove it.
 2. Check ⊕ ⊖ and insert the battery.
 3. Attach the battery cover.
Press firmly until it clicks.

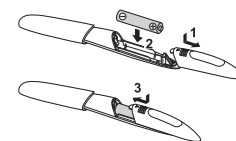

Notes

- You can use the appliance for approximately 1 month with the Panasonic LR03 (AAA alkaline battery).
(When used in an environment at a 20 °C room temperature, twice a week, and five minutes at a time.)
- Use only LR03 (AAA alkaline battery). Manganese batteries significantly degrade performance.

Instructions

- When you use the appliance for the first time, apply the appliance to your skin softly and shave off the hair gradually.
- Do not use the appliance on your face.
- ▶ **Preparations**
 - Wipe off moisture or sweat on your skin.
 - Do not apply skin lotion, milky lotion, powder, or antiperspirant etc. Keep your skin clean and dry.

1 Hold the centre of protective cap and remove it.



2 Slide the power switch to "1" and shave.

- Set down the blade and apply it along your skin.
- Move the appliance toward the direction indicated by the arrow slowly against the hair flow.

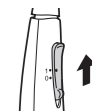

Example of use

Underarms

Move in several directions



Arms

Inwards from the outside of the arm



Hands/fingers

Inwards from the outside



Legs

Upwards from the bottom of the leg



Nape of the neck/back

Upwards from the bottom



Bikini line

Upwards from the bottom
• Wear your swimsuit or shorts, and determine the line you want to shave beforehand.



3 Set the power switch to "0".

4 Attach the protective cap.

- To prevent deformation or damage to the blade, or attachment of foreign objects, be sure to attach the protective cap after using the appliance.

Replacing

- Be sure to set the power switch to "0" when installing or removing the blade.

Removing the blade

- Support the head of the shaver with your fingers so that it does not swing excessively.

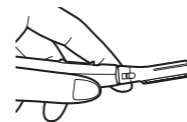

- Slide the blade release button in the direction of the arrow.

- It is easier to slide the blade release button by using your fingernail.

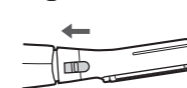

- Remove the blade toward the direction indicated by an arrow.

- Lift the resin section with your fingernail.

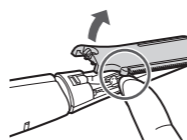

Attaching the blade

- Support the head of the shaver with your fingers so that it does not swing excessively.

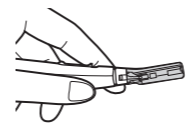

- Insert the hook at the end of the head into the hole on the blade to attach it.

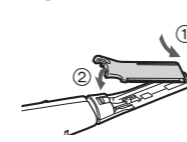

- Slide the blade release button in the direction of the arrow.

- It is easier to slide the blade release button by using your fingernail.

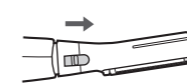

Cleaning

- This appliance cannot be washed with water. Clean it up with a dry cloth.
- Be sure to set the power switch to "0" before cleaning.
- Do not wipe the main body with alcohol, nail polish remover or detergent (hand cleansers) etc. Doing so may cause malfunction, cracking or discoloration of the parts. → Clean with a well-wrung cloth immersed in diluted soapy water.

- Remove the blade and clean it with a dry cloth.
 - It is not possible to disassemble the blade.
- Attach the blade. (See page 7.)

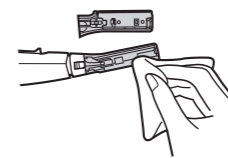

Troubleshooting

If the problems still cannot be solved, contact the store where you purchased the appliance or a service centre authorized by Panasonic for repair.

The appliance is not cutting as well as before.

- Replace the blade.
- Guidelines for replacement**
 - Approximately 1.5 years
- Replace with a new battery.
- Clean the hair dust.

The appliance is not working.

- Clean the hair dust.
- Make sure the battery is installed correctly.

Specifications

Power supply	Dry-cell battery
Battery type	One LR03 (AAA) alkaline battery • Sold separately
Airborne Acoustical Noise	69 (dB(A) re 1 pW)

This product is intended for household use only.

Disposal of Old Equipment

Only for European Union and countries with recycling systems



This symbol on the products, packaging, and/or accompanying documents means that used electrical and electronic products must not be mixed with general household waste.

For proper treatment, recovery and recycling of old products, please take them to applicable collection points in accordance with your national legislation.

By disposing of them correctly, you will help to save valuable resources and prevent any potential negative effects on human health and the environment.

For more information about collection and recycling, please contact your local authority.

Penalties may be applicable for incorrect disposal of this waste, in accordance with national legislation.

Authorized Representative in EU:

Panasonic Marketing Europe GmbH
Panasonic Testing Centre
Winsbergring 15, 22525 Hamburg, Germany

Importer:

Panasonic Marketing Europe GmbH
Hagenauer Strasse 43, 65203 Wiesbaden, Germany

Manufactured by:

Panasonic Corporation
1006, Oaza Kadoma, Kadoma City, Osaka, Japan