

NA-S5518B

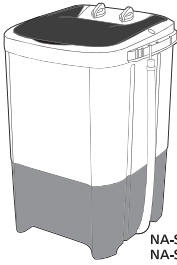

NA-S6518B, NA-S7018B,
NA-S8018B

Panasonic®

Operating Instructions Single Tub Washing Machine

Model No. NA-S8018B, NA-S7018B,
NA-S6518B, NA-S5518B

For Household Use

Special Features:

- 2-Way Superflow
- Rust-proof Body
- Rat-Proof Design
- Dolphin Wave Pulsator
- Durable Plastic Material
- Long pulsator rotation



Thank you for buying Panasonic Washing Machine.
Before operating this product, read the instructions carefully.
Keep this manual and the warranty certificate for future use.

Safety Precautions

The following explanations are provided for the items you should know to prevent personal injuries and property damages to the users and other people.

- WARNING** This sign warns of risk of death or serious injury.
- CAUTION** This sign warns of injury or damage to property.
- This pictogram indicates a "Restricted" type of act.
- This pictogram indicates a "Necessary" item to be performed.

WARNING

- This appliance is not intended for use by person (including children) with reduced physical, sensory or mental capabilities, or lack of experience and knowledge, unless they have been given supervision or instruction concerning use of the appliance by a person responsible for their safety.
Children should be supervised to ensure that they do not play with the appliance.
- Always lay down the drain hose while using the unit. ■ Always unplug the unit after usage.

CAUTION

- When any abnormality/failure occurs, stop using the product immediately and disconnect the power plug. (Risk of smoke/fire/electric shock)
- Water or foreign objects have accidentally entered the electrical parts of the washing machine. Burnt odor or abnormal noise is detected during operation. The supply cord is damaged or needs to be replaced.
Contact your nearest Panasonic Authorized Service Center (PASC) IMMEDIATELY.

- Do not place any lighted candle or any light source (lamp, lighted cigarette, etc.) on top, inside or near the unit. (These light source are fire hazard.)
- Do not allow water to come in contact with all electric parts. (You may risk electric shock.)
- Be careful in closing the lid. (Fingers might get caught at the hinge.) for NA-S6518B, NA-S7018B, NA-S8018B
- Do not use hot water over 50°C. (Plastic parts might be deformed.)
- Do not pull the plug by pulling the cord.

- Do not allow the cord to be pinched by the unit or by heavy objects.
- Do not expose the unit directly on sunlight to prevent fading of color and deformation of plastic parts.
- Do not attempt to repair or reconstruct the unit in case of trouble. (Refer first to section seven (7) of this manual or contact PASC for assistance.)
- Do not exert or apply too much force on wash timer.
- Do not pull the plug with wet hands.

Notice

INSTALLATION

CAUTION

- Do not place on carpets or rugs.
- Do not install on a weak or rough floor.
- Do not place your unit on direct sunlight, humid area like bathroom and places exposed to rain.
- Do not place unit near open flame.
- Place the unit on a level floor and a well-ventilated place.
- Please remove all packaging materials before using the washing machine.

USING A DRAIN HOSE

HOSE REROUTING (For NA-S6518B, NA-S7018B AND NA-S8018B ONLY)

The hose can be rerouted to the left or right side of the body, depending on the location of your house's drain hole. To do so, perform the following:

- 1 Unhook the Hose from the Hose Hanger and position the Hose as shown on Fig.1: Place a mat or any cloth on the floor before laying down the unit to protect it from scratches.
- 2 The default position of the Hose is at the right side of the body (with person facing front of the unit): To set the Hose at the left side.
 - a Untie the Hose and the Tie Wires from the base (Fig.1).
 - b Reroute the Hose to the left side. Hook each Tie Wire between two holes on the base. Wrap the Tie Wires around the hose once, then twist at least 3 times (Fig. 2).
 - c Hook the Hose to the Hose Hanger at your left side.
- 3 Return the unit to its upright position.

Fig.1

Fig.2

■ Hose arrangement (Fig.3)

- a Do not put the hose tip under the water.
- b Always lay down the drain hose flat on the ground.
- c The extension drain hose length should be 2m or less.

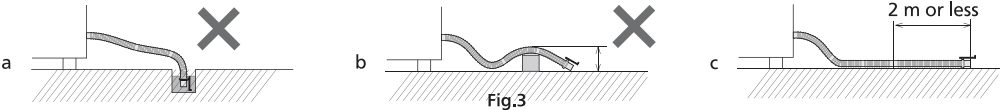

Note: After unpacking the unit and laying down the Hose, some water used in quality assurance testing may come out of the Hose.

Parts Identification

FOR USAGE OF LESS THAN 3 MINUTES



WASH TIMER

Turn Wash Timer to halfway before setting it to desired washing or rinsing time. To turn off the unit in washing or rinsing operation, turn counter clockwise to OFF position until it clicks

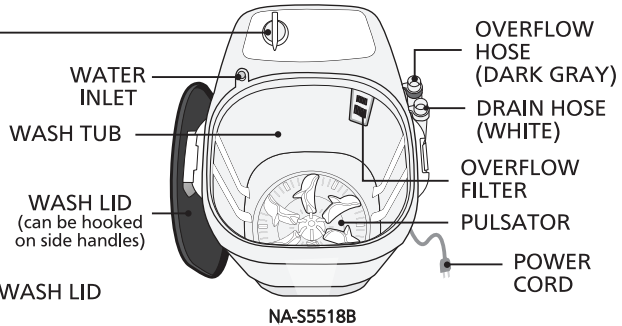

NA-S5518B

OVERFLOW FILTER

DRAIN HOSE

WASH TUB

WATER INLET

POWER CORD

PULSATOR

NA-S6518B, NA-S7018B,
NA-S8018B

NA-S6518B, NA-S7018B, NA-S8018B



CYCLE SELECTOR

WASH / RINSE
For washing
or rinsing

DRAIN
For draining
water

Washing Tips

Preparations before
Washing











Washing

Rinsing

This process is recommended to fully utilize the features of your Washing Machine. You can innovate the Washing Process depending on your washing style and preference.

● SUPPLEMENTARY TABLES FOR GENERAL OPERATION

Table 1: Washing Capacity Guide

Laundry Type											
Approx. Weight (Dry Weight)	50 g	50 g	90 g	150 g	200 g	300 g	500 g	500 g	500 g	800 g	800 g

Note: Washing capacity will change depending on clothes type, size, thickness, material, etc.

Table 2: Recommended Wash Timer Settings.

FULL LOAD	MATERIAL	WASHING TIME
	Synthetic, Rayon, Thin Wool, Synthetic (Thick)	1-2 min
	Cotton, Linen (Thin)	4-7 min
	Cotton, Linen (Thick)	7-8 min
	Thick and Heavily Soiled Cotton, Linen or Over-alls	15 min Wash

● PREPARATIONS BEFORE WASHING

- Remove loose objects from pockets.
- Mend clothes with worn-out patches & other damages.
- Wash sturdy clothes reversely.
- Sort fabrics according to type.
 - a. Separate white clothes from colored clothes.
 - b. Wash dyed or oiled clothes separately.
- Check washing instructions attached to the clothes.

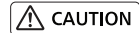
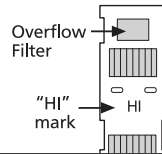

To prevent water splashing out of the Tub, please use water level approximately halfway between the "HI" level and Tub bottom, if you will wash a load at half of the rated capacity or lower.

General Operation

● WASHING

- ALWAYS CLOSE THE WASH LID TO AVOID SPLASHING OF WATER
- Always lay down the Drain hose (for NA-S6518B, NA-S7018B, NA-S8018B) or Overflow hose (for NA-S5518B) while using the unit

- ① **For NA-S5518B**
Unhook **OVERFLOW HOSE** (Gray) from the Hose Hanger. Leave it that way while using the Washing Machine.

For NA-S6518B, NA-S7018B, NA-S8018B
Unhook **DRAIN HOSE** & set **CYCLE SELECTOR** to **WASH/RINSE**

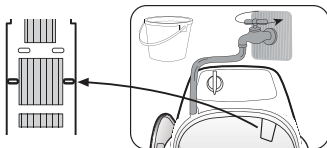

- ② **NA-S5518B:**
Insert water hose to inlet or prepare a pail to fill wash tub with water halfway between pulsator and "O" water level mark.



- **NA-S6518B, NA-S7018B & NA-S8018B:**
Insert water hose to inlet or prepare a pail to fill wash tub with water halfway between pulsator and "HI" water level mark.



- ③ Put detergent depending on the water volume and detergent package indications.

HI	NA-S5518B	49 L	
HI	NA-S6518B	64 L	
HI	NA-S7018B	63 L	
	NA-S8018B	62 L	

- ④ Set the **WASH** knob approximately 1 minute to dissolve the detergent.



- ⑤ Put clothes one by one in the wash tub and push it towards the bottom. Continue adding water up to appropriate level. (Gradually add water to achieve a faster clothes turning rate. Refer to item no. 2 for maximum water level according to model.)



- ⑥ Set **WASH TIMER** to appropriate setting. (Please refer to Table 2)



- If you will not use the water in the wash tub for further loads, set the **CYCLE SELECTOR** (for NA-S6518B, NA-S7018B, NA-S8018B) to drain or drain it by laying down the **DRAIN HOSE** (for NA-S5518B)

○ RINSING

ALWAYS CLOSE THE WASH LID TO AVOID SPLASHING OF WATER.

- ① Hook DRAIN HOSE to the hose hanger.
(NA-S5518B)

Set CYCLE SELECTOR to WASH/RINSE.
(NA-S6518B, NA-S7018B, NA-S8018B)



- ③ Set Wash Timer to 3-5 mins.

- ② Turn on faucet or use pail to fill Wash Tub with water up to appropriate level.

- ④ After Wash Timer returns to "OFF", set Cycle Selector to drain by laying down the Drain hose (for NA-S5518B).



Cleaning Guide

⚠ Always unplug the unit before performing cleaning maintenance

When Cleaning External Surfaces

- ❌ Do not splash water on the control panel.
- ❌ Do not use brushes, petroleum-based chemicals, polishing powders, rubbing compound, cleansers, thinner, benzene, alcohol and other hazardous chemicals
- ❗ Use a soft, dry cloth.
- ❗ For very dirty surfaces, use only a soft cloth dipped in a mild soap and water solution.

To Clean the Pulsator

- ① Use a screw driver to loosen the screw.
(Do not loosen all the way).
- ② Lift the Pulsator by pulling the screw.
- ③ Remove the lint and splash with water.

To Clean the Overflow Filter

- ① For NA-S5518B: Pinch one side of the Overflow Filter then pull; For NA-S6518B, NA-S7018B & NA-S8018B: Pull the Overflow Filter. (Fig.3)
- ② Remove lint and splash with water.

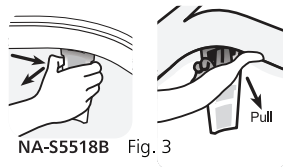

NA-S5518B Fig. 3

- ❗ For better washing results, you are advised to clean the Overflow Filter, Lint Filter and Pulsator every after using the product.

- ③ Remount the Overflow Filter (Be sure that the bottom hook is secured to the tub.)

Before Calling for Service

CHECK THE FOLLOWING CONDITIONS BEFORE CALLING FOR REPAIR OR SERVICE. IF MALFUNCTION PERSISTS, PLEASE CONTACT YOUR NEAREST PANASONIC AUTHORIZED SERVICE CENTER (PASC).

○ CONDITION 1 Unit is not operating.

- ❗ Power Plug is not completely inserted.
 - ▶ Connect Power Plug properly.
- ❗ Wash Timer is not turned ON.
 - ▶ Adjust Timer to desired setting.

○ CONDITION 2 Long draining time

- ❗ Drain Hose is twisted
 - ▶ Untwist Drain Hose by hand.
- ❗ Clogged drain hole
 - ▶ Remove pulsator and check if lint or other objects block the Tub Drain Hole.

○ CONDITION 3 Noisy wash operation

Note: Normal washing operation creates noise due to rotation. However if there are unusual noise:

- ❗ Foreign objects are trapped between Tub and Pulsator
 - ▶ Use screw driver to loosen the screw (Do not loosen all the way)
 - ▶ Lift Pulsator by pulling the screw.
 - ▶ Remove trapped foreign objects.
 - ▶ Remount the Pulsator then tighten the screw.
 - ▶ When turning the screw, be sure not to damage the screw head.

Product Specification

	NA-S5518B	NA-S6518B	NA-S7018B	NA-S8018B
Power Supply	230V a.c., 60Hz	230V a.c., 60Hz	230V a.c., 60Hz	230V a.c., 60Hz
Washing Capacity (Dry Weight)	5.5 kg	6.5 kg	7.0 kg	8.0 kg
Motor Input	255 W	280 W	305 W	295 W
Drive System	Direct Drive	Gear Drive	Gear Drive	Gear Drive
Net Weight	10.7 kg	14.4 kg	14.4 kg	14.4 kg
Dimensions (W x D x H)	483x537x922mm	550x546x861mm	550x546x861mm	550x546x861mm
Recommended Diameter of Water Supply Hose	16 mm or 5/8 inch maximum outside diameter	19 mm or 3/4 inch maximum outside diameter	19 mm or 3/4 inch maximum outside diameter	19 mm or 3/4 inch maximum outside diameter
Maximum Water Inlet Pressure	275 kPa	275 kPa	275 kPa	275 kPa

Note: Specifications are subject to change for improvement without notice.

Panasonic Manufacturing Philippines Corporation
Ortigas Avenue Extension, Taytay Rizal, Philippines
Website: www.panasonic.com/ph

© Panasonic Manufacturing Philippines Corporation 2018

S0818MB3224
PW9901-ONU30
Printed in the Philippines