

Panasonic®

Operating Instructions Twin-Tub Washing Machine

For Household Use

Model No. NA-W12521B
 NA-W14021B
 NA-W16021B

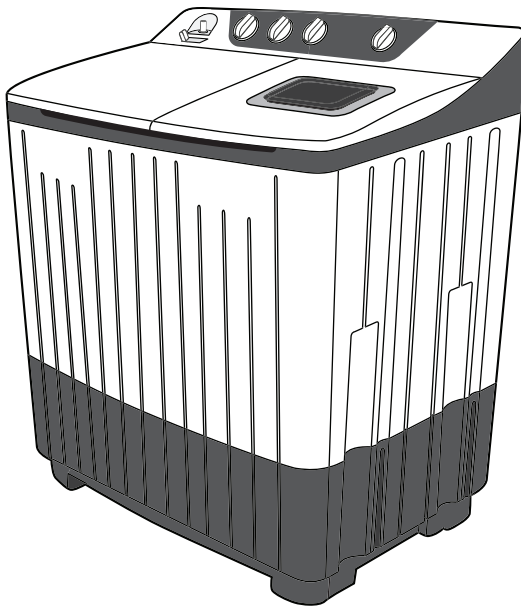

Contents

Safety Precautions	1
Part Names	2
Installation	3
Operation Panel	4
Washing	5
Soaking	6
Rinsing	7
Spinning	8
Maintenance	9
Troubleshooting	10
Requests and things to abide by	11
Technical Specifications	12

Thank you for buying
Panasonic Washing Machine

- Read these instructions carefully for optimum performance and safety before use.
- Keep this manual for future reference.



1 Safety Precautions

Read and follow these safety precautions.



WARNING

Never do the following to the power plug and cord

(To prevent fire or electric shock)

- Do not plug in or unplug the power cord with wet hands.
- Do not hold or pull on the cord when removing the plug from the socket.
- Do not use a power cord or plug that is damaged. If the power cord is damaged, it must be replaced by the manufacturer, its service agent or a similarly qualified person to avoid a hazard.

Do not allow children to use on their own

- This appliance is not intended for use by persons (including children) with reduced physical, sensory or mental capabilities, or lack of experience and knowledge, unless they have been given supervision or instruction concerning the use of the appliance by a person responsible for their safety,
- Children should be supervised to ensure that they do not play with the appliance.

Observe the following about the power plug and cord

(To prevent fire or electric shock)

- Use a socket that satisfies the rating requirement solely for this appliance. Do not use a plug adaptor or extension cord.
- Always fully insert the power plug into the socket.
- Wipe the power plug periodically with a dry cloth. (Accumulated dust collects moisture, which may cause insulation failure, resulting in fire.)
- Unplug the power cord before cleaning.



CAUTION

Do not wash, rinse, or spin waterproof sheets or clothes.

(To prevent injury, damage to the main unit, walls, floor or laundry, or water leakage if the appliance falls over or oscillates extremely while spinning)

- Raincoats, wet suits, etc.

Observe the following

- Be careful not to get your fingers caught when opening and closing the lid.
- Do not insert your hands or feet under the main unit. (To prevent injury by rotating parts.)
- Do not climb or put heavy objects on the appliance. (To prevent deformation and breakage resulting in injury.)
- If the lid is broken, immediately stop using the appliance.



May cause serious injury or death.

Keep away from fire.

Do not put flammable materials or clothes with such things attached in the tub.

Keep them away from the appliance.

(To prevent explosion or fire)

- For example: Kerosene, gasoline, benzine/thinner, alcohol, etc.

Never disassemble, repair or modify the appliance yourself.

- In case of malfunction or failure, immediately stop use, unplug the power cord, and ask your nearest service center for repair.

Do not touch the spinner tub until it completely stops.

(To prevent injury)

- If the spinner tub does not stop within 15 seconds when the spinner lid is opened during spin process, unplug the appliance immediately and call the Panasonic Service Care Center.



May cause injury or property damage.

(To prevent deformation and breakage resulting to injury)

- Do not connect to the hot water supply.
- Do not directly pour hot water of 50°C or higher into the tub.
- Do not obstruct the openings of the bottom face with carpet, etc.

For maintenance and service..

Panasonic Customer Care Center:

Globe/TM users: Panasonic<space>message to 21584703 (SMS only)
Smart/Sun/Talk N' Text users: Panasonic<space>message to 225654703 (SMS only)

Email Address: pmpc_csdclc@ph.panasonic.com

Contact Number: (02) 8706-7603;
PLDT Toll Free: 1800-10-7262782 (PANA-SVC)
Globe Toll Free: 1800-8-2934357 (WeHelp)
Fax: (02) 8706-7612;
Website: <http://www.panasonic.com/ph>

2 Part Names

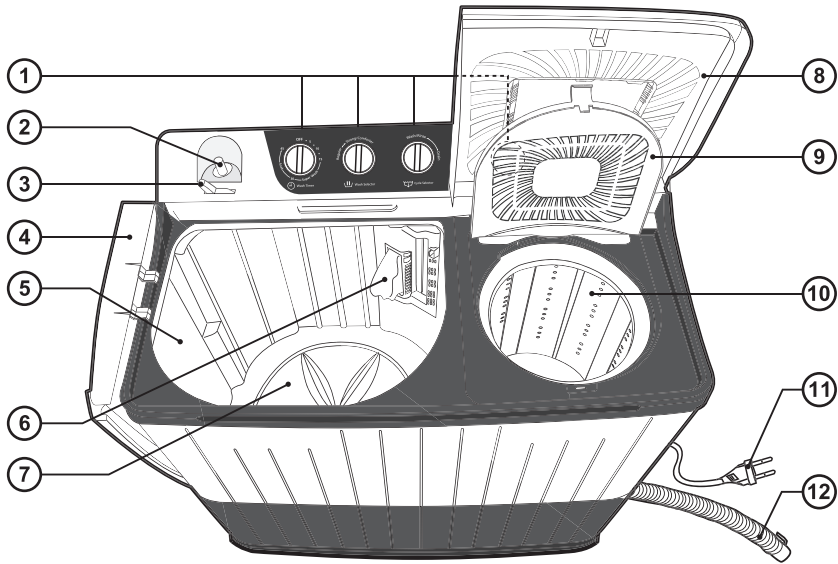

1. Control Panel of Washing Machine, Spinner Tub.

2. Inlet Hose Connector

3. Water Supply Selector
(NA-W14021B and NA-W16021B only)

4. Wash Tub Lid

5. Wash Tub

6. Lint Filter

7. Pulsator

8. Spinner Lid (Super Air Dry)

9. Inner Lid

10. Spinner Tub

11. Power Cord

12. Drain Hose

Accessories:

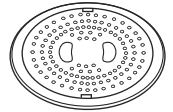

Spinner Cap
(To prevent clothes from springing out)

3 Installation

■ If the installation, test run or inspection of the Washing Machine are not followed as stated in this installation instruction, Panasonic will not be liable for any accident or damages.

Installing this Washing Machine should be settled in a well-ventilated and safe place where you can connect the drain hose and the power supply. It is recommended to place the Washing Machine on a level floor and avoid a place where it can be exposed to direct sunlight.

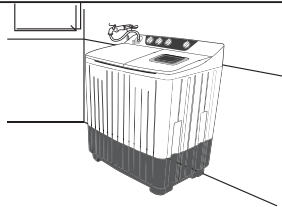

Insert the power plug firmly into the power outlet.

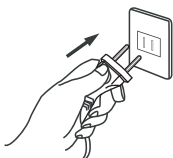

The inlet hose connector, which supply the water into the Washing Tub and Spin Tub can be adjusted.

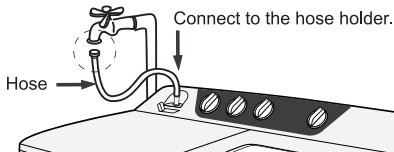

Connect hose to a water tap by pushing it until the water tap reach the innermost part of the inlet hose end. Adjust it to a correct and firm position.

Pull out the drain hose from the washer. When using the unit for the first time, you may find water remaining in the drain hose. It was used for the factory performance test. It does not imply any malfunction.

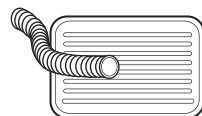

4 Operation Panel

Wash Timer: Use this timer to set washing/rinsing time up to 15 min.

Soak Timer: Soak/Wash mode timing at 15-45 min.



(If you want to set the timer to 2 min. or less, turn the control beyond the 5 min. position and then turn it back to the desired setting.)

The operation panel for NA-W14021B is used in this manual.

Wash Selector (NA-W14021B and NA-W16021B only)

This selector is to set for washing:
- Regular
- Strong/Comforter

Note: Make sure the selector is positioned correctly to the setting to work properly.

Spin Timer

This selector is to turn to your desired length of time for spin-dry laundry by using 5 min. (If you want to set the timer to 2 min. or less, turn the selector beyond the 5 min. position, and then turn it back to the desired position.)

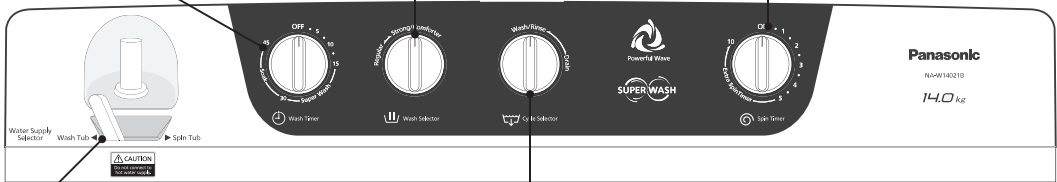

Water Supply Selector (NA-W14021B and NA-W16021B only)

Water Supply Selector to water inlet.
- Wash Tub (LEFT)
- Spin Tub (RIGHT)

Cycle Selector

This selector is to set for wash/rinse or drain the water from the wash tub.
- Wash/Rinse for washing & rinsing
- Drain for draining the water from the wash tub.

Feeding Caution Label

- Do not connect to the hot water supply.
- When the water spills out of the hole under the label, it means too much water has supplied. Close the water tap and adjust the level.

WARNING

- Be careful if the water spills out on the control panel
- Do not place any wet clothes on the control panel
- Do not use any chemicals or thinner to wipe the machine

5 Washing

1. Set the Cycle Selector to "Wash/Rinse"
2. Fill the Wash Tub with water up to the MEDIUM water level line.
3. Put the clothes in the Wash Tub. Do not put excessive amount of laundry, which is specified in Table 1 and 2.
4. Put recommended detergent mentioned in Table 3.
5. Set the Wash Selector to "Regular" or "Strong/Comforter". (Wash Selector is set upon the kind of clothes and the level of stained laundry.) (For NA-W14021B and NA-W16021B only)
6. When washing is completed, drain off the water by adjusting the Cycle Selector to "Drain".
7. After the water is discharged, turn the Cycle Selector switch to Wash/Rinse position.
8. Fill the Wash Tub with water based on Table 1
9. Set Wash Timer to 5 min. or 7 min. position to rinse.
10. When you finish washing, drain off the water from the tub by turning Cycle Selector to "Drain" position.

When using "Pre Wash" Detergent

Please use "Pre-Wash" Detergent inside the Washing Machine as shown in **Figure 1** and not outside of the Washing Machine as shown in **Figure 2**.

Using some type of "Pre-Wash" Detergent outside the Washing Machine may cause damage on the plastic part.

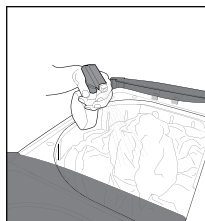

Fig. 1
Recommended

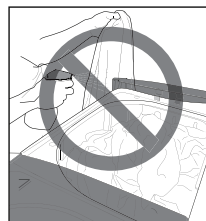

Fig. 2
Not-Recommended

Laundry Preparation and Check

For clothes easily losing color Wash Separately.

Pre Laundry check

To prevent damages to clothes, malfunction and drainage failure

- Remove coins, pins, paper clips, nails, etc.
- Fasten buttons and close zippers.
- Do not wash items (such as paper diapers) other than laundry.
- Reverse clothes likely to peel.
- Use a brush to remove pet and human hair, sand, etc.
- Tie strings, etc.

For delicate underwear only

Use laundry nets.

- Underwire brassieres
 - Lacy clothes, lingerie and stockings
- When using a net
- Do not overpack.
 - Put the zipper's slider into the cover.
(To prevent damage to clothes and the main unit)

Table 1: Washing Capacity Guide

Water Level	Minimum 61 L 4 kg		Low 74 L 7 kg		Medium 82 L 10 kg		High 90 L 12-13 kg		Maximum 90 L 14 kg	
Laundry Type	Pajamas (up,down)	T-shirt	Bath Towels	Children Wear	Apron	Sheets	Socks	Underwear	Handkerchief	Pants (Denims)
Fabric Type	Cotton	Cotton	Cotton	All Types	Synthetic Fiber	Cotton	Cotton	Cotton	Cotton	All Types
Approx. Weight / Piece (Dry Weight)	500 g	200 g	500 g	200 g	100 g	500 g	50 g	150 g	50 g	1000 g

Note: Washing capacity will change depending on clothes type, size, thickness, material, etc.

Table 2: The amount of the laundry and setting control panel

Amount of Laundry	Clothes		Synthetic Fiber	Cotton	Heavy Stained Clothes
	System				
Less than 1.2 kg	Washing Time		2 min.	2 - 5 min.	7 - 10 min.
	Regular and Strong/Comforter		Regular	Regular	Strong/Comforter
1.2 kg and Above	Washing Time		2 - 5 min.	7 - 10 min.	Soak 30 min. Wash 15 min.
	Regular and Strong/Comforter		Regular	Regular	Strong/Comforter

Table 3: Normal Water Volume & Detergent

Water Level	NA-W12521B	NA-W14021B	NA-W16021B	Detergent Quantity
	High (94 L) Medium (84 L) Low (74 L) Minimum (58 L)	High (110 L) Medium (98 L) Low (86 L) Minimum (67 L)	High (110 L) Medium (98 L) Low (86 L) Minimum (67 L)	Detergent Quantity use according to the amount specified on the detergent package.
	Note: Water Only	Note: Water Only	Note: Water Only	

Note

Water level may be less than the water level line while washing, if so refill the water. Be careful not to exceed the MAXIMUM water level line; it may cause the water to spill out from the tub.

6 Soaking

How the Soak Function operates

Soak Function

- Soak Function enhances the efficiency of the regular function, which helps to wash the clothes cleaner.
- Soak function will be operated after the Wash Timer is set to 45 min. position, then the washer will operate.
- Soak Function will run and stop alternately for 3 times until 15 min. then the operation will return to regular function.
- To set the time for regular or soak functions, turn the switch to your desired period of time.

Characteristics of Soak Function

1. Maximize the efficiency of the detergent. It allows the detergent to penetrate into the fabric easily.
2. Soaking the water beforehand can help to clean out the stains and smell.
3. Do not use a brush otherwise it will damage the clothes.
4. Caring and preserving the fabric for extended life.

7 Rinsing

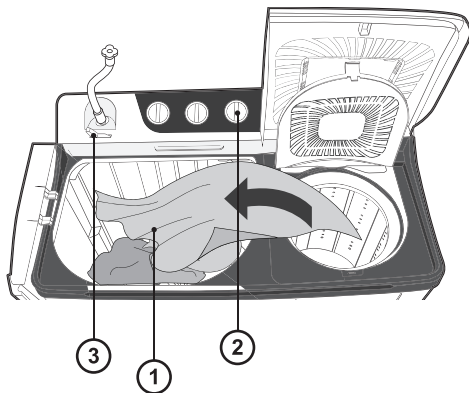
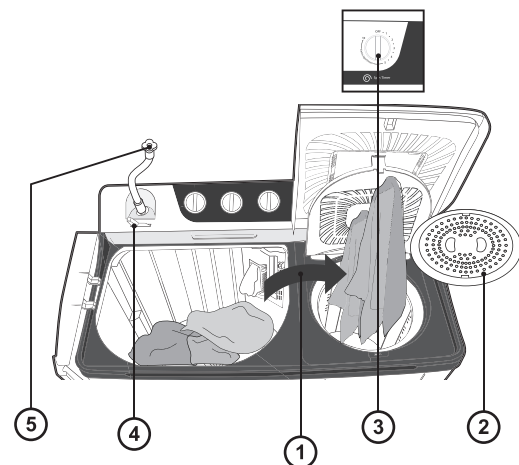

Midterm Spinning

1. After the wash process ends, put the washed clothes into the spin tub.
2. Place the spinner cap in the tub and close the spinner lid. (See "Spinning" for details about the spinner cap)
3. Set the spinning time to 2-3 min. by turning the spin timer.

■ To perform "Foam removing by Spinning" After Step 3, Spinning with water supply can be operated to dilute detergent, so that rinsing time and water will be saved. (Do not perform this step to avoid stained clothes if water is contaminated with reddish rust or so.)
(For NA-W14021B & NA-W16021B only)

4. Set the water supply selector to the spin tub then turn on the water faucet and supply water for about 1 min.
(For NA-W14021B & NA-W16021B only)
5. Turn off the water faucet and operate spinning for 2-3 min.
(For NA-W14021B & NA-W16021B only)

Rinsing

1. After the midterm spinning process ends, put the clothes back to the wash tub.
2. Set the cycle selector to "Wash/Rinse".
3. Set the water supply selector to the wash tub.
(For NA-W14021B & NA-W16021B only)
4. Select the way of Rinsing, "Rinse with water saving" or "Rinse with water supplying".

■ Rinse with water saving

1. Fill the wash tub with water up to the water level depending on the laundry amount, and then turn off the water faucet.
2. Set the wash time to 2-3 min. by turning Wash Timer for rinsing.
3. After draining water, perform 2nd rinsing in the same way with the steps 1-3 shown above.

■ Rinse with water supplying

1. Fill the wash tub with water up to the water level depending on the laundry amount.
2. Set the time to 5 min. or 7 min. by turning Wash Timer for rinsing.

Note

- Keep the state of water supply.
- Make sure to close the lid of Wash Tub. If not, filled water may splash out from the tub when water supply is too much.

8 Spinning

Spinning

- Put the laundry into the spinner tub by putting the small-sized laundry in the bottom area to keep the balance of the tub.
- Place the spinner cap in the tub as shown in the below figures.
- Close the Inner lid and Spinner lid firmly.
- Set the spinning time to 1-5 min. (See attached table 4)

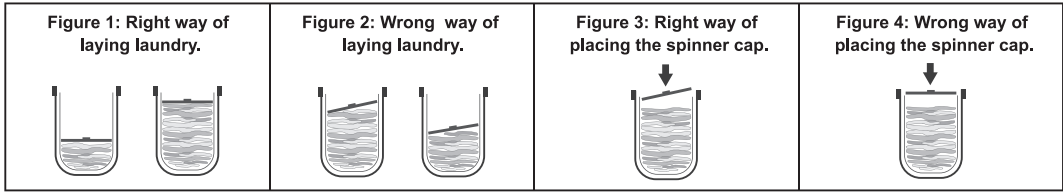

Hints for Spinning

- If there is a sound from the spinner, open the spinner lid then try to lay the laundry evenly (Figure 1)
- If the Spinner Lid is opened while the spinning function is working, the machine will stop within 2-14 seconds.
- If it is still running, contact the service center.
- If the Spinner Lid is not closed, the machine will not work even if the timing is set.

Spinner Cap Installation

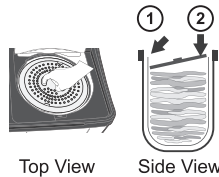

- Place the Spinner Cap as shown in the picture.
1. Enter Spinner Cap
 2. Push Down

Table 4: Setting time for Spinning upon Laundry

Max. Capacity: 10 kg

Type of Laundry	Spinning Time
Working Clothes	5 min.
Thin synthetic fiber and waving cloth (Delicate Clothes)	1 min.
Synthetic Fiber (Sweater)	1-2 min.
Knitting Clothes/Underwear	3-5 min.
Bath towel, etc. (Bed Sheet)	5 min.

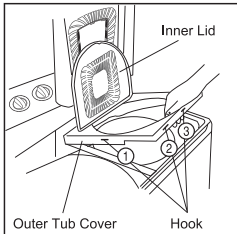

In case of the laundry falling from the Spinner Tub

- Remove the power plug from the power outlet.
- Open the inner lid and outer tub cover by ① ② ③ lock respectively and pick up the laundry.
- When placing back the outer tub cover, be sure to push it firmly until the front hook is engaged securely.

Final Step

Empty the Spinner Tub, then turn the cycle selector switch to drain and discharge the washing water and switch to Wash / Rinse. Then remove the power plug from the power outlet.

9 Maintenance

Be sure to remove the power plug from the power outlet before cleaning the machine and lint filter.

The laundry or button is stuck into the pulsator.

If the buttons, coins or the like is stuck in the gap between wash tub and pulsator and cannot be removed, contact your nearest service center.

How to clean the Lint Filter

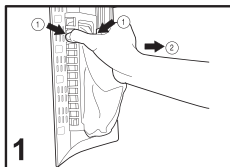

Pull out the lint filter from the lock. By using fingers to press and pull out at the upper part of the Lint Filter.

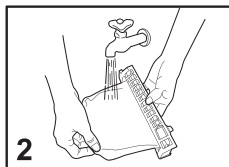

Rinse the dirt from the filter with water.

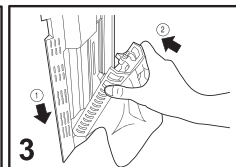

Set it back to the original position.

- Insert the bottom first as shown in the figure.
- Press down and lock

10 Troubleshooting

If any abnormality is found, check the following before calling the service center:

1. Is the power plug inserted firmly or power cord disconnected?
2. Is the timer switch turned to "off" position?
3. Is the Spinner Lid closed properly?
4. Is there any laundry fallen out from the Spinner Tub?

NOTE: If all the above points have been checked and no abnormality is found but the machine is still working improperly, Please contact the Service Center.

11 Requests and things to abide by

If the spinner tub does not stop after 15 seconds from the time you lifted the Spinner Lid, immediately stop use of the machine and call a Panasonic Customer Care Center. Do not use too much detergent. (The rinse will be insufficient)

Please do not use a cover made of polyvinyl chloride on the machine, as it can damage the plastic part and the surface paint.

- If you intend to use the such cover, first place a piece of cloth over the machine to keep it from coming in contact with the cover.

If the amount of water is too much (the water pressure being too high), tighten the tap.

- This could cause the inlet hose to come off, or water to leak from the tap.

Do not use sprays on the cover or the machine parts

- Bug poison, hair spray, air freshener, etc. can cause breakdown and also crack the plastic of the machine.

Do not allow the machine to gather condensation on the floor.

- When the air temperature is high and the water temperature is low, condensation sometimes runs off into the floor.

Do not wash or spin any clothes, materials or sheets that are watertight.

Example: Raincoats, fishing jackets and trousers, ski-wear, etc.

- There is the possibility of such articles of fabric coming out of the spinner tub during the spin-dry, which can damage the clothes and/or the washing machine.

12 Technical Specifications

	NA-W12521B	NA-W14021B	NA-W16021B
Rated voltage	230 V ~		
Rated frequency	60 Hz		
Rated power consumption	Wash: 500 W, Spin: 235 W	Wash: 590 W, Spin: 235 W	Wash: 635 W, Spin: 235 W
Standard Wash Capacity (Dry Weight)	12.5 kg	14 kg	16 kg
Standard Spin-Dry Capacity (Dry Weight)	10 kg	10 kg	10 kg
Standard water amount	80 L	92 L	88 L
Product dimensions	880 mm × 540 mm × 1057 mm	950 mm (W) × 540 mm (D) × 1057 mm (H)	
Product weight	36 kg	41 kg	
Maximum Water Inlet Pressure	275 kPa		

Panasonic Manufacturing Philippines Corporation
Laguna Technopark, Sta. Rosa, Laguna, Philippines
<http://www.panasonic.com/ph>