



Operating Instructions 2-Door Refrigerator-Freezer (For Household Use)

NR-BP200VS



Features

ECONAVI

INVERTER



Contents

- Safety precautions
- Installation
- Parts Identification
- General Operation
- Usage and Customization
- Maintenance
- Special Features
- Specifications

■ NON-CFC

This unit uses totally NON-CFC MATERIALS (Restriction of Hazardous Substances) These both for refrigerant (R600a) and for insulation are regulations that set maximum concentration (Cyclo-Pentane). This refrigerator does not damage the Earth's ozone layer.

■ RoHS Compliant Product

are regulations that set maximum concentration limits on hazardous substances in materials used in electronic equipment.

Thank you for purchasing the Panasonic Refrigerator.

- Before using this product, please read these instructions carefully and follow safety precautions.
- Please make sure to sign up and register your product in our Customer Service Portal and save this manual for future use.

Specifications

Model No.		2-DR REFRIGERATOR - FREEZER NR-BP200VS
Capacity (liters) Volume (PNS IEC 62552-3:2016)	Total	200
	Freezer	53
	Refrigerator	147
Net Weight (kg)		39 kg
Outside Dimensions Width x Depth x Height (mm)		545 x 560 x 1425
Refrigerant Type		R600a
Rated Voltage (V), Rated Frequency (Hz)		230 V~, 60 Hz
Cooling System		Non-Frost Cooling
Defrosting System		Automatic
Color		Inox

Imported by:
Panasonic Manufacturing Philippines Corporation
© Panasonic Manufacturing Philippines Corporation 2026

Printed in P.R.C.

Safety Precautions

⚠ WARNING

This sign warns of risk of death or serious injury.

⚠ CAUTION

This sign warns of injury or damage to property.

⚠ This symbol means required actions.

⊘ This symbol means prohibited actions.

⊘ This symbol means do not disassemble.

⚠ WARNING

This appliance is not intended for use by persons (including children) with reduced physical, sensory or mental capabilities, or lack of experience and knowledge, unless they have been given supervision or instruction concerning use of the appliance by a person responsible for their safety. Children should be supervised to ensure that they do not play with the appliance.

For plug and cord..

- ⚠ Unplug the unit when cleaning the refrigerator.
- Properly plug the unit into a wall outlet with its required voltage.
- Connect the unit to an exclusive wall outlet that is for the refrigerator only.
- Avoid connecting other appliances to the same wall outlet.
- Periodically wipe the dust on the power plug.
- If the power supply cord is damaged, it must be replaced by the manufacturer, its authorized service centers, or similarly qualified persons in order to avoid hazard.
- If you detect burning smell, unplug the unit and ventilate the area.
- Please ensure minimum clearance of 10 cm between back of refrigerator and wall for air ventilation and to prevent damage to the power supply cord.
- When abnormality or failure occurs, stop using the product immediately and unplug the unit.
- Abnormality and failure example: (Risk of smoke / fire / electric shock)
 - Power cord or plug is abnormally hot
 - There is burning smell
 - Power cord is deeply cut or deformed
 - You can feel tingling electricity

For connection..

- ⚠ Plug your refrigerator into an exclusive wall outlet of 230 V~, 10 A or more.
- ⊘ Do not plug your refrigerator to an octopus connection.
- ⊘ Do not plug your refrigerator to any loose outlet. Power cord may deteriorate and may cause fire.

When installing the refrigerator..

- ⊘ Do not install the product in locations exposed to water.
- Do not block the ventilation port of refrigerator.
- Leaked refrigerant may cause fire and explosion.

When using..

- ⊘ Do not let any children hang or ride on the refrigerator door, the unit may turn over and cause an accident.
- Do not touch the compressor or pipes because of high temperature. There is a risk of burn injury.
- Do not spray combustible chemicals near the refrigerator. Do not damage the refrigerant circuit (piping on the back). The flammable refrigerant may catch fire and lead to an explosion.

When moving or transporting the refrigerator..

- ⊘ Do not transport the refrigerator in a horizontal position. Laying the refrigerator horizontally may damage the piping. If any damage is noticed, do not operate the refrigerator, avoid using fire and ventilate the room.
- Make sure that the door is facing up to avoid accidental opening of doors when lifting.
- ⚠ It is recommended to lift it or use rag underneath the unit to avoid it from scratching the floor.

If you will not use the refrigerator for a long period of time..

- ⚠ Unplug the refrigerator and take out all the food from the refrigerator and freezer compartment.
- Wipe off all the water and open the refrigerator to keep it dry.
- Prevent children from entering the refrigerator.

When opening or closing the doors..

- ⊘ Do not place items that are bigger than the tray or shelf, the door will not close completely causing cold air to leak out of the refrigerator.
- Do not open the refrigerator frequently or leave it open for a long time to prevent water dripping inside and to prevent wasting energy.
- ⚠ Mind the gap between the door seal (Gasket). It must be completely closed to the cabinet body.

When storing food..

- ⊘ Do not block the cold air outlet on top of the Cold Air Control. If cold air does not spread inside the case it will not be sufficiently cooled, blocking items may encounter freezing.
- Do not freeze glass bottles, that there are risk of injury. (If liquid in a glass bottle is frozen, the bottle will break and may cause injury.)
- Do not overload. Maintain proper spacing of food for good air circulation.
- Do not place warm/hot food inside the refrigerator.
- Allow hot food to cool down before placing inside the refrigerator.

In case of emergency..

- ⚠ Risk of Fire / Flammable Materials
- Maintenance work must only be carried out by well-trained maintenance worker.
- ⊘ Do not store explosive substances such as aerosol cans with a flammable propellant and chemicals or scientific specimens in the appliance.
- Do not use electrical appliances such as Ion deodorizer/ Humidifier in the refrigerator. Leaked refrigerant may catch fire from a spark of the electrical contacts and may cause an explosion.
- Do not use electrical appliances inside the food storage compartments of the appliance, unless they are the type recommended by manufacturer.
- ⊘ Do not disassemble, repair or modify the refrigerator by yourself. If you want to repair the refrigerator, please consult Panasonic Customer Care Center.
- Do not use mechanical devices or other means to accelerate the defrosting process, other than those recommended by the manufacturer.

When recycling the product..

- ⚠ Before taking the refrigerator to be recycled, please remove all the door gasket to prevent locking a child inside it.
- The operating instructions should be handed over to any person who would use or handle the refrigerator whenever the refrigerator would be transferred to another location or delivered to a recycling plant.
- Cyclo-Pentane is used for insulation of this refrigerator and flammable gas is used for the refrigerant.
- When disposing off this unit, please dispose it by the proper method, do not burn the unit.

- ⚠ If you detect a burning smell, disconnect the power plug to stop the operation of the unit.
- If you detect a gas leak from the cooling circuit, ventilate the kitchen.
- If you damaged the cooling circuit (piping at the back), ventilate the kitchen and contact your nearest Panasonic Authorized Service Center.
- Refrigerator LED Lamp.
The refrigerator LED lamp is designed specially for this product. If replacement is required, contact the Panasonic Care Center Hotline.

- ⚠ Do not subject glass trays to high impact. (it may break and cause injury.)
- Food containers must reach the bottom of the door shelves.
- Food must not protrude from every shelf.
- Store fruits and vegetables inside the Crisper Case.
- Trapped moisture helps preserve the freshness of food for longer period.
- Water and beverages should be sealed to prevent odor contamination.
- Vegetables, fruits and fresh foods should be wrapped or packed in a container before freezing or refrigerating.
- Put foods such as meat or fish in the freezer compartment if you want to store it for a long time.
- Cover juicy food with tight lid containers, plastic film or foil.

When cleaning..

- ⊘ Do not clean the refrigerator with chemical substance or liquid. It will cause damage and corrosion to the metal surface.
- Do not place your hands or feet beneath the refrigerator.
- Clean the defrost pan located at back of the unit every three (3) months to prevent odor and growth of unwanted organisms.

Caution..

- ⚠ If the crisper glass accidentally breaks, please observe necessary precautions to avoid injuries.
- If the unit does not run, unplug the unit to reset the PCB program.
- Wait for at least ten (10) minutes before plugging to continue its operation.

For maintenance and service..

Panasonic Customer Care Center:
SMS (Text only): TYPE Panasonic<space>message and send to 21584703 (Globe/MTM)
Contact Number: (02) 8-706-7603; Fax: (02) 8-706-7612
Toll Free: 1800-10-7262782 (PLDT), 1800-82-934357 (Globe)
Email: pmpc_csdic@ph.panasonic.com
Website: http://www.panasonic.com/ph

Installation



- 1 Remove the bottom pad including all tapes and styrofoams attached inside and outside of the refrigerator.

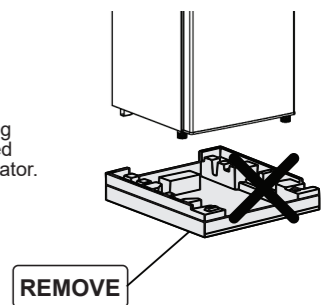

- 2 Level the refrigerator by adjusting the leg shell to stabilize the unit to the ground.

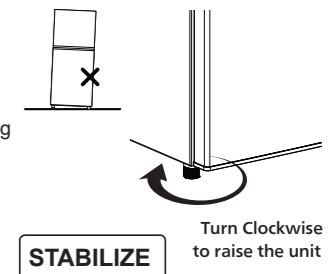

- 3 Provide adequate space between your unit and the wall for heat dissipation and door opening clearance.

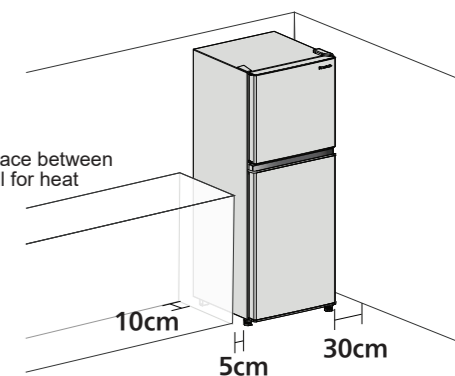

- 4 AFTER INSTALLATION, WAIT 3 HOURS BEFORE PLUGGING TO OUTLET.
Once connected, allow the unit to cool for 3 hours before storing food.

Area around where the refrigerator is installed

- Place the unit on sturdy and flat floor.
- Do not place your unit near any source of moisture like faucets and sinks.
- Do not place your refrigerator in a humid place as rust may form and may cause electric shock.
- Do not place your refrigerator near any source of heat like gas range, gas stove, and direct sunlight to avoid weak performance of the unit.
- Do not block door openings under any conditions.
- The refrigerator must be located in a place with good air circulation.
- In case of placing the refrigerator on an uneven surface, adjust the built-in adjustable leg shell to make the unit stable.

Moving or shifting

- When moving or shifting the refrigerator, remove the accessories inside and make sure there is no water inside the unit.

Parts Identification

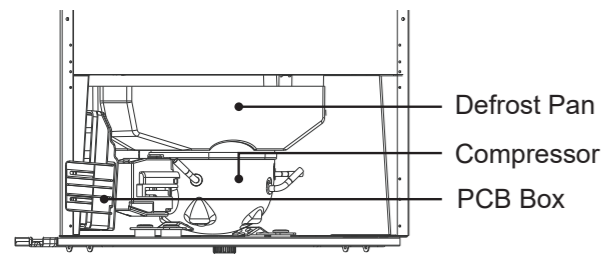
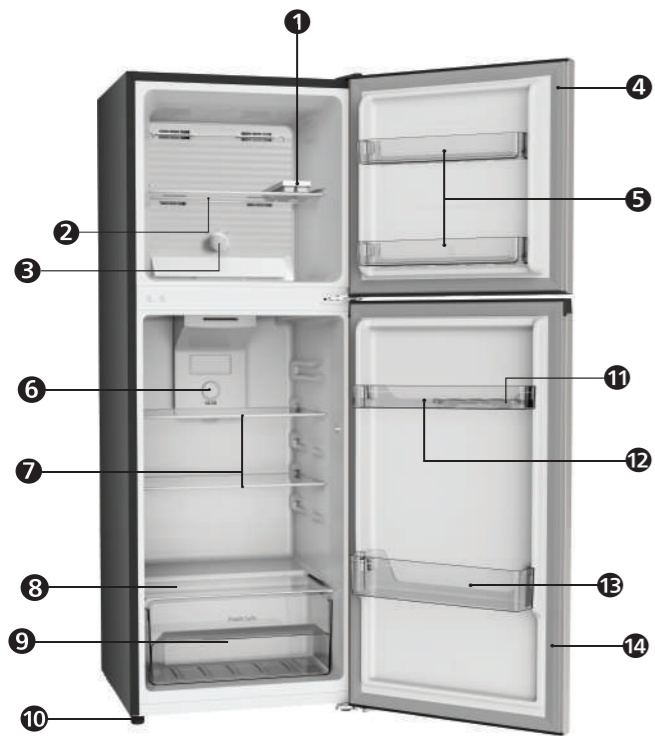

Defrost Pan
Compressor
PCB Box

Parts and Accessories

- 1 Ice Tray*
- 2 Glass Tray FC
- 3 Cold Air Control
- 4 Door Gasket (FC)
- 5 Free Shelf (2pcs)*
- 6 Temperature Control
- 7 Glass Tray PC (2 pcs.)
- 8 Glass Tray Crisper*
- 9 Crisper Case*
- 10 Adjustable Leg Shell
- 11 Egg Tray*
- 12 Free Shelf*
- 13 Bottle Shelf*
- 14 Door Gasket (PC)

(*) - Accessories

General Operation

Cold Air Control

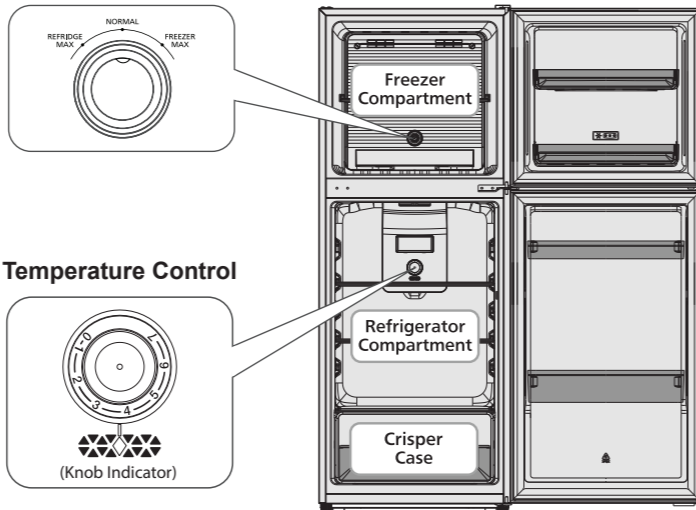

Temperature Control

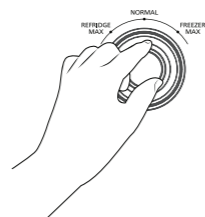
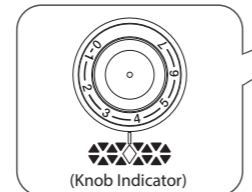

Cold Air Control

Use to vary the flow of cold air between Refrigerator and Freezer Compartment.

- Normal** Balanced distribution of cold air in Freezer and Refrigerator
- Refridge Max** Prioritize cooling in the Refrigerator
- Freezer Max** Prioritize cooling in the Freezer

Temperature Control

Use to vary the temperature at the Refrigerator Compartment.

- 0 (OFF)** Refrigerator Compartment and Freezer is OFF
- 1-2 (Min)** For storing minimal amount of food
- 3-5 (Normal)** For storing moderate amount of food
- 6-7 (Max)** For storing large amount of food

Storage Guide

- Freezer Compartment** Storing food for extended period of time. For storage of frozen and dried food.
- Refrigerator Compartment** For regular storage of foods and drinks or any food for temporary storage.
- Vegetable Case** High humidity storage that keeps fruits and vegetables fresh.

When set to "Normal", the temperature may vary slightly depending in the usage and storage conditions.

Energy Saving Tip:

Temperature of the refrigerator compartment can vary depending on the environment, room temperature and the amount of food stored in the refrigerator. To maximize energy efficiency, set your refrigerator to the recommended setting (Cold Air Control to "Normal", Refrigerator Temp. Control to "4".)

Usage and Customization

GLASS TRAYS

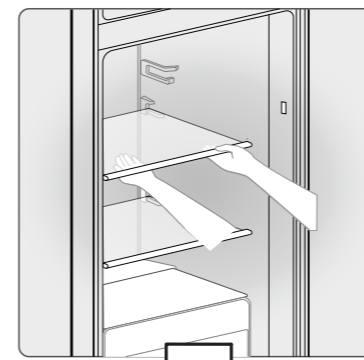

When storing large or tall items, move or remove the Glass Trays in the Refrigerator Compartment to optimize storage space.

ICE TRAY

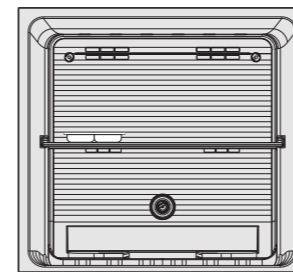

Place the Ice Tray on the top shelf of the Freezer Compartment. (Efficient Ice Making)

EGG TRAY

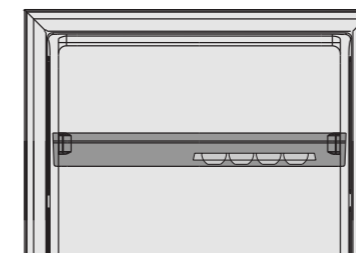

Place the moveable Egg Tray on top of the Free Shelf

Maintenance

1 Unplug the Unit



Before cleaning or conducting maintenance, make sure that the unit is disconnected from power supply. Do not connect or disconnect the power plug with wet hands.

When disconnected to the power supply, wait for 10 minutes before plugging back in. If not, the compressor may not work.

2 Remove the Accessories

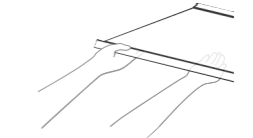

Clean the parts and accessories regularly to remove accumulated dirt and food residue.

Clean your refrigerator every 2-3 months to avoid build-up of dirt and food residue.

HOW TO REMOVE ACCESSORIES:

Free Shelf

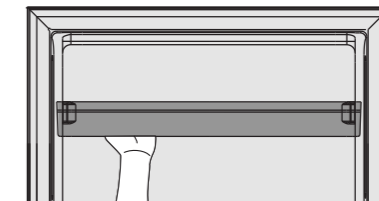

Gently pull up the Free shelf to release.

Bottle Shelf

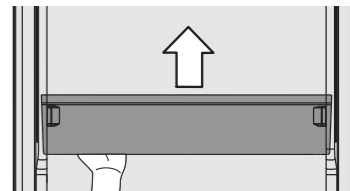

Gently slide the Bottle Shelf upward to release.

Glass Shelf

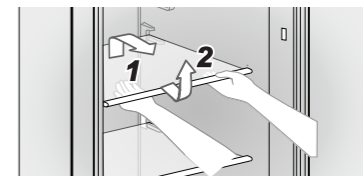

Raise the Glass Tray upward to avoid hitting the door.

Lift up the back of the Glass Shelf to release then pull outward.

Crisper Case & Crisper Glass

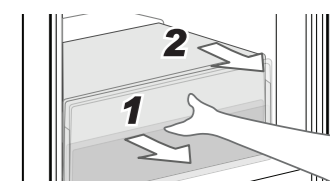

Make sure to remove the Crisper Case before removing the Crisper Glass.

Gently pull the crisper case outward until it releases. Then, pull out the crisper glass.

Defrost Pan

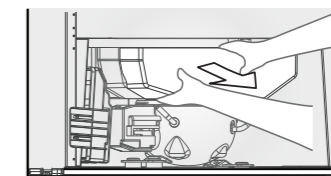

The Defrost Pan is inserted into the Compressor. Gently pull out the Defrost Pan until it releases.



Compressor Insert (Insert Defrost Pan) Defrost Pan Hook (Located at the bottom)

3 Wipe with cloth and water



Wipe off the stains and dirt with lukewarm water. Use a soft cloth or microfiber cloth to avoid making scratches on the surface of the parts.

Note: Do not use the following items, otherwise the surface may be scratched/broken.



Special Features



The motor will run in accordance with the temperature change inside the compartment. When required temperature is attained, the motor will run at a lower speed to save energy and lower noise.



Learns the lifestyle patterns of your family from door opening and time period of infrequent use to maximize energy efficiency.

*operates only when the temperature control is set to "Normal"