

ENGLISH

Panasonic

# Basic Operating Instructions

## Digital Camera

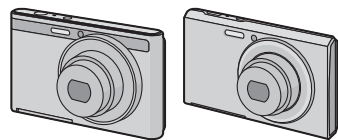

DMC-XS1

DMC-FH10

Model No. **DMC-XS1**  
**DMC-FH10**



Please read these instructions carefully before using this product, and save this manual for future use.

More detailed instructions on the operation of this camera are contained in "Operating Instructions for advanced features (PDF format)" in the supplied CD-ROM. Install it on your PC to read it.



-If you see this symbol-

### Information on Disposal in other Countries outside the European Union

This symbol is only valid in the European Union. If you wish to discard this product, please contact your local authorities or dealer and ask for the correct method of disposal.



Panasonic Corporation  
Web Site: <http://panasonic.net>

© Panasonic Corporation 2013



VQT4P57  
F1212SM0

## Limited Warranty (ONLY FOR AUSTRALIA)

### Panasonic Warranty

- The product is warranted for 12 months from the date of purchase. Subject to the conditions of this warranty Panasonic or its Authorised Service Centre will perform necessary service on the product without charge for parts or labour, if in the opinion of Panasonic, the product is found to be faulty within the warranty period.
- This warranty only applies to Panasonic products purchased in Australia and sold by Panasonic Australia or its Authorised Distributors or Dealers and only where the products are used and serviced within Australia or its territories. Warranty cover only applies to service carried out by a Panasonic Authorised Service Centre and only if valid proof of purchase is presented when warranty service is requested.
- This warranty only applies if the product has been installed and used in accordance with the manufacturer's recommendations (as noted in the operating instructions) under normal use and reasonable care (in the opinion of Panasonic). The warranty covers normal domestic use only and does not cover damage, malfunction or failure resulting from use of incorrect voltages, incorrect installation, accident, misuse, neglect, build-up of dirt or dust, abuse, misadjustment of customer controls, mains supply problems, thunderstorm activity, infestation by insects or vermin, tampering or repair by unauthorised persons (including unauthorised alterations), introduction of sand, humidity or liquids, commercial use such as hotel, office, restaurant, or other business or rental use of the product, exposure to abnormally corrosive conditions or any foreign object or matter having entered the product.
- This warranty does not cover the following items unless the fault or defect existed at the time of purchase:
  - Cabinet Part(s)
  - Video or Audio Tapes
  - SD cards or USB devices
  - User replaceable Batteries etc.
  - DVD, Blu-ray or Recordable Discs
  - Video / Audio Heads from wear and tear in normal use
  - Information stored on Hard Disk Drive, USB stick or SD card
  - DTV reception issues caused by TV Aerial / Cabling / Wall socket(s) etc.
- Some products may be supplied with Ethernet connection hardware. The warranty is limited on such products and will not cover
  - Internet and or DLNA connection / setup related problems
  - Access fees and or charges incurred for charges incurred in connection
  - The use of incompatible software or software not specifically stipulated in the product operations manual; and
  - Any indirect or consequential costs associated with the incorrect use or misuse of the hardware, its connection to the internet or any other device.
- To claim warranty service, when required, you should:
  - Telephone Panasonic's Customer Care Centre on 132600 or visit our website referred to below and use the Service Centre Locator for the name/address of the nearest Authorised Service Centre.
  - Send or take the product to a Panasonic Authorised Service Centre together with your proof of purchase receipt as a proof of purchase date. Please note that freight and insurance to and / or from your nearest Authorised Service Centre must be arranged by you.
  - Note that home or pick-up/delivery service is available for the following products in the major metropolitan areas of Australia or the normal operating areas of the nearest Authorised Service Centres: Plasma/LCD televisions / displays (screen size greater than 103 cm)
- The warranties hereby conferred do not extend to, and exclude, any costs associated with the installation, de-installation or re-installation of a product, including costs related to the mounting, de-mounting or remounting of any screen, (and any other ancillary activities), delivery, handling, freight, transportation or insurance of the product or any part thereof or replacement of and do not extend to, and exclude, any damage or loss occurring by reason of, during, associated with, or related to such installation, de-installation, re-installation or transit.

Panasonic Authorised Service Centres are located in major metropolitan areas and most regional centres of Australia, however, coverage will vary dependant on product. For advice on exact Authorised Service Centre locations for your product, please telephone our Customer Care Centre on 132600 or visit our website and use the Service Centre Locator.

In addition to your rights under this warranty, Panasonic products come with consumer guarantees that cannot be excluded under the Australian Consumer Law. If there is a major failure with the product, you can reject the product and elect to have a refund or to have the product replaced or if you wish you may elect to keep the goods and be compensated for the drop in value of the goods. You are also entitled to have the product repaired or replaced if the product fails to be of acceptable quality and the failure does not amount to a major failure.

If there is a major failure in regard to the product which cannot be remedied then you must notify us within a reasonable period by contacting the Panasonic Customer Care Centre. If the failure in the product is not a major failure then Panasonic may choose to repair or replace the product and will do so in a reasonable period of time from receiving notice from you.

**THIS WARRANTY CARD AND THE PURCHASE DOCKET (OR SIMILAR PROOF OF PURCHASE) SHOULD BE RETAINED BY THE CUSTOMER AT ALL TIMES**

If you require assistance regarding warranty conditions or any other enquiries, please visit the **Panasonic Australia** website [www.panasonic.com.au](http://www.panasonic.com.au) or contact by phone on **132 600** if phoning in, please ensure you have your operating instructions available.

**Panasonic Australia Pty. Limited**

ACN 001 592 187 ABN 83 001 592 187  
1 Innovation Road, Macquarie Park, NSW 2113

PRO-031-F11 Issue: 4.0

01-01-2011

Dear Customer,

We would like to take this opportunity to thank you for purchasing this Panasonic Digital Camera. Please read these Operating Instructions carefully and keep them handy for future reference. Please note that the actual controls and components, menu items, etc. of your Digital Camera may look somewhat different from those shown in the illustrations in these Operating Instructions.

Carefully observe copyright laws.

- Recording of pre-recorded tapes or discs or other published or broadcast material for purposes other than your own private use may infringe copyright laws. Even for the purpose of private use, recording of certain material may be restricted.

## Information for Your Safety

### WARNING:

- To reduce the risk of fire, electric shock or product damage,
- Do not expose this unit to rain, moisture, dripping or splashing.
- Use only the recommended accessories.
- Do not remove covers.
- Do not repair this unit by yourself. Refer servicing to qualified service personnel.

The socket outlet shall be installed near the equipment and shall be easily accessible.

### Product identification marking

Product	Location
Digital Camera	Bottom

### About the battery pack

#### CAUTION

- Danger of explosion if battery is incorrectly replaced. Replace only with the type recommended by the manufacturer.
- When disposing the batteries, please contact your local authorities or dealer and ask for the correct method of disposal.
- Do not heat or expose to flame.
- Do not leave the battery(ies) in a car exposed to direct sunlight for a long period of time with doors and windows closed.

#### Warning

Risk of fire, explosion and burns. Do not disassemble, heat above 60 °C or incinerate.

### About the AC adaptor (supplied)

#### CAUTION!

- To reduce the risk of fire, electric shock or product damage,
- Do not install or place this unit in a bookcase, built-in cabinet or in another confined space. Ensure this unit is well ventilated.

The unit is in the standby condition when the AC adaptor is connected. The primary circuit is always "live" as long as the AC adaptor is connected to an electrical outlet.

### Cautions for Use

- Do not use any other USB connection cables except the supplied one or a genuine Panasonic USB connection cable (DMW-USBC1: optional).
- Do not use any other AC adaptors except the supplied one.
- Always use a genuine Panasonic AV cable (DMW-AVC1: optional).
- Always use genuine Panasonic batteries (DMW-BCL7E).
- If you use other batteries, we cannot guarantee the quality of this product.
- Keep the Memory Card out of reach of children to prevent swallowing.

Keep this unit as far away as possible from electromagnetic equipment (such as microwave ovens, TVs, video games etc.).

- If you use this unit on top of or near a TV, the pictures and/or sound on this unit may be disrupted by electromagnetic wave radiation.
- Do not use this unit near cell phones because doing so may result in noise adversely affecting the pictures and/or sound.
- Recorded data may be damaged, or pictures may be distorted, by strong magnetic fields created by speakers or large motors.
- Electromagnetic wave radiation generated by microprocessors may adversely affect this unit, disturbing the pictures and/or sound.
- If this unit is adversely affected by electromagnetic equipment and stops functioning properly, turn this unit off and remove the battery or disconnect AC adaptor (supplied). Then reinsert the battery or reconnect AC adaptor and turn this unit on.

Do not use this unit near radio transmitters or high-voltage lines.

- If you record near radio transmitters or high-voltage lines, the recorded pictures and/or sound may be adversely affected.

### About illustrations in these operating instructions

The procedure is described for (DMC-XS1) as an example.

## Accessories

Check that all the accessories are supplied before using the camera. Product numbers correct as of January 2013. These may be subject to change.

Battery Pack (DMW-BCL7E)

AC Adaptor (VSK0776)

USB Connection Cable

(K1HY08YY0031)

Hand Strap (VFC4297)

CD-ROM (VFF1097)

- Software
  - PHOTOFunSTUDIO 9.0 LE (Windows 8/7/Vista/XP)
  - LoiLoScope 30 day full trial version (Windows 8/7/Vista/XP)
 (This will only install a shortcut to the trial version download site.)
- Operating Instructions for advanced features

- Consult the dealer or Panasonic if you lose the supplied accessories. (You can purchase the accessories separately.)

## Preparations

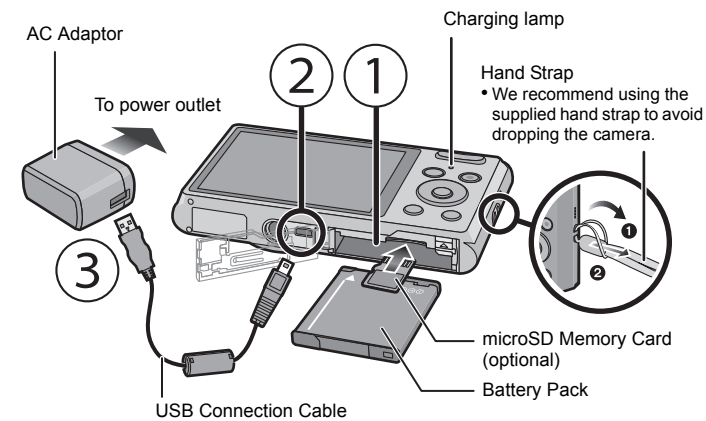

Charging time

Approx. 150 min

## Recording

- Set the date and time before using the camera.

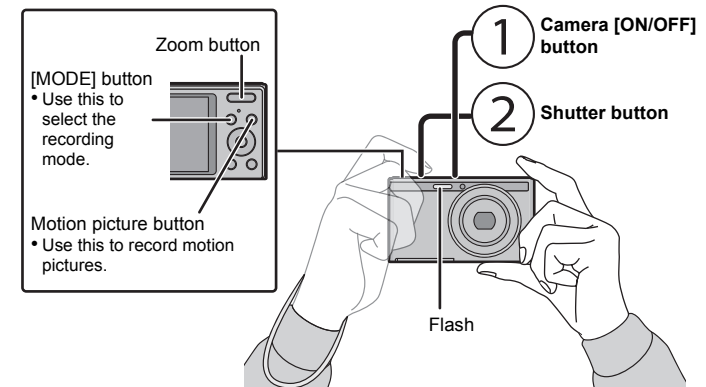

Number of recordable pictures

Approx. 260 pictures

## Playback

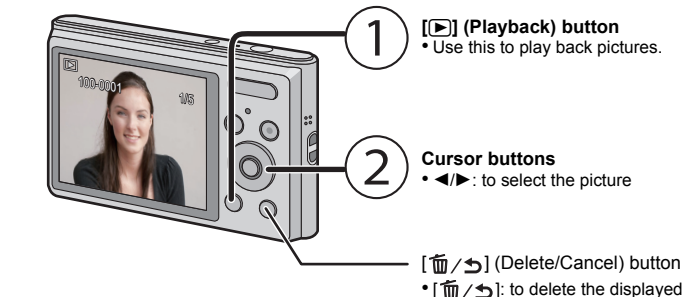

## Specifications

Specifications are subject to change without notice.

Digital Camera: Information for your safety

Power Source:	DC 5 V
Power Consumption:	1.1 W (When recording) 0.6 W (When playing back)

Camera effective pixels	16,100,000 pixels	
Image sensor	1/2.33" CCD, total pixel number 16,600,000 pixels, Primary colour filter	
Lens	Optical 5× zoom, f=4.3 mm to 21.5 mm (35 mm film camera equivalent: 24 mm to 120 mm)/F2.8 (Wide) to F6.9 (Tele)	
Image stabiliser	Optical method	
Focus range	Normal/ Intelligent auto	5 cm (Wide)/1 m (Tele) to ∞
	Scene Mode	There may be differences in the above settings.
Shutter system	Electronic shutter+ Mechanical shutter	
Shutter speed	8 seconds to 1/1600th of a second [Starry Sky] Mode: 15 seconds, 30 seconds, 60 seconds	
Exposure (AE)	Auto (Programme AE)	
Metering mode	Multiple	
LCD monitor	2.7" TFT LCD (4:3) (Approx. 230,000 dots) (field of view ratio about 100%)	
Microphone	Monaural	
Speaker	Monaural	
Recording media	Built-in Memory (Approx. 90 MB)/microSD Memory Card/microSDHC Memory Card	
Recording file format		
Still Picture	JPEG (based on "Design rule for Camera File system", based on "Exif 2.3" standard)	
Motion pictures	"QuickTime Motion JPEG" (motion pictures with audio)	
Interface		
Digital	"USB 2.0" (High Speed)	
Analogue video	NTSC/PAL Composite (Switched by menu)	
Audio	Audio line output (monaural)	
Terminal		
[AV OUT/DIGITAL]	Dedicated jack (8 pin)	
Dimensions (excluding the projecting parts)	(DMC-XS1) Approx. 93.8 mm (W)×53.5 mm (H)×17.6 mm (D) (DMC-FH10) Approx. 93.0 mm (W)×54.6 mm (H)×18.0 mm (D)	
Mass	(DMC-XS1) Approx. 103 g (with card and battery) Approx. 88 g (excluding card and battery) (DMC-FH10) Approx. 100 g (with card and battery) Approx. 85 g (excluding card and battery)	
Operating temperature	0 °C to 40 °C	
Operating humidity	10%RH to 80%RH	

AC Adaptor (Panasonic VSK0776):

Information for your safety

Input:	~110 V to 240 V, 50/60 Hz, 0.2 A
Output:	===5 V, 800 mA

Battery Pack (lithium-ion) (Panasonic DMW-BCL7E):

Information for your safety

Voltage/capacity:	3.6 V/690 mAh
-------------------	---------------