

Panasonic®

Basic Operating Instructions Digital Camera

Model No. **DMC-SZ9**

LUMIX

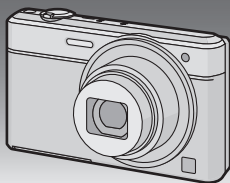

Please read these instructions carefully before using this product, and save this manual for future use.



More detailed instructions on the operation of this camera are contained in “Operating Instructions for advanced features (PDF format)” in the supplied CD-ROM. Install it on your PC to read it.



Dear Customer,

We would like to take this opportunity to thank you for purchasing this Panasonic Digital Camera. Please read these Operating Instructions carefully and keep them handy for future reference. Please note that the actual controls and components, menu items, etc. of your Digital Camera may look somewhat different from those shown in the illustrations in these Operating Instructions.

Carefully observe copyright laws.

- Recording of pre-recorded tapes or discs or other published or broadcast material for purposes other than your own private use may infringe copyright laws. Even for the purpose of private use, recording of certain material may be restricted.

Information for Your Safety

WARNING:

To reduce the risk of fire, electric shock or product damage,

- Do not expose this unit to rain, moisture, dripping or splashing.
- Use only the recommended accessories.
- Do not remove covers.
- Do not repair this unit by yourself. Refer servicing to qualified service personnel.

The socket outlet shall be installed near the equipment and shall be easily accessible.

■ Product identification marking

Product	Location
Digital Camera	Bottom

■ About the battery pack

CAUTION

- Danger of explosion if battery is incorrectly replaced. Replace only with the type recommended by the manufacturer.
 - When disposing the batteries, please contact your local authorities or dealer and ask for the correct method of disposal.
-
- Do not heat or expose to flame.
 - Do not leave the battery(ies) in a car exposed to direct sunlight for a long period of time with doors and windows closed.

Warning

Risk of fire, explosion and burns. Do not disassemble, heat above 60 °C or incinerate.

■ About the AC adaptor (supplied)

CAUTION!

To reduce the risk of fire, electric shock or product damage,

- **Do not install or place this unit in a bookcase, built-in cabinet or in another confined space. Ensure this unit is well ventilated.**
-
- The unit is in the standby condition when the AC adaptor is connected. The primary circuit is always "live" as long as the AC adaptor is connected to an electrical outlet.

■ Cautions for Use

- Do not use any other USB connection cables except the supplied one or a genuine Panasonic USB connection cable (DMW-USBC1: optional).
- Always use a genuine Panasonic AV cable (DMW-AVC1: optional).
- Always use a genuine Panasonic HDMI micro cable (RP-CHEU15: optional).
Part number: RP-CHEU15 (1.5 m)

Keep this unit as far away as possible from electromagnetic equipment (such as microwave ovens, TVs, video games etc.).

- If you use this unit on top of or near a TV, the pictures and/or sound on this unit may be disrupted by electromagnetic wave radiation.
- Do not use this unit near cell phones because doing so may result in noise adversely affecting the pictures and/or sound.
- Recorded data may be damaged, or pictures may be distorted, by strong magnetic fields created by speakers or large motors.
- Electromagnetic wave radiation generated by microprocessors may adversely affect this unit, disturbing the pictures and/or sound.
- If this unit is adversely affected by electromagnetic equipment and stops functioning properly, turn this unit off and remove the battery or disconnect AC adaptor (supplied)/AC adaptor (DMW-AC5G: optional). Then reinsert the battery or reconnect AC adaptor and turn this unit on.

Do not use this unit near radio transmitters or high-voltage lines.

- If you record near radio transmitters or high-voltage lines, the recorded pictures and/or sound may be adversely affected.

-If you see this symbol-

Information on Disposal in other Countries outside the European Union

This symbol is only valid in the European Union.

If you wish to discard this product, please contact your local authorities or dealer and ask for the correct method of disposal.



Contents

Information for Your Safety	2
Before Use	6
Standard Accessories.....	7
Names and Functions of Main Parts	8
Inserting and Removing the Card (optional)/the Battery	9
Charging the Battery.....	10
Sequence of operations	11
Remote Shooting	13
• Installing the smartphone/tablet app “Image App”	13
• Connecting to a smartphone/tablet.....	14
• Taking pictures via a smartphone/tablet (remote recording).....	16
• Playing back pictures in the camera	16
Reading the Operating Instructions (PDF format)	17
Installing supplied software	18
Specifications	19
Limited Warranty (ONLY FOR AUSTRALIA).....	22

Before Use

■ Care of the camera

- Do not subject to strong vibration, shock, or pressure.
- This camera is not dust/splash/water proof.
Avoid using the camera in places with a lot of dust, water, sand, etc.

■ About Condensation (When the lens is fogged up)

- Condensation occurs when the ambient temperature or humidity changes. Be careful of condensation since it causes lens stains, fungus and camera malfunction.
- If condensation occurs, turn the camera off and leave it for about 2 hours. The fog will disappear naturally when the temperature of the camera becomes close to the ambient temperature.

Standard Accessories

Check that all the accessories are supplied before using the camera.
Product numbers correct as of January 2013. These may be subject to change.

- 1 Battery Pack
(Indicated as **battery pack** or **battery** in the text)

Charge the battery before use.

- 2 AC Adaptor

Can be used for charging and playback.

- 3 USB Connection Cable

- 4 CD-ROM

- Software
- Operating Instructions for advanced features

Install on your PC before use.



- 5 Hand Strap

- SD Memory Card, SDHC Memory Card and SDXC Memory Card are indicated as **card** in the text.

- **The card is optional.**

You can record or play back pictures on the built-in memory when you are not using a card.

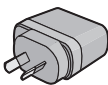
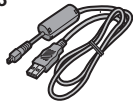
- Consult the dealer or your nearest Service Centre if you lose the supplied accessories. (You can purchase the accessories separately.)

<p>1</p>  <p>DMW-BCL7E</p>	<p>2</p>  <p>VSK0776</p>
<p>3</p>  <p>K1HY08YY0032</p>	<p>4</p>  <p>VFF1142</p>
<p>5</p>  <p>VFC4297</p>	

Names and Functions of Main Parts

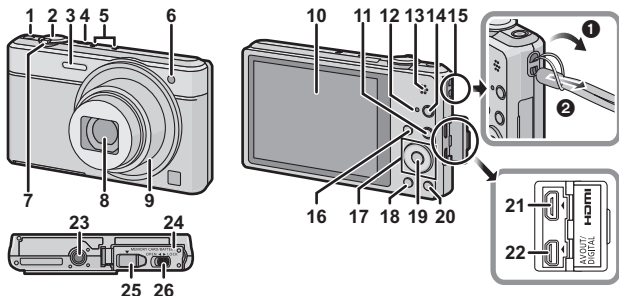

- | | | | |
|--|---|--|--|
| 1 | Motion picture button | 18 | [DISP.] button |
| 2 | Shutter button | 19 | [MENU/SET] button |
| 3 | Flash | 20 | [Q.MENU] button/
[/] (Delete/Cancel) button |
| 4 | Camera [ON/OFF] button | 21 | [HDMI] socket |
| 5 | Microphone | <ul style="list-style-type: none"> Do not connect with any cable other than an HDMI micro cable (RP-CHEU15: optional). Doing so may cause malfunction. | |
| 6 | Self-timer indicator
AF Assist Lamp | 22 | [AV OUT/DIGITAL] socket |
| 7 | Zoom lever | <ul style="list-style-type: none"> This socket is also used when charging the battery. | |
| 8 | Lens | 23 | Tripod mount |
| 9 | Lens barrel | <ul style="list-style-type: none"> A tripod with a screw length of 5.5 mm or more may damage this unit if attached. | |
| 10 | LCD monitor | 24 | Card/Battery door |
| 11 | [] (Playback) button | 25 | DC coupler cover |
| 12 | Charging lamp
Wi-Fi® connection lamp | <ul style="list-style-type: none"> When using an AC adaptor (DMW-AC5G: optional), ensure that the Panasonic DC coupler (DMW-DCC13: optional) and AC adaptor are used. | |
| 13 | Speaker | <ul style="list-style-type: none"> Always use a genuine Panasonic AC adaptor (DMW-AC5G: optional). | |
| <ul style="list-style-type: none"> Be careful not to cover the speaker with your finger. Doing so may make sound difficult to hear. | 26 | Release lever | |
| 14 | [Wi-Fi] button | | |
| 15 | Strap eyelet | | |
| <ul style="list-style-type: none"> Be sure to attach the strap when using the camera to ensure that you will not drop it. | | | |
| 16 | [MODE] button | | |
| 17 | Cursor buttons | | |

Inserting and Removing the Card (optional)/the Battery

- Check that this unit is turned off.
- We recommend using a Panasonic card.

1 Slide the release lever in the direction of the arrow and open the card/battery door.

- Always use genuine Panasonic batteries (DMW-BCL7E).
- If you use other batteries, we cannot guarantee the quality of this product.

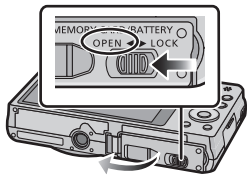

2 **Battery:** Being careful about the battery orientation, securely insert it all the way in, and then check that it is locked by the lever (A).

To remove the battery, move the lever (A) in the direction of the arrow.

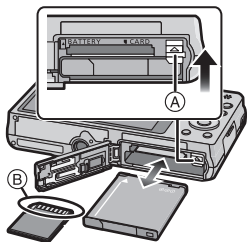

Card: Push it securely all the way until you hear a “click” while being careful about the direction in which you insert it.

To remove the card, push the card until it clicks, then pull the card out upright.

(B): Do not touch the connection terminals of the card.

3 **①:** Close the card/battery door.

②: Slide the release lever in the direction of the arrow.

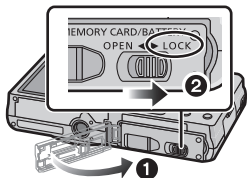

Note

- Keep the Memory Card out of reach of children to prevent swallowing.

Charging the Battery

- The battery that can be used with this unit is DMW-BCL7E.
- The battery is not charged when the camera is shipped. Charge the battery before use.
- Charge the battery with the AC adaptor (supplied) indoors (10 °C to 30 °C).

- Check that this unit is turned off.

Insert the battery to this unit, and then connect this unit to the AC adaptor (A) (supplied) or a PC (B).

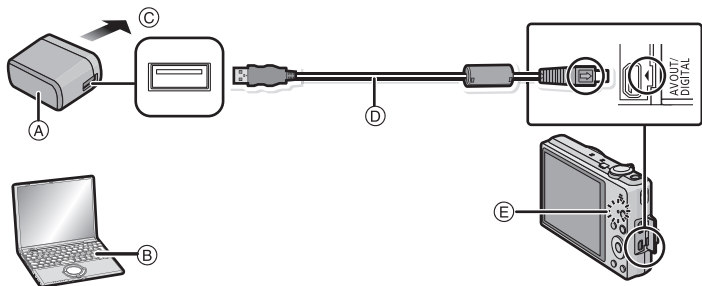

© To power outlet

© USB connection cable (supplied)

■ About the charging lamp (E)

Lit red: Charging.

Off: Charging has completed. (**Charging time: Approx. 150 min**)

When using the AC adaptor (supplied), observe the following points as improper connections may cause malfunctions.

- Do not use any other USB connection cables except the supplied one or a genuine Panasonic USB connection cable (DMW-USBC1: optional).
- Do not use any other AC adaptors except the supplied one.
- Do not use the AC adaptor (supplied) or the USB connection cable (supplied) with other devices.

Sequence of operations

1 Press camera [ON/OFF] button.

- The clock is not set when the camera is shipped. Set the date and time before using the camera.

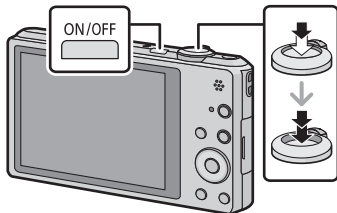

2 Press the shutter button halfway to focus and then press it fully to take the picture.

■ Recording Motion Pictures

1 Start recording by pressing the motion picture button.

2 Stop the recording by pressing the motion picture button again.

- Maximum time to record motion pictures continuously with [FHD/50i] in [AVCHD] is 29 minutes 59 seconds.
- Maximum time to record motion pictures continuously with [MP4] is 29 minutes 59 seconds or up to 4 GB.
You can check the recordable time on the screen. (For [FHD/25p] in [MP4] format, the file size is large and so the recordable time will drop below 29 minutes 59 seconds.)

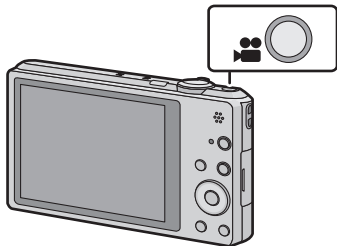

■ Selecting the Recording Mode

Press [MODE] to select the Recording Mode.

- IA**: Take pictures with automatic settings.
- 📷**: Take pictures with your own settings.
- 🌀**: Record while checking the image effect.
- 🖼️**: This mode allows you to take panorama pictures.
- SCN**: Take pictures according to scene.

■ Playing Back Pictures

Press [▶].

- Press ◀/▶ to select the picture.

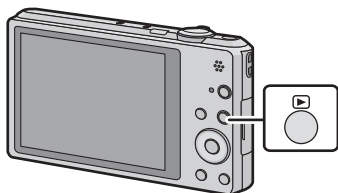

■ Deleting Pictures

Select the picture, and then press [🗑️/↶].

- Confirmation screen is displayed. Picture is deleted by selecting [Yes].

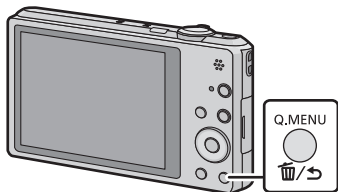

■ Setting the Menu



Press [MENU/SET] to display the menu screen to change the recording function, camera settings, and other settings.

Remote Shooting

You can remotely operate the camera using a smartphone/tablet.
You need to install “Image App” on your smartphone/tablet.

Installing the smartphone/tablet app “Image App”

The “Image App” is an application provided by Panasonic that allows your smartphone/tablet to perform the following operations of a Wi-Fi-compatible LUMIX.

	For Android™ apps	For iOS apps
Version	1.1 or higher	
OS	Android 2.2~Android 4.2*	iOS 4.3~iOS 6.0
Installation procedure	<ol style="list-style-type: none">1 Connect your Android device to a network.2 Select “Google Play™ Store”.3 Enter “Image App” into the search box.4 Select “Image App” and install it. <p>• The icon will be added to the menu.</p> 	<ol style="list-style-type: none">1 Connect the iOS device to the network.2 Select “App Store™”.3 Enter “Image App” into the search box.4 Select “Image App” and install it. <p>• The icon will be added to the menu.</p> 

• The service may not be able to be used properly depending on the type of smartphone/tablet being used. For compatible devices, see the following support site.

<http://panasonic.jp/support/global/cs/dsc/> (This Site is English only.)

• When downloading the app on a mobile network, high packet communication fees may be incurred depending on the details of your contract.

* Connecting to this unit with [Wi-Fi Direct] requires Android OS 4.0 or higher and Wi-Fi Direct™ support.

Connecting to a smartphone/tablet

Preparations:

- Install the “Image App” in advance. (P13)

1 Press [Wi-Fi].

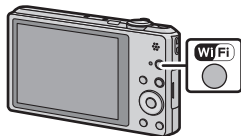

2 Press ▲/▼/◀/▶ to select [New Connection], and then press [MENU/SET].

- When connecting with the setting you used before, you can select the connection destination from [History Connection] or [Favorite Connection].

3 Press ▲/▼ to select [Remote Shooting], and then press [MENU/SET].

- The information (SSID and password) required for directly connecting your smartphone/tablet to this unit is displayed.
- To change the connection method, press [DISP.], and then select the connection method. For details, refer to “Changing the connection method”.

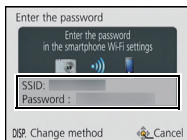
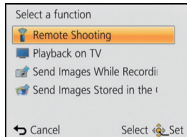

On your smartphone/tablet

(The default connection method is set to [Manual Connection].)

4 On the setting menu of your smartphone/tablet, turn on the Wi-Fi function.

5 Select the SSID that matches the one displayed on the screen of this unit, and then enter the password.

6 Start “Image App” on your smartphone/tablet. (P13)

- When the connection is complete, live images being captured by the camera are displayed on the smartphone/tablet.

■ Changing the connection method

- When connecting with [Via Network]

(On the camera)

- 1** Press ▲/▼ to select [Via Network], and then press [MENU/SET].
- 2** Select the method for connecting to a wireless access point, and set.

(On your smartphone/tablet)

- 3** On the setting menu of your smartphone/tablet, turn on the Wi-Fi function.
- 4** Select the wireless access point you want to connect to, and set.
- 5** Start “Image App” on your smartphone/tablet. (P13)

-
- When connecting with [Wi-Fi Direct] or [WPS Connection]

(On the camera)

- 1** Press ▲/▼ to select [Direct], and then press [MENU/SET].

Connection method	Description of settings
[Wi-Fi Direct]	<ol style="list-style-type: none">1 Set the device to Wi-Fi Direct™ mode.2 Press ▲/▼ to select [Wi-Fi Direct] and then press [MENU/SET].3 Press ▲/▼ to select the device to connect to, and then press [MENU/SET].<ul style="list-style-type: none">• Read the operating instructions of your device for details.
[WPS Connection]	[WPS (Push-Button)] <ol style="list-style-type: none">1 Press ▲/▼ to select [WPS (Push-Button)] and then press [MENU/SET].2 Set the device to WPS mode.<ul style="list-style-type: none">• You can wait longer for a connection by pressing the [DISP.] button on this unit.
	[WPS (PIN code)] <ol style="list-style-type: none">1 Press ▲/▼ to select [WPS (PIN code)] and then press [MENU/SET].2 Enter the PIN code of the device into this unit.

(On your smartphone/tablet)

- 2** Start “Image App” on your smartphone/tablet. (P13)

Taking pictures via a smartphone/tablet (remote recording)

Select [] on the smartphone/tablet.



- The recorded images are saved in the camera.
- Motion pictures cannot be recorded.
- Some settings are not available.
- The screen differs depending on the operating system.

Playing back pictures in the camera

Select [] on a smartphone/tablet.



- You can save pictures on the smartphone/tablet.
- Motion pictures cannot be played back.
- You can send pictures to a WEB service, etc.
- The screen differs depending on the operating system.

Reading the Operating Instructions (PDF format)

More detailed instructions on the operation of this camera are contained in “Operating Instructions for advanced features (PDF format)” in the supplied CD-ROM. Install it on your PC to read it.

■ For Windows

- 1 Turn the PC on and insert the CD-ROM containing the Operating Instructions (supplied).
- 2 Click the [Operating Instructions].
- 3 Select the desired language and then click [Operating Instructions] to install.
(A) To return to the install menu.
- 4 Double-click the “Operating Instructions” shortcut icon on the desktop.

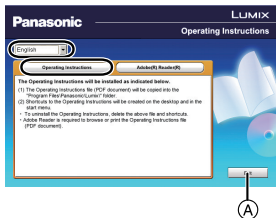

■ When the Operating Instructions (PDF format) will not open

You will need Adobe Acrobat Reader 5.0 or later, or Adobe Reader 7.0 or later to browse or print the Operating Instructions (PDF format).

- You can download and install a version of Adobe Reader that you can use with your OS from the following website.

<http://get.adobe.com/reader/otherversions/>

Installing supplied software

- The supplied CD-ROM includes the following software.
 - PHOTOfunSTUDIO 9.0 AE (Windows XP/Vista/7/8)
 - LoiLoScope 30 day full trial version (Windows XP/Vista/7/8)
(This will only install a shortcut to the trial version download site.)
- Before inserting the CD-ROM, close all running applications.

1 Check the environment of your PC.

- For details about information such as the operating environment or operating method, refer to the “Operating Instructions for advanced features (PDF format)” or the operating instructions for the respective software programmes.

2 Insert the CD-ROM with the supplied software.

- When you insert the supplied CD-ROM, the install menu will start.

3 Click on the [Applications] on the install menu.

4 Click on the [Recommended Installation].

- Proceed with installation according to messages appearing on the screen.



Note

- The software compatible with your PC will be installed.
- “PHOTOfunSTUDIO” and “LoiLoScope” are not compatible with Mac.

Specifications

Specifications are subject to change without notice.

Digital Camera:

Information for your safety

Power Source:	DC 5.1 V
Power Consumption:	1.3 W (When recording) 0.9 W (When playing back)

Camera effective pixels	16,100,000 pixels	
Image sensor	1/2.33" MOS sensor, total pixel number 17,500,000 pixels, Primary colour filter	
Lens	Optical 10× zoom, f=4.5 mm to 45 mm (35 mm film camera equivalent: 25 mm to 250 mm)/F3.1 (Wide) to F5.9 (Tele)	
Image stabiliser	Optical method	
Focus range	Normal	50 cm (Wide)/1.5 m (Tele) to ∞ (9× is 2 m to ∞)
	Macro/ Intelligent auto/ Motion picture	5 cm (Wide)/1.5 m (Tele) to ∞ (9× is 2 m to ∞)
	Scene Mode	There may be differences in the above settings.
Shutter system	Electronic shutter+Mechanical shutter	
Minimum Illumination	Approx. 10 lx (when i-low light is used, the shutter speed is 1/25th of a second)	
Shutter speed	4 seconds to 1/1600th of a second [Starry Sky] Mode: 15 seconds, 30 seconds	
Exposure (AE)	Auto (Programme AE)	
Metering mode	Multiple	
LCD monitor	3.0" TFT LCD (4:3) (Approx. 460,000 dots) (field of view ratio about 100%)	
Microphone	Stereo	
Speaker	Monaural	

Recording media	Built-in Memory (Approx. 60 MB)/SD Memory Card/ SDHC Memory Card/SDXC Memory Card
Recording file format	
Still Picture	JPEG (based on "Design rule for Camera File system", based on "Exif 2.3" standard)/DPOF corresponding/MPO
Motion pictures	AVCHD/MP4
Audio compression format	AVCHD: Dolby® Digital (2ch) MP4: AAC (2ch)
Interface	
Digital	"USB 2.0" (High Speed)
Analogue video	NTSC/PAL Composite (Switched by menu)
Audio	Audio line output (monaural)
Terminal	
[AV OUT/DIGITAL]	Dedicated jack (8 pin)
[HDMI]	MicroHDMI TypeD
Dimensions (excluding the projecting parts)	Approx. 96.5 mm (W)×56.8 mm (H)×21.2 mm (D)
Mass	Approx. 134 g (with card and battery) Approx. 119 g (excluding card and battery)
Operating temperature	0 °C to 40 °C
Operating humidity	10%RH to 80%RH

Wireless transmitter

Compliance standard	IEEE 802.11b/g/n (standard wireless LAN protocol)
Frequency range used (central frequency)	2412 MHz to 2462 MHz (1 to 11ch)
Encryption method	Wi-Fi compliant WPA™/WPA2™
Access method	Infrastructure mode

AC Adaptor (Panasonic VSK0776)

Information for your safety

Input:	~ 110 V to 240 V, 50/60 Hz, 0.2 A
Output:	=== 5 V, 800 mA

Battery Pack (lithium-ion) (Panasonic DMW-BCL7E):

Information for your safety

Voltage/capacity:	3.6 V/690 mAh
--------------------------	---------------

Limited Warranty (ONLY FOR AUSTRALIA)

Panasonic Warranty

- The product is warranted for 12 months from the date of purchase. Subject to the conditions of this warranty Panasonic or its Authorised Service Centre will perform necessary service on the product without charge for parts or labour, if in the opinion of Panasonic, the product is found to be faulty within the warranty period.
- This warranty only applies to Panasonic products purchased in Australia and sold by Panasonic Australia or its Authorised Distributors or Dealers and only where the products are used and serviced within Australia or its territories. Warranty cover only applies to service carried out by a Panasonic Authorised Service Centre and only if valid proof of purchase is presented when warranty service is requested.
- This warranty only applies if the product has been installed and used in accordance with the manufacturer's recommendations (as noted in the operating instructions) under normal use and reasonable care (in the opinion of Panasonic). The warranty covers normal domestic use only and does not cover damage, malfunction or failure resulting from use of incorrect voltages, incorrect installation, accident, misuse, neglect, build-up of dirt or dust, abuse, maladjustment of customer controls, mains supply problems, thunderstorm activity, infestation by insects or vermin, tampering or repair by unauthorised persons (including unauthorised alterations), introduction of sand, humidity or liquids, commercial use such as hotel, office, restaurant, or other business or rental use of the product, exposure to abnormally corrosive conditions or any foreign object or matter having entered the product.
- This warranty does not cover the following items unless the fault or defect existed at the time of purchase:
 - Cabinet Part(s)
 - Video or Audio Tapes
 - SD cards or USB devices
 - User replaceable Batteries
 - DVD, Blu-ray or Recordable Discs
 - Video / Audio Heads from wear and tear in normal use
 - Information stored on Hard Disk Drive, USB stick or SD card
 - DTV reception issues caused by TV Aerial / Cabling / Wall socket(s) etc
- Some products may be supplied with Ethernet connection hardware. The warranty is limited on such products and will not cover:
 - Internet and/or DLNA connection / setup related problems
 - Access fees and/or charges incurred for internet connection
 - The use of incompatible software or software not specifically stipulated in the product operations manual; and
 - Any indirect or consequential costs associated with the incorrect use or misuse of the hardware, its connection to the internet or any other device.
- To claim warranty service, when required, you should:
 - Telephone Panasonic's Customer Care Centre on 132600 or visit our website referred to below and use the Service Centre Locator for the name/address of the nearest Authorised Service Centre.
 - Send or take the product to a Panasonic Authorised Service Centre together with your proof of purchase receipt as a proof of purchase date. Please note that freight and insurance to and / or from your nearest Authorised Service Centre must be arranged by you.
 - Note that home or pick-up/delivery service is available for the following products in the major metropolitan areas of Australia or the normal operating areas of the nearest Authorised Service Centres:
 - Plasma/LCD televisions / displays (screen size greater than 103 cm)
- The warranties hereby conferred do not extend to, and exclude, any costs associated with the installation, de-installation or re-installation of a product, including costs related to the mounting, de-mounting or remounting of any screen, (and any other ancillary activities), delivery, handling, freight, transportation or insurance of the product or any part thereof or replacement of and do not extend to, and exclude, any damage or loss occurring by reason of, during, associated with, or related to such installation, de-installation, re-installation or transit.

Panasonic Authorised Service Centres are located in major metropolitan areas and most regional centres of Australia, however, coverage will vary dependant on product. For advice on exact Authorised Service Centre locations for your product, please telephone our Customer Care Centre on 132600 or visit our website and use the Service Centre Locator.

In addition to your rights under this warranty, Panasonic products come with consumer guarantees that cannot be excluded under the Australian Consumer Law. If there is a major failure with the product, you can reject the product and elect to have a refund or to have the product replaced or if you wish you may elect to keep the goods and be compensated for the drop in value of the goods. You are also entitled to have the product repaired or replaced if the product fails to be of acceptable quality and the failure does not amount to a major failure.

If there is a major failure in regard to the product which cannot be remedied then you must notify us within a reasonable period by contacting the Panasonic Customer Care Centre. If the failure in the product is not a major failure then Panasonic may choose to repair or replace the product and will do so in a reasonable period of time from receiving notice from you.

**THIS WARRANTY CARD AND THE PURCHASE DOCKET (OR SIMILAR PROOF OF PURCHASE)
SHOULD BE RETAINED BY THE CUSTOMER AT ALL TIMES**

If you require assistance regarding warranty conditions or any other enquiries, please visit the **Panasonic Australia** website www.panasonic.com.au or contact by phone on **132 600**
If phoning in, please ensure you have your operating instructions available.

Panasonic Australia Pty. Limited

ACN 001 592 187 ABN 83 001 592 187

1 Innovation Road, Macquarie Park NSW 2113

PRO-031-F11 Issue: 4.0

01-01-2011

This product incorporates the following software:

- (1) the software developed independently by or for Panasonic Corporation,
- (2) the software owned by third party and licensed to Panasonic Corporation and/or,
- (3) open sourced software including the software developed by the OpenSSL Project for use in the OpenSSL Toolkit (<http://www.openssl.org/>), and the software written by Eric Young (eay@cryptsoft.com).

For the software categorised as (1) and (2), please view the information by pressing [MENU/SET], displaying [Setup] → [Version Disp.], and then pressing [MENU/SET]. For the software categorised as (3), please refer to the applicable license terms in the following "Operating Instructions for advanced features (PDF format)".

- SDXC Logo is a trademark of SD-3C, LLC.
- Manufactured under license from Dolby Laboratories.
Dolby and the double-D symbol are trademarks of Dolby Laboratories.
- HDMI, the HDMI Logo, and High-Definition Multimedia Interface are trademarks or registered trademarks of HDMI Licensing LLC in the United States and other countries.
- HDAVI Control™ is a trademark of Panasonic Corporation.
- Mac and Mac OS are trademarks of Apple Inc., registered in the U.S. and other countries.
- Windows and Windows Vista are either registered trademarks or trademarks of Microsoft Corporation in the United States and/or other countries.
- App Store is a service mark of Apple Inc.
- Android and Google Play are trademarks or registered trademarks of Google Inc.

- “AVCHD” and the “AVCHD” logo are trademarks of Panasonic Corporation and Sony Corporation.
- QuickTime and the QuickTime logo are trademarks or registered trademarks of Apple Inc., used under license therefrom.
- The Wi-Fi CERTIFIED Logo is a certification mark of the Wi-Fi Alliance.
- The Wi-Fi Protected Setup Mark is a mark of the Wi-Fi Alliance.
- “Wi-Fi”, “Wi-Fi Protected Setup”, “Wi-Fi Direct”, “WPA” and “WPA2” are marks or registered marks of the Wi-Fi Alliance.

AVCHD™



- DLNA, the DLNA Logo and DLNA CERTIFIED are trademarks, service marks, or certification marks of the Digital Living Network Alliance.
- This product uses “DynaFont” from DynaComware Corporation. DynaFont is a registered trademark of DynaComware Taiwan Inc.
- Other names of systems and products mentioned in these instructions are usually the registered trademarks or trademarks of the manufacturers who developed the system or product concerned.

This product is licensed under the AVC patent portfolio license for the personal and non-commercial use of a consumer to (i) encode video in compliance with the AVC Standard (“AVC Video”) and/or (ii) decode AVC Video that was encoded by a consumer engaged in a personal and non-commercial activity and/or was obtained from a video provider licensed to provide AVC Video. No license is granted or shall be implied for any other use. Additional information may be obtained from MPEG LA, LLC.

See <http://www.mpegla.com>.

Panasonic Corporation

Web Site: <http://panasonic.net>

© Panasonic Corporation 2013