

iPod/iPhone, Disc, USB

Inserting or removing media

iPod/iPhone

Push **[iPod ▲]** to open the dock tray.

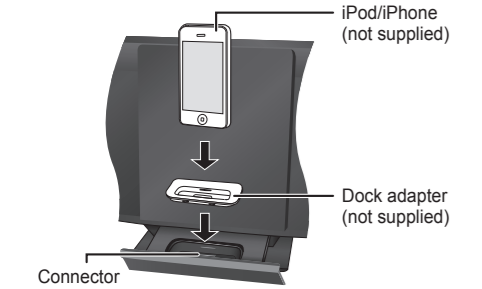

Note:

- Make sure to remove the iPod/iPhone from its case.
- Make sure to align your iPod/iPhone with the connector when inserting.
- Use a compatible dock adapter.
- If a dock adapter is not available, insert and remove the iPod/iPhone with care.

Disc

Press **[CD ▲ OPEN/CLOSE]** on the main unit to open the sliding door.

Put in a disc with the label facing towards you.

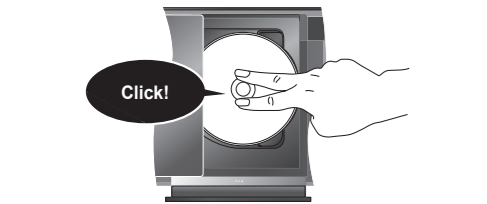

Note:
Keep fingers away from the sliding door when it is closing.

Radio

30 FM and 15 AM stations can be preset.

Preparation

Connect the antennas (⇒ "Getting started").

Press **[RADIO]** to select "FM" or "AM".

Automatic presetting

- Press **[PLAY MENU]** to select "A.PRESET".
- Press **[▲, ▼]** to select "LOWEST" or "CURRENT" frequency.
 - LOWEST : To begin auto preset from the lowest frequency.
 - CURRENT : To begin auto preset from the current frequency.
- Press **[OK]** to start presetting.
 - The tuner presets all the stations it can receive into the channels in ascending order.
 - To cancel, press **[■]**.

Manual tuning and presetting

- Press **[PLAY MENU]** to select "TUNEMODE".
- Press **[▲, ▼]** to select "MANUAL" and then press **[OK]**.
- Press **[◀◀/◀◀]** or **[▶▶/▶▶]** to tune in to the station.
 - To tune automatically, press and hold the button until the frequency starts changing quickly.
 - "STEREO" is shown when the system is tuned in to a stereo broadcast.

USB

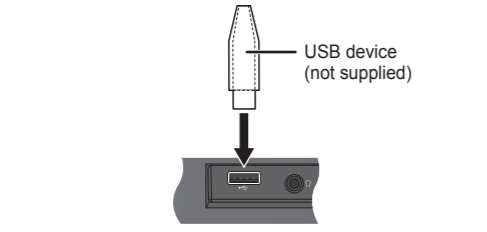

Note:
Do not use a USB extension cable. The system cannot recognise USB device connected through a cable.

Basic playback

Press **[iPod]**, **[CD]** or **[USB]** to select the source.

Play	Press [▶/II] .
Stop	Press [■] . USB : The track is memorised. "RESUME" is shown. Press two times to stop fully.
Pause	Press [▶/II] . Press again to continue playback.
Skip track	Press [◀◀/◀◀] or [▶▶/▶▶] .
Search through track	Press and hold [◀◀/◀◀] or [▶▶/▶▶] .

iPod/iPhone

View iPod menu	Press [iPod MENU] .
Select an item	Press [▲, ▼] and then press [OK] .

Note:

- Depending on the model, it may be necessary to remove the iPod/iPhone and select the album, artist, etc. on the iPod/iPhone.
- Operation results may vary depending on the iPod/iPhone models.
- Read the User Guide of the iPod/iPhone for the operating instructions.

Disc, USB

Skip album MP3	Press [▲, ▼] .
View information	Press [DISPLAY] .

Note:

- Maximum characters that can be shown: approximately 32
- This system supports ver. 1.0, 1.1 and 2.3 ID3 tags.
- Text data that the system does not support can show differently.

Play menu

- Press **[PLAY MENU]** to select "PLAYMODE" or "REPEAT".
- Press **[▲, ▼]** and then press **[OK]** to select the desired mode.

PLAYMODE	
OFF PLAYMODE	Play all tracks.
1-TRACK 1 ▶	Play one selected track. Press [◀◀/◀◀] or [▶▶/▶▶] to select the track.
1-ALBUM 1 ■ MP3	Play one selected album. Press [▲, ▼] to select the album.
RANDOM RND	Play all tracks randomly.
1-ALBUM RANDOM 1 ■ RND MP3	Play all tracks in one selected album randomly. Press [▲, ▼] to select the album.
REPEAT	
ON REPEAT ↺	Repeat playback.
OFF REPEAT	Cancel repeat playback.

Note:

- During random playback, you cannot skip to tracks which have been played.
- The setting returns to default when you open the sliding door.

Sound effects

- Press **[SOUND]** to select a sound effect.
- Press **[▲, ▼]** to select the desired setting.

PRESET EQ	"HEAVY" : Adds punch to rock. "SOFT" : For background music. "CLEAR" : Clarifies higher frequencies. "VOCAL" : Adds gloss to vocal. "FLAT" : Cancels the sound effect.
BASS	"BASS -4" to "BASS +4".
TREBLE	"TREBLE-4" to "TREBLE+4".
D.BASS	"ON D.BASS" or "OFF D.BASS".
SURROUND	"ON SURROUND" or "OFF SURROUND".

AM allocation setting (by main unit only)

- Press **[RADIO]** to select "AM".
- Press and hold **[RADIO]**.
 - After a few seconds, the display panel shows the current minimum radio frequency. Release the button when the minimum frequency changes.
 - To go back to the initial setting, do the above steps again.
 - After you change the setting, preset frequencies are erased.

Compatible media

iPod/iPhone (as of February 2012)

Update your iPod/iPhone with the latest software before using this system.

iPod touch 1st, 2nd, 3rd and 4th generation
iPod nano 2nd, 3rd, 4th, 5th and 6th generation
iPod classic
iPhone 4S / iPhone 4 / iPhone 3GS / iPhone 3G / iPhone

Charging an iPod/iPhone

An iPod/iPhone is charged automatically when connected to the system (even when the system is in standby mode).

- See the iPod/iPhone display for its battery charging status.
- Disconnect the iPod/iPhone if it is not used for an extended period of time after charging is complete
- Charging stops when the battery is fully charged. The battery will deplete naturally.

Troubleshooting

Before requesting service, make the following checks. If you are in doubt about some of the check points, or if the solutions indicated do not solve the problem, consult your dealer for instructions.

Common problems

No operations can be done with the remote control.

- Examine that the battery is installed correctly.
- The remote control and this unit are using different codes (⇒ right, "REMOTE □").

Sound is distorted or no sound.

- Adjust the volume of the system.
- Examine the volume of the iPod/iPhone.
- Switch off the system, determine and correct the cause, then switch the system on again. It can be caused by straining of the speakers through excessive volume or power, and when using the system in a hot environment.

A "humming" sound can be heard during playback.

- An AC mains lead or fluorescent light is near the cable. Keep other appliances and cords away from the cable of this system.

iPod/iPhone

You cannot switch on the iPod/iPhone.

- Examine that the battery of the iPod/iPhone is not depleted.
- Switch off the iPod/iPhone and the system before you connect the iPod/iPhone. Connect the iPod/iPhone and try again.

iPod/iPhone does not charge.

- Examine the connection.

Disc

- This system can play CD-R/RW with CD-DA or MP3 format content.
- Some CD-R/RW cannot be played because of the condition of the recording.
- MP3 files are defined as tracks and folders are defined as albums.
- This system can access up to:
 - CD-DA : 99 tracks
 - MP3 : 999 tracks, 255 albums (including root folder) and 20 sessions
- Disc must conform to ISO9660 level 1 or 2 (except for extended formats).
- Recordings will not necessarily be played in the order you recorded them.

USB

- Compatible USB devices which are defined as mass storage class:
 - USB devices that support bulk-only transfer
 - USB devices that support USB 2.0 full speed
- Files are defined as tracks and folders are defined as albums.
- Track must have the extension ".mp3" or ".MP3".
- This system can access up to:
 - 255 albums (including root folder)
 - 2500 tracks
 - 999 tracks in one album
- CBI (Control/Bulk/Interrupt) is not supported.
- NTFS file system is not supported (only FAT 12/16/32 file system is supported).
- Some files can fail to work because of the sector size.

Clock and timers

Setting the clock

This is a 24-hour clock.

- Press **[SETUP]** to select "CLOCK".
- Press **[▲, ▼]** to set the time.
- Press **[OK]**.

To show the clock for a few seconds

Press **[SETUP]** to select "CLOCK" and then press **[OK]**.

Note:

Reset the clock regularly to maintain accuracy.

Sleep timer

The sleep timer switches off the system after the set time.

Press **[SLEEP]** to select the setting (in minutes). To cancel, select "OFF".

SLEEP 30 → SLEEP 60 → SLEEP 90 → SLEEP120
↑ OFF ↓

Note:

- The remaining time is always shown on the display. The display changes temporarily when you perform other operations.
- The sleep timer can be used together with the play timer.
- The sleep timer always comes first. Be sure not to set an overlap of timers.

Play timer

You can set the timer to come on at a certain time to wake you up.

Preparation

Set the clock.

- Press **[SETUP]** to select "TIMER ADJ".
- Press **[▲, ▼]** to set the start time.
- Press **[OK]**.
- Do steps 2 and 3 again to set the end time.

To start the timer

- Prepare the audio source you want to listen to and set the volume.
- Press **[SETUP]** to select "TIMER SET".
- Press **[▲, ▼]** to select "SET" and then press **[OK]**. "⊙" is shown.
 - The system must be switched off for the timer to operate.

Check the settings	1. Press [SETUP] to select "TIMER ADJ". 2. Press [OK] .
Cancel	1. Press [SETUP] to select "TIMER SET". 2. Press [▲, ▼] to select "OFF" and then press [OK] .

Note:

- The timer starts at a low volume and increases gradually to the preset level.
- The timer comes on at the set time every day if the timer is on.
- If you switch off the system and switch on again while a timer is in operation, the timer will not stop at the end time.

Auto off function

This function switches off the system (except in radio source) if you do not use the system for approximately 30 minutes.

- Press **[SETUP]** to select "AUTO OFF".
- Press **[▲, ▼]** to select "ON" or "OFF" and then press **[OK]**.

Remote control code

When other Panasonic equipment responds to the remote control of this system, change the remote control code for this system.

To set the code to "REMOTE 2"

- Press and hold **[CD]** on the main unit and **[▲]** on the remote control until "REMOTE 2" is shown.
- Press and hold **[OK]** and **[▲]** for a minimum of 4 seconds.

To set the code to "REMOTE 1"

- Press and hold **[CD]** on the main unit and **[▼]** on the remote control until "REMOTE 1" is shown.
- Press and hold **[OK]** and **[▼]** for a minimum of 4 seconds.

Radio

A beat sound is heard.

- Switch off the TV or move it away from the system.
- Move mobile telephones away from the unit if the interference is apparent.

A low hum is heard during AM broadcasts.

- Move the antenna away from other cables and cords.

Stations cannot be selected.

- Change the AM frequency step (⇒ "AM allocation setting").

Main unit displays

"-:-:-"

- You connected the AC mains lead for the first time or there was a power failure recently. Set the clock.

"ADJUST CLOCK"

- Clock is not set. Adjust the clock accordingly.

"ADJUST TIMER"

- Play timer is not set. Adjust the play timer accordingly.

"ERROR"

- An incorrect operation was done. Read the instructions and try again.

"F61"

- There is a power supply problem.

"IPOD OVER CURRENT ERROR" or "USB OVER CURRENT ERROR"

- The iPod/iPhone or USB device is drawing too much power. Remove the iPod/iPhone or USB device. Switch the system off and on again.

"NODEVICE"

- The iPod/iPhone or USB device is not connected. Examine the connection.

"NO DISC"

- You have not put in a disc.

"NO PLAY"

- You have put in a disc that the system cannot play.
- You have inserted a USB device that cannot be played. Examine the content. You can only play supported format.
- If there are more than 255 albums or folders (audio and non-audio), some of the MP3 files in these albums cannot be read and played. Transfer these music albums to another USB device. Alternatively, reformat the USB device and save these music albums prior to saving the other non-audio folders.