

Panasonic®

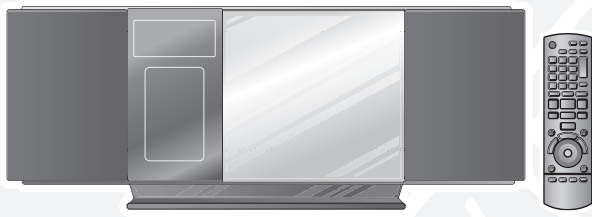

Operating Instructions Compact Stereo System

Model No. **SC-HC30DB**

DAB+

Dear customer

Thank you for purchasing this product.

Before connecting, operating or adjusting this product, please read the instructions completely. Please keep this manual for future reference.

Operations in these instructions are described using remote control, but you can do the operations with the main unit if the controls are the same. Your unit may not look exactly as illustrated.

CAUTION!

THIS PRODUCT UTILIZES A LASER.
USE OF CONTROLS OR ADJUSTMENTS OR PERFORMANCE OF
PROCEDURES OTHER THAN THOSE SPECIFIED HEREIN MAY
RESULT IN HAZARDOUS RADIATION EXPOSURE.
DO NOT OPEN COVERS AND DO NOT REPAIR YOURSELF.
REFER SERVICING TO QUALIFIED PERSONNEL.

CAUTION!

- DO NOT INSTALL OR PLACE THIS UNIT IN A BOOKCASE,
BUILT-IN CABINET OR IN ANOTHER CONFINED SPACE.
ENSURE THE UNIT IS WELL VENTILATED. TO PREVENT
RISK OF ELECTRIC SHOCK OR FIRE HAZARD DUE TO
OVERHEATING, ENSURE THAT CURTAINS AND ANY OTHER
MATERIALS DO NOT OBSTRUCT THE VENTILATION VENTS.
- DO NOT OBSTRUCT THE UNIT'S VENTILATION OPENINGS
WITH NEWSPAPERS, TABLECLOTHS, CURTAINS, AND
SIMILAR ITEMS.
- DO NOT PLACE SOURCES OF NAKED FLAMES, SUCH AS
LIGHTED CANDLES, ON THE UNIT.
- DISPOSE OF BATTERIES IN AN ENVIRONMENTALLY
FRIENDLY MANNER.

WARNING:

TO REDUCE THE RISK OF FIRE, ELECTRIC SHOCK OR
PRODUCT DAMAGE,

- DO NOT EXPOSE THIS APPARATUS TO RAIN, MOISTURE,
DRIPPING OR SPLASHING AND THAT NO OBJECTS FILLED
WITH LIQUIDS, SUCH AS VASES, SHALL BE PLACED ON THE
APPARATUS.
- USE ONLY THE RECOMMENDED ACCESSORIES.
- DO NOT REMOVE THE COVER (OR BACK); THERE ARE NO
USER SERVICEABLE PARTS INSIDE. REFER SERVICING TO
QUALIFIED SERVICE PERSONNEL.

CAUTION

Danger of explosion if battery is incorrectly replaced. Replace only
with the same or equivalent type recommended by the manufacturer.
Dispose of used batteries according to the manufacturer's instructions.

The socket outlet shall be installed near the equipment and easily
accessible.
The mains plug of the power supply cord shall remain readily operable.
To completely disconnect this apparatus from the AC Mains,
disconnect the power supply cord plug from AC receptacle.

This product may receive radio interference caused by mobile
telephones during use. If such interference is apparent, please
increase separation between the product and the mobile telephone.

THIS UNIT IS INTENDED FOR USE IN MODERATE CLIMATES.

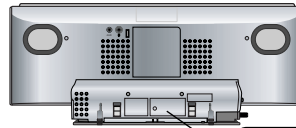

CLASS 1
LASER PRODUCT

RQT4389ZAA

CAUTION - CLASS 1M INVISIBLE LASER RADIATION WHEN OPEN AND
INTERLOCKS DEFEATED.
DO NOT VIEW DIRECTLY WITH OPTICAL INSTRUMENTS.
IEC60825-1+A2 / CLASS 1M

VARNING - KLASS 1M OSYNLIG LASERSTRÅLNING NÄR DENNA DEL
ÄR ÖPPNAD OCH SPÄRREN ÄR URKOPPLAD.
BETRÄKTA EJ STRÅLEN DIREKT GENOM OPTISKT INSTRUMENT.

FORSIGTIG - USYNLIG LASERSTRÅLNING KLASSE 1M. NÄR LÅGET ER ÅBENT
OG SIKKERHEDSAFBRYDERE ER UDE AF FUNKTION.
UNDGÅ AT SE LIGE PÅ MED OPTISKE INSTRUMENTER.

VARO - AVATTAESSA JA SUOJALUKITUS OHITETTAESSA
OLET ALTTIINA LUOKAN 1M NÄKYMÄTÖNTÄ LASERSÄTEILYÄ.
ÄLÄ KATSO OPTISELLA LAITTEELLA SUORAAN SÄTEESEEN.

VORSICHT - UNSICHTBARE LASERSTRAHLUNG KLASSE 1M. WENN ABDECKUNG
GEÖFFNET UND SICHERHEITSSPERRUNGEN ÜBERBRÜCKT.
NICHT DIREKT MIT OPTISCHEN INSTRUMENTEN BETRACHTEN.

ATTENTION - RAYONNEMENT LASER INVISIBLE, CLASSE 1M. EN CAS
D'OUVERTURE ET LORSQUE LA SÉCURITÉ EST NEUTRALISÉE.
NE PAS REGARDER DIRECTEMENT À L'AIDE D'INSTRUMENTS
D'OPTIQUE.

注意 - 打开时及联失效除时有不可见激光辐射。
避免光束照射。

注意 - ここを開き、安全インターロックを解除すると
不可視レーザー光が出ます。
ビームを見たり、触れたりしないでください。

Inside of product

RQLS0418

- If you see this symbol -

Information on Disposal in other Countries outside the
European Union



This symbol is only valid in the European Union.
If you wish to discard this product, please contact
your local authorities or dealer and ask for the
correct method of disposal.



"Made for iPod" means that an electronic accessory has been
designed to connect specifically to iPod and has been certified by the
developer to meet Apple performance standards.

"Works with iPhone" means that an electronic accessory has been
designed to connect specifically to iPhone and has been certified by
the developer to meet Apple performance standards.

Apple is not responsible for the operation of this device or its
compliance with safety and regulatory standards.
iPod is a trademark of Apple Inc., registered in the U.S. and other
countries. iPhone is a trademark of Apple Inc.

MPEG Layer-3 audio decoding technology licensed from Fraunhofer
IIS and Thomson.

Supplied accessories



Please check and identify the supplied accessories.

- | | |
|---|--|
| <input type="checkbox"/> 1 AC mains lead | <input type="checkbox"/> 1 DAB antenna |
| <input type="checkbox"/> 1 Remote control
(N2QAYB000521) | <input type="checkbox"/> 2 Batteries |

Screw accessories

- | | |
|---|--|
| <input type="checkbox"/> 2 Fixing screws B | <input type="checkbox"/> 1 Safety holder |
|---|--|

Wall bracket accessories

- | | |
|---|---|
| <input type="checkbox"/> 1 Wall bracket | <input type="checkbox"/> Four-legged cushions |
|---|---|

- The included AC mains lead is for use with this unit only. Do not use it with other equipment.
- Do not use an AC mains lead of other equipment.

Table of contents

Supplied accessories	3
Connections	3
Attaching the unit to a wall (Optional)	4
Control guide	7
Disc operations	8
Radio operations	10
DAB	11
Timer	14
Sound adjustment	14
External unit	15
Troubleshooting guide	17
Memory reset (Initialization)	18
Maintenance	18
Specifications	18
Safety precautions	19

Connections

Back View

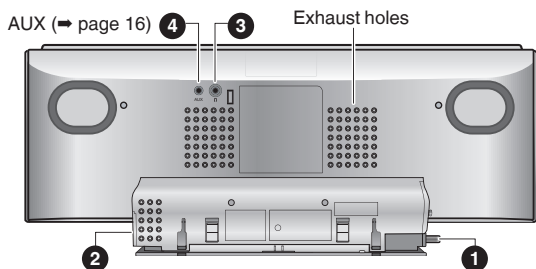

1 Connect the DAB antenna to receive FM radio and DAB (Digital Audio Broadcasting).

The cross bar of the T should be kept firmly stretched. Find a good position with good reception.

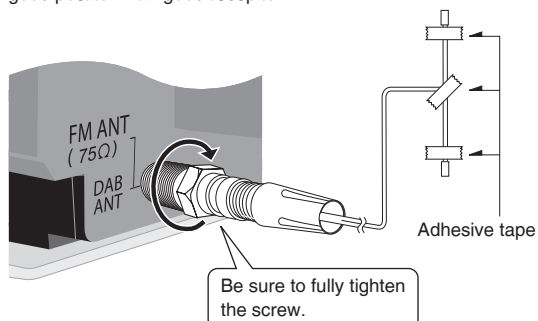

- Tape the antenna to a wall or column, in a position with the least amount of interference.
- Please refer to "Checking the DAB signal quality" (→ page 13).

2 Connect the AC mains lead.

Connect the AC mains lead after all other connections are complete.

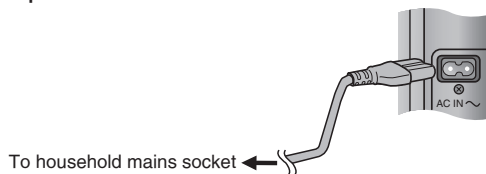

3 Headphones (not included)

Reduce the volume level and connect the headphones.
Plug type: 3.5 mm stereo



- Avoid listening for prolonged periods of time to prevent hearing damage.
- Excessive sound pressure from earphones and headphones can cause hearing loss.
- Listening at full volume for long periods may damage the user's ears.
Be sure to use the supplied or recommended headphones or earphones.

Notes on speakers

- These speakers do not have magnetic shielding. Do not place them near televisions, personal computers or other devices easily influenced by magnetism.
- The speaker nets cannot be removed.

DAB outdoor antenna (Optional)

DAB outdoor antenna (not included)

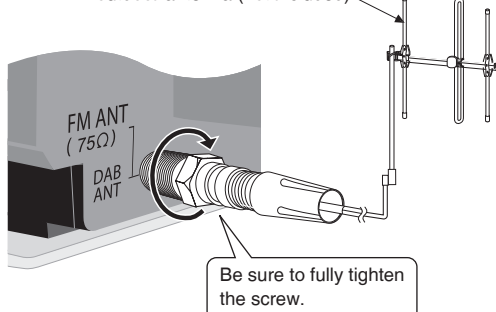

- Use DAB outdoor antenna for better reception.
- The antenna should only be installed by a competent technician.
- Never use the outdoor antenna during lightning storm.
- Please refer to "DAB" (→ page 11).

Attaching the unit to a wall (Optional)

Notes on installation

- Before installation, read the “Safety precautions” and “Wall mount instructions” for correct installation.
- For optimal performance and to prevent potential problems, do not install this unit:
 - at locations other than vertical walls.
 - near a sprinkler or a sensor.
 - near high-voltage lines or power sources.
 - near heating device.
 - at locations where the unit is subject to vibration or impact.
 - near sources of magnetism, heat, vapour, airborne grease, etc.
 - at locations where there may be water droplets (e.g. under an air conditioner).
- Do not install this unit under ceiling lights (e.g. spotlight, halogen light, etc.).
Failure to do so may bend the cabinet or lead to damage caused by high heat.
- Use a proper installation method that suits the structure and material of the wall.
- Use a soft blanket or cloth to prevent damage to the product or floor during installation.
- When tightening screws, make sure the screws are not loosely-tightened or overtightened.
- Secure a safe surrounding area and pay attention to safety during installation.
- Panasonic is not liable for incidental or consequential damages resulting from improper installation or operation.

Safety precautions

WARNING!

Only a qualified building contractor shall install or uninstall this unit.

Improper installation may cause the unit to fall, resulting in injury.

To prevent injury, the unit must be securely attached to the wall in accordance with the installation instructions.

Do not install the unit where it cannot support the load.

If the mounting parts are not strong enough, this may cause the unit to fall, resulting in injury.

Do not use installation methods other than instructed.

This may cause the unit to fall and be damaged, resulting in injury.

Do not install the unit at locations other than vertical walls.

This may cause the unit to fall and be damaged, resulting in injury.

Take the safety factor for mounting strength into account (approx. 10 times the product weight).

Insufficient strength will cause the unit to fall, resulting in injury.

The wall on which the unit is to be attached to should be capable of supporting 20 kg per screw.

Insufficient strength of the walls will cause the unit to fall in the long run.

Do not disassemble or modify the wall-mounting hanger.

This will cause the unit to fall and be damaged, resulting in injury.

CAUTION!

Do not install this unit at humid or dusty locations, or locations where airborne grease or steam may come into contact with the unit, or under an air conditioner where water may drip onto the unit.

This may have negative impact on the unit, resulting in fire or electric shock.

Secure enough space of more than 30 cm above the main unit and more than 10 cm on the left and right sides respectively. Keep space between the wall and rear of the unit clear of obstructions.

Blocking the exhaust holes on the main unit may result in fire.

Use the designated components for installation.

Otherwise, the main unit may fall and be damaged, resulting in injury.

Prevent the mounting screws or power cord from coming into contact with metal parts inside the wall during installation.

Failure to do so may cause electric shock.

When removing the main unit, remove the wall mounting screws as well.

Otherwise the wall mounting screws may hit a person and lead to injury.

Install the unit at a height where the operation buttons can be seen for safe operation.

Operating at improper position may cause the unit to fall and be damaged, resulting in injury.

Installation accessories

■ Included accessories

- Screw accessories (RFAX1020)
 - » 2 Fixing screws **B** (XYN3+J10FJ)
 - » 1 Safety holder (RMKX1015)
- Wall bracket accessories (RFAX1021)
 - » 1 Wall bracket (RGQX1004)
 - » Four-legged cushions (RKAX0028-K)

Keep all the intended accessories out of reach of children to prevent swallowing.

■ Commercially available accessories (not included)

- 2 Wall mounting screws **C**
- 1 Safety holder screw **C**

Use screws with nominal diameter of 4 mm, which are suitable to the material of the wall (e.g. wood, steel, concrete, etc.).

Attaching the unit to a wall (Optional) (continued)

Wall mount instructions

- Before installation, turn the unit off and disconnect the AC mains lead plug from the AC receptacle.
- Tighten screws firmly to prevent slack in each step.

1. Detach the stand from the unit.

- ① Unscrew the fixing screw **A** (2 pieces) at the bottom of the unit. Keep the removed screws in a safe place.
- ② Slide the stand off the unit.

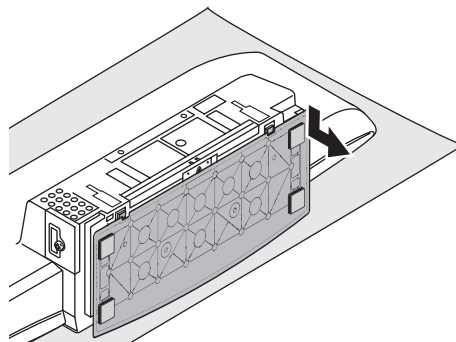
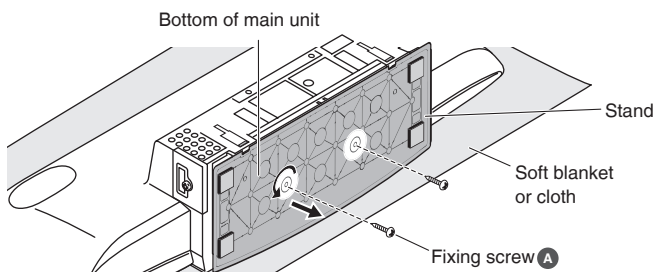

2. Attach the wall bracket to the back of the unit.

- ① Align both tabs on the wall bracket and the main unit, then slide it in until it clicks into place.
- ② Secure the wall bracket with fixing screw **B** (2 pieces). (Tightening torque: 1.2 Nm to 1.5 Nm)

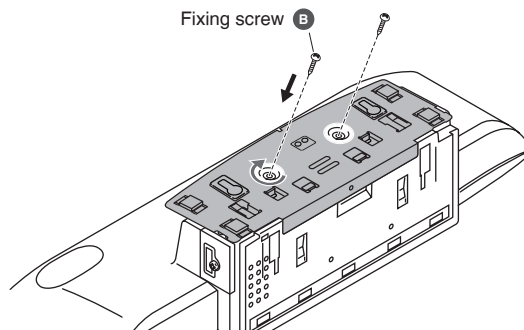
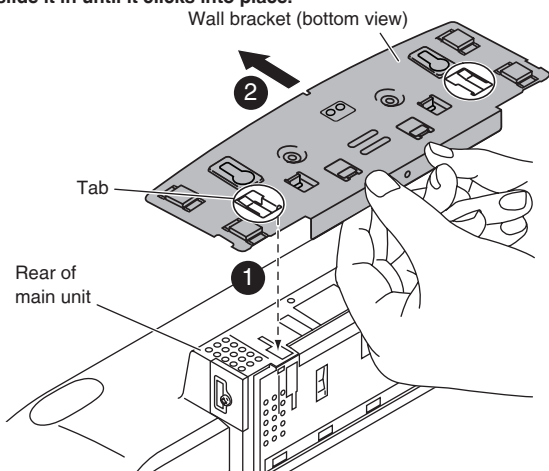

3. Drive the mounting screws into the wall.

- ① Measure and mark the position of the mounting screw **C** (2 pieces) and drive them into the wall.

- Use figures below for screw positions and measurements.
- Please install using both wall mounting screws.
- Use a level ruler to ensure both screws are level.
- Use a screw which is strong enough to support the weight of at least 20 kg.

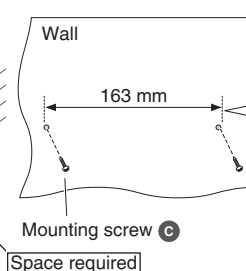
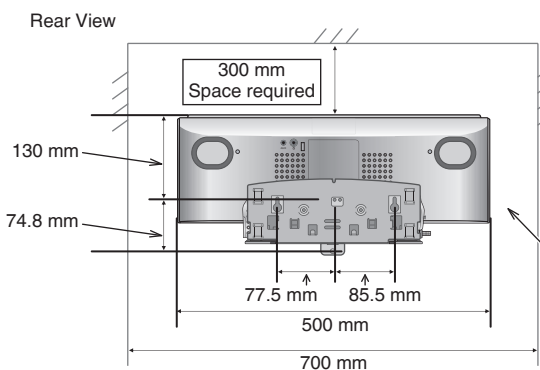

A length which supports the strength of 20 kg or more must be kept for each screw.

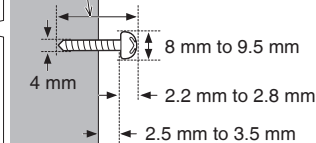

Attaching the unit to a wall (Optional) (continued)

Wall mount instructions (continued)

4. Hang the unit on the wall.

① Hook the unit securely onto the mounting screws **C**.

- Connect the DAB antenna before hanging the main unit on the wall (⇒ page 3).
- After hanging the unit, release your hand carefully to confirm the unit sits securely on the wall.

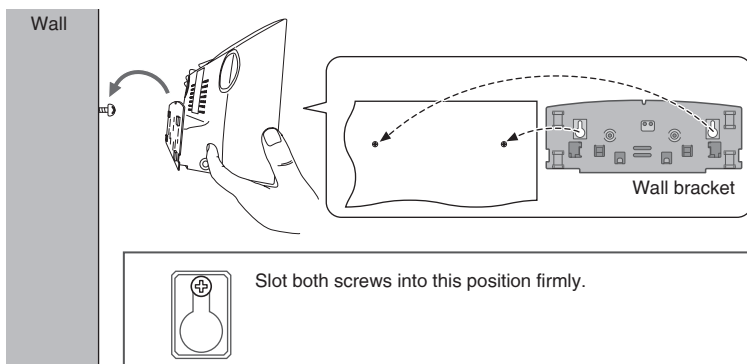

5. Install the safety holder.

- ① Fix the safety holder onto the wall bracket.
- ② Drive safety holder screw **C** to secure the safety holder onto the wall.

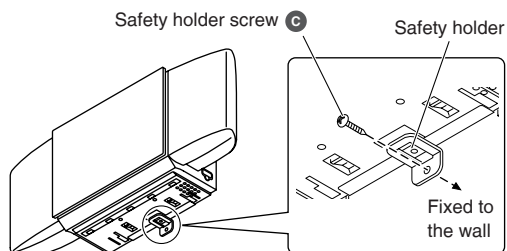

■ Fall-preventive measure (Optional)

- ① Thread a wire (commercially available) through the slot on the wall bracket before step 4 (⇒ above).
 - ② Fix the wire to the wall with a screw (commercially available) after step 5 (⇒ left).
- Fix the screw to the wire so that a slack of no more than 5 cm is kept in the upper centre part of the main unit.

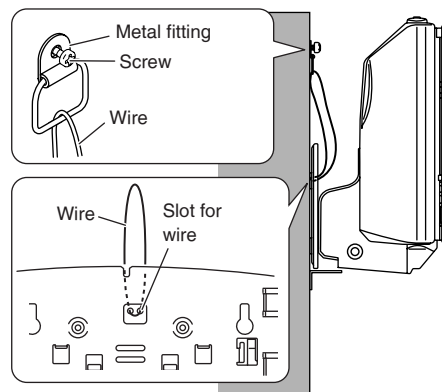

Removing the unit from the wall

- ① Remove safety holder screw **C** and the safety holder.
 - ② Unmount the unit from the wall.
 - ③ Unscrew fixing screw **B** (2 pieces).
 - ④ Hold down both the catches and then slide the wall bracket off the unit (⇒ right).
 - ⑤ Reattach the stand to the bottom of the unit and secure it with fixing screw **A** (2 pieces).
 - ⑥ Remove the mounting screw **C** (2 pieces) from the wall.
- Remove the fall-preventive wire before step ① if you are using it.

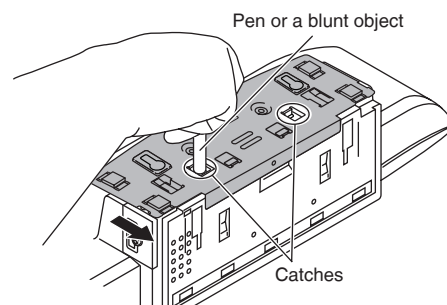

Control guide

Remote control

- Refer to the numbers in parentheses for page reference.

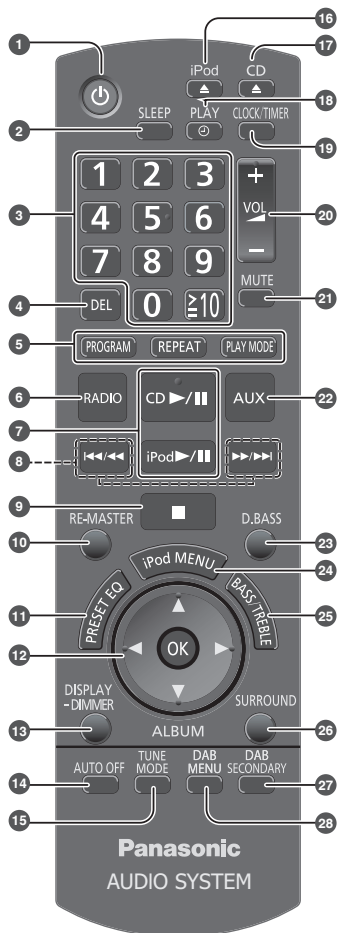

Main unit

- Buttons such as 1 function the same as the remote control. They can be used interchangeably.

Top View

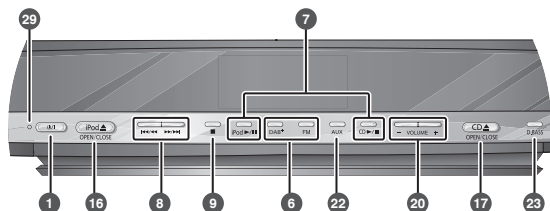

Front View

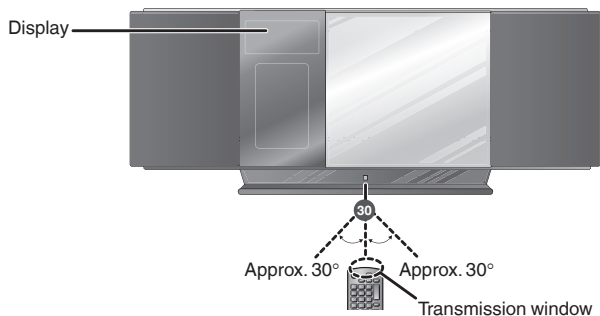

- 1 **Standby/on switch** [⏻], [⏻/⏹] (8, 14, 18)
Press to switch the unit from on to standby mode or vice versa. In standby mode, the unit is still consuming a small amount of power.
- 2 **[SLEEP]** (14)
- 3 **Numeric buttons** [1-9, 0, ≥10] (8, 9, 10, 12, 16)
To select a 2-digit number
e.g. 16: [≥10] → [1] → [6]
To select a 3-digit number
e.g. 226: [≥10] → [≥10] → [2] → [2] → [6]
- 4 **[DEL]** (9)
- 5 **[PROGRAM]** (9, 10, 12)
[REPEAT] (9)
[PLAY MODE] (9, 10, 12, 16)
- 6 **[RADIO]**, **[DAB]**, **[FM]** (10, 12)
- 7 **[CD ▶/⏸]** (8, 9)
[iPod ▶/⏸] (15)
- 8 **[◀◀/▶▶]**, **[▶▶▶▶]** (8, 9, 10, 12, 15)
- 9 **[■]** (8, 9, 15)
- 10 **[RE-MASTER]** (14)
- 11 **[PRESET EQ]** (14)
- 12 **[▲, ▼]**, **[◀, ▶]** (8, 9, 13, 14, 15)
[OK] (9, 13, 14, 15, 16)
- 13 **[DISPLAY, -DIMMER]** (9, 12)
Press and hold to dim the display panel. Press and hold again to cancel.
- 14 **[AUTO OFF]**
This function allows you to turn the unit off (except in radio mode) after the unit is left unused for about 30 minutes. Press twice to turn it on.
- 15 **[TUNE MODE]** (10)
- 16 **[▲, iPod]**, **[iPod ▲, OPEN/CLOSE]** (15)
- 17 **[▲, CD]**, **[CD ▲, OPEN/CLOSE]** (8)
- 18 **[⏻]**, **[PLAY]** (14)
- 19 **[CLOCK/TIMER]** (14)
- 20 **[+, VOL ▲, -], [- VOLUME +]**
- 21 **[MUTE]**
Mutes the sound. Press again to cancel. "MUTE" is also cancelled when the volume is adjusted or the unit is turned off.
- 22 **[AUX]** (16)
- 23 **[D.BASS]** (14)
- 24 **[iPod MENU]** (15)
- 25 **[BASS/TREBLE]** (14)
- 26 **[SURROUND]** (14)
- 27 **[DAB SECONDARY]** (12)
- 28 **[DAB MENU]** (13)
- 29 **Standby indicator**
- 30 **Remote control signal sensor**
Aim the remote control at the sensor, avoiding obstacles, at a maximum range of 7 m directly in front of the unit.

Control guide (continued)

Preparing the remote control

Place this side in before the other side.

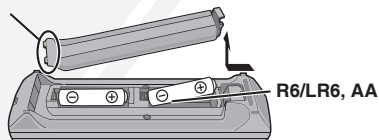

Do not:

- mix old and new batteries.
- use different types of batteries at the same time.
- take apart or short-circuit the batteries.
- attempt to recharge alkaline or manganese batteries.
- use the batteries if the coverings have been peeled off.

Batteries

- Use a manganese dry battery or an alkaline dry battery.
- Insert so the poles (+ and -) match those in the remote control.
- Remove if the remote control is not going to be used for a long period of time.
- Store in a cool and dark place.
- Do not heat or expose to flame.
- Do not leave the batteries in an automobile exposed to direct sunlight for a long period of time with doors and windows closed.
- Mishandling of batteries in the remote control can cause electrolyte leakage, which may cause a fire.

Disc operations

Inserting a disc

- ① Press [⏻] to turn the unit on.
- ② Press [⏮, CD] to open the sliding door.

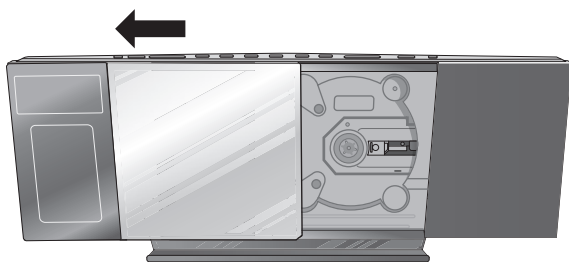

- ③ With the label of the disc facing towards you, tilt the disc into the disc tray under the sliding door.

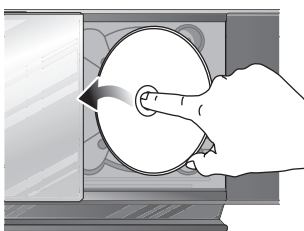

- ④ Place the disc onto the spindle in the centre and then push the disc down until it clicks into place.

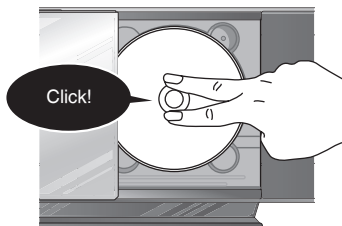

- ⑤ Press [⏮, CD] to close the sliding door.

Keep fingers away from the sliding door when it is closing to avoid possible minor injuries.

Removing a disc

- ① Press [⏮, CD] to open the sliding door.
 - ② Hold the centre and the top right of the disc and pull the top right of the disc to unlock it from the spindle.
 - ③ Tilt the disc so as not to touch the sliding door and remove the disc.
- Damage may occur if the sliding door is forced closed.
 - Be careful of CD hitting the sliding door while being removed.

Basic play

- ① Press [⏻] to turn the unit on.
- ② Insert the disc to be played (→ left).
- ③ Press [CD ▶/⏮] to start play.

Stop	Press [■].
Pause	Press [CD ▶/⏮]. Press again to resume play.
Skip track	Press [⏮/⏮] or [▶/▶].
Search the current track (CD)	Press and hold [⏮/⏮] or [▶/▶].
Skip album (MP3)	Press [▲, ▼].
Direct access play (Play starts with the track you select.)	CD: Press the numeric buttons to select the track. MP3: ① Press [▲, ▼] to select the album. ② Press [▶/▶] once and then the numeric buttons to select the track.

Disc operations (continued)

Program play

Enables you to program up to 24 tracks.

① Press [CD ►/II] and then [■].

② Press [PROGRAM].

CD: ③ Press the numeric buttons to select the track.

To program more tracks, continue by pressing the numeric buttons.

④ Press [OK] or [CD ►/II] to start play.

MP3: ③ Press [▲,▼] to select the album.

④ Press [►►/►►] once and then the numeric buttons to select the track.

⑤ Press [OK].

To program more tracks, repeat step ③ to ⑤.

⑥ Press [CD ►/II] to start play.

Cancel program mode	Press [PROGRAM] in the stop mode to clear "PGM" indicator from the display.
Replay the program	Press [PROGRAM] in the stop mode and then [CD ►/II].
Check program contents	Press [◀◀/▶▶] or [►►/►►] when "PGM" is displayed in the stop mode. To check while programming, press [PROGRAM] twice after "PGM" appears and then press [◀◀/▶▶] or [►►/►►].
Delete last programmed track	Press [DEL] in the stop mode.
Clear all programmed tracks	Press [■] in the stop mode. "CLR ALL" is displayed. Within 5 seconds, press the button again to clear all tracks.

- The program memory is cleared when you open the sliding door.

Display function

Press [DISPLAY, –DIMMER] repeatedly during play or pause to view the current track's information.

- Maximum number of displayable characters: approximately 30
- This unit supports ver. 1.0 and 1.1 ID3 tags. Text data that is not supported will not be displayed.

Play Mode function

① Press [CD ►/II].

② Press [PLAY MODE] repeatedly to select the following modes.

Mode	To play
1-TRACK 1TR	one selected track on the disc. Press the numeric buttons to select the track.
1-ALBUM 1ALBUM (MP3)	one selected album on the disc. Press [▲,▼] to select the album.
RANDOM RND	a disc randomly.
1-ALBUM RANDOM 1ALBUM RND (MP3)	all tracks in one selected album randomly. Press [▲,▼] to select the album.

- During random play, you cannot skip to the previous track.
- The current play mode is cleared when you open the sliding door.
- To repeat program play or selected play mode, press [REPEAT]. Press again to cancel.

Notes on CD-R and CD-RW

- This unit can play CD-R and CD-RW recorded with CD-DA or MP3.
- Use an audio recording disc for CD-DA and finalise* it when you finish recording.
* A process performed after recording that enables CD-R or CD-RW players to play audio CD-R and CD-RW.
- The unit may not be able to play some discs due to the condition of the recording.
- Do not use irregularly shaped CDs.
- Do not attach extra labels and stickers.
- Do not use CDs with labels and stickers that are coming off or with excessive adhesive under the labels and stickers.
- Do not attach scratch-proof covers or any other kind of accessories.
- Do not write anything on the CDs.
- Do not clean CDs with liquids (Wipe with a soft and dried cloth).

Creating MP3 files playable on this unit

- Maximum number of tracks and albums: 999 tracks and 255 albums.
- Compatible compression rate: Between 64 kbps and 320 kbps (stereo). 128 kbps (stereo) is recommended.
- Disc formats: ISO9660 level 1 and level 2 (except for extended formats).
- The time for reading TOC depends on the number of the tracks, folders or folder structures.

Limitations on MP3

- This unit is compatible with multi-sessions and it takes more time to start playing.
- This unit cannot play files recorded using packet write.
- If the disc includes both MP3 and normal audio data (CD-DA), the unit plays the type recorded in the inner part of the disc.
If the disc includes both MP3 and other types of audio data (e.g. WMA or WAV), the unit plays only the MP3.
- Depending on how you create the MP3 files, they may not play in the order you numbered them or may not play at all.

Radio operations

Manual tuning

- ① Press [RADIO] to select "FM".
- ② Press [TUNE MODE] to select "MANUAL".
- ③ Press [◀◀/◀◀] or [▶▶/▶▶] to select the frequency of the required station.
"ST" is displayed when a stereo FM broadcast is being received.

To tune automatically

- ① Repeat step ① and ② (⇒ above).
 - ② Press and hold [◀◀/◀◀] or [▶▶/▶▶] until the frequency starts changing rapidly.
- To cancel auto tuning, press [◀◀/◀◀] or [▶▶/▶▶] once again.
 - Auto tuning may not function when there is excessive interference.

■ To improve FM sound quality

Press and hold [PLAY MODE] to display "MONO" indicator. Press and hold again to cancel.

- "MONO" is also cancelled if the frequency is changed.
- Turn "MONO" off for normal listening.

Memory preset

You can preset up to 30 FM channels.

Preparation: Press [RADIO] to select "FM".

■ Automatic presetting

- ① Press [PLAY MODE] to switch between "LOWEST" and "CURRENT" frequency.
- ② Press and hold [PROGRAM] for at least 2 seconds to start presetting.

■ Manual presetting

- ① Press [TUNE MODE] to select "MANUAL".
- ② Press [◀◀/◀◀] or [▶▶/▶▶] to tune to the required station.
- ③ Press [PROGRAM].
- ④ Press the numeric buttons to select a channel.
The station occupying a channel is erased if another station is preset in that channel.
- ⑤ To preset more stations, repeat step ② to ④.

■ Selecting a preset station

- ① Press [TUNE MODE] to select "PRESET".
 - ② Press [◀◀/◀◀] or [▶▶/▶▶] to select the channel.
- Alternatively, press the numeric buttons to select the channel.

DAB

DAB (Digital Audio Broadcasting) is a new form of radio that is broadcast digitally. Unlike regular analogue broadcasting, digital radio deteriorates less, and is thus able to provide quality sound closer to that of a disc.

DAB structure

Bands

There are two types of DAB bands, "BAND III" (receivable in this unit) and "L BAND" (not broadcast in Australia and not receivable on this unit).

Frequencies

There are 38 frequencies on BAND III. Among these, 3 are used in Australia (current as of March, 2010).

Ensemble, station and service

The number of stations that makes up one frequency differs between DAB and analogue radio. Analogue stations broadcast on different frequencies, even if it is the same company doing the broadcasting. With DAB, however, it is possible to broadcast a number of stations on the same frequency.

In DAB terminology, an ensemble represents a group of stations on the same frequency.

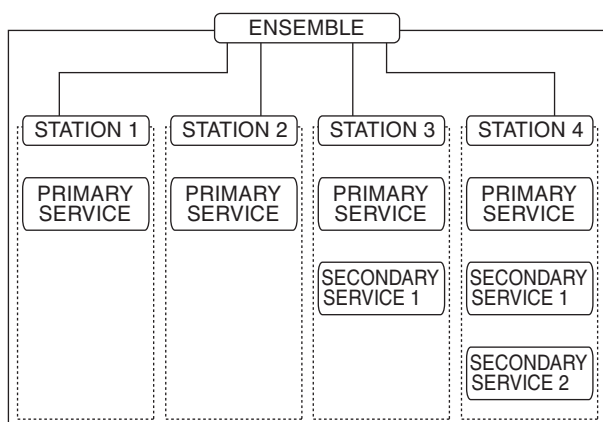

As shown in the diagram, an ensemble consists of a group of stations with primary services and secondary services. This means, for example, that commentary on sports events from different areas can all be broadcast at once.

DAB reception method on this unit

Depending on the region, there is a difference between broadcast frequency and stations broadcast along the same frequency. For this reason, a memory of receivable stations should first be created and then selected from those memorised stations as the reception method.

DAB Auto scan

This function searches for currently receivable stations and inputs them into the unit memory.

When DAB is selected for the first time, this function starts automatically.

- Depending on some factors such as the broadcasting time availability, the station may not broadcast even if it is stored into the memory. If this occurs, "NO SERVICE" is displayed.

Station memory updating

When there is a station name change, or a new station begins broadcasting, the unit memory is automatically updated when:

- the previous station name is displayed by selecting "STATION TUNE".
- the new station is displayed by selecting "STATION TUNE" where another station has already broadcast on the same frequency.

Deleting stations that are no longer broadcasting is not automatic. If you want to delete a station, perform Auto scan again and a new memory will be created.

When a new frequency begins broadcasting, stations on the new frequency are not automatically added to the memory. Perform Auto scan to add them to the memory. You may also need to change the Auto scan range if the new frequency is outside the factory-set Auto scan range (⇒ page 13).

Station tune

You can select stations from the memory created (⇒ page 12) in alphanumeric order.

You can easily select your favourite stations by using presets (⇒ page 12).

DAB (continued)

DAB operation

- 1 Press [RADIO] to select "DAB+".

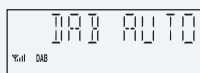

If you are selecting DAB for the first time, "DAB AUTO SCAN" is displayed, stations that are currently receivable are memorised.



When a frequency is tuned, the ensemble corresponding to the frequency is displayed.

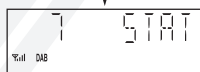
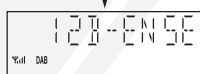

Total number of receiving stations is displayed.

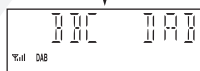

The station first in alphanumeric order is broadcast.

- "SCAN FAILED" appears if no stations are memorised. If this occurs, adjust the antenna and try Auto scanning or change the Auto scan frequency range (➡ page 13).

- 2 Press [PLAY MODE] to select "STATION TUNE".

Each time you press the button:

"STATION TUNE" ↔ "PRESET TUNE"

- 3 Press [◀◀/▶▶] or [▶▶/▶▶] to select a station.

The station name changes in alphanumeric order.

DAB Auto scan

Press and hold [PLAY MODE] until "DAB AUTO SCAN" appears.

When a frequency is tuned using Auto scanning, the ensemble corresponding to the frequency is displayed for approximately 2 seconds.

- When updating memory with Auto scan, preset stations will be erased. Preset them again (➡ right).
- Total stations received is displayed for approximately 2 seconds.

Presetting

■ Presetting channel

- 1 Press [◀◀/▶▶] or [▶▶/▶▶] to select the station.

- 2 Press [PROGRAM].

- 3 Press the numeric buttons to select the channel.

The station occupying a channel is erased if another station is preset in that channel.

- 4 To preset more stations, press [PLAY MODE] to select "STATION TUNE" and then repeat steps 1 to 3.

- Maximum channels presettable is 20.
- You cannot preset stations when the station is not broadcasting or when the secondary service is selected.

■ Selecting a preset channel

- 1 Press [PLAY MODE] to select "PRESET TUNE".

- 2 Press [◀◀/▶▶] or [▶▶/▶▶] to select the channel.

- Alternatively, press the numeric buttons to select the channel.

Listening to the secondary service

Press the [DAB SECONDARY] to select the secondary service.

"S" is displayed if there is a secondary service broadcast.

The secondary services are selected each time the button is pressed. The primary service is returned to after the last secondary service.

Display

Press [DISPLAY, -DIMMER] to select the display.

The information scroll through the display.

Each time you press the button:

Dynamic label
(information about the broadcast)

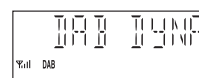

PTY display
(program type)

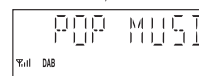

Ensemble label
(the name of the ensemble)

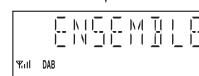

Frequency display

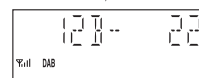

Time display



◀◀ DAB (continued)

Turning automatic clock adjustment function on

To adjust the time information during DAB broadcasting and automatic time adjustment.

- ① Press [DAB MENU] to enter menu mode.
- ② Within 10 seconds, press [▲,▼] to select "AUTO CLOCK ADJ." and then press [OK].



- ③ Within 10 seconds, press [▲,▼] to select "ON ADJUST" and then press [OK].



- Select "OFF ADJUST" to turn the automatic clock adjustment function off.

To exit

Press [DAB MENU] again.

Checking the DAB signal quality

To improve reception by adjusting the antenna while monitoring signal quality on the display.

- ① Press [DAB MENU] to enter menu mode.
"SCAN FAILED" appears if no stations are memorised. If this occurs, adjust the antenna and try Auto scanning or change the Auto scan frequency range (⇒ right).
- ② Within 10 seconds, press [▲,▼] to select "SIGNAL QUALITY" and then press [OK].



- ③ Press [▲,▼] to select the frequency.

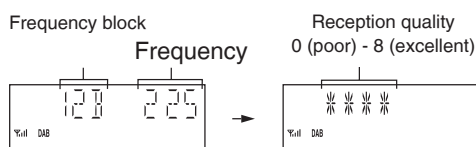

To exit

Press [DAB MENU] again.

- In order to enjoy the new stations after adjusting the antenna, perform Auto scanning and update the station memory.

Changing the Auto scan frequency range

Only the frequencies currently used in Australia as of March 2010 on BAND III are Auto scanned ("AUSTRALIA", factory setting).

Select "ALL BAND III" when you want to store stations on other frequencies to memory.

- ① Press [DAB MENU] to enter menu mode.
- ② Within 10 seconds, press [▲,▼] to select "DAB SCAN MODE" and then press [OK].



- ③ Within 10 seconds, press [▲,▼] to select "AUSTRALIA" or "ALL BAND III" and then press [OK].



- Auto scan begins automatically after the change has been made.

To exit

Press [DAB MENU] again.

- The DAB preset channels are erased when the "DAB SCAN MODE" is changed.
- If the DAB play timer has been set, the timer switches to off.

ALL BAND III Frequency

Frequency block	Frequency (MHz)	Frequency block	Frequency (MHz)
5A	174.928	9D	208.064
5B	176.640	10A	209.936
5C	178.352	10B	211.648
5D	180.064	10C	213.360
6A	181.936	10D	215.072
6B	183.648	11A	216.928
6C	185.360	11B	218.640
6D	187.072	11C	220.352
7A	188.928	11D	222.064
7B	190.640	12A	223.936
7C	192.352	12B	225.648
7D	194.064	12C	227.360
8A	195.936	12D	229.072
8B	197.648	13A	230.784
8C	199.360	13B	232.496
8D	201.072	13C	234.208
9A	202.928	13D	235.776
9B	204.640	13E	237.488
9C	206.352	13F	239.200

Shaded areas are frequencies used currently as of March 2010 in "Australia".

Timer

Setting the clock

This is a 24-hour clock.

- ① Press **[CLOCK/TIMER]** to select "CLOCK".
- ② Within 5 seconds, press **[▲, ▼]** to set the time. (Press and hold to change the time faster.)
- ③ Press **[OK]**.
 - To display the clock, press **[CLOCK/TIMER]**.
 - Reset the clock regularly to maintain accuracy.

Play timer

You can set the timer to come on at a certain time to wake you up.

This unit offers 3 optional play timers.

Preparation:

- Turn the unit on and set the clock (➡ above).
- Prepare the music source (disc, radio, iPod/iPhone or AUX) and set the volume.

- ① Press **[CLOCK/TIMER]** repeatedly to select play timer.
- ② Within 5 seconds, press **[▲, ▼]** to set the starting time.
- ③ Press **[OK]**.
- ④ To set the finishing time, repeat step ② and ③.

To activate the timer

- ⑤ Press **[⏮, PLAY]** repeatedly to turn the selected play timer on.
- ⑥ Press **[⏻]** to turn the unit off.

Change the settings	Repeat step ① to ④ (➡ above).
Change the source or volume	① Press [⏮, PLAY] twice to clear ⏮PLAY indicator from the display. ② Make changes to the source or volume. ③ Perform step ⑤ and ⑥ (➡ above).
Check the settings (When the unit is on or in standby mode)	Press [CLOCK/TIMER] repeatedly to select "⏮PLAY 1", "⏮PLAY 2" or "⏮PLAY 3".
Cancel	Press [⏮, PLAY] twice to clear the timer indicator from the display.

- The timer will start at the preset time, with the volume increasing gradually to the preset level.

Sleep timer

The sleep timer can turn the unit off after a set time.

Press **[SLEEP]** to turn the sleep function on or off.

30MIN → 60MIN → 90MIN → 120MIN
 ↑ OFF (Cancelled) ↓

Press **[SLEEP]** once to check the remaining time.

- The play timer and sleep timer can be used together. The sleep timer always has the priority. Be sure not to overlap the timer settings.
- When AUTO OFF is ON and the unit is left unused for about 30 minutes, the unit will shut down even if the play time or sleep time has not expired.

Sound adjustment

Preset EQ	Press [PRESET EQ] repeatedly to select "HEAVY", "SOFT", "CLEAR", "VOCAL" or "FLAT".
Bass or Treble	① Press [BASS/TREBLE] repeatedly to select "BASS" or "TREBLE". ② Press [▲, ▼] to adjust the level (-4 to +4).
Surround Sound	Press [SURROUND] repeatedly during play to select "ON SURROUND" or "OFF SURROUND". If interference in FM stereo reception increases, cancel the surround sound effect.
D.Bass	Press [D.BASS] repeatedly during play to select "ON D.BASS" or "OFF D.BASS".
Re-master	Press [RE-MASTER] repeatedly during play to select "ON RE-MASTER" or "OFF RE-MASTER". <ul style="list-style-type: none"> • Digital remaster is effective on MP3. • Analogue remaster is effective on iPod/iPhone and AUX.

External unit

Enjoying audio from iPod or iPhone

■ Inserting an iPod/iPhone

- ① Press [**▲**, iPod] to open the sliding door.
- ② Insert the suitable dock adapter (not included) for the iPod/iPhone.
Insert the side of the iPod/iPhone dock adapter with the clips facing towards you first and then push the opposite side until it clicks into place.

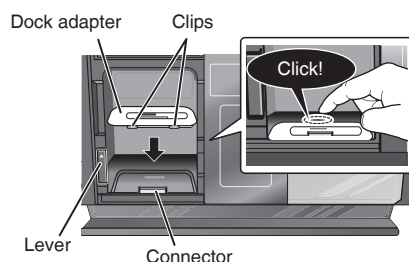

- ③ Press [**▲**] to unlock the iPod/iPhone dock and then pull the docking switch lever to tilt the iPod/iPhone dock.

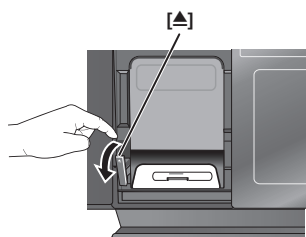

- ④ Connect the iPod/iPhone (not included) firmly.
Be sure to remove the iPod/iPhone from its case.

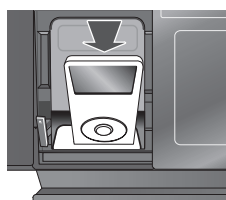

- ⑤ Push the docking switch lever back until it clicks into place.

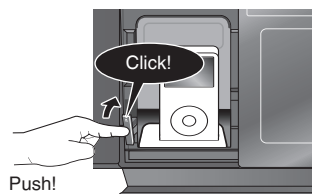

- ⑥ Press [**▲**, iPod] to close the sliding door.

■ Removing an iPod/iPhone

- ① Repeat step ① and ③ (⇒ left).
 - ② To remove, simply pull the iPod/iPhone straight out to disconnect it.
 - ③ Repeat step ⑤ and ⑥ (⇒ left).
- If the iPod/iPhone dock is not tilted when connecting or disconnecting the iPod/iPhone, it may cause damage to the connector.
 - When inserting an iPod/iPhone into the unit, be sure to use the dock adapter either supplied with the iPod/iPhone or commercially available from Apple Inc.
 - Reduce the volume of the main unit to minimum before connecting or disconnecting the iPod/iPhone.

Play	Press [iPod ▶/].
Pause	Press [iPod ▶/] or [■].
Skip track	Press [◀◀/▶▶] or [▶▶/▶▶].
Search the current track	Press and hold [◀◀/▶▶] or [▶▶/▶▶].
Display iPod/iPhone menu/ return to previous menu	Press [iPod MENU] in the play mode. (Remote control only)
Select contents from iPod/iPhone menu	Press [▲, ▼] and then [OK]. (Remote control only)

Notes on iPhone:

- All phone features can only be controlled by the iPhone's touch screen.
- The unit does not display incoming calls or the phone status.
- The ringtone of incoming call can be heard from the iPhone's speaker. When the unit is in iPod/iPhone mode, the ringtone can also be heard from the unit's speakers.
- Connecting or disconnecting the iPhone from the unit will not cancel a call.
- There is no Apple Inc. specification that will guarantee the iPhone responses above. iPhone responses may vary on new iPhone models or iPhone new software updates.

External unit (continued)

■ Charging the iPod/iPhone

- When iPod/iPhone is being charged in standby mode, "IPOD CHARGING" is shown on the main unit's display.
- Check iPod/iPhone to see if the battery is fully charged. If you are not using iPod/iPhone for an extended period of time after recharging has completed, disconnect it from the main unit as the battery will be depleted naturally. (Once fully recharged, additional recharging will not occur.)

■ Compatible iPod

Name	Memory size
iPod nano 5th generation (video camera)	8 GB, 16 GB
iPod touch 2nd generation	8 GB, 16 GB, 32 GB, 64 GB
iPod classic	120 GB, 160 GB (2009)
iPod nano 4th generation (video)	8 GB, 16 GB
iPod classic	160 GB (2007)
iPod touch 1st generation	8 GB, 16 GB, 32 GB
iPod nano 3rd generation (video)	4 GB, 8 GB
iPod classic	80 GB
iPod nano 2nd generation (aluminum)	2 GB, 4 GB, 8 GB
iPod 5th generation (video)	60 GB, 80 GB
iPod 5th generation (video)	30 GB
iPod nano 1st generation	1 GB, 2 GB, 4 GB
iPod 4th generation (colour display)	40 GB, 60 GB
iPod 4th generation (colour display)	20 GB, 30 GB
iPod 4th generation	40 GB
iPod 4th generation	20 GB
iPod mini	4 GB, 6 GB

■ Compatible iPhone

Name	Memory size
iPhone 3GS	16 GB, 32 GB
iPhone 3G	8 GB, 16 GB
iPhone	4 GB, 8 GB, 16 GB

- Compatibility depends on the software version of the iPod/iPhone.

Portable audio equipment (during AUX mode)



AUX

- ① **Plug the audio cord into the AUX jack.**

Plug type: 3.5 mm stereo

- ② **Press [AUX] and start playback from the portable audio source.**

You can select the sound input level of the portable audio equipment. Press [PLAY MODE] repeatedly to select "HIGH" or "NORMAL".

- Switch the equalizer off or turn the volume of the portable equipment down to reduce the input signal. High level of input signal will distort the sound.
- For details, refer to the instruction manual of the other equipment.
- Cords and equipment are not included.

Changing the main unit and remote control mode

The remote control and main unit are factory-set to "REMOTE 1" mode. If you find the remote control unintentionally also controls other equipment, you can switch to operate in "REMOTE 2" mode.

To switch to "REMOTE 2" mode (by main unit only)

- ① **Press and hold [AUX] and then press [2] until "REMOTE 2" is displayed.**
- ② **Press and hold [OK] and [2] for at least 2 seconds.**

To return to "REMOTE 1" mode

Repeat the steps above but replace [2] with [1]. ("REMOTE 1" will be displayed.)

◀◀ Troubleshooting guide

Before requesting service, make the following checks. If you are in doubt about some of the check points, or if the remedies indicated in the chart do not solve the problem, consult your dealer for instructions.

■ Common problems

Incorrect display or play will not start

- You have not inserted the disc properly. Insert it correctly.
- The disc is scratched or dirty (Tracks skipped).
- There is moisture on the lens. Wait for about an hour and then try again.

MP3 cannot be read

- You may not be able to play MP3 if you have copied a multi-session disc that has no data between sessions.
- When creating a multi-session disc, it is necessary to close the session.
- The amount of data on the disc is too small. Set the amount of data to above 5 MB.

Noise is heard or no sound

- While playing MP3, noise may occur if the recording is poor.
- Keep this unit away from mobile phones if the interference is apparent.
- Turn the volume up.
- Switch the unit off, check and correct the connection and then switch the unit on. Causes include straining of the speakers through excessive volume or power and using the unit in a hot environment.

Humming heard during play

- An AC mains lead or fluorescent light is near the cords. Keep other appliances and cords away from this unit's cables.

A beat sound or noise is heard while receiving radio broadcast

- Switch the television or other audio player off or separate it from the unit.
- Switch the portable audio player off if connected to the AUX port.

The picture on the television near the unit disappears or stripes appear on the screen

- The location and orientation of the antenna are incorrect.
- The television antenna wire is too close to the unit. Separate the antenna wire of the television from the unit.

No response when remote control buttons are pressed

- Check that the batteries are inserted correctly (⇒ page 8).

■ Display

"--:--"

- You plugged the AC mains lead in for the first time or there was a power failure recently. Set the time (⇒ page 14).

"ADJUST CLOCK"

- Clock is not set. Adjust the clock accordingly.

"ADJUST TIMER"

- Play timer is not set. Adjust the play timer accordingly.

"PGM FULL"

- The number of programmed tracks is limited to 24. No further tracks can be programmed.

"NO PLAY"

- A CD-ROM disc that is not in CD-DA or MP3 format is inserted. It cannot be played.

"ERROR"

- Incorrect operation is performed. Read the instructions and try again.

"F61" or "F76"

- There is a power supply problem. Consult the dealer.

"AUTO OFF"

- The unit has been left unused for about 29 minutes and will shut down in a minute. Press any button to cancel it.

"ILLEGAL OPEN"

- Sliding door is not in correct position. Turn the unit off and on again.

"NODEVICE"

- The iPod/iPhone device is not inserted correctly. Read the instructions and try again (⇒ page 15).

"REMOTE 1"

- The main unit is in "REMOTE 1" mode. Switch the remote control to "REMOTE 1" mode (⇒ page 16).

"REMOTE 2"

- The main unit is in "REMOTE 2" mode. Switch the remote control to "REMOTE 2" mode (⇒ page 16).

■ DAB

DAB reception is poor

- Keep the antenna away from computers, televisions, other cables and cords.
- Use an outdoor antenna (⇒ page 3).

"DATA"

- Data broadcast being received over the DAB broadcast signal, cannot be used on this unit.

"SCRAMBLED"

- The broadcast station being received cannot be accessed.

"NO SERVICE"

- The station is currently not broadcasting.

"NO SIGNAL"

- This station cannot be received. Check your antenna (⇒ page 3).

"SCAN FAILED"

- Stations are not receivable. Check your antenna and try Auto scanning (⇒ page 3, 12, 13).

"STATION FULL"

- DAB station memory is full. Use the following method to clear station memory.
 - ① Press **[DAB MENU]**.
 - ② Press **[▲, ▼]** to select "STATION CLEAR".
 - ③ Press **[OK]**. "OK? Push OK" is displayed.
 - ④ Press **[OK]**.Station memory is erased and the unit automatically begins Auto scanning.

■ iPod/iPhone

iPod/iPhone does not turn on

- Verify that the iPod/iPhone battery is not depleted before connecting it to the unit.
- Before inserting the iPod/iPhone into the dock, turn both the unit and the iPod/iPhone off. Turn the power on and select the appropriate source.

No sound is heard from the speakers

- The iPod/iPhone is not inserted correctly into the dock. Turn the iPod/iPhone off and remove it from the dock connector. Reinsert it and turn it on again.
- Make sure that the iPod/iPhone is actually playing something.
- Adjust the volume.

Distorted sound or the sound level is too low

- Make sure the equalizer function of the iPod/iPhone is turned off.

iPod/iPhone cannot be controlled by the remote control or main unit

- Make sure the iPod/iPhone is inserted properly into the dock.
- Check the dock connection and make sure that iPod/iPhone is selected as the source of music (⇒ page 15).

iPod/iPhone does not charge

- Check all connections (⇒ page 3, 15).

Memory reset (Initialization)

When the following situations occur, reset the memory:

- There is no response when buttons are pressed.
- You want to clear and reset the memory contents.

To reset memory

- ① **Disconnect the AC mains lead.** (Wait for at least 3 minutes before proceeding to step 2.)
- ② **While pressing and holding down [⏻/I] on the main unit, reconnect the AC mains lead.**
“-----” appears on the display.
- ③ **Release [⏻/I].**
All the settings are returned to the factory preset. You will need to reset the memory items.

Maintenance

■ Pull out the power plug from the outlet for maintenance beforehand and then wipe it using a soft and dried cloth.

- When dirt is heavy, wring the cloth moistened in water tightly to wipe the dirt, and then wipe it with a dried cloth.
- Do not use solvents such as benzine, thinner, alcohol and detergent, which may deform the coating of the outer case.
- When using a chemical cloth, follow the precautions.

■ Care on the CD lens

- Clean the lens regularly to prevent malfunctions. Use a blower to remove dust and a cotton swab if it is extremely dirty.
- Do not use the lens cleaner of the CD type.

Specifications

■ AMPLIFIER SECTION

RMS Output Power

Front Ch (both ch driven) 20 W per channel (6 Ω), 1 kHz, 10 % THD

Total RMS power 40 W

Phone jack

Terminal Stereo, 3.5 mm jack

Output level (CD, 1 kHz, -20 dB) max. 0.2 mW + 0.2 mW, 32 Ω

Aux (Rear)

Terminal Stereo, 3.5 mm jack

■ TUNER SECTION

Preset Memory

FM 30 stations

Frequency Modulation (FM)

Frequency range 87.50 MHz to 108.00 MHz (50 kHz step)

Antenna terminals 75 Ω (unbalanced)

■ DAB SECTION

DAB memories

20 channels

Frequency Band (Wavelength)

Australia 9A to 9C

(202.928 MHz to 206.352 MHz)

Band III (Europe/Australia) 5A to 13F

(174.928 MHz to 239.200 MHz)

Intermediate Frequency

2.048 MHz

Sensitivity *BER 4x10⁻⁴

Max input power 0 dBm

Min requirement -98 dBm

DAB External Antenna

Terminal F - Connector (75 Ω)

■ DISC SECTION

Disc played [8 cm or 12 cm]

(1) CD-Audio (CD-DA)

(2) CD-R/RW (CD-DA, MP3)

(3) MP3*

* MPEG-1 Layer 3, MPEG-2 Layer 3

Pick up

Wavelength 795 nm

Laser power CLASS 1

Audio Output (Disc)

Number of channels FL, FR, 2 channel

■ SPEAKER SECTION

Type 1 way, 1 speaker system (Passive Radiator)

Speaker unit(s)

Full range 6.5 cm Cone type x 1 / channel

Passive Radiator 8 cm x 2 / channel

Impedance 6 Ω

■ GENERAL

Power supply

AC 220 V to 240 V, 50 Hz

Power consumption

31 W

Dimensions (W x H x D)

500 mm x 201 mm x 102 mm

(D = 69 mm minimum)

Mass

Approx. 2.8 kg

Operating temperature range

0 °C to +40 °C

Operating humidity range

35 % to 80 % RH (no condensation)

Power consumption in standby mode:	0.09 W (approx.)
---	-------------------------

- Specifications are subject to change without notice.
- Total harmonic distortion is measured by the digital spectrum analyser.

◀◀ Safety precautions

Placement

Set the unit up on an even surface away from direct sunlight, high temperatures, high humidity, and excessive vibration. These conditions can damage the cabinet and other components, thereby shortening the unit's service life.

Do not place heavy items on the unit.

Voltage

Do not use high voltage power sources. This can overload the unit and cause a fire.

Do not use a DC power source. Check the source carefully when setting the unit up on a ship or other place where DC is used.

AC mains lead protection

Ensure the AC mains lead is connected correctly and not damaged. Poor connection and lead damage can cause fire or electric shock. Do not pull, bend, or place heavy items on the lead.

Grasp the plug firmly when unplugging the lead. Pulling the AC mains lead can cause electric shock.

Do not handle the plug with wet hands. This can cause electric shock.

Foreign matter

Do not let metal objects fall inside the unit. This can cause electric shock or malfunction.

Do not let liquids get into the unit. This can cause electric shock or malfunction. If this occurs, immediately disconnect the unit from the AC mains supply and contact your dealer.

Do not spray insecticides onto or into the unit. They contain flammable gases which can ignite if sprayed into the unit.

Service

Do not attempt to repair this unit by yourself. If sound is interrupted, indicators fail to light, smoke appears, or any other problem that is not covered in these instructions occurs, disconnect the AC mains lead and contact your dealer or an authorized service centre. Electric shock or damage to the unit can occur if the unit is repaired, disassembled or reconstructed by unqualified persons.

Extend operating life by disconnecting the unit from the AC mains if it is not to be used for a long time.

