

**Panasonic**

Operating Instructions

**Compact Stereo System**

Model No. **SC-HC05**



**Dear Customer**

Thank you for purchasing this system.

For optimum performance and safety, read these instructions fully before you connect, operate or adjust this system.

Keep this manual for future reference.

Your system and the illustrations can look differently.

Note:  
"EB" on the packaging indicates the United Kingdom.

Panasonic Corporation  
Web Site: <http://panasonic.net>



RQTX1318-B  
L0311HHO

© Panasonic Corporation 2011

**Caution for AC mains lead**

**For the United Kingdom, Saudi Arabia and Kuwait**  
For your safety, please read the following text carefully.

This appliance is supplied with a moulded three pin mains plug for your safety and convenience. A 5-ampere fuse is fitted in this plug. Should the fuse need to be replaced please ensure that the replacement fuse has a rating of 5-ampere and that it is approved by ASTA or BSI to BS1362.

Check for the ASTA mark or the BSI mark on the body of the fuse.

If the plug contains a removable fuse cover you must ensure that it is refitted when the fuse is replaced. If you lose the fuse cover the plug must not be used until a replacement cover is obtained. A replacement fuse cover can be purchased from your local dealer.

**CAUTION!**  
IF THE FITTED MOULDED PLUG IS UNSUITABLE FOR THE SOCKET OUTLET IN YOUR HOME THEN THE FUSE SHOULD BE REMOVED AND THE PLUG CUT OFF AND DISPOSED OF SAFELY. THERE IS A DANGER OF SEVERE ELECTRICAL SHOCK IF THE CUT OFF PLUG IS INSERTED INTO ANY 13-AMPERE SOCKET.

If a new plug is to be fitted please observe the wiring code as stated below. If in any doubt please consult a qualified electrician.

**IMPORTANT**

The wires in this mains lead are coloured in accordance with the following code:  
Blue: Neutral, Brown: Live.

As these colours may not correspond with the coloured markings identifying the terminals in your plug, proceed as follows:

The wire which is coloured Blue must be connected to the terminal which is marked with the letter N or coloured Black or Blue.

The wire which is coloured Brown must be connected to the terminal which is marked with the letter L or coloured Brown or Red.

**WARNING: DO NOT CONNECT EITHER WIRE TO THE EARTH TERMINAL WHICH IS MARKED WITH THE LETTER E, BY THE EARTH SYMBOL OR COLOURED GREEN OR GREEN/YELLOW.**

**THIS PLUG IS NOT WATERPROOF—KEEP DRY.**

**Before use**

Remove the connector cover.

**How to replace the fuse**

The location of the fuse differ according to the type of AC mains plug (figures A and B). Confirm the AC mains plug fitted and follow the instructions below. Illustrations may differ from actual AC mains plug.

1. Open the fuse cover with a screwdriver.

Figure A

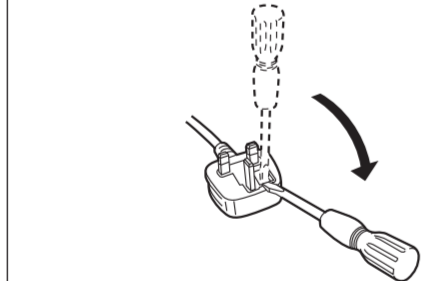
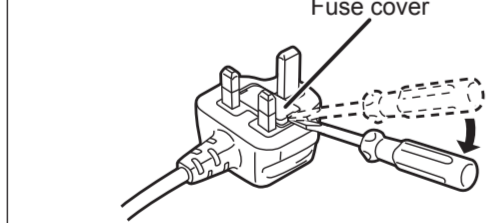

Figure B



2. Replace the fuse and close or attach the fuse cover.

Figure A

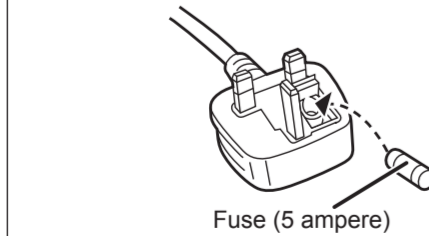
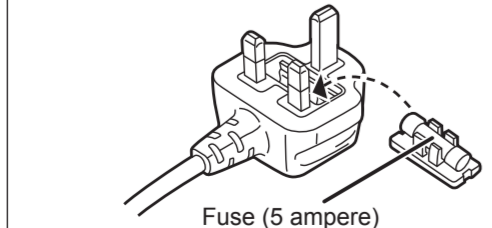

Figure B



**WARNING:**  
TO REDUCE THE RISK OF FIRE, ELECTRIC SHOCK OR PRODUCT DAMAGE,  
• DO NOT EXPOSE THIS APPARATUS TO RAIN, MOISTURE, DRIPPING OR SPLASHING AND THAT NO OBJECTS FILLED WITH LIQUIDS, SUCH AS VASES, SHALL BE PLACED ON THE APPARATUS.  
• USE ONLY THE RECOMMENDED ACCESSORIES.  
• DO NOT REMOVE THE COVER (OR BACK); THERE ARE NO USER SERVICEABLE PARTS INSIDE. REFER SERVICING TO QUALIFIED SERVICE PERSONNEL.

**CAUTION!**  
• DO NOT INSTALL OR PLACE THIS UNIT IN A BOOKCASE, BUILT-IN CABINET OR IN ANOTHER CONFINED SPACE. ENSURE THE UNIT IS WELL VENTILATED. TO PREVENT RISK OF ELECTRIC SHOCK OR FIRE HAZARD DUE TO OVERHEATING, ENSURE THAT CURTAINS AND ANY OTHER MATERIALS DO NOT OBSTRUCT THE VENTILATION VENTS.  
• DO NOT OBSTRUCT THE UNIT'S VENTILATION OPENINGS WITH NEWSPAPERS, TABLECLOTHS, CURTAINS, AND SIMILAR ITEMS.  
• DO NOT PLACE SOURCES OF NAKED FLAMES, SUCH AS LIGHTED CANDLES, ON THE UNIT.  
• DISPOSE OF BATTERIES IN AN ENVIRONMENTALLY FRIENDLY MANNER.

**For the United Kingdom, Australia and New Zealand**  
THIS UNIT IS INTENDED FOR USE IN MODERATE CLIMATES.

**For others**  
THIS UNIT IS INTENDED FOR USE IN TROPICAL CLIMATES.

The socket outlet shall be installed near the equipment and easily accessible.  
The mains plug of the power supply cord shall remain readily operable.  
To completely disconnect this apparatus from the AC Mains, disconnect the power supply cord plug from AC receptacle.

This product may receive radio interference caused by mobile telephones during use. If such interference is apparent, please increase separation between the product and the mobile telephone.

**CAUTION!**  
Danger of explosion if battery is incorrectly replaced. Replace only with the same or equivalent type recommended by the manufacturer. Dispose of used batteries according to the manufacturer's instructions.

**WARNING**  
Risk of fire, explosion and burns. Do not recharge, disassemble, heat above 60°C or incinerate.

**WARNING**  
Keep the Button-Type battery out of the reach of children. Never put Button-Type battery in mouth. If swallowed call your doctor.

Product identification marking is located on the bottom of unit.

**Safety precautions**

**Placement**

Set the system up on an even surface away from direct sunlight, high temperatures, high humidity, and excessive vibration. These conditions can damage the cabinet and other components, thereby shortening the service life of the system.

Do not place heavy items on the system.

**Voltage**

Do not use high voltage power sources. This can overload the system and cause a fire.

Do not use a DC power source. Check the source carefully when setting the system up on a ship or other place where DC is used.

**AC mains lead protection**

Ensure the AC mains lead is connected correctly and not damaged. Poor connection and lead damage can cause fire or electric shock. Do not pull, bend, or place heavy items on the lead.

Grasp the plug firmly when unplugging the lead. Pulling the AC mains lead can cause electric shock.

Do not handle the plug with wet hands. This can cause electric shock.

**Information for Users on Collection and Disposal of Old Equipment and used Batteries**

These symbols on the products, packaging, and/or accompanying documents mean that used electrical and electronic products and batteries should not be mixed with general household waste.

For proper treatment, recovery and recycling of old products and used batteries, please take them to applicable collection points, in accordance with your national legislation and the Directives 2002/96/EC and 2006/66/EC.

By disposing of these products and batteries correctly, you will help to save valuable resources and prevent any potential negative effects on human health and the environment which could otherwise arise from inappropriate waste handling.

For more information about collection and recycling of old products and batteries, please contact your local municipality, your waste disposal service or the point of sale where you purchased the items.

Penalties may be applicable for incorrect disposal of this waste, in accordance with national legislation.

**For business users in the European Union**  
If you wish to discard electrical and electronic equipment, please contact your dealer or supplier for further information.

**[Information on Disposal in other Countries outside the European Union]**  
These symbols are only valid in the European Union. If you wish to discard these items, please contact your local authorities or dealer and ask for the correct method of disposal.

**Note for the battery symbol (bottom two symbol examples):**  
This symbol might be used in combination with a chemical symbol. In this case it complies with the requirement set by the Directive for the chemical involved.

**Supplied accessories**

**Check and identify the supplied accessories.**  
Use numbers indicated in parentheses when asking for replacement parts. (Product numbers correct as of March 2011. These may be subject to change.)

**AC mains lead**

**For the United Kingdom, Saudi Arabia and Kuwait**

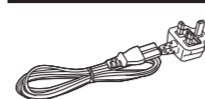

(K2CZ3YY00005)

**For Australia and New Zealand**



(K2CJ2DA00010)

**For Thailand**



(K2CP2CA00001)

**For others**



(K2CQ2CA00007)

**1 x Remote control**



(RAK-SC989ZM)

**1 x Lithium Button-Type battery**

(Battery is already installed in the remote control.)



**For the United Kingdom and Ireland**

**Sales and Support Information**

**Customer Care Centre**

• For customers within the UK: 0844 844 3852  
• For customers within Ireland: 01 289 8333  
• Visit our website for product information [www.panasonic.co.uk](http://www.panasonic.co.uk)  
• E-mail: [customer.care@panasonic.co.uk](mailto:customer.care@panasonic.co.uk)

**Direct Sales at Panasonic UK**

• For customers: 0844 844 3856  
• Order accessory and consumable items for your product with ease and confidence by phoning our Customer Care Centre Monday–Thursday 9:00 a.m. – 5:30 p.m., Friday 9:30 a.m. – 5:30 p.m. (Excluding public holidays).  
• Or go on line through our Internet Accessory ordering application at [www.pas-europe.com](http://www.pas-europe.com).  
• Most major credit and debit cards accepted.  
• All enquiries transactions and distribution facilities are provided directly by Panasonic UK Ltd.  
• It couldn't be simpler!  
• Also available through our Internet is direct shopping for a wide range of finished products, take a browse on our website for further details.

**Specifications**

**Amplifier section**

**RMS output power stereo mode**  
Front Ch (both ch driven)  
20 W per channel (6 Ω), 1 kHz, 10% THD  
Total RMS stereo mode power 40 W  
**Except the United Kingdom, Australia and New Zealand**  
**PMPO output power** 450 W

**Terminal section**

**AUX (rear)**  
Terminal Stereo, 3.5 mm jack

**Speaker section**

**Type** 2 way, 2 speaker system (passive radiator)  
**Speaker unit(s)**  
Woofer 6.5 cm cone type x 1/ch  
Tweeter 1.5 cm piezo type x 1/ch  
Passive radiators 8 cm x 2/ch  
**Impedance** 6 Ω

**Bluetooth® section**

**Bluetooth® system specification** Ver. 2.1 + EDR  
**Wireless equipment classification** Class 2 (2.5 mW)  
A2DP, AVRCP  
**Support profiles** 2402 MHz to 2480 MHz  
Frequency band (Adaptive Frequency Hopping)  
**Driving distance** 10 m line of sight  
(iPhone 4, at height 1 m, in MODE 1)

**General**

**Power supply**  
**For the United Kingdom, Australia and New Zealand** AC 220 to 240 V, 50 Hz  
**For others** AC 110 to 240 V, 50/60 Hz  
**Power consumption** 16 W  
**Dimensions (W x H x D)**  
370 mm x 176 mm x 85 mm  
(D = 121 mm dock open)  
(D = 59 mm without stand)  
**Mass** 1.8 kg  
**Operating temperature range** 0°C to +40°C  
**Operating humidity range** 35% to 80% RH (no condensation)

**Power consumption in standby mode**  
**0.2 W (approximate)**

**Note:**  
1. Specifications are subject to change without notice. Mass and dimensions are approximate.  
2. Total harmonic distortion is measured by the digital spectrum analyzer.

**Getting started**

**Remote control**

**Before using**  
Remove the insulation sheet before you use the remote control for the first time.

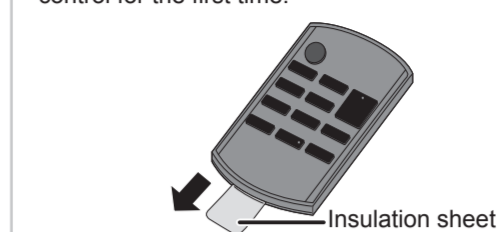

**Replacing the battery**  
Replace the remote control battery when it stops operating or when the range is decreased. Replace with a new battery (CR2025) only.

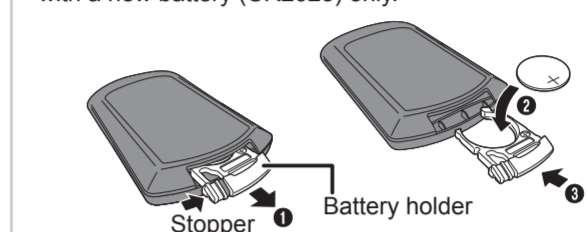

**1 While pressing the stopper, pull out the battery holder.**

**2 Insert a new battery with the (+) side facing up.**

**3 Push the battery holder back fully.**

**CAUTION!**

• Do not heat or expose to flame.  
• Do not leave the battery(ies) in an automobile exposed to direct sunlight for a long period of time with doors and windows closed.  
• Remove the battery if you do not use the remote control for a long period of time. Keep in a cool, dark area.

**Connect the AC mains lead**

**For the United Kingdom, Saudi Arabia and Kuwait**  
READ THE CAUTION FOR AC MAINS LEAD BEFORE CONNECTION.

**Rear view**

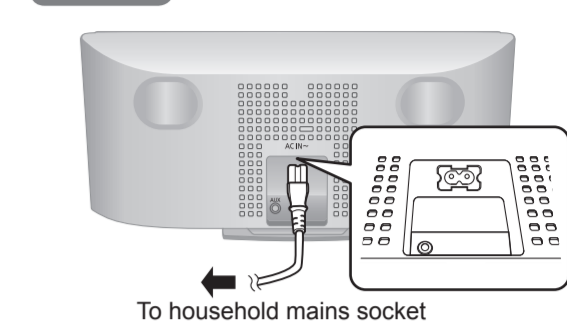

• Use the included AC mains lead with this system only.  
• Do not use an AC mains lead from other equipment.

**Conserving power**

The system consumes approximately 0.2 W when it is in standby mode. Disconnect the power supply if you do not use the system. Some settings will be lost after you disconnect the system. You have to set them again.

**Speakers**

• Do not remove the speaker nets.  
• These speakers do not have magnetic shielding. Do not put them near TVs, PCs or other devices easily influenced by magnetism.  
• When you play at high levels for a long period, it can cause damage to the system and decrease the life of the system.  
• Decrease the volume when you play distorted sound to prevent damage.

**Overview of controls**

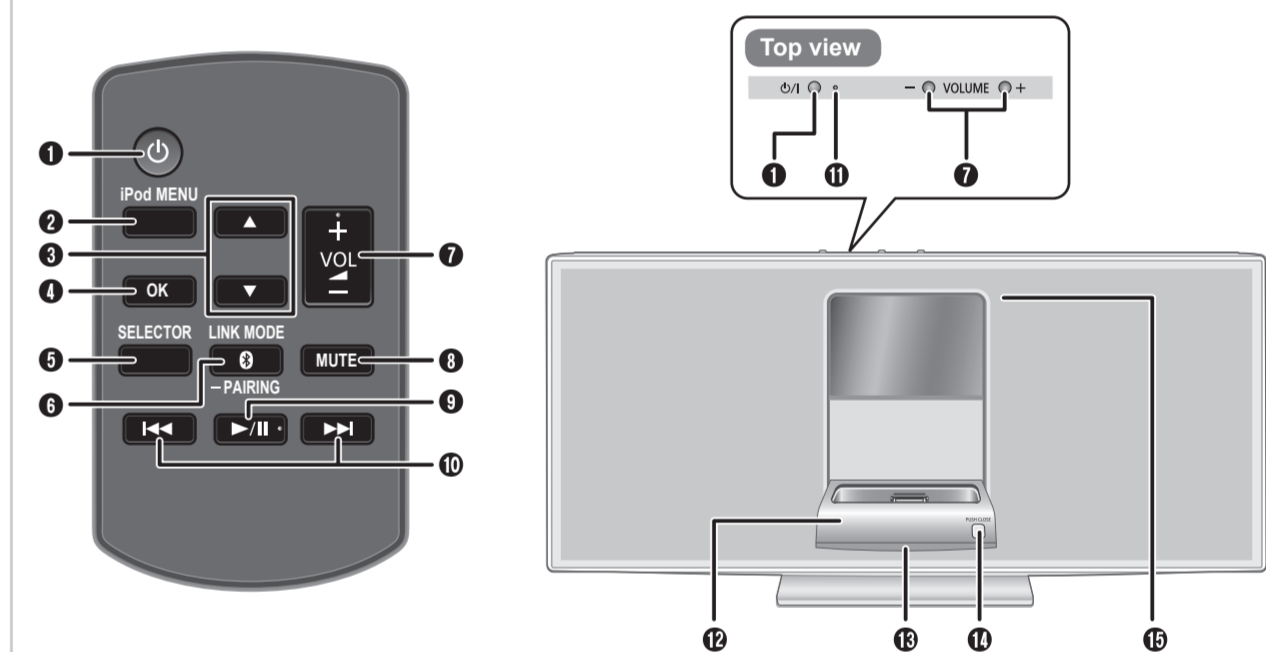

- Standby/on switch [ON], [OFF]  
Press to switch the unit from on to standby mode or vice versa. In standby mode, the unit is still consuming a small amount of power.
- View the iPod or iPhone menu
- Select an item
- Confirm a selection  
Set or cancel the auto off function
- Select iPod, Internet radio, Bluetooth® or AUX mode  
Bluetooth® is the default mode except when an iPod or iPhone is connected.
- Start Bluetooth® pairing mode  
Select Bluetooth® link mode  
Adjust the audio input level in AUX mode
- Adjust the volume of the system  
The setting returns to the default when you disconnect the AC mains lead.
- Mute the sound of the system  
In iPod mode : The light blue and green status indicators blink alternately.  
In Bluetooth® mode : The light blue and blue status indicators blink alternately.  
In AUX mode : The light blue status indicator blinks continuously.  
This function does not work when the system is pairing or waiting to connect with a Bluetooth® device.  
Press the button again to cancel.  
Mute is also cancelled when you adjust the volume or when you switch off the system.
- Start or pause playback
- Skip or search track
- Power indicator  
On : The system is on  
Off : The system is in standby mode
- iPod or iPhone dock
- Status indicator  
Green : iPod mode  
Blue : Bluetooth® mode  
Light blue : Set or cancel the auto off function  
Off : Mute function is on  
Off : AUX mode  
The green status indicator blinks each time a remote control button is pressed.
- [PUSH CLOSE]  
Press while closing the dock.
- Remote control sensor  
Point the remote control at the remote control sensor, away from obstacles, at a maximum range of 7 m directly in front of the main unit.

## Using an iPod or iPhone

### Connecting an iPod or iPhone

#### Preparation

Update your iPod or iPhone with the latest software. Make sure to remove the iPod or iPhone from its case.

#### 1 Push **[▲, iPod]** to open the dock.

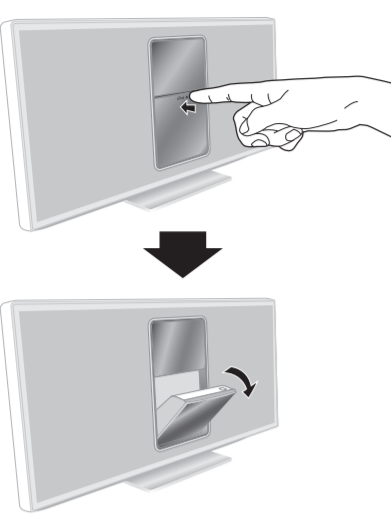

#### 2 Insert a compatible dock adapter.

#### 3 Connect the iPod or iPhone.

The status indicator changes to green.

#### iPhone

(not included)

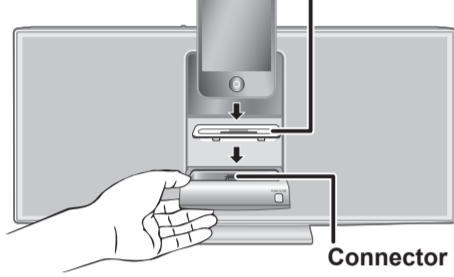

Hold the dock when connecting or disconnecting the iPod or iPhone.

#### To close the dock

##### 1 Disconnect the iPod or iPhone.

##### 2 Press **[PUSH CLOSE]** while closing the dock.

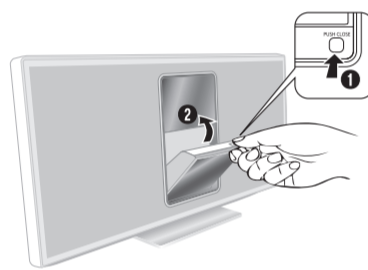

#### Note:

- Make sure to align your iPod or iPhone with the connector when inserting.
- Make sure to press **[PUSH CLOSE]** while closing the dock to prevent damage.
- When an iPod or iPhone is connected, press **[SELECTOR]** to switch between modes (Internet radio, Bluetooth®, AUX or iPod).
- The system automatically switches on when you connect an iPod or iPhone that is in playback mode (except for some models).
- To purchase a dock adapter, consult your local iPod or iPhone dealer.

### Basic playback

#### 1 Connect the iPod or iPhone.

#### 2 Press **[▶/II]** to start playback.

Pause playback	Press <b>[▶/II]</b> . Press again to continue playback.
Skip track	Press <b>[⏪]</b> or <b>[▶▶]</b> .
Search track	Press and hold <b>[⏪]</b> or <b>[▶▶]</b> .
View the iPod or iPhone menu	Press <b>[iPod MENU]</b> .
Select an item	Press <b>[▲]</b> or <b>[▼]</b> and then press <b>[OK]</b> .

#### Note:

- Depending on the model, it may be necessary to remove the iPod or iPhone and select the album, artist, etc. on the iPod or iPhone.
- Operation results may vary depending on the iPod or iPhone models.
- Read the User Guide of the iPod or iPhone for operating instructions.

## Listening to the Internet radio

You can listen to a radio station on the Internet if you install the "vTuner for Panasonic" application on your iPod touch or iPhone. Download this application from the App Store.

#### Note:

For compatible iPod touch and iPhone models and instructions on how to use the "vTuner for Panasonic" application, refer to: <http://radio.vtuner.com/panasonic/en/>

### Compatible iPod and iPhone

#### (as of March 2011)

- iPod touch 4th generation (8GB, 32GB, 64GB)
- iPod nano 6th generation (8GB, 16GB)
- iPod touch 3rd generation (32GB, 64GB)
- iPod nano 5th generation (video camera) (8GB, 16GB)
- iPod touch 2nd generation (8GB, 16GB, 32GB)
- iPod classic [120GB, 160GB (2009)]
- iPod nano 4th generation (video) (8GB, 16GB)
- iPod classic (160GB) (2007)
- iPod touch 1st generation (8GB, 16GB, 32GB)
- iPod nano 3rd generation (video) (4GB, 8GB)
- iPod classic (80GB)
- iPod nano 2nd generation (aluminum) (2GB, 4GB, 8GB)
- iPod 5th generation (video) (60GB, 80GB)
- iPod 5th generation (video) (30GB)
- iPod nano 1st generation (1GB, 2GB, 4GB)
- iPhone 4 (16GB, 32GB)
- iPhone 3GS (8GB, 16GB, 32GB)
- iPhone 3G (8GB, 16GB)
- iPhone (4GB, 8GB, 16GB)

Compatibility depends on the software version of your iPod or iPhone.

#### Note:

- The display on the iPod can show differently because of the compatibility of the iPod models.
- All phone features can only be controlled by the touch screen of the iPhone.
- The system does not show incoming calls or the phone status.
- Playback will stop when there is an incoming call. Disconnect the iPhone to answer the call.
- A call is not cancelled when you connect or disconnect the iPhone from the system.
- There is no Apple Inc. specification that will guarantee the above iPhone response. iPhone responses can be different on newer models or with newer software.

### Charging an iPod or iPhone

An iPod or iPhone is charged automatically when connected to the system (even when the system is in standby mode).

- See the iPod or iPhone display for its battery charging status.
- Disconnect the iPod or iPhone if it is not used for an extended period of time after charging is complete.
- Charging stops when the battery is fully charged. The battery will deplete naturally.

## Using Bluetooth®

You can connect and play an audio device wirelessly through Bluetooth®.

**Panasonic bears no responsibility for data and/or information that can possibly be compromised during a wireless transmission.**

#### Preparation

Switch on the Bluetooth® feature of the device and put the device near the system. Read the operating instructions of the device for details.

The blue status indicator can indicate different Bluetooth® conditions:

Blinks quickly	The system is ready for pairing.
Blinks slowly	The system is waiting to connect.
Lighted	A Bluetooth® device is connected.

### Pairing and connecting a device

#### 1 Press **[SELECTOR]** to select Bluetooth® mode.

Status indicator: Blue

#### 2 Access the Bluetooth® menu of the device and search for "SC-HC05".

#### 3 Pair or connect the device to "SC-HC05".

If prompted for a passkey, input "0000". The device connects with this system automatically after pairing is complete.

#### Note:

- A device must be paired to connect.
- This system can only connect to one device at a time.
- A device stays connected even if the system is switched to iPod or AUX mode.

### Pairing with additional devices

#### 1 Press **[SELECTOR]** to select Bluetooth® mode.

#### 2 Press and hold **[0, -PAIRING]**.

#### 3 Access the Bluetooth® menu of the device and search for "SC-HC05".

#### 4 Pair or connect the device to "SC-HC05".

You can pair up to 6 devices with this system. If a 7th device is paired, the device with the oldest connection history will be replaced.

You only have to do pairing once, unless:

- The pairing of the device has been replaced.
- The memory of this system has been reset.
- The pairing of "SC-HC05" has been deleted from the device.

### Disconnecting a device

A device is disconnected when you:

- Switch off the system or the device.
- Move the device out of the maximum range (→ "Range of use").
- Stop or disable the Bluetooth® transmission of the device.

### Basic playback

#### 1 Press **[SELECTOR]** to select Bluetooth® mode.

#### 2 Connect the device.

#### 3 Press **[▶/II]** to start playback.

Pause playback	Press <b>[▶/II]</b> . Press again to continue playback.
Skip track	Press <b>[⏪]</b> or <b>[▶▶]</b> .

#### Note:

- When playing iPod or iPhone by Bluetooth® with the main unit, intermittent sound may be experienced if you leave the iPod or iPhone Bluetooth® menu screen active or when making Bluetooth® registration and connection. If this occurs, please exit the iPod or iPhone Bluetooth® menu screen.
- If playback does not start, stop or disable the Bluetooth® transmission of the device and then connect the device again.
- If you connect an iPod or iPhone to the dock when it is playing via Bluetooth®, the system switches to iPod mode and playback is paused. Press **[▶/II]** to continue playback.

### Link mode

You can select different modes to suit the type of connection.

#### 1 Stop or disable the Bluetooth® transmission of the device.

#### 2 Press **[0, LINK MODE]**.

**MODE 1 ↔ MODE 2**  
(default)

MODE 1 → MODE 2: The light blue status indicator blinks 4 times.

MODE 2 → MODE 1: The light blue status indicator blinks 2 times.

MODE 1	For stable communication.
MODE 2	For good audio quality. Communication can disconnect easily. Select "MODE 1" if this occurs.

### About Bluetooth®

#### Frequency band

- This system uses the 2.4 GHz frequency band.

#### Certification

- This system conforms to frequency restrictions and has received certification based on frequency laws. Thus, a wireless permit is not necessary.
- The actions below are punishable by law:
  - Taking apart or modifying the main unit.
  - Removing specification indications from the bottom of this main unit.

#### Restrictions of use

- Wireless transmission and/or usage with all Bluetooth® equipped devices is not guaranteed.
- All devices must conform to standards set by Bluetooth SIG, Inc.
- Depending on the specifications and settings of a device, it can fail to connect or some operations can be different.
- This system supports Bluetooth® security features. But depending on the operating environment and/or settings, this security is possibly not sufficient. Transmit data wirelessly with this system with caution.
- This system cannot transmit data to a Bluetooth® device.

#### Range of use

- Use this device at a maximum range of 10 m.
- The range can decrease depending on the environment, obstacles or interference.

#### Interference from other devices

- Other devices can use the same frequency as this system and cause the system to operate incorrectly or sound distortion.
- To prevent interference from other devices:
  - Keep the system away from other devices that emit radio frequency interference.
  - Do not use this system and a wireless LAN device at the same time. Switch off any wireless LAN device.

#### Intended usage

- This system is for normal, general use only.
- Do not use this system near an equipment or in an environment that is sensitive to radio frequency interference (example: airports, hospitals, laboratories, etc.).

## Using the auxiliary input

You can connect a portable audio equipment and listen to the audio through this system.

#### Preparation

Switch off the equalizer (if any) of the portable audio equipment to prevent sound distortion. Decrease the volume of the system and the portable audio equipment before you connect or disconnect the portable audio equipment.

#### 1 Connect the portable audio equipment.

Plug type: Ø 3.5 mm stereo

#### 2 Press **[SELECTOR]** to select AUX mode.

Status indicator: Off

#### 3 Play the portable audio equipment.

#### Note:

- Read the operating instructions of the portable audio equipment for details.
- Components and cables are sold separately.

#### Rear view

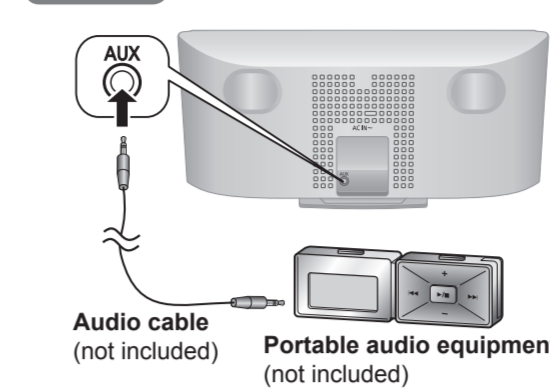

#### To adjust the audio input level

Press **[0, LINK MODE]-PAIRING]**.

**NORMAL ↔ HIGH**  
(default)

#### Note:

- Select "NORMAL" if the sound is distorted during "HIGH" input level.
- The setting returns to the default when you disconnect the AC mains lead.

## Troubleshooting guide

Before requesting service, make the following checks. If you are in doubt about some of the check points, or if the solutions indicated do not solve the problem, consult your dealer for instructions.

### Common problems

#### Power indicator blinks and then the system automatically switches off.

- An error has occurred. Disconnect the AC mains lead. Wait for a few seconds, connect the AC mains lead and then switch on the system again. If the problem continues, contact an authorised service centre.

#### No sound.

- Examine the connections.
- Increase the volume of the system.
- Examine the volume of the iPod, iPhone, Bluetooth® device or portable audio equipment.
- Make sure that the iPod, iPhone, Bluetooth® device or portable audio equipment is actually playing something.

#### Sound is distorted.

- Lower the volume of the system.
- Noise can occur if you play a lower quality audio content.
- Make sure that the equalizer function of the iPod, iPhone, Bluetooth® device or portable audio equipment is switched off.
- Move mobile telephones away from the main unit if the interference is apparent.

#### A "humming" sound can be heard during playback.

- An AC mains lead or fluorescent light is near the cable. Keep other appliances and cords away from the cable of this system.

#### No response when remote control buttons are pressed.

- Remove the insulation sheet before you use the remote control for the first time.
- Examine that the battery is installed correctly.
- The battery is weak. Replace it with a new one.

#### Other Panasonic equipment responds to the remote control of this system. This system responds to the remote control of other Panasonic equipment.

- Change the remote control code of the other Panasonic equipment.

#### iPod or iPhone

##### iPod or iPhone does not switch on.

- Make sure that the iPod or iPhone battery is not depleted. Charge the iPod or iPhone.
- Switch off the system and then switch it on again.

##### iPod or iPhone does not respond.

- Make sure that the system is in iPod mode.
- The iPod or iPhone is not connected correctly. Remove the iPod or iPhone and connect it again.

##### iPod or iPhone does not charge.

- Examine the connections.

#### For the United Kingdom and Ireland

CE 0678

OPERATING AT 2402 MHz TO 2480 MHz

#### Declaration of Conformity (DoC)

Hereby, "Panasonic Corporation", declares that this product is in compliance with the essential requirements and other relevant provisions of Directive 1999/5/EC. Customers can download a copy of the original DoC to our R&TTE products from our DoC server:

<http://www.doc.panasonic.de>  
Contact to Authorised Representative: Panasonic Marketing Europe GmbH, Panasonic Testing Centre, Winsberg 15, 22525 Hamburg, Germany

This product is intended to be used in the following countries: GB, IE

This product is intended for general consumer. (Category 3)

#### For Ireland

##### Gaeilge

##### Dearbhú Comhréireachta (DoC)

Leis seo, dearbháloinn "Panasonic Corporation" go bhfuil an táirge seo i gcomhréir le riachtanais nachtanacha agus forálacha ábhartha eile den Treoir 1999/5/EC. Féadfaidh custaiméirí coilp dár DDearbhú Comhréireachta (DoC) bunaidh dár dtáirgí R&TTE ónár bhfreastalaim um DDearbhú Comhréireachta (DoC):

<http://www.doc.panasonic.de>  
Mionsonraí Teagmhála Ionadai Údaraithe: Panasonic Marketing Europe GmbH, Panasonic Testing Centre, Winsberg 15, 22525 Hamburg, An Ghearmáin

Tá an táirge seo ceaptha chun a úsáid sna tíortha seo a leanas: GB, IE

Tá an táirge seo ceaptha don ghnáth-thormhálóir. (Catagóir 3)

Made for iPod iPhone

"Made for iPod" and "Made for iPhone" mean that an electronic accessory has been designed to connect specifically to iPod, or iPhone, respectively, and has been certified by the developer to meet Apple performance standards.

Apple is not responsible for the operation of this device or its compliance with safety and regulatory standards. Please note that the use of this accessory with iPod, or iPhone may affect wireless performance.

iPhone, iPod, iPod classic, iPod nano, and iPod touch are trademarks of Apple Inc., registered in the U.S. and other countries.

The Bluetooth® word mark and logos are owned by the Bluetooth SIG, Inc. and any use of such marks by Panasonic Corporation is under license. Other trademarks and trade names are those of their respective owners.