

Operating Instructions CD Stereo System

Model No. **SC-PM500**



Dear Customer

Thank you for purchasing this system. For optimum performance and safety, read these instructions fully before you connect, operate or adjust this system. Keep this manual for future reference. These operating instructions are applicable to the following system.

System	SC-PM500
Main unit	SA-PM500
Speakers	SB-PM500

Your system and the illustrations can look differently.

Do the procedures with the remote control. You can also use the buttons on the main unit if they are the same.

SUPPLIED ACCESSORIES

Please check and identify the supplied accessories.

- 1 x AC mains lead
- 1 x Remote control battery
- 1 x AM loop antenna
- 1 x Remote control (N2QAYB000640)
- 1 x FM indoor antenna

Panasonic Corporation
Web Site: <http://panasonic.net>



RQT9545-B
L0511LL0

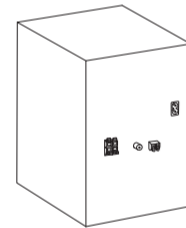

Back of product

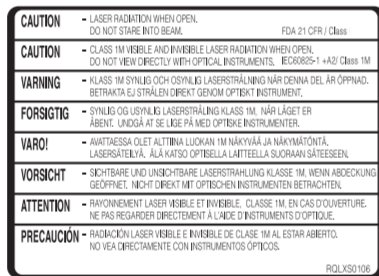

Inside of product

WARNING:
TO REDUCE THE RISK OF FIRE, ELECTRIC SHOCK OR PRODUCT DAMAGE,
• DO NOT EXPOSE THIS APPARATUS TO RAIN, MOISTURE, DRIPPING OR SPLASHING AND THAT NO OBJECTS FILLED WITH LIQUIDS, SUCH AS VASES, SHALL BE PLACED ON THE APPARATUS.
• USE ONLY THE RECOMMENDED ACCESSORIES.
• DO NOT REMOVE THE COVER (OR BACK); THERE ARE NO USER SERVICEABLE PARTS INSIDE. REFER SERVICING TO QUALIFIED SERVICE PERSONNEL.

CAUTION!
• DO NOT INSTALL OR PLACE THIS UNIT IN A BOOKCASE, BUILT-IN CABINET OR IN ANOTHER CONFINED SPACE. ENSURE THE UNIT IS WELL VENTILATED. TO PREVENT RISK OF ELECTRIC SHOCK OR FIRE HAZARD DUE TO OVERHEATING, ENSURE THAT CURTAINS AND ANY OTHER MATERIALS DO NOT OBSTRUCT THE VENTILATION VENTS.
• DO NOT OBSTRUCT THE UNIT'S VENTILATION OPENINGS WITH NEWSPAPERS, TABLECLOTHS, CURTAINS, AND SIMILAR ITEMS.
• DO NOT PLACE SOURCES OF NAKED FLAMES, SUCH AS LIGHTED CANDLES, ON THE UNIT.
• DISPOSE OF BATTERIES IN AN ENVIRONMENTALLY FRIENDLY MANNER.

CAUTION!
THIS PRODUCT UTILIZES A LASER. USE OF CONTROLS OR ADJUSTMENTS OR PERFORMANCE OF PROCEDURES OTHER THAN THOSE SPECIFIED HEREIN MAY RESULT IN HAZARDOUS RADIATION EXPOSURE. DO NOT OPEN COVERS AND DO NOT REPAIR YOURSELF. REFER SERVICING TO QUALIFIED PERSONNEL.

The socket outlet shall be installed near the equipment and easily accessible. The mains plug of the power supply cord shall remain readily operable. To completely disconnect this apparatus from the AC Mains, disconnect the power supply cord plug from AC receptacle.

This product may receive radio interference caused by mobile telephones during use. If such interference is apparent, please increase separation between the product and the mobile telephone.

THIS UNIT IS INTENDED FOR USE IN MODERATE CLIMATES.

SAFETY PRECAUTIONS

Placement

Set the system up on an even surface away from direct sunlight, high temperatures, high humidity, and excessive vibration. These conditions can damage the cabinet and other components, thereby shortening the service life of the system. Place it at least 15 cm away from wall surfaces to avoid distortion and unwanted acoustical effects. Do not place heavy items on the system.

Voltage

Do not use high voltage power sources. This can overload the system and cause a fire. Do not use a DC power source. Check the source carefully when setting the system up on a ship or other place where DC is used.

AC mains lead protection

Ensure the AC mains lead is connected correctly and not damaged. Poor connection and lead damage can cause fire or electric shock. Do not pull, bend, or place heavy items on the lead. Grasp the plug firmly when unplugging the lead. Pulling the AC mains lead can cause electric shock. Do not handle the plug with wet hands. This can cause electric shock.

Foreign matter

Do not let metal objects fall inside the system. This can cause electric shock or malfunction. Do not let liquids get into the system. This can cause electric shock or malfunction. If this occurs, immediately disconnect the system from the power supply and contact your dealer. Do not spray insecticides onto or into the system. They contain flammable gases which can ignite if sprayed into the system.

Service

Do not attempt to repair this system by yourself. If sound is interrupted, indicators fail to light, smoke appears, or any other problem that is not covered in these instructions occurs, disconnect the AC mains lead and contact your dealer or an authorised service centre. Electric shock or damage to the system can occur if the system is repaired, disassembled or reconstructed by unqualified persons. Extend operating life by disconnecting the system from the power source if it is not to be used for a long time.

MAINTENANCE

To clean this system, wipe with a soft, dry cloth.
• Never use alcohol, paint thinner or benzene to clean this system.
• Before using chemically treated cloth, read the instructions that came with the cloth carefully.



"Made for iPod" and "Made for iPhone" mean that an electronic accessory has been designed to connect specifically to iPod, or iPhone, respectively, and has been certified by the developer to meet Apple performance standards.

Apple is not responsible for the operation of this device or its compliance with safety and regulatory standards.

Please note that the use of this accessory with iPod, or iPhone may affect wireless performance.

iPhone, iPod, iPod classic, iPod nano, and iPod touch are trademarks of Apple Inc., registered in the U.S. and other countries.

MPEG Layer-3 audio coding technology licensed from Fraunhofer IIS and Thomson.

– If you see this symbol –

Information on Disposal in other Countries outside the European Union
This symbol is only valid in the European Union. If you wish to discard this product, please contact your local authorities or dealer and ask for the correct method of disposal.

SPECIFICATIONS

Amplifier section

RMS output power stereo mode
Front Ch (both ch driven)
20 W per channel (6 Ω), 1 kHz, 10% THD
Total RMS stereo mode power 40 W

FM/AM tuner, terminals section

Preset station FM 30 stations
AM 15 stations
Frequency modulation (FM)
Frequency range 87.50 MHz to 108.00 MHz (50 kHz step)
Antenna terminals 75 Ω (unbalanced)
Amplitude modulation (AM)
Frequency range 522 kHz to 1629 kHz (9 kHz step)
520 kHz to 1630 kHz (10 kHz step)

Headphones jack
Terminal Stereo, 3.5 mm jack

Disc section

Disc played (8 cm or 12 cm)
CD, CD-R/RW (CD-DA, MP3* formatted disc)
* MPEG-1 Layer 3, MPEG-2 Layer 3
Pick up
Wavelength 790 nm (CD)
Laser power CLASS 1 (CD)
Audio output (Disc)
Number of channels 2 ch (FL, FR)
FL = Front left channel
FR = Front right channel

USB section

USB port
USB standard USB 2.0 full speed
Media file format support MP3 (*.mp3)
USB device file system FAT 12, FAT 16, FAT 32
USB port power 500 mA (max)

Speaker section

Type 2 way, 2 speaker system (bass reflex)
Speaker unit(s)
Woofer 10 cm cone type
Tweeter 6 cm cone type
Impedance 6 Ω
Output sound pressure 80.5 dB/W (1 m)
Frequency range 52 Hz to 31 kHz (–16 dB)
74 Hz to 27 kHz (–10 dB)

Dimensions (W x H x D) 145 mm x 224 mm x 197 mm

Mass 1.9 kg

General

Power supply AC 220 to 240 V, 50 Hz
Power consumption 19 W
Dimensions (W x H x D) 153 mm x 224 mm x 232 mm
Mass 1.7 kg
Operating temperature range 0°C to +40°C
Operating humidity range 35% to 80% RH (no condensation)

Power consumption in standby mode
0.2 W (approximate)

Note:
1) Specifications are subject to change without notice.
Mass and dimensions are approximate.
2) Total harmonic distortion is measured by the digital spectrum analyzer.

1 PREPARING THE REMOTE CONTROL

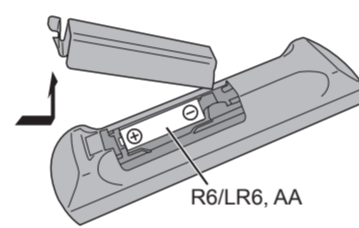

Use alkaline or manganese battery.

Install the battery so that the poles (+ and –) align with those in the remote control.

Point the remote control at the remote control sensor, away from obstacles, at a maximum range of 7 m directly in front of the main unit.

CAUTION!
Danger of explosion if battery is incorrectly replaced. Replace only with the same or equivalent type recommended by the manufacturer. Dispose of used batteries according to the manufacturer's instructions.

4 OVERVIEW OF CONTROLS

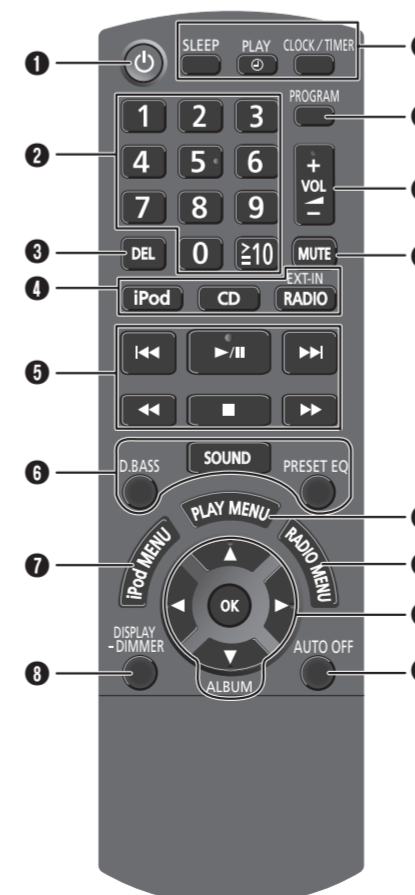

- Refer to the numbers in parentheses for chapter references.
- Standby/on switch** [ON], [OFF] (8, 12)
Press to switch the unit from on to standby mode or vice versa. In standby mode, the unit is still consuming a small amount of power.
 - Numeric buttons [1 to 9, 0, ≥10]**
To select a 2-digit number
Example: 16: [≥10] → [1] → [6]
 - Delete a programmed track (5)
 - Select source**
[iPod]: Select iPod (6)
[CD]: Select disc (5)
[RADIO, EXT-IN] / [RADIO, EXT-IN(USB)]: Select radio or USB (7, 10)
 - Basic operation**
[▶/||]: Playback or pause operation
[■]: Stop playback
[◀], [▶]: Skip track
[◀◀], [▶▶]: Skip preset radio station
[◀◀], [▶▶]: Search track
[▶▶], [▶▶]: Tune in to the radio station
[◀◀◀], [▶▶▶]: Skip and search track
Select preset radio station
 - Select the sound effects (9)
 - Select the iPod menu item (6)
 - View the information shown on the display panel
Decrease the brightness of the display panel
Press and hold the button to use this function. To cancel, press and hold the button again.
 - Set the sleep timer (8)
Set the clock and timer (8)
 - Set the program function (5, 7)
 - Adjust the volume of the system
 - Mute the sound of the system**
Press the button again to cancel. "MUTE" is also cancelled when you adjust the volume or when you switch off the system.
 - Set the play menu item (5)
 - Set the radio menu item (7)
 - [▲, ▼]: Skip album
Adjust clock setting
[◀, ▶]: Select the item in the menu
[OK]: Confirm the setting
 - Automatically switch off the system**
This function switches off the system (except in radio source) if you do not use the system for approximately 30 minutes. To cancel, press the button again.
 - iPod or iPhone dock (6)
 - Headphones jack (10)
 - Display panel
 - USB port (21)
 - Open or close the disc tray
 - Disc tray
 - Remote control sensor

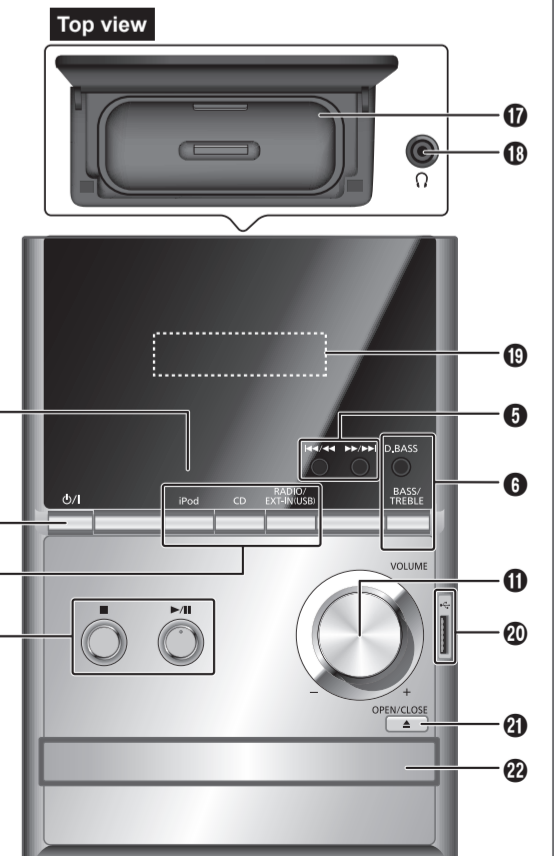

2 PLACEMENT OF SPEAKERS



The right and left speakers are the same.

Use only the supplied speakers.
The combination of the main unit and speakers give the best sound. You can cause damage to the system and decrease the sound quality if you use other speakers.

CAUTION!
• Use the speakers only with the recommended system. If not, you can cause damage to the amplifier and speakers and can cause a fire. Consult an approved service personnel if damage occurs or if there is a sudden apparent change in performance.
• Do the procedures included in these instructions when you attach the speakers.

- Note:**
- Keep your speakers more than 10 mm from the main unit for ventilation.
 - Put the speakers on a flat safe surface.
 - These speakers do not have magnetic shielding. Do not put them near TVs, PCs or other equipment easily influenced by magnetism.
 - When you play at high levels for a long period, it can cause damage to the system and decrease the life of the system.
 - Decrease the volume in these conditions to prevent damage:
– When you play distorted sound.
– When you adjust the sound quality.
 - To prevent damage to the speakers, do not touch the speaker cones if you remove the nets.

3 MAKING THE CONNECTIONS

Conserving power
The system consumes approximately 0.2 W when it is in standby mode. Disconnect the power supply if you do not use the system. Some settings will be lost after you disconnect the system. You have to set them again.

- Connect the speakers.**
Be careful not to cross (short-circuit) or reverse the polarity of the speaker wires as doing so may damage the speakers.
- Connect the FM indoor antenna.**
Place the antenna where reception is best.
- Connect the AM loop antenna.**
- Connect the AC mains lead.**
Use the included AC mains lead with this system only. Do not use an AC mains lead from other equipment.

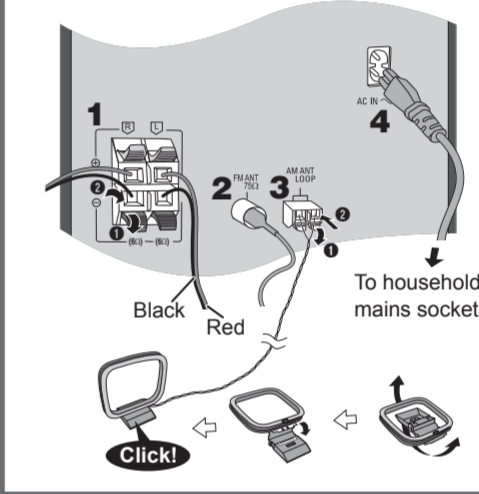

5 DISCS

Playing discs

- Press **[▲, OPEN/CLOSE]** on the main unit to open the disc tray. Put in a disc with the label facing up. Press **[▲, OPEN/CLOSE]** again to close the disc tray.

- Press **[CD]** and then press **[▶/II]** to start playback.

Stop playback	Press [■] during playback.
Pause playback	Press [▶/II] during playback. Press again to continue playback.
Skip album (MP3)	Press [▲, ▼] .
Skip track	Press [◀◀] or [▶▶] (main unit: [◀◀/▶▶] or [▶▶/▶▶]).
Search through track (CD)	Press and hold [◀◀] or [▶▶] (main unit: [◀◀/▶▶] or [▶▶/▶▶]).

Repeat playback

You can repeat "Program playback" or other selected "Playback function".

- Press **[PLAY MENU]** to select "REPEAT".
- Press **[◀, ▶]** to select "ON REPEAT" and then press **[OK]**. "CD" is shown. To cancel, select "OFF REPEAT".

Playmode function

- Press **[PLAY MENU]** to select "PLAYMODE".
- Press **[◀, ▶]** and then press **[OK]** to select the desired mode.

OFF PLAYMODE	Play all tracks.
1-TRACK (TR)	Play one selected track on the disc. Press the numeric buttons to select the track.
1-ALBUM (ALBUM (MP3))	Play one selected album on the disc. Press [▲, ▼] to select the album.
RANDOM (RD)	Play a disc randomly.
1-ALBUM RANDOM (ALBUM RD (MP3))	Play all tracks in one selected album randomly. Press [▲, ▼] to select the album.

Note:

- During random playback, you cannot skip to tracks which have been played or press the numeric buttons.
- This function does not work with "Program playback".
- The setting returns to the default "OFF PLAYMODE" when you open the disc tray.

Viewing available information

You can view the available information on the display panel.

Press [DISPLAY].

- Maximum characters that can be shown: approximately 16
- This system supports ver. 1.0, 1.1 and 2.3 ID3 tags.
- Text data that the system does not support can show differently.

Program playback

This function allows you to program up to 24 tracks.

(CD)

- Press **[PROGRAM]** in the stop mode. "PGM" is shown.
- Press the numeric buttons to select the desired track. Do this step again to program other tracks.
- Press **[▶/II]** to start playback.

(MP3)

- Press **[PROGRAM]** in the stop mode.
- Press **[▲, ▼]** to select the desired album.
- Press **[▶/II]** and then press the numeric buttons to select the desired track.
- Press **[OK]**. Do steps 2 through 4 again to program other tracks.
- Press **[▶/II]** to start playback.

Cancel program mode	Press [PROGRAM] in the stop mode.
Replay the program	Press [PROGRAM] and then press [▶/II] .
Check program contents	Press [◀◀] or [▶▶] when "PGM" is shown in the stop mode. To check while programming, press [PROGRAM] two times after "PGM" is shown, then press [◀◀] or [▶▶] .
Clear the last track	Press [DEL] in the stop mode.
Clear all programmed tracks	Press [■] in the stop mode. "CLR ALL" is shown. Within 5 seconds, press [■] again.

Note:

The program memory is cleared when you open the disc tray.

Note on CDs

- This system can access up to 99 tracks.
- This system can play MP3 files and CD-DA format audio CD-R/RW that have been finalised.
- This system can fail to play some CD-R/RW because of the condition of the recording.

Note on MP3s

- Files are treated as tracks and folders are treated as albums.
- This system can access up to 999 tracks, 255 albums (including root folder) and 20 sessions.
- Disc must conform to ISO9660 level 1 or 2 (except for extended formats).
- To play in a certain order, prefix the folder and file names with 3-digit numbers in the order you want them to play.

Limitations on MP3 playback

- If you have recorded MP3s on the same disc as CD-DA, only the format recorded in the first session can be played.
- Some MP3s cannot be played because of the condition of the disc or recording.
- Recordings will not necessarily be played in the order you recorded them.

USING AN iPod OR iPhone (continued)

Note:

- Make sure to align your iPod or iPhone with the connector when inserting the iPod or iPhone.
- The operations may vary or not work depending on the iPod or iPhone models.
- Depending on the model, it may be necessary to remove the iPod or iPhone and select the album, artist, etc. on the iPod or iPhone.
- Read the User Guide of the iPod or iPhone for the operating instructions.

Charging an iPod or iPhone

An iPod or iPhone is charged automatically when connected to the system (even when the system is in standby mode).

- See the iPod or iPhone display for its battery charging status.
- Disconnect the iPod or iPhone if it is not used for an extended period of time after charging is complete.
- Charging stops when the battery is fully charged. The battery will deplete naturally.

Compatible iPod and iPhone

Update your iPod or iPhone with the latest software before using this system.

Compatibility depends on the software version of your iPod or iPhone.

- iPod touch 4th generation (8GB, 32GB, 64GB)
- iPod nano 6th generation (8GB, 16GB)
- iPod touch 3rd generation (32GB, 64GB)
- iPod nano 5th generation (video camera) (8GB, 16GB)
- iPod touch 2nd generation (8GB, 16GB, 32GB)
- iPod classic [120GB, 160GB (2009)]
- iPod nano 4th generation (video) (8GB, 16GB)
- iPod classic (160GB) (2007)
- iPod touch 1st generation (8GB, 16GB, 32GB)
- iPod nano 3rd generation (video) (4GB, 8GB)
- iPod classic (80GB)
- iPod nano 2nd generation (aluminum) (2GB, 4GB, 8GB)
- iPod 5th generation (video) (60GB, 80GB)
- iPod 5th generation (video) (30GB)
- iPod nano 1st generation (1GB, 2GB, 4GB)
- iPhone 4 (16GB, 32GB)
- iPhone 3GS (8GB, 16GB, 32GB)
- iPhone 3G (8GB, 16GB)
- iPhone (4GB, 8GB, 16GB)

Note on iPhone

- All phone features can only be controlled by the touch screen of the iPhone.
- The system does not show incoming calls or the phone status.
- Playback will stop when there is an incoming call.
- A call is not cancelled when you connect or disconnect the iPhone from the system.
- There is no Apple Inc. specification that will guarantee the above iPhone response. iPhone responses can be different on newer models or with new software.

8 CLOCK AND TIMERS

Setting the clock

This is a 24-hour clock.

- Press **[CLOCK/TIMER]** to select "CLOCK".
- Within 10 seconds, press **[▲, ▼]** to set the time.
- Press **[OK]**.

Press **[CLOCK/TIMER]** to show the clock for a few seconds.

Note:

Reset the clock regularly to maintain accuracy.

Sleep timer

The sleep timer switches off the system after the set time.

Press [SLEEP] to select the setting (in minutes).

To cancel, select "OFF".

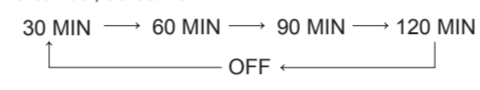

To show the remaining time

Press **[SLEEP]**.

Note:

- The sleep timer can be used together with the play timer.
- The sleep timer always comes first. Be sure not to set an overlap of timers.

Play timer

You can set the timer to come on at a certain time to wake you up.

Switch on the system and set the clock.

Prepare the music source you want to listen to (disc, radio, USB, iPod or iPhone) and set the volume.

- Press **[CLOCK/TIMER]** to select "⊙PLAY 1", "⊙PLAY 2" or "⊙PLAY 3".

- Within 10 seconds, press **[▲, ▼]** to set the start time.

- Press **[OK]**.

- Do steps 2 and 3 again to set the end time.

To start the timer

- Press **[⊙, PLAY]** to start "⊙PLAY 1", "⊙PLAY 2" or "⊙PLAY 3".

- Press **[⊙]** to switch off the system.

The system must be switched off for the timer to operate.

Change the settings	Do steps 1 through 4 and 6 again (⇒ above).
Change the source or volume	1) Press [⊙, PLAY] two times to remove the timer indicator on the display panel. 2) Change the source or volume. 3) Do steps 5 and 6 (⇒ above).
Check the settings	Press [CLOCK/TIMER] to select "⊙PLAY 1", "⊙PLAY 2" or "⊙PLAY 3".
Cancel	Press [⊙, PLAY] two times to remove the timer indicator on the display panel.

Note:

- The timer starts at a low volume and increases gradually to the preset level.
- The timer comes on at the set time every day if the timer is on.
- If you switch off the system and switch on again while a timer is in operation, the timer will not stop at the end time.

11 REMOTE CONTROL CODE

When other Panasonic equipment responds to the remote control of this system, change the remote control code for this system.

To set the code to "REMOTE 2"

- Press and hold **[CD]** on the main unit and **[2]** on the remote control until "REMOTE 2" is shown.

- Press and hold **[OK]** and **[2]** for a minimum of 4 seconds.

To set the code to "REMOTE 1"

- Press and hold **[CD]** on the main unit and **[1]** on the remote control until "REMOTE 1" is shown.

- Press and hold **[OK]** and **[1]** for a minimum of 4 seconds.

12 TROUBLESHOOTING GUIDE

Before requesting service, indicate the following checks. If you are in doubt about some of the check points, or if the solutions indicated do not solve the problem, consult your dealer for instructions.

Common problems

No operations can be done with the remote control.

- Examine that the battery is installed correctly.

Sound is distorted or no sound.

- Increase the volume.
- Switch off the system, determine and correct the cause, then switch the system on again. It can be caused by straining of the speakers through excessive volume or power, and when using the system in a hot environment.

A "humming" sound can be heard during playback.

- An AC mains lead or fluorescent light is near the cables. Keep other appliances and cords away from the cables of this system.

Discs

Display not shown correctly.

Playback does not start.

- You have not put in the disc correctly. Put it in correctly.
- Disc is dirty. Clean the disc.
- Replace the disc if it is scratched, warped, or non-standard.
- There is condensation. Let the system dry for 1 to 2 hours.

Radio

A beat sound is heard.

- Switch off the TV or move it away from the system.
- Set to "BP 1" or "BP 2" when in AM tuner mode.

A low hum is heard during AM broadcasts.

- Move the antenna away from other cables and cords.

iPod or iPhone

You cannot switch on the iPod or iPhone.

- Examine that the battery of the iPod or iPhone is not depleted.
- Switch off the iPod or iPhone and the system before you connect the iPod or iPhone. Connect the iPod or iPhone and try again.

No sound.

- Switch off the iPod or iPhone and remove from the system. Connect the iPod or iPhone to the system and switch it on and play it again.

USB

The USB mass storage device or the contents in it cannot be read.

- The format of the USB mass storage device or the contents in it is/are not compatible with the system.
- USB mass storage devices with storage capacity of more than 32 GB cannot work in some conditions.

Slow operation of the USB mass storage device.

- Large content size or large memory USB mass storage device takes longer time to read.

The elapsed time shown is different from the actual play time.

- Transfer the data to another USB mass storage device or backup the data and reformat the USB mass storage device.

Memory reset (Initialisation)

When the following situations occur, refer to the instructions below to reset the memory:

- There is no response when buttons are pressed.
- You want to clear and reset the memory contents.

To reset the memory

- Disconnect the AC mains lead. (Wait 3 minutes before you continue with step 2.)
- While you press and hold **[⊙/1]** on the main unit, connect the AC mains lead again. "-----" shows on the display panel.
- Release **[⊙/1]**. All the settings are set back to the factory preset. It is necessary to set the memory items again.

6 USING AN iPod OR iPhone

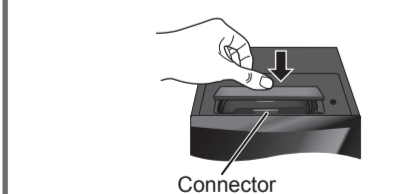

- Press to open the cover and insert a compatible dock adapter.

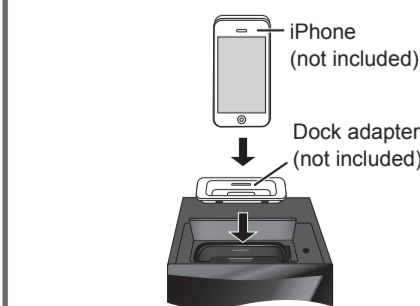

- Connect the iPod or iPhone firmly. Make sure to remove the iPod or iPhone from its case.

- Press **[iPod]** and then press **[▶/II]** to start playback.

Pause playback	Press [▶/II] or [■] .
Skip track	Press [◀◀] or [▶▶] (main unit: [◀◀/▶▶] or [▶▶/▶▶]).
Search the current track	Press and hold [◀◀] or [▶▶] (main unit: [◀◀/▶▶] or [▶▶/▶▶]).
View iPod or iPhone menu. Return to previous menu	Press [iPod MENU] in the play mode.
Select an iPod or iPhone menu item	Press [▲, ▼] and then press [OK] .