



Before operating this unit, please read these instructions completely and save them for future use.

Panasonic Electric Works Co., Ltd.
<http://panasonic.net>

Printed in Japan
ES9700LA631H Y0909-0

Important

► Before use

This WET/DRY shaver can be used for wet shaving with shaving lather or for dry shaving. You can use this watertight shaver in the shower and clean it in water. The following is the symbol of Wet shaver. The symbol means that the hand-held part may be used in a bath or shower.



Treat yourself to wet lather shaves for at least three weeks and notice the difference. Your Panasonic WET/DRY shaver requires a little time to get used to because your skin and beard need about a month to adjust to any new shaving method.

► Using the shaver

Caution - The outer foil is very thin and can be damaged if not used correctly. Check that the foil is not damaged before using the shaver. Do not use the shaver if the foil etc. is damaged as you will cut your skin.

This appliance is not intended for use by persons (including children) with reduced physical, sensory or mental capabilities, or lack of experience and knowledge, unless they have been given supervision or instruction concerning use of the appliance by a person responsible for their safety. Children should be supervised to ensure that they do not play with the appliance.

► Charging the shaver

Do not use any power cord or AC adaptor other than one specifically designed for this model (RE7-51). Plug in the adaptor into a household outlet where there is no moisture and handle it with dry hands. The shaver may become warm during use and charging. However, this is not a malfunction. Do not charge the shaver where it will be exposed to direct sunlight or other heat sources. Hold the

adaptor when disconnecting it from the household outlet. If you tug on the power cord, you may damage it. The supply cord cannot be replaced. If the cord is damaged, the appliance should be scrapped.

Adequate ambient temperature for charging is 15-35 °C.

If the indicators on the LCD panel do not glow, wait for a short while until it glows.

► Cleaning the shaver

Warning - Disconnect the power cord from the shaver before cleaning it to prevent electric shock.

Keep both the inner blades inserted. If only one of the inner blades is inserted, the shaver may be damaged. If you clean the shaver with water, do not use salt water or hot water. Do not soak the shaver in water for a long period of time. Wipe it with a cloth dampened with soapy water. Do not use thinners, benzene, alcohol or other chemicals to clean.

► Storing the shaver

Disconnect the power cord when storing the shaver. Do not bend the power cord or wrap it around the shaver. Keep these operating instructions in a safe place.

SPECIFICATIONS

Power source: See the name plate on the product.
(Automatic voltage conversion)

Motor voltage: 3.6 V DC

Charging time: 1 hour

This product is intended for household use only.

Ⓔ EN

Parts identification

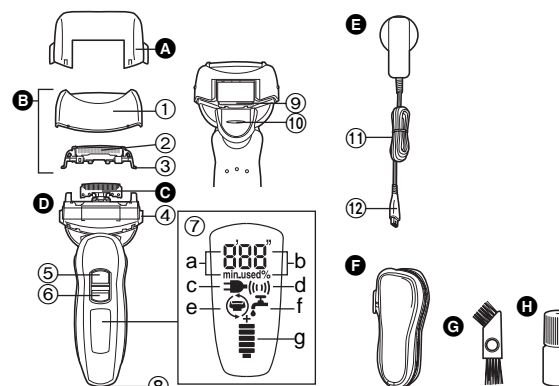

- | | |
|-------------------------------------|---------------------------|
| A Protective cap | c. Charge status |
| B Outer foil section | d. Sonic vibration |
| ① Foil frame | e. Foil/blade check |
| ② System outer foil | f. Clean |
| ③ System outer foil release buttons | g. Battery capacity |
| C Inner blades | Ⓔ Appliance socket |
| D Main body | ⑨ Trimmer |
| ④ Foil frame release buttons | ⑩ Trimmer handle |
| ⑤ OFF/ON switch | E Adaptor (RE7-51) |
| ⑥ Switch lock button | ⑪ Power cord |
| ⑦ LCD panel | ⑫ Appliance plug |
| a. Used time | F Soft case |
| b. Battery capacity | G Cleaning brush |
| | H Oil |

Charge

Charging

- 1** Insert the appliance plug into the shaver.
- 2** Plug in the adaptor into a household outlet.

- The indicators on the LCD panel glow and charging starts.
- Charging is completed when the indicators on the LCD panel blink. (Max. 1 hour later)

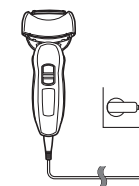

About the LCD panel

The LCD panel shows the remaining battery capacity from 0% to 100%, in 10% increments.

While charging



The indicators glow.

After charging is completed

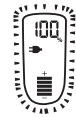

The indicators blink once every second.

10 minutes after charging is completed



The indicators blink once every 2 seconds.

During use



The used time is shown.

- The indicators turn off after 5 seconds.
- The shown time returns to [0'00"] after 10 minutes.

After use

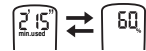

The used time and the remaining battery capacity are shown alternately after turning off the shaver.

When the battery capacity is low

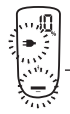

- You can shave 1 to 2 times after "10%" appears. (This will differ depending on usage.)

"10%" appears and blinks.

- A full charge will supply enough power for approx. 14 shaves of 3 minutes each.

Shave

Using the shaver

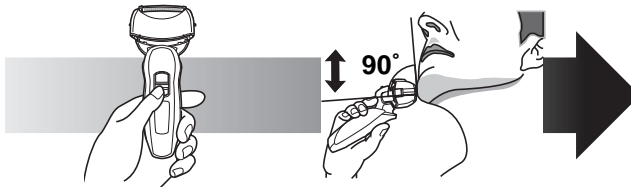

- Slide the switch lock button downwards and press the OFF/ON switch.
- Hold the shaver as illustrated above and shave.

Start out shaving by applying gentle pressure to your face. Stretch your skin with your free hand and move the shaver back and forth in the direction of your beard. You may gently increase the amount of pressure as your skin becomes accustomed to this shaver. Applying excessive pressure does not provide a closer shave.

► Using the trimmer handle

You can change the pivot action. Also, slide the handle up to "mm" when using the trimmer.

FREE

You can move the shaver head.



LOCK

You can lock the shaver head.



mm

Slide the trimmer handle up. Place at a right angle to your skin and move downwards to trim your sideburns.



Clean

Cleaning

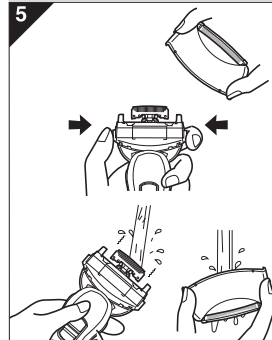
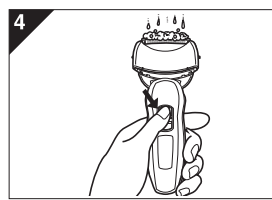

We recommend that you clean your shaver with the turbo mode for "sonic" vibration cleaning when the faucet symbol appears on the LCD panel.

- Disconnect the power cord from the shaver.
- Apply some hand soap and some water to the outer foil.
- Slide the switch lock button downwards to unlock the OFF/ON switch.
- Press the OFF/ON switch for more than 2 seconds to activate the turbo mode for "sonic" vibration cleaning.
 - appears on the LCD panel.
 - After about 20 seconds, it will be automatically turned off, or you can turn it off by pressing the OFF/ON switch.
- Remove the outer foil section and press the OFF/ON switch for more than 2 seconds to activate the turbo mode for "sonic" vibration cleaning and clean it with running water.
- Wipe off any drops of water with a dry cloth.

7

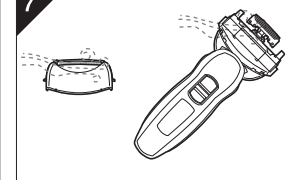

- Dry the outer foil section and the shaver completely.
- Attach the outer foil section to the shaver.
- Lubricate the shaver.

Caution for turbo mode

- Shaving in turbo mode may damage your skin. Turn the shaver off and then on again to cancel turbo mode.
- Do not place your fingers on the OFF/ON switch while using the shaver. This may cause the shaver to turn off or enter turbo mode.

Lubrication

To maintain shaving comfort, it is recommended that the oil provided with the shaver is used.

- Switch off the shaver.
- Apply one drop of oil to each of the outer foils.
- Raise the trimmer and apply a drop of oil.
- Switch the shaver on, and run it for approximately five seconds.
- Switch off the shaver, and wipe off any excess oil from the outer foils with a soft cloth.

Replacing the system outer foil and the inner blades

When appears on the LCD panel, approx once a year (this will differ depending on usage). It is recommended to replace the system outer foil and check the inner blades.

- Press the OFF/ON switch for more than 30 seconds to delete .

system outer foil	once every year
inner blade	once every two years

► Replacing the system outer foil

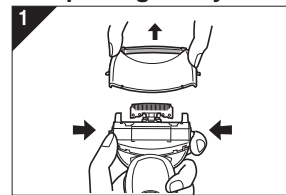

- Press the foil frame release buttons and lift the outer foil section upwards as illustrated.
- Press the system outer foil release buttons and pull down the system outer foil as illustrated.
- Align the foil frame mark and the system outer foil mark and securely attach together.

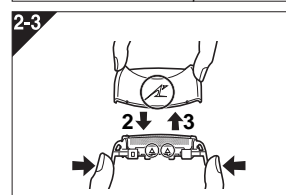

- The system outer foil cannot be reversely attached.
 - Always insert the system outer foil to the foil frame when attaching to the shaver.
- After turning the mark to the front, securely attach the outer foil section to the shaver until it clicks.

► Replacing the inner blades

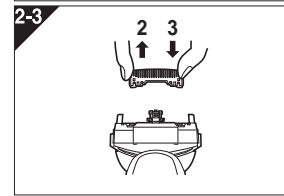
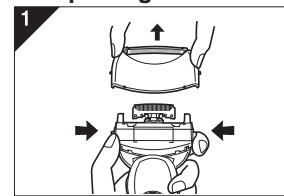

- Press the foil frame release buttons and lift the outer foil section upwards as illustrated.
- Remove the inner blades one at a time as illustrated.
 - Do not touch the edges (metal parts) of the inner blades to prevent injury to your hand.
- Insert the inner blades one at a time until they click as illustrated.

Cleaning with the brush

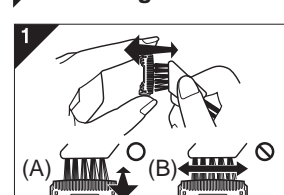

- Clean the inner blades using the short brush by moving it in direction (A). Clean the system outer foil, the shaver body and the trimmer using the long brush.
 - Do not move the short brush in direction (B) as it will damage the inner blades and affect their sharpness.
 - Do not use the short brush to clean the outer foils.

Removing the built-in rechargeable battery

Remove the built-in rechargeable battery before disposing of the shaver. Please make sure that the battery is disposed of at an officially designated location if there is one. Do not dismantle or replace the battery so that you can use the shaver again. This could cause fire or an electric shock. Replace it at an authorised service center.

- Disconnect the power cord from the shaver when removing the battery.
- Perform steps ① to ④ and lift the battery, and then remove it.

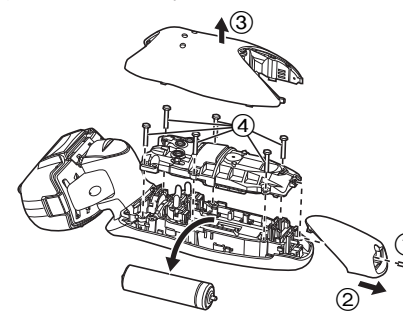

For environmental protection and recycling of materials

This shaver contains a Lithium-ion battery. Please make sure that the battery is disposed of at an officially assigned location, if there is one in your country.