



Panasonic®

Operating Instructions

3 Door Refrigerator
(For household use)

Model No. **NR-CY54A**

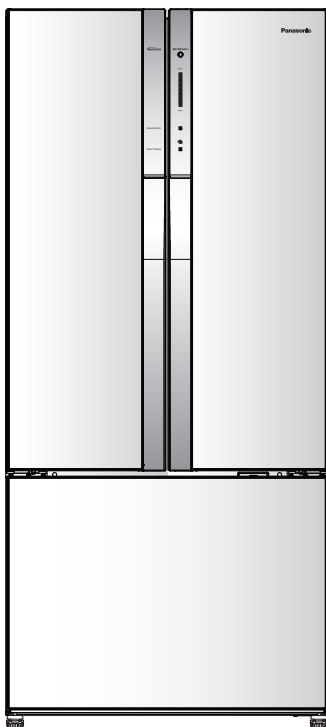

Contents

Safety Precautions	2
Installation	4
Parts Identification	6
To use all features	7
• Temperature Control	7
• Quick Freezing	8
• ECONAVI Operation	8
• Refrigerator Compartment	9
• Freezer Compartment	9
Food Stored	10
Usage Tips	11
Cleaning Tips	12
To Clean	13
Troubleshooting	15
Specifications	16

Thank you for purchasing a Panasonic Refrigerator.

- Before operating this unit, please read these instructions completely.
Before using this product, please pay particular attention to the “Safety precautions” section (Pages 2 and 3) for safe use.
- Please ensure the date and name of store of purchase are stamped in warranty card and keep it stored together with these operating instructions in a safe place for future reference.

AUS/NZ

AK-173620
T1115-0
Printed in Thailand
11-2015

Safety Precautions

Please be sure to observe.



WARNING

This expression presumes possibility of a death or serious injury.



CAUTION

This expression presumes possibility of personal injury or property damage.



Do not



Make sure you do this



Do not take apart



iso-butane

Risk of fire / flammable materials



WARNING



In order to prevent fires, electrical shocks, explosion, injuries, etc.

For power plug and cord...



- Periodically wipe the power plug with a dry cloth. (Dust accumulated on the plug of a refrigerator that operates continuously leads to reduced insulation due to moisture and may cause fire.)
- Plug into a wall outlet of the rated voltage on its own with the rated current and insert plug fully.
- Connect to an exclusive wall outlet for the refrigerator only. Avoid connecting other appliances to the same wall outlet. Unroll entire length of the cord before plugging in.
- Unplug the unit when cleaning the refrigerator.
- If the supply cord is damaged, it must be replaced by the manufacturer, its service agent or similarly qualified persons in order to avoid a hazard.
- Do not sandwich the cord between the refrigerator and the wall, etc.
- Do not let the cord get damaged.
- Do not insert or disconnect the power plug into/from the wall socket with wet hands.



On top of the refrigerator...



- Do not put anything on top of refrigerator. Otherwise, it may fall due to vibration of the machine.

In case of emergency...



**R600a
iso-butane**

- Maintenance work must only be carried out at workshop by well-trained maintenance worker.



- Do not store explosive substances such as aerosol cans with a flammable propellant and chemicals or scientific specimens in the appliance.
- Do not use electrical appliances such as a deodorizer in the refrigerator. Leaked refrigerant may catch fire from a spark of the electrical contacts and may cause an explosion.
- Do not disassemble, repair or modify the refrigerator by yourself. If you want to repair the refrigerator, please consult your dealer or authorized service center.
- Do not use mechanical devices or other means to accelerate the defrosting process, other than those recommended by the manufacturer.



When recycling the product...



- Before taking the refrigerator to be recycled, please remove the door gasket to prevent locking a child in it.
- The operating instructions should be handed over to any person who would use or handle the refrigerator whenever the refrigerator would be transferred to another location and delivered to a recycling plant.
- Cyclo-Pentane is used for insulation of this refrigerator and flammable gas is used for refrigerant. When disposing of this unit, please discard it by the proper method and do not dispose of the unit by burning.
- The warning labels mentioned above should be kept throughout the life of the refrigerator.



WARNING

When installing...



- Do not install the product in locations exposed to water.
- Provide a grounding connection or install a ground-fault interrupter when the product is installed in a humid or wet location. (Contact your distributor.)
- Do not block the ventilation port of the refrigerator or spaces around it. Leaked refrigerant may cause a fire and explosion.



- For safety it should be checked that the ground connection system in the house has been installed correctly.

When using...



- Do not let any children hang or ride on the refrigerator door, the unit may turn over and cause an accident.
- Do not apply water on the body or interior. Electrical insulation could deteriorate and may cause shocks or fire.
- Do not damage the cooling circuit (piping on the back). The flammable refrigerant may catch fire and lead to an explosion.
- Do not touch the compressor or pipes because of high temperature. There is a risk of burn injury.
- Do not spray combustible chemicals near the refrigerator.



- If you detect a burning smell, disconnect the power plug.
- If you detect a gas leak from the cooling range, ventilate the kitchen.
- If you have damaged the cooling circuit (piping on the back), then ventilate the kitchen and contact your distributor.
- Refrigerator LED lamp.
The refrigerator LED lamp is designed specially for this product, it does not function on individual replacing. If replacement is required, please contact your dealer or authorised service agent.



- This appliance is not intended for use by persons (including children) with reduced physical, sensory or mental capabilities, or lack of experience and knowledge, unless they have been given supervision or instruction concerning use of the appliance by a person responsible for their safety.
- Children should be supervised to ensure that they do not play with the appliance.



CAUTION

When storing food...



- Do not freeze glass bottles, that there is a risk of injury. (If the liquid in a glass bottle is frozen and broken, you may be injured.)
- Do not touch frozen foods or containers (especially metallic) with wet hands.
- Do not place warm/hot foodstuffs in the refrigerator. Store warm food and drinks after they have cooled.
- Do not eat any smelling or colour-changed food. Rotten food may cause illness.
- Do not subject glass trays to high impact. (Otherwise those glass trays may break and you may be injured)
- Food containers must reach the bottom of the door shelves.
- The foods must not protrude from the shelf.



When opening/closing the doors...



- Do not open the refrigerator doors when someone is in the vicinity of the refrigerator.
- Do not push drawers by holding them at the top.
- Do not open refrigerator frequently or leave it open for long time in order to prevent water dripping inside and wasting energy.
- Be careful not to place your feet under the bottom drawer.
- Mind the gap between the doors. They may nip your hand while closing the door.

When cleaning...



- Do not slide hands on the metal rail.
- Do not clean the refrigerator with chemical substance or liquid. It will cause damage and have corrosion on the surface.
- Do not place your hands or feet beneath the bottom of the refrigerator.

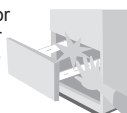

When moving or transporting the refrigerator...



- Do not transport refrigerators in a horizontal position. Laying a refrigerator horizontally may damage the piping. If any damage is noticed, do not touch the refrigerator, avoid using fire and ventilate the room.
- Apply protective covering, etc. to floors with a fragile surface.
- Hold the carrying handles when transporting the refrigerator.



Installation

Before using for product.



Install the refrigerator in the following locations.

- Locate away from direct sunlight or heat.
- Place in a well ventilated location to avoid rust.
- Position on a level and even surface.
→ On carpet, mats or vinyl floors place a plate underneath the refrigerator.
- Place the refrigerator away from other devices to prevent noise and incorrect image display on TV's and other devices.
- Allow access to the power plug for easy cleaning to avoid dust accumulation.

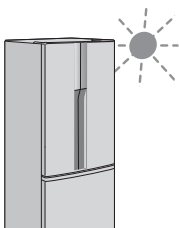

Has a heat radiating space been provided around the refrigerator?

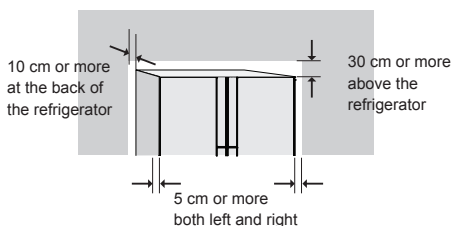

Have any measures taken against tipping due to earthquakes?

In order to prevent the refrigerator from tipping, permanently fix it by using belts, etc.

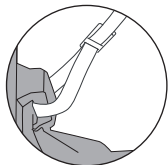

Fix the refrigerator.

Turn the adjuster bolts (right and left) until they reach the floor to stabilize the refrigerator.

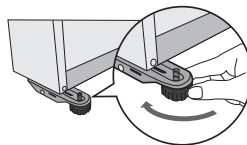

Notice

Immediately after the installation, noise becomes a little louder because the interior of the refrigerator is not yet cooled and the compressor or the fan is operated with high-speed rotation, but it is not abnormal. (Once the interior of the refrigerator is cooled, the noise will reduce.)

Requests and notices



Do not peel the seal on the back.

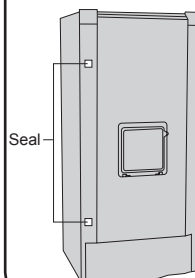

Otherwise, the cooling performance may deteriorate. If you have peeled it, then cut a cloth packing tape into a square and paste it onto the refrigerator.

Do not open/close the doors during the interior cooling process.

Do not open/close the doors until the interior has cooled down sufficiently. (Warm air flowing into the interior will block the cooling function.)



Please wait until the interior has cooled down.

- It may take approximately four hours to cool down the interior.
- It may take 24 hours or more to cool down the interior and achieve equilibrium in the summer, etc.
- Ice-making starts only after the interior has been cooled down sufficiently.

Installation

■ If the door is slanted downwards.

Turn the adjuster bolt on the lower side, as shown in the diagram on the left, in order to adjust the level.

- The freezer/refrigerator doors may tilt within four to five days after installation due to the load of the food or adaptation to the floor surface, turn the corresponding adjuster bolt with the dedicated tool to adjust and level the door again to restore.

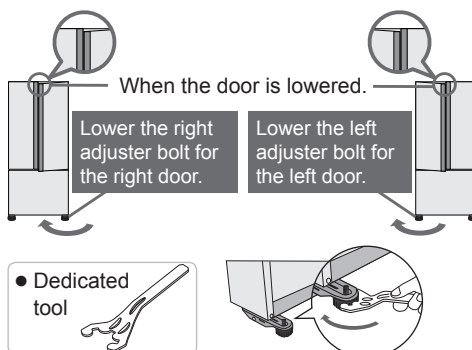

Parts Identification

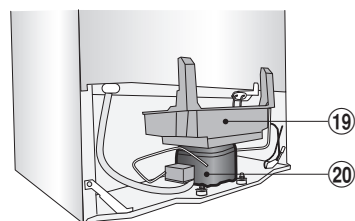
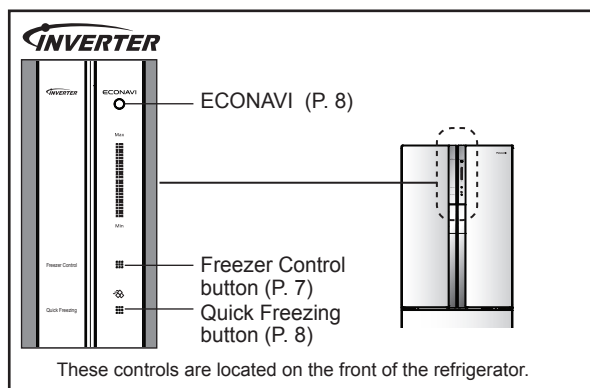
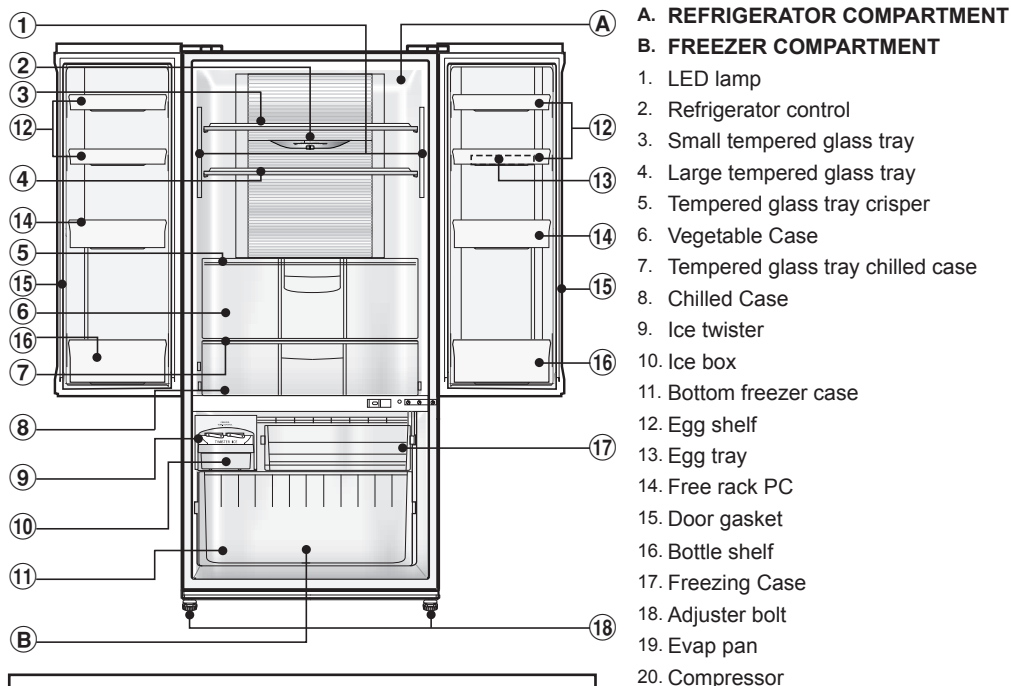

Special feature

■ NON-FLON

This unit uses totally NON-FLON MATERIALS both for refrigerant (iso-butane (R600a)) and for insulation (Cyclo-Pentane). These materials do not damage the earth's ozone layer and has almost no effect on global warming.

■ INVERTER

In accordance with temperature change inside the compartment, the motor will run at different speeds. When the temperature inside the refrigerator is stable, the motor will run at a lower speed to save energy and lower noise. When powerful cooling is required, the motor will run at a higher speed.

To use all features

Temperature Control

- Sliding the lever to operate the "REFRIGERATOR CONTROL" when changing the temperature of refrigerator compartment.

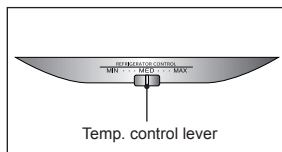

TEMP. CONTROL REFRIGERATOR COMPARTMENT	
"MIN"	Higher than "MED" by approximately 2°C ~ 3°C
"MED"	Approximately 1°C ~ 6°C
"MAX"	Lower than "MED" by approximately 2°C ~ 3°C

- Operate the "Freezer Control" button when changing the freezer compartment.

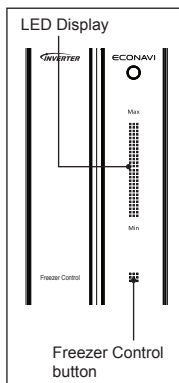

TEMP. CONTROL FREEZER COMPARTMENT	
LED Display "Blue light LED"	Temperature of freezer compartment
"Max"	Lower than "Med" by approximately 2°C ~ 3°C
"Med"	Approximately -17°C ~ -23°C
"Min"	Higher than "Med" by approximately 2°C ~ 3°C

Notices

The temperature control can vary depending on the environment and amount of food stored in the refrigerator.

How to operate the "9 levels" mode

This refrigerator is specially designed with adjustable temperature levels using 9 different temperature levels as explained below:

- ① Set the LED display to the "Min" position by touching the "Freezer Control" button.
- ② Touch and hold the "Freezer Control" button for 10 seconds until the LED display is at the "Min" position.
- ③ Use the "Freezer Control" button to set the required temperature mode, where one step is the minimum cooling mode and nine step is the maximum cooling mode.

To reset the setting "9 levels" mode



Repeat steps ① and ② to return the unit to normal operation mode.

Cooling Level	<div> <div>Minimum</div> <div></div> <div>Maximum</div> </div>								
Step	1	2	3	4	5	6	7	8	9
Freezer Control LED Display									
	■ ■ ■ Lighting			⚡ Flashing				□ □ □ Not Lighting	

Quick Freezing

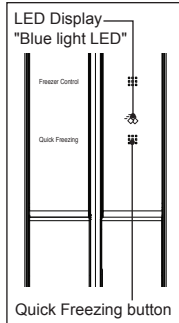
■ How to operate the "Quick Freezing" mode



- Touch the "Quick Freezing" button, the Blue light LED  turns on (150 min. "Quick Freezing" mode).
- The "Quick Freezing" operation will automatically stop after 150 min. and return to normal mode. (The Blue light LED  will turn off).

Notes

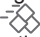
- To stop the "Quick Freezing" operation, touch the "Quick Freezing" button.
- A flashing Blue light LED  indicates the defrosting system is active. The "Quick Freezing" operation will start right after the defrosting operation is finished.
- The Freezer temperature control will not operate during "Quick Freezing" mode as the compressor is already at maximum operating levels for the "Quick Freezing" mode.

ECONAVI Operation

The refrigerator detects the opening and closing of the refrigerator door and the brightness around the refrigerator to automatically control operation to ensure maximum energy saving.*1

ECONAVI lamp is on during ECONAVI operation

- ECONAVI mode: The refrigerator learns the lifestyle patterns of your family from door opening and time periods of infrequent use to maximise energy efficiency.

Notices

- The refrigerator learns your lifestyle patterns from the previous 3 weeks of use and uses that data from the 4th week onwards. Therefore the ECONAVI lamp "ON/OFF" pattern may change from the 4th week onwards.
- The refrigerator performs the ECONAVI energy saving operation when it becomes dark*2 around the refrigerator such as overnight when you are asleep.
- The brightness of the ECONAVI lamp is lowered approximately 5 minutes after it is lit.

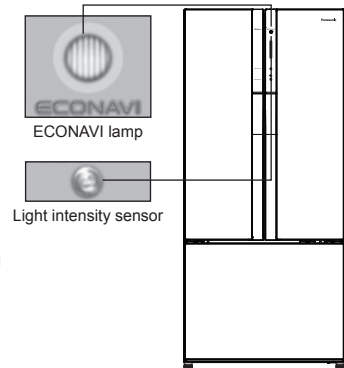

Settings for enabling ECONAVI operation

- ECONAVI operation is automatically enabled when the temperature control for the freezer compartment is set to "Med".
- ECONAVI mode does not operate if the "Quick Freezing" mode is in operation.
- It is not possible to force to start of the ECONAVI mode.

Remark

*1 The effectiveness of the ECONAVI mode is dependant on the ambient temperature, ambient brightness and the number of times the refrigerator door is opened and closed and the state in which food is stored.

*2 Darkness is detected by the light intensity sensor at approximately 3 lx to 10 lx or less

Refrigerator Compartment

Only the height of the second "tray" from the top can be changed.

- (1) Lift up the rear side of the tray and pull it forward. Once the protrusions of the tray are unhooked from rails, tilt and remove the tray by rotating it.

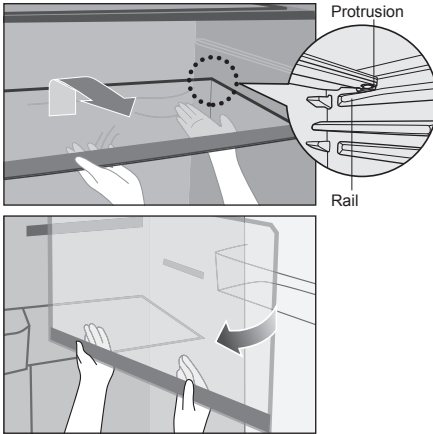

- (2) Insert the tray in the desired position by reversing the steps.

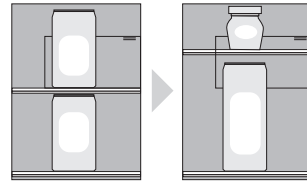

Warning

- When the rotary partition is opened forward, put it back into place. (The doors cannot be closed and it may cause damage.)



Freezer Compartment

Food storage in the bottom freezer case

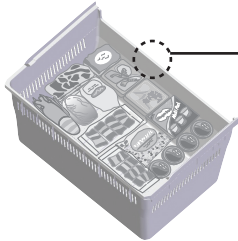

Storage upper limit line

If the inserted food exceeds this line, The cooling performance may deteriorate or the compartment may become frosted.

Three tips for freezing food and locking in the flavour...



1. Freeze thin and small items of food quickly!
2. Ensure food is fully sealed
3. Do not refreeze

To make ice

- 1** Take out the ice twister

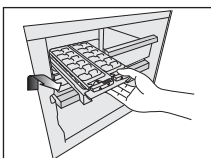

- Pull out the ice twister. (See page 14)

- 2** Fill with water

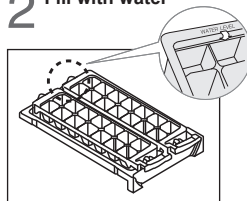

- Fill water up to the "WATER LEVEL" line.

- 3** Install the ice twister

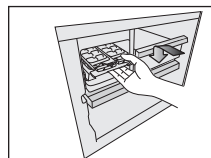

- Place tray back into the ice making compartment. (P.14)

- 4** To move ice cubes

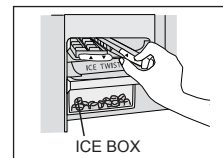

- Twist the ice twister clockwise. (The ice cubes will drop into the ice box.)

To use all features

Foods Stored

■ In order to preserve food quality for long time, please store it in the right place.



When storing food...

- Foodstuff such as vegetable, fruits and fresh food should be wrapped or packed in box before freezing and refrigerating.
- If you put high moisture content in the refrigerator this should be sealed and wrapped to prevent dew and frost.
- Water and beverage bottles should be sealed to prevent odours.

Where to store these different foodstuffs?

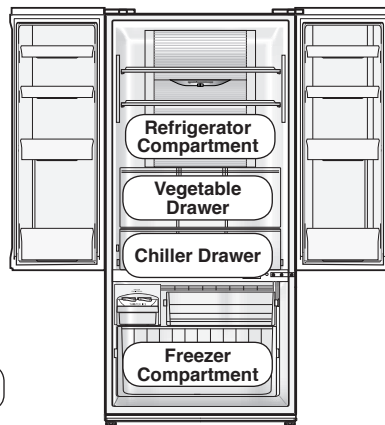

Approx

8°C ~

Approx

3°C ~

Not Frozen

Vegetable Drawer

"Fruits and vegetables"

A rather high humidity keep fruits and vegetables fresh and juicy.



Approx

6°C ~

Approx

1°C ~

Refrigerator Compartment

"Food and drinks readily served"

For regular storage of food and drinks or temporary storage of those to be served soon.



Approx

3°C ~

Approx

-3°C ~

Chiller Drawer

"Food and drinks not to be frozen"

For dairy products, etc. that perish easily but whose quality changes if frozen.



Approx

-17°C ~

Approx

-23°C ~

Frozen

Freezer Compartment

"If storing food for an extended period..."

For storage of frozen or dried foods.



• When set to "MED", the temperature may vary slightly depending on the usage conditions.



Basics of energy saving

Save cool air!

Energy saving tips

Do not stuff food into the compartments.

That may interfere with the cold air flow. Provide sufficient space between foods.



Open/close the doors minimum times.

Simply store items not often used in one of the doors, and prevent the cool air from escaping.



Do not block the cold air outlet with food items!

If the cool air does not spread into every corner of the refrigerator, then the interior will not be sufficiently cooled and more electricity will be consumed.



Store warm food and drinks after they have cooled.

Otherwise, they will not only raise the interior temperature, but also affect the freshness of other foods.



Do not put food in the refrigerator when it is not necessary.

■ A cold dark place will suffice!



It is not necessary to store uncut onions, potatoes, etc. in the refrigerator (except during the summer).

■ Cool just before you eat!



If uncut tropical fruits are cooled down excessively, they may be discolored or their vitamin contents may decrease.

Storage using tightly sealed containers is recommended!



To prevent the interior from being discoloured!



- Cut citrus fruits
(→ The plastic will be discoloured white.)

To prevent odours from spreading!



- Garlic or other strong smelling vegetables
(→ Odours will spread to other nearby food.)

Cleaning Tips

1 Clean the refrigerator immediately after it is stained!

Wipe off stains on the interior surfaces quickly before they harden.

In particular, cooking oil may cause plastic to crack and citrus juice may cause the refrigerator to become discoloured. When stains cannot be removed easily, wipe them with a cloth lightly soaked in a neutral kitchen detergent. Then, wipe with a cloth lightly dipped in water.



Rub the door surface with a soft damp cloth.

Rub the control panels and door buttons with a dry cloth.



2 Clean the detachable items occasionally...

Once a week for the ice twister. As a guide, remove the trays, door shelves, etc. and wash them by immersing them in lukewarm water every three months.



3 Clean the door gasket at least once a month.

Clean by wiping with a soft damp cloth. Petroleum gel has been applied to the door gasket on the hinge side of the unit, be careful not to wipe this off.

Notice

The "door gasket" is replaceable by an authorised service agent. If the door gasket comes off while cleaning, it can be pushed back into the groove.

Point where petroleum gel was applied.

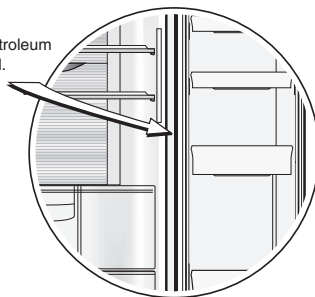

Warning

Do not use the following items for cleaning. (Otherwise, the surface will be scratched.)



Kitchen detergents
(They crack plastic!)

Alkaline or faintly Alkaline



Cleanser or soap powder



Benzine, thinner, alcohol,
acid, petroleum



Scrubber



Hot Water

To Clean

■ Removing and re-installing for cleaning.

Before cleaning or conducting maintenance, be absolutely sure to disconnect the power plug from the power outlet. Do not connect or disconnect the power plug with wet hands.

When the plug is disconnected, leave it for 10 minutes before plugging again. If not, the compressor may not work.

Trays

Removing

1. Unhook from the protrusion at the rear of the tray by lifting the tray upward and pulling the tray forward until it comes free, tilt and remove the tray by rotating it.

Attaching

2. Push the tray until it reached the end lock.

Notice

- When removing the tray above the vegetable case, please pull out the vegetable case first and then follow to removing the tray as above.
- In case of attaching the tray and it does not lock, make sure that you did not attach the wrong tray.

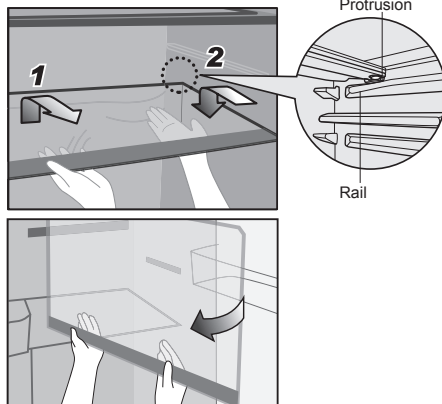

Door shelf

Removing

1. Lift it upward, alternating between the right and left side.

Attaching

2. Place on both supports and then press in until it reaches the end of supports.

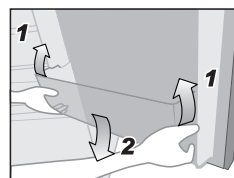

Vegetable case / Chilled case

Removing

1. Pull the case unit forward until it reaches the end of the stopper.
2. Lift the front of the case unit slightly and remove completely.

Attaching

1. Insert the case unit into the supports.
2. Raise the case unit up slightly and push forward until the end is reached.

Notice

- To maintain vitamins in fruits and vegetables, please ensure the drawer locks properly after use.

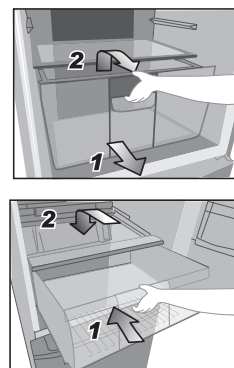

To Clean

Case (Freezer compartment)

1. Pull the freezer draw out towards yourself.
2. Lift up the drawer slightly and pull towards yourself until it reaches the stoppers.
3. Lift both sides of the bottom freezer case and move upward to remove.

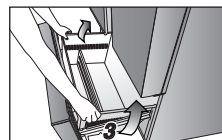
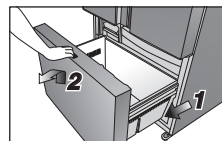

Notice

- The contact sections of the drawer rails have been coated with lubricant. Do not wipe it off.

ICE TWISTER (Quick Ice Making corner)

Removing

1. Unhook the protrusion by lifting it upward and pulling the ice tray and/or ice box forward until completely removed.

Attaching

2. Push the ice tray and/or ice box until it reaches the end lock.



ICE TRAY



ICE BOX

Note

You can disassemble the ice tray and ice box to increase space in the freezer.

Evap pan (Backside of the refrigerator)

Removing

1. Tilt up the evap pan a bit and then lift it upward until the evap pan hole unlocks from the hook evap pan.
2. Pull the evap pan until it touches with the evap pipe then carefully take it out under the evap pipe.

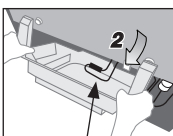
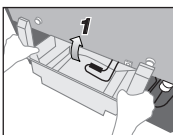

Evap pipe

Attaching

1. Insert the evap pan under the evap pipe.
2. Insert the evap pan hole into the hook evap pan as well as press-fitting both sides.

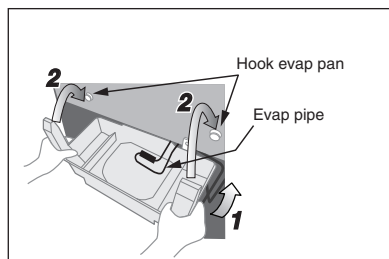

Warning

- Do not damage or deform the Evap pipe.

Troubleshooting

In these cases?

Check here.

The refrigerator does not operate.

- Check that the plug and wall socket are in good condition.
- Check if there is any problem with the mains fuse or house wiring.
- Check by unplugging for 10 minutes and plugging back in.

The refrigerator is not cool enough.

- Check to be sure that the temperature control lever is at the proper position. (P.7)
- Check to ensure that the refrigerator is not overloaded with food or that hot food have been placed in the refrigerator.
- Is the refrigerator exposed to direct sunlight or a heat source? (P.4)
- Is the refrigerator door completely closed?
- Is the refrigerator door opened frequently?

Condensation generated inside and outside the cabinet / surface of door.

- Condensation may appear on the surface of the cabinet when humidity is high or air circulation around the unit is poor.
- If there is condensation inside, check if the door is completely closed. Is the refrigerator frequently opened or left open for a long time? Have any hot foodstuffs been placed inside the refrigerator?

The refrigerator generates noise.

- Check if the refrigerator is located on a stable, level floor and is installed correctly. Use the adjustable bolt if required to level the refrigerator. (P.5)
- Check if there is any object in contact with the refrigerator.
- Cracking sound within caused by the parts adjusting temperature which is normal.
- After installation, the refrigerator may make loud noise. The noise will be less when the refrigerator has been cooled.

Food becomes frozen

- Was the food placed near the cold air duct?
- If the temperature control has been set to "Max" try adjusting the temperature control to the "Min" setting.
- Has the food been placed in the chilled case?

ECONAVI does not operate.
(the ECONAVI lamp does not light)

- Has the "Quick Freezing" mode been activated? (P.8)
- Is the temperature setting of the freezer compartment set to something other than "Med"?
- Has the door been opened frequently or has hot food been placed in the refrigerator?
- The learning function may automatically disable ECONAVI operation during times of frequent use.

ECONAVI operation is rarely performed.

- Is there a power failure?
If a power failure occurs, the learning function data collected up until the point of power failure will be lost. The ECONAVI operation will rarely be performed until the learning function has collected data again.

ECONAVI operation is stopped part way though.

- If the auto defrost function is turned on during ECONAVI operation, the normal cooling operation will need to be performed after defrost. Therefore the ECONAVI operation may be stopped during this defrost/cooling process.
- The learning function may sometimes restart the normal cooling operation.

ECONAVI operation is performed too often (the ECONAVI lamp rarely turns off).

- Is the light intensity sensor hidden?
- Are there dirt or scratches on the control panel where the light intensity sensor is located?
- ECONAVI operation may be performed while the refrigerator is being used depending on the conditions of use, but the cooling performance is maintained.



The ECONAVI lamp does not light properly.

To Clean Troubleshooting

Specifications

Model No.		NR-CY54A
Freezer Star Rating		✱✱✱
Capacity (L) Gross / Storage (AS/NZS 4474.1:2007)	Total	547 / 452
	Freezer	153 / 99
	Refrigerator	394 / 353
Outside Dimensions Width x Depth x Height (mm)		770 x 743 x 1,714
Refrigerant Type		R600a
Net Weight (kg/lb)		90 / 198
Cooling System		Non-frost cooling.
Rated Voltage (V) Rated Frequency (Hz)		Refer to the rating label put at the door or the back of the cabinet.

Panasonic Corporation

Website: <http://www.panasonic.com>

© Panasonic Appliances (Thailand) Co., Ltd. 2015