

Panasonic®

Operating Instructions & Installation Instructions

Washing Machine
(Domestic use)

Model No.

NA - 128VG5



Read Before Using	3
SAFETY PRECAUTIONS	3
Installation Instructions	10
Preparations	15
Washing Instructions	23
Maintenance	31
Troubleshooting	34
Others	39

Thank you for purchasing this appliance.

- For optimum performance and safety, please read these instructions carefully.
- Before connecting, operating or adjusting this appliance, please read the instructions completely. Please keep this manual for future reference.

CONTENTS

Read Before Using

SAFETY PRECAUTIONS	3
Checking Your Washing Machine . . .	9

Installation Instructions

Choosing the Right Location	10
Carrying the appliance	10
Installation of bottom plate	10
Installing the set-in appliance	10
The right place for the appliance	10
Installation	11
Removing the anchor bolts	11
Levelling the appliance	11
Connecting Hoses and Power Supply	12
Hoses and lead lengths	12
Water-supply hose	12
Water-drain hose	13
Connecting to the power supply	13
Checking after Installation	14
Installation checklist	14
Test run after installation	14

Preparations

Before Washing	15
Using the Buttons	18
Door locking and unlocking methods . . .	20
Adding Detergent and Other Chemicals	21

Washing Instructions

Washing	23
Optional Functions	24
Preset timer	24
Individual washing functions	24
Child lock	25
Setting the buzzer	25
Programme List	26

Maintenance

Maintenance	31
Cleaning the outside of the appliance	31
Cleaning the detergent drawer	31
Cleaning the door seal and window . .	32
Cleaning the drain filter	32
Cleaning the water supply filter	33
Preventing a frozen water supply hose	33

Troubleshooting

Fault Checklist	34
Error	37
Consider the Environment	38

Others

Power and Water Consumption . . .	39
Specifications	40

Read and follow these safety precautions.

WARNING

This describes issues which could cause death or serious injury.

General Use

- This appliance is not intended for use by persons (including children) with reduced physical, sensory or mental capabilities, or lack of experience and knowledge, unless they have been given supervision or instruction concerning use of the appliance by a person responsible for their safety.
- Children should be supervised to ensure that they do not play with the appliance.
- Do NOT place a stand or a chair close to the appliance.
Children may reach the control panel or climb onto or into the appliance.
- Turn off the water supply to the appliance if it will not be used for a prolonged period, such as during a holiday. This is particularly important if there is no drainage around the appliance.
If the water supply is left on, the water pressure may increase and result in a leak.

SAFETY PRECAUTIONS

- Do NOT install the appliance in a damp location or in a location exposed to the weather.
This may result in product malfunction or deterioration, electric shock or fire.
- Do NOT spill water directly onto any part of the appliance.
This may result in malfunction, electric shock or fire.
- Keep sources of ignition, such as candles or cigarettes, away from the appliance.
They may cause a fire or damage to the appliance.
- Keep flammable materials away from the appliance, for example, gasoline, thinner, alcohol, or clothing soaked with these materials.
They may cause an explosion or a fire.

Power source and cable

- Unplug the mains lead when cleaning the appliance.

WARNING

- Check the mains lead and mains plug for damage.
If the mains lead is damaged, it must be replaced by the manufacturer, its service agent or similarly qualified persons to avoid a hazard.
- Do NOT use a mains plug adaptor or extension cable. There is a possibility of overheating which may cause a fire. Use an unused household mains socket, fully rated at AC 220 V to 240 V. If you are not sure, contact a qualified electrician.
- ENSURE the mains plug is fully inserted into the household mains socket.
Otherwise, a loose connection may overheat and cause an electric shock or fire.
- Do NOT touch the mains lead or mains plug with wet hands.
Doing so may cause an electric shock.
- Do NOT pull the mains lead but hold the mains plug to unplug the appliance.
Otherwise, the mains lead may be damaged, which may lead to an electric shock or fire.

SAFETY PRECAUTIONS

To Prevent Injury

- The appliance should be installed by the manufacturer's dealer or service agent. If the installation, test run and inspection are not carried out following the installation method outlined in these instructions, the manufacturer will not be liable for any accident or damage caused.
- Do NOT dismantle, repair or modify the appliance.
The appliance may malfunction, which may result in a fire or an injury. If repairs are needed, contact your local Customer Service Centre.
- Do NOT touch the laundry inside the drum until it has completely stopped, as there is a possibility of injury. Keep children away from the rotating drum.



CAUTION

This describes issues which could cause injury or damage your belongings.

General Use

- Prior to use, turn on the tap and check the hose and connections for any leaks.
Improper connection could cause leaks.
- Do NOT obstruct the openings of the bottom face with carpet, etc.

CAUTION

- New hose-sets supplied with the appliance are to be used and old hose-sets should not be reused.
- This appliance is only suitable for textiles labelled washing machine washable.
- Do NOT connect to the hot water supply. This appliance works ONLY with cold water.
- Do NOT apply pesticide, hair spray or deodorant to the appliance.
- Do NOT put any electrical equipment, for example, TV, radio or battery charger, on or near the appliance.
- Do NOT put excessive laundry or detergent into the appliance. This may cause damage to the appliance.
- REMOVE the anchor bolts using the supplied spanner or a similar tool before installing the appliance. The anchor bolts are used to transport the appliance. If the anchor bolts are not removed, the appliance will vibrate severely during use.
- The installation shall be in accordance with the requirements of AS/NZS 3500.1.1.

SAFETY PRECAUTIONS

To Prevent Injury

- Do NOT climb onto the appliance.
This may cause injury or damage to the appliance.
- Keep fingers away from the door hinge when opening and closing the door.
- Do NOT slide your hand (or unprotected foot) underneath the appliance when in use.
- Check all of the laundry and remove all objects such as nails, pins, coins, clips, metal wires, etc.
They may cause damage to the laundry or the appliance.
- Do NOT use the appliance to wash waterproof sheets or clothing. There is a possibility of excessive vibration or failure during the spin cycle, which may result in an injury, damage to the appliance or a water leak.
- BE CAREFUL when draining hot water out of the drum.
- BE CAREFUL not to get laundry caught in the door seal when it is closed. This may result in a water leak or damage to the laundry during the wash cycle.

Checking Your Washing Machine

Detergent drawer
(see page 21)

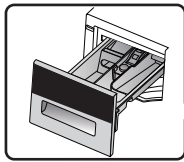

Door

Door seal

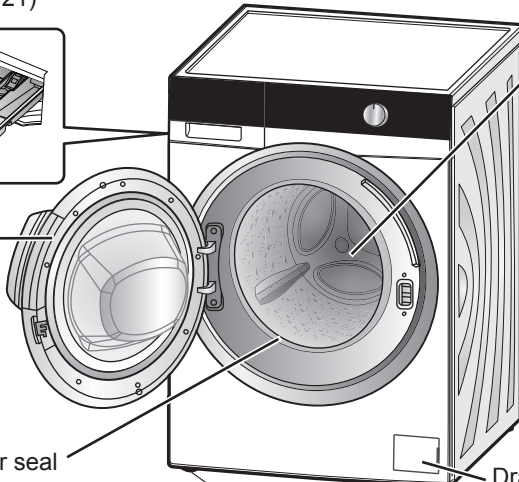

Drum
(Washing/ Spin-
drying tub)

Mains lead/ Mains
plug

Water-drain hose

Adjustable stands
(see page 11)

Drain filter cover
(see page 32)

CAUTION

Do NOT bend the mains lead when the appliance is running.

Accessories

Make sure that all accessories are supplied with the appliance.

Elbow (1) (see page 13)

For fixing the water-drain hose



Cover cap (4) (see page 11)



Water-supply hose (1) (see page 12)

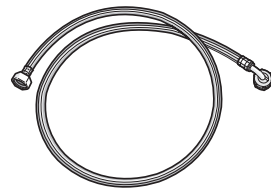

Bottom plate (1) (see page 10)

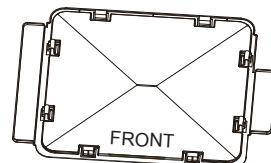

Choosing the Right Location

Carrying the appliance

The appliance must be carried by 2 or more people.



Start by tilting the appliance backwards. One person should stand behind it, holding the rear of the top panel. The other person should grip the bottom stands in the front.

Installation of bottom plate

The accessories for the bottom plate are in the upper foam pad of the packaging, so do not throw the foam pad away.

Upper foam pad Bottom plate (position for bottom plate)

The bottom plate must be installed with the FRONT mark facing frontwards.

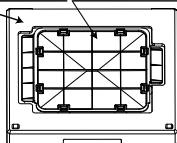

- ① Tilt the appliance body backwards by about 60° and keep it stable, and then conduct installation from the front.
- ② Hang the rear claw of the bottom plate to the base first.
- ③ Snap the front claw into the base. (Until a click is given)
- ④ Snap the left and right claws into the base securely. (Until a click is given)

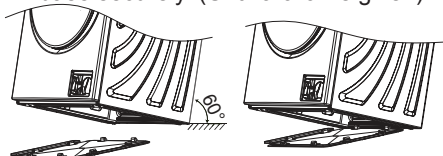

①

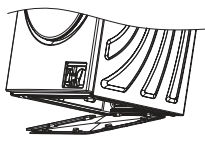

②

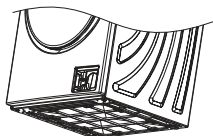

③ ④

Installing the set-in appliance

- You need a space at least 60 cm wide. At least 2 mm of clearance on the sides, and 3 mm of clearance above and behind the appliance are required.
- Remember to insert the mains plug into an independent household dedicated socket, and ensure that the socket is at a place facilitating plug insertion and removal.

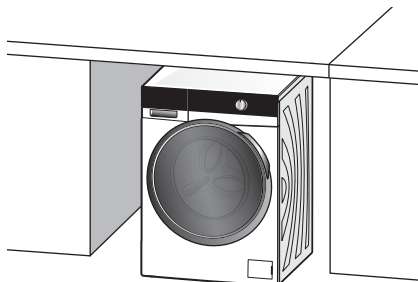

The right place for the appliance

Make sure that there is enough space for the appliance.

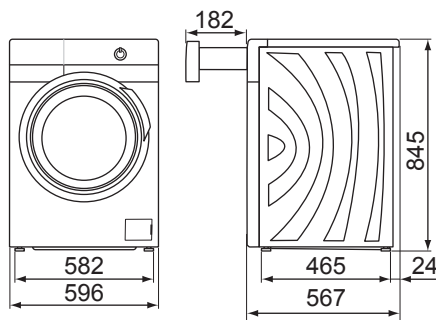

Dimensions (unit: mm)

CAUTION

- Install the appliance on a flat and firm floor surface to avoid excessive vibration and noise.
- Do not install the appliance in direct sunlight or in a place where freezing may occur in winter.
- Do not let metallic portions of the appliance come into contact with metal plates, stainless steel plates of a kitchen sink, or other appliances.

Removing the anchor bolts

The internal parts are fixed by 4 anchor bolts. Carry or move the appliance with the anchor bolts for transport installed, and be sure to remove the bolts using a spanner (non-attached article), etc. before setup.

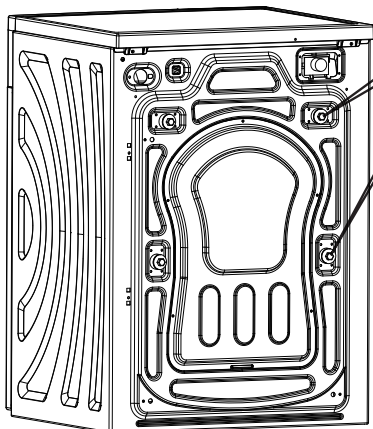

CAUTION

If spin-drying operation is conducted with the bolts for transport installed, extreme vibration will occur.

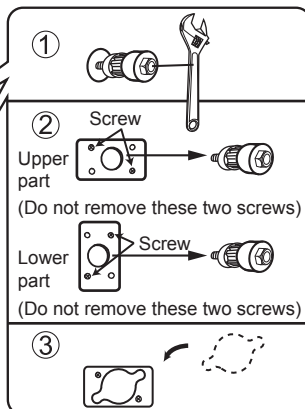

The removed anchor bolts for transport are quite necessary for moving. Be sure to hand them over to the customer.

For carrying again, install the bolts in an order contrary to the removing order.

- ① Loosen the anchor bolts (4 pieces) for transport using a spanner, etc.
- ② Pull the rub part of each bolt outwards while turning it anticlockwise.
- ③ Take cover caps (4 pieces) from the accessories, align them with and press them into the corresponding holes until full matching.

CAUTION

- If the cover caps are not installed properly, intrusion of foreign matter or entry of an infant's finger may occur.
- Rubber may be deformed to cause pull-out difficulty; please contact a service agent.

Levelling the appliance

- When four feet are on a floor surface, the appliance must be level and stable without shaking.
- Level the appliance by using a spirit level and adjusting the foot height. (Place the spirit level in the front-rear direction and in left-right direction.)
- Loosen nut A using a thin spanner.
- Adjust the height of feet B (4 places) by turning in the direction shown in the figure.
- Tighten nut A upwards to prevent the feet from loosening.

※ The spirit level and spanner are not supplied as accessories.

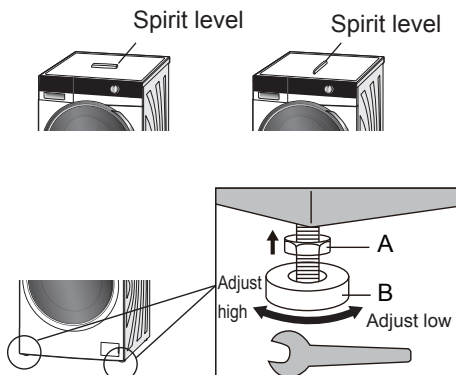

Connecting Hoses and Power Supply

Please follow the instructions in this section to conduct operations to prevent water leak. If you are unsure, ask a service agent to connect the hoses.

Hoses and lead lengths

Left side connections

Right side connections

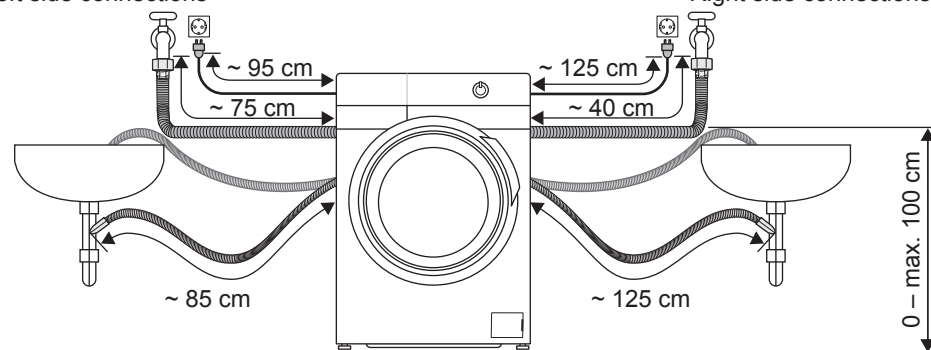

Water-supply hose

CAUTION

- Do not connect the water-supply hose to a combination tap.
- Do not twist, squash, modify, or cut the hose.



- Optimum mains water pressure is 0.03 - 1.0 MPa. If the water pressure exceeds this value, install a pressure reducing valve.
- Water-flow from the tap should be more than 5 L/min.

Connecting the water-supply hose

1. Attach one end of the hose to the water inlet on the back of the appliance and tighten the joint by hand.

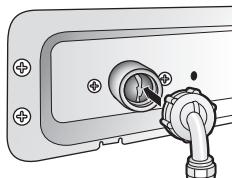

2. Attach the other end of the hose to the tap and tighten it the same way.

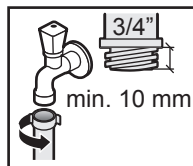

Standard hose

3. Open the tap slowly and make sure that there are no leaks around the joints.
The joints are subject to water pressure.

Connecting Hoses and Power Supply

Water-drain hose

CAUTION

Do not twist, pull, or bend the water-drain hose.

Drain the water to a sink or wash-basin

Elbow
(used only
when hanging
is required)

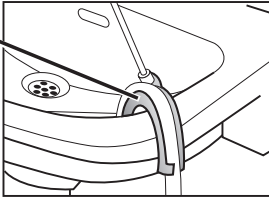

Draining to a drain hose

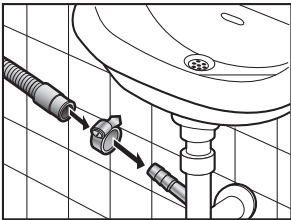

CAUTION

Fix the water-drain hose so that it will not come off.

CAUTION

- Do not clog the water-drain outlet of the wash-basin. Ensure smooth water drainage.
- Do not soak the end of the water-drain hose into the drained water, otherwise water will return into the appliance.

Connecting to the power supply

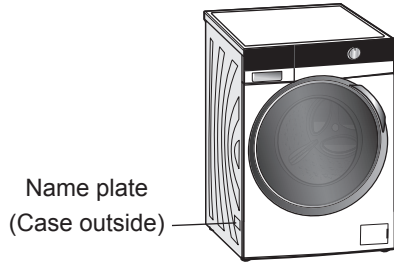

CAUTION

- The name plate indicates the rated power that the appliance needs. Make sure that the power supply specifications in your residence match the information mentioned here.
 - Do not insert the mains plug of the appliance into a socket with an extension cable or a multi-position socket.
- If the mains lead or plug is damaged, stop use the appliance and contact a service agent of the company for replacement.

Checking after Installation

Installation checklist

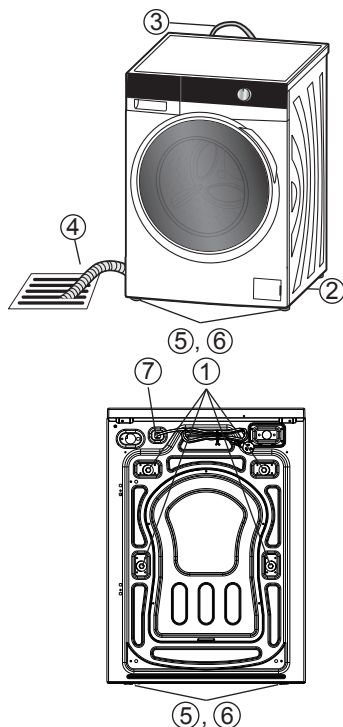

- ① Anchor bolts for transport
Have they been removed?
Have the cover caps been installed correctly?
- ② Installation location
Is the appliance installed on a flat and firm floor surface?
Does it run without vibrating?
- ③ Water-supply hose
Is it free from leaks?
Is the water supply normal?
- ④ Water-drain hose
Is it free from leaks?
Does it drain normally
- ⑤ Adjustable stands
Are they installed securely?

- ⑥ Stand cushions
Are they standing flat?
If the appliance is not level, there may be abnormal sounds when water is drained out.
- ⑦ Mains lead connection
Is the rated voltage of the independent socket between 220 V and 240 V?

Test run after installation

Confirm whether there is water leakage or abnormal noise and whether the water drainage is normal.

Conduct the following operations without laundry in the drum.

1. **Open the water tap.**
2. **Close the door.**
3. **Press the On button, select the Rapid 15 programme, and then press the Start/Pause button.**

Confirm the following:

- Is there abnormal noise?
In case of this, ensure that the appliance is stable.
- Is there a water leak?
In case of this, ensure that the water hoses are connected correctly.

The following errors may occur:

U 11

- Is the water-drain hose connected correctly?
Is the water-drain hose clogged?

U 14

- Is the water-supply hose connected correctly and is the water tap opened?

After checking and eliminating the error, open and then close the door, and re-start the commissioning.

Checking before use

For the appliance's initial operation or after a prolonged period of non-operation, perform the following procedures:

1. **Secure the water supply hose.**
2. **Turn on the tap.**
3. **Connect the power supply.**
4. **Make sure that the water drain hose is positioned towards a drain.**

For more details, see page 13.

Before initial use

The default setting is the 40 °C Cotton programme. Before using the appliance for the first time, run the programme WITHOUT any detergent or clothing to rinse out residue or moisture.

NOTE

There may be residual water in the appliance due to the factory inspection prior to shipment. This is not a malfunction.

Preparing the laundry

Sorting the laundry

- Read clothing care labels to sort the laundry into different loads.
- Sort the laundry by colour, type of fabric and how soiled it is. Doing so will help you choose the correct programme and temperature for each wash.
- Clothes that are not colour fast should be washed separately. Wash denim separately.



- You should put bras with metal wires, tights, lace clothing and small items into a laundry net to prevent them or the appliance from being damaged.

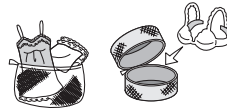

Treating stains

Apply stain remover to stained portions. For dirt and solid stains, wash lightly by hand first.

Checking clothing

- Check that pockets on clothing do not contain any objects that may damage the clothes or the appliance.

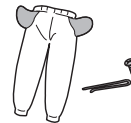

- Tie up any loose strings on the clothing and close zippers. Turn clothing with raised fabrics and zippers inside out. Otherwise, the clothes may be damaged.

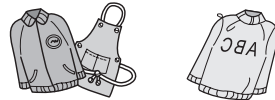

- Remove any hair, animal fur, sand and other materials with a brush before washing.



NOTE

Do not wash clothes heavily stained with large quantities of vegetable oil or cosmetic oil (aroma oil, etc.). Failure to observe this may result in the door seal swelling, causing the water to overflow and leading to malfunctions.

Before Washing

Wool and Delicates programmes

These two programmes, in which the drum spins and stops gently, are the best programmes for washing delicates. For details about washing instructions, see page 23.

Laundry loads

- Wool programme: 2.0 kg or less
- Delicates programme: 2.0 kg or less

Approximate weights

- Wool sweater : 400 g
(1 piece)



- Silk blouse : 200 g
(1 piece)



- Trousers : 400 g
(1 pair)



- With the Wool or Delicates programme, you may need to use the Extra Rinse function to remove excessive detergent from the laundry. (See page 19)

Hanging the laundry

- Hang out white or light-coloured wool and nylon items away from direct heat or sunlight.
- After washing, lay out wool and nylon clothes, and return them to their normal shape before hanging in the shade. This saves on ironing too.
- Hang wool items without folds or creases, or spread them out to dry.

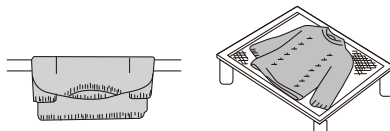

- Use hangers for shirts, blouses, and trousers. You may wrap a towel around the hanger to approximate the clothing's shoulder width so that the clothing will retain its shape as it dries.



Tips for washing delicates

Putting laundry in the drum

Pile items one on top of each other.

※ Excessive clothes may cause vibration; be sure to comply with the specified standard capacity.

Detergents



- For wool items, use neutral liquid detergent. Detergents of other types may damage the clothes.

If clothing shrinks after being washed

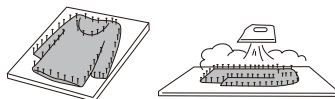
Spread the clothing out to its original size on an ironing board. Use dress pins to hold the size and shape. Then, use an iron to steam the clothing and leave it to dry.



Bedding programme

- Make sure that the label of each item to be washed shows either the machine wash symbol () or handwash symbol () .
- Wash only one blanket at a time.

Washable

- 100% synthetic fibre blankets – up to 3.0 kg
- 100% cotton blankets – up to 1.5 kg (single bed size)
- Sheets
- Bedspreads
- 100% synthetic fibre undersheets

Non-washable

- 100% wool blankets
- Long-piled blankets
- Electric blankets (including cover)

Method for putting blankets, etc. into the drum

1. Fold down blankets or bedspreads into a quarter of their original size.

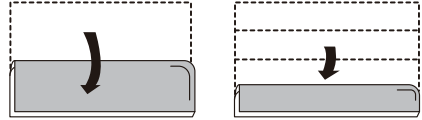

2. Put the blanket or bedspread into the drum.

Fold it as shown in the following figure (6 folds) while putting it into the drum:

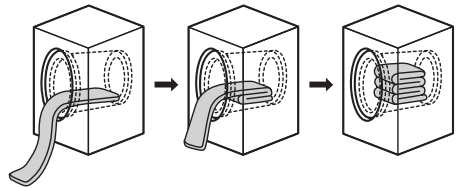

Both ends of the blanket should be directed inward the drum.

CAUTION

- **Do not roll blankets or bedspreads into balls, or haphazardly fold them.**

This may cause excessive vibration and damage to the laundry or the appliance.

- **Do not use blanket nets, which prevent the laundry from being spin-dried properly.**

Using the Buttons

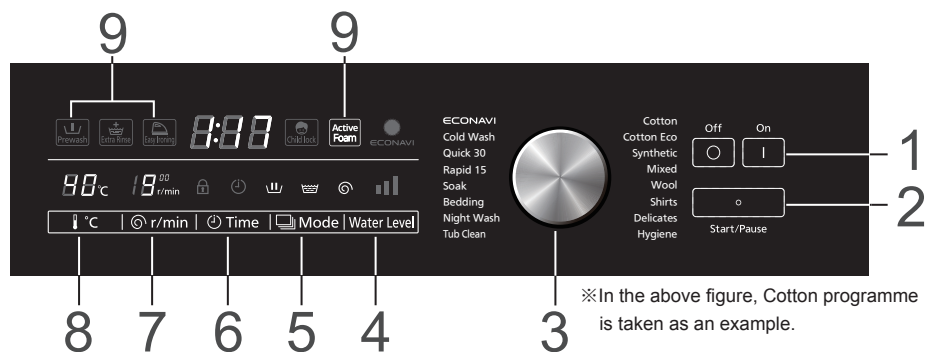

※In the above figure, Cotton programme is taken as an example.

1. Off/On

- If the Start/Pause button is not pressed within 10 minutes after the appliance is turned on, the appliance will be turned off automatically.
- After the appliance is turned off, if you see displayed, then the appliance can be restarted only if this display goes out.

2. Start/Pause

Press this button to start or pause the wash programme.

3. Programme selection

Use this dial to choose the best programme for the laundry.
(See pages 26–27)

4. Water Level

Touch this button to choose three ranges of water level, i.e. high, medium and low, and indicates low water level, indicates medium water level and indicates high water level. In different programmes chosen, some water levels cannot be selected.

5. Mode

Touch this button to select any individual function, e.g., Rinse and Spin, or mixed multiple functions, e.g., Wash - Rinse and Rinse - Spin. (See page 24)

6. Time

Touch this button to set “Wash appointment”, and the setting can be up to 24 hours with 1 hour as unit, which means that the wash is completed 24 hours later. (See page 24)

7. Spin speed

Touch this button to choose a spin speed.

8. Temperature

Touch this button to select washing temperatures ranging from cold to 90 °C. You can select high temperatures for washing whites, sheets, or soiled laundry.

※Note that a high temperature selected for laundry with bright colour may cause staining and discolouration.



9. Additional functions

Touch one of the following function buttons to choose and add a function by yourself according to you needs.

NOTE

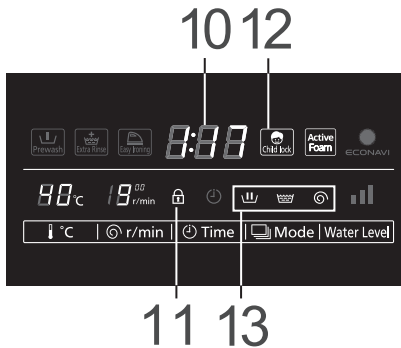
- Operation buttons are capacitive. Touch buttons directly with your finger's skin. (Except On, Off and Start/Pause buttons.)
- When a towel containing water or detergent touches an operation button, the appliance may malfunction.



Function	Description
Prewash 	Prewash soiled laundry.
Extra Rinse 	Add the rinse process once, to more thoroughly rinse the laundry.
Easy Ironing 	<ul style="list-style-type: none"> - This function makes ironing easier by spinning the laundry more gently (at 900 r/min or less). - After washing has finished, the laundry will be rotated intermittently in the drum for at most 30 minutes or until the door is unlocked. - Reduces wrinkles of the laundry and helps unravel tangled laundry.
Active Foam	<p>For a programme with foam cleaning function, this function is defaulted as enabled after the appliance is turned on.</p> <p>This button can be used to choose the foam cleaning function enabled or disabled; when the foam cleaning function is enabled, the indicator lamp of this button flashes.</p>

10. Remaining time indication

- Displays the approximate remaining time until the programme finishes. For example, 1:18 means 1 hour and 18 minutes.
- Detects the weight of the laundry at the beginning of the programme and then provides an approximate running time of the chosen programme.

※This time displayed is only a rough estimation. The actual running time of programme may vary with the amount and type of laundry, the water supply pressure and the water-drain conditions.

11. Door locking indicator lamp

- If the indicator lamp lights up, it indicates that the door is in a locked state.
- If the indicator lamp does not light up, it indicates that the door is in the unlocked state.

12. Child lock

- Touch this button to set the child lock function. Thus, the door and operation panel will be locked.
(See page 25)
The display screen displays CL for two seconds, and the  indicator lamp lights up, this indicates that the child lock is activated.

13. Process indicator lamp

- Shows the current process of the programme. E.g. wash, rinse, and spin.



- If the indicator lamp flashes, it indicates that this process is under way.
- If the indicator lamp goes out, it indicates that this process has finished.

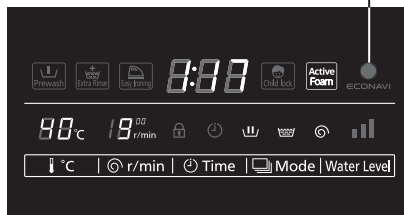

14. ECONAVI indicator lamp

This programme detects the laundry amount and material (cotton, chemical fibre, etc.) and determines the best suited wash time and water amount to save energy and water.

The wash time and water amount can be saved more with smaller amount of laundry, larger amount of clothes that easily dry, such as chemical fibre, or with higher temperature.

- Lamp indications
 - Blinking: Detecting
 - Lighting: In ECONAVI operation
 - OFF: Not in ECONAVI operation

NOTE

When you choose ECONAVI programme, recommend to put the dry laundry only into the drum. ECONAVI sensing may not work properly, if the wet laundry only is loaded.

Door locking and unlocking methods

The door is automatically locked when any programme is run. When the door is locked, the  symbol is displayed.

CAUTION

- When the door is in the locked state, if the appliance is switched off or a power cut occurs, then the door can be unlocked only after the appliance is re-powered on.
- This function is different from the child lock function. (See page 25)

Press the Start/Pause button to unlock the door during operation.

After about 1 minute, the drum will stop and the door will be automatically unlocked. (However, the following cases are exceptional.)

Regarding door locking during operation

1. In high temperature state.
For the sake of safety, even if the appliance stops temporarily at a high temperature, the door cannot be opened.
 - To open the door, switch off the power first, and then re-switch on it and conduct spin-only operation. After water injecting and draining is repeated for several minutes, and the temperature falls, you can open the door.
2. In some programmes, the water level is higher than the door after the appliance enters the rinsing process; therefore, to prevent the water from overflowing, even if the appliance stops temporarily, the door cannot be opened. To open the door, switch off the power first, and then re-switch on it and conduct spin-only operation.

CAUTION

- If you have to unlock the door during programme operation, ensure as much as possible that the water flowing from the drum will not wet the floor.
- When you open the door of the appliance, there may be foam spill, please hold the foams using towel, etc.

Adding Detergent and Other Chemicals

Pull out the detergent drawer and add detergent or softener into the correct compartment. Based on the amount and soiling degree of laundry, the amount of detergent shall be determined by referencing the instructions for various detergents.

CAUTION

Do not use the appliance when the detergent drawer is removed. This may result in a water leak.

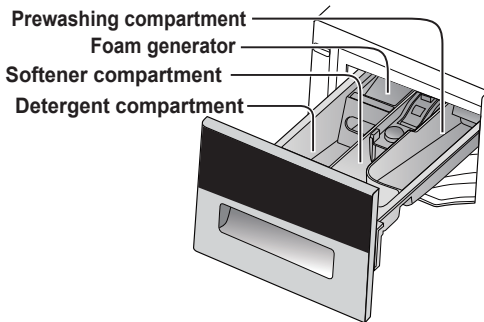

Detergent compartment

The following detergents and additives may be added into this compartment:

- Detergent
- Drum cleaning detergent or bleach

Only when water flows over the detergent compartment can the detergent flow into the drum. Therefore, if you forget to add detergent, please switch off the power, and then re-switch on it and conduct spin-only operation. Afterwards, add detergent and restart the programme.

Detergent

1. Liquid detergent

CAUTION

Do not use liquid detergent in the detergent compartment in the programme with Prewash function. Do not add detergent into the foam generator compartment.

For the Wool programme, it is recommended to use neutral liquid detergent.

2. Powdered detergent

It is recommended to use low-foam powdered detergent.

To prevent powdered detergent from remaining in the drawer:

- Dry the inside of the detergent compartments with a piece of cloth.
- Make sure that the detergent is not lumpy when you add it, as this may cause a blockage over time.
- If the detergent remains in the detergent compartment, put it into the drum.

Amount of detergent

The amount of detergent you should use depends on the following factors:

- The laundry soiling degree
- The amount of the laundry
- Water hardness

The foaming degree depends on the amount and type of detergent, the laundry soiling degree and the hardness and temperature of the water.

Adding Detergent and Other Chemicals

Softener compartment

The following additives may be added into this compartment:

- Fabric softener

Fabric softener

To prevent static electricity, add softener before you start washing. Softener will be automatically added in the final rinse process.

If the softer remains in the softener compartment, dilute the softener before adding it. Add up to only 130 ml to the compartment to avoid overflowing.

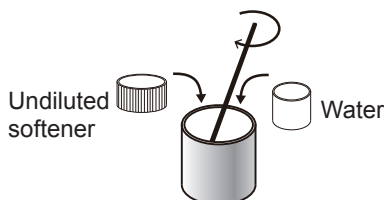

Note that the green cover should be at the correct position; otherwise, automatic injection of softener may be influenced.

The softener should not be beyond the maximum amount mark on the compartment.

※According to different brands, softener may form residue in the detergent drawer when it is injected by water flow; if so, rinse out the remaining softener with clean water.

If the remaining softener cannot be rinsed out, remove the detergent drawer from the appliance and rinse out the residue. (See page 31)

Prewashing detergent compartment

Prewashing detergent

If you choose a programme with Prewash, be sure to add prewashing detergent into this compartment.

CAUTION

- The amount of foam depends on the amount and type of detergent, the laundry soiling degree and the temperature.
- If you open the door of the appliance during operation, there may be foam or water spill, please hold the foams or water using towel, etc.
- Do not use excessive powdered detergent, which may cause excessive foam. In case of excessive foam, the defoaming programme will be added automatically and the time will be extended.

Water softening agent

If you live in a hard water area (total hardness of 1.3 mmol/L or higher), we recommend using a water softening agent. For more details on water hardness, contact your local water authority.

Use of a water softening agent can help reduce the amount of detergent required for each wash and help prevent the formation of limescale deposits, which may damage the appliance.



※In the above figure, Cotton programme is taken as an example.

1. Open the door, and put the laundry into the drum.

For the details of preparation and laundry categorization, see pages 15 and 26–27.

2. Close the door, and then press the On button.

NOTE

- Make sure to place the laundry within the drum so that it does not get caught in the door.

Failure to observe this may result in damage to the door seal, leading to malfunctions.

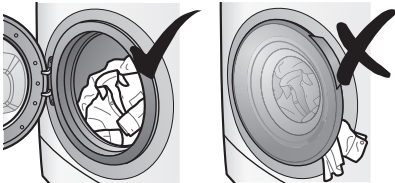

- Do NOT overload the drum. This may cause excessive vibration or damage to the appliance.

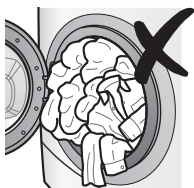

3. Turn the programme selection dial to select the washing programme you need.

- The display screen will display the approximate time required for washing.

4. Select additional functions and other settings.

- Prewash
- Extra Rinse
- Easy Ironing
- Temperature
- Spin speed
- Active Foam
- Water level

For explanation of additional functions and other settings, see pages 18–19.

For more details on the optional functions and settings of each programme, see pages 28–29.

5. Add detergent into the detergent drawer. (See page 21)

6. Press the Start/Pause button.



1:17



Water supply is started after the remaining time is displayed.

The buzzer will sound when the programme has finished, and the door will unlock immediately.

CAUTION

- If the basic programme is used but the detergent in the laundry is not rinsed out completely, please use the Extra Rinse function.
- Take out the laundry and when necessary, return it to its original shape again. Do not leave the laundry in the drum for excessive time after the programme is over, as this may cause discolouration, deformation and/or wrinkling.
- After a high-temperature washing programme, be careful to avoid scalding when taking out the laundry or contacting the inside of the drum.

Optional Functions

Preset timer

Select a time period from the current time to the end of operation.

- No preset time can be set to the Wool, Delicates and Tub Clean programmes.
- The operation time of the appliance may be shorter or longer than the preset time according to the factors including the type of laundry, the temperature, and the water supply and drain conditions.

CAUTION

Do not use detergent that is not easy to dissolve in the preset function, because the detergent might cake up before the wash starts and cannot flow out.

Setting preset timed operation

Continuously touch the preset button until the desired preset time is displayed, and then press the Start/Pause button to complete the preset time setting.

Change the preset time (it needs to be reset after the appliance is powered off and then re-powered on)

1. Press the On button to start the appliance.
2. Select the required programme and optional function.
3. Set a preset time.
4. Press the Start/Pause button.

Cancel the preset time









Press the Off button. (All settings will be cancelled.)

View the preset setting

After a preset time is set, the  indicator lamp lights up constantly. To confirm the preset content, you can touch any button to view it.

Individual washing functions

Touch the Mode button to choose a process

Process	Description
Wash 	When separate washing is conducted (The water is not drained after washing)
Rinse 	Rinse the washed laundry (The water is not drained after rinsing)
Spin 	Spin dry the washed laundry
Wash – Rinse  	Wash and rinse the laundry (The water is not drained after rinsing)
Rinse – Spin  	Rinse and spin dry the washed laundry
Wash – Spin  	When separate washing is conducted

- After the appliance is started, the display symbol flashes to confirm that the process is under way.
- This function cannot be selected in the Rapid 15 and Tub Clean programmes.

Child lock

- To prevent a child from entering the drum, the child lock function locks the door and the buttons.

Activating/deactivating child lock

1. **Press the On button.**
2. **Press and hold the Child lock button for more than 5 seconds.**
When the screen displays CL for two seconds, and a beep is given, the setting is completed. (During child lock setting, even if no washing operation is conducted, the child lock indicator lamp lights up constantly.)
3. **To deactivate, press and hold the Child lock button for more than 5 seconds. Two beeps are given, and the child lock is deactivated.**

Example for using the child lock

- Put the laundry into the drum, select a programme, start operation, and set the child lock. (The child lock is still in locked state after the operation is over.)



- Deactivate the child lock, and take out the laundry.



- When not using the appliance, please set the child lock. (The locked state is maintained after the power supply is switched off.)



- To use the appliance, please deactivate the child lock and then open the door.

CAUTION

If the case displayed in page 37 occurs during operation, please switch off the power, deactivate the child lock and then re-operate the appliance.

Setting the buzzer

Cancel the buzzer given when a programme is over.

1. **Press the On button to start the appliance.**
2. **Press and hold the Mode button for more than 5 seconds.**
A buzzer is given, thus the buzzer given when the washing is over is cancelled. To recover the buzzer, switch off the appliance and repeat the steps 1 and 2. (two buzzers are given.)

Programme List

Programme	Load	Suitable laundry type and conditions
Cotton	8.0 kg	Daily wash for cotton, linen, and cotton blends. (E.g. T-shirt, underwear, towel, and table cloth)
Cotton Eco	8.0 kg	Washing takes longer but consumes less energy and water than the Cotton programme.
Synthetic	4.0 kg	Gentle wash for chemical fibres.
Mixed	8.0 kg	Wash for blend fabrics, e.g. cotton, linen, and synthetic fibres
Wool	2.0 kg	Gentle wash for hand and machine washable wool and wool blend clothes.
Shirts	2.0 kg	Wash for shirts and women's blouses.
Delicates	2.0 kg	Wash for underwear and machine-washable silk clothes. Gentler than the Wool programme.
Hygiene	8.0 kg	Wash for infants' clothing, table cloth and sheets.

Programme List

Programme	Load	Suitable laundry type and conditions
ECONAVI	8.0 kg	For items with mixed Fabric, for example , cotton, linen and synthetic fibres. (For details about ECONAVI programme, see page 20)
Cold Wash	8.0 kg	Washes laundry without warming up water. For cottons and linen blends.
Quick 30	4.0 kg	Rapid wash for lightly-soiled items.
Rapid 15	2.0 kg	15 min wash for some lightly-soiled items.
Soak	4.0 kg	Wash for heavily-soiled clothes.
Bedding	4.0 kg	Wash for large items such as blankets, curtains and bedspreads.
Night Wash	4.0 kg	Low-speed spin-drying, to reduce noise; wash for cotton and chemical fibres.
Tub Clean	—	Cleaning drum (use this programme together with Drum cleaning detergent sold on the market, and operate according to the instructions for the Drum cleaning detergent)

Programme List

Programme	In automatic setting					
	Required time	Temperature	Spin speed	Water level	Temperature	
Cotton	0:57~1:17	40 °C	900 (r/min)	Automatic	Cold 30 °C 40 °C 50 °C 60 °C	
Cotton Eco	3:28~4:28	40 °C	900 (r/min)	Automatic	Cold 30 °C 40 °C 50 °C 60 °C	
Synthetic	0:53	30 °C	700 (r/min)	Medium	Cold 30 °C 40 °C	
Mixed	1:12~1:47	40 °C	1000 (r/min)	Automatic	Cold 30 °C 40 °C	
Wool	0:40	Cold	500 (r/min)	High	Cold 30 °C	
Shirts	1:11	40 °C	500 (r/min)	Low	Cold 30 °C 40 °C 50 °C 60 °C	
Delicates	0:41	30 °C	500 (r/min)	High	Cold 30 °C 40 °C	
Hygiene	1:43~1:58	90 °C	900 (r/min)	Automatic	60 °C 90 °C	
ECONAVI	1:18~2:23	Cold	1000 (r/min)	Automatic	Cold 30 °C 40 °C 50 °C 60 °C	
Cold Wash	1:53~2:53	Cold	1200 (r/min)	Automatic	Non-changeable	
Quick 30	0:30	Cold	900 (r/min)	Medium	Non-changeable	
Rapid 15	0:15	Cold	900 (r/min)	Medium	Non-changeable	
Soak	1:47	40 °C	900 (r/min)	High	Cold 30 °C 40 °C	
Bedding	1:21	Cold	700 (r/min)	High	Cold 30 °C	
Night Wash	1:57	40 °C	500 (r/min)	Medium	Cold 30 °C 40 °C	
Tub Clean	3:36	40 °C	900 (r/min)	High		

Programme List

Change range			Additional function				
	Spin speed	Water level	Prewash	Extra Rinse	Easy Ironing	Active Foam	
	1200 (r/min)1000 (r/min) 900 (r/min) 700 (r/min) 500 (r/min)	High Medium Low	✓	✓	✓	✓	
			✓	✓	✓	✓	
			900 (r/min) 700 (r/min) 500 (r/min)	✓	✓	✓	✓
			1200 (r/min)1000 (r/min) 900 (r/min) 700 (r/min) 500 (r/min)	✓	✓	✓	✓
	Non-changeable		—	✓	—	—	
	700 (r/min) 500 (r/min)	High Medium Low	✓	✓	✓	✓	
	Non-changeable		—	✓	—	—	
	900 (r/min) 700 (r/min) 500 (r/min)	High Medium Low	—	✓	✓	—	
	1200 (r/min)1000 (r/min) 900 (r/min)	Non- changeable	—	—	—	✓	
	1200 (r/min)1000 (r/min) 900 (r/min) 700 (r/min) 500 (r/min)	High Medium Low	✓	✓	✓	✓	
	900 (r/min) 700 (r/min) 500 (r/min)	High Medium Low	—	—	✓	✓	
			—	—	—	✓	
	1200 (r/min)1000 (r/min) 900 (r/min) 700 (r/min) 500 (r/min)	High Medium	—	✓	✓	✓	
			—	✓	✓	✓	
	700 (r/min) 500 (r/min)	High Medium Low	✓	✓	✓	✓	
Non-changeable			—	—	—	—	

Programme List

Required time

The time depends on the selected programme and the set temperature.

- The actual time may be slightly different from the displayed time.
- The displayed time includes the water supply time and water drain time, and may vary with the water pressure, water drain condition, and amount of laundry.
- If you change the settings during washing, the displayed time may change.
- To correct the bias of the laundry, the required time may be extended.

Additional functions

- Based on different programmes selected, different additional functions can be used.
- Some functions cannot be used in some programmes.
- If an unusable function is selected, an alarm for error may be given.
- During washing, the Extra Rinse and Easy Ironing functions can be changed.
Once the rinsing process is started, the setting cannot be changed.

Change settings during washing

- Once the washing is started, the functions other than Spin Speed, Extra Rinse, and Easy Ironing cannot be changed; to change them, switch off the power and then re-switch on it.
- During washing, you can press the Start/Pause button to change the Spin Speed, Extra Rinse or Easy Ironing function.
- If the washing process is completed, the settings cannot be changed.
- In the case of Rinse, Spin, Rinse - Spin, if there has been water in the drum, the programme will start from the drain process, and if there is no water in the drum, the programme will start from Spin; it will take a certain time from start to operation.

Cleaning the outside of the appliance

Clean the appliance body with a piece of soft cloth and mild detergent (e.g. kitchen detergent, and soapy water).

WARNING

- Do not splash water over the appliance body.
- Do not use cleansers, thinners, nor products containing alcohol or paraffin oil.

Cleaning the detergent drawer

Please clean the detergent drawer regularly, to avoid detergent residue and mould development.

1. Pull out the detergent drawer.

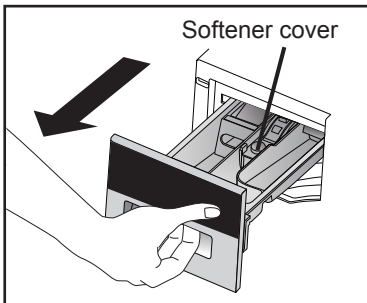

2. Pull it out while pressing the middle tab.

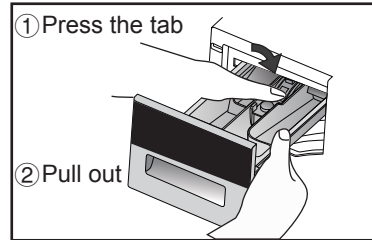

3. Pull laterally by both thumbs with proper force as shown by the small arrows in the figure, and push the softener cover upwards by the thumbs to remove it from the detergent drawer.

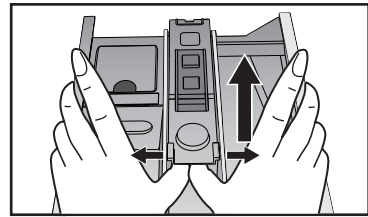

4. Wash out the residual detergent with water.

Use a piece of cloth to wipe the water from the detergent drawer.

5. Press the softener cover down to its original position in the detergent drawer. Confirm that all claws on both sides and in the rear are in place, and then replace the detergent drawer through insertion.

Maintenance

Cleaning the door seal and window

After using the appliance every time, perform the following operations:

- Remove any objects from the door seal.
- Wipe the window glass and door seal to remove lint and stains.
- Open the door timely for ventilation and drying.

Cleaning the drain filter

We recommend cleaning the drain filter once a month. The filter will have lint build up, which can reduce drainage water flow.

1. Switch off and unplug the appliance.
2. Open the front drain filter cover, and place a container to receive the drain water.

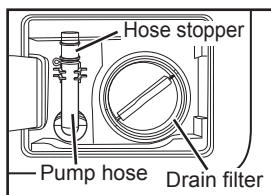

3. Pull out the pump hose, and remove the hose stopper so that the water flows out.

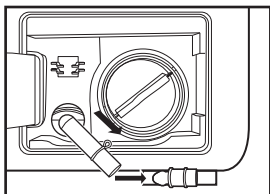

4. After the water is drained completely, turn the drain filter anticlockwise to unscrew it. And then, pull it out.
(Be careful to unscrew the drain filter. There may be more water drained. This is normal.)

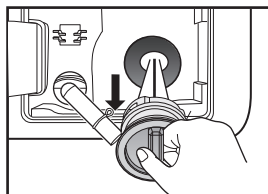
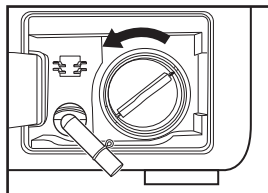

5. Remove any lint and debris.
6. Replace the drain filter.
7. Reinsert the hose stopper into the hose, replace the hose, and close the front drain filter cover.

CAUTION

Be careful when draining hot water. Be sure to turn the drain filter clockwise until it is in place. Otherwise, water leak may occur, and the front drain filter cover may not be closed normally.

Cleaning the water supply filter

- Remove the water-supply hose regularly, and clean out dirt on the filter.
- To prevent water splash, please follow the following steps before removing the water-supply hose.

1. Turn the tap off.
2. Press the On button to switch on the power.
3. Select the Cotton programme, and then press the Start/Pause button.
4. Switch off the power after 1 minute. Water has been drained out of the water-supply hose.
5. Unscrew the water-supply hose and remove it.
6. Clean the filter, which is on the rear of the appliance. Use a small brush, for example, a toothbrush.

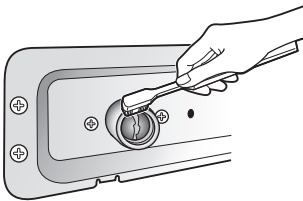

7. Reconnect the water-supply hose, turn on the tap, and check whether there is water leak.

Preventing a frozen water supply hose

If your appliance is delivered in freezing weather conditions, after installation, leave it at room temperature for 24 hours before using. This will ensure that the water-supply and water-drain hoses and internal connection hoses are not frozen.

In case of freezing, perform the following procedures:

1. Wrap hot towels around the joints of the water-supply hose.

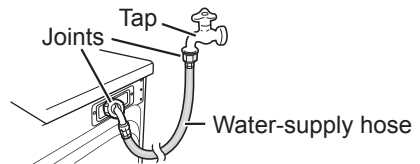

2. Add 2 to 3 litres of warm water into the drum.

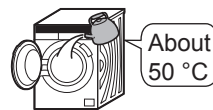

3. After waiting for ten or more minutes, touch the Mode button to run the Spin process.

Fault Checklist

Phenomena		Please confirm
Washing machine	Buttons do not work	<ul style="list-style-type: none"> • After start, you can press the Start/Pause for switch over only during washing. To change the programme, temperature, or the content after rinsing start, please switch off the appliance and then re-switch on it. • The child lock may be activated. (Page 25)
	Door cannot be opened	<ul style="list-style-type: none"> • The door lock may be activated. (Page 20) • The child lock may be activated. (Page 25) • The water temperature or level may be too high.
	Unusual odour	<ul style="list-style-type: none"> • Rubber parts may give off a smell when you start using the appliance, but the smell will go away over time.
Wash	No water seen during washing	<ul style="list-style-type: none"> • The reason is that the amount of water used in washing is less in a drum washing machine than in a pulsator washing machine.
	No water flows into the appliance	<ul style="list-style-type: none"> • The water tap may be turned off. • The water supply hose may be frozen. • The water supply may be disrupted. • The water supply filter may be clogged. (Page 33)
	Water flows into but is not stored in the appliance	<ul style="list-style-type: none"> • Do not open the door to pour water or hot water into the drum; otherwise, the water may not be stored but drained immediately. • When you restart the appliance, water drainage may occur.
	Water flows into the appliance mid-way	<ul style="list-style-type: none"> • If the water level falls, water will be automatically replenished. • When the amount of the laundry is large, water may be automatically replenished several times.
	Water is drained mid-way	<ul style="list-style-type: none"> • If there is too much foam, water drain – water supply operations may be conducted repeatedly to remove the foams. (Detect foam)
Rinse/ spin	No water flows into the appliance during rinsing process.	<ul style="list-style-type: none"> • If there is no water in the drum, the process will start from spin drying; after the spin drying finishes, water is supplied. • If there is no water in the drum, the process will start from water draining.
	Rinsing process begins before the spin drying process finishes	<ul style="list-style-type: none"> • If the laundry leans to one side, the corrective rinsing process will begin, to automatically correct the phenomenon of leaning to one side.
	During spin drying, the drum stops and rotates from time to time	<ul style="list-style-type: none"> • This is normal; the appliance has detected an unbalanced load and is trying to correct it.
	Foam and water remain on the door or the door seal	<ul style="list-style-type: none"> • Although some foam and laundry washing water might remain depending upon the state of the laundry and the amount of detergent used, the performance of the rinsing step is unaffected.
	The spin drying step starts and stops for many times	<ul style="list-style-type: none"> • This is normal; the spin drying step may be repeated but it will be preformed quietly. • The laundry may be too light. If so, add one or two bath towels.

Fault Checklist

Phenomena		Please confirm
Time	Remaining time changes	<ul style="list-style-type: none"> The remaining time is estimated and corrected continually. Thus, the time displayed may change. Therefore, time increase or decrease may occur. The displayed time is a standard time, and may be slightly different from the actually required time. In spin drying, if the laundry leans to one side, the number of running times will rise and the spin drying time will be extended accordingly.
Detergent and foam	Little foam	<ul style="list-style-type: none"> Powdered detergent should not be directly added into the drum. → Be sure to add it into the detergent drawer. The foaming degree may be influenced by water quality, water temperature and water level. <ul style="list-style-type: none"> In the case of little detergent The type of detergent (low-foam detergent, etc.) When the soiling is severe When the amount of the laundry is large
	Too much foam Foam may attach to the inside of the appliance cover	<ul style="list-style-type: none"> The foaming degree may be influenced by water quality, water temperature and water level. You may have used too much detergent. The type of detergent you are using may cause excess foam.
	No foam	<ul style="list-style-type: none"> If the laundry leans to one side, the appliance will automatically supply water; at this moment, foam clean cannot be performed. (To prevent foams from overflowing) Powdered synthetic detergent should not be directly added into the drum. → Be sure to add it into the detergent drawer. The foaming degree may be influenced by water quality, water temperature and water level.
	Softener overflows	<ul style="list-style-type: none"> If the softener added has exceeded the Max level of the detergent drawer, it will overflows naturally. (Page 22) If you close the detergent drawer too strongly, the softener may overflow from the appliance body.
	Powdered synthetic detergent residue	<ul style="list-style-type: none"> Powdered synthetic detergent should not be directly added into the drum. → Be sure to add it into the detergent drawer.
Sound	Abnormal noise Large vibration	<ul style="list-style-type: none"> Have the anchor bolts (for transport) been removed. Is the appliance body installed onto a firm and horizontal floor surface? → Consult the service shop. Has foreign matter such as hair clips or metal objects fallen into the appliance? At the start of washing, was wet laundry only loaded? → Be sure to spin dry wet laundry before start washing.
	There is noise when the water is drained	<ul style="list-style-type: none"> This is normal; the noise is created by the running drain pump.
	Fan rotation sound exists	<ul style="list-style-type: none"> This is normal; the purpose of fan rotation is to cool the electric parts.

Fault Checklist

Phenomena		Please confirm
Others	When power cut occurs	• The appliance stops running. Even if the power supply is recovered, the appliance will not run again. Switch on the power and restart the appliance.
	A circuit breaker trips the electricity supply	• The appliance stops running. After the circuit breaker is reset, the appliance will not run again. Please identify the cause of circuit breaker causing the power supply interruption, and solve the problem. Afterwards, reset the circuit breaker, re-switch on the power and restart the appliance.
	When water supply is disrupted	• After water supply is disrupted, there may be turbid water flowing out; remove the water-supply hose immediately, let turbid water flow out completely from the water tap, and then start the washing.
	The displayed contents are unclear	• When the appliance is set up at an outdoor location or the like, sunlight may directly irradiate the display part, causing the displayed contents to be unclear; this is not a fault.

Beep sounds, with a character U or H and number displayed alternately.

<p>U 11</p> <p>Unable to drain water</p>	<p>Check the water-drain hose for any of the following problems.</p> <ul style="list-style-type: none"> • Is the water-drain hose clogged? • Is the hose immersed in water? • Is the water-drain hose higher than 1 m? • Is the water frozen? • Is the water-drain filter clogged? (Page 32) 	<p>After the fault is eliminated, open the door first and then close it, restart the operation. (However, the door may not be opened due to water level; in this case, switch off the power, and then re-switch on it and restart the operation.)</p>
<p>U 12</p> <p>Door is not closed</p>	<ul style="list-style-type: none"> • Is the door opened? → Close the door. 	
<p>U 13</p> <p>Unable to spin dry</p>	<ul style="list-style-type: none"> • When the laundry is too much → Unravel the tangled laundry. • When the laundry is too little → Add 1–2 bath towels. • When large items including blanket are too many → Decrease some large items. • Is the appliance body shaking or is it placed on a tilt floor surface? 	<p>After the fault is eliminated, open the door, and then re-close it and restart the operation.</p>
<p>U 14</p> <p>Unable to supply water</p>	<ul style="list-style-type: none"> • Is the water tap opened? • Are the tap water pie and water-supply hose frozen? • Is the water supply disrupted? • Is there dirt on the filter in water-supply valve? (Page 33) 	<p>After the fault is eliminated, open the door, and then re-close it and restart the operation.</p>
<p>H 01</p>	<ul style="list-style-type: none"> • When a sign with H, such as H01, appears, beep does not sound. Disconnect the mains plug, and contact a service agent of our company. 	

Consider the Environment

Disposing of packaging

The packaging used to protect the washing machine from damage during transportation is all recyclable. For information on recycling, contact your local authority.

Disposing of Waste Electrical & Electronic Equipment

Information on disposal for users of waste electrical & electronic equipment (private households)



This symbol on the products and/or accompanying documents means that used electrical and electronic products should not be mixed with general household waste.

For proper treatment, recovery and recycling, please take these products to designated collection points, where they will be accepted on a free of charge basis. Alternatively, in some countries you may be able to return your products to your local retailer upon the purchase of an equivalent new product.

Disposing of this product correctly will help to save valuable resources and prevent any potential negative effects on human health and the environment which could otherwise arise from inappropriate waste handling. Please contact your local authority for further details of your nearest designated collection point.

Penalties may be applicable for incorrect disposal of this waste, in accordance with national legislation.

Information on disposal in other countries outside the European Union

This symbol is only valid in the European Union.

If you wish to discard this product, please contact your local authorities or dealer and ask for the correct method of disposal.

Eco-friendly Laundry

- Keep to the load limit of each programme.
- The washing machine automatically adjusts the operating time of each programme depending on the load.
- You only need to use a preliminary wash if your laundry is heavily soiled.

Detergent amount

- Use the correct amount of detergent based on the detergent pack instructions and local water hardness.
- Adjust the amount of detergent depending on how soiled your laundry is.

When using a tumble dryer

To save energy, please select the correct spin speed according to the instructions of your tumble dryer.

Power and Water Consumption

Programme	Temperature	Water level	Load	Power consumption ¹⁾	Water consumption ¹⁾	Time ¹⁾
Cotton	40 °C	High	8 kg	1.00 kWh	85 L	1:17
	60 °C	High	8 kg	1.20 kWh	85 L	1:32
Cotton Eco	40 °C ²⁾	High	8 kg	0.75 kWh	80 L	4:28
	60 °C	Medium	8 kg	0.90 kWh	71 L	4:28
ECONAVI	Cold	High	8 kg	0.36 kWh	97 L	2:23
	40 °C	High	8 kg	1.25 kWh	97 L	2:38
Cold Wash	Cold	High	8 kg	0.40 kWh	80 L	2:53

1) The power, water consumption and time indicated in the table may vary depending on variations in pressures, water hardness and temperatures, room temperatures, types and amounts of laundry, voltage fluctuations and functions to be used.

2) Cotton Eco, 40deg, 1200 r/min is for normally cotton soiled load with AS/NZS 2040.1, AS/NZS 2040.2, AS/NZS 6400.

Specifications

	NA-128VG5
Rated voltage	220 - 240 V
Rated frequency	50 Hz
Maximum energy rated power input	1690 - 1970 W
Heating energy rated power input	1610 W (230 V)
Power consumption	Off-mode/Left On-mode 0.2 W
Maximum spin speed	1200 r/min
Product weight	65 kg
Maximum mass of dry cloth	8 kg
Product dimensions	596 mm (W) ×567 mm (D)×845 mm (H)
Water consumption	Refer to “Power and Water Consumption”.
Pressure of tap water	0.03-1 MPa

