

Panasonic[®]

Operating Instructions

Refrigerator-Freezer (Household use)

Model No. **NR-BS63VS**

English



Contents

Introduction

Caring for the environment	2
Safety instructions	3

Installation

Installation.....	6
Choosing the right location.....	6
Removing the doors	7
Installing the refrigerator.....	9
Preparations	10

Operation

Parts and their functions	11
Interior and foods stored	11
For saving energy.....	12
Control panel.....	13
Setting the temperature	14
Using the handy functions	15
How to make ice	17
Concerning the user alert functions.....	17

Appendix

Removing and re-installing	18
Cleaning and maintenance	19
Cleaning	19
Checks after cleaning and maintenance	20
When the refrigerator is not going to be used for a prolonged period.....	20
When moving or transporting the refrigerator.....	20
Troubleshooting	21
Specifications	23

• **This appliance is intended to be used in household and similar applications such as**

- staff kitchen areas in shops, offices and other working environments;
- farm houses and by clients in hotels, motels and other residential type environments;
- bed and breakfast type environments;
- catering and similar non-retail applications.

Caring for the environment

Disposing of the packaging



Please recycle where possible (e.g. cardboard, plastic bags, adhesive tape and polystyrene) and make sure you dispose of all other packing materials safely.





Keep the packaging out of the reach of babies and young children, to avoid injury or suffocation.

Before disposing of your old appliance

Please follow either the disposal instructions from the manufacturer of the old appliance, or local disposal regulations for the appliance. Where this is not available, please follow the three step instructions below.

1. Remove the plug from the socket.
2. Cut the supply cord off, and safely dispose of it with the mains plug still attached.
3. Until the old appliance is collected, or you take it to a Recycling Centre, make sure it's out the reach of small children.
 - Remove all sealing materials from the door and leave all the shelves and drawers in place.
This way, children are less likely to climb in and become trapped.

Safety instructions

 Do not	 Indicates the appliance must be earthed to prevent electric shock
 Make sure you do this	 Do not take apart



Indicates risk of death or serious injury.

This appliance is not intended for use by persons (including children) with reduced physical, sensory or mental capabilities, or lack of experience and knowledge, unless they have been given supervision or instruction concerning use of the appliance by a person responsible for their safety. Children should be supervised to ensure that they do not play with the appliance.



Do not use a multiple socket adaptor and plug several appliances into the same socket adaptor.

- This can cause overheating, fire or short circuit.

Do not pinch, knot, or bend the supply cord, or place heavy objects on it.

- This increases the risk of fire or electric shock. If the supply cord or plug of the appliance is damaged, it must be replaced by the manufacturer, its service agent or similarly qualified person in order to avoid a hazard.

Do not unplug the refrigerator by pulling on the supply cord.

- This can damage to the supply cord. Always grip the plug and pull firmly from the socket.

Do not place any water container on the top of the refrigerator.

- Water can damage insulation of electrical components and cause short circuit, fire or electric shock.

Do not spray inflammable gas near the refrigerator.

- This can cause explosion or fire.

Do not spray water onto or into the refrigerator.

- This can cause fire or electric shock.

Do not touch the power plug with wet hands.

- This can cause electric shock.

Do not install the refrigerator in a damp place, or where it may come into contact with water.

- Deteriorated insulation of electrical parts can cause short circuit, electric shock or fire.

Do not store volatile or flammable substances in the refrigerator.

- Flammable substances such as benzene, thinners, alcohol, ether and Liquid Petroleum Gas (LPG) can cause explosions.

Do not store pharmaceuticals or other temperature-sensitive products in the refrigerator.

- You should not store products that require strict temperature controls in the refrigerator.

Do not let children climb, swing or hang on the refrigerator door.

- This can cause serious injury, as well as damaging the refrigerator.

Do not operate the refrigerator in the presence of explosive fumes or flammable gas.

- This can cause explosion or fire.

Do not store petrol or other flammable liquids and vapours in the refrigerator, or use them near the appliance.

- This can cause explosion or fire.

Do not use mechanical devices or other means to accelerate the defrosting process, other than those recommended by the manufacturer.

- This can cause damage to the interior of the refrigerator or cause an explosion.



Do not use electrical appliances inside the food storage compartments of the appliance, unless they are of the type recommended by the manufacturer.



Do not try to disassemble, repair or modify the refrigerator yourself.

- You may injure yourself – or others – with burns or electric shock, or damage the refrigerator. If your appliance needs alterations or repair, please consult authorized service centre.



Ensure that the refrigerator is plugged into an earthed mains socket. DO NOT plug into an unearthed mains socket.



Make sure the supply cord and plug are not squashed or damaged.

- A damaged power plug or cord can cause short-circuit, fire or electric shock.
- If the supply cord is damaged, it must be replaced by the manufacturer, its service agent or similarly qualified persons in order to avoid a hazard.
- **DO NOT ATTEMPT TO REPLACE IT YOURSELF.**

Remove any dirt or dust from the plug's pins before connecting to the power supply.

- Dust build-up on the plug can cause insulation failure, especially in humid conditions. This can cause short circuit, fire or electric shock. Unplug the supply cord and wipe it with a dry cloth. Never use a wet or damp cloth.

Plug your appliance into the socket, making sure the connection is secure.

- A loosely connected power plug can cause fire or electric shock.

Install the refrigerator in a well-ventilated area.

- The more refrigerant there is in an appliance, the larger the room it should be installed in. If there's a refrigerant fluid leak, and the appliance is in a small room, the build up of combustible gases is more likely. This can cause fire or explosion. As a guide, for every 8 g of coolant, you'll need at least 1 cubic metre of space in the room. The data plate inside the appliance tells you how much refrigerant your refrigerator contains.
- Keep ventilation openings, in the appliance enclosure or in the built-in structure, clear of obstruction.

The refrigerant (R600a) used in the refrigerator and the gases in the insulation material (cyclopentane) are both flammable. They also require special disposal procedures.

- Before you dispose of the appliance, make sure none of the pipes on the back are damaged. Refrigerant or gas leaks can cause fire or explosion.
- Do not damage the refrigerant circuit.

Unplug the refrigerator before cleaning and servicing.

- Failure to do this can cause electric shock.

If you smell burning or see smoke coming from the refrigerator, disconnect the power immediately and please consult authorized service centre.

LED RADIATION

DO NOT VIEW DIRECTLY WITH OPTICAL INSTRUMENTS

CLASS 1M LED PRODUCT



Indicates risk of injury or damage to property.



Do not put glass bottles or containers in the freezer.

- When the contents freeze, the glass may break.

Do not touch the inside walls of the freezer or items stored in the freezer with wet hands.

- Your skin can become frozen onto the interior wall, or items stored in the freezer.

Do not open or close the doors by taking hold of the door handles with both hands.

- This may cause personal injury.



If there's a power cut, avoid opening the refrigerator frequently or putting unchilled food in it.

- This can cause the temperature in the refrigerator to rise and spoil food stored inside.

If you're not going to use the refrigerator for a long time, unplug it from the mains.

Also, be careful of the gap between the fridge and freezer doors, especially if they are both open at the same time.

- This may cause personal injury.

When opening the refrigerator, be careful not to pinch your fingers at the "pinch point" areas.

- This can cause personal injury.

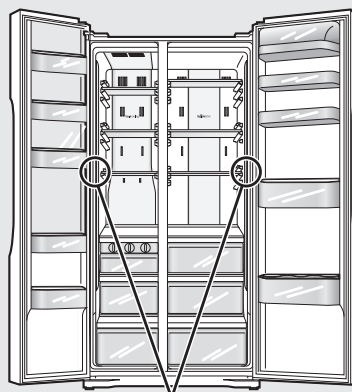

Potential pinch point

Installation

Choosing the right location

Install the refrigerator in a location which satisfies the following criteria:

- Where the refrigerator will not be exposed to direct sunlight
- Where the refrigerator will be at a distance from heating appliances, cooking appliances and other sources of heat
- A location which is well-ventilated and dry
- Where the floor is sturdy and level

Place a solid board underneath if the refrigerator is to be installed on top of a carpet or vinyl floor. The board will protect the floor from becoming deformed and discoloured.

Provide clearance to allow heat to dissipate

Residual heat is always being emitted from the refrigerator while it is operating.

Provide sufficient clearance around the refrigerator to allow this heat to dissipate so that its cooling ability is not impaired.

Dimensions (mm): W905 × D710 × H1850

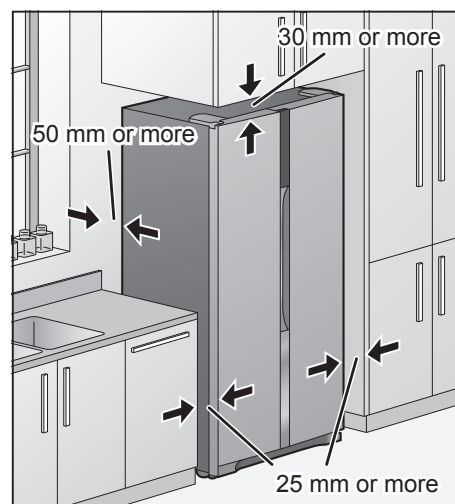

Installing the spacers

Install the spacers on the back panel of the refrigerator to ensure the minimum amount of space required to allow the heat generated by the refrigerator.

Attach to the back panel of the refrigerator after removing the double-sided tape's release liner.

Spacer (accessory)

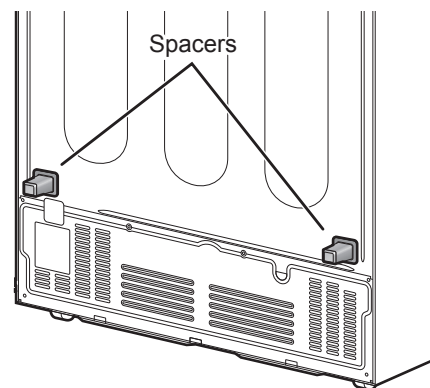

When the doors are completely open

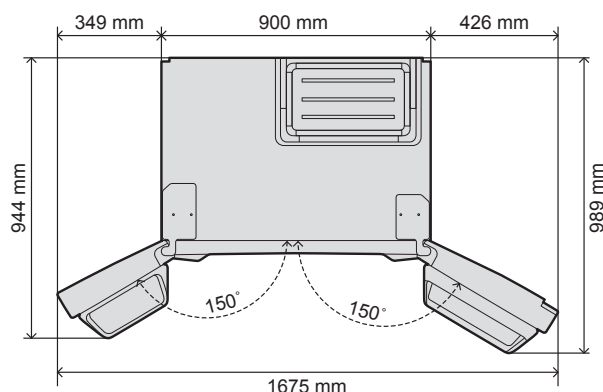

When the inside drawers have been taken out

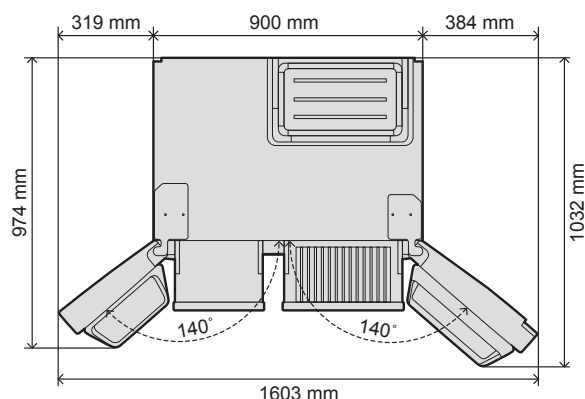

Removing the doors

If the refrigerator will not pass through a doorway or entrance, its doors can be removed.



CAUTION

Before removing the doors, be absolutely sure to check that the power of the refrigerator has been turned off.

When you want to remove the doors, please contact your dealer, an authorized service centre or access to our Web site (<http://panasonic.net>).

Panasonic or its Authorized agent cannot be held responsible if you remove the doors by yourself.

Dimensions (mm): W900 × D610 × H1845 (Without Door)

Removing the front grille

When the two doors are opened and the front grille is viewed from above, two screws – one on the left and the other on the right – will be seen.

Turn these screws counterclockwise, and remove them.

There is a connecting area slightly to the right of the centre of the front grille on its bottom. Take hold of this area, and pull the grille toward you to remove it.

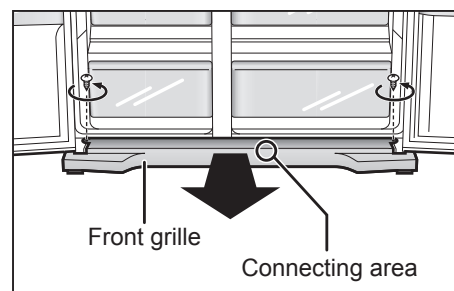

Removing the freezer/fridge door

When removing the door

- Ensure the door is in the closed position.
- Handle the removed door carefully to keep it safe from damage and impact.

(Please refer to the illustrations below.)

① Remove the top hinge cover.

Turn the hinge cover screw counterclockwise, and remove it.

② Disconnect the connecting cable. (only the fridge door)

While pressing on the knob, pull out the cable in the direction shown by the arrow.

③ Remove the top hinge.

Turn the hinge screws and the grounding screw counterclockwise, and remove them.

- When removing the top hinge, take care to support the door so that it will not topple forward.

④ Remove the door.

Lift the door straight up from the bottom hinge, and remove it.

(Top hinge of freezer)

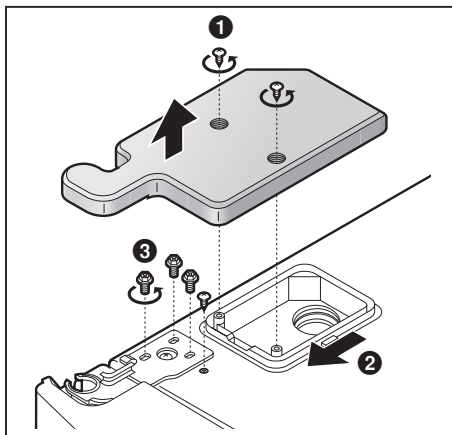

(Top hinge of fridge)

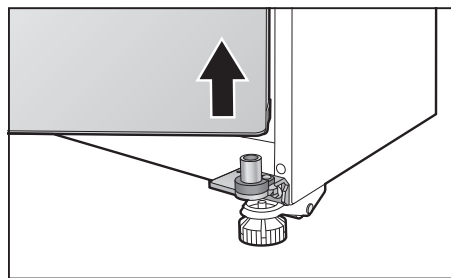
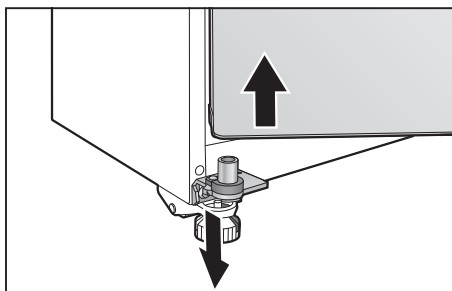
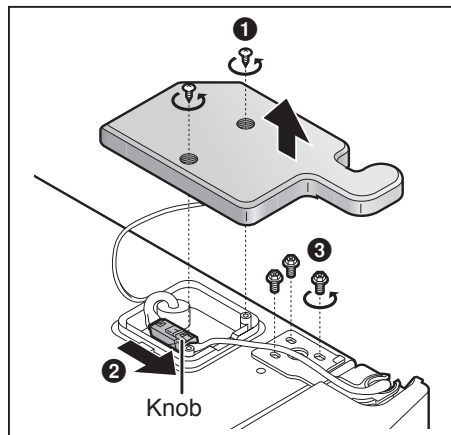

Attaching the doors and front grille

① Follow the steps for removing the doors and grille in their reverse order.

② Tighten up fixing screws after checking that the door is parallel to the body and cold air does not leak from around the gasket.

③ Tighten up screws to fix hinges using both the screwdriver (Phillips head) and hex wrench.

Installing the refrigerator

The refrigerator comes on four casters to enable it to be moved easily. Carefully read through the section “Choosing the right location”, and install the refrigerator in the best location. Once the installation location has been decided upon, secure the refrigerator, and adjust it so that it is level.

Removing the front grille

When the two doors are opened and the front grille is viewed from above, two screws – one on the left and the other on the right – will be seen.

Turn these screws counterclockwise, and remove them.

There is a connecting area slightly to the right of the centre of the front grille at the bottom. Take hold of this area, and pull the grille toward you to remove it.

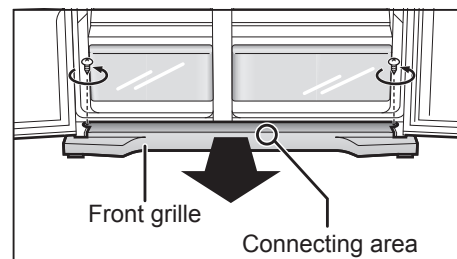

Securing the refrigerator

Insert a flat screwdriver into a slot on the adjustable legs at the left and right, turn them in the direction shown by the arrows to lower the legs to the floor level, and then secure the legs firmly.

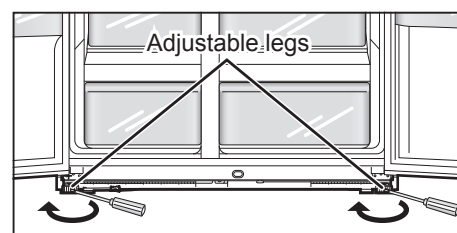

Levelling the refrigerator

Turn the adjustable legs so that the refrigerator is installed flush with the floor.

If the left and right doors are not flush with each other, turn one of the adjustable legs, and bring the doors into alignment.

If the left door is lower than the right door

Insert a flat screwdriver into a slot on the adjustable leg on the left, turn it in the direction shown by the arrow, and adjust.

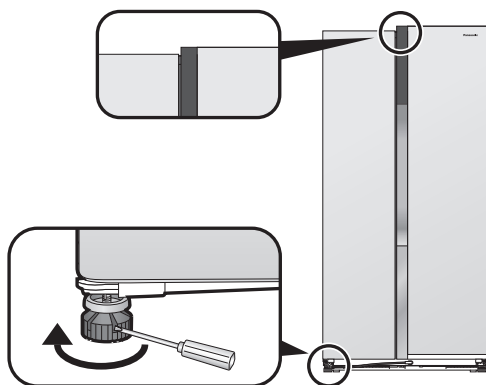

If the right door is lower than the left door

Insert a flat screwdriver into a slot on the adjustable leg on the right, turn it in the direction shown by the arrow, and adjust.

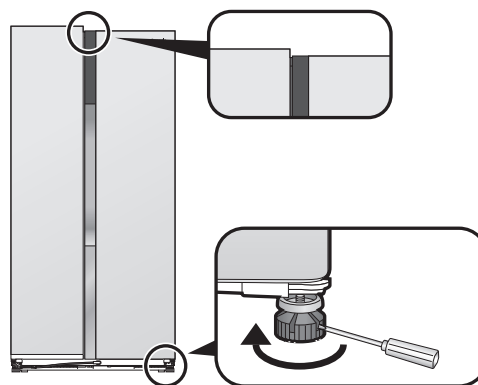

Attaching the front grille

Follow the steps for removing the grille in their reverse order.

Preparations

Maintenance

Remove all the packing materials and tapes.

Wipe the inside of the refrigerator using a soft cloth which has been dipped in lukewarm water and then wrung out.

Wash and completely dry the ice box before installing it. (Do not use a dish dryer, hair dryer or other appliance when drying.)

Connecting the power plug to the power outlet

When the power plug is connected to the power outlet, the temperature display starts flashing as shown in the figure on the right, and cooling starts inside the refrigerator. The temperatures displayed at this time are not the actual temperatures.

When the temperature of the fridge reaches 8 °C, the freezer reaches -12 °C, and the temperature display stops flashing and lights, and it shows the actual temperature. It takes about half a day to reach the set temperatures (when the room temperature is around 32 °C, there is no food inside the refrigerator, and the doors are closed). Place the food inside the refrigerator only after it was confirmed that the refrigerator compartment had been cooled.

Notes:

- Cooling may take longer in the summer months or at other times when the room temperature is higher.
- The temperature display flashes to warn that the temperature has risen.
- If you need to unplug the refrigerator, wait at least 10 minutes before you plug it back in again. You might damage the compressor.

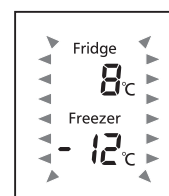

Parts and their functions

Interior and foods stored

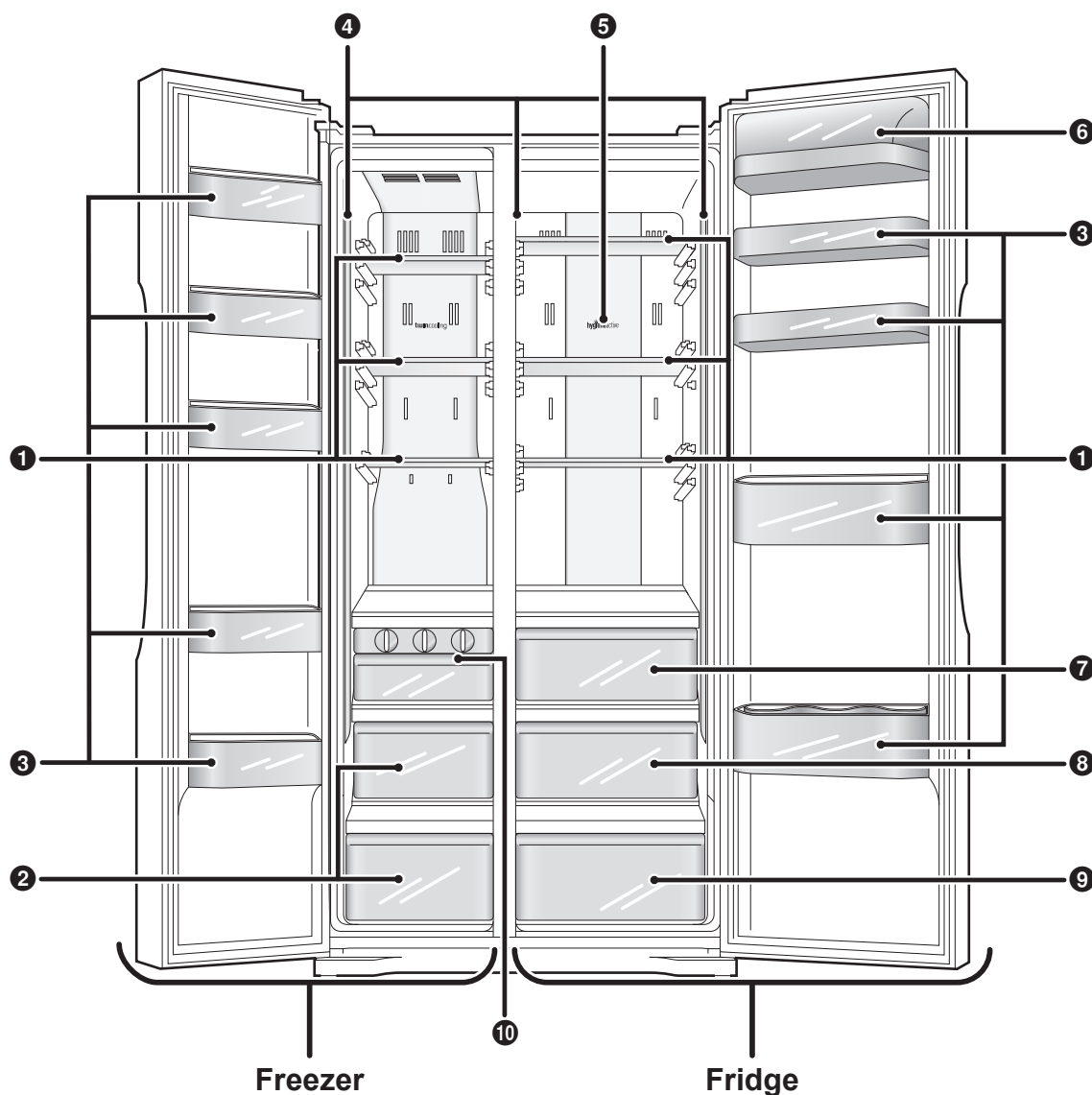

❶ Glass shelves

The positions of these shelves (except for the third shelf from the top in the freezer) can be adjusted.

❷ Drawers

❸ Door shelves

Only the second shelf from the bottom in the fridge can be adjusted.

Egg tray, bottle stopper provided (one each).

❹ Front tower LED light

❺ Hygiene active LED

Antibacterial/deodorizing filter and LED.





❻ Sealed case door shelf

❼ 0 °C Zone

❽ 2 °C Zone

❾ 5 °C Zone

❿ Ice tray & Ice box

Freezer -17 °C to -25 °C	Frozen foods, meats, fish, ice cream, etc.		
	Butter, dairy products, eggs, drinks, seasonings, cooked foods, etc.		
	0 °C Zone	Meats, fish, ham, sausages, etc.	
	2 °C Zone	Vegetables, fruits, etc. stored at low temperatures	
	5 °C Zone	Vegetables, fruits, etc.	
Fridge 1 °C to 7 °C			

Notes:

- The 0 °C Zone, 2 °C Zone and 5 °C Zone temperatures change depending on the temperature set for the fridge.
- A much larger space can be made available for use inside the freezer by removing the ice tray & ice box and upper drawer in the freezer.

For saving energy

1. Install the refrigerator in a dry, cool and well-ventilated location. The colder the ambient temperature, the better the efficiency. (Please refer to Page 6 for dimensions and clearance)
2. The combination of drawers and shelves that result in the largest in volume and the most efficient use of energy for the refrigerator.
 - Remove the ice tray & ice box and upper drawer in the freezer.
 - All shelves are the same position when you purchased.
3. Do not over fill the refrigerator to allow the air to circulate.
4. Open the doors only when necessary and as briefly as possible.
5. Occasionally clean the ventilation openings at the bottom of the refrigerator with a vacuum cleaner, etc. (Take care not to damage the refrigerant pipe inside the cover)
6. When setting to "Super Freeze Mode", power consumption will be increased.

Control panel

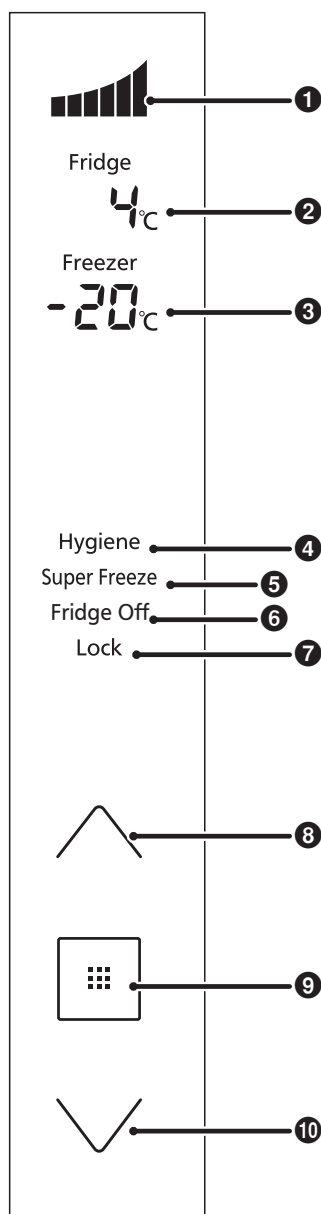

Display area

① Cooling power level

Cooling power by the refrigerator is indicated here.



Lowest power level
(when the compressor is shut down or running at lowest speed)



Low power level
(when the compressor is running at low speed)



Medium power level
(when the compressor is running at medium speed)

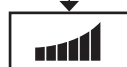

High power level
(when the compressor is running at high speed)

② Fridge temperature

③ Freezer temperature

④ Hygiene Active Mode

⑤ Super Freeze Mode

⑥ Fridge Off Mode

⑦ Child Lock

Control area

⑧ Up button

⑨ Set button

⑩ Down button

Notes:

- Normally the panel displays are off. Displays appear when the buttons are operated, or the doors are opened.
- The displayed temperature may differ from the actual temperature.
- The buttons are operated by pushing them.
- This refrigerator uses a microprocessor to control the temperature.
The temperature inside the refrigerator varies depending on such factors as changes in the room temperature, the speed at which the compressor is operating, how frequently the doors are opened and closed, and how much food is stored inside and how it is stored.

Setting the temperature

The temperatures of the fridge and freezer can be changed.
At the time of purchase, the temperatures are set as shown below.
Fridge: 4 °C Freezer: -20 °C

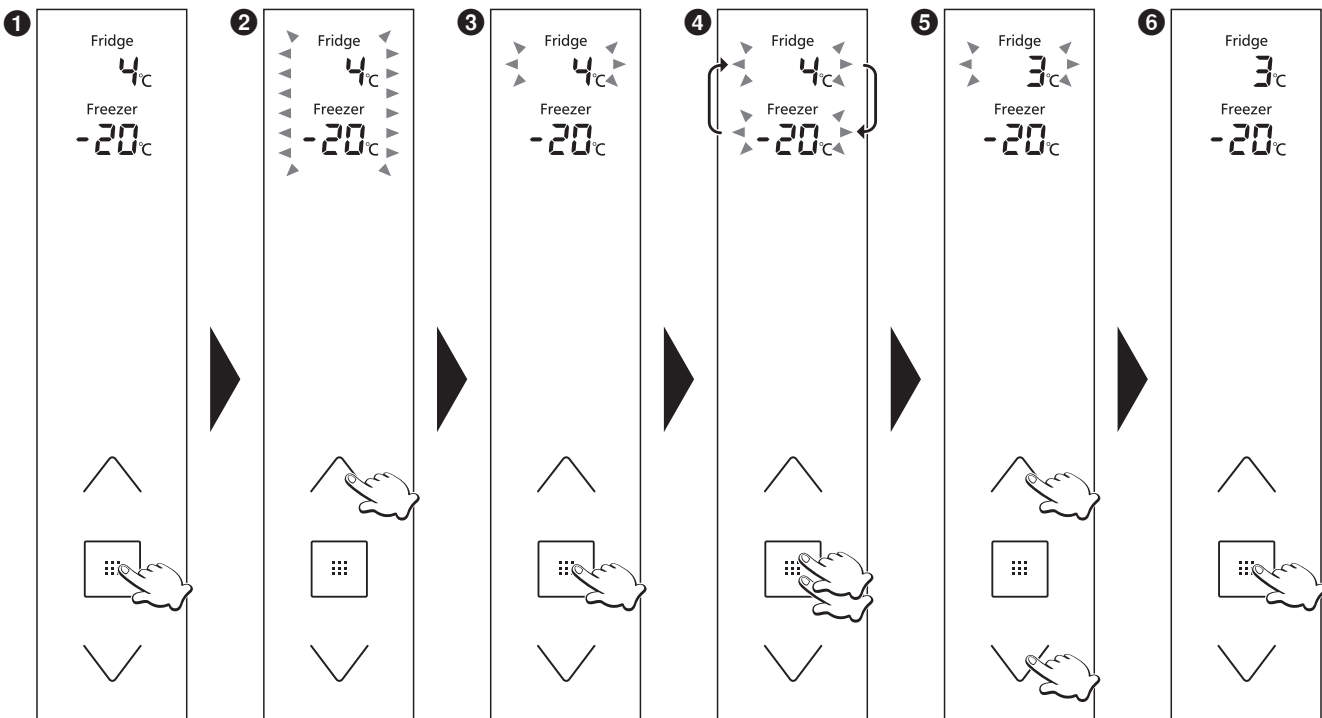

- 1 The control panel lights up, the temperature inside the refrigerator is displayed.
- 2 The temperature display start flashing, indicating that the temperatures can be set.
- 3 The temperature set for the fridge starts flashing.
- 4 Each time the button is pressed, the flashing display changes by one step in the sequence of fridge and freezer.
- 5 Adjust the temperature.
 - Press to raise the temperature and to lower it.
- 6 The display stops flashing and lights up, indicating that the temperatures are now set.
 - Approximately 30 seconds later, the control panel goes off.

Note:

- The display in 1 is restored if no operations are performed for 5 or so seconds during the setting process.

Fridge

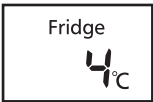

Set the temperature for the inside of the fridge.
Any temperature within the range from 1 °C to 7 °C can be set.

Notes:

- When the temperature is set at 1 °C for a prolonged period, some food may freeze.
- In the Fridge Off Mode, the temperature is not displayed, and the temperature cannot be set.

Freezer



Set the temperature for the inside of the freezer.
Any temperature within the range from -17 °C to -25 °C can be set.

Using the handy functions

This refrigerator comes with a number of useful functions for specific applications.

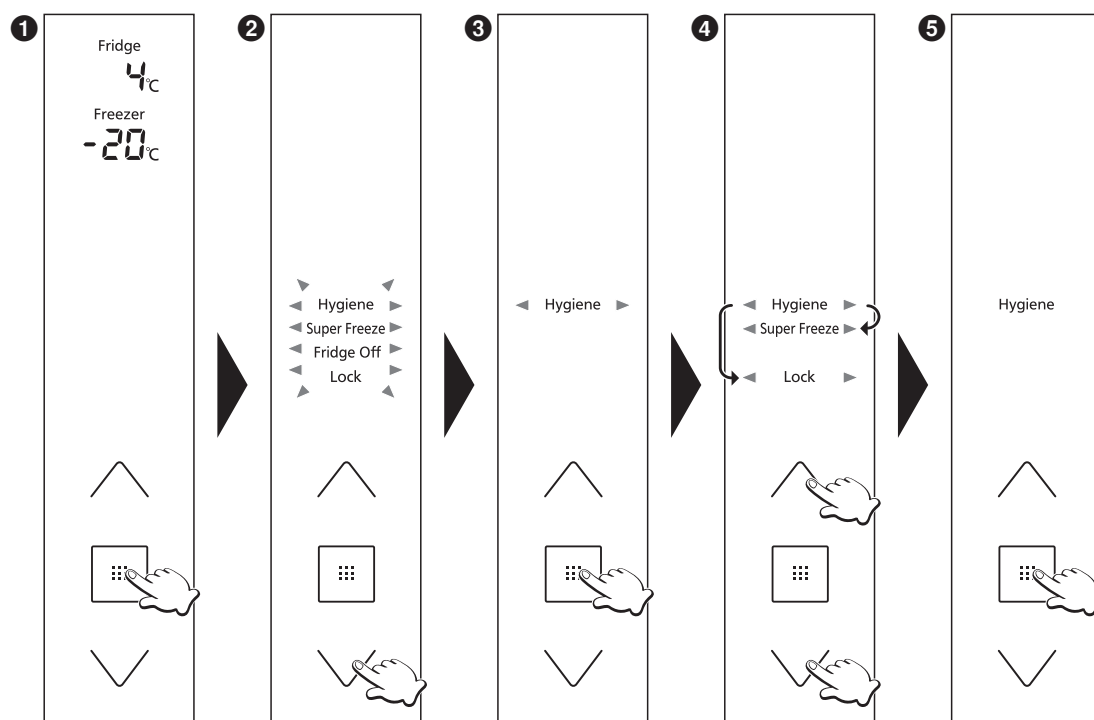

- ❶ The control panel lights up.
 - ❷ The function display start flashing, indicating that the functions can be set.
 - ❸ “Hygiene” starts flashing.
 - ❹ Select the function to be used.
 - ❺ The display corresponding to the selected function stops flashing and lights up, indicating that the function is set.
Each time the button is pressed, the display switches from “on” to “off”.
On: The function is set.
Off: The function is released.
- Approximately 30 seconds later, the control panel goes off.

Notes:

- The display in ❶ is restored if no operations are performed for 5 or so seconds during the setting process.
- If the temperature display is flashing, wait about 5 seconds for the display to light up before proceeding with the operations above.

Super Freeze Mode

Super Freeze

In this mode, the freezer can be cooled rapidly, enabling the fresh foods, etc. which are placed there to be frozen.

The Super Freeze Mode is automatically released after about 50 hours.

Notes:

- When the Super Freeze Mode is set, the temperature inside the freezer may drop below the set temperature.
- The compressor operates at high speed.
- The effect on the stored food can be reduced if setting the Super Freeze Mode several hours before storing the food in the freezer compartment.
- The following items are recommended in order to exert the maximum freezing capacity.
 - ① Set the Super Freeze Mode 24 hours before storing the food.
 - ② Place the food on the second drawer from the top or on the glass shelf.
(A bigger freezing capacity can be exerted if placing the food directly on the glass shelf.)
- The maximum freezing capacity within 24 hours is written in the rating label.

Hygiene Active Mode

Hygiene

The hygiene active LED comes on, and food is protected from bacteria and odours.

Note:

- When food with strong odours are to be stored, wrap it in plastic food wrap or place it inside a tightly sealed container. Otherwise, odours may be left in the fridge even if the Hygiene Active Mode has been set.

Fridge Off Mode

Fridge Off

Set this mode when the fridge is not going to be used for a prolonged period such as during a long vacation or when only the freezer is to be used.

When this mode is set, the fridge temperature is not displayed.

Notes:

- Before using the Fridge Off Mode, empty out the fridge, and close its door.
- The freezer is cooled in the usual way.

Child Lock

Lock

The buttons on the control panel can be locked. When the Child Lock is set, "Lock" is displayed on the control panel.

To release this mode, hold down  on the control panel for at least 3 seconds.

How to make ice

1. Gently pull out the ice tray and fill the ice tray with water to the water level line. Then carefully replace the ice tray horizontally.
2. When the ice cubes are ready, turn the knob clockwise (turn to the end and release), the ice cubes will drop from the ice tray into the ice box.

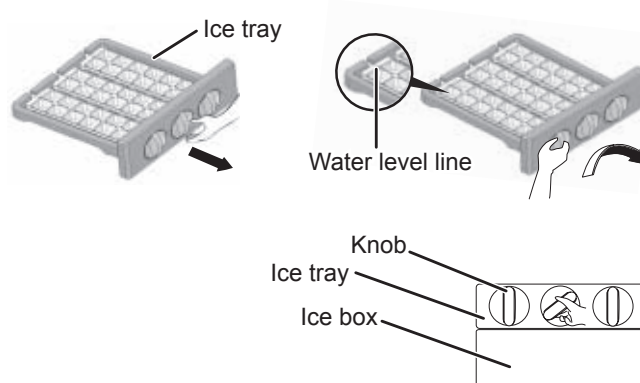

Notes:

- In order to make ice cubes quickly, set the freezer to the lowest temperature, or select the Super Freeze Mode. This will make the temperature of the freezer lower.
- Do not over-fill with water. It may become difficult to remove the ice cubes from ice tray and any trickle of water into the ice box will make the ice cubes freeze together.
- If the knob is turned before the ice cubes are ready, any remaining water will trickle into the ice box and cause the ice cubes to freeze together.

Concerning the user alert functions

The following user alert functions are activated when a door has been left ajar for a prolonged period of time or when the temperature inside the refrigerator has risen.

		Temperature display	Alarm	Front tower LED light
Door ajar	Continuous for 1 minute	Blinks	Sounds once	Blinks once
	Continuous for 3 minutes	Blinks	Sounds twice	Blinks twice
	Continuous for 5 minutes	Blinks*	Sounds continuously	Blinks continuously
Temperature rise inside the refrigerator	Freezer: -12 °C or more	Blinks*	- (Silent)	Normal operation
	Fridge: 8 °C or more	Blinks*	- (Silent)	Normal operation

*Blinks for 30 seconds every 30 minutes.

Removing and re-installing

Glass shelves

Raise the back part of the shelf slightly, and pull out the shelf.

To re-install the shelf, align it with the left and right guides, and push it into place.

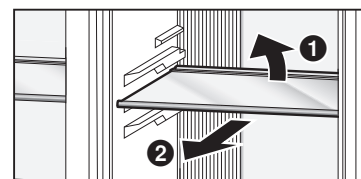

Drawers

Pull the drawer out all the way, and while raising the back part of the drawer slightly, and pull out the drawer.

To re-install the drawer, align it with the left and right guides, and push it into place.

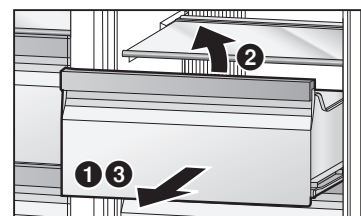

Door shelves and sealed case door shelf

Push the shelf up from below, and remove it.

To re-install the shelf, align the left and right protrusions, and insert the shelf firmly down until it will go no further.

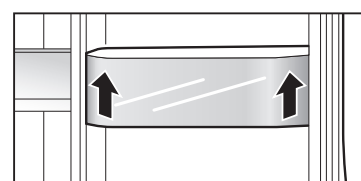

Cleaning and maintenance

Conduct periodic cleaning and maintenance to ensure that the refrigerator will be kept clean and that it will continue to operate for a long time to come.



WARNING

Before cleaning or conducting maintenance, be absolutely sure to disconnect the power plug from the power outlet. Do not connect or disconnect the power plug with wet hands. Doing so may result in an electric shock or injury.



CAUTION

Do not use the following items for cleaning:

- Alkaline cleaning agents (these may dissolve the plastic parts)
- Abrasive cleaners, soap powders, very hot or boiling water, brushes, acids, benzene, paint thinners, alcohol, etc. (these may mar the surfaces, paint and plastic parts)

Cleaning

Wipe off easily removable dirt using a cloth dipped in lukewarm water.

Wipe off stubborn dirt using a cloth dipped in some diluted neutral detergent used in the kitchen.

Then take up the remaining detergent using a cloth dipped in lukewarm water.

To complete the cleaning, be absolutely sure to wipe the surfaces dry to take up the remaining moisture.

Do not use cleaning agents (containing abrasive cleaners, or chemical mixture), and wipe off food stains, seasoning or dirt on the door as soon as possible.

Interior, drawers, glass shelves and door shelves

Be absolutely sure to wipe off edible oils, butter and other types of fats and oils on the plastic parts.

Otherwise, the plastic parts may be damaged. The drawers, glass shelves and door shelves can be removed.

If they are very dirty or smelly, remove and wash them.

Door opening seal

A dirty or damaged seal will allow the cold air inside to escape.

As soon as the seal becomes dirty, wipe off the dirt immediately.

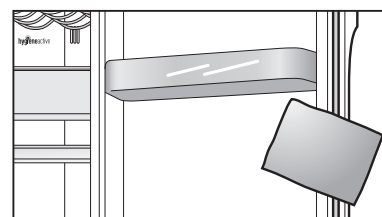

Exterior of refrigerator

If the exterior becomes dirty, wipe off the dirt. Also, allowing dust to accumulate on the power plug can cause a fire. At periodic intervals, remove the dust using a dry cloth, etc.

Control panel

Wipe the panel using a soft cloth which has been dipped in lukewarm water and then wrung out.

The control panel is made from delicate materials.

As such, take care not to damage its surface.

Note:

- Do not wash the drawers, glass shelves, door shelves, or other parts in a dishwasher. Doing so will cause the gilt on the parts or their plating to peel off or the parts to be damaged.

Checks after cleaning and maintenance

Is the supply cord damaged?

Has the power plug become hot?

Is the power plug firmly connected to the power outlet?

If the supply cord is damaged, remove the power plug from the socket and contact your dealer or an authorized service centre.

If LED or LED cover is damaged or if anything appears questionable, contact your dealer or an authorized service centre. Do not attempt to repair, replace or disassemble any damaged parts, etc. yourself.

When the refrigerator is not going to be used for a prolonged period

At times like this, disconnect the power plug. Leave the refrigerator doors ajar for two or three days to dry out the interior and prevent odours and mold.

When moving or transporting the refrigerator

Before moving or transporting the refrigerator

Remove all the food and ice inside the refrigerator, and disconnect the power plug.

- ❶ **Remove the front grille.**
- ❷ **Raise the adjustable legs, and pull the refrigerator toward the front.**
- ❸ **Drain off the water from the drain outlet at the bottom of the rear panel.**
Place a container under the drain outlet, tilt the refrigerator toward the rear, and drain off the water from the drain outlet.
- ❹ **Re-install the front grille.**
Follow the steps for removing the front grille in reverse.

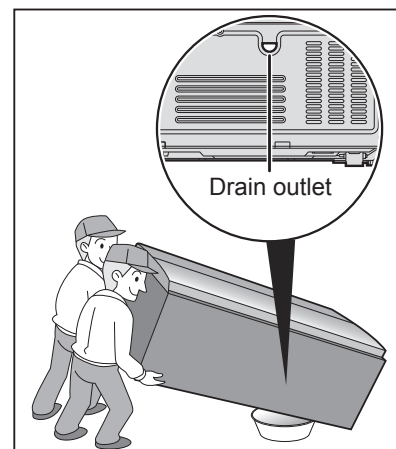

Moving or transporting the refrigerator

The refrigerator must be transported by at least four persons.

- Each person takes hold of the refrigerator at one of its four corners.
- Do not take hold of the doors.
- Tape the doors completely shut so that they will not open.

Note:

- Bear in mind that water remaining inside the refrigerator may spill out.

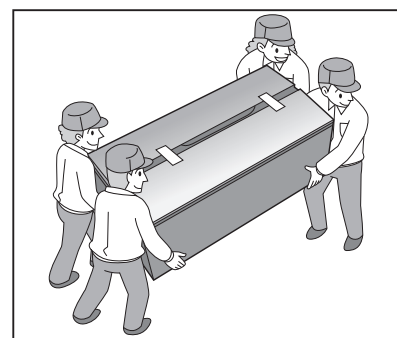

Troubleshooting

If you feel that the refrigerator is not working properly, check out the following points first.
If the trouble persists, disconnect the power plug and contact your dealer or an authorized service centre.

General

You hear unusual sounds from the refrigerator.	<ul style="list-style-type: none"> • Has the refrigerator been installed on a sturdy and level floor? • Have sufficient clearances been provided around the refrigerator? • Is anything vibrating on the top of the refrigerator? • It's normal to hear some noises when the refrigerator starts or stops operation.
You hear a sound after the compressor has shut down.	<ul style="list-style-type: none"> • This is normal, and is often caused by refrigerant flowing back to the compressor.
You hear a sound after you have opened or closed the door.	<ul style="list-style-type: none"> • This is normal, and is due to the difference in air pressure between the inside and outside of the refrigerator.
You hear the sound of air or water flowing after you have opened the door.	<ul style="list-style-type: none"> • This is caused by refrigerant flowing the internal pipework.
You hear a clicking sound each time the refrigerator's power is turned on.	<ul style="list-style-type: none"> • This is the sound made by the activation of the three-way valve, and is quite normal.
You hear a continuous whining sound.	<ul style="list-style-type: none"> • This sound is heard while the fan for circulating the cold air is operating. • Has the refrigerator been set to the Super Freeze Mode? In the Super Freeze Mode, the fan for circulating the cold air runs at high speed so it makes a loud noise. • Has the food been packed too tightly together or is the room temperature high? In cases like these, the fan for circulating the cold air runs at high speed so it makes a loud noise.
The compressor is quite loud.	<ul style="list-style-type: none"> • Has the refrigerator been set to the Super Freeze Mode? In the Super Freeze Mode, the compressor runs at high speed so it makes a loud noise. • Has the food been packed too tightly together or is the room temperature high? In cases like these, the compressor runs at high speed so it's normal for the compressor to be louder.
The compressor has been running for a long time.	<ul style="list-style-type: none"> • When the power plug has been connected for the first time, the compressor runs longer than usual in order to cool down the inside of the refrigerator until the set temperatures are reached. • Has the refrigerator been set to the Super Freeze Mode? • Have the doors been opened and closed frequently? Are the doors completely shut? • Have the food items been packed too tightly together or is the room temperature high? • When many food items are placed at a time, the compressor will need to run for a longer.
Condensation forms on the outside of the refrigerator.	<ul style="list-style-type: none"> • Condensation may form when the humidity in the room is high and is normal. Wipe it off using a dry cloth.
The outside of the refrigerator feels hot to the touch.	<ul style="list-style-type: none"> • Some heat is normal as the refrigerator incorporates a heat-dissipating pipe to prevent condensation.
The controls on the control panel cannot be operated.	<ul style="list-style-type: none"> • Is the power to the refrigerator on? • Has the refrigerator been set to the Child Lock?

The LED light does not come on.	<ul style="list-style-type: none"> • Has the refrigerator been set to the Fridge Off Mode? In the Fridge Off Mode, the front tower LED light of the fridge does not come on. • Is the power to the refrigerator on?
The alarm sounds, and the temperature display of the control panel and front tower LED light flashes.	<ul style="list-style-type: none"> • One or both of the refrigerator's doors have been left ajar. Close the doors.

Fridge and freezer

The fridge is not chilling (and the freezer is not freezing).	<ul style="list-style-type: none"> • Is the power to the refrigerator on?
The fridge is not chilling (and the freezer is not freezing) satisfactorily.	<ul style="list-style-type: none"> • Is the set temperature too high? • Is the refrigerator exposed to direct sunlight or positioned near a heating appliance? • Have sufficient clearances been provided around the refrigerator? • Have the food items been packed too tightly together or is the room temperature high? • Have the doors been opened and closed frequently? Are the doors completely shut? • Has the refrigerator been set to the Fridge Off Mode? • When warm food is put inside the refrigerator, the temperature will rise temporarily. • During the cold season or when the room temperature is low, it may feel as if the refrigerator is not chilling.
There is a difference between the set temperature and actual temperature.	<ul style="list-style-type: none"> • Has the refrigerator been set to the Super Freeze Mode? • When warm food is put inside the refrigerator, the temperature will rise temporarily.
Food in the fridge freezes.	<ul style="list-style-type: none"> • Is the set temperature for the fridge too low? • Has the food been placed at the back of the fridge? The area near the back wall is where the temperatures are coldest so avoid placing food which may freeze easily here.
Condensation forms in the fridge and drawers.	<ul style="list-style-type: none"> • The fridge maintains a high humidity to keep vegetables and other food items fresh. Condensation may form when the door has been opened and closed frequently or when it has not been shut completely. Wipe off the condensation using a dry cloth.
It is hard to open the freezer door.	<ul style="list-style-type: none"> • The difference in air pressure between the inside and outside of the freezer may sometimes make it hard to open the freezer door. Wait a few moments, and then try opening the door.
It smells inside the refrigerator.	<ul style="list-style-type: none"> • Were any food items with strong odours sealed before they were placed in the fridge? Place the items inside a sealed container and store them or store them on the sealed case door shelf. • Odours may stick to the surfaces inside the refrigerator. Wipe the surfaces using a soft cloth which has been dipped in lukewarm water.

Specifications

MODEL	NR-BS63VSX
TOTAL GROSS VOLUME	630 L
TOTAL STORAGE VOLUME	561 L
STORAGE FRIDGE VOLUME	339 L
STORAGE FREEZER VOLUME	222 L
OUTSIDE DIMENSIONS WIDTH x DEPTH x HEIGHT	905 mm x 710 mm x 1850 mm
WEIGHT	116 kg
RATED VOLTAGE	230 V
RATED FREQUENCY	50 Hz
REFRIGERANT	R600a
BLOWING AGENT	Cyclo-Pentane

*This refrigerator's volume is calculated based on ISO 15502.

Information on Disposal for Users of Waste Electrical & Electronic Equipment (private households)

[India Only]



For the purpose of recycling to facilitate effective utilization of resources, please return this product to a nearby authorized collection center, registered dismantler or recycler, or Panasonic service center when disposing of this product.

Please see the Panasonic website for further information on collection centers, etc.

<http://www.panasonic.co.in/wps/portal/home>

