

# Operating Instructions

Refrigerator  
(For household use)

Model No : NR-BY55BP  
NR-BY55BV

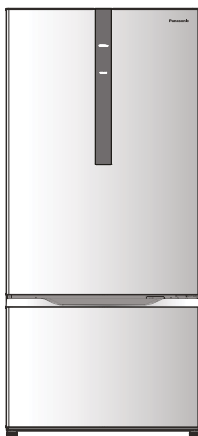

NR - BY55BP  
NR - BY55BV

## Contents

• Safety Precautions .....	2
• Installation .....	4
• Parts Identification .....	6
• Temperature control .....	7
• Temperature control (Fine adjustment mode) .....	7
• Quick freezing .....	8
• ECONAVI operation .....	8
• Refrigerator Compartment .....	9
• Freezer Compartment .....	9
• Food Stored .....	10
• Usage Tips .....	11
• Cleaning Tips .....	12
• To Clean .....	13
• Troubleshooting .....	15
• Specifications .....	16

### Thank you for purchasing a Panasonic Refrigerator.

- Before operating this unit, please read these instructions completely.  
**Before using this product, please pay particular attention to the "Safety Precautions" section (Page 2 and 3) for safe use.**
- Please make sure the date and name of store of purchase are stamped in warranty card and keep it with this operating instructions.

# Safety Precautions

Please be sure to follow these instructions.



## WARNING

This expression presumes possibility of a death or serious injury.



## CAUTION

This expression presumes possibility of personal injury or property damage.



Do not



Make sure you do this



Do not take apart



R600a

iso-butane

Risk of fire / flammable materials



## WARNING



In order to prevent fires, electrical shocks, explosion, injuries, etc.

### For power plug and cord...



- Periodically wipe the power plug with a dry cloth. (Dust accumulated on the plug of a refrigerator that operates continuously leads to reduced insulation due to moisture and may cause fire.)
- Plug into a wall outlet of the rated voltage on its own with the rated current and insert plug fully.
- Connect to an exclusive wall outlet for the refrigerator only. Avoid connecting other appliances to the same wall outlet. Unroll entire length of the cord before plugging in.
- Unplug the unit when cleaning the refrigerator.
- If the supply cord is damaged, it must be replaced by the manufacturer, its service agent or similarly qualified persons in order to avoid a hazard.
- Do not sandwich the cord between the refrigerator and the wall, etc.
- Do not let the cord get damaged.
- Do not insert or disconnect the power plug into/from the wall socket with wet hands.



### On top of the refrigerator...



- Do not put anything on top of refrigerator. Otherwise, it may fall due to vibration of the machine.

### In case of emergency...



R600a  
iso-butane



- Maintenance work must only be carried out at workshop by well-trained maintenance worker.

- Do not store explosive substances such as aerosol cans with a flammable propellant and chemicals or scientific specimens in the appliance.
- Do not use electrical appliances such as a deodorizer in the refrigerator. Leaked refrigerant may catch fire from a spark of the electrical contacts and may cause an explosion.
- Do not** disassemble, repair or modify the refrigerator by yourself. If you want to repair the refrigerator, please consult your dealer or authorized service center.
- Do not** use mechanical devices or other means to accelerate the defrosting process, other than those recommended by the manufacturer.

### When recycling the product...



- Before taking the refrigerator to be recycled, please remove all the door gasket to prevent locking a child in it.
- The operating instructions should be handed over to any person who would use or handle the refrigerator whenever the refrigerator would be transferred to another location and delivered to a recycling plant.
- Cyclo-Pentane is used for insulation of this refrigerator and flammable gas is used for refrigerant. When disposing of this unit, please discard it by the proper method and do not dispose of the unit by burning.
- The warning labels mentioned above should be kept throughout the life of the refrigerator.



# WARNING

## When installing...



- Do not install the product in locations exposed to water.
- Provide a grounding connection or install a ground-fault interrupter when the product is installed in a humid or wet location. (Contact your distributor.)
- Do not block the ventilation port of the refrigerator or spaces around it. Leaked refrigerant may cause a fire and explosion.



- For safety it should be checked that the ground connection system in the house has been installed correctly.

## When using...



- Do not let any children hang or ride on the refrigerator door, the unit may turn over and cause an accident.
- Do not apply water on the body or interior. Electrical insulation could deteriorate and may cause shocks or fire.
- Do not damage the cooling circuit (piping on the back). The flammable refrigerant may catch fire and lead to an explosion.
- Do not touch the compressor or pipes because of high temperature. There is a risk of burn injury.
- Do not spray combustible chemicals near the refrigerator.



- If you detect a burning smell, disconnect the power plug.
- If you detect a gas leak from the cooling range, ventilate the kitchen.
- If you have damaged the cooling circuit (piping on the back), then ventilate the kitchen and contact your distributor.
- Refrigerator LED lamp. The refrigerator LED lamp is designed specially for this product, it does not function on individual replacing. If replacement is required, please contact your dealer or authorised service agent.



- This appliance is not intended for use by persons (including children) with reduced physical, sensory or mental capabilities, or lack of experience and knowledge, unless they have been given supervision or instruction concerning use of the appliance by a person responsible for their safety.
- Children should be supervised to ensure that they do not play with the appliance.



# CAUTION

## When storing food...



- Do not freeze glass bottles, (that there is a risk of injury. (If the liquid in a glass bottle is frozen and broken, you may be injured.)
- Do not touch frozen foods or containers (especially metallic) with wet hands.
- Do not place warm/hot foodstuffs in the refrigerator. Store warm food and drinks after they have cooled.
- Do not eat any smelling or colour-changed food. Rotten food may cause illness.
- Do not subject glass trays to high impact. (Otherwise those glass trays may break and you may be injured)



- Food containers must reach the bottom of the door shelves.
- The foods must not protrude from the shelf.



## When opening/closing the doors...



- Do not open the refrigerator doors when someone is in the vicinity of the refrigerator.
- Do not push drawers by holding them at the top.
- Do not open refrigerator frequently or leave it open for long time in order to prevent water dripping inside and wasting energy.
- Be careful not to place your feet under the bottom drawer.
- Mind the gap between the doors. They may nip your hand while closing the door.

## When cleaning...



- Do not slide hands on the metal rail.
- Do not clean the refrigerator with chemical substance or liquid. It will cause damage and have corrosion on the surface.
- Do not place your hands or feet beneath the bottom of the refrigerator.
- Be cautious of hot copper pipe inside pan water evap when removing it.



## When moving or transporting the refrigerator...



- Do not transport refrigerators in a horizontal position. Laying a refrigerator horizontally may damage the piping. If any damage is noticed, do not touch the refrigerator, avoid using fire and ventilate the room.



- Apply protective covering, etc. to floors with a fragile surface.
- Hold the carrying handles when transporting the refrigerator.



# Installation

Before using for product.



## Install the refrigerator in the following locations.

- Locate away from direct sunlight or heat
- Place in a well ventilated location to avoid rust
- Position on a level and even surface  
→ On carpet, mats or vinyl floors place a plate underneath the refrigerator
- Place the refrigerator away from other devices to prevent noise and incorrect image display on TV's and other devices
- Allow access to the power plug for easy cleaning to avoid dust accumulation.

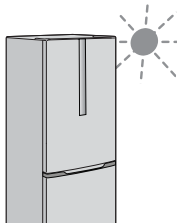

## Has a heat radiating space been provided around the refrigerator?

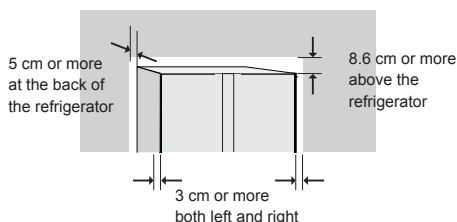

## For safety, the grounding connection should be done

(For a refrigerator with plug (2-pin plug) without any grounding wire)

The grounding connection will allow prevention of danger resulted from electricity leakage. The grounding connection can be performed in 2 ways as follows:

1. In the case that the grounding receptacle has been prepared for the socket (plug socket), connect the grounding wire to the screw used for grounding connection at the bottom rear of the refrigerator (regarding the screw used for grounding connection, please notice the  $\oplus$  symbol) as shown in the illustration ①.
2. In the case that the socket (plug socket) has not been provided with any grounding receptacle, connect the grounding wire to the screw at the bottom of the refrigerator, (as regard to the screw used for grounding connection, please notice the  $\oplus$  symbol). And then connect the other end to the grounding rod as shown in the illustration ②.

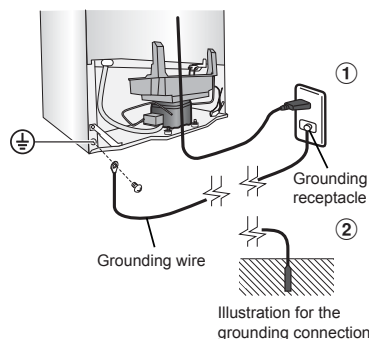

## Prohibited spots for grounding connection

- Water supply pipes and gas pipes (dangers from electric shock or explosion).
- The grounding wires of telephone cords and lightning rods (dangers from lightning).

## Requests and notices



### Fix the refrigerator.

Turn the adjuster bolts (right and left) until they reach the floor to stabilize the refrigerator.

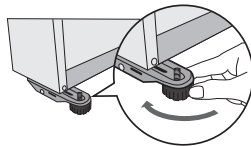

### Do not peel the seal on the back.

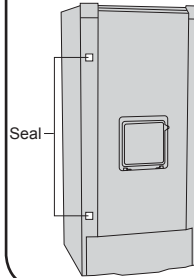

Otherwise, the cooling performance may deteriorate. If you have peeled it, then cut a cloth packing tape into a square and paste it onto the refrigerator.

### Do not open/close the doors during the interior cooling process.

Do not open/close the doors until the interior has cooled down sufficiently. (Warm air flowing into the interior will block the cooling function.)



### Please wait until the interior has cooled down.

- It may take approximately 4 hours to cool down the interior.
- It may take 24 hours or more to cool down the interior and achieve equilibrium in the summer, etc.

### ☐ Have any measures taken against tipping due to earthquakes?

In order to prevent the refrigerator from tipping, permanently fix it by using belts, etc.

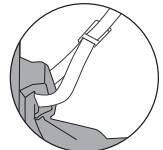

# Parts Identification

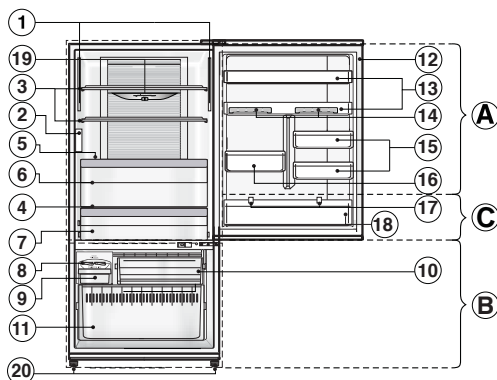

NR-BY55BP, NR-BY55BV

## A REFRIGERATOR COMPARTMENT

## B FREEZER COMPARTMENT

## C Chilled case

- ① LED lamp
- ② Control Panel
- ③ Tempered glass tray
- ④ Small tempered glass tray
- ⑤ Tempered glass tray crisper
- ⑥ Vegetable case
- ⑦ Chilled case
- ⑧ Ice twister
- ⑨ Ice box
- ⑩ Freezing Case
- ⑪ Bottom freezer case
- ⑫ Door gasket
- ⑬ Egg shelf
- ⑭ Egg tray
- ⑮ Free rack
- ⑯ Shelf PC
- ⑰ Slide stopper
- ⑱ Bottle shelf
- ⑲ Refrigerator temperature control
- ⑳ Adjustable bolt
- ㉑ Pan water evap
- ㉒ Compressor

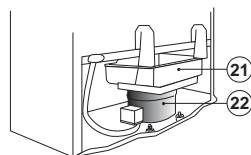

Product view from behind

## ② Control Panel

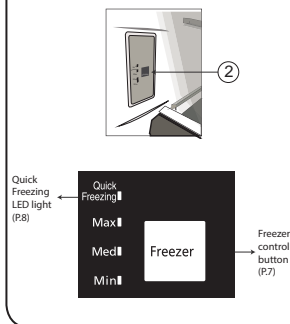

## SPECIAL FEATURE

### 1) NON-FLON

This unit uses totally NON-FLON MATERIALS both for refrigerant (iso-butane (R600a)) and for insulation (Cyclo-Pentane). These materials do not damage the earth's ozone layer and have almost no effect on global warming.

### 2) INVERTER

In accordance with temperature change inside the compartment, the motor will run at different speeds. When the temperature inside the refrigerator is stable, the motor will run at a lower speed to save energy and lower noise. When powerful cooling is required, the motor will run at a higher speed.

# Temperature control

- Slide the lever to operate the "REFRIGERATOR CONTROL" when changing the temperature of refrigerator compartment.

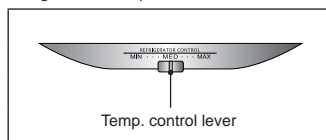

TEMP . CONTROL REFRIGERTOR COMPARTMANT	
"MIN"	Higher than "MED" by approximately 2°C ~ 3°C
"MED"	Approximately 1°C ~ 6°C
"MAX"	Lower than "MED" by approximately 2°C ~ 3°C

## Freezer Room temperature control

"Max" Lower than Med by approximately 2°C ~ 3°C	
"Med" Approx by approximately -23°C ~ -17°C	
"Min" Higher than Med by approximately 2°C ~ 3°C	

Temperature in Chilled case is automatically set at approximately -3°C ~ 3°C

### Remark

While operating the refrigerator for the first time, after connecting the plug, adjust the temperature to "Med" position for each control and leave it for 24 hours for the effective cooling operation. After that, adjust the temperature as you prefer. If you want to save the energy, do not adjust the temperature lower than the actual operating condition.

## Temperature control (Fine adjustment mode)

This refrigerator is specially designed for appropriate use, which can adjust the temperature level to 9 detailed levels with the following.

### How to operate the "9 levels" mode

#### For the Freezer room

- Set LED display to "Min" with the "Freezer" button.
- Press and hold the "Freezer" button (for more than 10 seconds) until the LED display return to show at "Min" position.
- Set "9 levels" mode following below table mentioned by pressing the "Freezer" button.

### LED Display table

Cooling Level	<div>Minimum<div><div></div><div></div><div></div><div></div><div></div><div></div><div></div><div></div><div></div><div></div></div>Maximum</div>									
Step	1	2	3	4	5	6	7	8	9	
LED DISPLAY	<div>Max<div></div></div> <div>Med<div></div></div> <div>Min<div></div></div>	<div>Max<div></div></div> <div>Med<div></div></div> <div>Min<div></div></div>	<div>Max<div></div></div> <div>Med<div></div></div> <div>Min<div></div></div>	<div>Max<div></div></div> <div>Med<div></div></div> <div>Min<div></div></div>	<div>Max<div></div></div> <div>Med<div></div></div> <div>Min<div></div></div>	<div>Max<div></div></div> <div>Med<div></div></div> <div>Min<div></div></div>	<div>Max<div></div></div> <div>Med<div></div></div> <div>Min<div></div></div>	<div>Max<div></div></div> <div>Med<div></div></div> <div>Min<div></div></div>	<div>Max<div></div></div> <div>Med<div></div></div> <div>Min<div></div></div>	<div>Max<div></div></div> <div>Med<div></div></div> <div>Min<div></div></div>
Lighting			Blinking			Not lighting				

■ Lighting

⏏ Blinking

■ Not lighting

### To reset the setting "9 levels" mode



Repeat step 1 and 2, then the refrigerator will return to normal operation mode.



### Remark:

Temperature control varies depends on the changing of environment and food storage quantity.

## Quick freezing

### How to operate the “Quick Freezing” mode

- Press the button “Freezer” until Blue light LED  turns on. “Quick Freezing” mode starts after 10 seconds.
- The system will stop operating automatically when it runs for 120 mins (as ambient temperature is below 25°C) or 150 mins (as ambient temperature is above 25°C) and return to normal mode (Blue light LED  turns off.)

- Remarks :**
- If you want to stop the operation immediately, press and hold the button “Freezer” until Blue light LED  turns off.
  - Blue light LED  flashing means that the defrosting system is now working “Quick Freezing” mode will start right after the defrosting operation is finished.
  - Freezer temp. control does not operate during “Quick Freezing” mode.

## ECONAVI operation

- This model also has ECONAVI mode, but it does not feature ECONAVI lamp and light intensity sensor.  
The ECONAVI detect opening and closing of door<sup>1</sup>
- This refrigerator will learn the lifestyle patterns of your family from opening and the time periods of infrequent use to perform ECONAVI operation.

### Remark :

- The refrigerator learns your lifestyle pattern from the previous 3 weeks, and uses what it has learned from the 4<sup>th</sup> week onwards.

## Setting for enabling ECONAVI operation

- ECONAVI operation is enabled automatically only when the temperature control of the freezer compartment are set to “Med”.  
(However, ECONAVI does not operate while quick freezing is operating.)
- It is not possible to forcefully start ECONAVI operation.

### Remark :

- <sup>1</sup> Effectiveness differs depending on the ambient temperature, number of times when doors are opened and closed, and state in which food is stored.



## Refrigerator Compartment

Only the height of the second "tray" from the top can be changed.

- (1) Lift up the rear of the tray and pull it forward. Once the protrusions of the tray are unhooked from rails, tilt and remove the tray by rotating it.

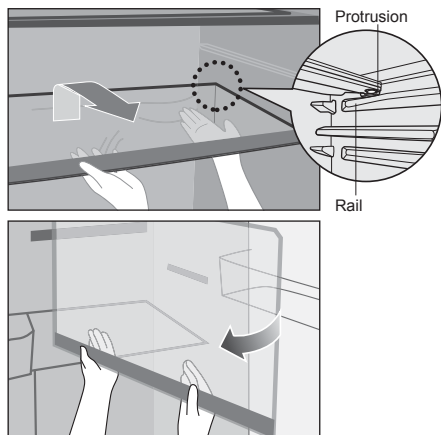

- (2) Insert the tray in the desired position by reversing the steps.

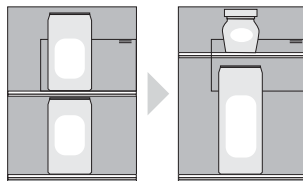

## Freezer Compartment

Food storage in the bottom freezer case

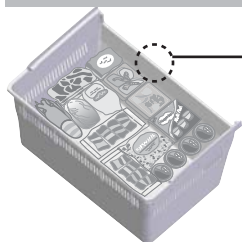

### "Maximum Storage"

If the stored food exceeds this line, The cooling performance may deteriorate or the compartment may become frosted.

### Three tips for freezing food and locking in the flavour...

1. Freeze thin and small items of food quickly!
2. Ensure food is fully sealed.
3. Do not refreeze



### To make ice

#### 1 Take out the ice twister

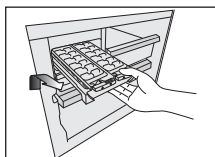

- Pull out the ice twister. (See page 14)

#### 2 Fill with water

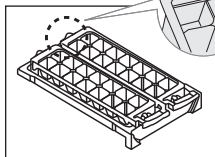

- Fill water up to the "WATER LEVEL" line.

#### 3 Install the ice twister

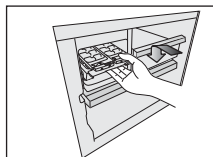

- Place tray back into the ice making compartment. (P.14)

#### 4 To move ice cubes

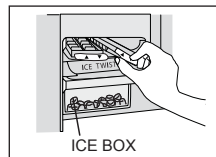

- Twist the ice twister clockwise. (The ice cubes will drop into the ice box.)

# Foods Stored

■ In order to preserve food quality for long time, please store it in the right place.



## When storing food...

- Foodstuff such as vegetable, fruits and fresh food should be wrapped or packed in box before freezing and refrigerating.
- If you put high moisture content in the refrigerator this should be sealed and wrapped to prevent dew and frost.
- Water and beverage bottles should be sealed to prevent odours.

## Where to store these different foodstuffs?

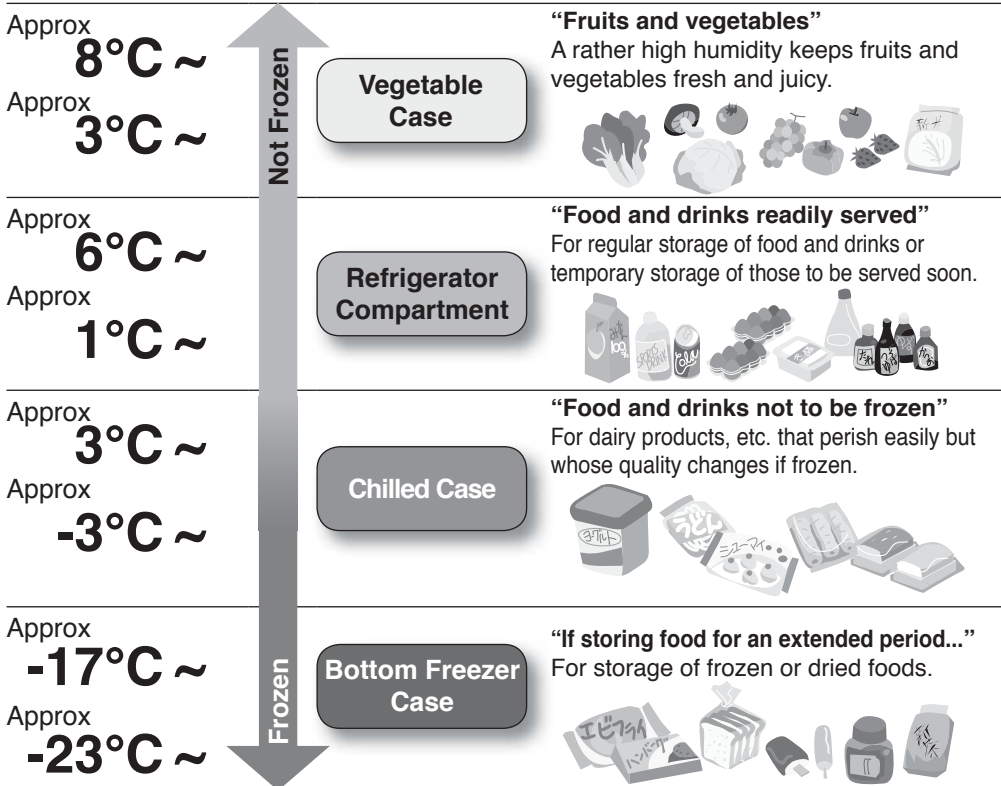
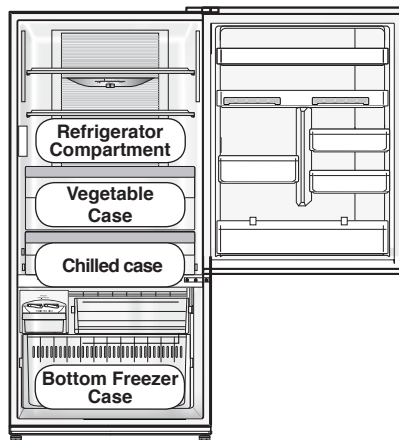

• When set to "MED", the temperature may vary slightly depending on the usage conditions.

# Usage Tips



Basics of energy saving  
**Save cool air!**

## Energy saving tips

### Do not stuff food into the compartments.

That may interfere with the cold air flow. Provide sufficient space between foods.



### Store warm food and drinks after they have cooled.

Otherwise, they will not only raise the interior temperature, but also affect the freshness of other foods.



### Do not block the cold air outlet with food items!

If the cool air does not spread into every corner of the refrigerator, then the interior will not be sufficiently cooled and more electricity will be consumed.



### Open/close the doors minimum times.

Prevent the cool air from escaping.

## Do not put food in the refrigerator when it is not necessary.

### ■ A cold dark place will suffice!



It is not necessary to store uncut onions, potatoes, etc. in the refrigerator (except during the summer).

### ■ Cool just before you eat!



If uncut tropical fruits are cooled down excessively, they may be discolored or their vitamin contents may decrease.

## Storage using tightly sealed containers is recommended!

To prevent the interior from being discoloured



- Cut citrus fruits  
(→ The plastic will be discoloured white.)

To prevent odours from spreading!



- Garlicky or other strong smelling vegetables  
(→ odours will spread to other nearby food.)



# Cleaning Tips

## 1 Clean the refrigerator immediately after it is stained!.

Wipe off stains on the interior surfaces quickly before they harden.

In particular, cooking oil may cause plastic to crack and citrus juice may cause the refrigerator to become discoloured. When stains cannot be removed easily, wipe them with a cloth lightly soaked in a neutral kitchen detergent. Then, wipe with a cloth lightly dipped in water.



## 2 Clean the detachable items occasionally...

Once a week for the ice twister. As a guide, remove the trays, door shelves, etc. and wash them by immersing them in lukewarm water every three months.



## 3 Clean the door gasket at least once a month.

Clean by wiping with a soft damp cloth. Petroleum gel has been applied to the door gasket on the hinge side of the unit, be careful not to wipe this off.

### Note

The "door gasket" is replaceable by an authorised service agent. If the door gasket comes off while cleaning, it can be pushed back into the groove.

Point where petroleum gel was applied.

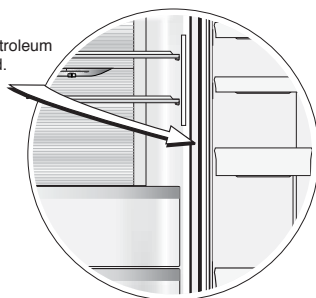

### Warning

Do not use the following items for cleaning. (Otherwise, the surface will be scratched.)



Kitchen detergents  
(They crack plastic!)

Alkaline or faintly Alkaline



Cleanser or soap powder



Benzine, thinner, alcohol,  
acid, petroleum



Scrubber



Hot Water

# To Clean

## ■ Removing and re-installing for cleaning.

Before cleaning or conducting maintenance, be absolutely sure to disconnect the power plug from the power outlet. Do not connect or disconnect the power plug with wet hands.

When the plug is disconnected, leave it for 10 minutes before plugging again. If not, the compressor may not work.

### Trays

#### Removing

1. Unhook the protrusion at the back by lifting it upward and pulling the tray outward until removing.

#### Attaching

2. Push the tray until it reached the end lock.

#### Note

- When removing the tray above the vegetable case, please pull out the vegetable case first and then follow to removing the tray as above.
- If the tray does not lock when attaching it, ensure that it is the correct tray.

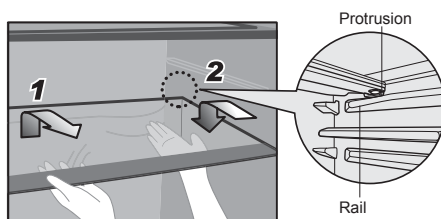

### Door shelf

#### Removing

1. Lift it upward, alternating between the right and left side.

#### Attaching

2. Place on both supports and then press in until it reaches the end of supports.

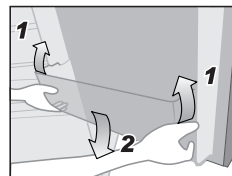

### Vegetable case / Chilled case

#### Removing

1. Pull the case unit forward until it reaches the end of the stopper.
2. Lift the front of the case unit slightly and remove completely.

#### Attaching

1. Insert the case unit into the supports.
2. Raise the case unit up slightly and push forward until the end is reached.

#### Note

- To maintain vitamins in fruits and vegetables, please ensure the drawer locks properly after use.

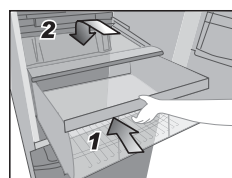
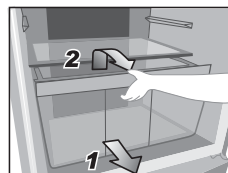

# To Clean

## Case (Freezer compartment)

1. Pull the freezer drawer out towards yourself.
2. Lift up the drawer slightly and pull towards yourself until it reaches the stoppers.
3. Lift both sides of the bottom freezer case and move upward to remove.

### Note

- The contact sections of the drawer rails have been coated with lubricant. Do not wipe it off.  
(The lubricant complies with the Food Sanitation Law.)

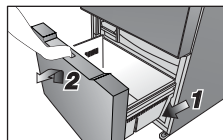

## ICE TWISTER (Quick Ice Making corner)

### Removing

1. Unhook the protrusion by lifting it upwards and pulling the ice tray and/or ice box forward until completely removed.

### Attaching

2. Push the ice tray and/or ice box until it reaches the end lock.

### Note

You can disassemble the ice tray and ice box to increase space in the freezer.



ICE TRAY



ICE BOX

## Evap pan (Backside of the refrigerator)

### Removing

1. Tilt up the evap pan a bit and then lift it upward until the evap pan hole unlocks from the hook evap pan.
2. Pull the evap pan until it touches with the evap pipe then carefully take it out under the evap pipe.

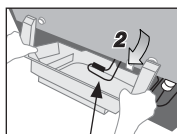
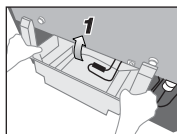

Evap pipe

### Warning

- Do not damage or deform the evap pipe.

### Attaching

1. Insert the evap pan under the evap pipe.
2. Insert the evap pan hole into the hook evap pan as well as press-fitting both sides.

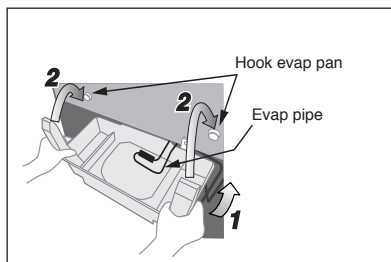

# Troubleshooting

## In these cases?

## Check here.

The refrigerator does not operate.

- Check that the plug and wall socket are in good condition.
- Check if there is any problem with the mains fuse or house wiring.
- Check by unplugging for 10 minutes and plugging back in.

The refrigerator is not cool enough.

- Check to be sure that the temperature control lever is at the proper position. (P.7)
- Check to ensure that the refrigerator is not overloaded with foodstuffs or that hot food have been placed in the refrigerator.
- Is the refrigerator exposed to direct sunlight or a heat source? (P.4)
- Is the refrigerator door completely closed?
- Is the refrigerator door opened frequently?

Condensation generated inside and outside the cabinet / surface of door.

- Condensation may appear on the surface of the cabinet when humidity is high or air circulation around the unit is poor.
- If there is condensation inside, check if the door is completely closed. Is the refrigerator frequently opened or left open for a long time? Have any hot foodstuffs been placed inside the refrigerator?

The refrigerator generates noise.

- Check if the refrigerator is located on a stable, level floor and is installed correctly. Use the adjustable bolt if required to level the refrigerator. (P.5)
- Check if there is any object in contact with the refrigerator.
- Cracking sound within caused by the parts adjusting temperature which is normal.
- After installation, the refrigerator may make loud noise. The noise will be less when the refrigerator has been cooled.

Food becomes frozen

- Was the food placed near the cold air duct?
- If the temperature control has been set to "Max" try adjusting the temperature control to the "Min" setting.
- Has the food been placed in the chilled case?

## Specifications

Model No.		NR-BY55BP NR-BY55BV
Freezer Star Rating		✱***
Capacity (L) Gross / Storage (AS/NZS 447.1:2007)	Total	551 / 461
	Freezer	153 / 99
	Refrigerator	398 / 362
Outside Dimensions Width x Depth x Height (mm)		775 x 741 x 1,714
Refrigerant Type		R600a
Net Weight (kg/lb)		79/194
Cooling System		Non-frost cooling.
Rated Voltage (V) Rated Frequency (Hz)		Refer to the rating label put at the door or the back of the cabinet.

---

**Panasonic Corporation**

Website: <http://www.panasonic.com>

© Panasonic Appliances (Thailand) Co., Ltd. 2016