



Panasonic

Operating Instructions
Clock Radio

Model No. **RC-CF30**

Panasonic Corporation
Web Site: <http://www.panasonic.com>



RQT0A54-L

Dear Customer

Thank you for purchasing this product.

For optimum performance and safety, please read these instructions thoroughly before connecting, operating or adjusting this product.

Keep this manual for future reference.

Compatible iPod and iPhone

- iPod nano 7th generation
- iPhone 5C
- iPhone 6 Plus
- iPod touch 5th generation
- iPhone 5S
- iPhone 5
- iPhone 6

Compatibility depends on the software version of your iPod or iPhone. Compatibility depends on the software version. Update your iPhone / iPod to the latest software before using it with this unit. Please be aware that Panasonic accepts no responsibility for the loss of data and / or information.



"Made for iPod" and "Made for iPhone" mean that an electronic accessory has been designed to connect specifically to iPod, or iPhone, respectively, and has been certified by the developer to meet Apple performance standards.

Apple is not responsible for the operation of this device or its compliance with safety and regulatory standards.

iPhone, iPod nano and iPod touch are trademarks of Apple Inc., registered in the U.S. and other countries. Lightning is a trademark of Apple Inc..

Safety precautions

Placement

Set the unit up on an even surface away from direct sunlight, high temperatures, high humidity, and excessive vibration. These conditions can damage the cabinet and other components, thereby shortening the unit's service life.

Place it at least 15 cm away from wall surfaces to avoid distortion and unwanted acoustical effects.

Do not place heavy items on the unit.

Voltage

Do not use high voltage power sources. This can overload the unit and cause a fire.

Do not use a DC power source. Check the source carefully when setting the unit up on a ship or other places where DC is used.

AC adaptor protection

Ensure the AC adaptor is connected correctly and not damaged. Poor connection and lead damage can cause fire or electric shock. Do not pull, bend, or place heavy items on the lead.

Grasp the plug firmly when unplugging the adaptor. Pulling the AC adaptor can cause electric shock.

Do not handle the plug with wet hands. This can cause electric shock.

Foreign matter

Do not let metal objects fall inside the unit. This can cause electric shock or malfunction.

Do not let liquids get into the unit. This can cause electric shock or malfunction. If this occurs, immediately disconnect the unit from the power supply and contact your dealer.

Do not spray insecticides onto or into the unit. They contain flammable gases which can ignite if sprayed into the unit.

Service

Do not attempt to repair this unit by yourself. If sound is interrupted, indicators fail to light, smoke appears, or any other problem that is not covered in these instructions occurs, disconnect the AC adaptor and contact your dealer or an authorised service centre. Electric shock or damage to the unit can occur if the unit is repaired, disassembled or reconstructed by unqualified persons.

Extend operating life by disconnecting the unit from the power source if it is not to be used for a long time.

Supplied accessories

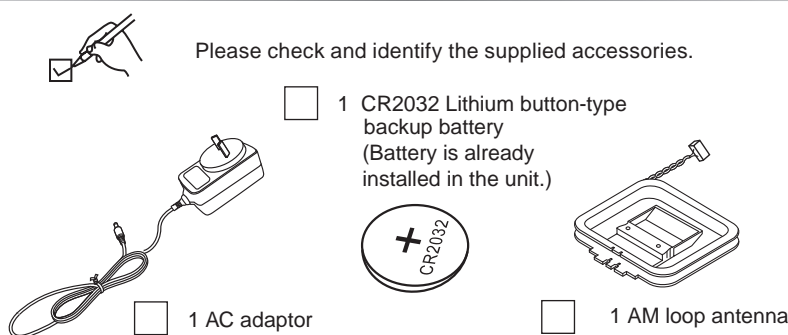

Memory backup

The back-up battery (CR2032) saves the clock and alarm settings in the event of a power interruption.

Bottom view

Before using the first time
Remove the insulation sheet **A**.

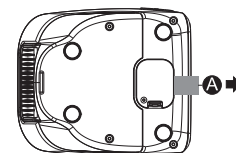

Inserting the battery
When there is no battery, the battery weak indicator will be displayed until a battery is inserted.

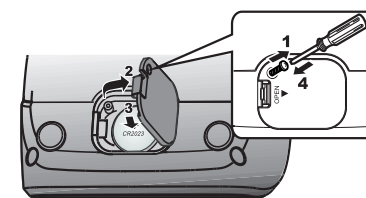

- 1 Keep the AC adaptor connected to the household mains socket when unscrewing the screw on the cover of the battery holder using a screwdriver.
- 2 Open the cover of the battery holder.
- 3 Insert a new battery with the (+) side facing up.
- 4 Close the cover of the battery holder and secure it with the screw.

Replacing the battery

The service life of this battery is approximately 1 month if AC power is down. When the battery is weak, the battery-weak indicator will blink constantly on the display.

Note:

- Do not heat or expose to flame.
- Do not leave the battery(ies) in an automobile exposed to direct sunlight for a long period of time with doors and windows closed.
- Remove the battery if the clock radio is not going to be used for a long period of time. Store in a cool, dark place.

CAUTION

- Danger of explosion if battery is incorrectly replaced. Replace only with the type recommended by the manufacturer.
- When disposing of the batteries, please contact your local authorities or dealer and ask for the correct method of disposal.

Warning

Keep the Button-Type battery out of the reach of children. Never put Button-Type battery in mouth. If swallowed call your doctor. Insert with poles aligned. Do not touch the terminals (+ and -) with metal objects.

Warning

Risk of fire, explosion and burns. Do not recharge, disassemble, heat above 100°C or incinerate.

Troubleshooting guide

Before requesting service, make the following checks. If you are in doubt about some of the check points, or if the solutions indicated do not solve the problem, consult your dealer for instructions.

Clock

Clock cannot be synchronised to iPod or iPhone's time.

- Make sure the iPod or iPhone is securely connected and turned on.
- Update your iPod or iPhone with the latest software.

Daylight saving time does not work.

- Make sure the clock has been set correctly.
- Press and hold [z²] in clock mode to activate daylight saving time.

Alarm

The iPod, radio or buzzer alarm does not sound at the preset time.

- Check that "ALARM 1" or "ALARM 2" has been correctly activated.

The iPod or radio alarm is activated but there is no sound at the preset time.

- Check the alarm's volume setting.

iPod or iPhone

The iPod or iPhone cannot be operated with this unit.

- Make sure the iPod or iPhone has been securely connected and turned on.
- Update your iPod or iPhone with the latest software.

There is no sound from the iPod or iPhone.

- Make sure the iPod or iPhone has been securely connected.
- Adjust the volume.

The iPod or iPhone does not charge.

- Check the connections. Turn off and remove the iPod or iPhone from the dock connector. Reinsert and turn it on again.

Radio

A noise or sound distortion is heard.

- Distance the unit away from any television, personal computer or device easily influenced by magnetism.

A low hum is heard during AM broadcast.

- Separate the antenna from other cables and cords.

Specifications

AMPLIFIER SECTION

RMS Output Power (Mono) 2.6 W (3 Ω), 1 KHz, 10% THD
Front channel

TUNER SECTION

Preset memory FM 10 stations
AM 10 stations
Frequency modulation (FM)
Frequency range 87.50 MHz to 108.00 MHz (50 KHz step)
Antenna terminals 75Ω (unbalanced)
Amplitude modulation (AM)
Frequency range 522 kHz to 1629 kHz (9 kHz step)
520 kHz to 1630 kHz (10 kHz step)

SPEAKER SECTION

Type 1 way, 1 speaker system
Speaker unit(s) Impedance 3Ω
Full range 40 mm cone type

GENERAL

Power supply (AC adaptor) AC 100 to 240 V, 50/60 Hz
DC Output 5 V
Power consumption (with iPod or iPhone charging)
Main unit 11 W
Dimension (W x H x D) 123 mm x 92 mm x 105 mm
Mass
Main unit 0.357 Kg (approximate)
AC adaptor 0.095 Kg (approximate)
Operating temperature range 0°C to + 35°C
Operating humidity range 20% to 80% RH (no condensation)

Power consumption in standby mode:

Main unit 0.3 W (approximate)
AC adaptor 0.3 W (approximate)

Note:

- 1) Specifications are subject to change without notice. Mass and dimensions are approximate.
- 2) Total harmonic distortion is measured by the digital spectrum analyser.

Limited Warranty (FOR AUSTRALIA ONLY)

Panasonic Warranty

1. The product is warranted for 12 months from the date of purchase. Subject to the conditions of this warranty Panasonic or its Authorised Service Centre will perform necessary service on the product without charge for parts or labour, if in the opinion of Panasonic, the product is found to be faulty within the warranty period.
2. This warranty only applies to Panasonic products purchased in Australia and sold by Panasonic Australia or its Authorised Distributors or Dealers and only where the products are used and serviced within Australia or its territories. Warranty cover only applies to service carried out by a Panasonic Authorised Service Centre and only if valid proof of purchase is presented when warranty service is requested.
3. This warranty only applies if the product has been installed and used in accordance with the manufacturer's recommendations (as noted in the operating instructions) under normal use and reasonable care (in the opinion of Panasonic). The warranty covers normal domestic use only and does not cover damage, malfunction or failure resulting from use of incorrect voltages, incorrect installation, accident, misuse, neglect, build-up of dirt or dust, abuse, maladjustment of customer controls, mains supply problems, thunderstorm activity, infestation by insects or vermin, tampering or repair by unauthorised persons (including unauthorised alterations), introduction of sand, humidity or liquids, commercial use such as hotel, office, restaurant, or other business or rental use of the product, exposure to abnormally corrosive conditions or any foreign object or matter having entered the product.
4. This warranty does not cover the following items unless the fault or defect existed at the time of purchase:
 - (a) Cabinet Part(s)
 - (b) Video or Audio Tapes
 - (c) SD cards or USB devices
 - (d) User replaceable Batteries
 - (e) DVD, Blu-ray or Recordable Discs
 - (f) Video / Audio Heads from wear and tear in normal use
 - (g) Information stored on Hard Disk Drive, USB stick or SD card
 - (h) DTV reception issues caused by TV Aerial / Cabling / Wall socket(s) etc.
5. Some products may be supplied with Ethernet connection hardware. The warranty is limited on such products and will not cover (a) Internet and or DLNA connection / setup related problems (b) Access fees and or charges incurred for internet connection (c) The use of incompatible software or software not specifically stipulated in the product operations manual; and (d) Any indirect or consequential costs associated with the incorrect use or misuse of the hardware, its connection to the internet or any other device.
6. To claim warranty service, when required, you should:
 - Telephone Panasonic's Customer Care Centre on 132600 or visit our website referred to below and use the Service Centre Locator for the nearest address of the nearest Authorised Service Centre.
 - Send or take the product to a Panasonic Authorised Service Centre together with your proof of purchase receipt as a proof of purchase date. Please note that freight and insurance to and / or from your nearest Authorised Service Centre must be arranged by you.
 - Note that home or pick-up/delivery service is available for the following products in the major metropolitan areas of Australia or the normal operating areas of the nearest Authorised Service Centres:
 - Plasma/LCD televisions / displays (screen size greater than 103 cm)
7. The warranties hereby conferred do not extend to, and exclude, any costs associated with the installation, de-installation or re-installation of a product, including costs related to the mounting, de-mounting or re-mounting of any screen, (and any other ancillary activities), delivery, handling, freight, transportation or insurance of the product or any part thereof or replacement of and do not extend to, and exclude, any damage or loss occurring by reason of, during, associated with, or related to such installation, de-installation, re-installation or transit.

Panasonic Authorised Service Centres are located in major metropolitan areas and most regional centres of Australia, however, coverage will vary dependant on product. For advice on exact Authorised Service Centre locations for your product, please telephone our Customer Care Centre on 132600 or visit our website and use the Service Centre Locator.

In addition to your rights under this warranty, Panasonic products come with consumer guarantees that cannot be excluded under the Australian Consumer Law. If there is a major failure with the product, you can reject the product and elect to have a refund or to have the product replaced or if you wish you may elect to keep the goods and be compensated for the drop in value of the goods. You are also entitled to have the product repaired or replaced if the product fails to be of acceptable quality and the failure does not amount to a major failure.

If there is a major failure in regard to the product which cannot be remedied then you must notify us within a reasonable period by contacting the Panasonic Customer Care Centre. If the failure in the product is not a major failure then Panasonic may choose to repair or replace the product and will do so in a reasonable period of time from receiving notice from you.

THIS WARRANTY CARD AND THE PURCHASE DOCKET (OR SIMILAR PROOF OF PURCHASE) SHOULD BE RETAINED BY THE CUSTOMER AT ALL TIMES

If you require assistance regarding warranty conditions or any other enquiries, please visit the **Panasonic Australia** website www.panasonic.com.au or contact by phone on **132 600** if phoning in, please ensure you have your operating instructions available.

Panasonic Australia Pty. Limited
ACN 001 592 187 ABN 83 001 592 187
1 Innovation Road, Macquarie Park NSW 2113

PRO-031-F11 Issue: 4.0

01-01-2011

Factory reset

In standby mode, press [◀/▶, ADJ] and [VOL -], "dEF" will show on LCD. Factory reset is done.

Overview of controls

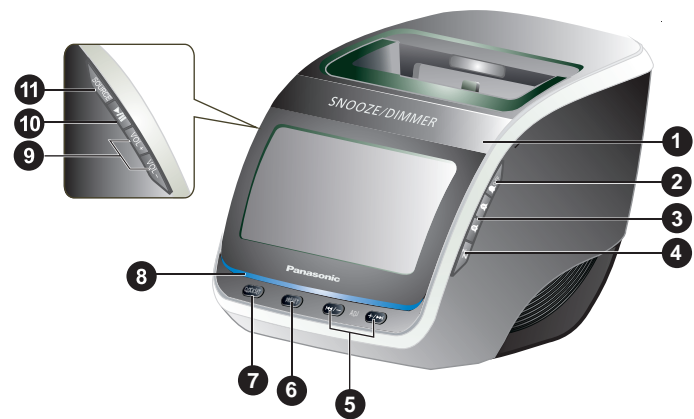

- 1 [SNOOZE/DIMMER]**
To stop the alarm for 9 minutes.
To adjust the display panel's brightness (High (default), Medium or Low).
- 2 [OFF] ALARM OFF**
To turn off the alarm.
- 3 [1] ALARM 1, [2] ALARM 2**
To activate either alarm 1 or alarm 2 function.
To display alarm 1 or alarm 2 setting.
- 4 [z z] SLEEP**
To activate sleep function.
To activate daylight saving time (summer time) in clock mode.
- 5 [<-> /-, ADJ], [+/ >>>, ADJ]**
To adjust clock, radio and alarm settings.
To skip to previous or next track.
To backward or forward search through a track.
- 6 [PRESET]**
To perform automatic presetting or to view preset channels in radio mode.
- 7 [CLOCK SET]**
Press and hold to set clock.
- 8 [DECO LED]**
The deco LED will turn on when iPod or iPhone is docked.
Press & hold [SNOOZE/DIMMER] to turn off or turn on the deco LED.
- 9 [VOL +], [VOL -]**
To adjust the volume.
- 10 [>>> /||]**
To start music playback from an iPod or iPhone and to pause during playback.
- 11 [SOURCE]**
To select clock, "IPOD", "RADIO FM" or "RADIO AM" mode.

Making the connections

Rear view

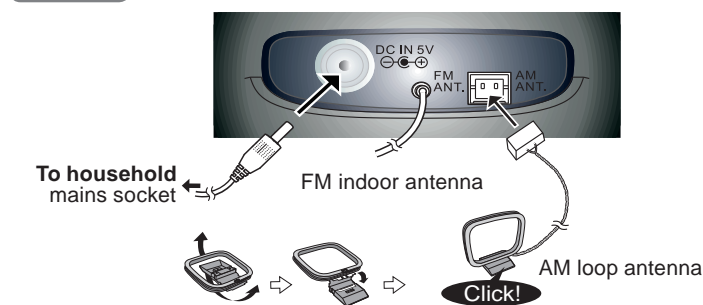

- 1 Connect the AM antenna.**
Stand the antenna up on its base.
- 2 Connect the AC adaptor.**
 - Do not use an AC adaptor from other equipment.
 - Do not use any other AC adaptors except the supplied one.
 - The unit is in the standby condition when the AC adaptor is connected. The primary circuit is always "live" as long as the AC adaptor is connected to an electrical outlet.

Maintenance

To clean this unit, wipe with a soft, dry cloth.

- Never use alcohol, paint thinner or benzine to clean this unit.
- Before using chemically treated cloth, read the instructions that came with the cloth carefully.

Setting the clock

The clock is displayed once the main unit is connected to the household mains socket.

Reset the clock regularly to maintain accuracy (monthly accuracy +/- 60 seconds).

- 1** Press and hold [CLOCK SET] for 2 seconds.
- 2** Press [<-> /-, ADJ] or [+/ >>>, ADJ] to select the day.
- 3** Press [CLOCK SET] again to confirm.
- 4** Repeat steps 2 and 3 to set the hour and minute.

Example:



To change the clock display

In clock mode, press and hold [+/ >>>, ADJ] and [VOL -] at the same time for 2 seconds to select between a 12-hour or 24-hour display.

For 12-hour display:

AM : "PM" is not displayed.

PM : "PM" is displayed.

Daylight saving time (summer time)

In clock mode, press and hold [z z] to activate or cancel daylight saving time (summer time) function.

"DST" is displayed when the function is activated.

Synchronising clock with iPod or iPhone time

This function allows you to set the clock's time to be the same time as your iPod or iPhone's time (see "Compatible iPod or iPhone").

Auto Sync clock while an iPod or iPhone is docked onto the main unit.

Note:

- Compatibility depends on the software version of your iPod or iPhone.

Using an iPod or iPhone

- 1 Pull out the iPod or iPhone support.**

Adjust the support according to the height of your iPod or iPhone.

- 2 Connecting an iPod or iPhone.**

Hold the main unit when connecting or disconnecting the iPod or iPhone.

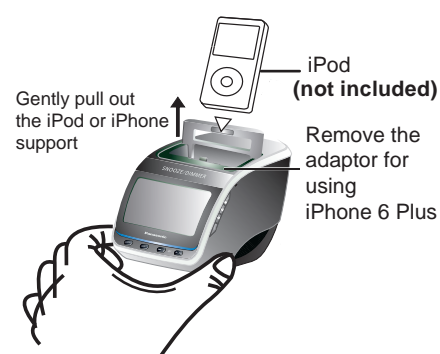

Note:

When docking an iPod touch or iPhone for the first time, a message will be displayed on your iPod touch or iPhone if the Memory Loader application has not been installed (see "Using the Memory Loader application").

Charging an iPod or iPhone

The iPod or iPhone charges automatically when connected to the main unit.

- See iPod or iPhone display to check its charging status.
- If the iPod or iPhone is not being used for an extended period of time after charging has completed, disconnect it from the main unit, as the battery will be depleted naturally. (Once fully charged, additional charging will not occur.)

Playing an iPod or iPhone

- 1** Place an iPod or iPhone in the dock and turn it on.
- 2** Press [SOURCE] to select "IPOD".
- 3** Press [>>> /||] once to start music playback from the iPod or iPhone. Press again to pause playback.
- 4** Press [<-> /-, ADJ] or [+/ >>>, ADJ] to skip to the previous or next track.
- 5** Press and hold [<-> /-, ADJ] or [+/ >>>, ADJ] to backward or forward search through a track.

Note:

- If the iPod or iPhone automatically shuffles or skip a track;
 - Turn off its "Shake" feature (if there is any).
- For iPod or iPhone operation details, refer to iPod or iPhone's User Guide.

Using the radio

Manual tuning

- 1** Press [SOURCE] to select "RADIO FM" or "RADIO AM".
- 2** Press [<-> /-, ADJ] or [+/ >>>, ADJ] to select the desired frequency.

To tune automatically

Press and hold [<-> /-, ADJ] or [+/ >>>, ADJ] until the frequency starts changing rapidly. Automatic tuning stops when it finds a station or when [<-> /-, ADJ] or [+/ >>>, ADJ] is pressed again.

Note:

For better reception, extend and change the direction of the FM or AM antenna.

Memory preset

You may store your favourite channels in 10 FM or 10 AM preset channels.

Preparation

Press [SOURCE] to select "RADIO FM" or "RADIO AM".

Automatic presetting (AP)

Press and hold [SOURCE] until "AP" is displayed.

Note:

- Automatic presetting begins from the current frequency.
- Only the first 10 stations detected will be stored.
- "AP" will blink continuously until all 10 channels have been set.

Manual presetting

- 1** Press [<-> /-, ADJ] or [+/ >>>, ADJ] to select the desired frequency.
- 2** Press and hold [PRESET] for 2 seconds to display the preset number.
- 3** Press [<-> /-, ADJ] or [+/ >>>, ADJ] to select a preset number.
- 4** Press [PRESET] again to confirm.

Tuning in to a preset channel

Press [PRESET] to switch between preset channels.

AM allocation setting

This system can also receive AM broadcasts allocated in 10 kHz steps.

- 1 Press [SOURCE] to select "RADIO AM".**
- 2 Press and hold [>>> /||].**
After a few seconds the display changes to a flashing display of the current minimum frequency. Release the button when the minimum frequency changes.
 - To return to the original step, repeat the above steps.
 - After changing the setting, previously preset frequency will be cleared.

Using the Memory Loader application

This main unit is designed to operate with the Memory Loader application which can be downloaded from the App Store (search for MemoryLoader).

If you have not already downloaded the free Memory Loader application, you will see the following message on your iPod touch or iPhone display:

Application Not Installed
This accessory requires an application you do not have installed. Would you like to install it from the App store?

This message is a reminder for you to download the application in order to enjoy the enhanced features of this main unit. However, your iPod touch and iPhone will work properly with this main unit even without the Memory Loader application installed.

Memory loader is only compatible with iPod touch and iPhone running iOS 6.0 or later.

Once the Memory Loader application is installed into your iPod touch or iPhone, the following functions can be easily accessible and controlled directly through the application's platform.

Alarm

- Adjust alarm 1 and alarm 2 settings easily.
- You may select any combination of days for the alarm to sound.
- You can choose your desired snooze settings from a choice of 1 to 30 minutes.

Radio

- Preset 10 FM or 10 AM channels by scrolling through your desired frequencies by using the selector.

Events

- You can be alerted of dates stored on your iPod touch or iPhone contacts (if the alarm is set to sound on that day).

Nap

- You can set a short nap timer or countdown on your iPod touch or iPhone.

Daylight saving time (DST)

- Activate or deactivate the daylight saving time function with one simple step.

For more information, visit: www.memoryloader.com

Using the sleep timer

This function enables you to turn off the unit automatically after the set time (only in iPod and radio mode).

- 1** Press [z z] to activate the timer.
- 2** Press [z z] again to select your desired time (in minutes).
OFF (default) → 30 → 60 → 90 → 120

Note:

Press [z z] once to check the remaining time.

Using the alarm

You can set two different alarm times. Before setting the alarm, make sure to set the clock (see "Setting the clock").

Setting the alarm

- 1** Press and hold [1] or [2] until the hour display blinks.
- 2** Within 10 seconds, press [<-> /-, ADJ] or [+/ >>>, ADJ] to set the hour.
- 3** Press [1] or [2] to confirm.
- 4** Repeat steps 2 and 3 to set the minutes.
- 5** Press [<-> /-, ADJ] or [+/ >>>, ADJ] to select the days of the week:
MON-SUN (everyday) → MON-FRI (weekdays)
SAT-SUN (weekend)
- 6** Press [1] or [2] to confirm.
- 7** Press [<-> /-, ADJ] or [+/ >>>, ADJ] to select the desired alarm mode: "IPOD", "RADIO" or "BUZZER".
- 8** Press [1] or [2] to confirm.
"IPOD" selection: Continue with steps 9 and 10.
"RADIO" selection: Continue from steps 11 to 16.

Setting iPod alarm

- 9** Press [<-> /-, ADJ] or [+/ >>>, ADJ] to adjust the volume level.
- 10** Press [1] or [2] to confirm the setting.

Note:

- The buzzer will sound if no iPod or iPhone is detected at the set alarm time.
- Music will be played from the iPod or iPhone's library when the alarm sounds.

Setting radio alarm

- 11** Press [<-> /-, ADJ] or [+/ >>>, ADJ] to adjust the volume level.
- 12** Press [1] or [2] to confirm.
- 13** Press [<-> /-, ADJ] or [+/ >>>, ADJ] to select "FM" or "AM".
- 14** Press [1] or [2] to confirm.
- 15** Press [<-> /-, ADJ] or [+/ >>>, ADJ] to select the desired preset channel.
- 16** Press [1] or [2] to confirm the setting.

Note:

- Alarm will function only when powered by AC power.
- To activate or display the alarm setting, press [1] or [2] once.
- Press [1] or [2] again to deactivate the alarm function.

Turning off the alarm

Press [OFF] to turn off the alarm.

The alarm will sound at the same time on the next day.

Note:

If the alarm is not turned off, it will sound continuously for 59 minutes before turning off by itself.

Snoozing the alarm

Press [SNOOZE] when the alarm sounds to stop it for a few minutes.

The alarm will sound again after 9 minutes.

Tip:

For iPod touch and iPhone users, use the Memory Loader application to unlock custom alarm settings (see "Using the Memory Loader application").