

### 2-WAY Mini-FSV LE2 Series

HP	4			4			5			5			6			6																																														
Model name	U-4LE2H4			U-4LE2H7			U-5LE2H4			U-5LE2H7			U-6LE2H4			U-6LE2H7																																														
Power supply	220/230/240V/1-phase/50Hz 220/230V/1-phase/60Hz			380/400/415V/3-phase/50Hz 380/400V/3-phase/60Hz			220/230/240V/1-phase/50Hz 220/230V/1-phase/60Hz			380/400/415V/3-phase/50Hz 380/400V/3-phase/60Hz			220/230/240V/1-phase/50Hz 220/230V/1-phase/60Hz			380/400/415V/3-phase/50Hz 380/400V/3-phase/60Hz																																														
Voltage	220V	230V	240V	380V	400V	415V	220V	230V	240V	380V	400V	415V	220V	230V	240V	380V	400V	415V																																												
Capacity	Cooling		kW			12.1			12.1			14.0			14.0			15.5			15.5																																									
	Heating		kW			12.5			12.5			16.0			16.0			16.5			16.5																																									
EER/COP	Cooling		W/W			5.08			5.08			4.61			4.61			4.27			4.27																																									
	Heating		W/W			5.95			5.95			5.25			5.25			5.08			5.08																																									
Dimensions	H x W x D			mm			996 x 980 x 370			996 x 980 x 370			996 x 980 x 370			996 x 980 x 370			996 x 980 x 370			996 x 980 x 370																																								
Net weight	kg			106			106			106			106			106			106			106																																								
	Electrical ratings	Cooling		Running current			A			11.90			11.40			10.90			3.89			3.69			3.56			15.20			14.50			13.90			4.91			4.67			4.50			18.10			17.30			16.60			5.87			5.57			5.37	
Heating		Running current			A			10.60			10.10			9.70			3.47			3.29			3.18			15.20			14.60			14.0			4.93			4.68			4.51			16.20			15.50			14.90			5.25			4.99			4.81			
Cooling		Power input			kW			2.38			2.38			2.38			3.04			3.04			3.04			3.04			3.04			3.63			3.63			3.63			3.63			3.63			3.63															
Heating		Power input			kW			2.10			2.10			2.10			3.05			3.05			3.05			3.05			3.05			3.25			3.25			3.25			3.25			3.25			3.25															
Starting current	A			1			1			1			1			1			1			1			1																																					
Air flow rate	m <sup>3</sup> / min			69			69			72			72			74			74			74																																								
	L/s			1,150			1,150			1,200			1,200			1,233			1,233			1,233																																								
Refrigerant amount at shipment	kg			R410A 6.70			R410A 6.70			R410A 6.70			R410A 6.70			R410A 6.70			R410A 6.70			R410A 6.70																																								
Piping connection	Gas pipe		mm (inches)			Ø15.88 (Ø5/8)			Ø15.88 (Ø5/8)			Ø15.88 (Ø5/8)			Ø15.88 (Ø5/8)			Ø15.88 (Ø5/8)			Ø15.88 (Ø5/8)																																									
	Liquid pipe		mm (inches)			Ø9.52 (Ø3/8)			Ø9.52 (Ø3/8)			Ø9.52 (Ø3/8)			Ø9.52 (Ø3/8)			Ø9.52 (Ø3/8)			Ø9.52 (Ø3/8)																																									
Ambient temperature operating range	Cooling		-10°CDB~+46°CDB			-10°CDB~+46°CDB			-10°CDB~+46°CDB			-10°CDB~+46°CDB			-10°CDB~+46°CDB			-10°CDB~+46°CDB			-10°CDB~+46°CDB																																									
	Heating		-20°CWB~+18°CWB			-20°CWB~+18°CWB			-20°CWB~+18°CWB			-20°CWB~+18°CWB			-20°CWB~+18°CWB			-20°CWB~+18°CWB			-20°CWB~+18°CWB																																									
Sound pressure level (Cooling)	Normal mode		dB(A)			52.0			52.0			53.0			53.0			54.0			54.0																																									
	Silent mode (3)		dB(A)			45.0			45.0			46.0			46.0			47.0			47.0																																									
Sound power level (Cooling)	Normal mode		dB			69.0			69.0			71.0			71.0			73.0			73.0																																									

Global remarks	Rated conditions:		Cooling	Heating
	Indoor air temperature		27°C DB / 19°C WB	20°C DB
	Outdoor air temperature		35°C DB	7°C DB / 6°C WB

These specifications are subject to change without notice.

### Dimensions

U-4LE2H4 / U-4LE2H7  
U-5LE2H4 / U-5LE2H7  
U-6LE2H4 / U-6LE2H7

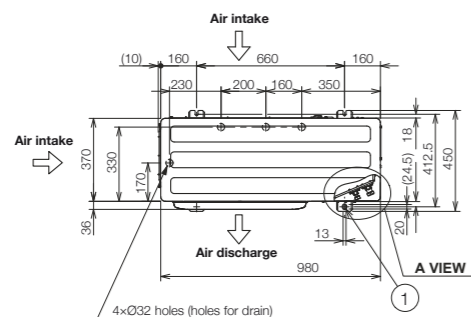

- ① Mounting hole (4-R6.5), anchor bolt : M10
- ② Refrigerant tubing (liquid tube), flared connection (Ø9.52)
- ③ Refrigerant tubing (gas tube), flared connection (Ø15.88)
- ④ Refrigerant tubing port
- ⑤ Electrical wiring port (Ø13)
- ⑥ Electrical wiring port (Ø22)
- ⑦ Electrical wiring port (Ø27)
- ⑧ Electrical wiring port (Ø35)

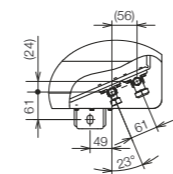

A VIEW

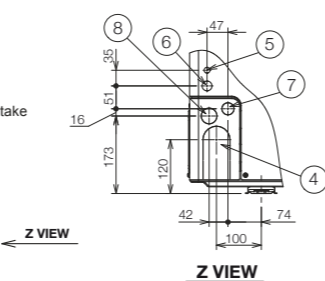
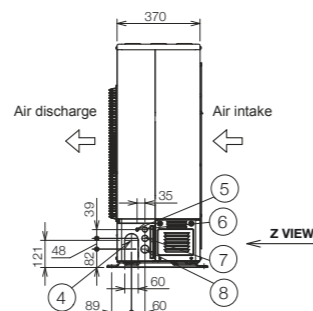
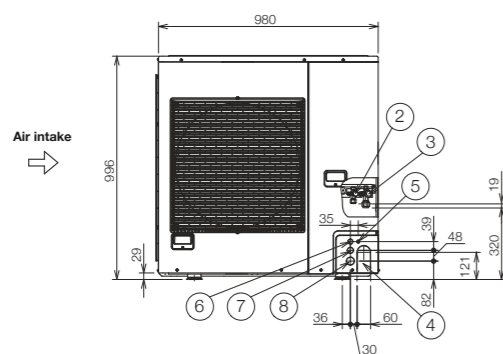

Unit: mm

### 2-WAY Mini-FSV LE1 Series

HP	8						10											
Model name	U-8LE1H7						U-10LE1H7											
Power supply	380/400/415V/3-phase/50Hz 380/400V/3-phase/60Hz						380/400/415V/3-phase/50Hz 380/400V/3-phase/60Hz											
Voltage	380V		400V		415V		380V		400V		415V							
Capacity	Cooling		kW				22.4				28.0							
	Heating		kW				25.0				28.0							
EER/COP	Cooling		W/W				4.20				3.59							
	Heating		W/W				4.52				4.55							
Dimensions	H x W x D						1,500 x 980 x 370											
Net weight	kg						132											
Electrical ratings	Cooling		Running current		A		8.70		8.25		7.95		12.7		12.1		11.7	
	Heating		Running current		A		9.05		8.60		8.25		10.0		9.55		9.20	
	Cooling		Power input		kW		5.33		5.33		5.33		7.80		7.80		7.80	
	Heating		Power input		kW		5.53		5.53		5.53		6.15		6.15		6.15	
Starting current	A						1											
Air flow rate	m <sup>3</sup> / min						150											
	L/s						2,500											
Refrigerant amount at shipment	kg						R410A 6.30											
Piping connection	Gas pipe		mm (inches)				Ø19.05 (Ø3/4)				Ø22.22 (Ø7/8)							
	Liquid pipe		mm (inches)				Ø9.52 (Ø3/8)				Ø9.52 (Ø3/8)							
Ambient temperature operating range	Cooling: -10°CDB~+46°CDB, Heating: -20°CWB~+18°CWB						Cooling: -10°CDB~+46°CDB, Heating: -20°CWB~+18°CWB											
Sound pressure level (Cooling)	Normal mode		dB(A)				59.0				62.0							
	Silent mode (3)		dB(A)				52.0				55.0							
Sound power level (Cooling)	Normal mode		dB				80.0				83.0							

Global remarks	Rated conditions:		Cooling	Heating
	Indoor air temperature		27°C DB / 19°C WB	20°C DB
	Outdoor air temperature		35°C DB	7°C DB / 6°C WB

These specifications are subject to change without notice.

### Dimensions

U-8LE1H7 / U-10LE1H7

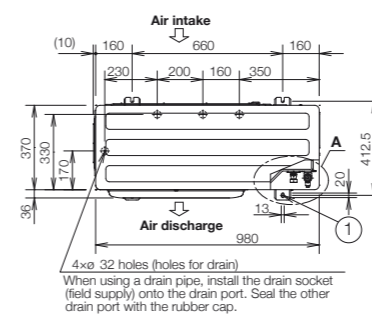

- ① Mounting hole (4-R6.5), anchor bolt : M10
- ② Refrigerant tubing (liquid tube), flared connection (Ø9.52) for 8-10 HP finally.
- ③ Refrigerant tubing (gas tube), flared connection (Ø19.05)
- ④ Refrigerant tubing port
- ⑤ Electrical wiring port (Ø13)
- ⑥ Electrical wiring port (Ø22)
- ⑦ Electrical wiring port (Ø27)
- ⑧ Electrical wiring port (Ø35)

**For U-10LE1H7**  
The tubing of the gas main has a diameter of ø22.22, but the connection to the service valve of the outdoor unit has a diameter of ø19.05, so a flare has to be used. Consequently, be sure to use the enclosed joint tube B and joint tube A in making connections (brazing).

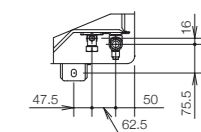

A VIEW

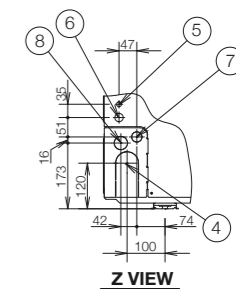
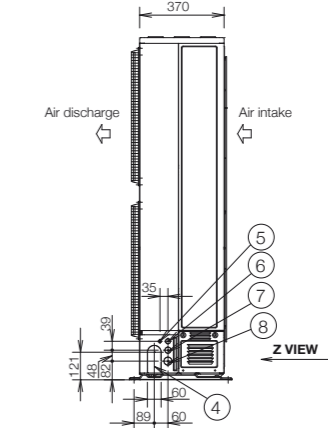
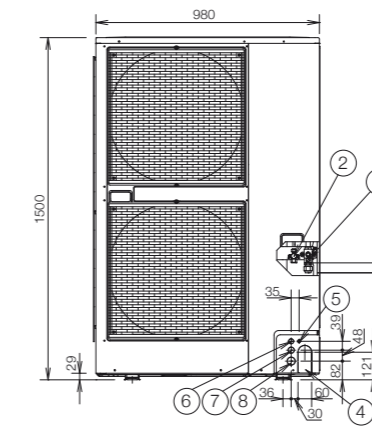

Unit: mm