

Panasonic®

Operating Instructions
使用说明书

Wireless Speaker System 无线扬声器系统

Model No. **SC-UA7**

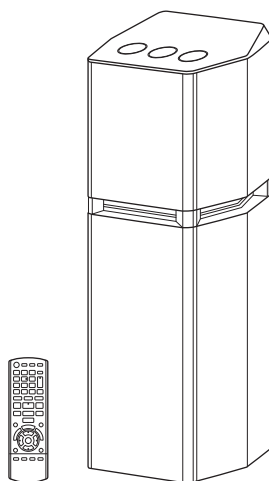

Thank you for purchasing this product.

For optimum performance and safety, please read these instructions carefully.

Please keep this manual for future reference.

感谢您购买本产品。

为确保最佳性能和安全，请仔细阅读本说明书。

请保管本说明书以备今后参考。

GS

RQT0B17-G

Your system and the illustrations can look differently.

Recording and playback of content on this or any other devices may require permission from the owner of the copyright or other such rights of that content. Panasonic has no authority to and does not grant you that permission and explicitly disclaims any right, ability or intention to obtain such permission on your behalf. It is your responsibility to ensure that your use of this or any other devices complies with applicable copyright legislation in your country. Please refer to that legislation for more information on the relevant laws and regulations involved or contact the owner of the rights of the content you wish to record or playback.



**Disposal of Old Equipment and Batteries
Only for European Union and countries
with recycling systems**

This symbol is only valid in the European Union.

If you wish to discard this product, please contact your local authorities or dealer and ask for the correct method of disposal.

Table of contents

Safety precautions	2
References	3
Note on AC mains lead	3
Supplied accessories	4
Transporting the unit	4
Maintenance	4
Preparing the remote control	5
Making the connections	5
Overview of controls	6
Preparing media	8
Media playback	9
Radio	10
Recording	11
Sound effects	12
Illumination	13
DJ jukebox	13
Karaoke jukebox	13
Using a microphone	14
Clock and timers	14
External equipment	15
Others	16
Troubleshooting	17
Specifications	19
Limited Warranty (Australia)	20

Safety precautions

WARNING!

Unit

- To reduce the risk of fire, electric shock or product damage,
 - Do not expose this unit to rain, moisture, dripping or splashing.
 - Do not place objects filled with liquids, such as vases, on this unit.
 - Use only the recommended accessories.
 - Do not remove covers.
 - Do not repair this unit by yourself. Refer servicing to qualified service personnel.
 - Do not let metal objects fall inside this unit.

CAUTION!

Unit

- To reduce the risk of fire, electric shock or product damage,
 - Do not install or place this unit in a bookcase, built-in cabinet or in another confined space. Ensure this unit is well ventilated.
 - Do not obstruct this unit's ventilation openings with newspapers, tablecloths, curtains, and similar items.
 - Do not place sources of naked flames, such as lighted candles, on this unit.

For Asia and the Middle East

This unit is intended for use in tropical climates.

For others

This unit is intended for use in moderate climates.

- This unit may receive radio interference caused by mobile telephones during use. If such interference occurs, please increase separation between this unit and the mobile telephone.
- Set the unit up on an even surface away from direct sunlight, high temperatures, high humidity, and excessive vibration.

AC mains lead

- The mains plug is the disconnecting device. Install this unit so that the mains plug can be unplugged from the socket outlet immediately.

Battery

- Danger of explosion if battery is incorrectly replaced. Replace only with the type recommended by the manufacturer.
- When disposing of the batteries, please contact your local authorities or dealer and ask for the correct method of disposal.
- Do not heat or expose to flame.
- Do not leave the battery(ies) in a car exposed to direct sunlight for a long period of time with doors and windows closed.
- Do not break open or short-circuit the battery.
- Do not charge the alkaline or manganese battery.
- Do not use the battery if the cover has peeled off.
- Remove the battery if you do not use the remote control for a long period of time. Keep in a cool, dark area.

References

About Bluetooth®

Panasonic bears no responsibility for data and/or information that can possibly be compromised during a wireless transmission.

Frequency band

- This system uses the 2.4 GHz frequency band.

Certification

- This system conforms to the frequency restrictions and has received certification based on frequency laws. Thus, a wireless permit is not necessary.
- The actions below are punishable by law:
 - Taking apart or modifying the unit.
 - Removing specification indications.

Restrictions of use

- Wireless transmission and/or usage with all Bluetooth® equipped devices is not guaranteed.
- All devices must conform to standards set by Bluetooth SIG, Inc.
- Depending on the specifications and settings of a device, it can fail to connect or some operations can be different.
- This system supports Bluetooth® security features. But depending on the operating environment and/or settings, this security is possibly not sufficient. Transmit data wirelessly to this system with caution.
- This system cannot transmit data to a Bluetooth® device.

Range of use

- Use this device at a maximum range of 10 m.
- The range can decrease depending on the environment, obstacles or interference.

Interference from other devices

- This system may not function properly and troubles such as noise and sound jumps may arise due to radio wave interference if this unit is located too close to other Bluetooth® devices or the devices that use the 2.4 GHz band.
- This system may not function properly if radio waves from a nearby broadcasting station, etc. is too strong.

Intended usage

- This system is for normal, general use only.
- Do not use this system near an equipment or in an environment that is sensitive to radio frequency interference (example: airports, hospitals, laboratories, etc.).

Licenses

The Bluetooth® word mark and logos are registered trademarks owned by Bluetooth SIG, Inc. and any use of such marks by Panasonic Corporation is under license. Other trademarks and trade names are those of their respective owners.

Google Play and Android are trademarks of Google Inc.

MPEG Layer-3 audio coding technology licensed from Fraunhofer IIS and Thomson.

Note on AC mains lead

(For the AC mains plug of three pins)

Before use

Remove the connector cover.

How to replace the fuse

The location of the fuse differ according to the type of AC mains plug (figures A and B). Confirm the AC mains plug fitted and follow the instructions below. Illustrations may differ from actual AC mains plug.

- Open the fuse cover with a screwdriver.

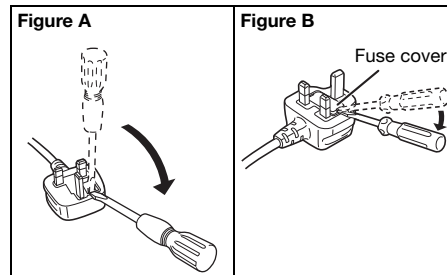

- Replace the fuse and close or attach the fuse cover.

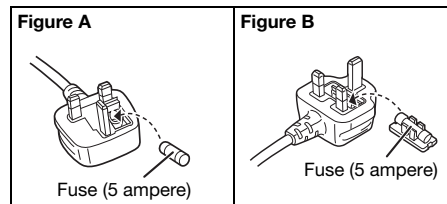

Supplied accessories

Check and identify the supplied accessories.

- ☐ 4 AC mains leads
- ☐ 1 Cleaning cloth
- ☐ 1 Ferrite core



- ☐ 1 FM indoor antenna



- ☐ 1 Remote control
(N2QAYB001082)

- ☐ 1 Remote control battery

Note:

Use the AC mains lead that is suitable for your household mains socket.

- The audio output is multidirectional. Do not obstruct the speakers with any object that may decrease the sound quality.
- The subwoofer is located at the front and rear of the unit. Keep the rear of the unit at least 10 cm away from a wall for better sound quality.
- When you play at high levels for a long period, it can cause damage to the speakers and decrease the life of the speakers.
- Decrease the volume in these conditions to prevent damage:
 - When the sound is distorted.
 - When you adjust the sound quality.

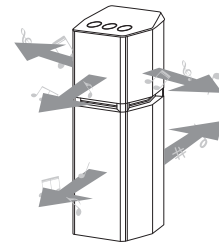

CAUTION!

- Improper handling or transportation manner may cause the unit to fall, etc., resulting in damage and/or personal injury.
- Do not transport the unit by holding the lighting plate as this may damage the lighting plate.
- Do not put any object on the top panel of the unit.
- Do not stack any object on the unit.
- Do not allow children to climb on the unit.
- Be careful when babies or children are near.



Transporting the unit

Preparation

Disconnect all connected devices and cables from the unit.

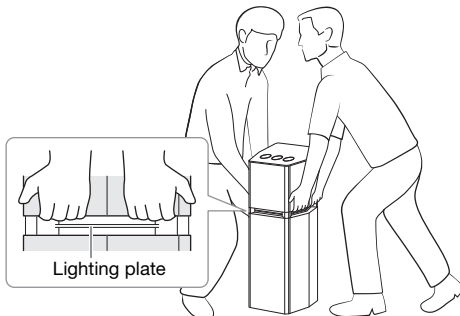

Note:

- More than one person is required to move, tilt or carry the unit.
- Keep the unit at least 10 mm away from other objects for proper ventilation.
- Put the unit on a flat safe surface.
- The speakers do not have magnetic shielding. Do not put them near PCs or other equipment easily influenced by magnetism.

Maintenance

To clean this system, wipe with a soft, dry cloth.

- Disconnect the AC mains lead to reduce the risk of fire, electric shock or product damage.
- Never use alcohol, paint thinner or benzene to clean this system.
- Before using chemically treated cloth, read the instructions that came with the cloth carefully.

Preparing the remote control

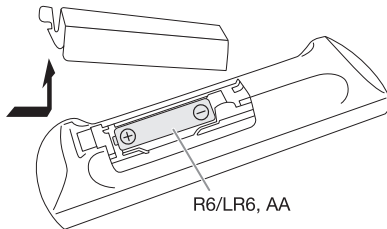

Use alkaline or manganese battery.

Install the battery so that the poles (+ and -) align with those in the remote control.

Making the connections

Connect the AC mains lead only after all the other connections have been made.

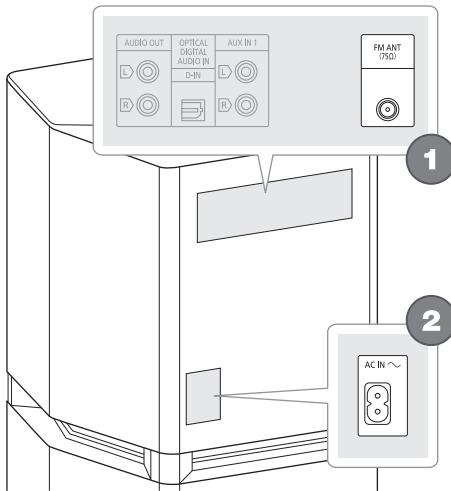

1 Connect the FM indoor antenna.

Put the antenna where reception is best.

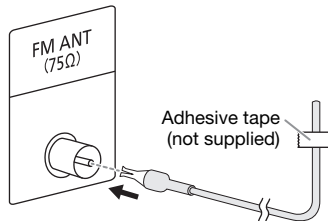

2 Connect the AC mains lead.

Do not use any other AC mains leads except the supplied one.

To household
mains socket

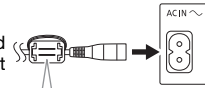

Attaching the ferrite core near to the terminal

- ① Pull on the tabs (both sides) to open.
- ② Put the AC mains lead onto one of the concave surfaces.
- ③ Coil the AC mains lead around the ferrite core and onto the other concave surface.
- ④ Close the ferrite core until it clicks.

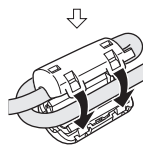
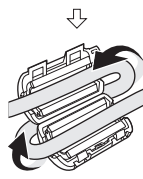
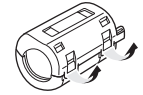

Note:

Failure to attach the ferrite core to the AC mains lead may cause interference to other devices nearby.

Conserving power

The system consumes a small amount of power even when it is in standby mode. Disconnect the power supply if you do not use the system. Some settings will be lost after you disconnect the system. You have to set them again.

Overview of controls

Do the procedures with the remote control. You can also use the touch keys on the unit if they are the same.

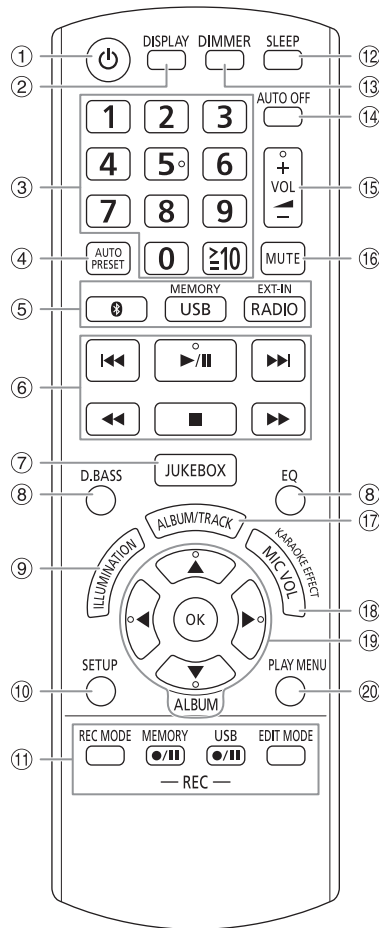

- ① **Standby/on switch** [⏻], [⏻/⏶]
Press*1 or touch*2 to switch the unit from on to standby mode or vice versa. In standby mode, the unit is still consuming a small amount of power.
*1 For the button on the remote control
*2 For the touch key on the unit
- ② View the content information
- ③ **Numeric buttons**
To select a 2-digit number
Example: 16: [≥10] → [1] → [6]
- ④ Auto preset the radio station
- ⑤ **Select the audio source**
On the unit:
Touch [SELECT] to select the source:
USB A → USB B → BLUETOOTH → FM
↑
AUX 2 ← AUX 1 ← D-IN ← MEMORY
To start Bluetooth® pairing, touch and hold [Ⓜ].
- ⑥ Basic playback control
- ⑦ Select DJ jukebox or Karaoke jukebox
- ⑧ Select the sound effects
- ⑨ Switch on or switch off the illumination
- ⑩ View the setup menu
- ⑪ Recording operation control
- ⑫ Set the sleep timer
- ⑬ **Decrease the brightness of the display panel and the illumination**
The status indicators are also switched off.
To cancel, press the button again.
- ⑭ **Automatically switch off the system**
This system automatically switches off when you do not use it for approximately 20 minutes.
This function does not work when you are in radio source or when a Bluetooth® device is connected.
To cancel, select "OFF".
- ⑮ Adjust the volume level
- ⑯ **Mute the sound**
To cancel, press the button again.
"MUTE" is also cancelled when you adjust the volume or when you switch off the system.
- ⑰ Select MP3 album or track
- ⑱ Adjust the microphone volume level
Select the Karaoke effects
- ⑲ Select or confirm the option
- ⑳ View the play menu

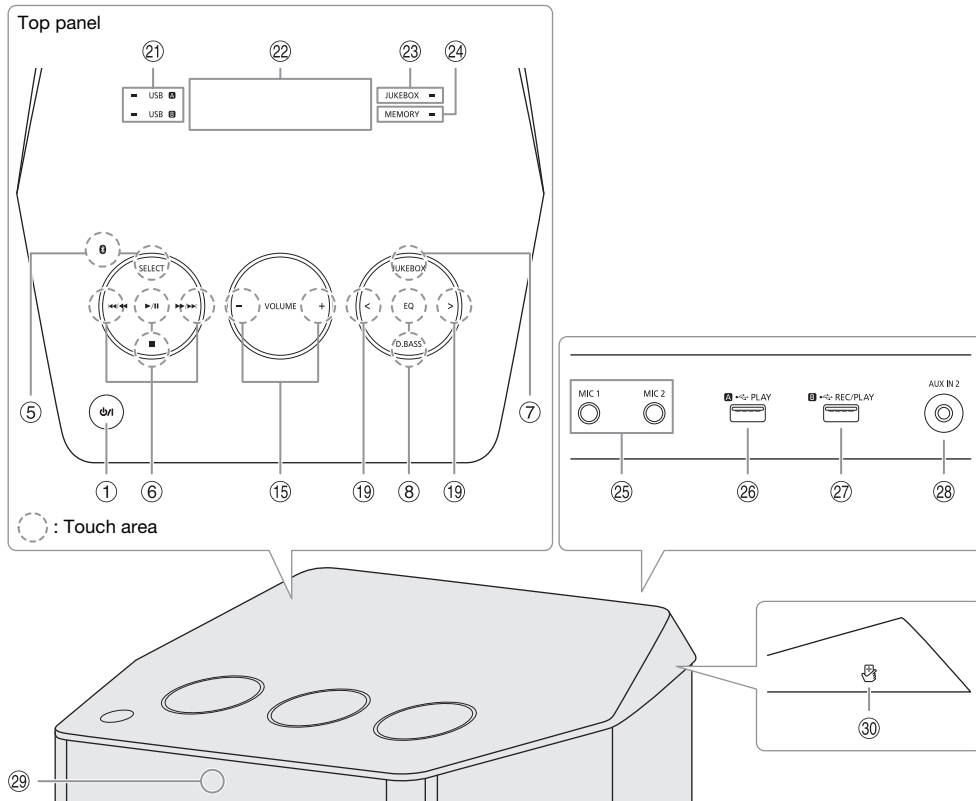

- ②① USB status indicator
- ②② Display panel
- ②③ DJ jukebox or Karaoke jukebox status indicator
- ②④ Internal memory status indicator
- ②⑤ Microphone jack
- ②⑥ **USB A**
USB port (A) (Play MP3 tracks).
- ②⑦ **USB B**
USB port (B) (Play MP3 tracks.
Record sound or music tracks).
- ②⑧ AUX IN 2 jack
- ②⑨ **Remote control sensor**
Distance: Within approximately 7 m
Angle: Approximately 20° up and down, 30° left and right
- ③⑩ NFC touch area

Note:

You can use the touch keys just by touching the marks. The system beeps when you touch any touch key (refer to "Touch sound" for switching off the touch sound).

- To ensure these touch keys are operated correctly, make sure to touch within the touching area of the mark (refer to the illustration above for the touch area).
- To avoid operating these touch keys unintentionally, do not put any object on them.

Preparing media

USB

Preparation

Before you connect a USB device to the system, make sure you do a backup of the data.

1 Decrease the volume and connect the USB device to the USB port.

Hold the unit when connecting or disconnecting the USB device.

2 Press [USB/MEMORY] to select "USB A" or "USB B".

USB status indicator lights up in red when selected.

Note:

Do not use a USB extension cable. The system cannot recognise USB device connected through a cable.

Bluetooth®

You can connect and play an audio device wirelessly through Bluetooth®.

Preparation

- Switch on the Bluetooth® feature of the device and put the device near the system.
- Read the operating instructions of the device for details.

Pairing a device

Preparation

If this system is connected to a Bluetooth® device, disconnect it (→ "Disconnecting a device").

1 Press [8].

If "PAIRING" is shown, continue with step 3.

2 Press [PLAY MENU] to select "PAIRING" and then press [OK].

3 Select "SC-UA7" from the Bluetooth® menu of the device.

If prompted for a passkey, input "0000".

The device connects with this system automatically after pairing is complete.

The name of the connected device is shown for a few seconds.

Using the unit

1 Touch and hold [8] until "PAIRING" is shown.

2 Select "SC-UA7" from the Bluetooth® menu of the device.

Note:

You can pair up to 8 devices with this system. If a 9th device is paired, the device that has not been used for the longest time will be replaced.

Connecting a device

Preparation

If this system is connected to a Bluetooth® device, disconnect it (→ "Disconnecting a device").

1 Press [8].

"BLUETOOTH READY" is shown.

2 Select "SC-UA7" from the Bluetooth® menu of the device.

The name of the connected device is shown for a few seconds.

3 Start playback on the device.

Note:

- A device must be paired to connect.
- This system can only connect to one device at a time.
- When "BLUETOOTH" is selected as the source, this system will automatically try to connect to the last connected device. ("LINKING" is shown during this process.)

Disconnecting a device

1 Press [8].

2 Press [PLAY MENU] to select "DISCONNECT?".

3 Press [◀, ▶] to select "OK? YES" and then press [OK].

"BLUETOOTH READY" is shown.

To cancel, select "OK? NO".

Using the unit

Touch and hold [8] until "PAIRING" is shown.

Note:

A device is disconnected when you:

- Select a different source.
- Move the device out of the maximum range.
- Disable the Bluetooth® transmission of the device.
- Switch off the system or the device.

One-Touch Connection (NFC)

For NFC-compatible Bluetooth® devices (Android™ devices) only

Simply by touching an NFC (Near Field Communication)-compatible Bluetooth® device on the system, you can complete all preparations, from registering a Bluetooth® device to establishing a connection.

Android™ device version lower than 4.1 requires the installation of the "Panasonic MAX Juke" app (free of charge).

- ① Enter "Panasonic MAX Juke" in the search box on Google Play™ to search and then select "Panasonic MAX Juke".
- ② Start the app.
 - Follow the instructions to complete the settings.
 - Make sure to use the latest version of the app.

Preparation

Switch on the NFC feature of the device.

- 1 Press [F].
- 2 Touch and hold the device on the NFC touch area of the unit [B].

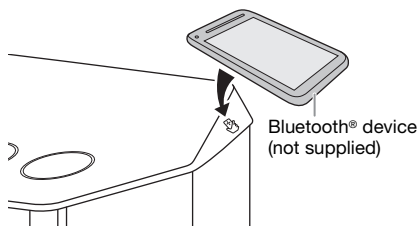

- Hold the device until it beeps, vibrates or displays a pop-up window, and then move the device away from the system.
- Once the registration and connection of the device is complete, the name of the connected device is shown on the system for a few seconds.
- When the connection is not established even if the device has touched the NFC touch area, change its touching position. The connection may improve if you use the "Panasonic MAX Juke" app.

3 Start playback on the device.

Note:

- While connected, you can connect another device by touching and holding it on the NFC touch area of the unit. The previous device will be disconnected automatically.
- Depending on the device:
 - The one-touch connection may not work.
 - The position of the NFC touch area of the device may be different.
 - When the connection is established, playback may start automatically.

Media playback

The following marks indicate the availability of the feature.

- USB**: USB device with MP3 files.
BLUETOOTH: Bluetooth® device.
MEMORY: Internal memory (refer to "Recording" for adding tracks to the internal memory).

Basic playback

USB BLUETOOTH MEMORY

Play	Press [▶/⏮].
Stop	Press [■]. USB MEMORY The position is memorised. "RESUME" is shown. Press again to stop fully.
Pause	Press [▶/⏮]. Press again to continue playback.
Skip	Press [◀◀] or [▶▶] (unit: [◀◀/▶▶] or [▶▶/▶▶]) to skip track. USB MEMORY Press [▲, ▼] to skip MP3 album.
Search	Press and hold [◀◀] or [▶▶] (unit: [◀◀/▶▶] or [▶▶/▶▶]).

Note:

Depending on the Bluetooth® device, some operations may not work.

Viewing available information

USB BLUETOOTH MEMORY

You can view the available information, such as MP3 album and track number, on the display panel.

Press [DISPLAY].

Example: MP3 album and track number display.



Note:

- Maximum characters that can be shown: Approximately 32
- This system supports ver. 1.0, 1.1 and 2.3 ID3 tags.
- Text data that the system does not support can show differently.

Play menu

USB MEMORY

- 1 Press **[PLAY MENU]**.
- 2 Press **[◀, ▶]** to select the setting and then press **[OK]**.

OFF PLAYMODE	Cancel the setting.
1-TRACK 1	Play one selected track. Press the numeric buttons to select the track.
1-ALBUM 1	Play one selected MP3 album. Press [▲, ▼] to select the MP3 album.
RANDOM RND	Play all tracks randomly.
1-ALBUM RANDOM 1 RND	Play all tracks in one selected MP3 album randomly. Press [▲, ▼] to select the MP3 album.
ALL REPEAT 	Repeat all tracks.
1-TRACK REPEAT 1	Repeat 1-TRACK.
1-ALBUM REPEAT 1	Repeat 1-ALBUM.
RANDOM REPEAT RND	Repeat random playback.
1-ALBUM RANDOM REPEAT 1 RND	Repeat 1-ALBUM RANDOM.

Note:

- During random playback, you cannot skip to tracks which have been played.
- The setting is cancelled when you disconnect the USB device.

Link mode

BLUETOOTH

You can change the link mode to suit the connection type.

Preparation

If this system is connected to a Bluetooth® device, disconnect it (→ "Disconnecting a device").

- 1 Press **[PLAY MENU]** to select **"LINK MODE"**.
- 2 Press **[◀, ▶]** to select the mode and then press **[OK]**.

MODE 1	Emphasis on connectivity.
MODE 2 (default)	Emphasis on sound quality.

Note:

- Depending on the device, the playback image and sound may not be synchronised. In this case, select "MODE 1".
- Select "MODE 1" if the sound is interrupted.

Note on USB device

- This system does not guarantee connection with all USB devices.
- This system supports USB 2.0 full speed.
- This system can support USB devices of up to 32 GB.
- Only FAT 12/16/32 file system is supported.

Note on MP3 file

- Files are defined as tracks and folders are defined as albums.
- Tracks must have the extension ".mp3" or ".MP3".
- Tracks will not necessarily be played in the order you recorded them.
- This system can access up to:
 - 800 albums (including root folder)
 - 8000 tracks
 - 999 tracks in one album

Radio

Preparation

Press **[RADIO/EXT-IN]** to select "FM".

Manual tuning

Press **[◀◀]** or **[▶▶]** to tune in to the station.

To tune automatically, press and hold the button until the frequency starts changing quickly.

"STEREO" is shown when a stereo broadcast is being received.

Using the unit

- 1 Touch **[■]** to select **"MANUAL"**.
- 2 Touch **[◀◀/▶▶]** or **[▶▶/▶▶]** to tune in to the station.

Memory presetting

You can preset up to 30 FM stations.

Automatic presetting

- 1 Press **[AUTO PRESET]** to select **"LOWEST"** or **"CURRENT"**.

LOWEST	Tuning begins from the lowest frequency.
CURRENT	Tuning begins from the current frequency.

- 2 Press **[OK]** to start presetting.

The tuner presets all the stations it can receive into the channels in ascending order.

To cancel, press **[■]**.

Manual presetting

- 1 Press [**◀◀**] or [**▶▶**] (unit: [**◀◀/◀◀**] or [**▶▶/▶▶**]) to tune in to the station.
- 2 Press [**OK**].
- 3 Press the numeric buttons to select a preset number.
Do steps 1 through 3 again to preset more stations.
The new station replaces any station that occupies the same preset number.

Selecting a preset station

Press the numeric buttons, [**◀◀**] or [**▶▶**] to select the preset station.

Using the unit

- 1 Touch [**■**] to select "PRESET".
- 2 Touch [**◀◀/◀◀**] or [**▶▶/▶▶**] to select the preset station.

Improving the sound quality

- 1 Press [**PLAY MENU**] to select "FM MODE".
- 2 Press [**◀**, **▶**] to select "MONO" and then press [**OK**].
To cancel, select "STEREO".
"MONO" is also cancelled when you change the frequency.

To memorise the setting

Continue with step 2 of "Manual presetting".

Checking the signal status

Press [**DISPLAY**].

FM ----	The FM signal is weak. The system is not tuned in to a station.
FM ST	The FM signal is in stereo.
FM MONO	"MONO" is selected as the "FM MODE". The FM signal is in monaural.

Recording

This system can record up to 800 folders (maximum 999 tracks in an album) or a total of 8000 tracks, depending on the available storage capacity of the internal memory or the USB device in **USB B**.

To check storage space

In the stop mode, press [**DISPLAY**].

Example: Remaining recording time of the internal memory.



Internal memory Remaining recording time source

- "UPDATE" is shown when the system is reading the USB device.
- "NO DEVICE" is shown if there is no USB device connected to **USB B**.

Note:

- All recordings are in ".mp3" format.
- You cannot do recording when you are using random playback mode or in the optical input source.
- DJ jukebox or Karaoke jukebox is switched off during recording.
- Repeat playback mode is cancelled during recording.
- A new album is added each time you do a recording.
- The sequence of album may change after the recording.
- The recordings are kept in a folder named "REC_DATA" in the USB device or the internal memory.
- USB status indicator blinks in red during USB recording.
- Internal memory status indicator blinks in red during internal memory recording.

Basic recording

- 1 Select the source you want to record.

Radio

Tune in to the radio station.

AUX 1 or AUX 2

Connect and play the equipment (⇒ "External equipment").

- 2 Press [**MEMORY REC ●/II**] or [**USB REC ●/II**] to start recording.

The name of the folder that keeps the recording is shown.

Stop recording	Press [■]. "WRITING" is shown.
Pause recording	Press [MEMORY REC ●/II] or [USB REC ●/II] during recording. Press again to continue recording. Note: You can pause during recording except in "SYNCHRO" mode. A track mark is added every time you pause (⇒ "Adding track marks").

Note:

Wait for a few seconds for the system to prepare the USB device before you start recording.

Adding track marks

You can divide tracks using various modes.

Before recording

Press [REC MODE] to select the mode.

MANUAL	Add a track mark manually. Press [OK] during recording to add a track mark.
SYNCHRO (For AUX 1 or AUX 2 source)	Recording starts automatically when the other equipment starts to play. Recording pauses when it detects silence for 3 seconds.
TIME MARK	A track is automatically divided at 5-minute intervals.

Note:

- During recording, if you press [OK] or pause recording while using "TIME MARK" mode, the 5-minute counter is reset.
- You cannot add track marks manually in "SYNCHRO" mode.

Recording MP3 tracks

You can record MP3 tracks from:

- USB A** to **USB B** or the internal memory
- USB B** to the internal memory or vice versa

1 Prepare the source you want to record.

Record all tracks	Select "OFF PLAYMODE" (→ "Play menu").
Record a specified album or track	Select "1-ALBUM" or "1-TRACK" (→ "Play menu").

2 Press [MEMORY REC ●/II] or [USB REC ●/II] to start recording.

To check the recording progress, press [DISPLAY].

Stop recording	Press [■]. Recording stops at the last fully recorded track in the album. For example, if you stop recording during the fourth track, only the first three tracks are recorded. "NO FILE RECORDED" is shown if no track is recorded.
----------------	--

Note:

- Some tracks can use a longer time to record.
- Some tracks cannot be recorded because of the condition of the source.
- The recorded file name is the same as the original file (only a maximum of 32 characters can be shown on the display panel).

Deleting the recorded tracks

1 MEMORY

Press [USB/MEMORY] to select "MEMORY".

USB B

Press [USB/MEMORY] to select "USB B".

2 Press [▲, ▼] to select the album.

3 Press [◀◀] or [▶▶] to select the track.

4 Press [EDIT MODE] to select the mode.

TRACK DEL	Delete a single track.
ALBUM DEL	Delete one album (maximum 999 tracks).
FORMAT	Format the USB device.
ALL DEL	Delete all albums in the internal memory.

5 Press [OK].

The selected item to be deleted is shown.

6 Press [OK].

"SURE? NO" is shown.

7 Press [◀, ▶] to select "SURE? YES" and then press [OK].

"WRITING" is shown.

To cancel, select "SURE? NO".

Sound effects

1 Press [EQ] to select the sound effect.

2 Press [◀, ▶] (unit: [<, >]) to select the setting and then press [OK].

PRESET EQ	Select the desired preset EQ setting. Note: Select "VOICE EX" for voices to be heard as if they are coming from a TV. (The unit and the TV must be put side by side.)
BASS/MID/TREBLE	-4 to +4
SURROUND	"ON SURROUND" or "OFF SURROUND"

D.Bass

1 Press [D.BASS] to select "D.BASS LEVEL" or "D.BASS BEAT".

To cancel, select "OFF D.BASS".

2 Press [◀, ▶] (unit: [<, >]) to select the setting and then press [OK].

Note:

D.BASS BEAT: This function emphasises the attack level of the drumbeat and produces a punchy sound. Depending on the track, the effect may be small.

Illumination

You can switch on or switch off the illumination on the system.

Press [ILLUMINATION] to select "ON" and then press [OK].

To cancel, select "OFF".

DJ jukebox

USB MEMORY

You can use the DJ jukebox function to add a cross-fade effect or sample sound mix between songs.

Using the "Panasonic MAX Juke" app

You can download and install the free Android™ app "Panasonic MAX Juke" on Google Play™ for additional features, such as to request song playback from multiple devices simultaneously. You can also call up the tracks you want to play through the app. For details on the app, refer to the site below.

http://av.jpn.support.panasonic.com/support/global/cs/audio/app/max_juke/android/index.html
(This site is in English only.)

Press [JUKEBOX] to select "DJ JUKEBOX ON" and then press [OK].

To cancel, select "JUKEBOX OFF".

Note:

- The system switches to repeat mode automatically when you switch on DJ jukebox.
- DJ jukebox is switched off when you switch off the system, change to another source or during recording.

Changing the repeat setting

1 Press [PLAY MENU].

2 Press [◀, ▶] to select the setting and then press [OK].

RANDOM REPEAT RND ◁	Repeat random playback.
ALL TITLE REPEAT ◁	Repeat all tracks.
RANDOM MIX REPEAT RND ◁	Repeat random playback. Sample sound is added to the intervals of all tracks.

Changing the DJ jukebox effect

1 Press [JUKEBOX] to select "DJ JUKEBOX ON".

2 Press [◀, ▶] (unit: [◀, ▶]) to select the effect and then press [OK].

Note:

You cannot select the DJ jukebox effect when you are using "RANDOM MIX REPEAT" mode.

Karaoke jukebox

Preparation

Select the music source.

Press [JUKEBOX] to select "KARAOKE JUKEBOX ON" and then press [OK].

To cancel, select "JUKEBOX OFF".

Note:

- The system switches to repeat mode automatically when you switch on Karaoke jukebox.
- Karaoke jukebox is switched off when you switch off the system or start recording.

Changing the repeat setting

1 Press [PLAY MENU].

2 Press [◀, ▶] to select the setting and then press [OK].

RANDOM REPEAT RND ◁	Repeat random playback.
ALL TITLE REPEAT ◁	Repeat all tracks.
RANDOM MIX REPEAT RND ◁	Repeat random playback. Sample sound is added to the intervals of all tracks.

Changing the Karaoke effect

1 Press [MIC VOL/KARAOKE EFFECT] to select "KARAOKE EFFECT".

2 Press [▲, ▼] to select the effect.

VOCAL CANCEL	Switch on or switch off the voice guide (depending on the source).
ECHO	Add an echo effect to the sound.
KEY CONTROL	Change the key of a song.
TEMPO	USB MEMORY Change the speed of a song.
BGM	Change the background music level.
MIC EQ	Select a MIC EQ level.
OFF	Cancel the effect.

3 Press [◀, ▶] to select the setting and then press [OK].

Note:

To use the Karaoke effect in D-IN, AUX 1 or AUX 2 source, set "D-IN MODE" or "AUX MODE" to "MODE 1" (⇒ "D-IN mode and AUX mode").

Using a microphone

Preparation

Decrease the volume of the system to its minimum before you connect or disconnect a microphone.

- 1 Connect a microphone (not supplied) to the microphone jack.**
Plug type: Ø 6.3 mm monaural
- 2 Press [MIC VOL/KARAOKE EFFECT] to select "MIC1 VOL" or "MIC2 VOL".**
- 3 Press [◀, ▶] to adjust the volume of the microphone.**

If you want to sing with the background music.

- 4 Play the music source and adjust the volume of the system.**

Note:

- If a strange noise (howling) is emitted, move the microphone away from the speakers, or decrease the volume of the microphone.
- When you do not use the microphone, disconnect it from the microphone jack, and decrease the volume of the microphone to its minimum.
- This system cannot record from microphone.

Clock and timers

Setting the clock

This is a 24-hour clock.

- 1 Press [SETUP] to select "CLOCK".**
- 2 Press [◀, ▶] to set the time and then press [OK].**

To check the time

Press [SETUP] to select "CLOCK" and then press [OK].

In standby mode, press [DISPLAY].

Note:

Reset the clock regularly to maintain accuracy.

Sleep timer

The sleep timer switches off the system after the set time.

Press [SLEEP] to select the setting (in minutes).

To cancel, select "OFF".

SLEEP 30 → SLEEP 60 → SLEEP 90 → SLEEP 120
↑ OFF ←

To check the remaining time

Press [SLEEP].

Note:

- The remaining time is shown for a few seconds every minute. "SLEEP 1" is always shown when only 1 minute remains.
- The play timer and sleep timer or the record timer and sleep timer can be used together.
- The sleep timer always comes first. Be sure not to set an overlap of timers.

Play timer and record timer

(Except for Bluetooth®, D-IN, AUX 1 and AUX 2 source)

You can set the timer to come on at a certain time to:

- Wake you up (play timer).
- Record from the radio (record timer).

Play timer and record timer cannot be used together.

Preparation

Set the clock.

- 1 Press [SETUP] to select "TIMER ADJ".**
- 2 Press [◀, ▶] to select "⌚PLAY" or "⌚REC" and then press [OK].**
- 3 Press [◀, ▶] to set the start time and then press [OK].**
- 4 Do step 3 again to set the end time.**
- 5 For play timer, press [◀, ▶] to select the source you want to play and then press [OK].**
- 6 For record timer, press [◀, ▶] to select "MEMORY" or "USB B" to keep the recording and then press [OK].**

To start the timer

- 1 Prepare the source.**

Play timer	Prepare the source you want to listen to (USB, internal memory or radio) and set the volume.
Record timer	Connect the USB device to USB B (for USB recording) and tune in to the radio station.

- 2 Press [SETUP] to select "TIMER SET".**
- 3 Press [◀, ▶] to select the setting and then press [OK].**

PLAY ON	Start the play timer.
PLAY OFF	Cancel the play timer.
REC ON	Start the record timer.
REC OFF	Cancel the record timer.

"⌚" is shown.

The system must be switched off for the timer to operate.

To check the setting

- 1 Press [SETUP] to select "TIMER ADJ".**
- 2 Press [◀, ▶] to select "⌚PLAY" or "⌚REC" and then press [OK].**

In standby mode, press [DISPLAY] two times.

Note:

- The play timer starts at a low volume and increases gradually to the preset level.
- The record timer starts 30 seconds before the set time with the volume muted.
- The timer comes on at the set time every day if the timer is on.
- If you switch off the system and then switch on again while a timer is in operation, the timer will not stop at the end time.

External equipment

Preparation

- Disconnect the AC mains lead.
- Switch off all equipment and read the appropriate operating instructions.

Note:

- Do not bend cables at sharp angles.
- Components and cables are sold separately.

Using the optical input

You can connect a TV, VCR, DVD player etc., and listen to the audio through this system.

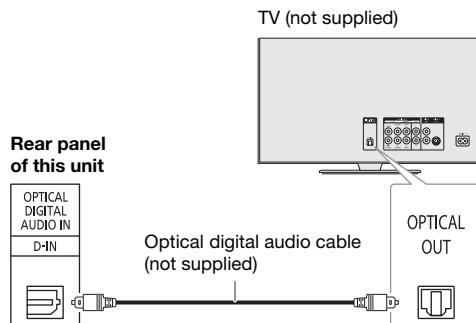

- 1 Connect the external equipment.**
- 2 Press [RADIO/EXT-IN] to select "D-IN".**
- 3 Play the external equipment.**

Note:

- This system can only detect linear PCM signals.
- Sampling frequency: 32 kHz, 44.1 kHz and 48 kHz
- The sound is muted if the signal format or frequency is not supported.
- If there are sounds coming from the TV's speakers, decrease the volume of the TV to its minimum.
- Read the operating instructions of the external equipment for details.
- If you want to connect equipment other than those described, refer to the audio dealer.
- Sound distortion can occur when you use an adaptor.

Using the auxiliary input

You can connect a VCR, DVD player etc., and listen to the audio through this system.

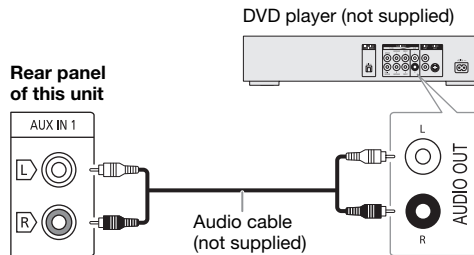

- 1 Connect the external equipment.**
- 2 Press [RADIO/EXT-IN] to select "AUX 1".**
- 3 Play the external equipment.**

Note:

- If you want to connect equipment other than those described, refer to the audio dealer.
- Sound distortion can occur when you use an adaptor.

Connecting a portable audio equipment

You can play music from a portable audio equipment.

Preparation

- Switch off the equaliser (if any) of the portable audio equipment to prevent sound distortion.
- Decrease the volume of the system and the portable audio equipment before you connect or disconnect the portable audio equipment.

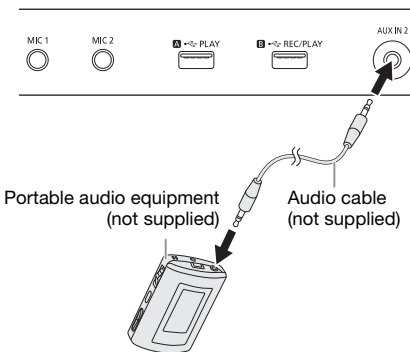

- 1 Connect the portable audio equipment.**
Plug type: Ø 3.5 mm stereo
- 2 Press [RADIO/EXT-IN] to select "AUX 2".**
- 3 Play the portable audio equipment.**

To adjust the input level

- 1 Press [PLAY MENU] to select "INPUT LEVEL".
- 2 Press [◀, ▶] to select "NORMAL" or "HIGH" and then press [OK].

Note:

- You cannot adjust the input level during recording.
- Select "NORMAL" if the sound is distorted during "HIGH" input level.
- Read the operating instructions of the portable audio equipment for details.

Connecting an additional SC-UA7 unit

You can play sound from this unit to an additional SC-UA7 unit.

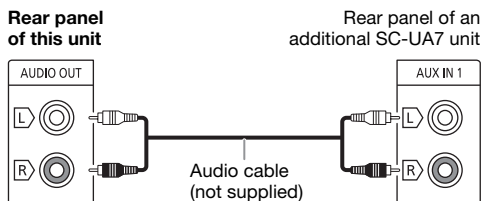

- 1 Connect the additional SC-UA7 unit.
- 2 On the additional SC-UA7 unit: Press [RADIO/EXT-IN] to select "AUX 1".
- 3 On this unit: Start playback.

Note:

Sound effects are controlled separately by each unit. Select the same sound effect on the additional SC-UA7 unit if necessary.

D-IN mode and AUX mode

- 1 Press [RADIO/EXT-IN] to select "D-IN", "AUX 1" or "AUX 2".
- 2 Press [PLAY MENU] to select "D-IN MODE" or "AUX MODE".
- 3 Press [◀, ▶] to select the mode and then press [OK].

MODE 1 (default)	Select this mode to use the Karaoke effect function.
MODE 2	Select this mode when watching TV, movies or using an external player with Karaoke features.

Others**Auto off**

This system automatically switches off when you do not use it for approximately 20 minutes.

Press [AUTO OFF] to select "ON" and then press [OK].

To cancel, select "OFF".

Note:

This function does not work when you are in radio source or when a Bluetooth® device is connected.

Bluetooth® standby

This function automatically switches on the system when you establish a Bluetooth® connection from a paired device.

- 1 Press [SETUP] to select "BLUETOOTH STANDBY".
- 2 Press [◀, ▶] to select "ON" and then press [OK]. To cancel, select "OFF".

Note:

Some devices may take longer to respond. If you are connected to a Bluetooth® device before switching off the system, wait for a minimum of 5 seconds before connecting to this system from your Bluetooth® device again.

Touch sound

The system beeps when you touch any touch key on the unit.

- 1 Press [SETUP] to select "BUZZER".
- 2 Press [◀, ▶] to select "ON" and then press [OK]. To cancel, select "OFF".

Note:

This function works even when the system is muted.

Software version

You can check the software version of the system.

- 1 Press [SETUP] to select "SW VER." and then press [OK]. The software version is shown.
- 2 Press [OK] again to exit.

Troubleshooting

Before requesting service, make the following checks. If you are in doubt about some of the check points, or if the solutions indicated do not solve the problem, consult your dealer for instructions.

Common problems

The unit does not work.

- The safety device has been activated. Do the following:
 1. Touch [⏻] on the unit to switch the unit to standby mode. If the unit does not switch to standby mode,
 - Touch and hold the touch key for a minimum of 10 seconds. Or,
 - Disconnect the AC mains lead and then connect it again.
 2. Touch [⏻] again to switch on the unit. If the problem persists, consult your dealer.

The display panel lights up and changes continuously in standby mode.

- Touch and hold [■] on the unit to select "DEMO OFF".

No operations can be done with the remote control.

- Examine that the battery is installed correctly.

Sound is distorted or no sound.

- Adjust the volume of the system.
- Switch off the system, determine and correct the cause, and then switch on again. It can be caused by straining of the speakers through excessive volume or power, and when using the system in a hot environment.

A humming sound can be heard during playback.

- An AC mains lead or fluorescent light is near the cables. Keep other appliances and cords away from the cables of this system.

The sound level reduces.

- The protection circuit has been activated due to the continuous use at high volume output. This is to protect the system and maintain the sound quality.

USB

The USB device or the contents in it cannot be read.

- The format of the USB device or the contents in it are not compatible with the system.
- USB devices with storage capacity of more than 32 GB cannot work in some conditions.

Slow operation of the USB device.

- Large content size or large memory USB device takes longer time to read.

Bluetooth®

Pairing cannot be done.

- Check the Bluetooth® device condition.
- The device is out of the 10 m communication range. Move the device nearer to the system.

The device cannot be connected.

- The pairing of the device was unsuccessful. Do pairing again.
- The pairing of the device has been replaced. Do pairing again.
- This system might be connected to a different device. Disconnect the other device and try pairing the device again.
- The system may have a problem. Switch off the system and then switch on again.

The device is connected but audio cannot be heard through the system.

- For some built-in Bluetooth® devices, you have to set the audio output to "SC-UA7" manually. Read the operating instructions of the device for details.

Sound from the device is interrupted.

- The device is out of the 10 m communication range. Move the device nearer to the system.
- Remove any obstacle between the system and the device.
- Other devices that use the 2.4 GHz frequency band (wireless router, microwaves, cordless phones, etc.) are interfering. Move the device nearer to the system and distance it from the other devices.
- Select "MODE 1" for stable communication.

The one-touch connection (NFC) is not working.

- Make sure the system and the NFC feature of the device are switched on.
- Touch and hold the device on the NFC touch area of the unit again.

Playback image and sound are not synchronised.

- Restart the playback app of the device.
- Connect the device to the system with an audio cable (not supplied).

Radio

Sound is distorted.

- Use an optional FM outdoor antenna. The antenna should be installed by a competent technician.

A beat sound is heard.

- Switch off the TV or move it away from the system.
- Move mobile telephones away from the system if the interference is apparent.

D-IN, AUX

Playback image and sound are not synchronised.

- When in D-IN source, set "D-IN MODE" to "MODE 2".
- When in AUX 1 or AUX 2 source, set "AUX MODE" to "MODE 2".

Karaoke effect cannot be used.

- When in D-IN source, set "D-IN MODE" to "MODE 1".
- When in AUX 1 or AUX 2 source, set "AUX MODE" to "MODE 1".

Unit displays

"ADJUST CLOCK"

- The clock is not set. Adjust the clock.

"ADJUST TIMER"

- The play timer and/or record timer is not set. Adjust the play timer and/or record timer.

"ALB FULL"

- The number of albums has exceeded the supported limit.

"AUDIO UNSUPPORTED"

- The signal format or frequency is not supported.
- This system does not support bitstream signals. Change the digital audio output setting on the external equipment to PCM.
- This system supports sampling frequencies of 32 kHz, 44.1 kHz and 48 kHz. Select only the supported sampling frequencies on the connected equipment.
- Try connecting the external equipment by using the auxiliary input.

"AUTO OFF"

- The system has not been used for 20 minutes and will switch off within a minute. To cancel, press any button or touch any touch key.

"CAN'T REC"

- You cannot do recording because the remaining recording time of the USB device is less than the total time of the music source. Change to a USB device which has enough recording time and do the recording again.
- You cannot do recording because the USB device is write-protected. Remove the write protection of the USB device and try again.

"DEVICE FULL"

- You cannot do recording because the remaining recording time of the USB device is less than the total time of the music source. Change to a USB device which has enough recording time and do the recording again.

"ERROR"

- An incorrect operation was done. Read the instructions and try again.

"ERROR" (during recording)

- You cannot select other playback source (example: radio, USB etc.) or press [◀◀] or [▶▶] during recording. Stop the recording function.

"F61"

- There is a problem with the amplifier of the system.
- Disconnect the USB device. Switch off the system and then switch on again.

"F703"

- Examine the Bluetooth® connection.
- Disconnect the Bluetooth® device. Switch off the system and then switch on again.

"F76"

- There is a problem with the power supply.
- Disconnect the AC mains lead and consult your dealer.

"F77"

- Disconnect the AC mains lead and consult your dealer.

"NO DEVICE"

- You cannot do recording or check available storage space because there is no USB device connected to **USB B**.

"NO PLAY"**"UNSUPPORT"**

- Examine the content. You can only play supported format.
- The files in the USB device can be corrupted. Format the USB device and try again.
- The system may have a problem. Switch off the system and then switch on again.

"NO TRACK"

- There is no album or track in the USB device or the internal memory.

"PLAYERERROR"

- An unsupported MP3 file has been played. The system will skip that track and play the next one.

"REC ERROR"

- You disconnected the USB device during recording. Connect the USB device and do recording again.
- An error occurred during USB recording. Disconnect the USB device and then connect it again.

"REMOTE 1"**"REMOTE 2"**

- The remote control and the unit are using different codes. Change the code of the remote control.
 - When "REMOTE 1" is shown, press and hold [OK] and [1] for a minimum of 4 seconds.
 - When "REMOTE 2" is shown, press and hold [OK] and [2] for a minimum of 4 seconds.

"TRK FULL"

- The number of files has exceeded the supported limit.

"USB A NO DEVICE"**"USB B NO DEVICE"**

- The USB device is not connected. Examine the connection.

"USB OVER CURRENT ERROR"

- The USB device is using too much power. Disconnect the USB device, switch off the system and then switch on again.

"VBR"

- The system cannot show the remaining play time for variable bit rate (VBR) tracks.

Remote control code

When other Panasonic equipment responds to the remote control of this system, change the remote control code for this system.

Preparation

Press [RADIO/EXT-IN] to select "AUX 1" or "AUX 2".

To set the code to "REMOTE 2"

- 1 Touch and hold [SELECT] on the unit and [2] on the remote control until "REMOTE 2" is shown.
- 2 Press and hold [OK] and [2] for a minimum of 4 seconds.

To set the code to "REMOTE 1"

- 1 Touch and hold [SELECT] on the unit and [1] on the remote control until "REMOTE 1" is shown.
- 2 Press and hold [OK] and [1] for a minimum of 4 seconds.

System memory reset

Reset the memory when the following situations occur:

- There is no response when buttons are pressed or when touch keys are touched.
- You want to clear and reset the memory contents.

- 1 Touch and hold [⏮] on the unit until "RESET?" is shown.

- 2 While you touch and hold [⏮] on the unit, touch [SELECT].

"RESET" is shown.

After "-----" is shown, the unit will switch off automatically.

All the settings are set back to the factory preset.

It is necessary to set the memory items again.

Specifications

Amplifier section

RMS output power stereo mode

Front Left/Right Ch	375 W per channel (3 Ω), 1 kHz, 30% THD
Subwoofer Ch (x 2)	475 W per channel (2 Ω), 100 Hz, 30% THD
Total RMS stereo mode power	1700 W

PMPO output power 18700 W

Tuner, terminals section

Frequency modulation (FM)

Preset memory	30 stations
Frequency range	87.50 MHz to 108.00 MHz (50 kHz step)
Antenna terminals	75 Ω (unbalanced)

Digital audio input

Optical digital input	Optical terminal
Sampling frequency	32 kHz, 44.1 kHz, 48 kHz

AUX IN 1

Audio input	Pin jack
-------------	----------

AUX IN 2

Audio input	Stereo, 3.5 mm jack
-------------	---------------------

AUDIO OUT

Audio output	Pin jack
--------------	----------

Microphone

Terminal	Mono, 6.3 mm jack (2 system)
----------	------------------------------

USB section

USB port

USB standard	USB 2.0 full speed
Media file format support	MP3 (*.mp3)
USB device file system	FAT12, FAT16, FAT32

USB recording

Bit rate	128 kbps
USB recording speed	1x
Recording file format	MP3 (*.mp3)

Internal memory section

Memory

Memory size	4 GB
Media file format support	MP3 (*.mp3)

Memory recording

Bit rate	128 kbps
Memory recording speed	1x
Recording file format	MP3 (*.mp3)

Bluetooth® section

Version	Bluetooth® Ver. 2.1 + EDR
Class	Class 2
Supported profiles	A2DP, AVRCP, SPP, OPP, FTP
Operating frequency	2.4 GHz band FH-SS
Operation distance	10 m line of sight

Speaker section

Front speaker

Speaker unit(s)	
Tweeter x 4	6 cm cone type
Woofer x 4	8 cm cone type

Subwoofer

Speaker unit(s)	
Super Woofer x 2	16 cm cone type

General

Power supply	AC 220 V to 240 V, 50/60 Hz
Power consumption	190 W
Dimensions (W x H x D)	260 mm x 744 mm x 295 mm
Mass	14 kg
Operating temperature range	0°C to +40°C
Operating humidity range	20% to 80% RH (no condensation)

Power consumption in standby mode (approximate)

0.5 W

Power consumption in standby mode (approximate) (With "BLUETOOTH STANDBY" set to "ON")

0.6 W

Note:

- Specifications are subject to change without notice.
- Mass and dimensions are approximate.
- Total harmonic distortion is measured by the digital spectrum analyser.

Limited Warranty (Australia)

Panasonic Warranty

1. The product is warranted for 12 months from the date of purchase. Subject to the conditions of this warranty Panasonic or its Authorised Service Centre will perform necessary service on the product without charge for parts or labour, if in the opinion of Panasonic, the product is found to be faulty within the warranty period.
2. This warranty only applies to Panasonic products purchased in Australia and sold by Panasonic Australia or its Authorised Distributors or Dealers and only where the products are used and serviced within Australia or its territories. Warranty cover only applies to service carried out by a Panasonic Authorised Service Centre and only if valid proof of purchase is presented when warranty service is requested.
3. This warranty only applies if the product has been installed and used in accordance with the manufacturer's recommendations (as noted in the operating instructions) under normal use and reasonable care (in the opinion of Panasonic). The warranty covers normal domestic use only and does not cover damage, malfunction or failure resulting from use of incorrect voltages, incorrect installation, accident, misuse, neglect, build-up of dirt or dust, abuse, maladjustment of customer controls, mains supply problems, thunderstorm activity, infestation by insects or vermin, tampering or repair by unauthorised persons (including unauthorised alterations), introduction of sand, humidity or liquids, commercial use such as hotel, office, restaurant, or other business or rental use of the product, exposure to abnormally corrosive conditions or any foreign object or matter having entered the product.
4. This warranty does not cover the following items unless the fault or defect existed at the time of purchase:

(a) Cabinet Part(s)	(e) DVD, Blu-ray or Recordable Discs
(b) Video or Audio Tapes	(f) Video / Audio Heads from wear and tear in normal use
(c) SD cards or USB devices	(g) Information stored on Hard Disk Drive, USB stick or SD card
(d) User replaceable Batteries	(h) DTV reception issues caused by TV Aerial / Cabling / Wall socket(s) etc
5. Some products may be supplied with Ethernet connection hardware. The warranty is limited on such products and will not cover

(a) Internet and or DLNA connection / setup related problems
(b) Access fees and or charges incurred for internet connection
(c) The use of incompatible software or software not specifically stipulated in the product operations manual; and
(d) Any indirect or consequential costs associated with the incorrect use or misuse of the hardware, its connection to the internet or any other device.
6. To claim warranty service, when required, you should:
 - Telephone Panasonic's Customer Care Centre on 132600 or visit our website referred to below and use the Service Centre Locator for the name / address of the nearest Authorised Service Centre.
 - Send or take the product to a Panasonic Authorised Service Centre together with your proof of purchase receipt as a proof of purchase date. Please note that freight and insurance to and / or from your nearest Authorised Service Centre must be arranged by you.
 - Note that home or pick-up / delivery service is available for the following products in the major metropolitan areas of Australia or the normal operating areas of the nearest Authorised Service Centres:
 - Plasma / LCD televisions / displays (screen size greater than 103 cm)
7. The warranties hereby conferred do not extend to, and exclude, any costs associated with the installation, de-installation or re-installation of a product, including costs related to the mounting, de-mounting or remounting of any screen, (and any other ancillary activities), delivery, handling, freighting, transportation or insurance of the product or any part thereof or replacement of and do not extend to, and exclude, any damage or loss occurring by reason of, during, associated with, or related to such installation, de-installation, re-installation or transit.

Panasonic Authorised Service Centres are located in major metropolitan areas and most regional centres of Australia, however, coverage will vary dependant on product. For advice on exact Authorised Service Centre locations for your product, please telephone our Customer Care Centre on 132600 or visit our website and use the Service Centre Locator.

In addition to your rights under this warranty, Panasonic products come with consumer guarantees that cannot be excluded under the Australian Consumer Law. If there is a major failure with the product, you can reject the product and elect to have a refund or to have the product replaced or if you wish you may elect to keep the goods and be compensated for the drop in value of the goods. You are also entitled to have the product repaired or replaced if the product fails to be of acceptable quality and the failure does not amount to a major failure.

If there is a major failure in regard to the product which cannot be remedied then you must notify us within a reasonable period by contacting the Panasonic Customer Care Centre. If the failure in the product is not a major failure then Panasonic may choose to repair or replace the product and will do so in a reasonable period of time from receiving notice from you.

THIS WARRANTY CARD AND THE PURCHASE DOCKET (OR SIMILAR PROOF OF PURCHASE) SHOULD BE RETAINED BY THE CUSTOMER AT ALL TIMES

If you require assistance regarding warranty conditions or any other enquiries, please visit the **Panasonic Australia** website www.panasonic.com.au or contact by phone on **132 600**
If phoning in, please ensure you have your operating instructions available.

Panasonic Australia Pty. Limited

ACN 001 592 187 ABN 83 001 592 187
 1 Innovation Road, Macquarie Park NSW 2113

PRO-031-F11 Issue: 4.0

01-01-2011

RQT0B17

20
20

Confidential
 Until: 1 Aug 2016