

# Ventilating Fan Specifications

**Model FV-60GT4**

		200V		220V		380V		400V	415V	440V
		50Hz	60Hz	50Hz	60Hz	50Hz	60Hz	50Hz	50Hz	50Hz
Air Volume	CMH $\pm$ 10%	9,360	10,800	9,420	10,860	9,420	10,920	9,510	9,540	9,540
Power Consumption	W $\pm$ 15%	325	475	340	490	310	450	345	325	335
Current	A $\pm$ 15%	1.60	1.80	1.70	1.80	0.85	0.90	0.90	0.89	0.94
Speed	R/M $\pm$ 10%	940	1,090	960	1,110	940	1,070	940	950	950
Starting Current	A	8.0	7.1	8.6	7.8	3.6	3.5	3.7	3.8	4.0
Noise	dB (A)	49	53	50	54	49	53	49	49	49

at 0mmAq. Static pressure.

- |                                |   |
|--------------------------------|---|
| 1. Power Rating -----          | 3 PASE AC 200-220V 50/60Hz<br>3 PASE AC 380-440V 50Hz. AC 380V 60Hz |
| 2. Motor Type -----            | 3 PASE induction motor. Class E. 6 Pole                             |
| 3. Blade Type -----            | Propeller fan   |
| 4. Ambient temperature -----   | - 10 to 50 deg.C  |
| 5. Insulation Resistance ----- | More than 1 meg ohm   |
| 6. Electric Strength -----     | AC 1500V 1 minute   |
| 7. Weight -----                | 34.0 Kg   |
| 8. Color -----                 | White   |

## Performance Data

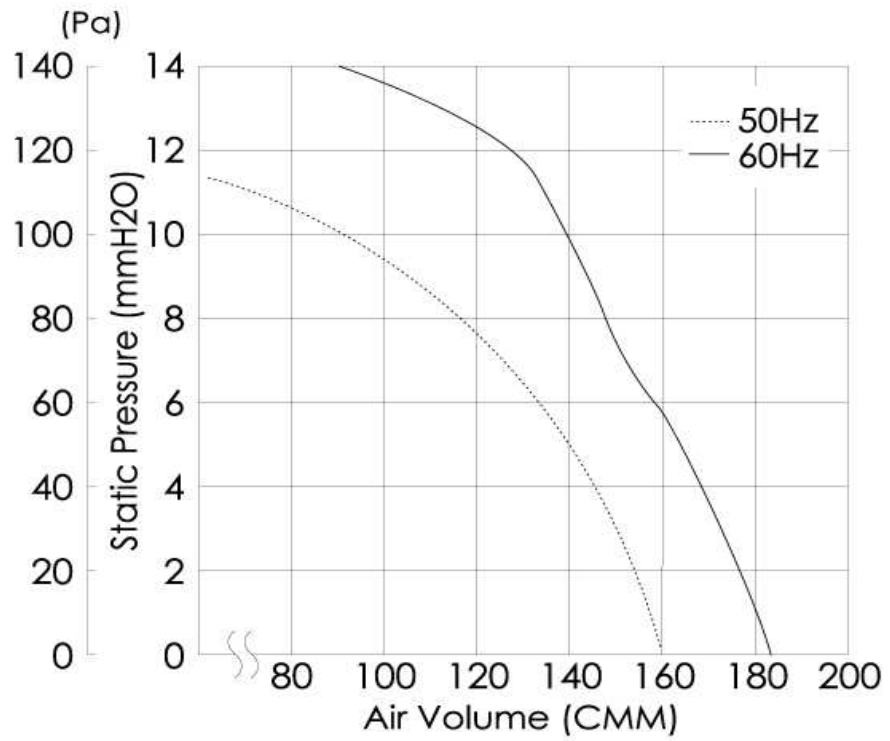

## Dimension

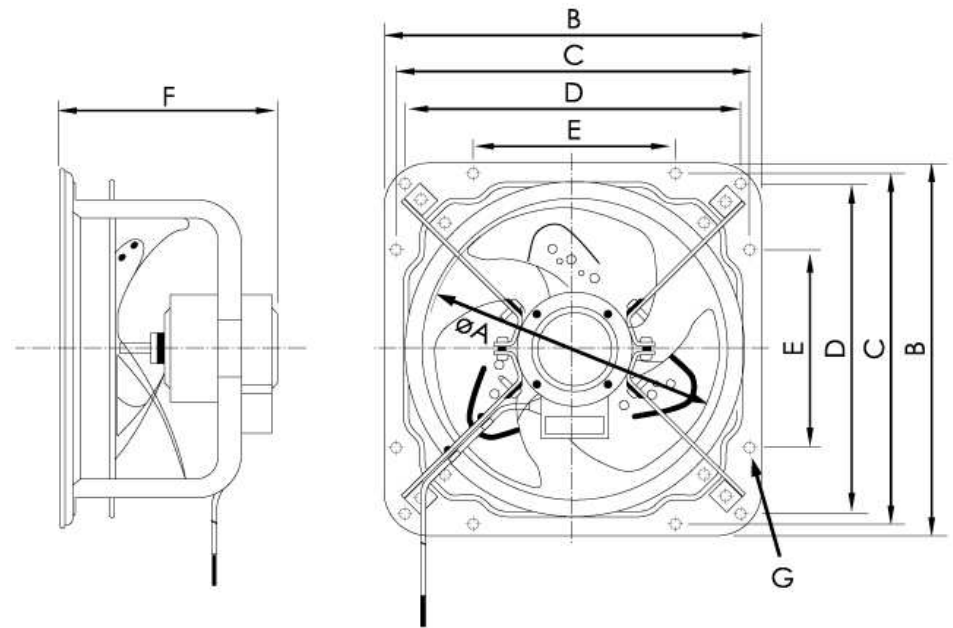

FV-60GT4	A	B	C	D	E	F	G
	620	760	720	650	400	320	15